

ONTARIO PROVINCIAL STANDARD DRAWING	Nov 2006 Rev 1	ONTARIO PROVINCIAL STANDARD DRAWING	Nov 2006 Rev 1
STRAW BALE FLOW CHECK DAM	OPSD 219.180	LIGHT-DUTY SILT FENCE BARRIER	OPSD 219.110

- NOTES:**
- 1 Number of bales varies to suit ditch.
 - 2 Straw bales to be butted tightly against adjoining bales and shaped to conform to the sides of the ditch to prevent water flow through barrier.
 - 3 All dimensions are in millimetres unless otherwise shown.
- NOTES:**
- THE CONTRACTOR SHALL IMPLEMENT BEST MANAGEMENT PRACTICES, TO PROVIDE FOR PROTECTION OF THE AREA DRAINAGE SYSTEM AND THE RECEIVING WATERCOURSE, DURING CONSTRUCTION ACTIVITIES. THE CONTRACTOR ACKNOWLEDGES THAT FAILURE TO IMPLEMENT APPROPRIATE EROSION AND SEDIMENT CONTROL MEASURES MAY BE SUBJECT TO PENALTIES IMPOSED BY ANY APPLICABLE REGULATORY AGENCY.
1. SILT FENCE TO BE ERECTED PRIOR TO EARTH WORKS BEING COMMENCED. SILT FENCE TO BE MAINTAINED UNTIL VEGETATION IS ESTABLISHED OR UNTIL START OF SUBSEQUENT PHASE.
 2. STRAW BALE SEDIMENT TRAPS TO BE CONSTRUCTED IN EXISTING ROAD SIDE DITCHES. TRAPS TO REMAIN AND BE MAINTAINED UNTIL VEGETATION IS ESTABLISHED.
 3. SILT SACK TO BE PLACED AND MAINTAINED UNDER COVER OF ALL CATCHBASINS. GEOTEXTILE SILT SACK IN STREET C/Bs TO REMAIN UNTIL ALL CURBS ARE CONSTRUCTED. GEOTEXTILE FABRIC IN RYCBs TO REMAIN UNTIL VEGETATION IS ESTABLISHED. ALL CATCHBASINS TO BE REGULARLY INSPECTED AND CLEANED, AS NECESSARY, UNTIL SOD AND CURBS ARE CONSTRUCTED.
 4. CONTRACTOR TO PROVIDE DETAILS ON LOCATION(S) AND DESIGN OF DEWATERING TRAP(S) PRIOR TO COMMENCING WORK. CONTRACTOR ALSO RESPONSIBLE FOR MAINTAINING TRAP(S) AND ADJUSTING SIZE(S) IF DEEMED REQUIRED BY THE ENGINEER DURING CONSTRUCTION.
 5. CONTRACTOR TO PROTECT EXISTING CATCHBASINS WITH FILTER CLOTH UNDER THE COVERS TO TRAP SEDIMENTATION. REFER TO IDENTIFIED STRUCTURES.
 6. WORKS NOTED ABOVE ARE TO BE INSTALLED, INSPECTED, MAINTAINED AND ULTIMATELY REMOVED BY SERVICING CONTRACTOR.
 7. THIS IS A "LIVING DOCUMENT" AND MAY BE MODIFIED IN THE EVENT THE PROPOSED CONTROL MEASURES ARE INSUFFICIENT

LEGEND:

- LIGHT DUTY SILT FENCE AS PER OPSD-219.110
- SNOW FENCE
- STRAW BALE CHECK DAM AS PER OPSD-219.180
- ROCK CHECK DAM AS PER OPSD-219.210
- SILT SACK PLACED UNDER EXISTING CB COVER
- TEMPORARY MUD MAT 0.15m THICK 50mm CLEAR STONE ON NON WOVEN FILTER CLOTH

CLIENT

MAGIL LAURENTIENNE
ML Wellington Realty Investments Inc.
C/O ML DEVCO INC.
651, Church Avenue N.
Ottawa (Ontario) K1Z 5G2
Tel: 613-686-6319

COPYRIGHT
This drawing has been prepared solely for the intended use. Any reproduction or distribution for any purpose other than authorized by IBI Group is forbidden. Written dimensions shall have precedence over scaled dimensions. Contractors shall verify and be responsible for all dimensions and conditions on the job, and IBI Group shall be informed of any variations from the dimensions and conditions shown on the drawing. Shop drawings shall be submitted to IBI Group for general conformance before proceeding with fabrication.

IBI Group Professional Services (Canada) Inc.
is a member of the IBI Group of companies.

ISSUES	DESCRIPTION	DATE
1	ISSUED FOR COORDINATION	2022-01-26
2		
3		
4		
5		

NOT FOR CONSTRUCTION

0.011, 012 FOR NOTES, LEGEND, CB TABLE, STREET SECTIONS AND DETAILS.

KEY PLAN
N.T.S.

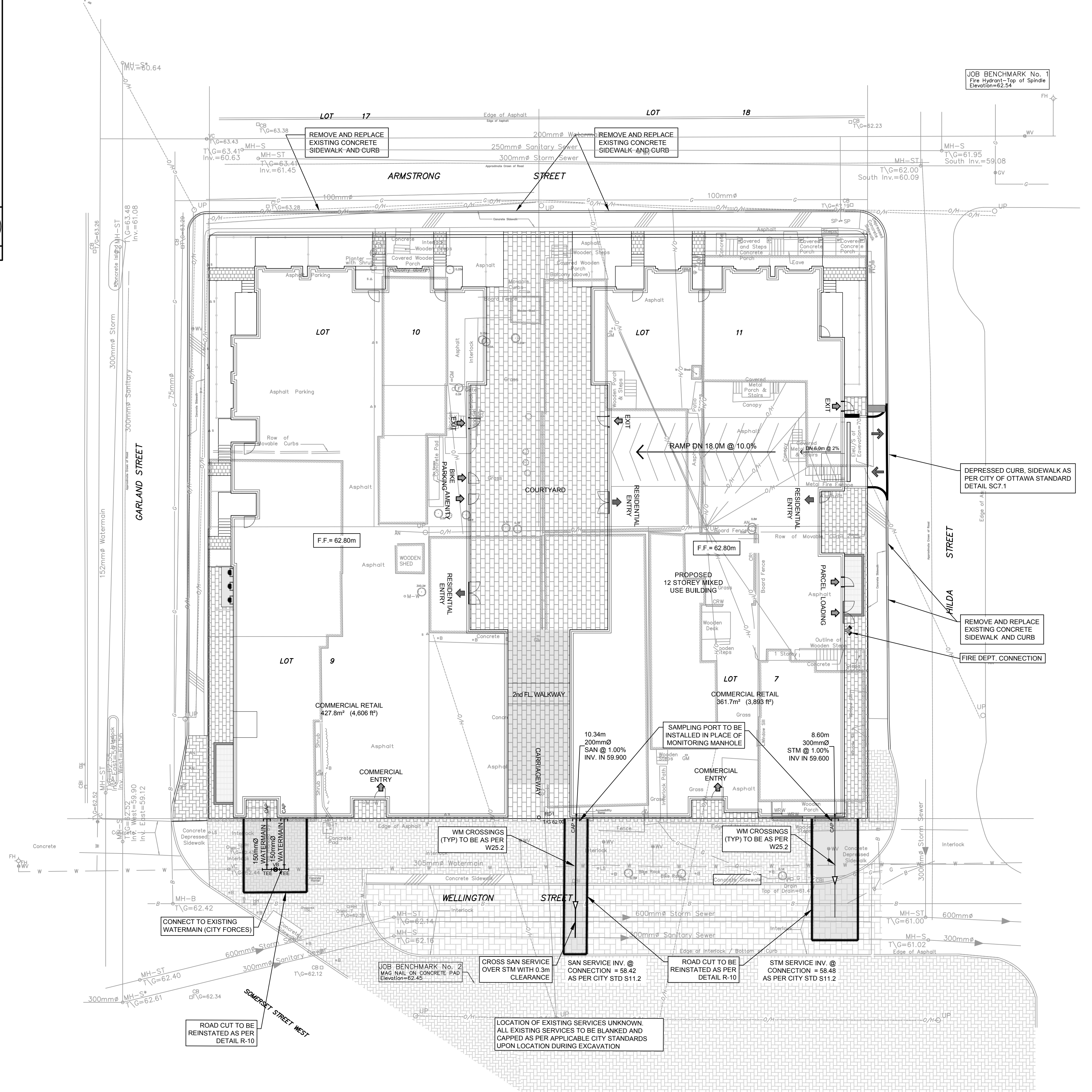

LEGEND:

FOTENN CONSULTANTS INC. 285 Cooper Street, Suite 300 Ottawa, Ontario, K2P 0V7 T: 613 730 5709 F: 613 730 1136 E: info@fotenn.com	Geotechnical Engineer PATERSON GROUP 154 Colborne Road South Ottawa, Ontario, K2E 7J5 T: 613 229 7281 E: info@patersongroup.ca
Geotechnical Engineer CGH TRANSPORTATION INC. 113 Main Street Ottawa, Ontario, K1S 5N4 T: 343 969 6117 E: chris@cgtransportation.com	Architecture RODERICK LAHEY ARCHITECTS 56 Beech Street Ottawa, Ontario, K1S 3J6 T: 613 724 8932 E: adam@rodericklahey.ca

SEAL

J. I. MOFFATT
2022/01/28
PROVINCE OF ONTARIO

1:200

PROJECT

979, WELLINGTON

PROJECT NO: 126031

DRAWN BY: J.B./D.P.S.

CHECKED BY: J.B.

PROJECT MGR: J.I.M.

APPROVED BY: J.I.M.

SHEET TITLE

EROSION AND SEDIMENTATION CONTROL PLAN

SHEET NUMBER C-900

ISSUE 1

IBI GROUP
Suite 400 - 333 Preston Street
Ottawa ON K1S 5N4 Canada
Tel: 613 225 1311 / 613 241 3300 Fax: 613 225 9868
ibigroup.com

PROJECT

979, WELLINGTON

PROJECT NO: 126031

DRAWN BY: J.B./D.P.S.

CHECKED BY: J.B.

PROJECT MGR: J.I.M.

APPROVED BY: J.I.M.

SHEET TITLE

EROSION AND SEDIMENTATION CONTROL PLAN

SHEET NUMBER C-900

ISSUE 1

CITY PLAN No. xxxxx

CITY FILE No. D07-XX-XX-XXXX
Scale Check
File Location: \\1128031_979Wellington\03_Design\04_Civil\Sheets\C-900 EROSION AND SEDIMENTATION CONTROL PLAN.dwg Last Saved: December 16, 2021, by: DSiluma Printed: Wednesday, March 2, 2022 2:10:23 PM by: Don Sturms