

Drawing Remains the Property of/Copyright Reserved by Gino J. Aiello Landscape Architect. Do Not Use or Reproduce Without Approval of Gino J. Aiello. NOT To Be Used For Construction Unless indicated by Revision: "FOR LANDSCAPE CONSTRUCTION". Contractor is Responsible for Verification of Site Locations of all Utilities. Report any Discrepancies Between Site and Drawing Immediately to Gino J. Aiello. Do NOT Proceed Until Clarified.

TURF AREAS TO BE SOD C/W 150MM DEPTH TOPSOIL ON APPROVED SUBGRADE | SOD TO BE #1 GRADE TURFGRASS NURSERY SOD per NSGA - Fine Fescue/Kentucky Bluegrass Sod | PLANTING MIX TO BE APPROVED BY LANDSCAPE ARCHITECT | PLANT MATERIAL TO MEET CNLA STANDARDS/BE APPROVED BY LANDSCAPE ARCHITECT PRIOR TO PLANTING | ALL MATERIALS & WORK TO BE MAINTAINED UNTIL FINAL ACCEPTANCE. (MOWING TURF, WEEDING BEDS, WATERING TURF & PLANTS) & INCLUDE 1 YEAR WARRANTY FROM DATE OF FINAL ACCEPTANCE | PROVIDE WATERING OF ALL PLANT MATERIAL AS REQUIRED FOR PROPER ESTABLISHMENT, UNTIL END OF WARRANTY PERIOD | REFER TO CIVIL ENGINEER'S DRAWING FOR ELEVATIONS / GRADING |

The Landscape Plan is to be read in conjunction with the grading, servicing, site and survey plan | Bare root material to be planted in season only | All plant material locations to be staked on site by the landscape contractor and checked by the landscape architect prior to planting | All trees to be preserved on or directly adjacent to the site will be protected | Plant material are to be installed a minimum of, 3.0m away from any part of any hydro transformer, 3.0m corridor between a fire hydrant and the curb, a 2.5m radius beside or behind a fire hydrant, 2.0m from any servicing/utility line or structure |

REFER TO TCR BY IFS

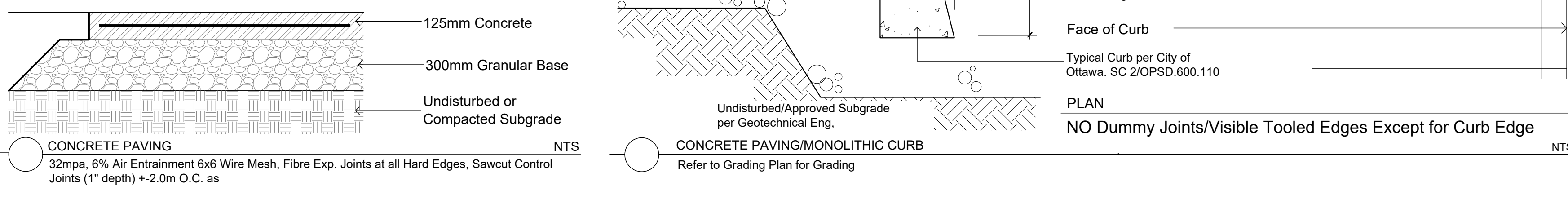
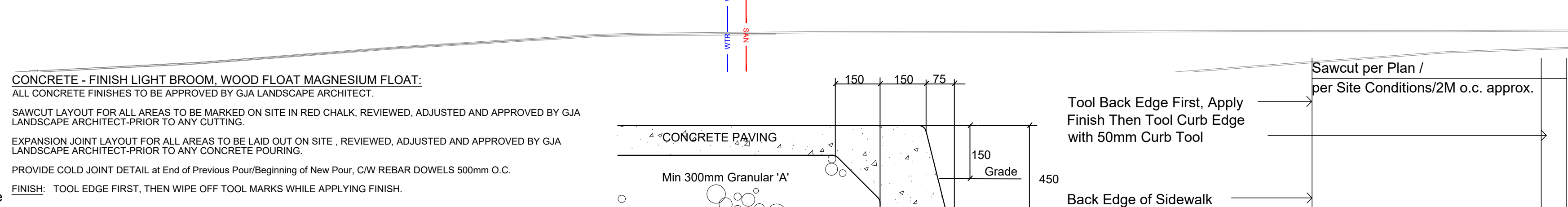
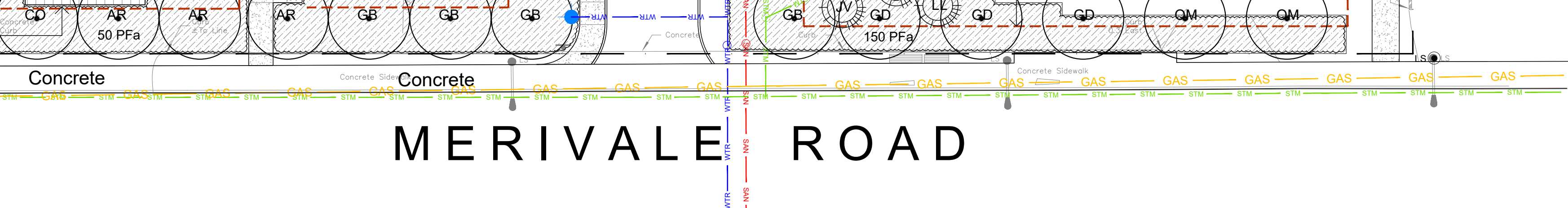
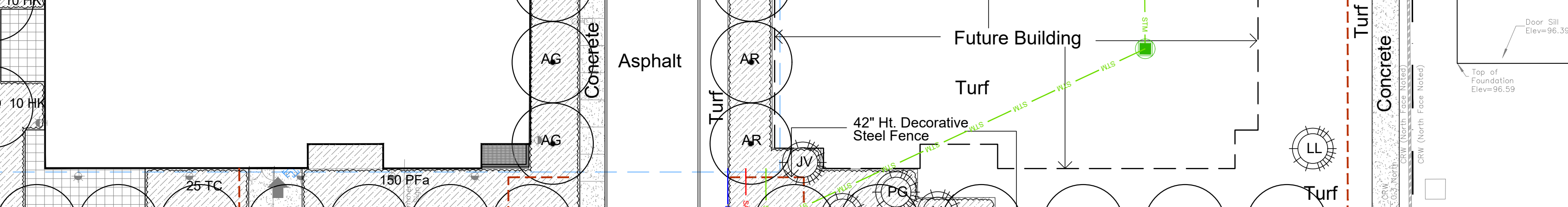
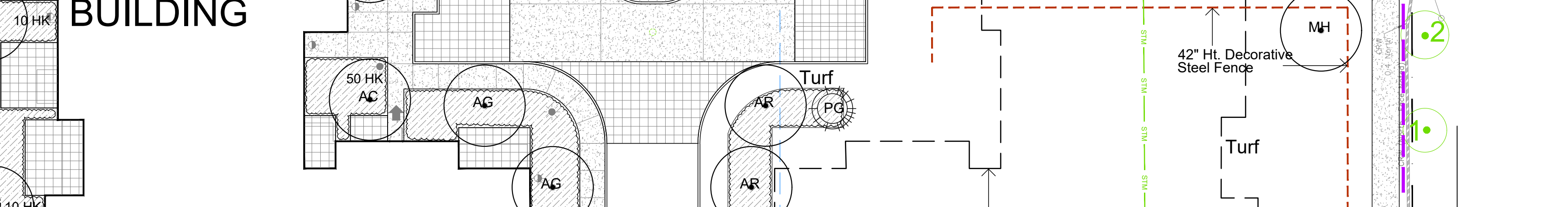
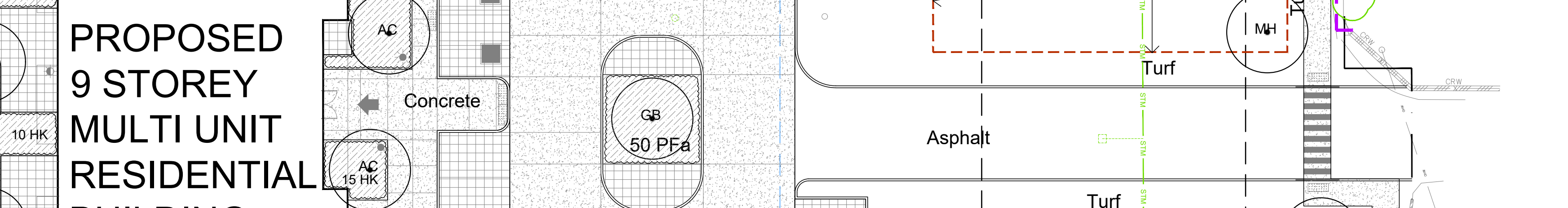
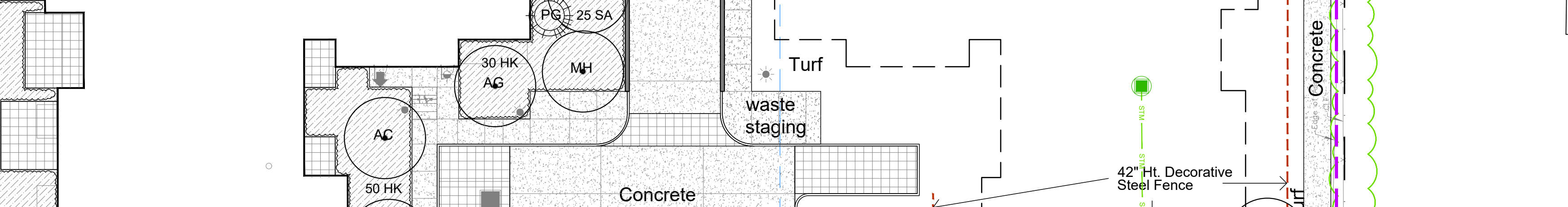
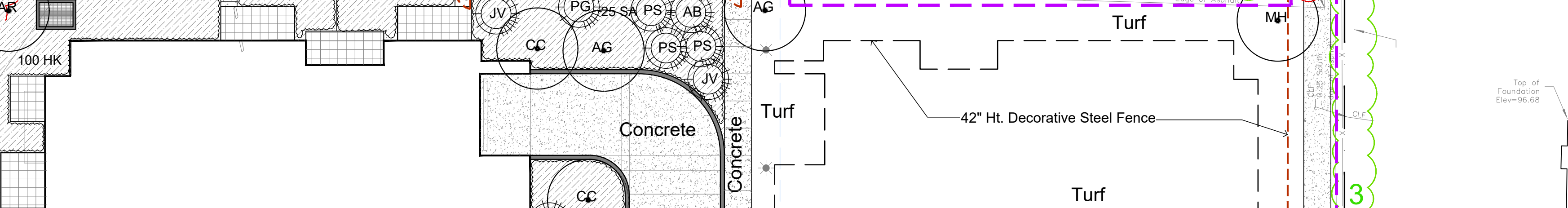
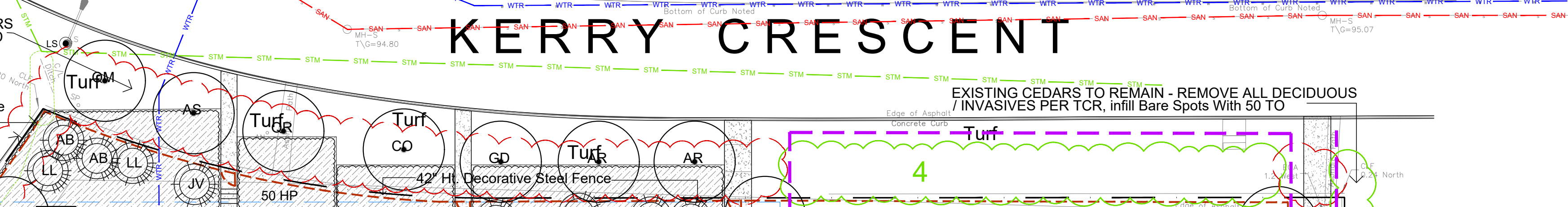
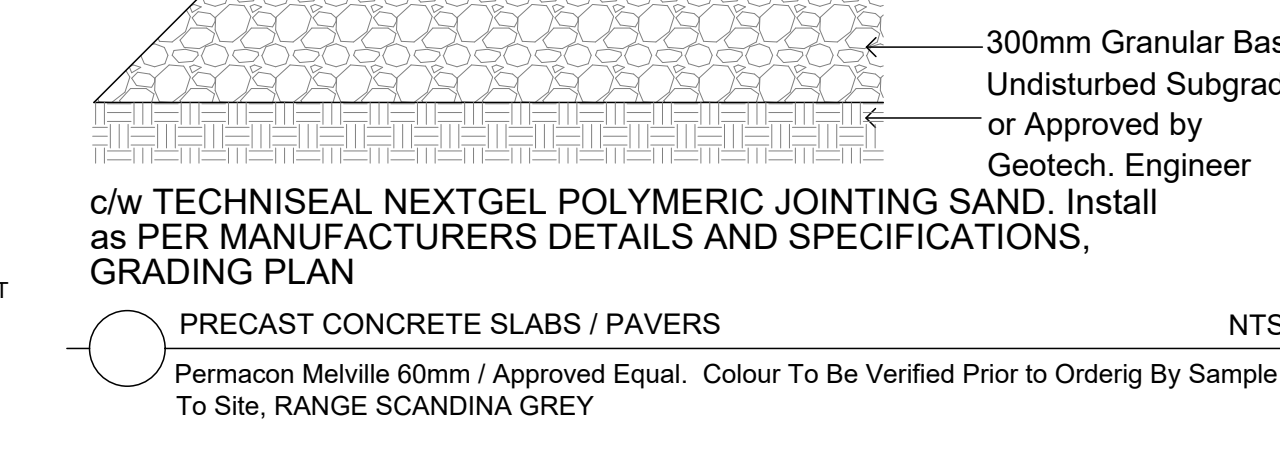
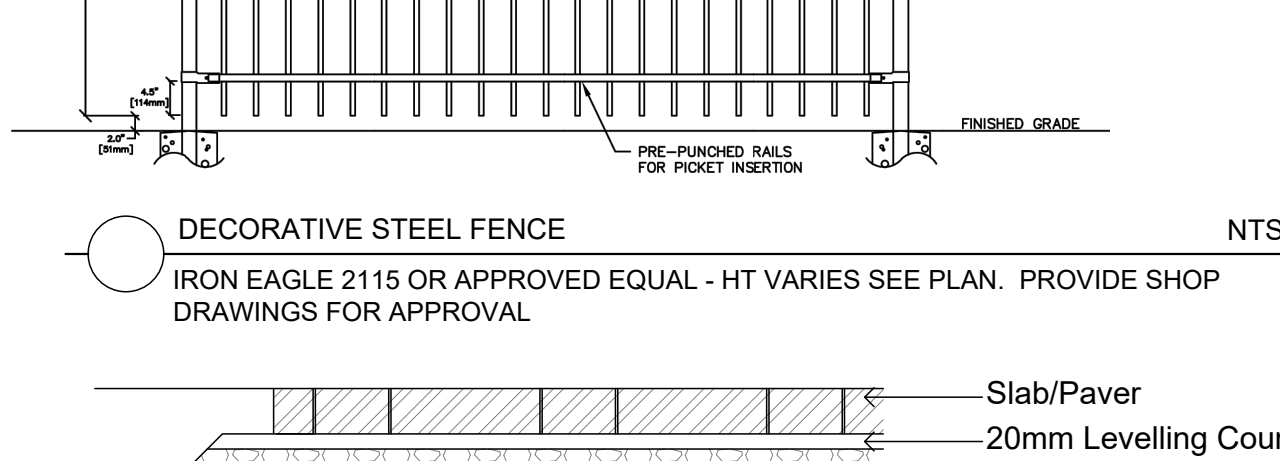
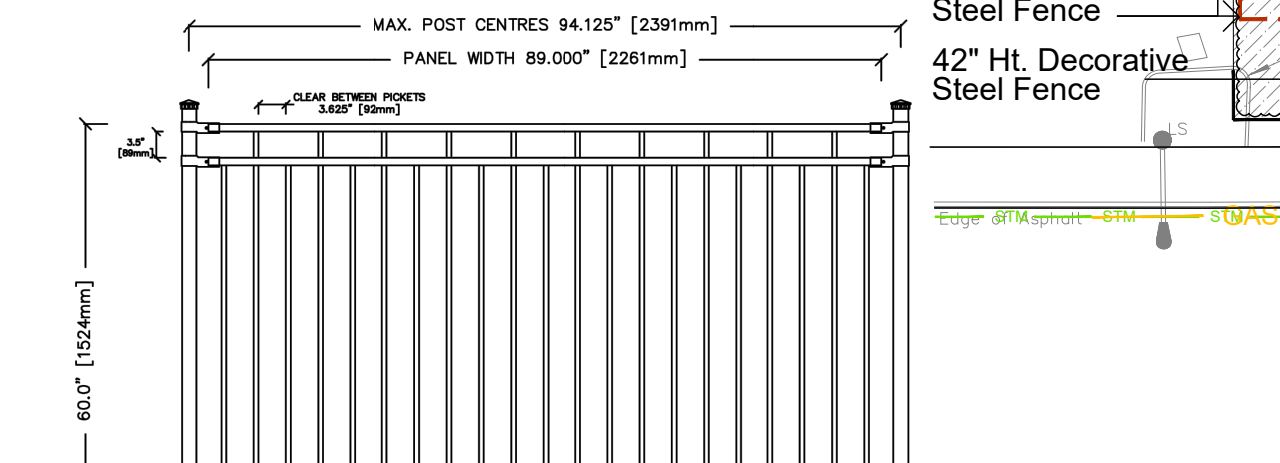
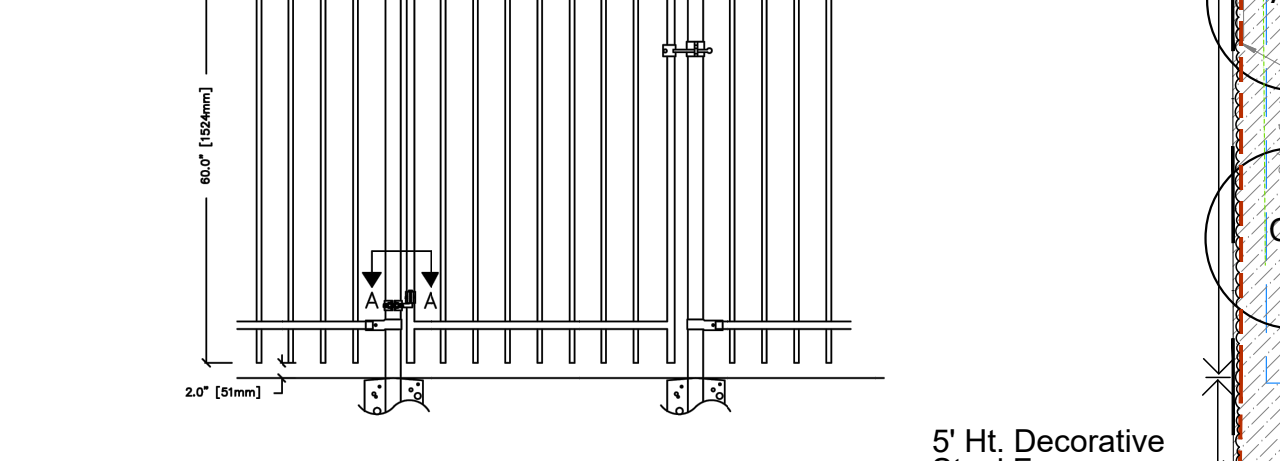
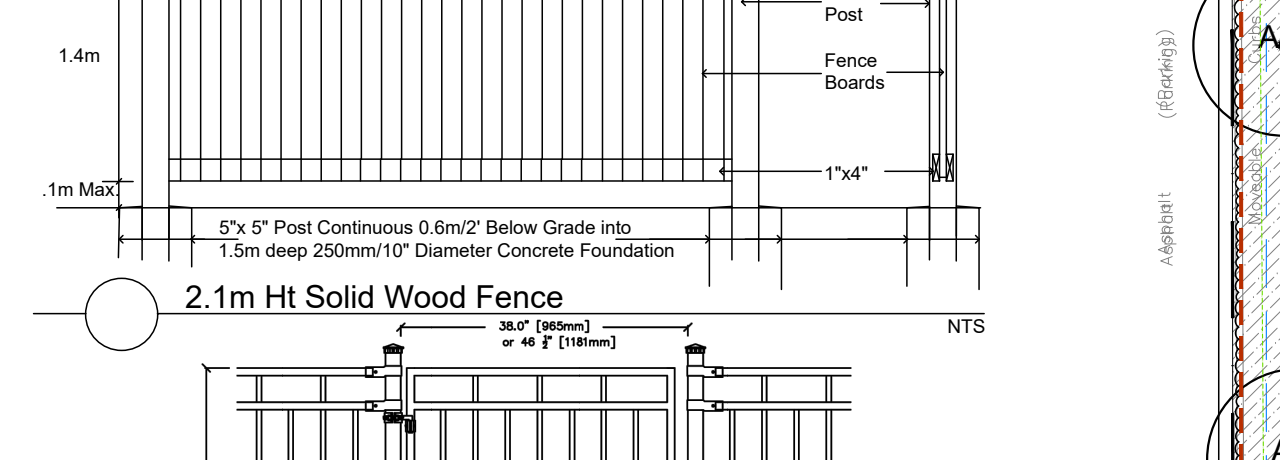
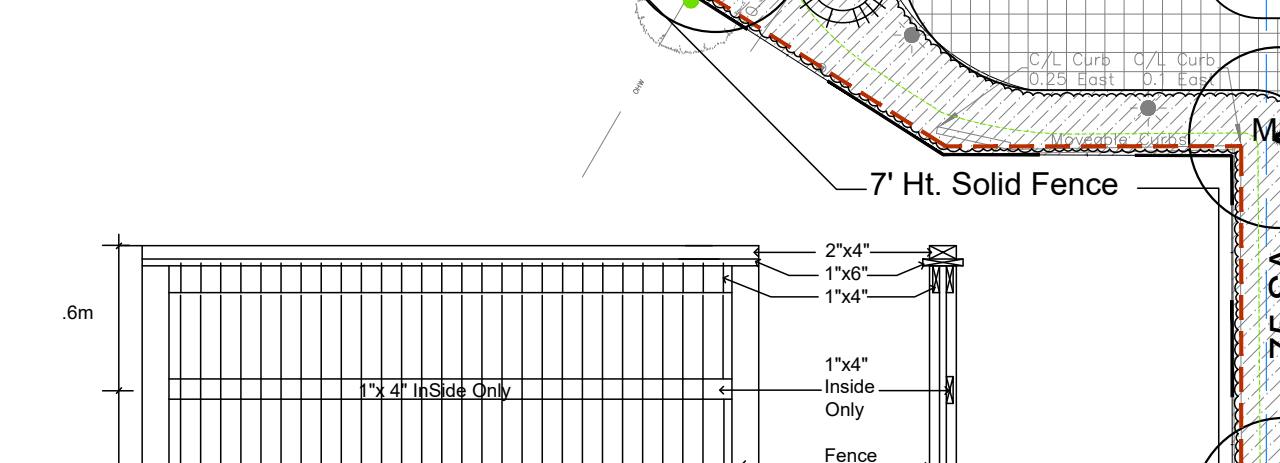
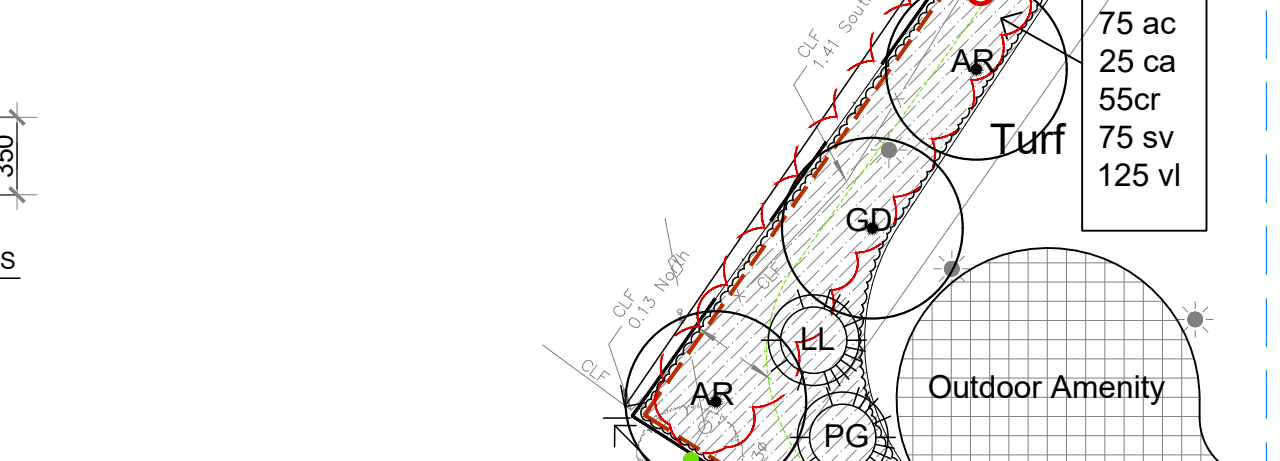
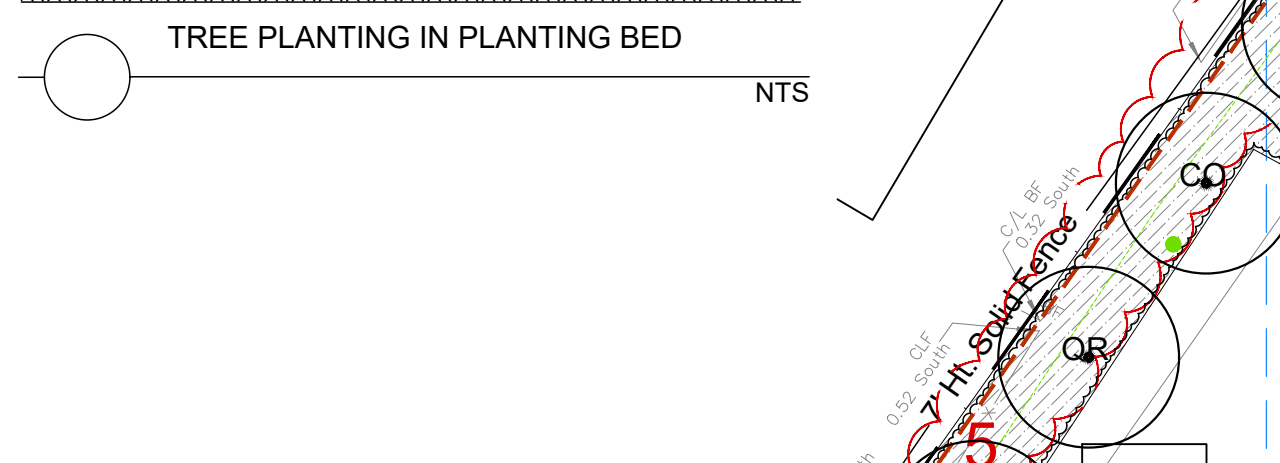
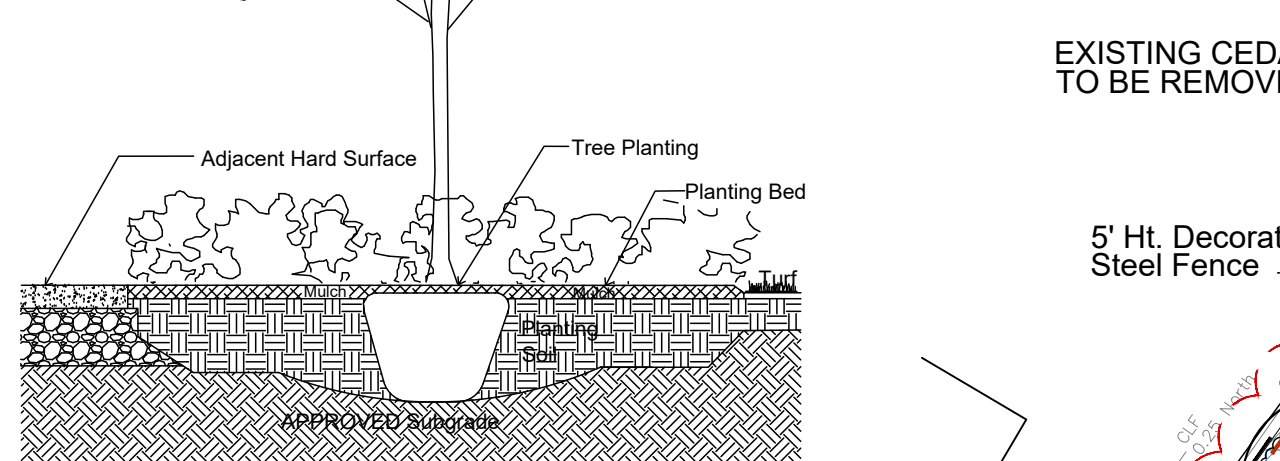
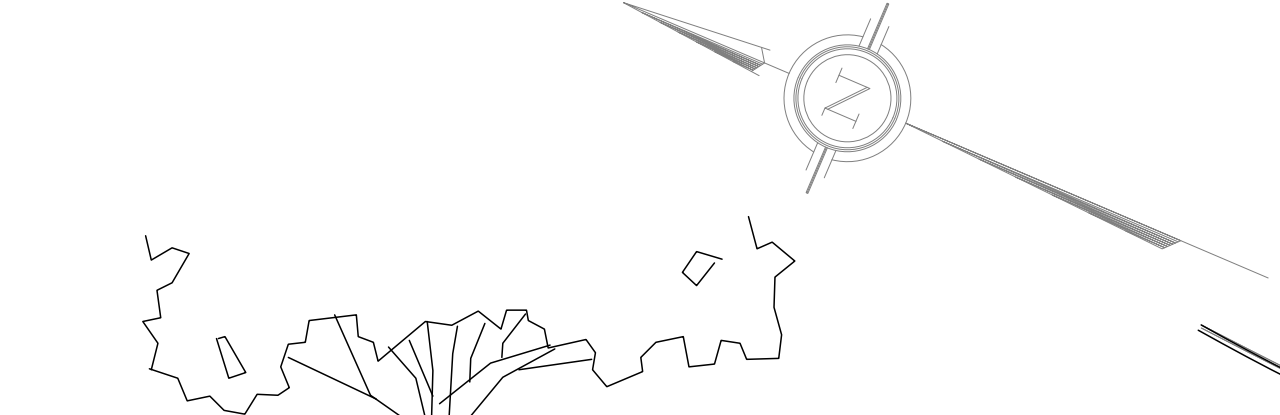
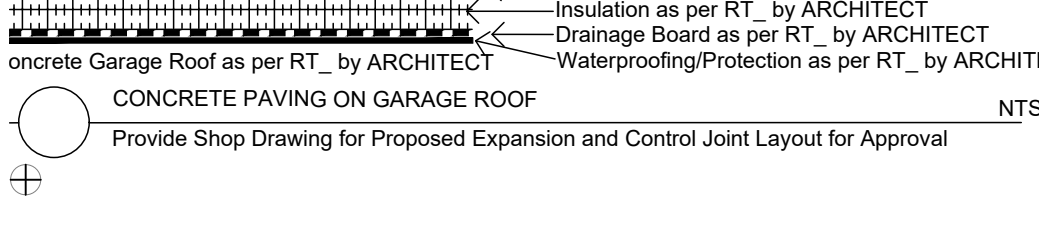
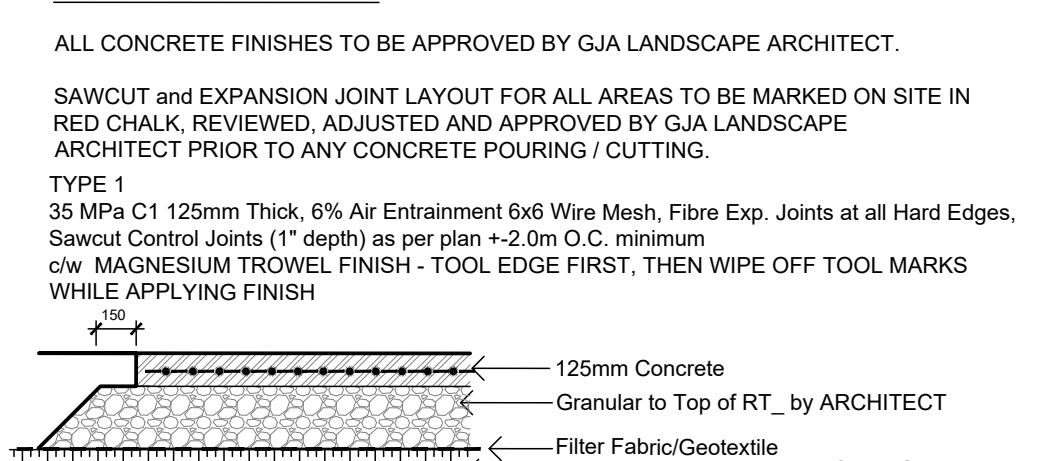
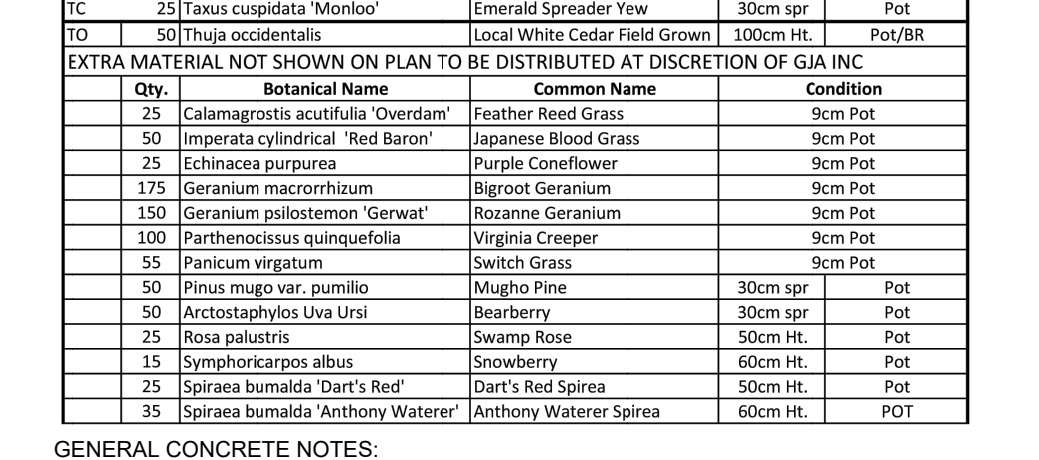
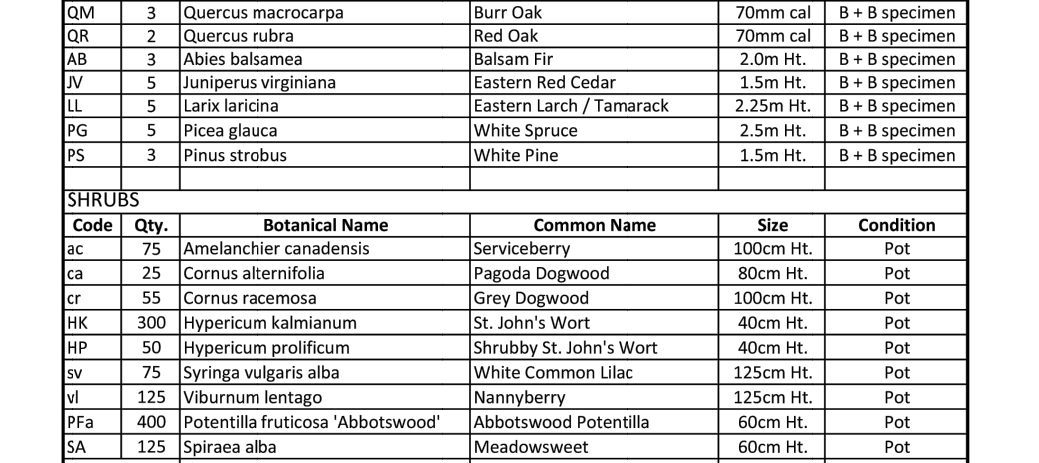
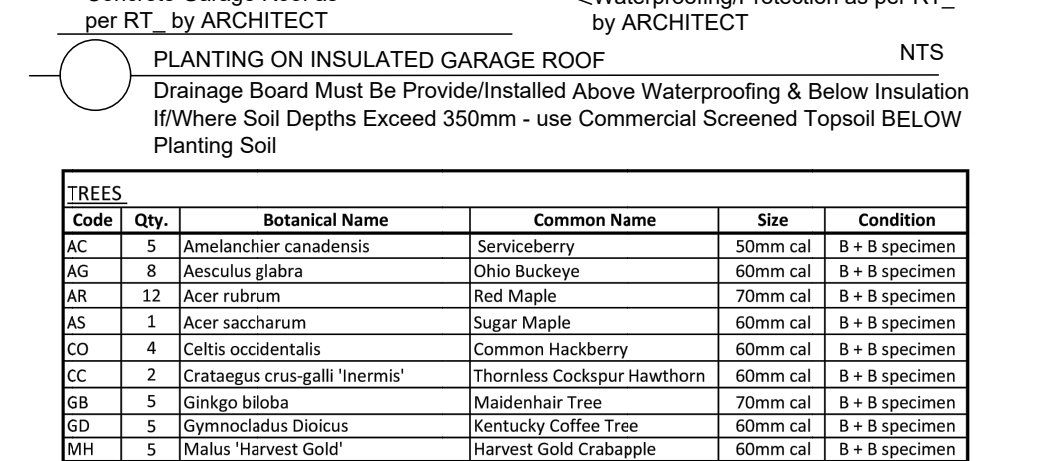
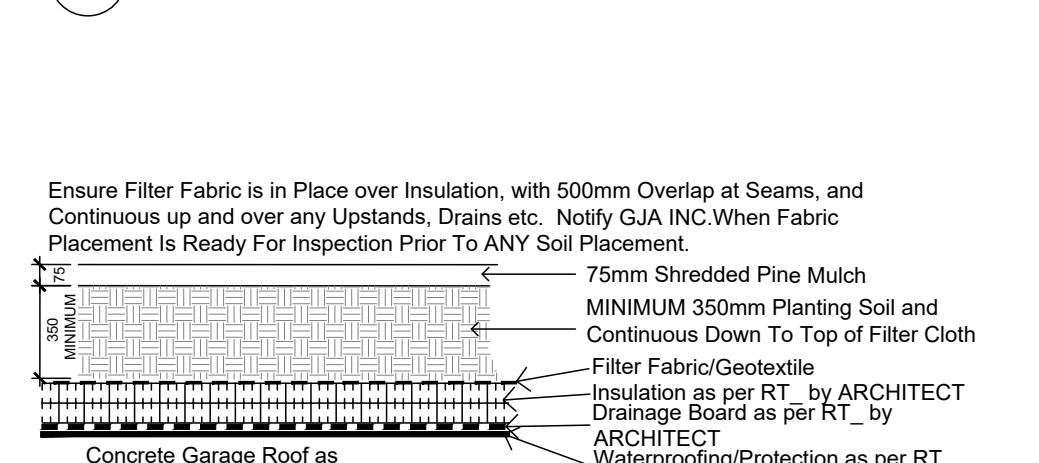
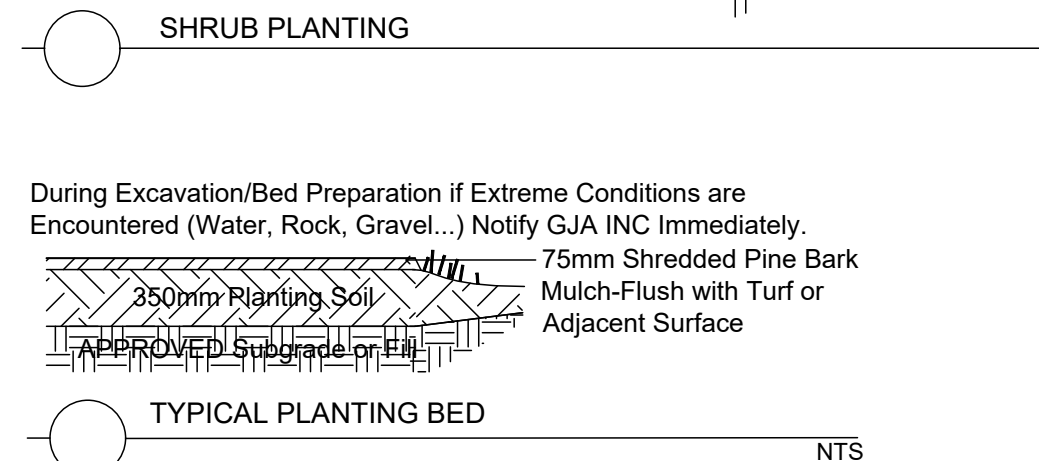
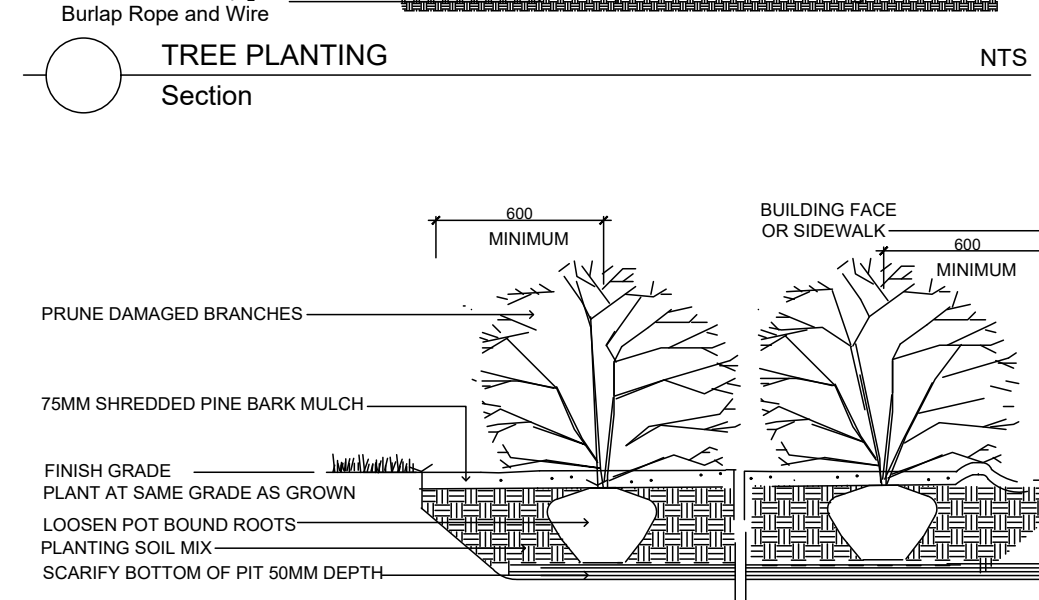
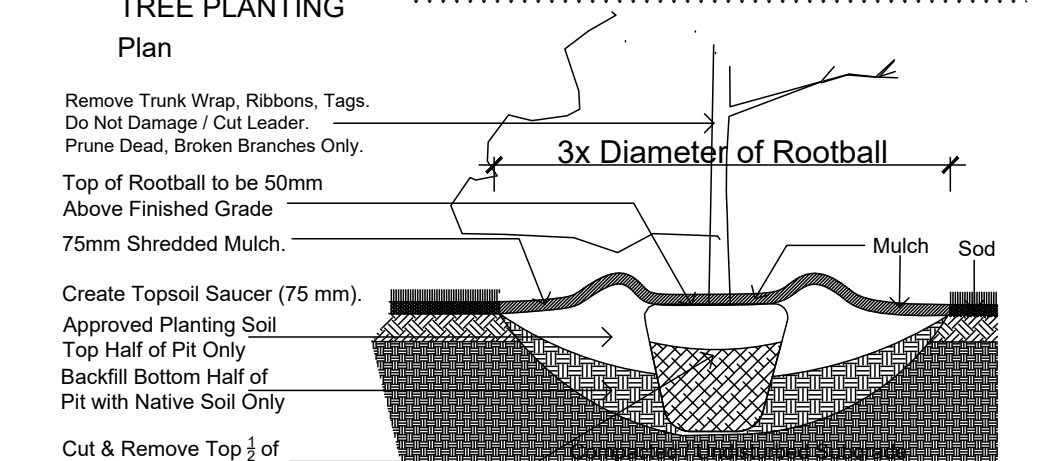
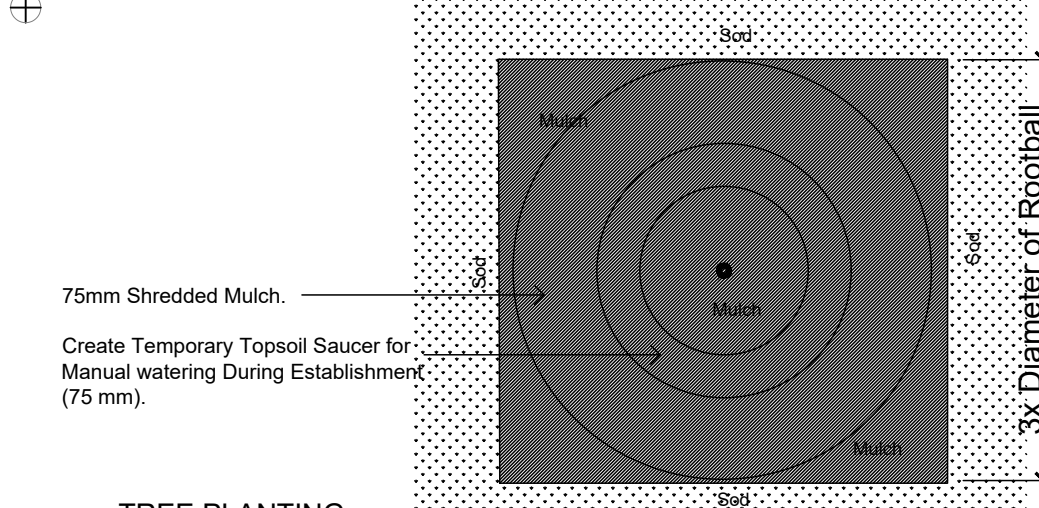

PROPOSED 9 STOREY MULTI UNIT RESIDENTIAL BUILDING

TREES	Code	Qty.	Botanical Name	Common Name	Size	Condition
AC	5	Acer saccharum	Sugar Maple	60mm cal	B = B specimen	
AG	8	Amelanchier canadensis	Serviceberry	50mm cal	B = B specimen	
AS	12	Acer rubrum	Red Maple	70mm cal	B = B specimen	
AS	1	Acer saccharum	Sugar Maple	60mm cal	B = B specimen	
CD	4	Celtis occidentalis	Common Hackberry	60mm cal	B = B specimen	
CC	2	Crataegus crus-galli 'Inermis'	Thornless Cockspur Hawthorn	60mm cal	B = B specimen	
GB	5	Ginkgo biloba	Maidenhair Tree	70mm cal	B = B specimen	
GD	5	Gymnocladus dioica	Kentucky Coffee Tree	60mm cal	B = B specimen	
GH	1	Malus 'Harvest Gold'	Harvest Gold crabapple	60mm cal	B = B specimen	
GM	3	Quercus macrocarpa	Burr Oak	70mm cal	B = B specimen	
QR	2	Quercus rubra	Red Oak	70mm cal	B = B specimen	
AB	1	Abies balsamea	Balsam Fir	2.0m Ht.	B = B specimen	
AR	5	Juniperus virginiana	Eastern Red Cedar	1.5m Ht.	B = B specimen	
LL	5	Larix laricina	Eastern Larch / Tamarack	2.25m Ht.	B = B specimen	
PS	3	Pinus strobus	White Pine	1.5m Ht.	B = B specimen	

SHRUBS	Code	Qty.	Botanical Name	Common Name	Size	Condition
AS	75	Amelanchier canadensis	Serviceberry	50mm cal	Pot	
AG	25	Cornus alternifolia	Pagoda Dogwood	80cm Ht.	Pot	
GR	55	Cornus racemosa	Grey Dogwood	100cm Ht.	Pot	
HK	300	Hypericum kalmianum	St. John's Wort	40cm Ht.	Pot	
HP	50	Hypericum prostratum	St. John's Wort	40cm Ht.	Pot	
SV	75	Syringa vulgaris alba	White Common Lilac	125cm Ht.	Pot	
MB	125	Viburnum lentago	Nannyberry	125cm Ht.	Pot	
PT	400	Potentilla fruticosa 'Abbotswood'	Abbotswood Potentilla	60cm Ht.	Pot	
SA	125	Spiraea alba	Meadowsweet	60cm Ht.	Pot	
TC	25	Taxus cuspidata 'Monkio'	Emerald Spreader Yew	30cm sp.	Pot	
TD	50	Thuja occidentalis	Local White Cedar Red Green	100cm	Pot/Box	

EXTRA MATERIAL NOT SHOWN ON PLAN TO BE DISTRIBUTED AT DISCRETION OF GJA INC	Qty.	Botanical Name	Common Name	Condition
25	Callimagrostis acutiflora 'Overdam'	Feather Reed Grass	9cm Pot	
50	Imperata cylindrica 'Red Baron'	Japanese Blood Grass	9cm Pot	
25	Echinacea purpurea	Purple Coneflower	9cm Pot	
175	Geranium macrorrhizum	Bigroot Geranium	9cm Pot	
150	Geranium polsterianum 'Genat'	Bozanne Geranium	9cm Pot	
100	Parthenocissus quinquefolia	Virginia Creeper	9cm Pot	
55	Panicum virgatum	Switch Grass	9cm Pot	
50	Pinus mugo var. pumilio	Mugo Pine	30cm sp.	
50	Arctostaphylos Uva Ursi	Bearberry	30cm sp.	
25	Rosa palustris	Swamp Rose	50cm Ht.	
15	Symphoricarpos albus	Snowberry	60cm Ht.	
25	Spiraea bumalda 'Dart's Red'	Dart's Red Spirea	50cm Ht.	
35	Spiraea bumalda 'Anthony Waterer'	Anthony Waterer Spirea	60cm Ht.	

GENERAL CONCRETE NOTES:
ALL CONCRETE FINISHES TO BE APPROVED BY GJA LANDSCAPE ARCHITECT.
SAWCUT AND EXPANSION JOINT LAYOUT FOR ALL AREAS TO BE MARKED ON SITE IN RED CHALK, REVIEWED, ADJUSTED AND APPROVED BY GJA LANDSCAPE ARCHITECT PRIOR TO ANY CONCRETE POURING / CUTTING.
TYPE 1
35 MPa C1 125mm Thick, 6% Air Entrainment 6x6 Wire Mesh, Fibre Exp. Joints at all Hard Edges, Sawcut Control Joints (1" depth) as per plan +2.0m O.C. minimum
c/w MAGNESIUM TROWEL FINISH - TOOL EDGE FIRST, THEN WIPE OFF TOOL MARKS WHILE APPLYING FINISH

CONCRETE PAVING ON GARAGE ROOF
Provide Shop Drawing for Proposed Expansion and Control Joint Layout for Approval

DECORATIVE STEEL FENCE
IRON EAGLE 2115 OR APPROVED EQUAL - HT VARIES SEE PLAN. PROVIDE SHOP DRAWINGS FOR APPROVAL

PRECAST CONCRETE SLABS / PATHS
Permacon Melville 60mm / Approved Equal. Colour To Be Verified Prior to Ordering By Sample To Site, RANGE SCANDINA GREY

CONCRETE - FINISH LIGHT BROOM, WOOD FLOAT MAGNESIUM FLOAT:
ALL CONCRETE FINISHES TO BE APPROVED BY GJA LANDSCAPE ARCHITECT.
SAWCUT LAYOUT FOR ALL AREAS TO BE MARKED ON SITE IN RED CHALK, REVIEWED, ADJUSTED AND APPROVED BY GJA LANDSCAPE ARCHITECT PRIOR TO ANY CUTTING.
EXPANSION JOINT LAYOUT FOR ALL AREAS TO BE LAID OUT ON SITE, REVIEWED, ADJUSTED AND APPROVED BY GJA LANDSCAPE ARCHITECT PRIOR TO ANY CONCRETE POURING.
PROVIDE COLD JOINT DETAIL at End of Previous Pour/Beginning of New Pour. C/W REBAR DOWELS 500mm O.C.
FINISH: TOOL EDGE FIRST, THEN WIPE OFF TOOL MARKS WHILE APPLYING FINISH.

CONCRETE PAVING
32mpa, 6% Air Entrainment 6x6 Wire Mesh, Fibre Exp. Joints at all Hard Edges, Sawcut Control Joints (1" depth) +2.0m O.C. as

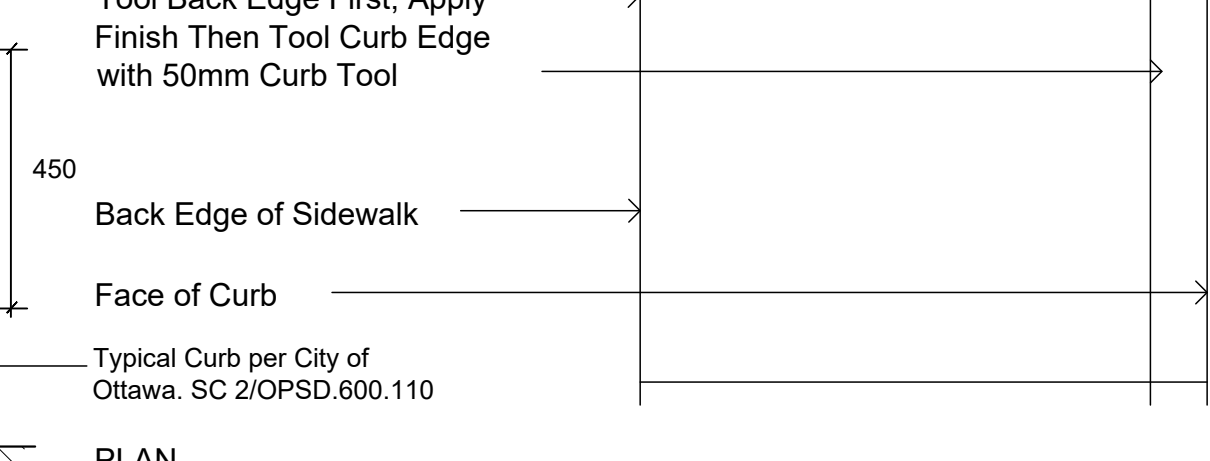
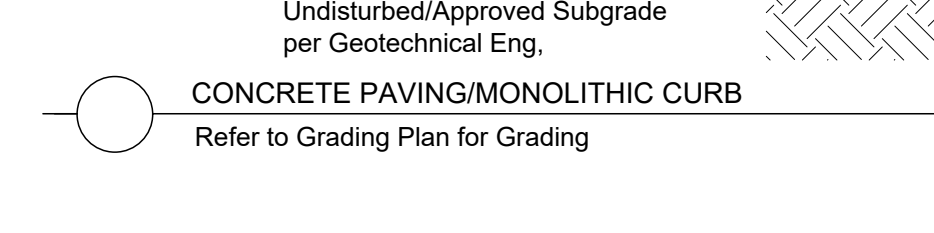
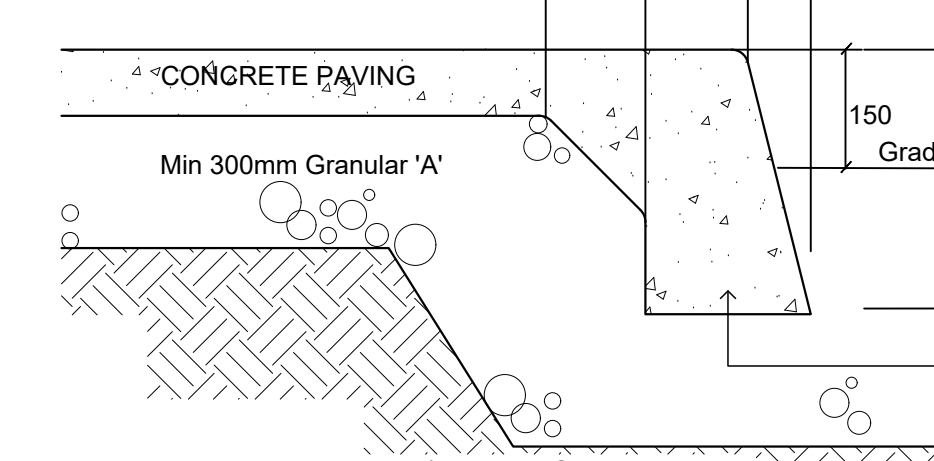

PLAN
NO Dummy Joints/Visible Tooled Edges Except for Curb Edge

- Existing Tree to Remain
- Existing Tree to be Removed
- Protection for Existing Trees

- ### LANDSCAPE PLAN LEGEND
- Proposed Coniferous Tree
 - Proposed Deciduous Tree
 - Proposed Planting Bed
 - Proposed Concrete
 - Proposed Pedestrian Pavement
 - Garage Below Grade
 - Decorative Steel Fence
 - FD Siamese Connection
 - Fire Hydrant
 - BELOW GRADE SERVICES REFER TO CIVIL /CUP
 - U/G Water Service
 - U/G Storm Service
 - U/G Sanitary Service
 - U/G Gas Service

3	THIRD SUBMISSION SPC	2023 08 21
2	SECOND SUBMISSION SPC	APRIL 11 2023
1	FIRST SUBMISSION SPC	DECEMBER 23 2021
0	REVIEW / COORDINATION	OCTOBER 2021
No.	Revision	Date

Property Owner: **Katasa Groupe + Development**
301-69, rue Jean-Proulx, Gatineau Quebec, J8Z 1W2

Gino J. Aiello | landscape architect
GJA Inc. GJA.LA.COM (613) 286 5130
110 Dobbey Road #1 (Ottawa Ontario) K2T 0C2

Project: **RESIDENTIAL DEVELOPMENT**
1509 MERIVALE ROAD NEPEAN

Drawing: **Landscape Plan**

Scale: 1:250
City of Ottawa
Dwg - 18657

Sheet Number: **L1**
D07-12-21-0233