

Drawing Remains the Property of/Copyright Reserved by Gino J. Aiello Landscape Architect. Do Not Use or Reproduce Without Approval of Gino J. Aiello. **NOT To Be Used For Construction Unless** indicated by Revision: **"FOR LANDSCAPE CONSTRUCTION"**. Contractor is Responsible for Verification of Site Locations of all Utilities. Report any Discrepancies Between Site and Drawing Immediately to Gino J. Aiello. Do NOT Proceed Until Clarified.

TURF AREAS TO BE SOD C/W 150MM DEPTH TOPSOIL ON APPROVED SUBGRADE | SOD TO BE #1 GRADE TURFGRASS NURSERY SOD per NSGA - Fine Fescue/Kentucky Bluegrass Sod | PLANTING MIX TO BE APPROVED BY LANDSCAPE ARCHITECT | PLANT MATERIAL TO MEET CNLA STANDARDS/BE APPROVED BY LANDSCAPE ARCHITECT PRIOR TO PLANTING | ALL MATERIALS & WORK TO BE MAINTAINED UNTIL FINAL ACCEPTANCE. (MOWING TURF, WEEDING BEDS, WATERING TURF & PLANTS) & INCLUDE 1 YEAR WARRANTY FROM DATE OF FINAL ACCEPTANCE | PROVIDE WATERING OF ALL PLANT MATERIAL AS REQUIRED FOR PROPER ESTABLISHMENT, UNTIL END OF WARRANTY PERIOD | REFER TO CIVIL ENGINEER'S DRAWING FOR ELEVATIONS / GRADING |

The Landscape Plan is to be read in conjunction with the grading, servicing, site and survey plan | Bare root material to be planted in season only | All plant material locations to be staked on site by the landscape contractor and checked by the landscape architect prior to planting | All trees to be preserved on or directly adjacent to the site will be protected | Plant material are to be installed a minimum of, 3.0m away from any part of any hydro transformer, 3.0m corridor between a fire hydrant and the curb, a 2.5m radius beside or behind a fire hydrant, 2.0m from any servicing/utility line or structure |

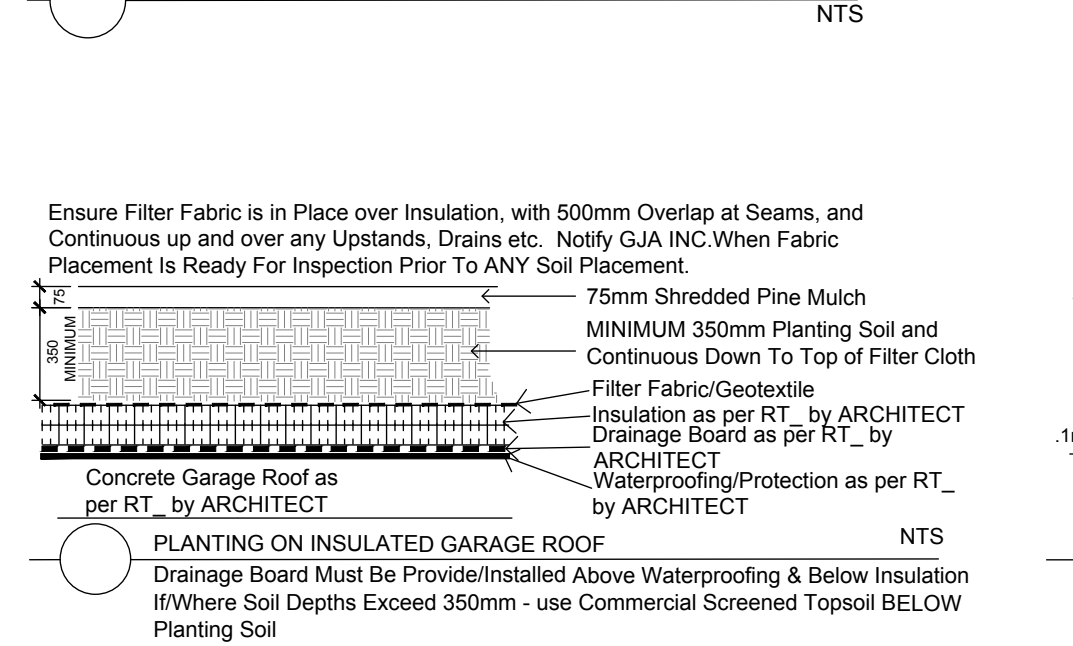
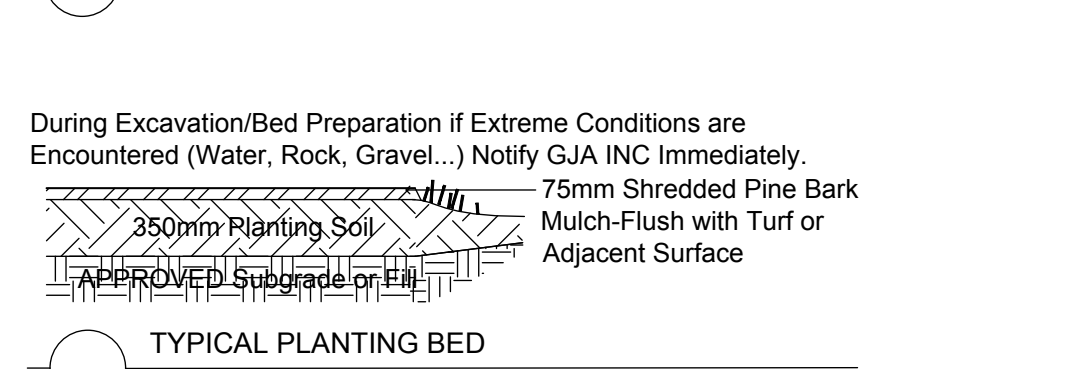
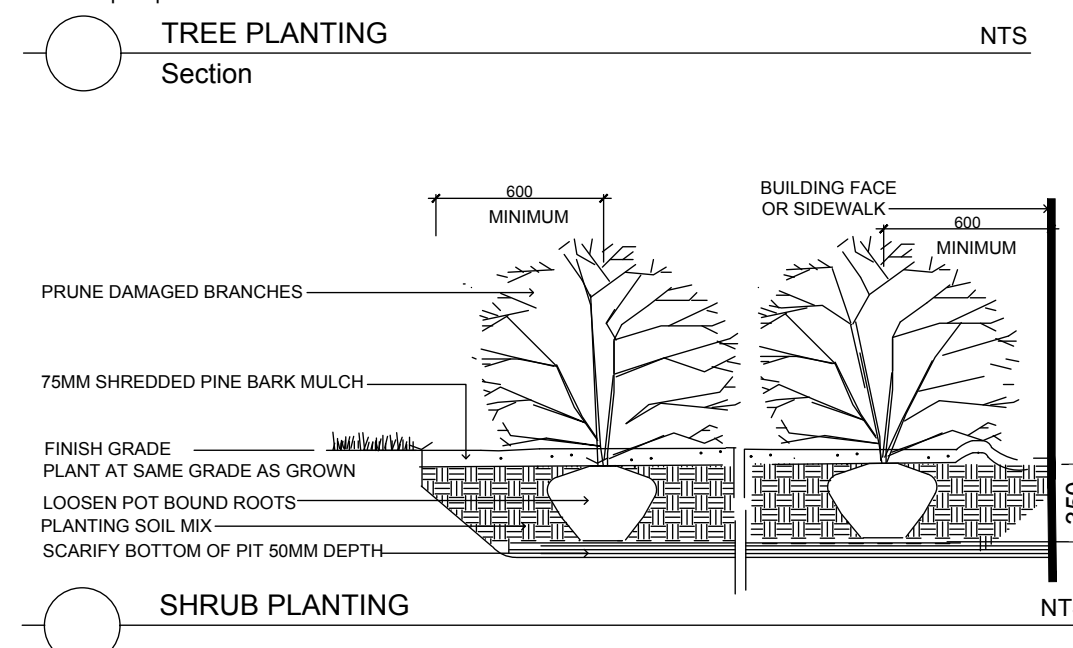
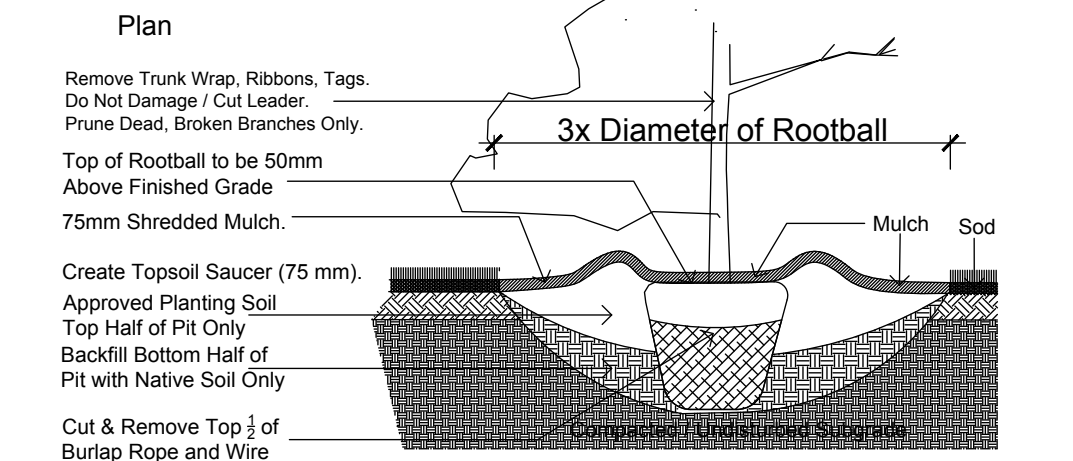
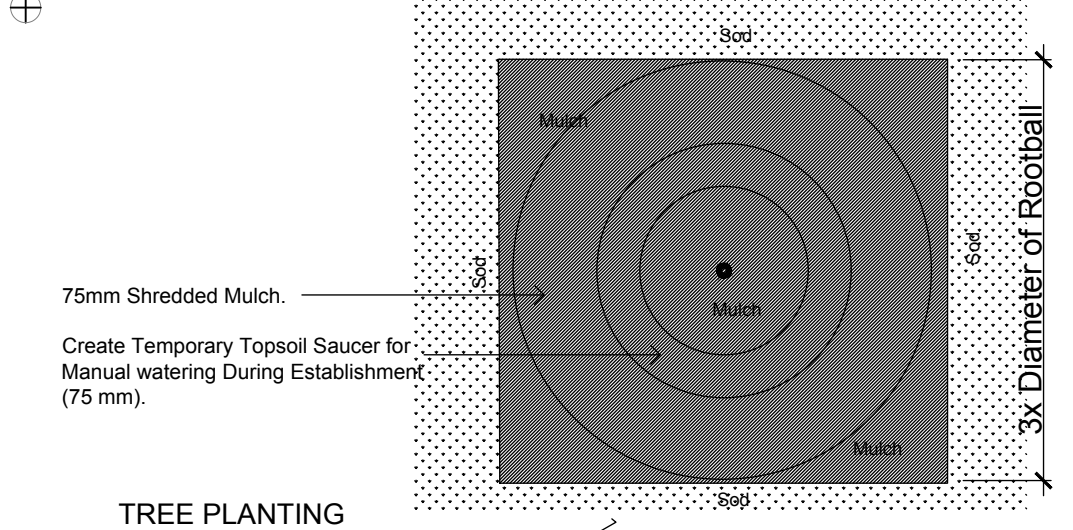

TREES	Code	Qty.	Botanical Name	Common Name	Size	Condition
AC	7	Amelanchier canadensis	Serviceberry	50mm cal	B + B specimen	
AG	4	Aesculus glabra	Ohio Buckeye	60mm cal	B + B specimen	
AR	7	Acer rubrum	Red Maple	70mm cal	B + B specimen	
AS	1	Acer saccharum	Sugar Maple	60mm cal	B + B specimen	
CO	1	Celtis occidentalis	Common Hackberry	60mm cal	B + B specimen	
CC	3	Crataegus crus-galli 'Inermis'	Thornless Cockspur Hawthorn	60mm cal	B + B specimen	
GB	5	Ginkgo biloba	Maidenhair Tree	70mm cal	B + B specimen	
MH	6	Malus 'Harvest Gold'	Harvest Gold Crabapple	60mm cal	B + B specimen	
ST	5	FUTURE STREET TREES		70mm cal	B + B specimen	
PG	12	Picea glauca	White Spruce	2.5m Ht.	B + B specimen	

SHRUBS	Code	Qty.	Botanical Name	Common Name	Size	Condition
ca	25	Cornus alternifolia	Pagoda Dogwood	80cm Ht.	Pot	
cr	55	Cornus racemosa	Grey Dogwood	100cm Ht.	Pot	
HK	300	Hypericum kalmianum	St. John's Wort	40cm Ht.	Pot	
HP	50	Hypericum profluum	Shrubby St. John's Wort	40cm Ht.	Pot	
sv	75	Syringa vulgaris alba	White Common Lilac	125cm Ht.	Pot	
vi	125	Viburnum lentago	Nannyberry	125cm Ht.	Pot	
PfA	400	Potentilla fruticosa 'Abbotswood'	Abbotswood Potentilla	60cm Ht.	Pot	
SA	125	Spiraea alba	Meadowweet	60cm Ht.	Pot	
TC	25	Taxus canadensis 'Monloie'	Emerald Spruener Yew	30cm spr	Pot	
TD	50	Thuja occidentalis	Local White Cedar Field Grow	100cm Ht.	Pot/BR	

EXTRA MATERIAL NOT SHOWN ON PLAN TO BE DISTRIBUTED AT DISCRETION OF GJA INC	Qty.	Botanical Name	Common Name	Condition
25	Calamagrostis acutiflora 'Overdam'	Feather Reed Grass	9cm Pot	
50	Imperata cylindrica 'Red Baron'	Japanese Blood Grass	9cm Pot	
25	Echinacea purpurea	Purple Coneflower	9cm Pot	
175	Geranium macrorrhizum	Bigroot Geranium	9cm Pot	
150	Geranium psilostemon 'Gerwat'	Rozanne Geranium	9cm Pot	
100	Parthenocissus quinquefolia	Virginia Creeper	9cm Pot	
55	Panicum virgatum	Switch Grass	9cm Pot	
50	Pinus mugo var. pumilio	Mugho Pine	30cm spr	
50	Arctostaphylos Uva Ursi	Bearberry	30cm spr	
25	Rosa palustris	Swamp Rose	50cm Ht.	
15	Symphoricarpos albus	Snowberry	60cm Ht.	
25	Spiraea bumalda 'Dart's Red'	Dart's Red Spirea	50cm Ht.	
35	Spiraea bumalda 'Anthony Waterer'	Anthony Waterer Spirea	60cm Ht.	

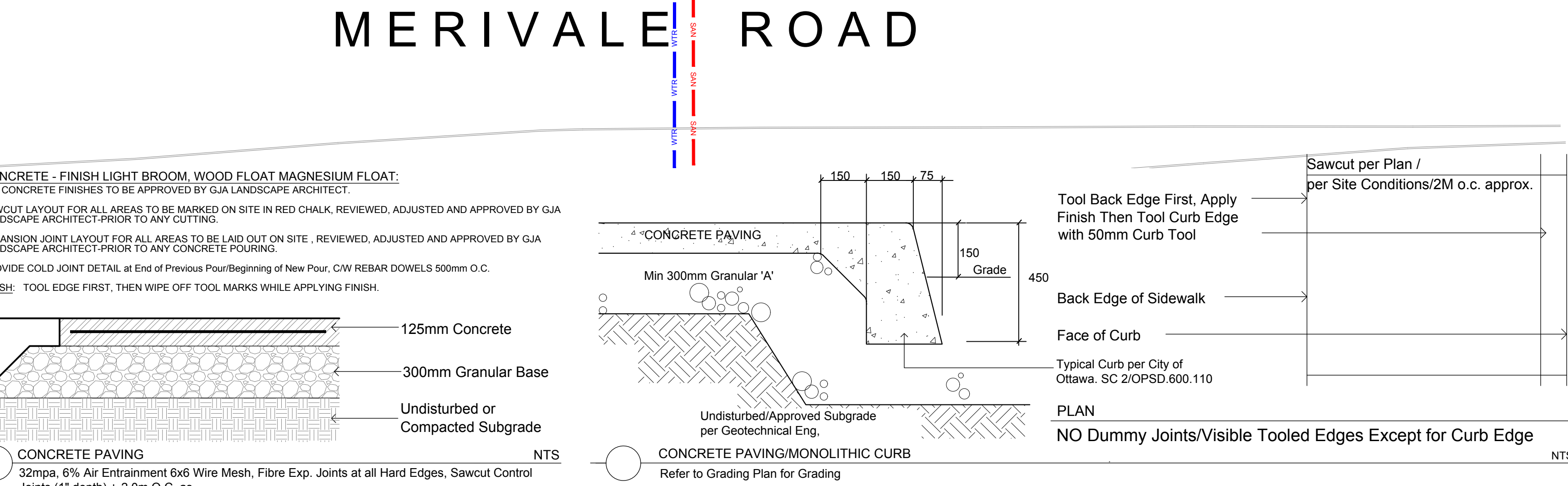
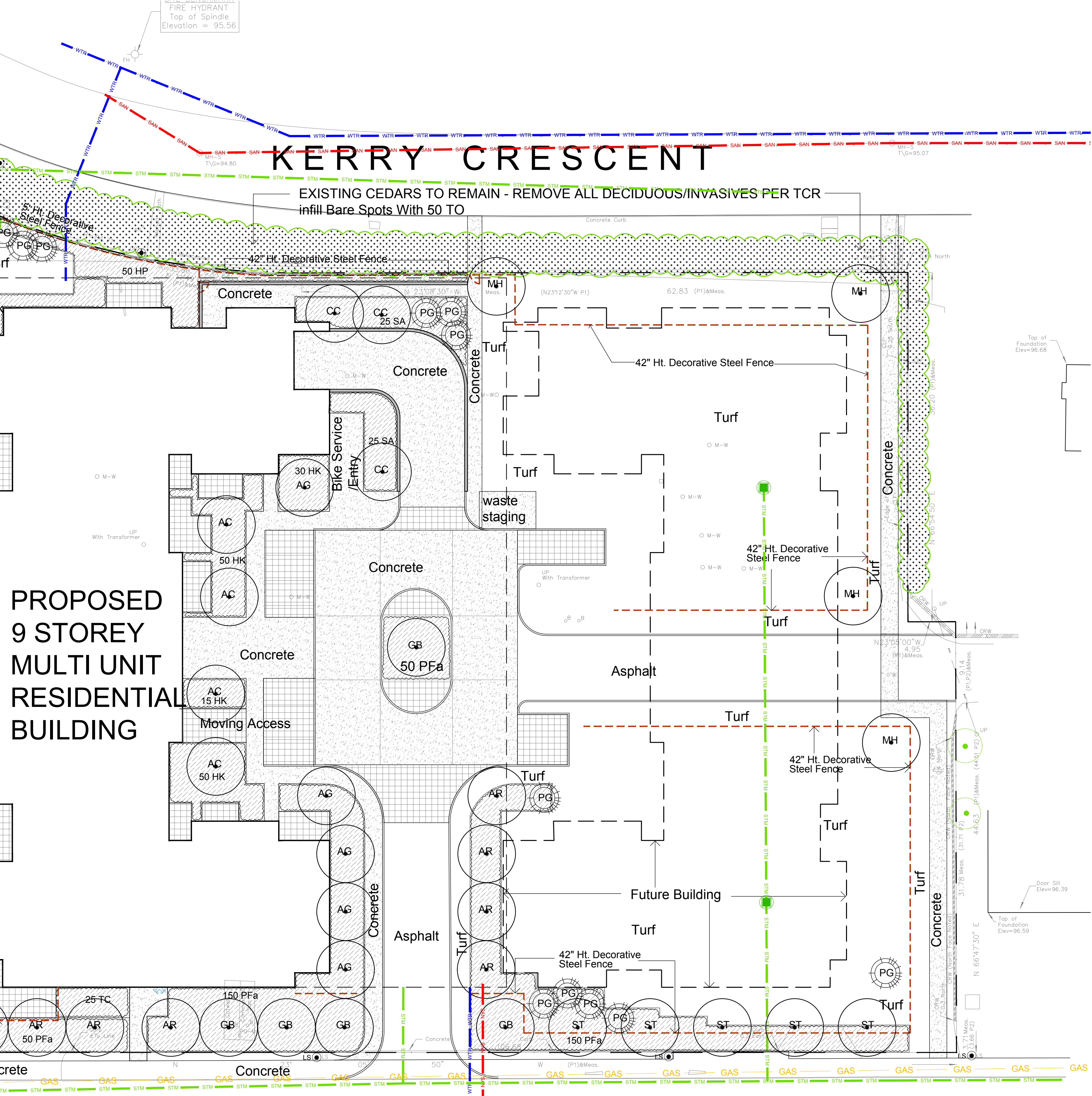
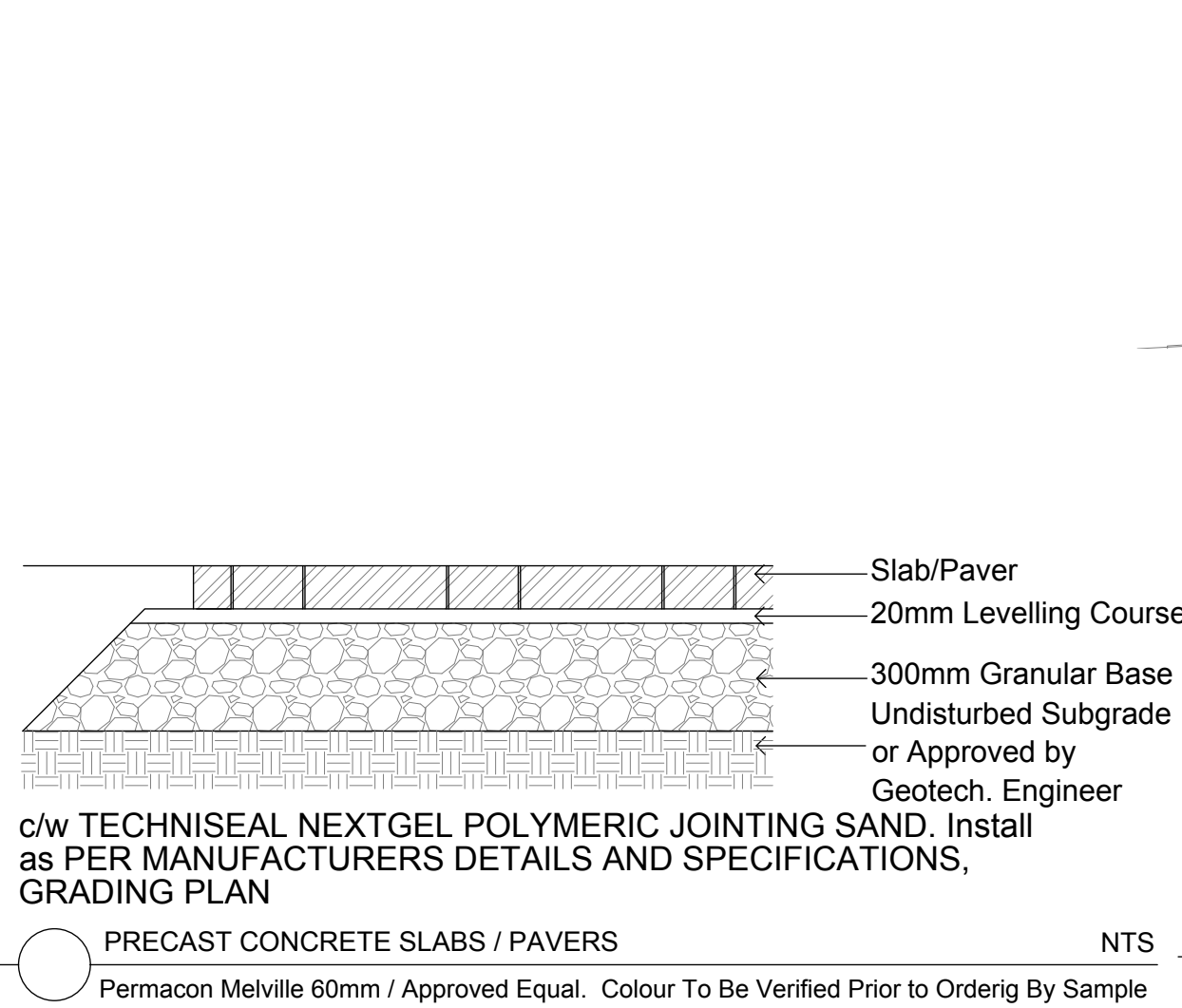
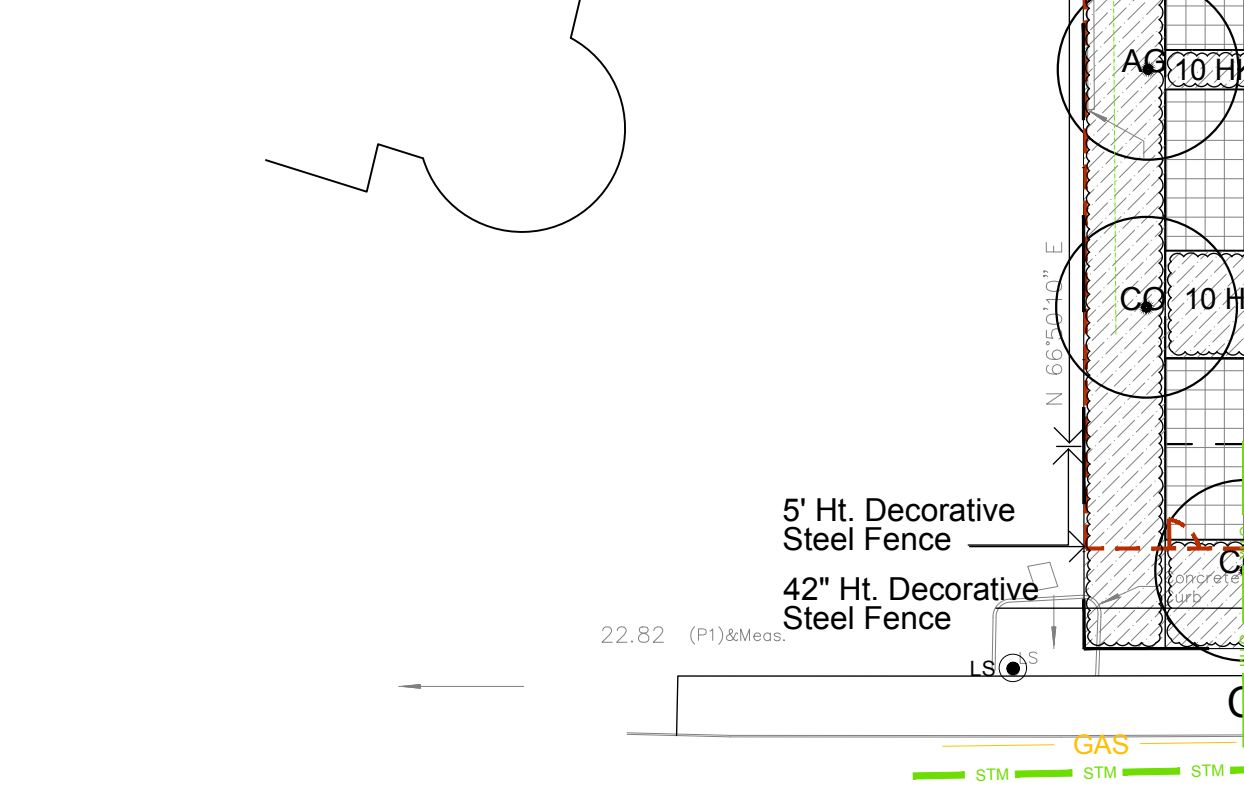
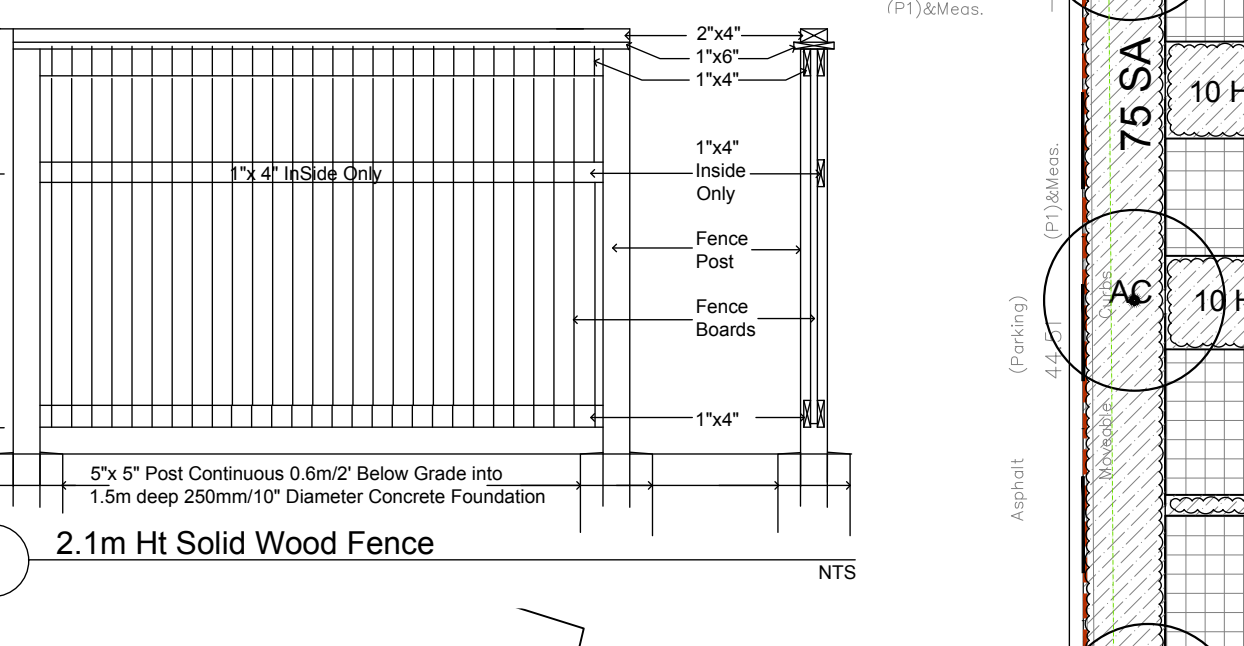
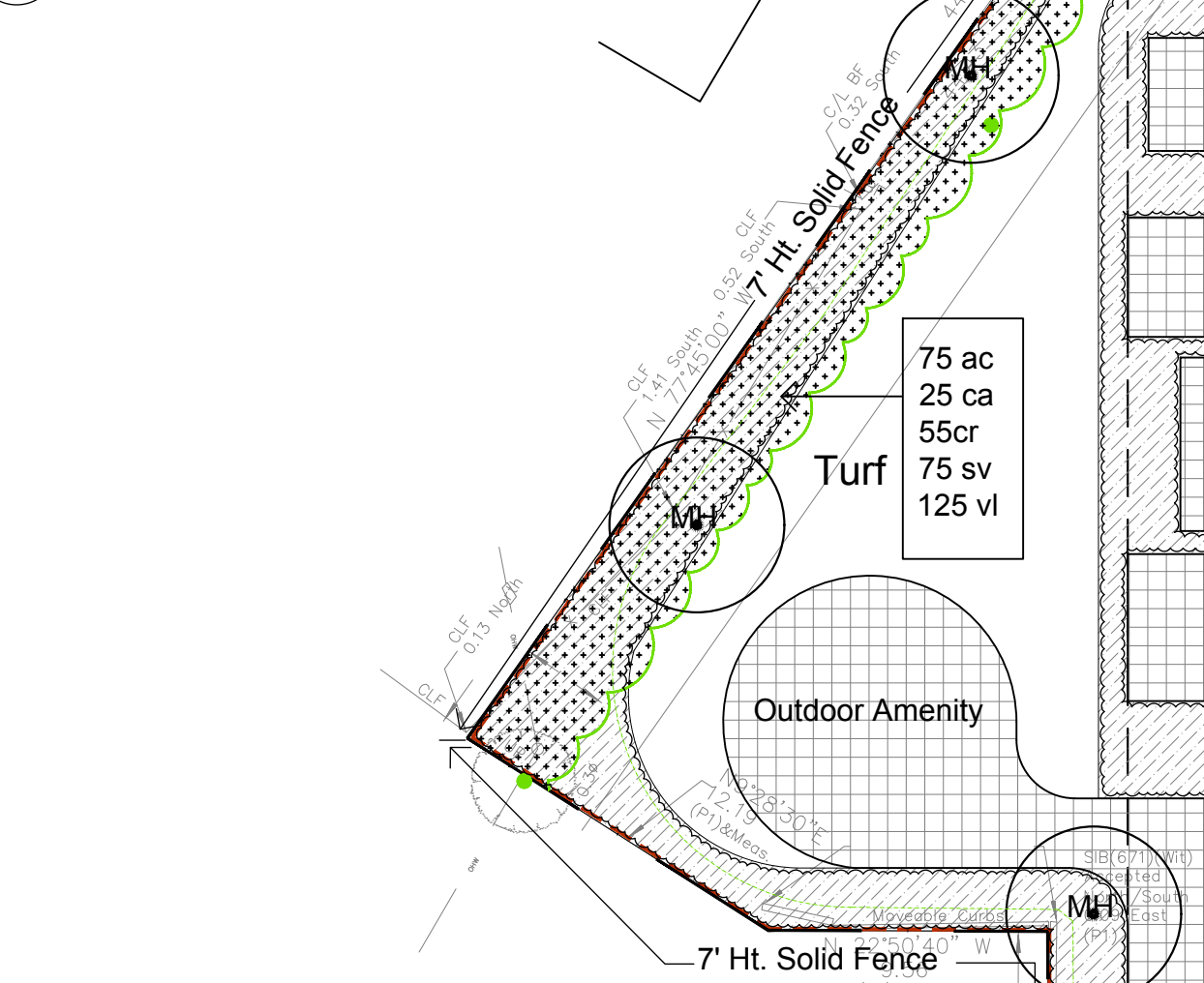
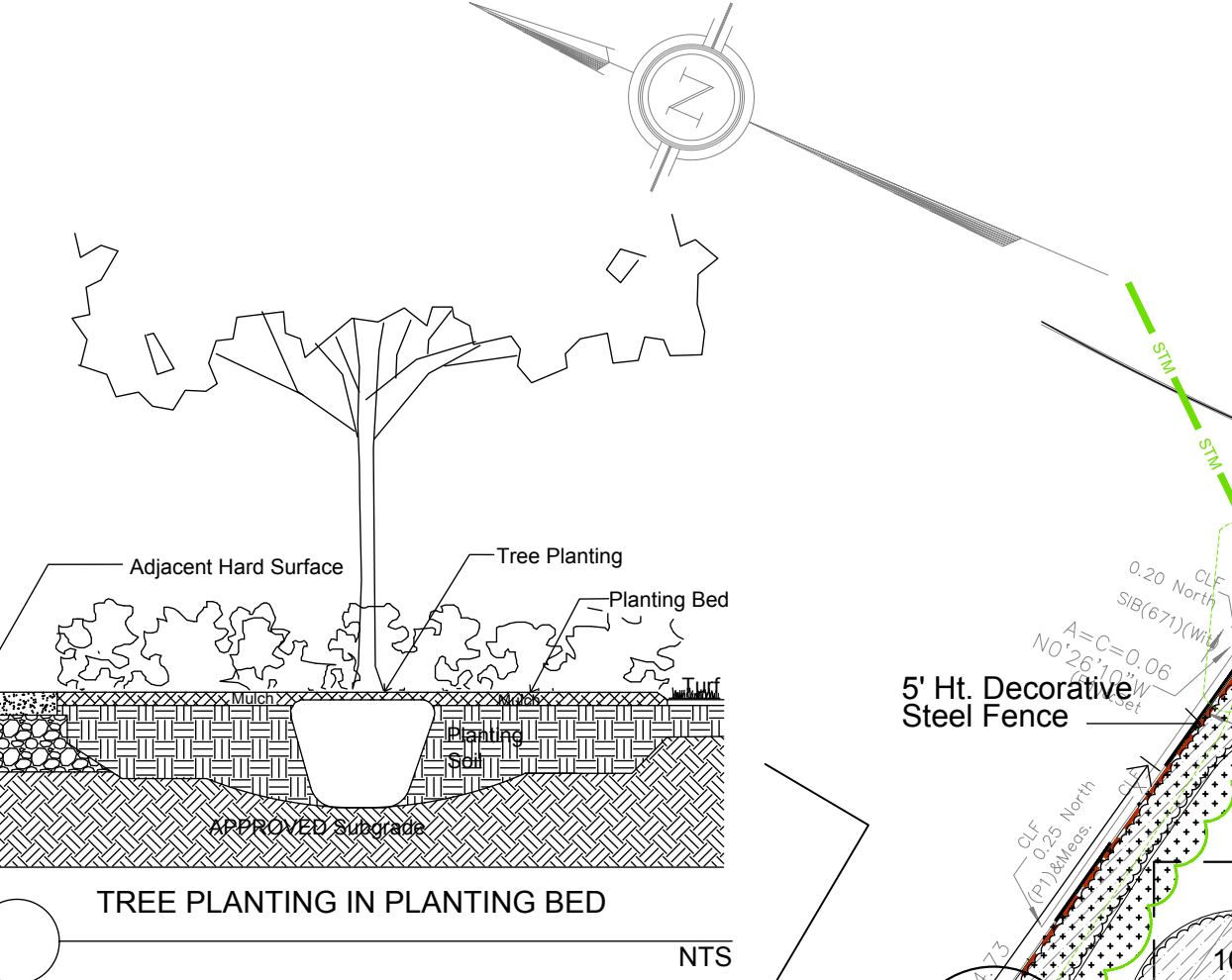
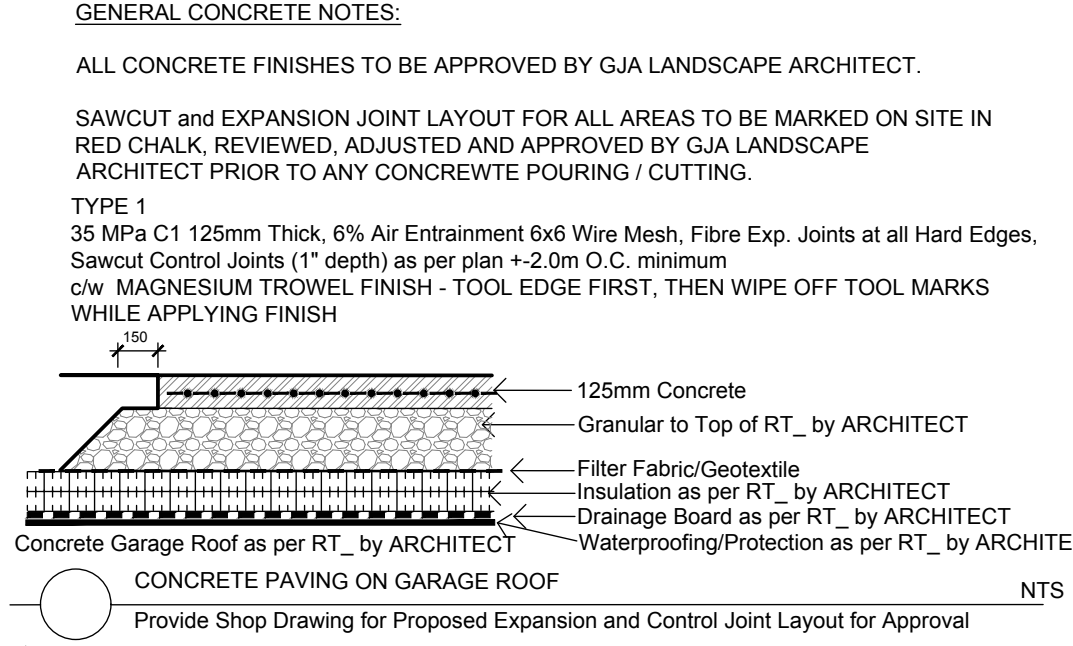

- REFER TO TCR BY IFS
- Existing Tree - Refer To TCR by IFS for Details/Actions
- LANDSCAPE PLAN LEGEND
- Proposed Coniferous Tree
  - Proposed Deciduous Tree
  - Proposed Planting Bed
  - Proposed Concrete
  - Proposed Pedestrian Pavement
- BELOW GRADE SERVICES REFER TO CIVIL /CUP
- U/G Water Service
  - U/G Storm Service
  - U/G Sanitary Service
  - U/G Gas Service
  - U/G TelCo Service

No.	Revision	Date
1	FIRST SUBMISSION SPC	DECEMBER 23 2021
0	REVIEW / COORDINATION	OCTOBER 2021

No.	Revision	Date
1	FIRST SUBMISSION SPC	DECEMBER 23 2021
0	REVIEW / COORDINATION	OCTOBER 2021

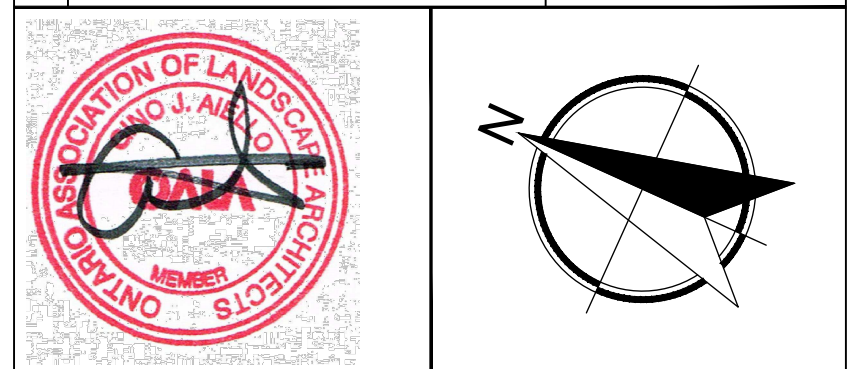

Property Owner: **Katasa Groupe + Development**  
301-69, rue Jean-Proulx, Gatineau Quebec, J8Z 1W2

Gino J. Aiello | landscape architect  
GJA Inc.

Project: **RESIDENTIAL DEVELOPMENT**  
1509 MERIVALE ROAD NEPEAN

Drawing: **Landscape Plan**

Scale: 1:250  
City of Ottawa  
Dwg - #####

Sheet Number: **L1**