

### PROPOSED PLANT LIST

KEY	QTY	BOTANICAL NAME	COMMON NAME	SIZE	CONDITION	REMARKS
<b>TREES</b>						
AM	2	<i>Acer x freemanii</i> 'Armstrong'	Armstrong Maple	50mm cal.	B&B	
HL	1	<i>Gleditsia triacanthos</i>	Honey Locust	50mm cal.	B&B	
SM	1	<i>Acer saccharum</i>	Sugar Maple	50mm cal.	B&B	
<b>SHRUBS</b>						
AH	13	<i>Hydrangea arborescens</i> 'Annabelle'	Annabelle Hydrangea	1 Gal. pot	Potted	
BB	8	<i>Euonymus alatus</i>	Burning Bush	600mm ht.	Potted	
CC	14	<i>Juniperus sabina</i> 'Calgary Carpet'	Calgary Carpet Juniper	600mm spr.	Potted	
JT	6	<i>Juniperus sabina</i> 'Tarnarskifolia'	Tarnarix Juniper	600mm spr.	Potted	
PO	7	<i>Potentilla fruticosa</i> 'Goldfinger'	Goldfinger Potentilla	600mm ht.	Potted	
PP	9	<i>Spiraea japonica</i> 'Little Princess'	Little Princess Spiraea	600mm ht.	Potted	
RR	6	<i>Rosa rugosa</i>	Rugosa Rose	800mm ht.	Potted	

### EXISTING TREE TO REMAIN LIST

KEY	QTY	BOTANICAL NAME	COMMON NAME	SIZE	CONDITION	REMARKS
AN	1	<i>Acer negundo</i>	Manitoba Maple	500mm DBH	GOOD	TO REMAIN
PA	2	<i>Picea abies</i>	Norway Spruce	200-400mm DBH	GOOD	TO REMAIN
TO	*	<i>Thuja occidentalis</i>	Cedar Hedge (White)	100-240mm DBH	GOOD	TO REMAIN

\* DENOTES NUMEROUS FOR INFORMATION REGARDING THE RETENTION AND PROTECTION OF EXISTING TREES PLEASE REFER TO "TREE CONSERVATION REPORT" PREPARED BY ASTRID NIELSEN OF DENRDON FORESTRY SERVICES FEBRUARY 15TH, 2023

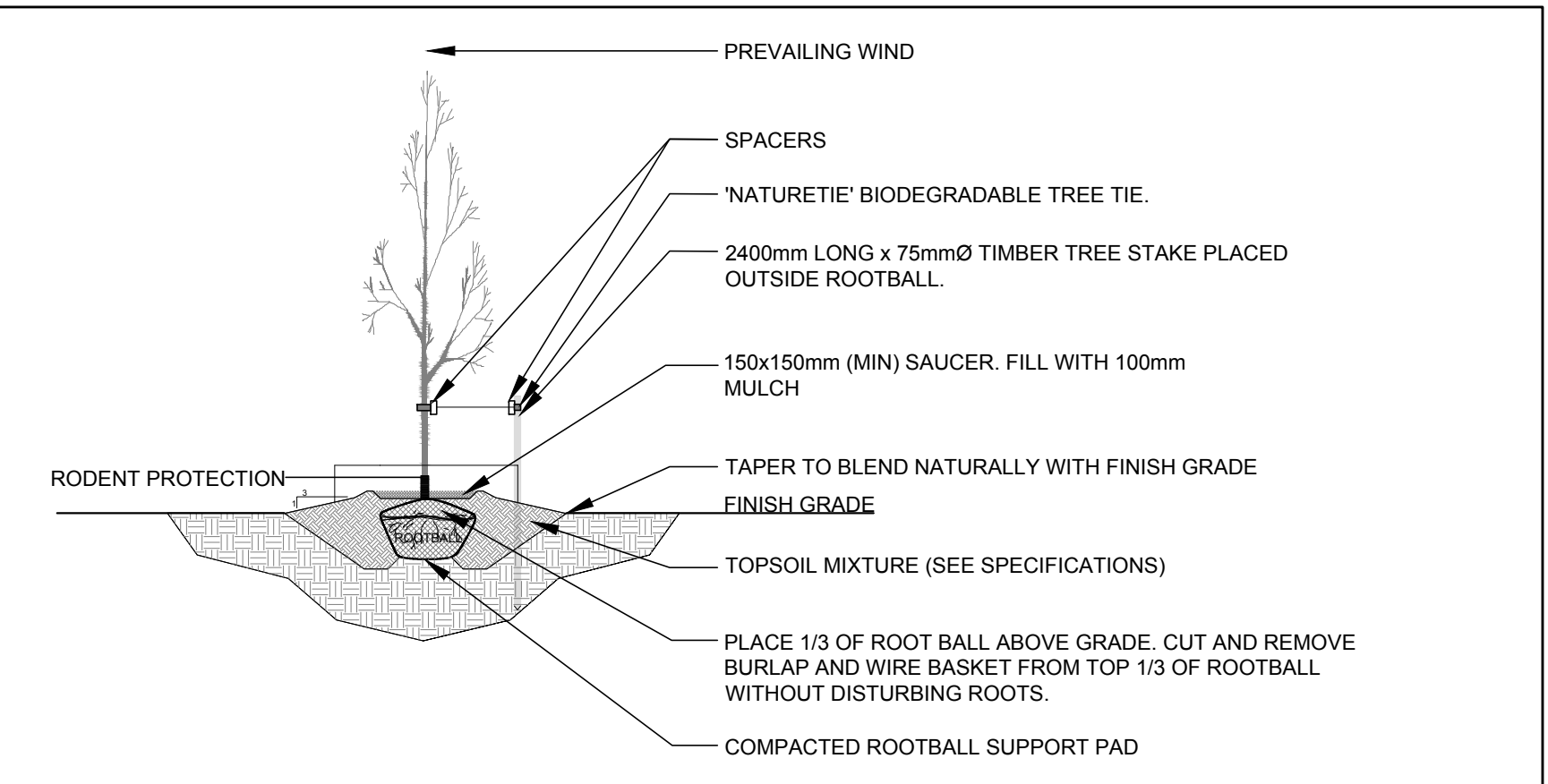

2 DECIDUOUS TREE PLANTING  
SCALE: NTS

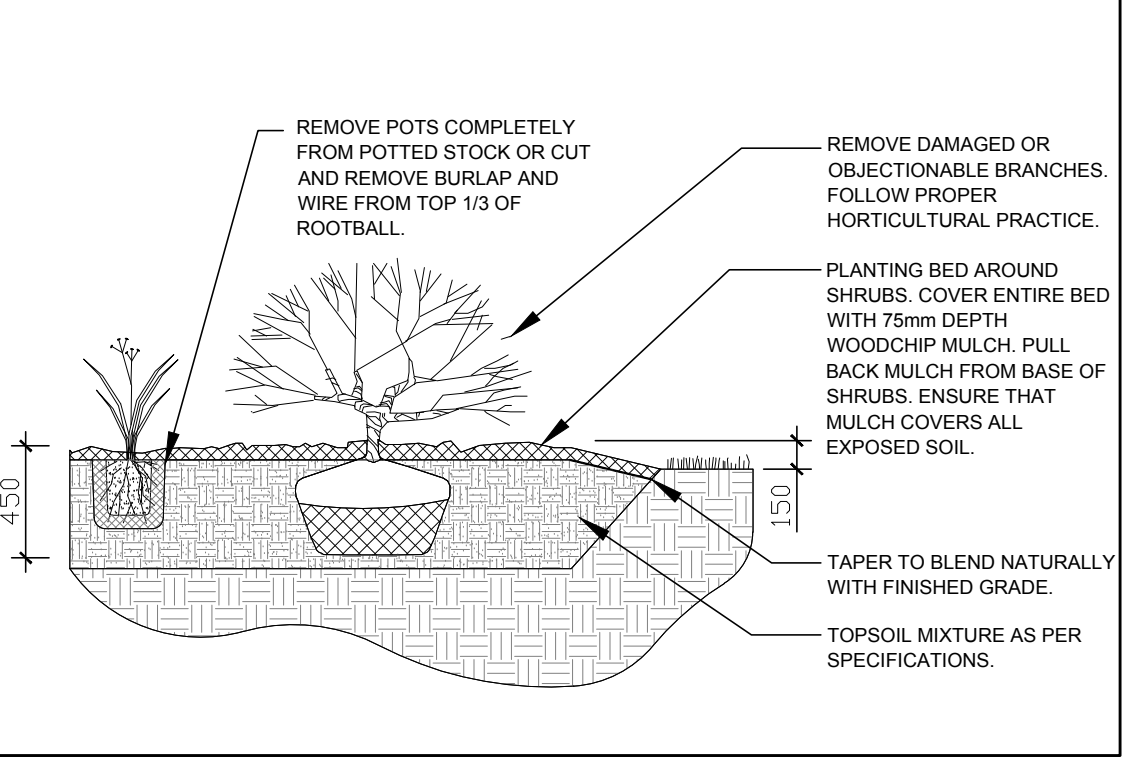

3 SHRUB PLANTING  
SCALE: NTS

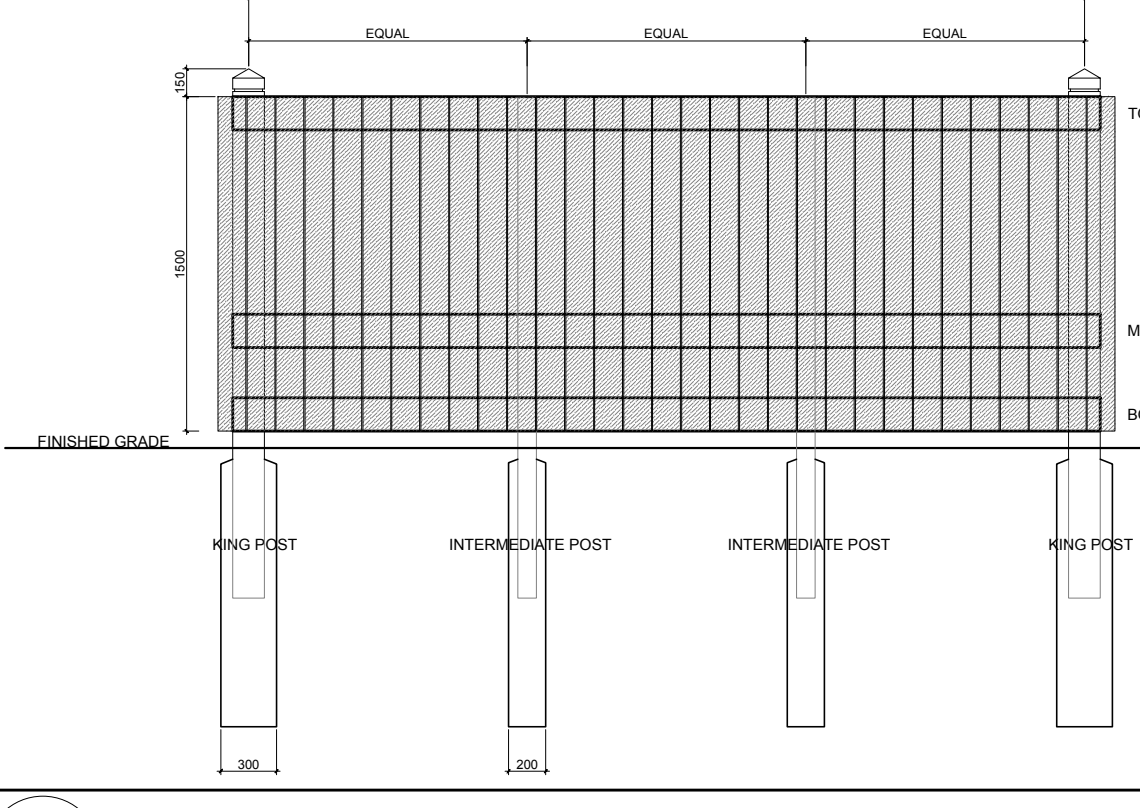

4 1.5m Ht. WOOD BOARD PRIVACY FENCE  
SCALE: NTS

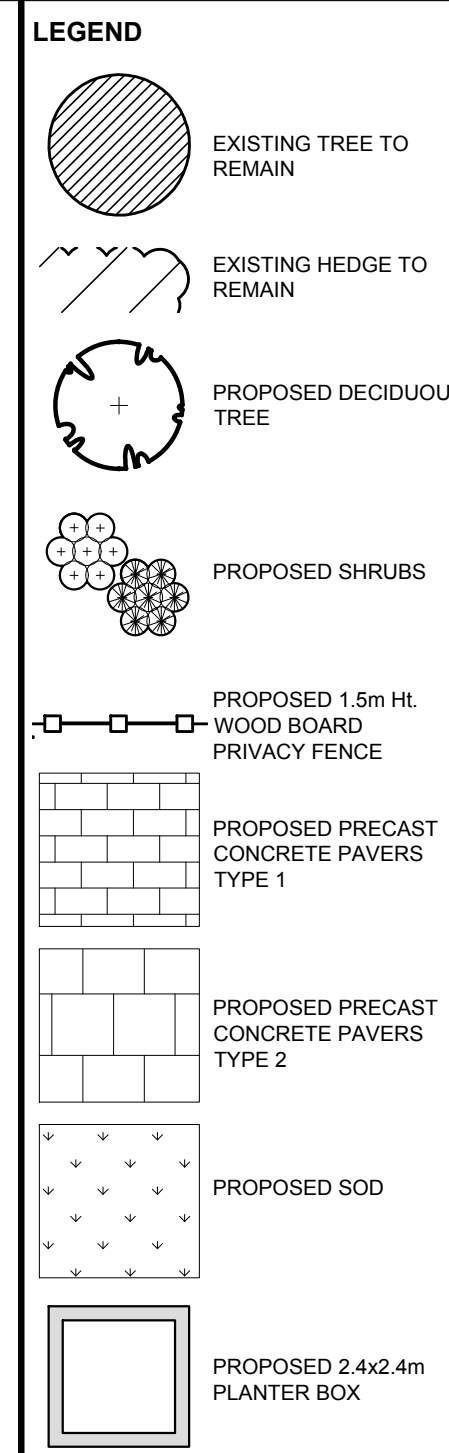

**CLIENT: GIL (CARLING AVE) INC**  
1 KENVIEW BLVD. SUITE 301, BRAMPTON, ON L6T 5E6

**CONSULTANTS ARCHITECTS:**  
**WOODMAN ARCHITECT ASSOCIATES LTD.**  
4 BEECHWOOD AVE. UNIT 201 - OTTAWA, ON, K1L 6L9 - TEL: (613) 233-6030

**SURVEYORS:**  
**FARLEY, SMITH & DENIS SURVEYING LTD.**  
ONTARIO LAND SURVEYORS  
CANADA LAND SURVEYORS  
190 COLONNADE ROAD, OTTAWA, ONTARIO K2E 7J5  
PHONE: (613) 727-8226 - FAX: (613) 727-1823

- ### GENERAL NOTES
- IT IS THE RESPONSIBILITY OF THE APPROPRIATE CONTRACTOR OR OFFICIAL TO REPORT ANY ERRORS, OMISSIONS OR DISCREPANCIES ON THIS PLAN WITH ACTUAL SITE CONDITIONS TO THE LANDSCAPE ARCHITECT BEFORE PROCEEDING WITH CONSTRUCTION.
  - THE CONTRACTOR IS TO NOTIFY ALL UTILITY COMPANIES AND AUTHORITIES PRIOR TO ANY EXCAVATION AND ASCERTAIN LOCATIONS OF UNDERGROUND SERVICES.
  - THE CONTRACTOR IS TO REINSTATE ALL AREAS AND ITEMS DAMAGED AS A RESULT OF CONSTRUCTION ACTIVITY.
  - THE CONTRACTOR IS TO COMPLY WITH ALL PERTINENT CODES AND BY-LAWS.
  - THE CONTRACTOR IS TO MAINTAIN A POSITIVE SURFACE RUN-OFF THROUGHOUT THE ENTIRE CONSTRUCTION PERIOD.
  - THE LANDSCAPE ARCHITECT IS NOT RESPONSIBLE FOR SUBSURFACE CONDITIONS.
  - THE CONTRACTOR IS TO IDENTIFY ALL EXISTING TREES TO REMAIN ON SITE WITH THE LANDSCAPE ARCHITECT PRIOR TO CONSTRUCTION.
  - THE CONTRACTOR IS TO STAKE THE PROPOSED LOCATION OF ALL PLANT MATERIAL IN CONJUNCTION WITH THE LANDSCAPE ARCHITECT PRIOR TO EXCAVATION.
  - MINIMUM DISTANCES FOR SELECTED DECIDUOUS TREES ARE AS FOLLOWS:
    - BUILDING FOUNDATIONS 7.5M
    - SIDEWALKS 1.5M
    - PUBLIC STREETS 2.5M
    - UNDERGROUND INFRASTRUCTURE 2.0M
  - ALL TREES WITHIN 1M OF UNDERGROUND UTILITY TRENCHES ARE TO BE EXCAVATED BY HAND.
  - REMOVE ALL PROTECTIVE WRAPPING FROM TREE TRUNKS AFTER INSTALLATION.
  - STAKING OF TREES SHALL ONLY BE PERFORMED IF NECESSARY.
  - ENSURE THAT MULCH IS PULLED BACK A MIN. DISTANCE OF 75MM FROM BASE OF TREE TRUNK.

No.	Issue	Date	DR	CK
14	CLIENT NAME REVISED	02/07/2024	ML	JL
13	VENT LOCATION REVISED	02/05/2024	ML	JL
12	REVISED PER NEW CIVIL DRAWING	01/31/2024	ML	JL
11	REVISED PER CITY COMMENTS	01/23/2024	ML	JL
10	REVISED PER NEW SITE PLAN	10/27/2023	ML	JL
9	REVISED PER CITY COMMENTS	10/24/2023	ML	JL
8	REVISED PER NEW CIVIL DRAWING	09/12/2023	ML	JL
7	REVISED PER CITY COMMENTS	07/10/2023	ML	JL
6	REVISED PER CITY COMMENTS	02/06/2023	ML	JL
5	REVISED PER CITY COMMENTS	06/14/2022	ML	JL
4	ISSUED FOR UDRP REVIEW	08/17/2022	ML	JL
3	ISSUED FOR DISCUSSION AND REVIEW	12/15/2021	ML	JL
2	ISSUED FOR DISCUSSION AND REVIEW	08/07/2020	ML	JL
1	ISSUED FOR DISCUSSION AND REVIEW	06/16/2020	ML	JL

**APPROVED**  
By Kersten Nitsche at 8:49 am, Jun 12, 2024

*Kersten Nitsche*

**KERSTEN NITSCHÉ, MCIP RPP**  
MANAGER (A), DEVELOPMENT REVIEW WEST  
PLANNING, DEVELOPMENT AND BUILDING SERVICES  
DEPARTMENT, CITY OF OTTAWA

**JAMES B. LENNOX & ASSOCIATES INC.**  
**LANDSCAPE ARCHITECTS**  
3332 CARLING AVE. OTTAWA, ONTARIO K2H 5A5  
Tel: (613) 722-5168 Fax: (613) 343-3942

**PROJECT**  
PROPOSED RESIDENTIAL BUILDING  
1940 CARLING AVENUE  
OTTAWA, ON

**DRAWING**  
LANDSCAPE PLAN

**STAMP**

**SCALE**  
AS NOTED

**START DATE**  
JUNE, 2020

**PROJECT NO.**  
20MS2044

**TRUE NORTH**

**DRAWING NO.**  
**L.1**

**PLOT SIZE ARCH-D**

1 LANDSCAPE PLAN  
SCALE 1:100