

2023-02-17P:\1963 - 1940 Carling - 7 Storey Apt Bldg\4. Arch Working Drawings\1940 CARLING AVE_2023-02-15 - J.G.dwg

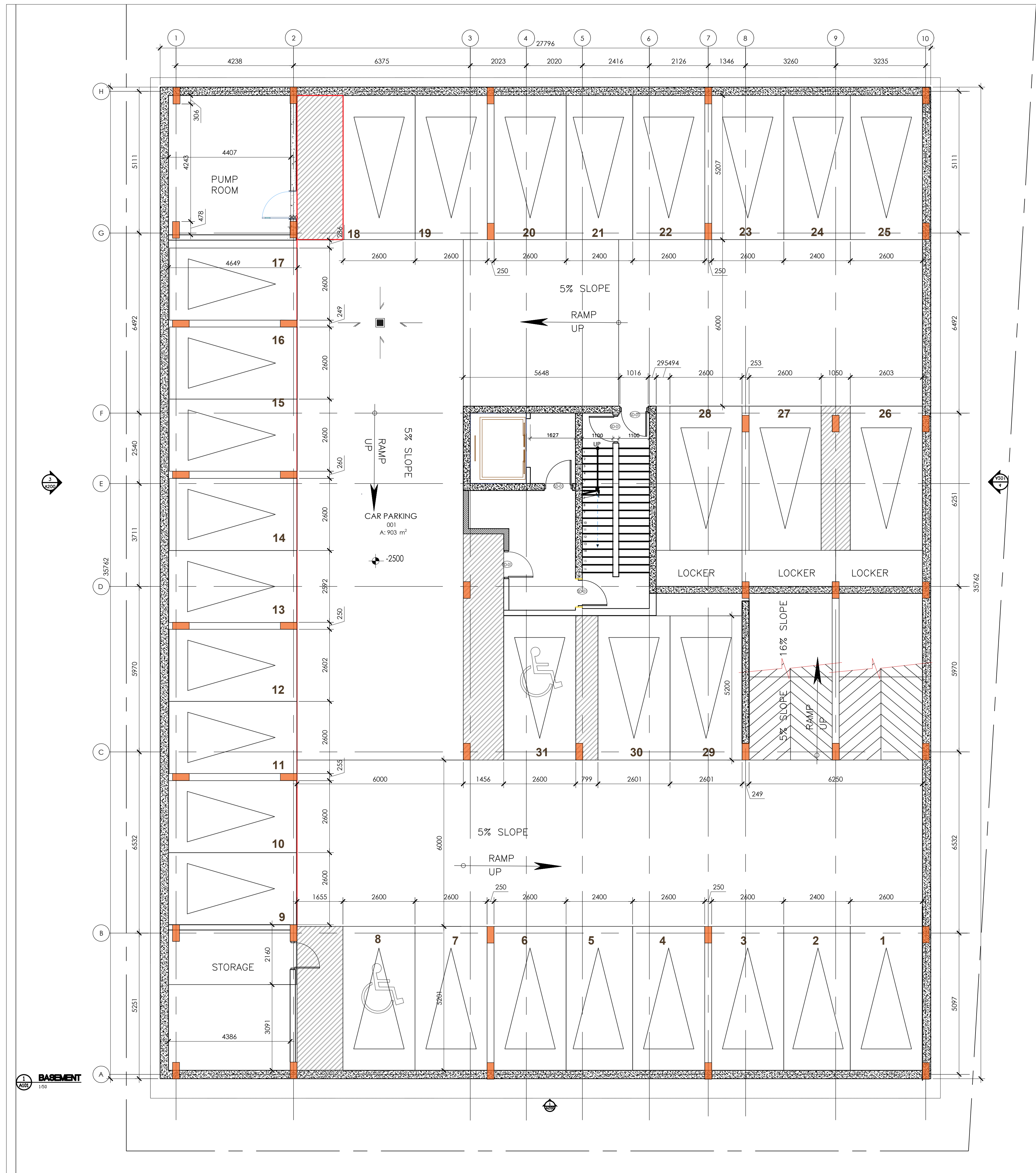

This Drawing And Its Contents Are The Property Of Woodman Architect & Associates Ltd. Copying & Any Other Kind Of Usage Of This Drawing Is Not Permitted Without The Architect's Written Consent.

KEY PLAN

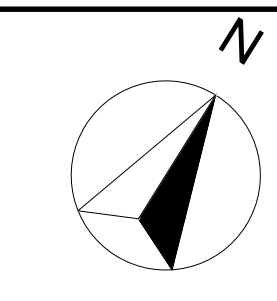

ALL CONTRACTORS TO VERIFY ALL DIMENSIONS ON SITE AND TO REPORT ALL ERRORS AND/OR OMISSIONS TO THE ARCHITECT.

ALL CONTRACTORS MUST COMPLY WITH ALL CODES AND BYLAWS AND OTHER AUTHORITIES HAVING JURISDICTION OVER THE WORK.

DO NOT SCALE DRAWINGS.

THIS DRAWING MAY NOT BE USED FOR CONSTRUCTION UNTIL SIGNED BY THE ARCHITECT.

COPYRIGHT RESERVED.

| NO. | REVISION | MM/DD/YY DATE |
|-----|------------------------------|---------------|
| 14 | | |
| 13 | | |
| 12 | | |
| 11 | | |
| 10 | | |
| 09 | | |
| 08 | ISSUED FOR APPROVAL | 02/16/23 |
| 07 | GENERAL REVISION | 02/04/23 |
| 06 | GENERAL REVISION | 10/24/22 |
| 05 | ISSUED FOR UDRP CONSULTATION | 08/16/22 |
| 04 | ISSUED FOR RESPONSE TO UDRP | 06/07/22 |
| 03 | ISSUED FOR COORDINATION | 06/23/22 |
| 02 | ISSUED FOR SITE PLAN | 12/03/21 |
| 01 | ISSUED FOR SITE PLAN | 08/27/21 |

WOODMAN ARCHITECT
ASSOCIATES LTD.

201-4 BEECHWOOD AVENUE, OTTAWA, ONTARIO, CANADA K1L8L9
TEL: 613 228 9850, FAX: 613 228 9848, mailbox@woodmanarchitect.com

CONSULTANTS:
STRUCTURAL -
MECHANICAL -
ELECTRICAL -

PROJECT
1940 CARLING AVENUE,
OTTAWA, ONTARIO

DRAWING:
BASEMENT

| | | |
|-------------|--------------|------|
| DATE | JOB NO. | 1963 |
| SCALE | DRAWING NO. | A101 |
| DRAWN BY | | |
| REVIEWED BY | R.J.W., R.W. | |

D07-12-22-0001