

**EXISTING TREE LIST**

KEY	QTY	BOTANICAL NAME	COMMON NAME	SIZE	CONDITION	REMARKS
EL	1	Ulmus americana	American Elm	100mm dia.	Good	To remain

**PROPOSED PLANT LIST**

KEY	QTY	BOTANICAL NAME	COMMON NAME	SIZE	CONDITION	SPACING
HL	4	Gleditsia triacanthos	Honey Locust	60mm dia.	B&B	

- GENERAL NOTES:**
- It is the responsibility of the appropriate contractor or official to report any errors, omissions or discrepancies on this plan with actual site conditions to the Landscape Architect before proceeding with construction.
  - The contractor is to notify all utility companies and authorities prior to any excavation and ascertain locations of underground services.
  - The contractor is to reinstate all areas and items damaged as a result of construction activity.
  - The contractor is to comply with all pertinent codes and by-laws.
  - The contractor is to maintain a positive surface run-off throughout the entire construction period.
  - The Landscape Architect is not responsible for subsurface conditions.
  - The contractor is to identify all existing trees to remain on site with the Landscape Architect prior to construction.
  - The contractor is to stake the proposed location of all plant material in conjunction with the Landscape Architect prior to excavation.
  - All trees within 1m of underground utility trenches are to be excavated by hand.
  - Remove all protective wrapping from tree trunks after installation.
  - Staking of trees shall only be performed if necessary.
  - Ensure that mulch is pulled back a min. distance of 75mm from base of tree trunk.

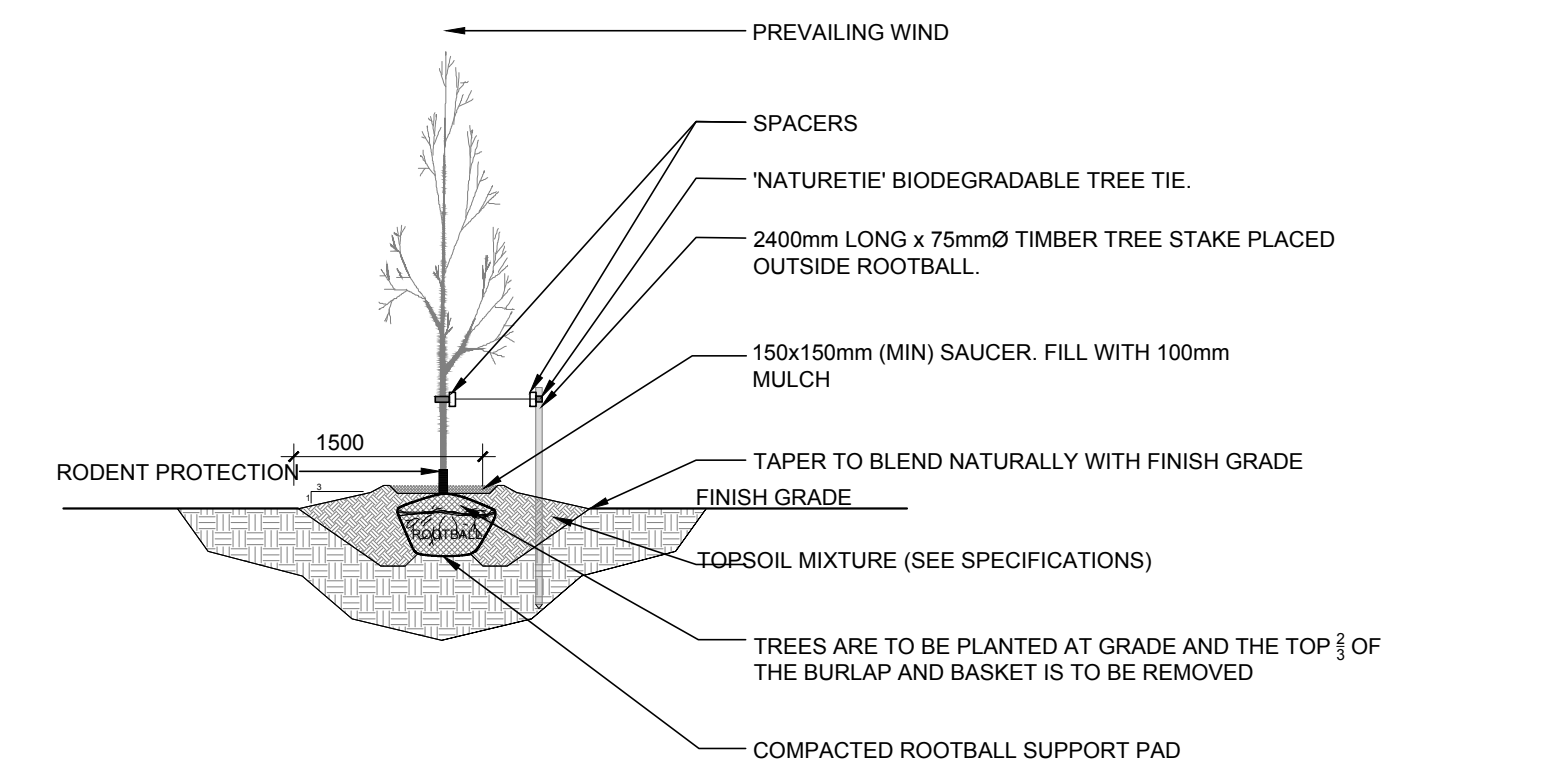

1 TREE CONSERVATION REPORT & LANDSCAPE PLAN  
L.1 SCALE 1:100

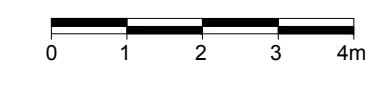

2 DECIDUOUS TREE PLANTING  
L.1 N.T.S.

**CONSULTANTS**

ARCHITECTS:  
CHMEL ARCHITECTS  
200-109 Bank Street, ON K1P5R6  
Tel: (613) 248-3885

CIVIL ENGINEERS:  
ANLEY GROUP  
2754 FERRIS BL, GOSHEN, ON K1T 3T7  
Tel: (613) 622-1052

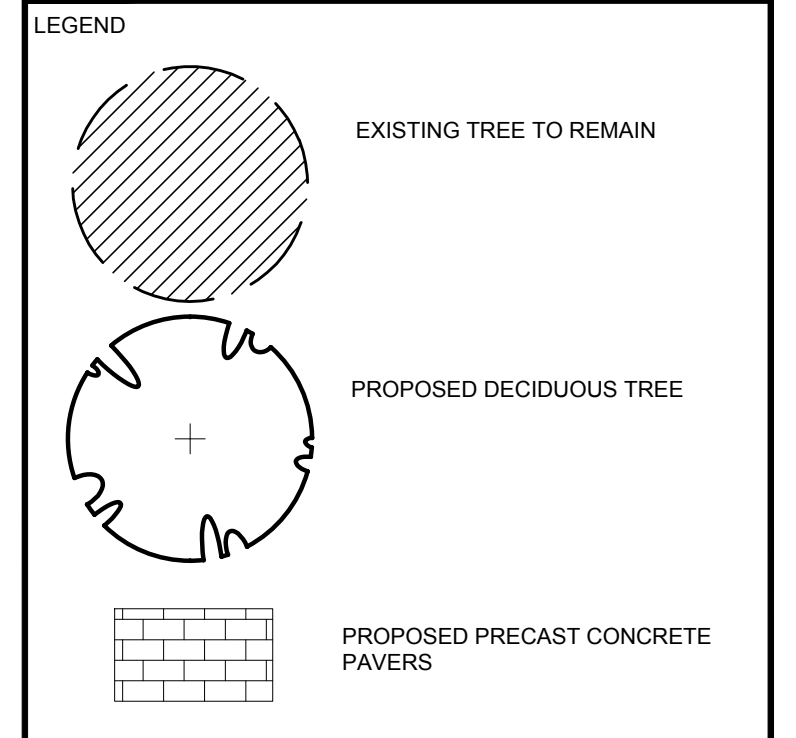

No.	Issue	Date	LC	JL
1	ISSUED FOR SITE PLAN APPROVAL	04/18/2023	LC	JL

**JAMES B. LENNOX & ASSOCIATES INC.**  
LANDSCAPE ARCHITECTS  
3332 CARLING AVE. OTTAWA, ONTARIO K2H 5A8  
Tel: (613) 722-5168 Fax: (866) 343-3942

**PROJECT**  
SOMERSET APARTMENTS  
352 SOMERSET STREET, OTTAWA, ON.

**DRAWING**  
LANDSCAPE PLAN

**STAMP**

SCALE: AS SHOWN

START DATE: APRIL, 2023

PROJECT NO.

**PROJECT NORTH**

**DRAWING NO.**  
L.1

PLOT SIZE ARCH-D