

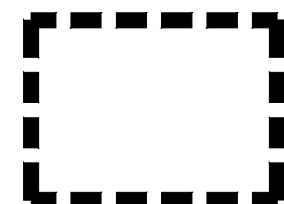

KEY MAP
SCALE: N.T.S.

LEGEND



STORM DRAINAGE AREA

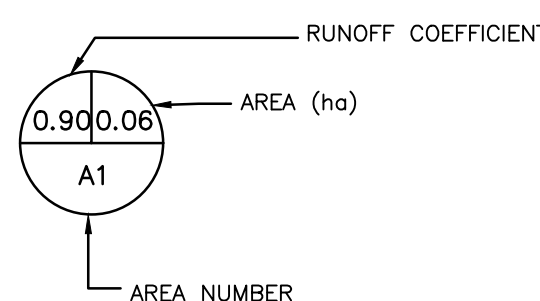

RUNOFF COEFFICIENT

AREA (ha)

AREA NUMBER

SOMERSET STREET

SITE BENCHMARK
FIRE HYDRANT
(TOP OF SPINDLE)
ELEVATION=73.19

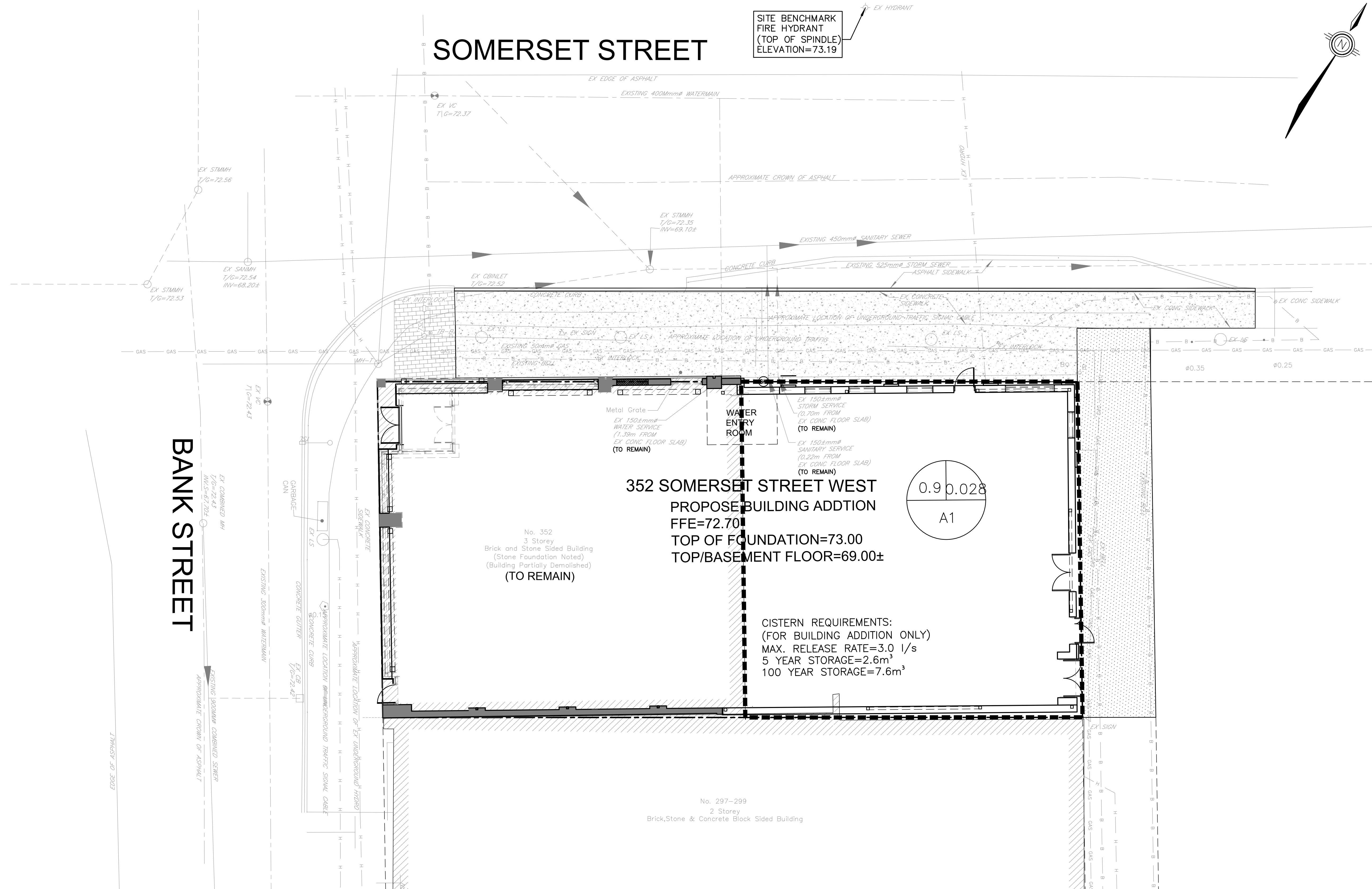

352 SOMERSET STREET WEST
PROPOSE BUILDING ADDTION
FFE=72.70
TOP OF FOUNDATION=73.00
TOP/BASEMENT FLOOR=69.00±

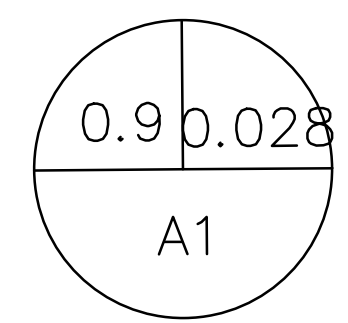

CISTERN REQUIREMENTS:
 (FOR BUILDING ADDITION ONLY)
 MAX. RELEASE RATE=3.0 l/s
 5 YEAR STORAGE=2.6m³
 100 YEAR STORAGE=7.6m³

CONTRACT DRAWINGS:
 Contractor must verify all dimensions and be responsible for same. Any discrepancies must be reported to the Engineer before commencing work. Drawings are not to be copied, distributed or used by others without the express written consent of Ainley Graham & Associates Limited. Use of these drawings for any other purpose is subject to the following caution.

CAUTION: The information contained in this drawing is solely for the intended recipient. Any copying, distribution or use by others without the express written consent of Ainley Graham & Associates Limited is prohibited. The recipient is responsible for confirming the accuracy and completeness of the information with the originator. The recipient assumes all risks and liabilities associated with the use of the drawings. The recipient will save and hold harmless Ainley Graham & Associates Limited for any claims whatsoever associated with or related to the use of the drawings. The recipient will not reuse any portion of the drawings for any future project without the express written permission of Ainley Graham & Associates Limited.

NO.	REVISIONS	DATE	INITIAL
1	ISSUED FOR SITE PLAN APPROVAL	MAR 29/23	JX

Not Valid Unless Signed And Dated

Professional Engineers
 Ontario
 MARCH 29, 2023
Limited Licensee
 Name: J.W.XU
 Number: 100171806
 Category: CIVIL-see limitation
 Limitations:
 This licence is subject to the limitations as detailed on the certificate.
 Association of Professional Engineers of Ontario

SCALE: 1 : 100
 DESIGN: JX
 DRAWN: JX
 CHECKED: GSC/JX
 DATE: AUG 2022

SOMERSET HOUSE
352 SOMERSET STREET WEST
CITY OF OTTAWA

STORMWATER MANAGEMENT PLAN

CONSULTING
ENGINEERS
PLANNERS

CONTRACT No. 21038 003-21038-SWM1