



Copyright Reserved

The Contractor shall verify and be responsible for all dimensions. DO NOT scale the drawing - any errors or omissions shall be reported to Stantec without delay.
The Copyrights to all designs and drawings are the property of Stantec. Reproduction or use for any purpose other than that authorized by Stantec is forbidden.

Legend

- EXISTING AREA ID
- EXISTING RUNOFF COEFFICIENT
- EXISTING STORM DRAINAGE AREA A_p
- EXISTING STORM DRAINAGE BOUNDARY
- DIRECTION OF OVERLAND FLOW
- EXISTING STORM SEWER
- EXISTING CATCHBASIN
- ORIGINAL GROUND ELEVATION

Notes

6	REVISED AS PER CITY COMMENTS	WAJ	KJK	23.04.13
5	REVISED AS PER CITY COMMENTS	WAJ	KJK	23.01.01
4	REVISED SITE PLAN	WAJ	KJK	22.11.24
3	REVISED AS PER CITY COMMENTS	WAJ	KJK	22.06.06
2	ISSUED FOR SITE PLAN APPROVAL	WAJ	KJK	22.01.19
1	ISSUED FOR REVIEW	WAJ	KJK	20.08.13
Revision		By	Appd.	YY.MM.DD

File Name:	160410274-08	WAJ	KJK	WAJ	20.08.04
		Dwn.	Chkd.	Dsgn.	YY.MM.DD

Permit-Seal

Client/Project
LASALLE INVESTMENT MANAGEMENT
22 ADELAIDE ST WEST, 26TH FLOOR

HOLLAND CROSS
HOLLAND AVE
OTTAWA, ON

Title
EXISTING STORM DRAINAGE PLAN

Project No.	Scale	0	2.5	7.5	12.5m
160410274	1:250				
Drawing No.	Sheet	Revision			

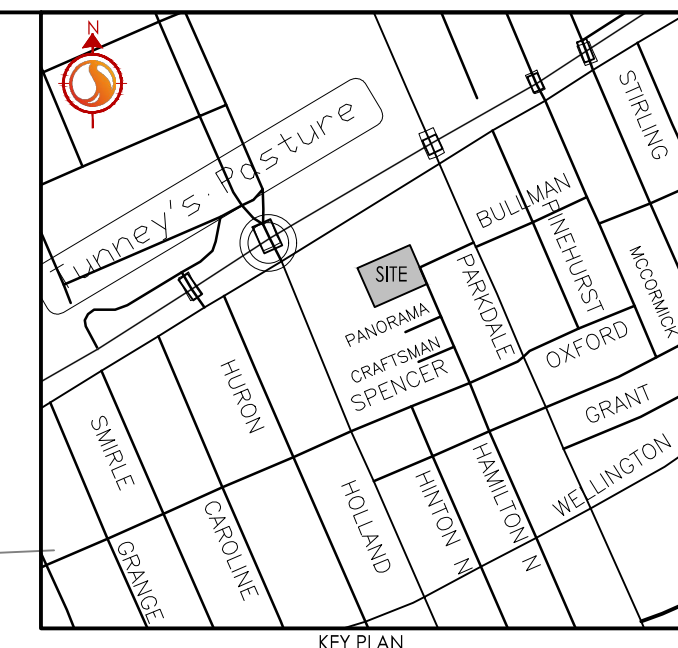
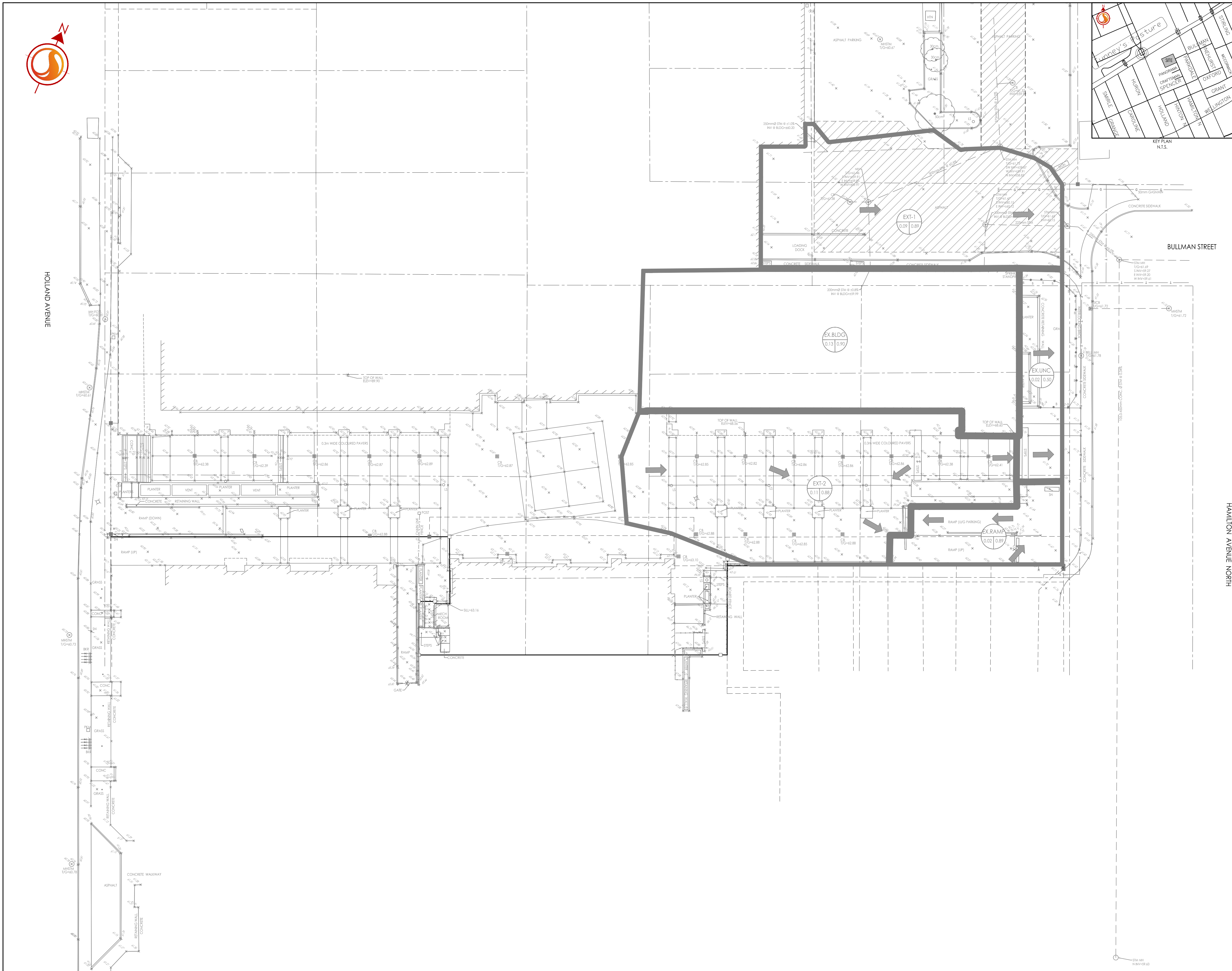

V:\Projects\160410274\160410274_08.dwg
 2023/04/13 11:30 AM
 ORIGINAL SHEET - ARCH D