

*Lucy Ramirez*

**LUCY RAMIREZ**  
PLANNER  
PLANNING, INFRASTRUCTURE & ECONOMIC DEVELOPMENT DEPARTMENT, CITY OF OTTAWA

**APPROVED**  
By Lucy Ramirez at 1:38 pm, Feb 22, 2024

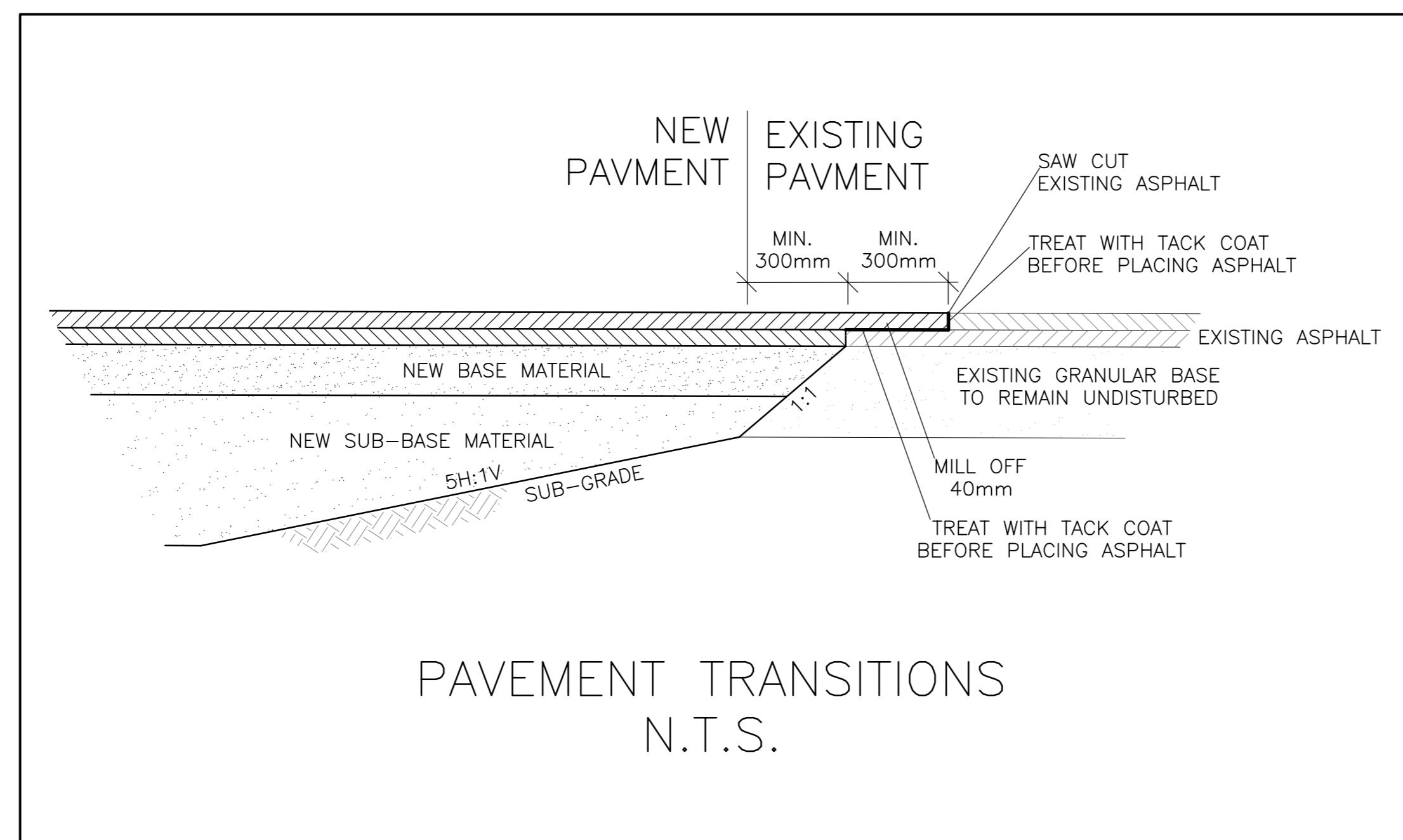

**WATER SERVICE PROFILE TABLE**

MATERIAL:  
150mm PVC PRESSURE CLASS 150 DR18

STATION	DESCRIPTION	GRADE ELEVATION	TOP OF PIPE	DEPTH OF COVER	NOTES
0+00.0	150mm x 150mm TEE CONNECTION IN 150mm MUNICIPAL WATERMAIN TO CITY OF OTTAWA STANDARDS	±69.10	±66.45	±2.65	-
0+05.4	11.25° VERTICAL BEND UP TO CITY OF OTTAWA STANDARDS	±69.20	66.45	±2.75	-
0+06.9	11.25° VERTICAL BEND DOWN TO CITY OF OTTAWA STANDARDS	69.35	66.75	2.60	-
0+07.9	-	69.38	66.75	2.63	CROSSING 300 SAN TOP ±66.35 WM U/S 66.60 - 250mm CLEARANCE (MIN. 250mm REQ'D)
0+08.0	-	69.38	66.75	2.63	CROSSING 450 ST INV ±67.55 WM TOP 66.75 - 800mm CLEARANCE (MIN. 500mm REQ'D)
0+08.4	-	69.39	66.75	2.64	BACK OF SIDEWALK
0+11.7	150mm VALVE & VALVE BOX TO CITY OF OTTAWA STANDARDS	69.56	66.75	2.81	-
0+12.7	-	69.61	66.75	2.86	ENTRY INTO BUILDING

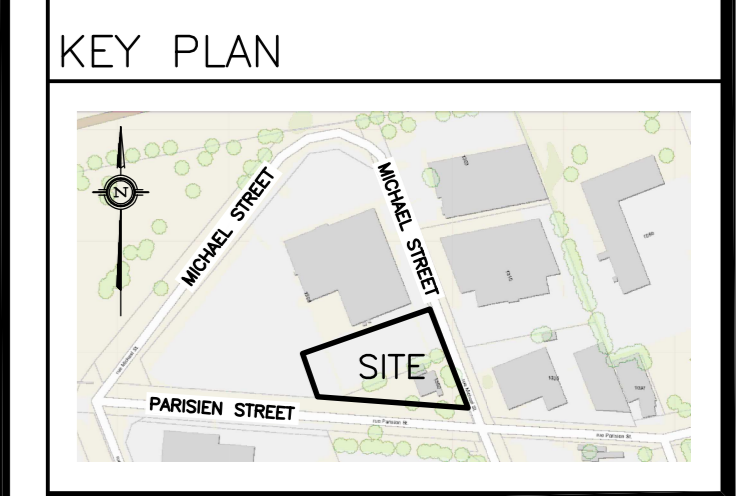

No.	DATE	REVISION
4	JAN 25-23	RE-ISSUED FOR APPROVAL
3	JUL 28-22	RE-ISSUED FOR APPROVAL
2	JAN 12-22	ISSUED FOR APPROVAL
1	JAN 11-22	ISSUED FOR COORDINATION

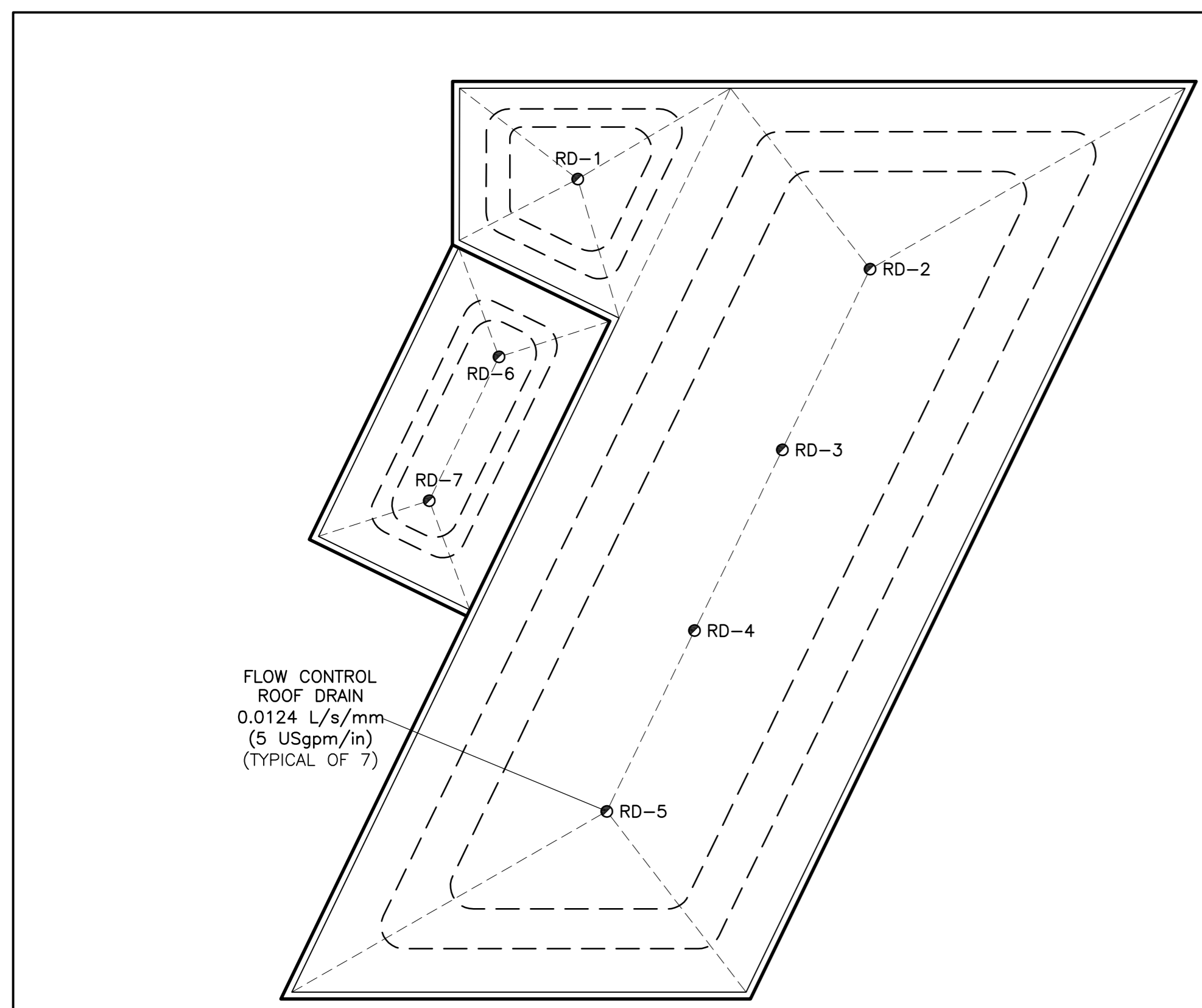

PONDING DEPTHS AT ROOF DRAINS	100-YEAR	5-YEAR
RD-1	116mm	86mm
RD-2,3,4,5	114mm	81mm
RD-6,7	89mm	61mm

UPPER ROOF: INSTALL A MINIMUM OF 9 SCUPPERS, EACH A MINIMUM 300mm WIDE. BOTTOM OF SCUPPERS SHALL BE 150mm ABOVE ROOF DRAINS (REFER TO ARCHITECTURAL FOR EXACT LOCATIONS AND DETAILS). ROOF SHALL BE DESIGNED TO CARRY THE LOAD OF WATER HAVING A 50mm DEPTH AT SCUPPER OR 200mm DEPTH AT ROOF DRAIN (REFER TO STRUCTURAL).

LOWER ROOF: INSTALL A MINIMUM OF 2 SCUPPERS, EACH A MINIMUM 300mm WIDE. BOTTOM OF SCUPPERS SHALL BE 150mm ABOVE ROOF DRAINS (REFER TO ARCHITECTURAL FOR EXACT LOCATIONS AND DETAILS). ROOF SHALL BE DESIGNED TO CARRY THE LOAD OF WATER HAVING A 50mm DEPTH AT SCUPPER OR 200mm DEPTH AT ROOF DRAIN (REFER TO STRUCTURAL).

**ROOF DRAINAGE PLAN**

**CATCH-BASIN & MANHOLE SCHEDULE**

REF	TOP	SIZE	TYPE	INVERT AT INLET	INVERT AT OUTLET	NOTES
<b>STORM SEWER</b>						
CB/MH-1	69.49	1200mm	PRE-CAST CONCRETE CATCH-BASIN/MANHOLE	-	67.52	TO OPSD 701.010 & CITY OF OTTAWA STANDARDS - FRAME & COVER TO CITY OF OTTAWA DRAWING No. S25 & S28.1
CB/MH-2	69.12	1200mm	PRE-CAST CONCRETE CATCH-BASIN/MANHOLE	67.42(E)	67.42(S)	TO OPSD 701.010 & CITY OF OTTAWA STANDARDS - FRAME & COVER TO CITY OF OTTAWA DRAWING No. S25 & S28.1
CB/MH-3	69.04	1200mm	PRE-CAST CONCRETE CATCH-BASIN/MANHOLE	67.40(N)	67.40(S)	TO OPSD 701.010 & CITY OF OTTAWA STANDARDS - FRAME & COVER TO CITY OF OTTAWA DRAWING No. S25 & S28.1 INSTALL ICD IN OUTLET PIPE
MH-4	69.07	CDS PMSU2015-4	PRE-CAST CONCRETE MANHOLE	67.39(N)	67.38(S)	TO OPSD 701.010 & CITY OF OTTAWA STANDARDS EXCEPT WITH A DEEP SUMP AS REQUIRED BY CDS INSTALL WATERTIGHT COVER
MH-5	±68.85	1200mm	PRE-CAST CONCRETE MANHOLE	67.36(N) ±67.31(E)	±67.30(W)	TO OPSD 701.010 & CITY OF OTTAWA STANDARDS - FRAME & COVER TO CITY OF OTTAWA DRAWING No. S25 & S24.1

**D. B. GRAY ENGINEERING INC.**  
Stormwater Management - Grading & Drainage - Storm & Sanitary Sewers - Watermain  
700 Long Point Circle 613-425-8044  
Ottawa, Ontario d.gray@dbgrayengineering.com

Project  
**PROPOSED 2 STOREY VOLVO DEALERSHIP**  
1328 MICHAEL STREET  
OTTAWA, ONTARIO

Drawing Title  
**DETAILS & SCHEDULES**

Engineer's Seal  
LICENCED PROFESSIONAL ENGINEER  
D.B. GRAY  
17016502  
JAN 25-23  
PROVINCE OF ONTARIO

Drawn D.B.G.  
H. Scale  
V. Scale  
Date NOV 2-21  
Job No. 21014

Drawing No.  
**C-5 of 8**

#18651

D07-12-22-0012