

SITE BOUNDARIES AND EXISTING GRADES AND OTHER EXISTING FEATURES ARE DERIVED FROM TOPOGRAPHIC SKETCH PREPARED BY ANNIS O'SULLIVAN, VOLLEBEKK LTD. JOB NO. 16814-16, DATED FEB 24, 2021. EXISTING ELEVATIONS SHOWN ON THE TOPOGRAPHIC SKETCH ARE GEODETIC AND ARE REFERRED TO THE COVID28 GEODETIC DATUM, DERIVED FROM CITY OF OTTAWA LRT CONTROL MONUMENT 2011-0006 HAVING AN ELEVATION OF 72.657 METRES.

ALL EXISTING TREES ON THE PROPERTY AND RIGHT-OF-WAY SHALL BE PROTECTED DURING AND AFTER CONSTRUCTION AS PER THE MUNICIPAL TREES AND NATURAL AREAS PROTECTION BY-LAWS AND THE URBAN TREES CONSERVATION BY-LAWS AS AMENDED FROM TIME TO TIME

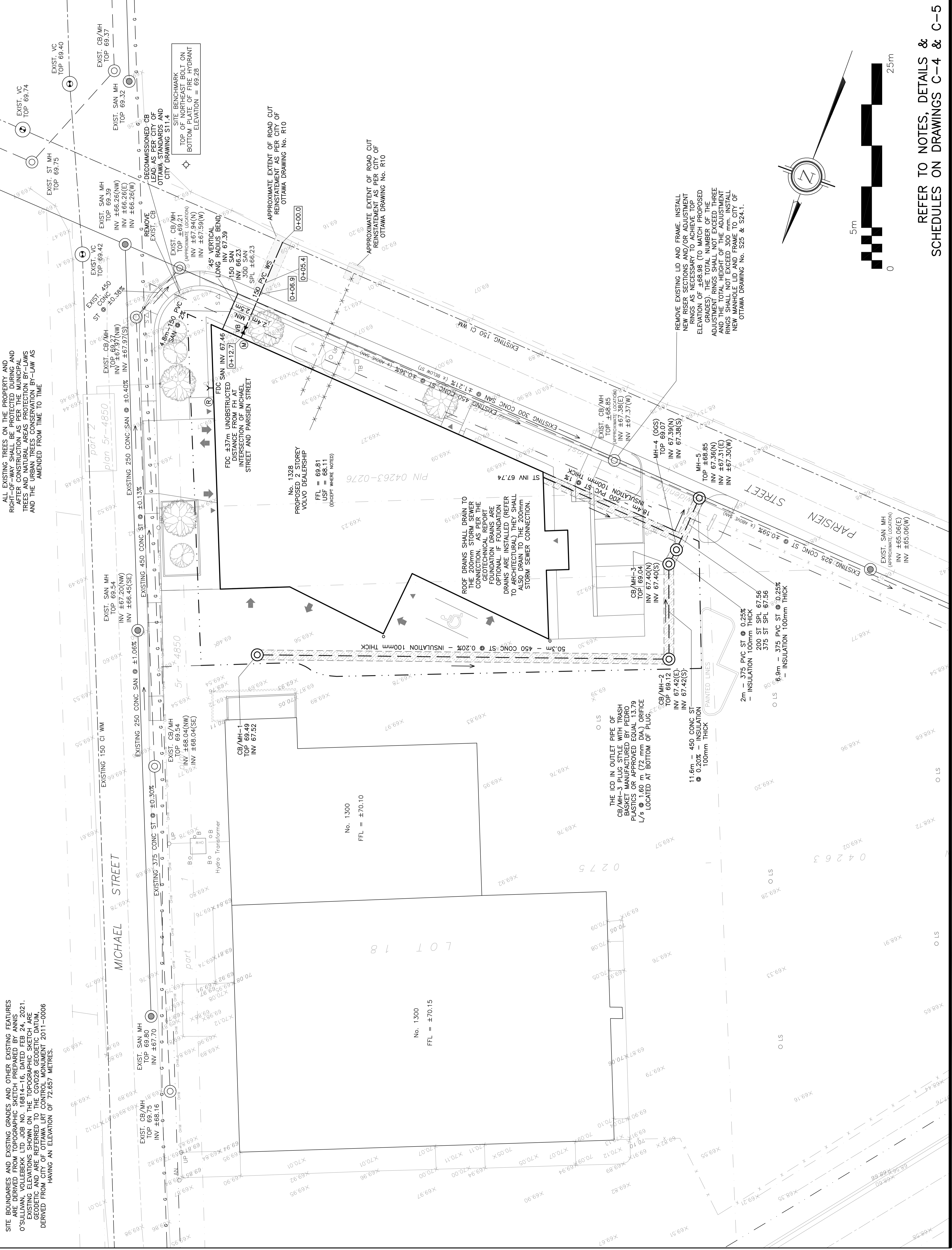

LEGEND

CB	CATCH-BASIN
MH	STORM MANHOLE
CB/MH	CATCH-BASIN/MANHOLE
MH	SANITARY MANHOLE
VC	VALVE CHAMBER
VB	VALVE & VALVE BOX
FH	FIRE HYDRANT
FDC	FIRE DEPARTMENT CONNECTION
SAN	SANITARY SEWER
ST	STORM SEWER
WS/WM	WATER SERVICE/WATERMAIN
SPL	SPRINGLINE OF PIPE
INV	INVERT OF PIPE
M	WATER METER
R	REMOTE WATER METER
FFL	FINISHED FLOOR ELEVATION
USF	UNDERSIDE OF FOOTING
---	PROPERTY LINE
- - -	EXISTING GRADE ELEVATION
X	CRITICAL ROOT ZONE

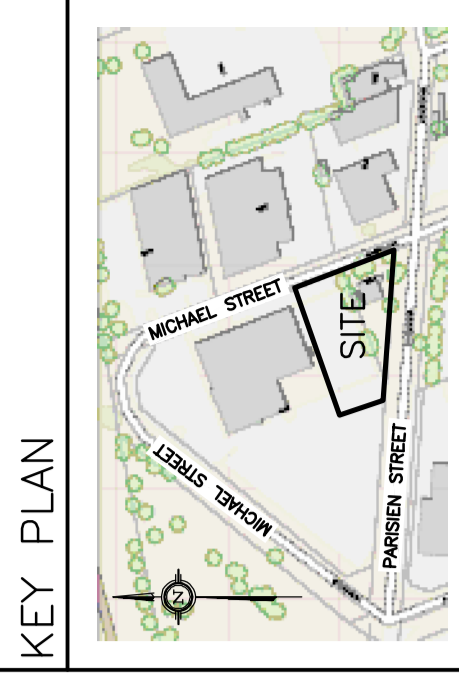

No.	DATE	REVISION
6	JUL 24-23	RE-ISSUED FOR APPROVAL
5	JAN 25-23	RE-ISSUED FOR APPROVAL
4	JUL 28-22	RE-ISSUED FOR APPROVAL
3	JAN 12-22	ISSUED FOR APPROVAL
2	JAN 11-22	ISSUED FOR COORDINATION
1	NOV 2-21	PRELIMINARY

D. B. GRAY ENGINEERING INC.
 Professional Engineer
 700 Long Point Circle
 Ottawa, Ontario
 613-425-8044
 d.gray@dbgrayengineering.com

PROPOSED 2 STOREY VOLVO DEALERSHIP
 1328 MICHAEL STREET
 OTTAWA, ONTARIO

SITE SERVICING PLAN

Engineer's Seal
 D.B. GRAY
 17016502
 JUL 24-23
 Drawing No. **C-1** of **8**
 NOT VALID UNLESS SIGNED & DATED
 #18651

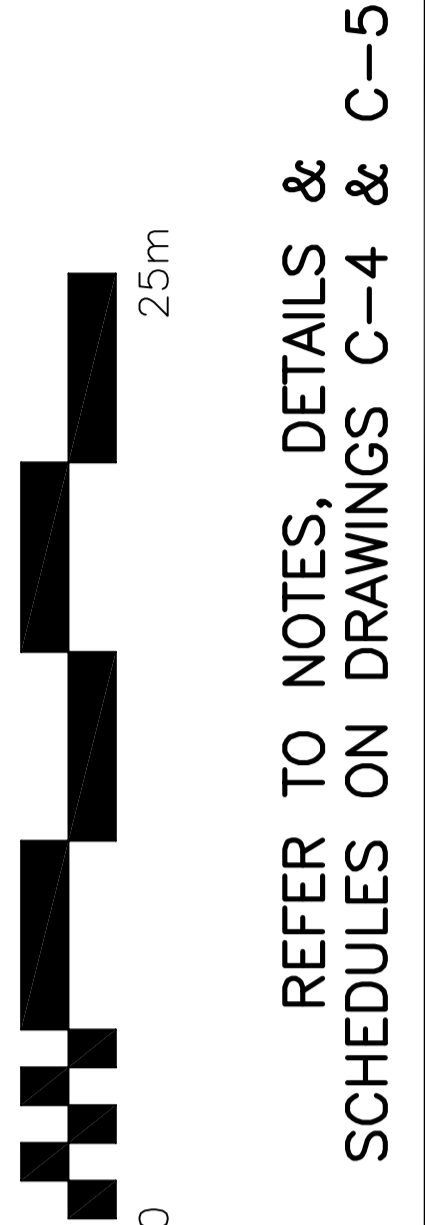

REFER TO NOTES, DETAILS & SCHEDULES ON DRAWINGS C-4 & C-5

REMOVE EXISTING LID AND FRAME. INSTALL NEW RISE SECTIONS AND/OR ADJUSTMENT RINGS AS NECESSARY TO ACHIEVE TOP ELEVATION OF ±68.98 (TO MATCH PROPOSED GRADES). THE TOTAL NUMBER OF THE ADJUSTMENT RINGS SHALL NOT EXCEED THREE AND THE TOTAL HEIGHT OF THE ADJUSTMENT RINGS SHALL NOT EXCEED 300 mm. INSTALL NEW MANHOLE LID AND FRAME TO CITY OF OTTAWA DRAWING No. 525 & 524.1.1.

ROOF DRAINS SHALL DRAIN TO THE 200mm STORM SEWER CONNECTION, AS PER THE GEOTECHNICAL REPORT. FOUNDATION DRAINS ARE OPTIONAL IF FOUNDATION DRAINS ARE INSTALLED (REFER TO ARCHITECTURAL). THEY SHALL ALSO DRAIN TO THE 200mm STORM SEWER CONNECTION.

THE ICD IN OUTLET PIPE OF CB/MH-3 PLUG STYLE WITH TRASH BASKET MANUFACTURED BY PEDRO PLASTICS OR APPROVED EQUAL 13.79 L/s @ 1.60 m (72 mm DIA.) ORIFICE LOCATED AT BOTTOM OF PLUG.

2m - 375 PVC ST @ 0.25%
 - INSULATION 100mm THICK
 200 ST SPL 67.56
 375 ST SPL 67.56
 O.L.S.
 6.9m - 375 PVC ST @ 0.25%
 - INSULATION 100mm THICK

11.6m - 450 CONC ST @ 0.20% - INSULATION 100mm THICK

No. 1328
 PROPOSED 2 STOREY
 VOLVO DEALERSHIP
 FFL = 69.81
 USF = 68.11
 (EXCEPT WHERE NOTED)

No. 1300
 FFL = ±70.10

No. 1300
 FFL = ±70.15