

SITE BOUNDARIES AND EXISTING GRADES AND OTHER EXISTING FEATURES ARE DERIVED FROM TOPOGRAPHIC SKETCH PREPARED BY ANNIS O'SULLIVAN, VOLLEBEKK LTD. JOB NO. 16814-16, DATED FEB 24, 2021. EXISTING ELEVATIONS SHOWN ON THE TOPOGRAPHIC SKETCH ARE GEODETIC AND ARE REFERRED TO THE COVID28 GEODETIC DATUM, DERIVED FROM CITY OF OTTAWA LRT CONTROL MONUMENT 2011-0006 HAVING AN ELEVATION OF 72.657 METRES.

ALL EXISTING TREES ON THE PROPERTY AND RIGHT-OF-WAY SHALL BE PROTECTED DURING AND AFTER CONSTRUCTION AS PER THE MUNICIPAL TREES AND NATURAL AREAS PROTECTION BY-LAW AS AMENDED FROM TIME TO TIME



- ① RETAINING WALL 1
T.O.W. VARIES
68.47 TO 68.58
B.O.W. VARIES
69.45 TO 69.22
HEIGHT VARIES
0.02m TO 0.36m
- ② RETAINING WALL 2
T.O.W. VARIES
69.58 TO 68.57
B.O.W. VARIES
69.22 TO 69.19
HEIGHT VARIES
0.36m TO 0.38m
- ③ RETAINING WALL 3
T.O.W. VARIES
69.57 TO 68.53
B.O.W. VARIES
69.19 TO 69.21
HEIGHT VARIES
0.38m TO 0.32m

REMOVE EXISTING LID AND FRAME. INSTALL NEW RISER SECTIONS AND/OR ADJUSTMENT RINGS AS NECESSARY TO ACHIEVE TOP ELEVATION OF +68.98 (TO MATCH PROPOSED GRADES). THE TOTAL NUMBER OF THE ADJUSTMENT RINGS SHALL NOT EXCEED THREE AND THE TOTAL HEIGHT OF THE ADJUSTMENT RINGS SHALL NOT EXCEED 300 mm. INSTALL NEW MANHOLE LID AND FRAME TO CITY OF OTTAWA DRAWING No. S25 & S24.1.

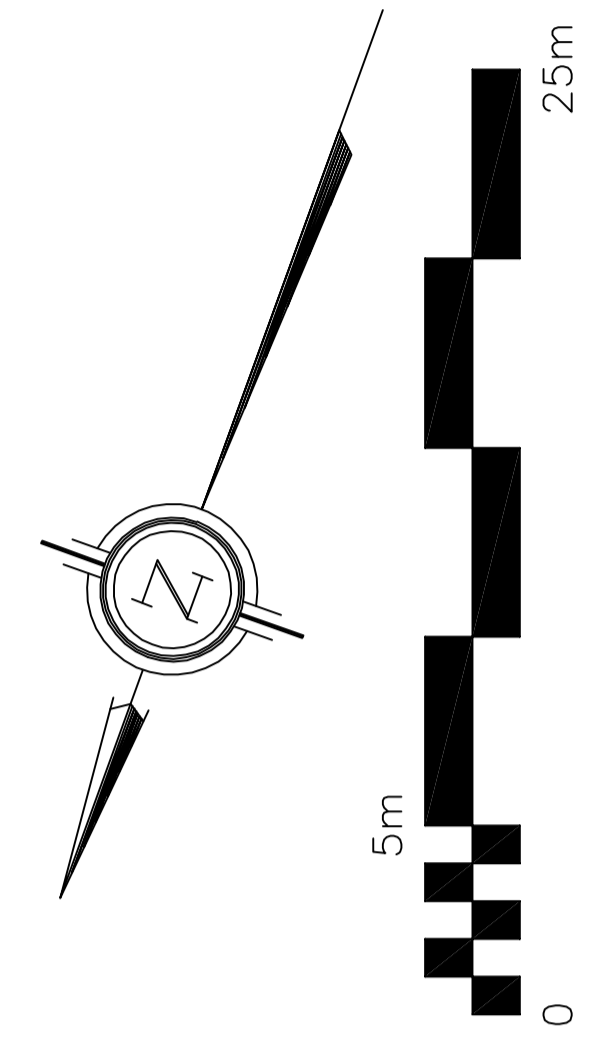

LEGEND

CB	CATCH-BASIN
MH	STORM MANHOLE
CB/MH	CATCH-BASIN/MANHOLE
MH	SANITARY MANHOLE
VC	VALVE CHAMBER
FH	FIRE HYDRANT
FDC	FIRE DEPARTMENT CONNECTION
FFL	FINISHED FLOOR ELEVATION
USF	UNDERSIDE OF FOOTING
- - -	PROPERTY LINE
+99.99	EXISTING GRADE ELEVATION
+99.99	PROPOSED GRADE ELEVATION
↑	OVERLAND FLOW
2%	PROPOSED SLOPE OF GRADE
150mm	150mm BARRIER CURB
D.C.	DEPRESSED CURB
C.R.Z.	CRITICAL ROOT ZONE
	ASPHALT PAVEMENT
□	CONCRETE
▨	PERMEABLE PAVERS

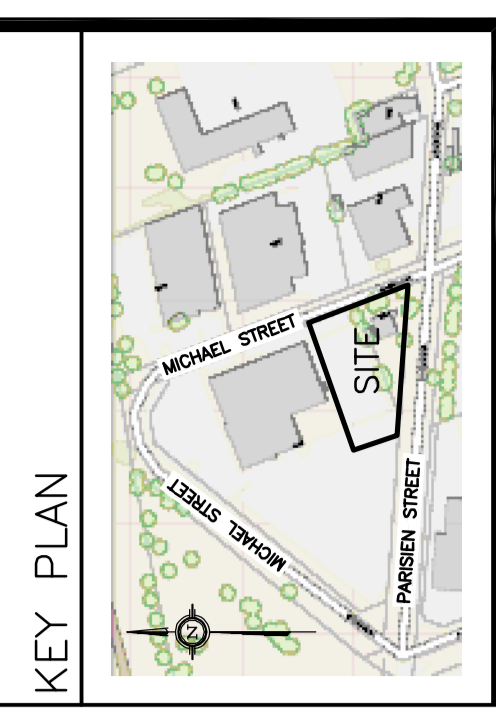

No.	DATE	REVISION
1	NOV 2-21	PRELIMINARY
2	JAN 11-22	ISSUED FOR COORDINATION
3	JAN 12-22	ISSUED FOR APPROVAL
4	JUL 28-22	RE-ISSUED FOR APPROVAL
5	JAN 25-23	RE-ISSUED FOR APPROVAL
6	JUL 24-23	RE-ISSUED FOR APPROVAL

D. B. GRAY ENGINEERING INC.
 Professional Engineer
 700 Long Point Circle
 Ottawa, Ontario
 K1M 1K7
 613-425-9144
 d.gray@dbgrayengineering.com

Project
PROPOSED 2 STOREY VOLVO DEALERSHIP
 1328 MICHAEL STREET
 OTTAWA, ONTARIO

Drawing Title
GRADING PLAN AND EROSION & SEDIMENT CONTROL PLAN

Engineer's Seal

 Drawn D.B.G.
 H. Scale 1:200
 V. Scale
 Date NOV 2-21
 Job No. 21014
 Drawing No. **C-3**
 of **8**
 NOT VALID UNLESS SIGNED & DATED

REFER TO NOTES, DETAILS & SCHEDULES ON DRAWINGS C-4 & C-5