

D1

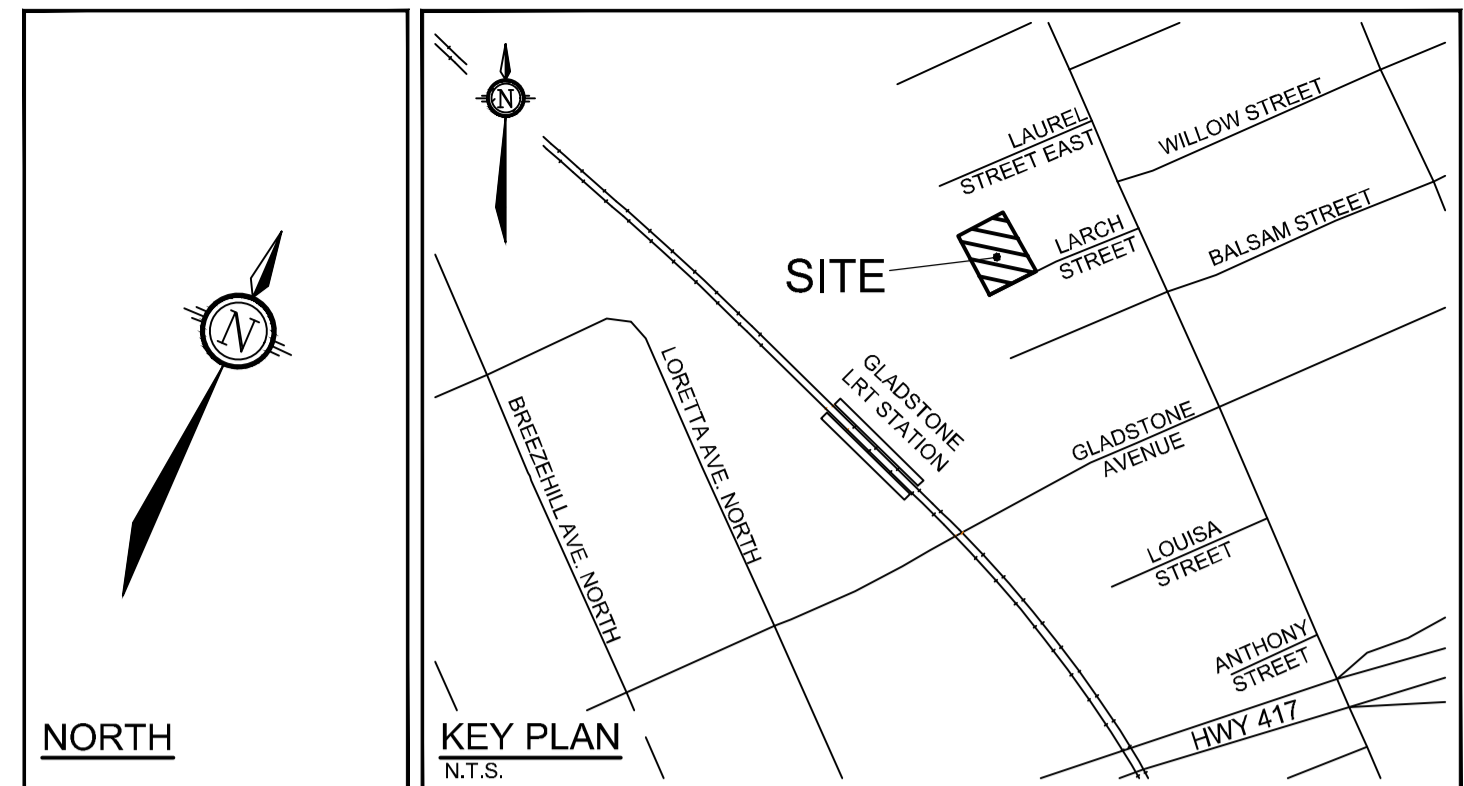

LEGEND

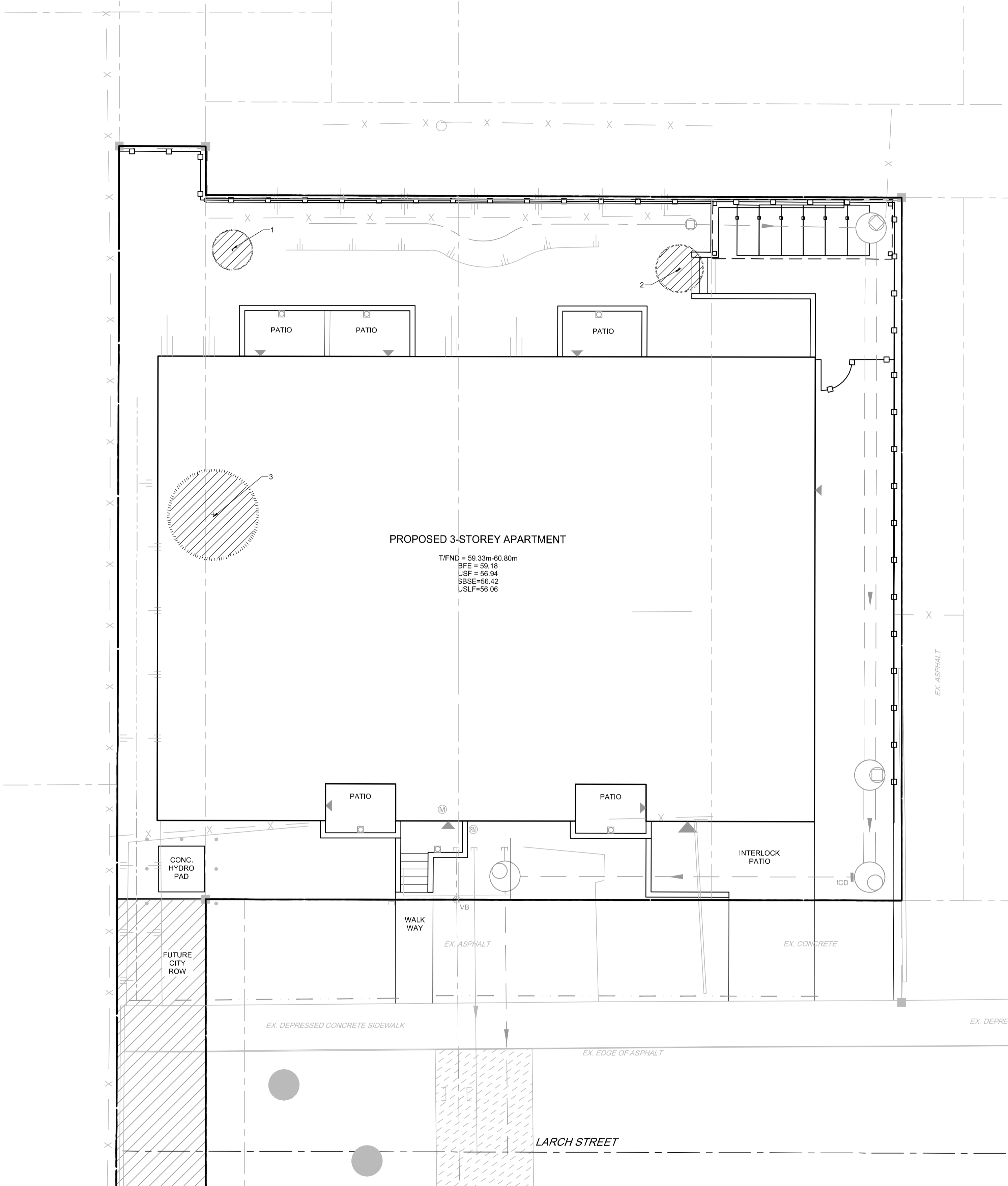
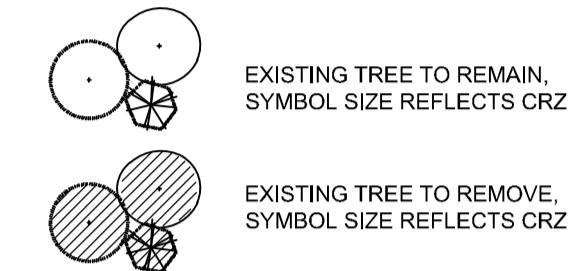

TREE PROTECTION

- Implement the following protection measures for retained trees, both on site and on adjacent sites, prior to any work activity, including tree removal. Maintain tree protection fence in place and in good condition for the duration of site works:
- The Landscape Architect or Certified Arborist is to determine the location of the tree protection fencing and detail it on any associated plans for the site (e.g. tree conservation report, tree disclosure report, etc.).
 - Under the guidance of a Landscape Architect or Certified Arborist, erect a fence at the critical root zone (CRZ) of trees. Diameter at breast height (DBH) is the trunk diameter measured at 1.3m height on the tree trunk. The CRZ is calculated as DBH x 10. Refer to the Tree Protection Fence detail.
 - Refer to the Tree Protection Plan for fence location.
 - Do not place any material or equipment within 2m of the CRZ of any tree, including outhouses.
 - Do not attach any signs, notices, or posters to any tree.
 - Do not disturb, raise, or lower the existing grade within the CRZ without approval.
 - Only tunnel or bore when digging within the CRZ of a tree. Hand work only where required within the CRZ, absolutely no machinery permitted.
 - Do not damage the root system, trunk, or branches, or any tree.
 - Do not extend hard surface or significantly change landscaping.
 - Ensure that exhaust fumes from all equipment are directed away from any tree canopy.
 - When trees marked for removal overlap with the CRZ of trees marked for preservation: cut roots at the edge of the CRZ and grind down stumps after tree removals, do not pull out stumps. Ensure there is not root pulling or disturbance of the ground within the CRZ.
 - Prior to work taking place, notify and consult the Landscape Architect if roots must be cut. Roots 20mm or larger should be cut at right angles with clean, sharp horticultural tools without tearing, crushing, or pulling.
 - If damaged or objectionable branches are observed, consult the Landscape Architect, before any work is conducted. Do not prune leaders. Do not prune more than 1/4 of crown.
 - Set up a water and fertilizing program, if trees are being affected by site works, to the satisfaction of the Landscape Architect.
 - The Landscape Architect is to prescribe mitigation measures if the protected fenced area must be reduced to facilitate construction. Measures may include the placement of plywood, wood chips, or steel plating over the roots for protection.

GENERAL

- Read and interpret this drawing/ drawing set in conjunction with all the contract details and specifications, including related civil, utility, structural, architectural, mechanical, electrical, environmental, geotechnical, and survey information.
- The Contractor is to determine the exact location, size, material, and elevation of all existing utilities prior to commencing construction. Protect and assume responsibility for all existing utilities regardless of being shown on the drawings.
- It is essential to use the plans and details in conjunction with the specifications and notes.
- Do not scale drawings. Work to dimensions only.
- Protect all existing and retained vegetation for the duration of construction according to the contract details and specifications.
- Reinstate all areas and items damaged or disturbed, beyond the Limit of Work, because of construction activities, including but not limited to construction staging areas, haul roads, stockpile areas, etc. to the satisfaction of the Consultant. Unless otherwise noted, Contractor is to reinstate all areas to pre-construction condition or better to the satisfaction of the Contract Administrator.

EXISTING TREE INVENTORY:

No.	Botanical Name	Common Name	DBH (cm)	CRZ (m)	Condition	Remarks	Recomm.
1	Pyrus sp.	Pear Tree	8.0	0.80	F	30cm vertical seam from ground level	Conflict
2	Magnolia sp.	Magnolia Tree	11.0	1.10	G		Conflict
3	Morus alba	Mulberry	18.0	1.80	G		Conflict

Legend

G	Good	Conflict	Remove, due to conflict with construction.
F	Fair	Remove	Remove, due to tree health or invasive status.
P	Poor	PROTECT	Protect as per detail D1 and related notes.
VP	Very Poor		

NOTE:
THE POSITION OF ALL POLE LINES, CONDUITS, WATERMANS, SEWERS AND OTHER UNDERGROUND AND OVERGROUND UTILITIES AND STRUCTURES IS NOT NECESSARILY SHOWN ON THE CONTRACT DRAWINGS, AND WHERE SHOWN, THE ACCURACY OF THE POSITION OF SUCH UTILITIES AND STRUCTURES IS NOT GUARANTEED. BEFORE STARTING WORK, DETERMINE THE EXACT LOCATION OF ALL SUCH UTILITIES AND STRUCTURES AND ASSUME ALL LIABILITY FOR DAMAGE TO THEM.

OWNER INFORMATION
15-19 LARCH ST. INC.
359 KENT STREET, SUITE 503,
OTTAWA, ONTARIO, K2P 0R6
ROBERTO CAMPAGNA
PHONE: (613) 851-7823
roberto@rocahomes.ca

NOT FOR CONSTRUCTION

No.	REVISION	DATE	BY
3.	REVISED PER NEW SITE PLAN	OCT 30/23	RGJ
2.	REVISED PER CITY COMMENTS	SEPT 15/22	RGJ
1.	ISSUED FOR SITE PLAN APPROVAL	FEB 17/22	RGJ

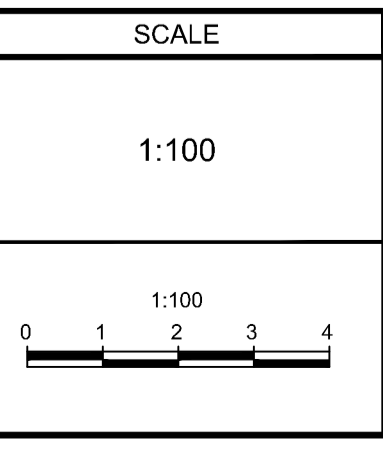

DESIGN	MT
CHECKED	MT
DRAWN	MT
CHECKED	MT
APPROVED	RJ

FOR REVIEW ONLY

NOVATECH
Engineers, Planners & Landscape Architects
Suite 200, 240 Michael Cowpland Drive
Ottawa, Ontario, Canada K2M 1P6
Telephone (613) 254-9643
Facsimile (613) 254-5867
Website www.novatech-eng.com

LOCATION CITY OF OTTAWA 15 LARCH STREET	PROJECT No. 120251
DRAWING NAME TREE CONSERVATION PLAN	REV # 3
DRAWING No. 120251-TCR	PLANTING #18698

M:\2020\120251\CA\01\Landscaping\1-Plan\120251-L_Dwg_TCR_Nov 01_2023 - 2.21pm_karralfov

D07-12-22-0027

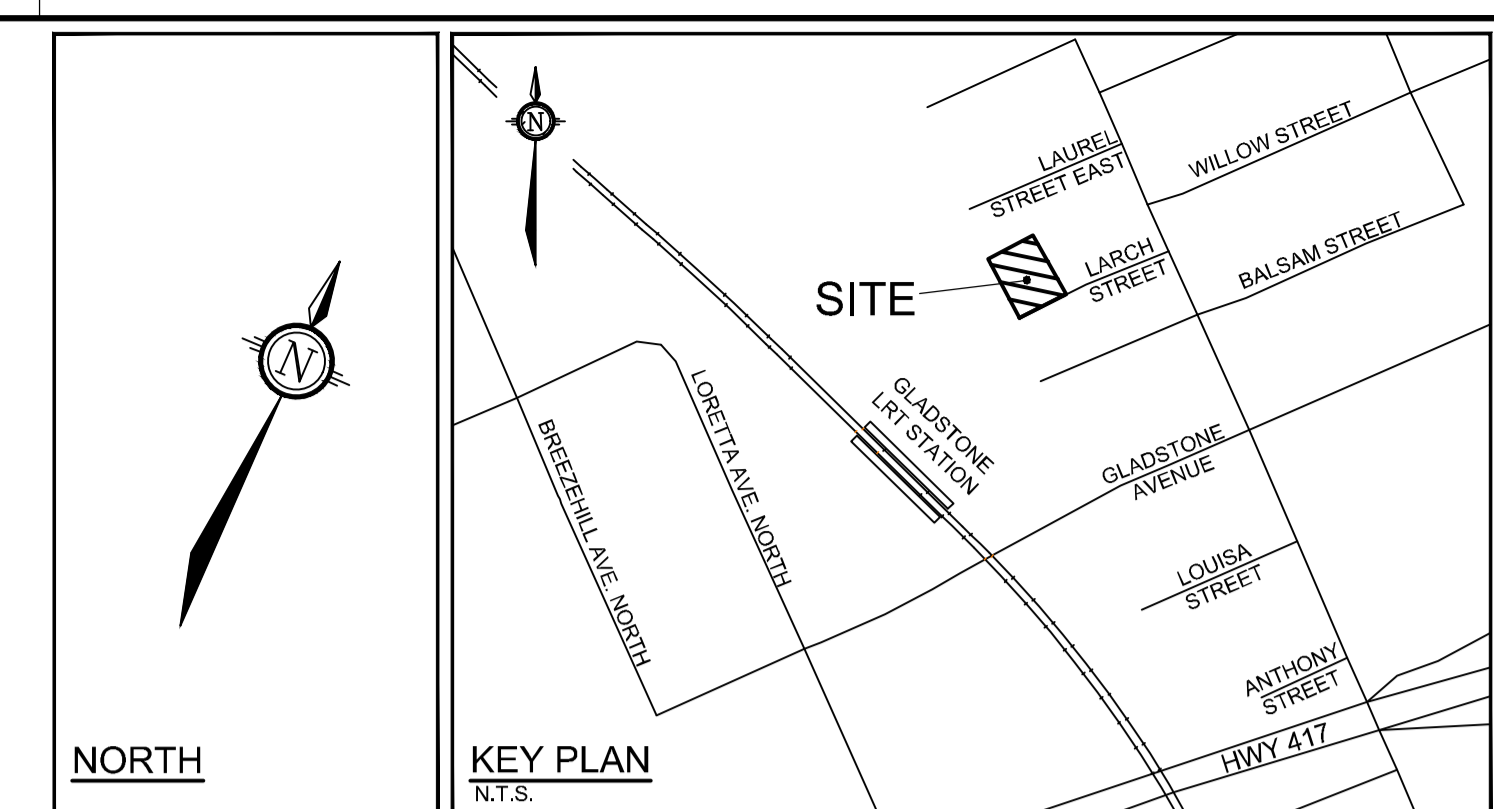
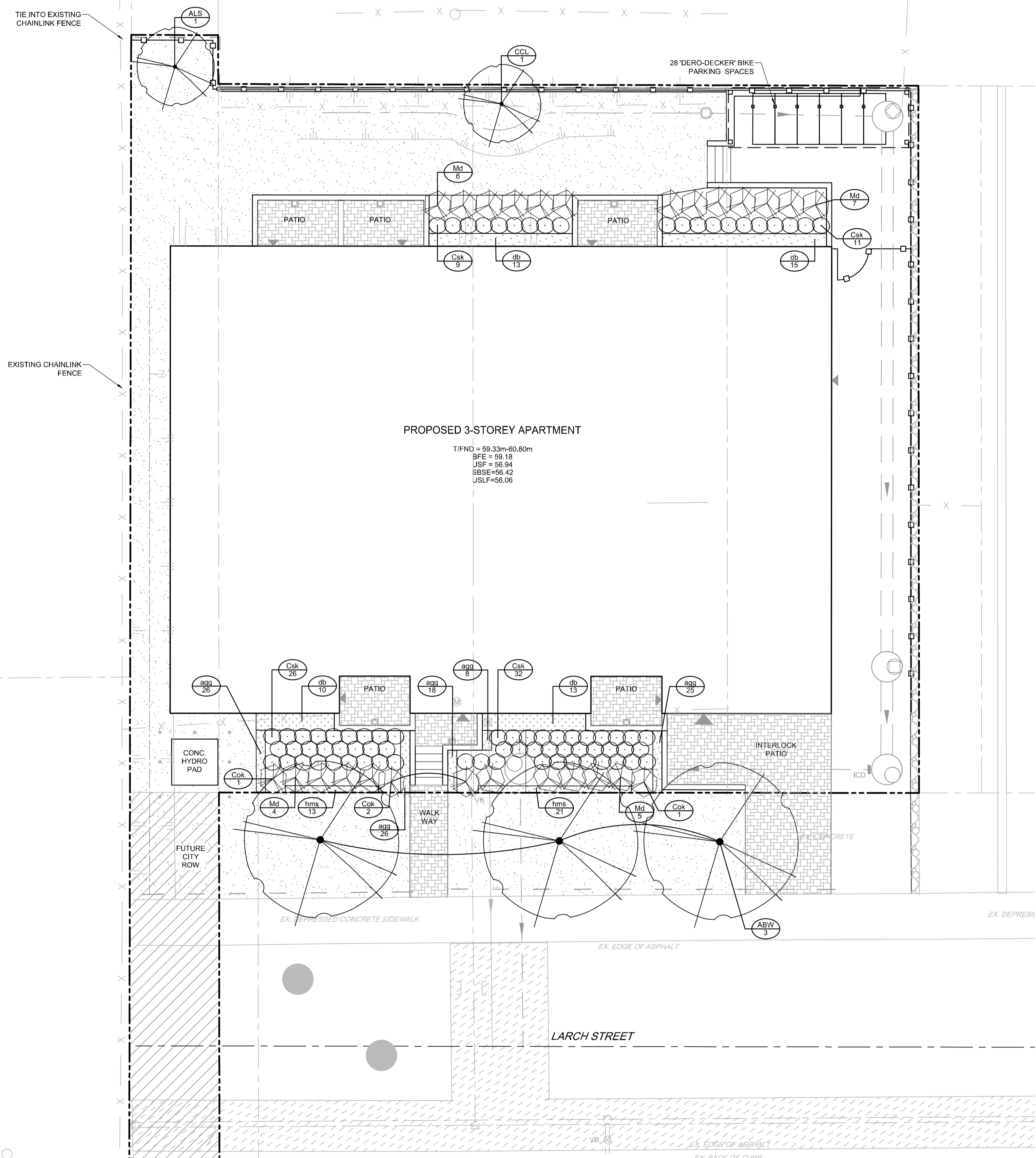

LEGEND

- PROPERTY LIMIT
- [Pattern] PROPOSED PAVERS
- [Pattern] RIVER STONE
- [Pattern] SOD
- [Pattern] PERENNIALS
- [Pattern] ORNAMENTAL GRASSES
- [Symbol] PROPOSED DECIDUOUS TREE
- [Symbol] PROPOSED SHRUBS
- [Symbol] SPECIES (SEE PLANT LIST)
- [Symbol] QUANTITY
- [Symbol] WOODEN FENCE 1.8m HT

- GENERAL**
- Read and interpret this drawing/ drawing set in conjunction with all the contract details and specifications, including related civil, utility, structural, architectural, mechanical, electrical, environmental, geotechnical, and survey information.
 - The Contractor is to determine the exact location, size, material, and elevation of all existing utilities prior to commencing construction. Protect and assume responsibility for all existing utilities regardless of being shown on the drawings.
 - It is essential to use the plans and details in conjunction with the specifications and notes.
 - Do not scale drawings. Work to dimensions only.
 - Protect all existing and retained vegetation for the duration of construction according to the contract details and specifications.
 - Reinstate all areas and items damaged or disturbed, beyond the Limit of Work, because of construction activities, including but not limited to construction staging areas, haul roads, stockpile areas, etc. to the satisfaction of the Consultant. Unless otherwise noted, Contractor is to reinstate all areas to pre-construction condition or better to the satisfaction of the Contract Administrator.
- PLANTING**
- Plant material to be No. 1 Grade and is to comply with Canadian Standards for Nursery Stock (latest edition) published by the Canadian Nursery Landscape Association.
 - Use structurally sound plant material with strong fibrous root system free of disease, defects, and injuries. Use trees with straight trunks, well and characteristically branched for species. Obtain approval from consultant of plant material at source prior to digging. All trees and shrubs to be container grown, potted, W/B or B/B, as indicated on Plant List. Bare root plants are only acceptable for certain species and as approved by the Landscape Architect.
 - Plant material substitutions are not be permitted without the written approval from the Consultant, with 48 hours notice, prior to shipping plant material.
 - Plant locations are schematic / approximate only. Contractor is to stake out locations on site for approval by the Landscape Architect prior to installation.
 - The illustrated number of plants shown in the Planting Plan supersedes the estimated number in the Plant List. Contractor to report any discrepancies to the Landscape Architect prior to installation. Contractor will assume full responsibility if the Landscape Architect is not notified.
 - Ensure trees are thoroughly watered following planting. Monitor material and ensure adequate moisture until acceptance.
 - In heavy clay or poorly drained soils, set root ball with root collar 75-100mm higher than finished grade.
 - Approved topsoil depths are as follows:
 - Plant Beds - 450mm continuous depth. Applies to shrubs, perennials, vines, and groundcovers.
 - Sod/ Seed Areas - 100mm depth.
 - Sod to be No. 1 Kentucky Bluegrass Sod grown from minimum mixture of 3 Kentucky Bluegrass cultivars. Quality and source are to comply with Canadian Standards for Nursery Stock, Section 17, (latest edition) published by the Canadian Nursery Landscape Nursery Landscape Association.
 - Apply the following mineral fertilizer unless soil tests show other requirements:
 - Plant Beds - (8-32-16), i.e. 8% Nitrogen, 32% Phosphorus, 16% Potash per manufacturer specifications.
 - Sod Areas - (8-32-16), i.e. 8% Nitrogen, 32% Phosphorus, 16% Potash at a rate of 350kg/ha.
 - Where applicable, for any plant areas with a mix of species/ cultivars notes. Contractor is to cluster like plants in groups of 3-5 and evenly distribute these in the noted area.

- NOVATECH DETAILS**
- Found on Sheet L2.
- D1. Standard Deciduous Tree Planting
 - D2. Shrub and Perennial Planting
 - D3. Wooden Fence
 - D4. Riverstone

PLANT LIST

KEY	QTY	BOTANICAL NAME	COMMON NAME	SIZE	COND	SPACING
Deciduous Trees						
ABW	3	<i>Acer rubrum</i> 'Brandywine'	Brandywine Red Maple	50mm Cal	WB	As Shown
ALS	1	<i>Amelanchier laevis</i> 'Spring Flurry'	Spring Flurry Serviceberry	50mm Cal	WB	As Shown
CCL	1	<i>Carpinus caroliniana</i>	American Hornbeam Ironwood	50mm Cal	WB	As Shown
Coniferous Shrubs						
Csk	4	<i>Chamaecyparis obtusa</i> 'Koster'	Koster's Hinokie False Cypress	3g	PT	As Shown
Md	22	<i>Microbiota decussata</i>	Siberian Carpet Cypress	2g	PT	As Shown
Deciduous Shrubs						
Csk	78	<i>Cornus sericea</i> 'Kelsey'	Kelsey Dogwood	2g	PT	As Shown
Perennials						
agg	103	<i>Allium giganteum</i> 'Globemaster'	Ornamental Onion	1g	PT	20cm O.C.
hms	34	<i>Hemerocallis</i> 'Mini Stella D'oro'	Mini Stella D'oro Daylily	1g	PT	30cm O.C.
Ornamental Grasses						
db	51	<i>Deschampsia cespitosa</i> 'Bronzeschiele'	Bronze Veil Tufted Hair Grass	1g	PT	50cm O.C.

NOTE:
THE POSITION OF ALL POLE LINES, CONDUITS, WATERMANS, SEWERS AND OTHER UNDERGROUND AND OVERGROUND UTILITIES AND STRUCTURES IS NOT NECESSARILY SHOWN ON THE CONTRACT DRAWINGS, AND WHERE SHOWN, THE ACCURACY OF THE POSITION OF SUCH UTILITIES AND STRUCTURES IS NOT GUARANTEED. BEFORE STARTING WORK, DETERMINE THE EXACT LOCATION OF ALL SUCH UTILITIES AND STRUCTURES AND ASSUME ALL LIABILITY FOR DAMAGE TO THEM.

OWNER INFORMATION
15-19 LARCH ST. INC.
359 KENT STREET, SUITE 503,
OTTAWA, ONTARIO, K2P 0R6
ROBERTO CAMPAGNA
PHONE: (613) 851-7823
roberto@rocahomes.ca

NOT FOR CONSTRUCTION

No.	REVISION	DATE	BY
3.	REVISED PER NEW SITE PLAN	OCT 30/23	RGJ
2.	REVISED PER CITY COMMENTS	SEPT 15/22	RGJ
1.	ISSUED FOR SITE PLAN APPROVAL	FEB 17/22	RGJ

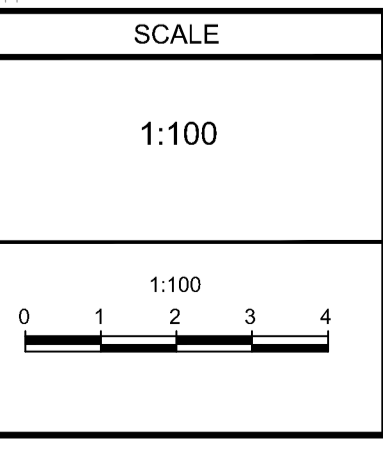

FOR REVIEW ONLY

DESIGN	CHECKED	DRAWN	CHECKED	APPROVED
JMK	RGJ	JMK	RGJ	RGJ

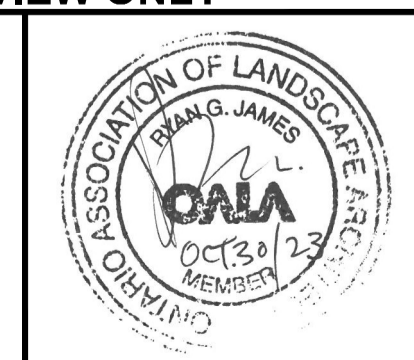

NOVATECH
Engineers, Planners & Landscape Architects
Suite 200, 240 Michael Cowpland Drive
Ottawa, Ontario, Canada K2M 1P6
Telephone (613) 254-9643
Facsimile (613) 254-5867
Website www.novatech-eng.com

LOCATION		PROJECT No.	
CITY OF OTTAWA 15 LARCH STREET		120251	
DRAWING NAME		REV #	
LANDSCAPE PLAN		REV # 3	
DRAWING No.		120251-L1	

M:\2020\120251\CA\LD\Landscapes\LD\Plan\120251-L1.dwg, L1 (Landscape), Nov 01, 2023 - 2:21pm, Karamfilov

D07-12-22-0027 #18698

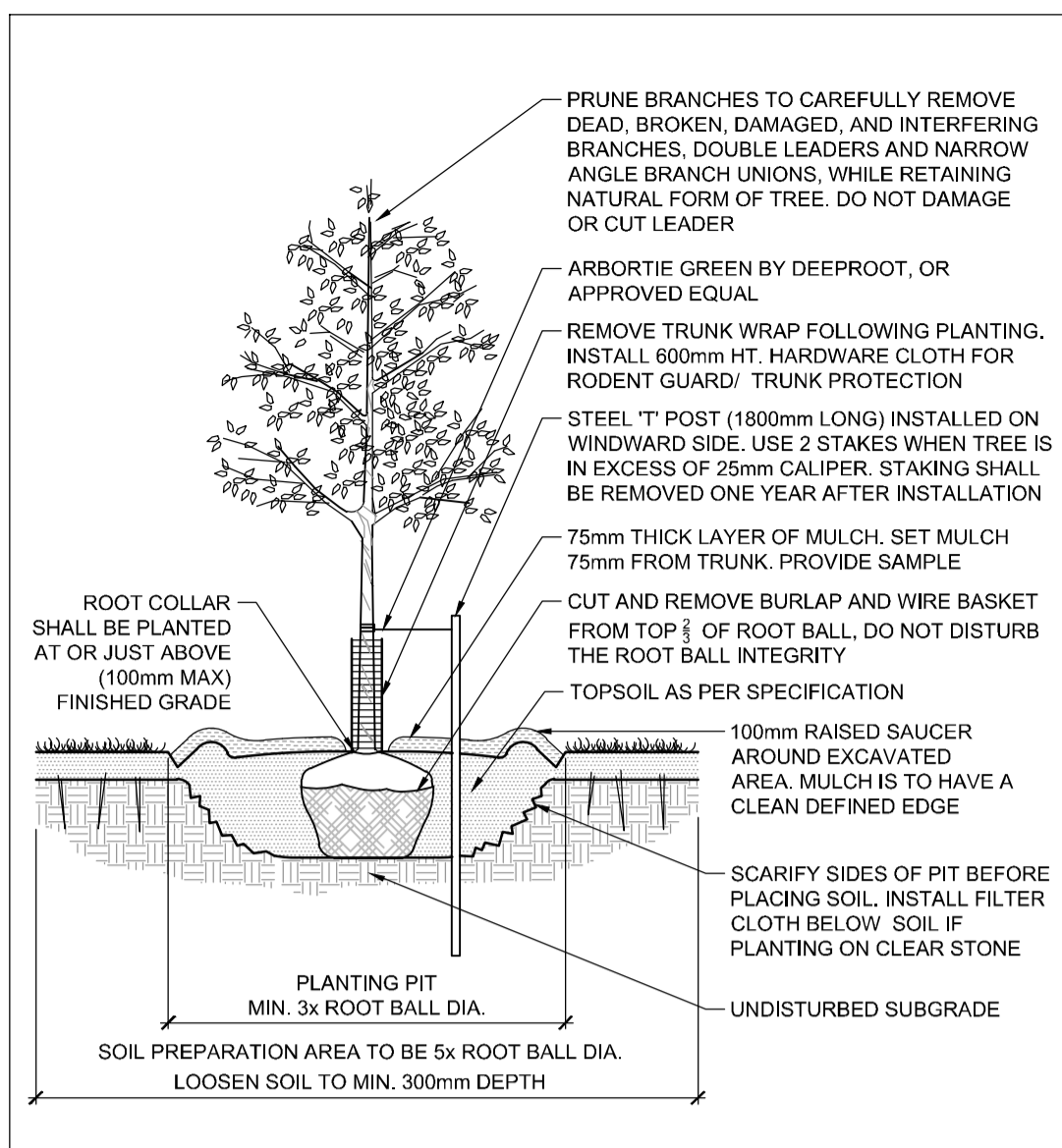

STANDARD DECIDUOUS TREE PLANTING

D1

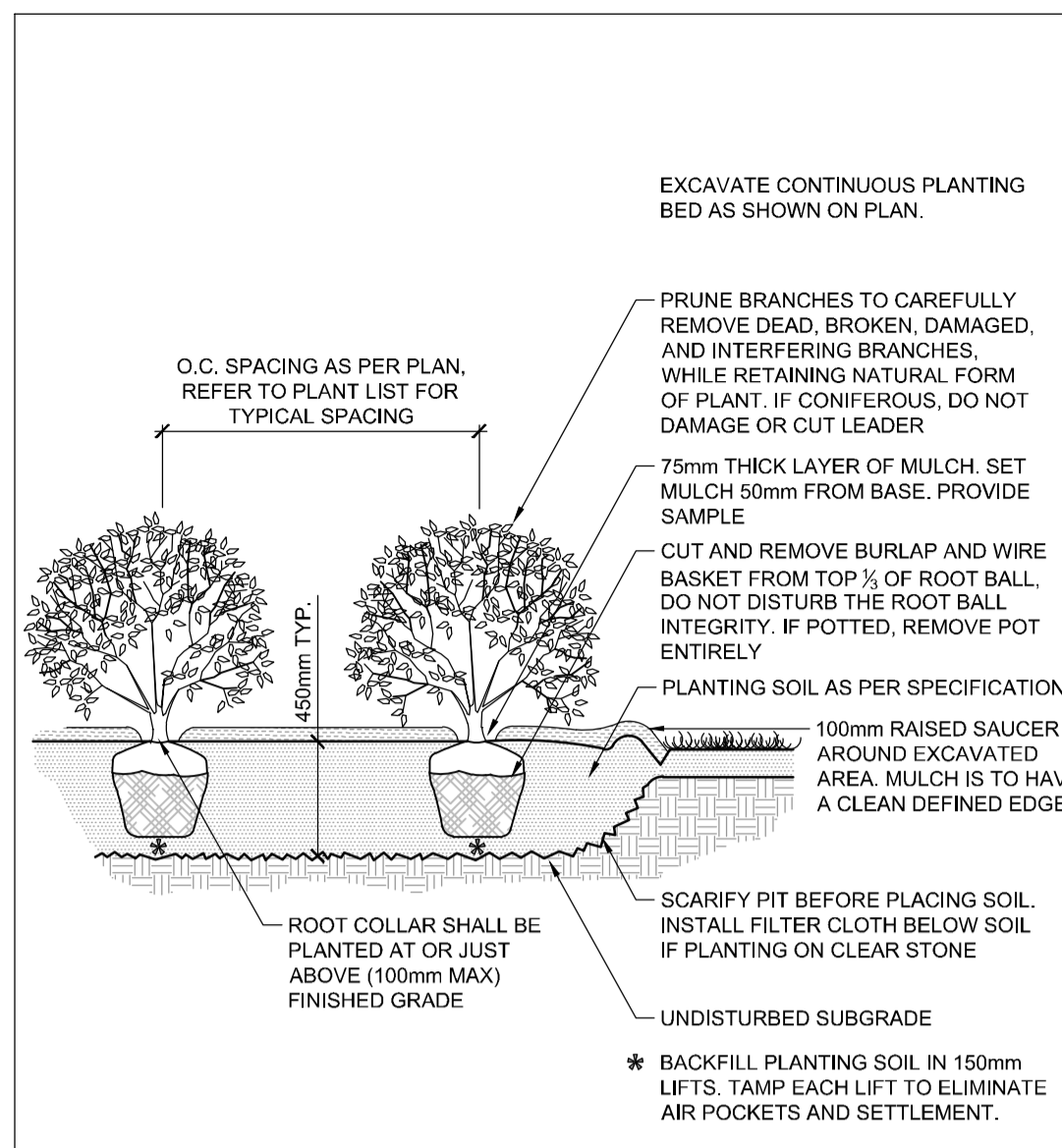

SHRUB AND PERENNIAL PLANTING

D2

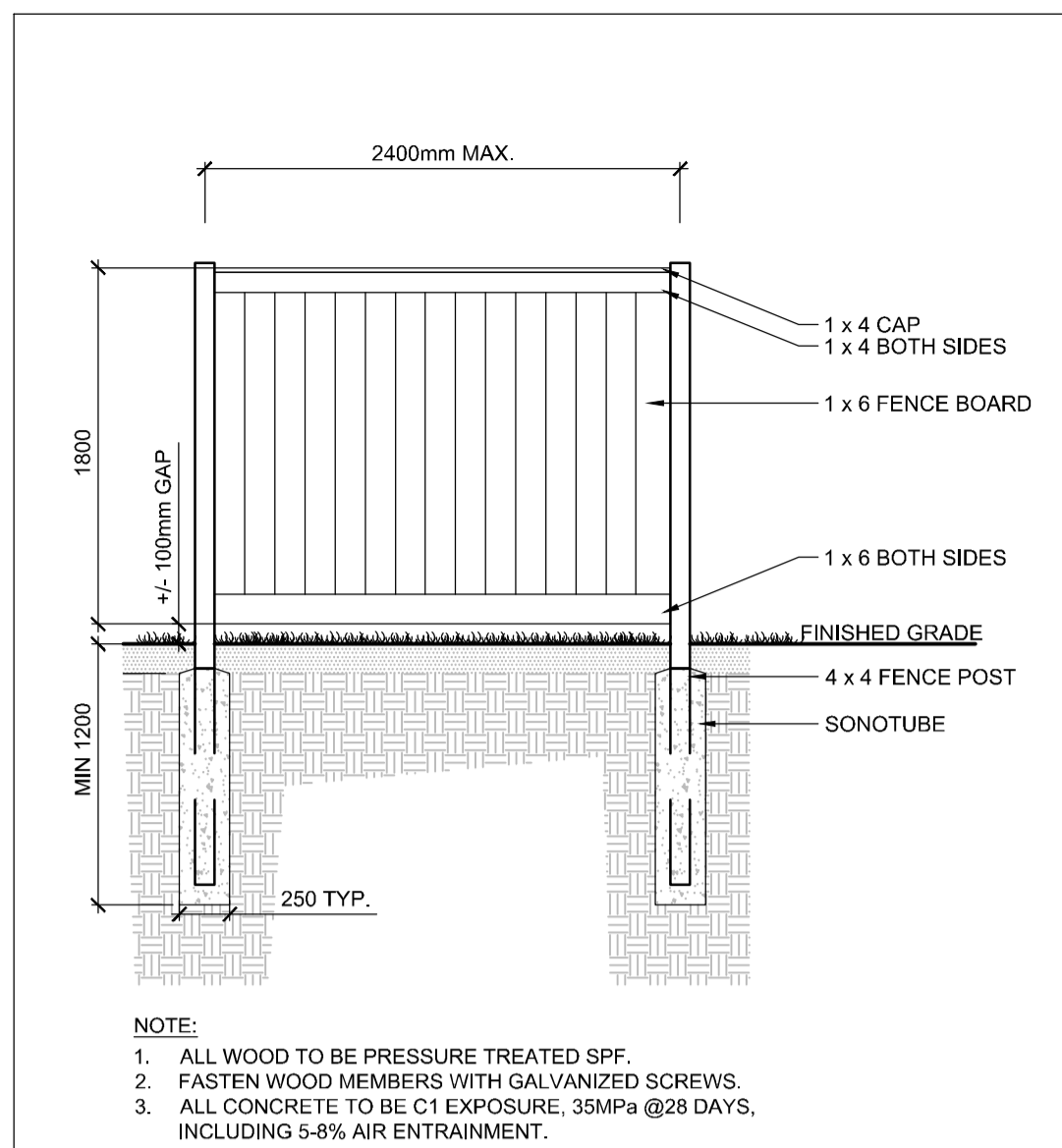

WOODEN FENCE

D3

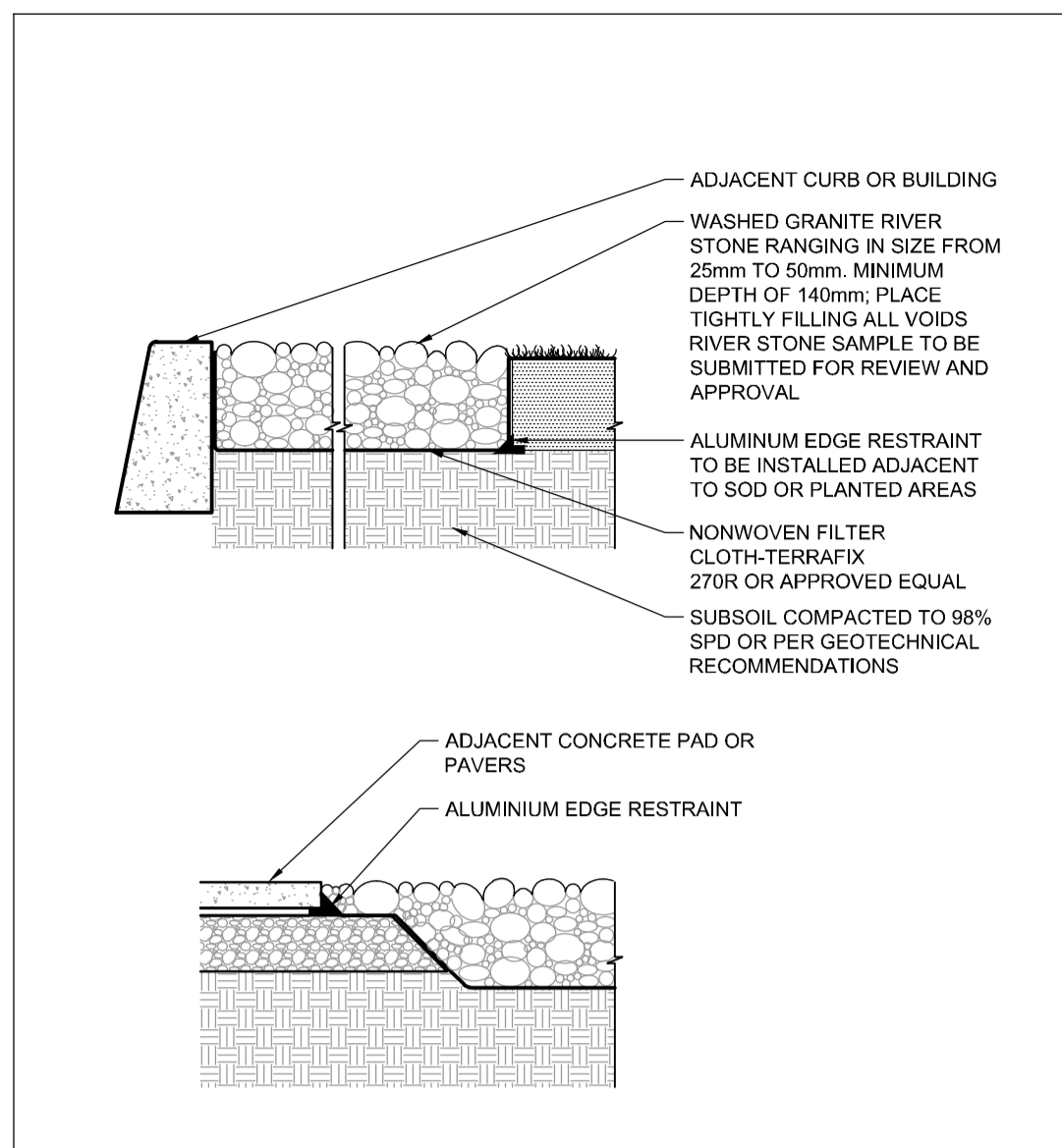

RIVERSTONE

D4

NOTE:
THE POSITION OF ALL POLE LINES, CONDUITS, WATERMANS, SEWERS AND OTHER UNDERGROUND AND OVERGROUND UTILITIES AND STRUCTURES IS NOT NECESSARILY SHOWN ON THE CONTRACT DRAWINGS, AND WHERE SHOWN, THE ACCURACY OF THE POSITION OF SUCH UTILITIES AND STRUCTURES IS NOT GUARANTEED. BEFORE STARTING WORK, DETERMINE THE EXACT LOCATION OF ALL SUCH UTILITIES AND STRUCTURES AND ASSUME ALL LIABILITY FOR DAMAGE TO THEM.

OWNER INFORMATION
15-19 LARCH ST. INC.
359 KENT STREET, SUITE 503,
OTTAWA, ONTARIO, K2P 0R6
ROBERTO CAMPAGNA
PHONE: (613) 851-7823
roberto@rocahomes.ca

NOT FOR CONSTRUCTION

No.	REVISION	DATE	BY
3.	REVISED PER NEW SITE PLAN	OCT 30/23	RGJ
2.	REVISED PER CITY COMMENTS	SEPT 15/22	RGJ
1.	ISSUED FOR SITE PLAN APPROVAL	FEB 17/22	RGJ

SCALE	DESIGN
AS SHOWN	JMK
	CHECKED RGJ
	DRAWN JMK
	CHECKED RGJ
	APPROVED RGJ

FOR REVIEW ONLY

NOVATECH
Engineers, Planners & Landscape Architects
Suite 200, 240 Michael Cowpland Drive
Ottawa, Ontario, Canada K2M 1P6
Telephone (613) 254-9643
Facsimile (613) 254-5867
Website www.novatech-eng.com

LOCATION CITY OF OTTAWA 15 LARCH STREET	PROJECT No. 120251
DRAWING NAME LANDSCAPE DETAILS	REV # 3
	DRAWING No. 120251-L2

M:\2020\120251\CAD\Landscapes\L-Plan\120251-L2.dwg, L2, Nov 01, 2023, 2:21pm, hbarat@ov

D07-12-22-0027