



Copyright Reserved

The Contractor shall verify and be responsible for all dimensions. DO NOT scale the drawing - any errors or omissions shall be reported to Stantec without delay.

Legend

- PROPOSED WATERMAIN
PROPOSED VALVE AND VALVE BOX
PROPOSED VALVE CHAMBER
PROPOSED REDUCER
PROPOSED FIRE HYDRANT
PROPOSED SANITARY SEWER
PROPOSED STORM SEWER
PROPOSED CATCHBASIN
EX/FUT. WATERMAIN
EXISTING/FUTURE VALVE AND VALVE BOX
EXISTING/FUTURE VALVE CHAMBER
EXISTING/FUTURE REDUCER
EXISTING/FUTURE FIRE HYDRANT
EXISTING/FUTURE SANITARY SEWER
EXISTING/FUTURE STORM SEWER
EXISTING/FUTURE CATCHBASIN MANHOLE
EXISTING/FUTURE CATCHBASIN
PROPOSED DEPRESSED CURB LOCATIONS
PROPOSED BARRIER CURB
THERMAL INSULATION ON STORM SEWER WHERE COVER IS LESS THAN 1.5m. THERMAL INSULATION ON WATERMAIN WHERE COVER IS LESS THAN 2.4m AS PER W22.
WATER METER AND REMOTE WATER METER LOCATION
EX. WATER METER AND REMOTE WATER METER LOCATION
ORIGINAL GROUND ELEVATION
PROPOSED ELEVATION
PROPOSED LOT CORNER ELEVATION
EXISTING ELEVATION AT LOT CORNER
FLOW DIRECTION AND GRADE
FINISHED FIRST FLOOR ELEVATION
UNDERSIDE OF FOOTING ELEVATION
ENGINEERED FILL REQUIRED
TERRACING 3:1 SLOPE MAXIMUM (UNLESS OTHERWISE SHOWN)
DIRECTION OF EXISTING OVERLAND FLOW
HEAVY DUTY ASPHALT.

Notes

- 1. WATER SERVICING TO BE SUPPLIED FROM 40 JAMIE AVENUE. REFER TO MECHANICAL AND ARCHITECTURAL DRAWINGS FOR DETAILS.
2. NEW BUILDING TO BE SPRINKLERED. DETAILS TO BE PROVIDED BY MECHANICAL ENGINEER.
3. NEW BUILDING ADDITION TO INCLUDE OIL/GRIFF SEPARATOR INSIDE BUILDING AS PART OF SANITARY PLUMBING PRIOR TO CONNECTING TO SANITARY SEWER SERVICE.
4. FLOOR DRAINS IN SHOP AREA TO BE CONNECTED TO INTERNAL SANITARY PLUMBING.
5. ONLY ROOF AND FOOTING DRAINAGE (IF REQUIRED) TO BE CONNECTED TO STORM SEWER SERVICE.
6. DEPTH OF EX. 300mm D.I. WATERMAIN IN JAMIE AVENUE TAKE FROM AS BUILT PLAN No. N-110 SHEET 2 OF 3 = 6.8m OR 2.1m.
7. CONTRACTOR TO NOTIFY ENGINEER OR CONTRACT ADMINISTRATOR OF ANY DISCREPANCIES NOTED ON PLAN PRIOR TO CONTINUING WITH CONSTRUCTION.
8. EXISTING DRAINAGE PATTERNS ON SITE TO BE MAINTAINED.
9. FOR ELECTRICAL, COMMUNICATIONS AND GAS SERVICING, REFER TO MECHANICAL DRAWINGS.

Revision table with columns for revision number, description, and date.

Permit-Seal table with columns for name, title, and date.

Client/Project

STAR MOTORS

STAR MOTORS BODY SHOP
36-40 JAMIE AVENUE INFILL ADDITION
OTTAWA, ON, CANADA

Title

SITE SERVICING AND GRADING PLAN

Project No. 160401647, Scale 1:200, Drawing No., Sheet, Revision

SSGP-1 3 of 6 0 PLAN # ????

SCHEDULE OF ROOF RELEASE RATES table with columns for drain type, tributary area, and release rate.

SEWER AND WATERMAIN CROSSING TABLE with columns for crossing, STM INV, STM OBV, SAN INV, SAN OBV, WTR TOP, WTR BTM.

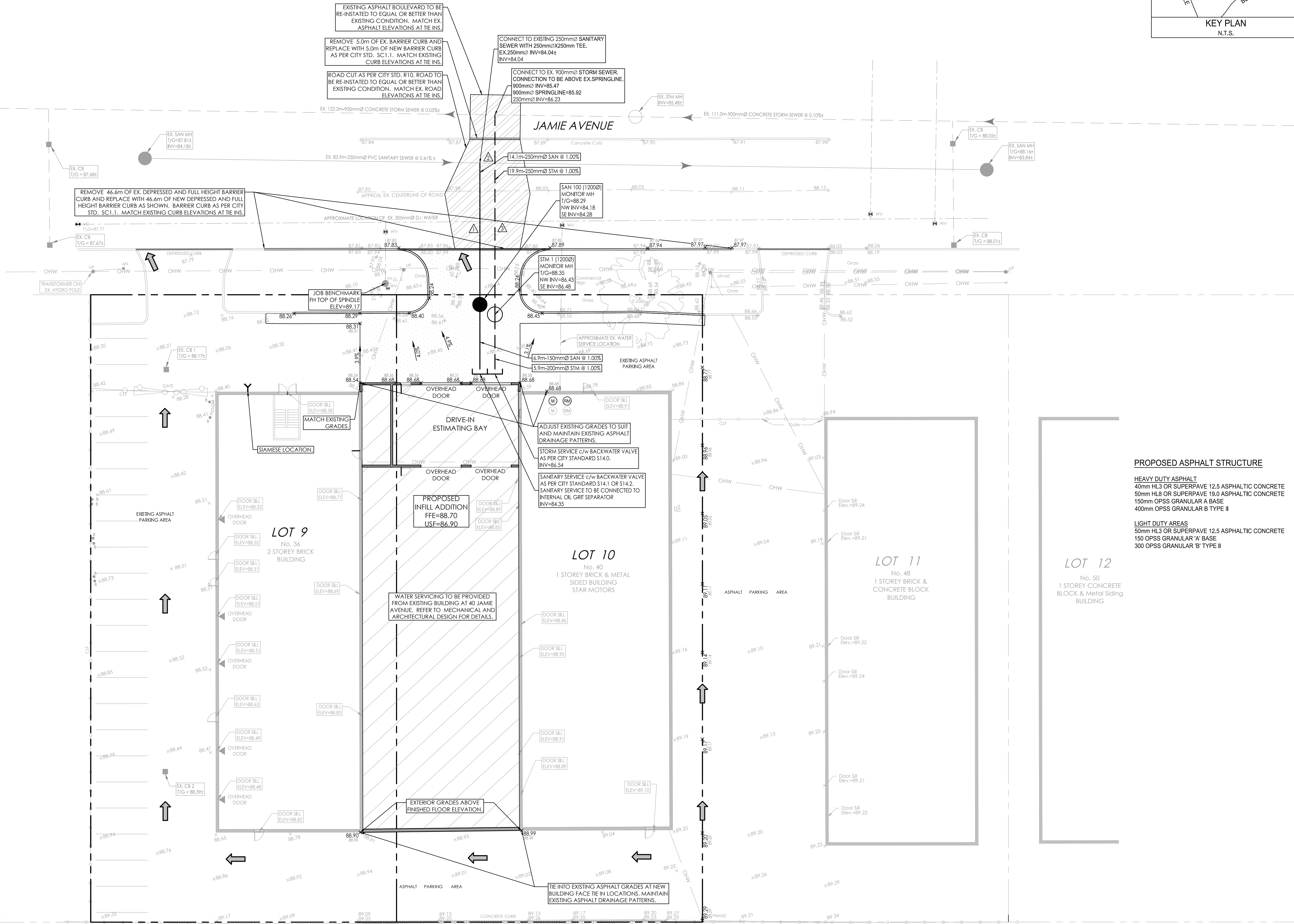

Vertical text on the left margin: 160401647.DWG, 2022/07/13 13:31 PM, 6/3/2022, JUNE