

Drawing Remains the Property of/Copyright Reserved by GJA INC. Do Not Use or Reproduce Without Approval of GJA INC. NOT To Be Used For Construction Unless indicated by Revision: "FOR LANDSCAPE CONSTRUCTION". Contractor is Responsible for Verification of Site Locations of all Utilities. Report any Discrepancies Between Site and Drawing Immediately to GJA INC. Do NOT Proceed Until Clarified.

TURF AREAS TO BE SOD C/W 150MM DEPTH TOPSOIL ON APPROVED SUBGRADE | SOD TO BE #1 GRADE TURFGRASS NURSERY SOD per NSGA - Fine Fescue/Kentucky Bluegrass Sod | PLANTING MIX TO BE APPROVED BY LANDSCAPE ARCHITECT | PLANT MATERIAL TO MEET CNLA STANDARDS/BE APPROVED BY LANDSCAPE ARCHITECT PRIOR TO PLANTING | ALL MATERIALS & WORK TO BE MAINTAINED UNTIL FINAL ACCEPTANCE, (MOWING TURF, WEEDING BEDS, WATERING TURF & PLANTS) & INCLUDE 1 YEAR WARRANTY FROM DATE OF FINAL ACCEPTANCE | PROVIDE WATERING OF ALL PLANT MATERIAL AS REQUIRED FOR PROPER ESTABLISHMENT UNTIL END OF WARRANTY PERIOD | REFER TO CIVIL ENGINEER'S DRAWING FOR ELEVATIONS / GRADING |

The Landscape Plan is to be read in conjunction with the grading, servicing, site and survey plan | Bare root material to be planted in season only | All plant material locations to be staked on site by the landscape contractor and checked by the landscape architect prior to planting | All trees to be protected | Plant material are to be installed a minimum of; 3.0m away from any part of any hydro transformer, 3.0m corridor between a fire hydrant and the curb, a 2.5m radius beside or behind a fire hydrant, 2.0m from any servicing/utility line or structure |

TREES 36-40 JAMIE AVENUE					
Code	Qty.	Botanical Name	Common Name	Size	Condition
AC	3	Amelanchier canadensis	Tree Serviceberry	50mm cal	B + B specimen
AG	3	Aesculus glabra	Ohio Buckeye	60mm cal	B + B specimen
PG	1	Picea glauca	White Spruce	1.5m Ht.	B + B specimen

SHRUBS 36-40 JAMIE AVENUE					
Code	Qty.	Botanical Name	Common Name	Size	Condition
HK	75	Hypericum kalmianum	St. John's Wort	40cm Ht.	Pot

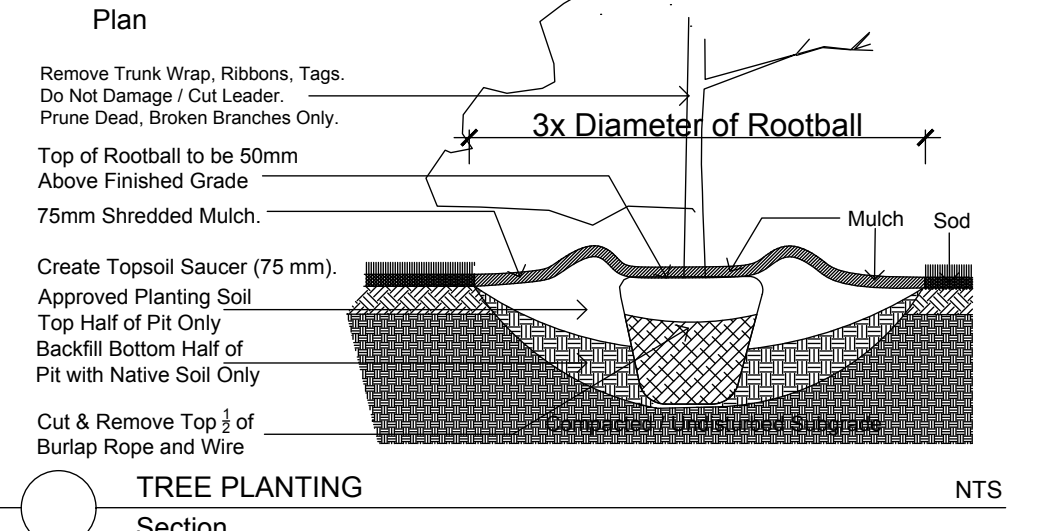
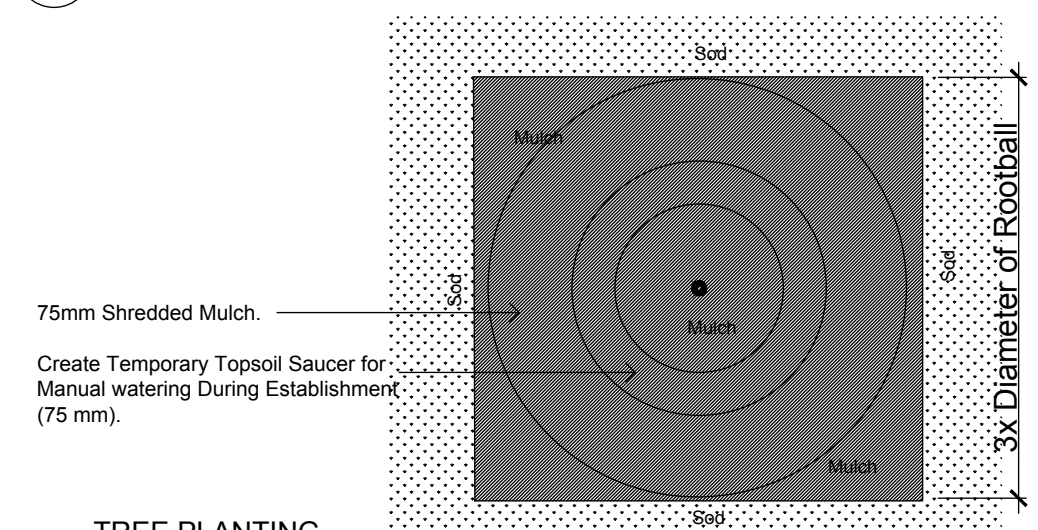
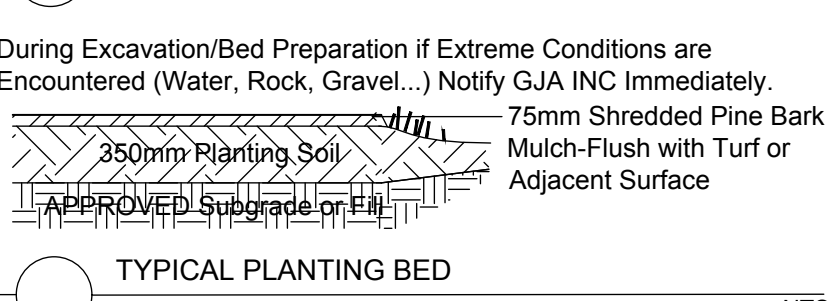
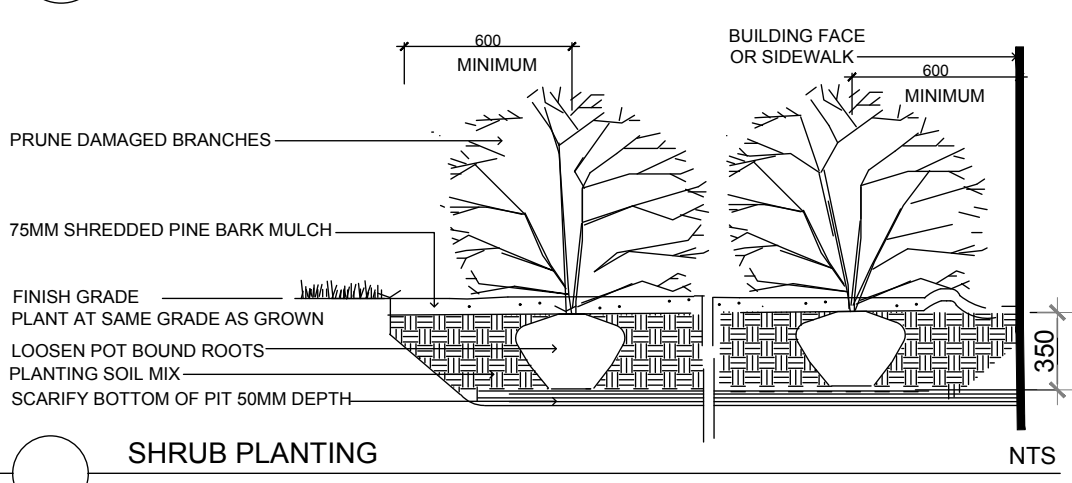
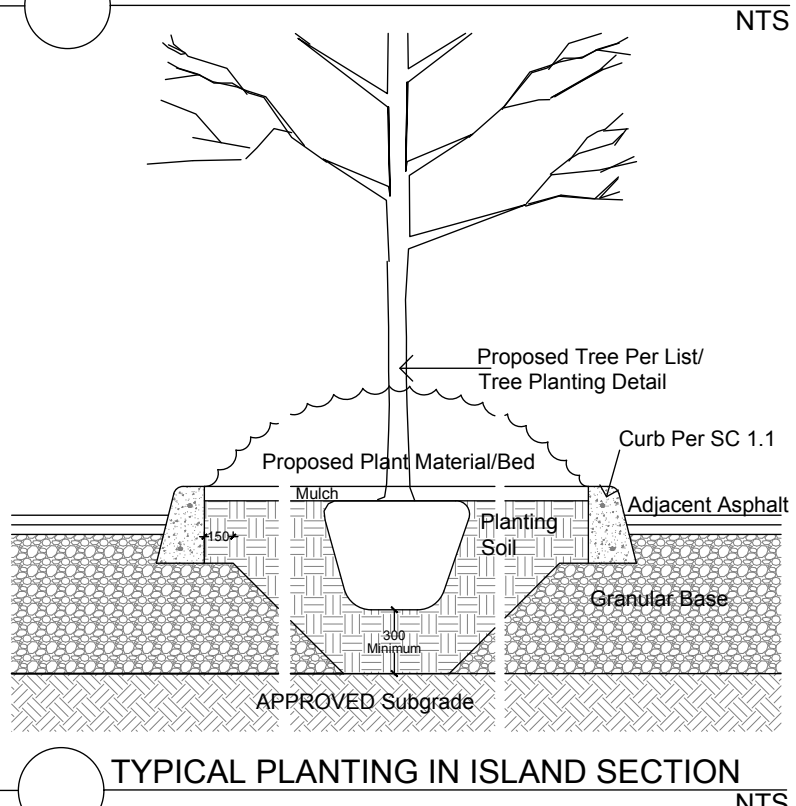
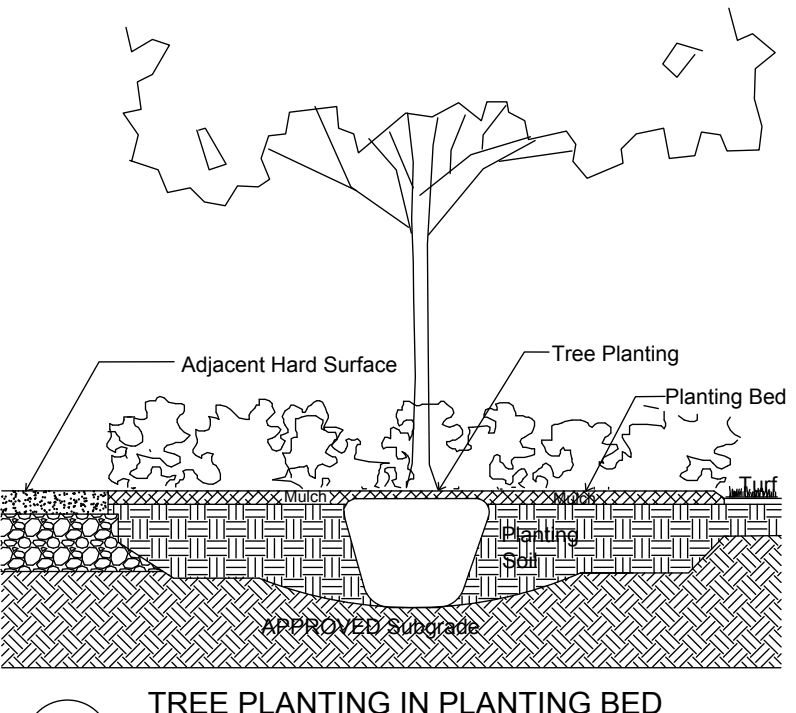
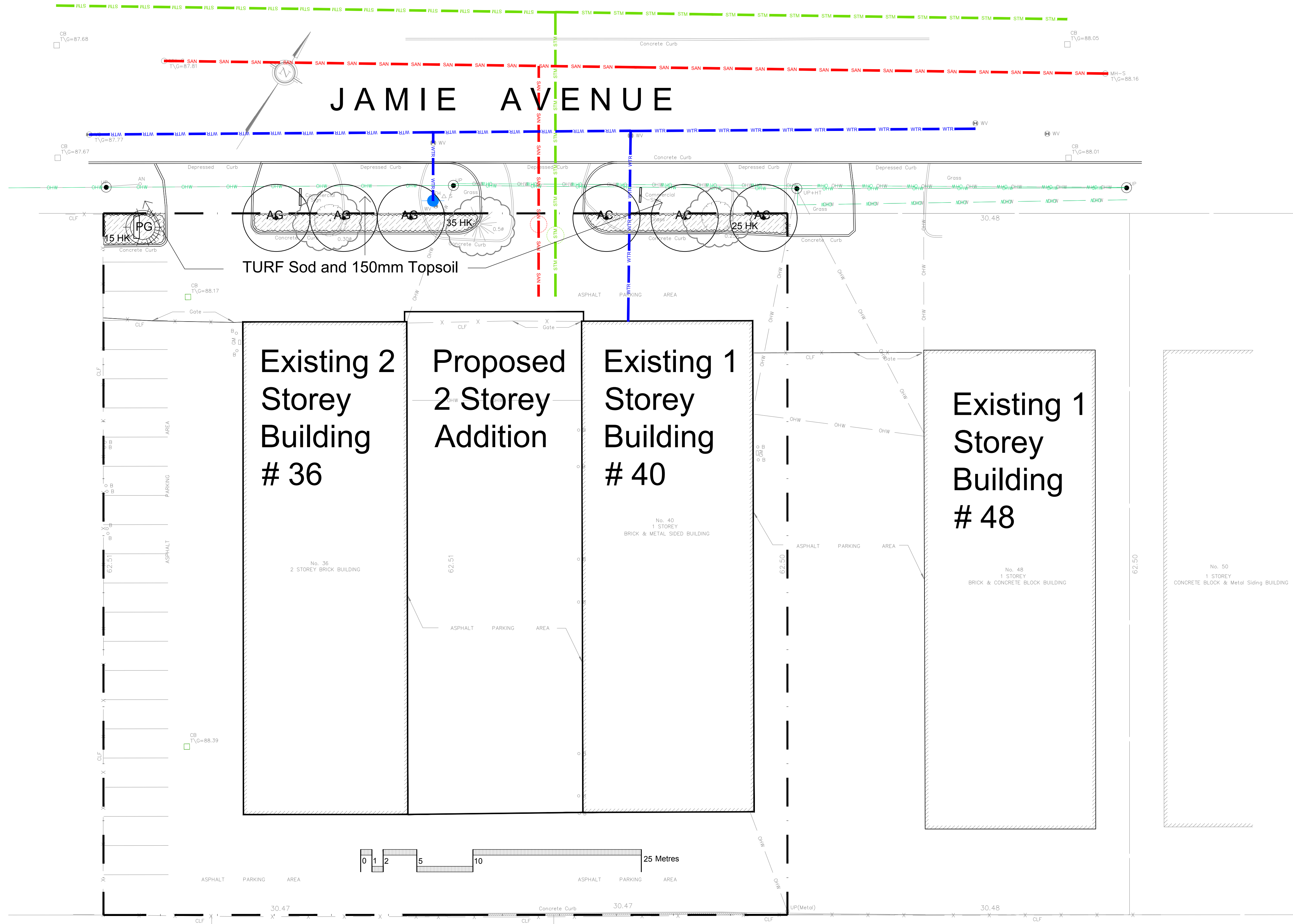

- LANDSCAPE PLAN LEGEND**
- Proposed Coniferous Tree (CT)
 - Proposed Deciduous Tree (DT)
 - Proposed Planting Bed
- BELOW GRADE SERVICES REFER TO CIVIL /CUP**
- U/G Water Service (WTR)
 - U/G Storm Service (STM)
 - U/G Sanitary Service (SAN)
 - O/H Hydro Service (OH)

#	Revision	Date
1	SITE PLAN CONTROL SUBMISSION	FEBRUARY 1 2022
0	REVIEW/COORDINATION	JANUARY 2022

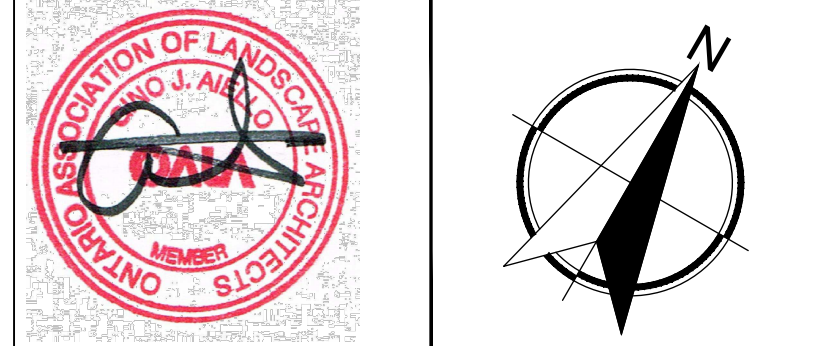

Property Owner
1067005 Ontario Ltd.
c/o Star Motors Ottawa 400 West Hunt Club Road Ottawa, K2E 1B2

Gino J. Aiello | landscape architect GJALA.com
GJA Inc. Gino@GJALA.com (613) 286 5130
110 Dabury Road Unit # 9 | Ottawa Ontario | K2T 0C2

Project
STAR MOTORS BODY SHOP INFILL ADDITION
36-40 JAMIE AVENUE

Landscape Plan
Scale: 1:200 Sheet Number
City of Ottawa Dwg - ##### **L1** D07