



Copyright Reserved

The Contractor shall verify and be responsible for all dimensions. DO NOT scale the drawing - any errors or omissions shall be reported to Stantec without delay.
The Copyrights to all designs and drawings are the property of Stantec. Reproduction or use for any purpose other than that authorized by Stantec is forbidden.

Legend

- C100A** SANITARY DRAINAGE AREA ID#
- 0.31 COM** COMMERCIAL FLOW RATE OF 28000L/haj/day APPLIED
- SANITARY DRAINAGE AREA ha.
- G100A** SANITARY DRAINAGE AREA ID#
- 0.11 INFL** INFILTRATION RATE OF 0.28 L/s/ha APPLIED
- SANITARY DRAINAGE AREA ha.
- SANITARY DRAINAGE AREA
- PROPOSED SANITARY SEWER
- EXISTING SANITARY SEWER

Notes

Revision	By	Appd.	YY.MM.DD
0	MJS	KK	22.02.11

Permit-Seal

Client/Project
STAR MOTORS

STAR MOTORS BODY SHOP
36-40 JAMIE AVENUE INFILL ADDITION
OTTAWA, ON, CANADA

Title
SANITARY DRAINAGE AREA PLAN

Project No. 160401647
Drawing No. Sheet 6 of 6
Scale 1:200
Revision 0

SA-1 PLAN # ?????

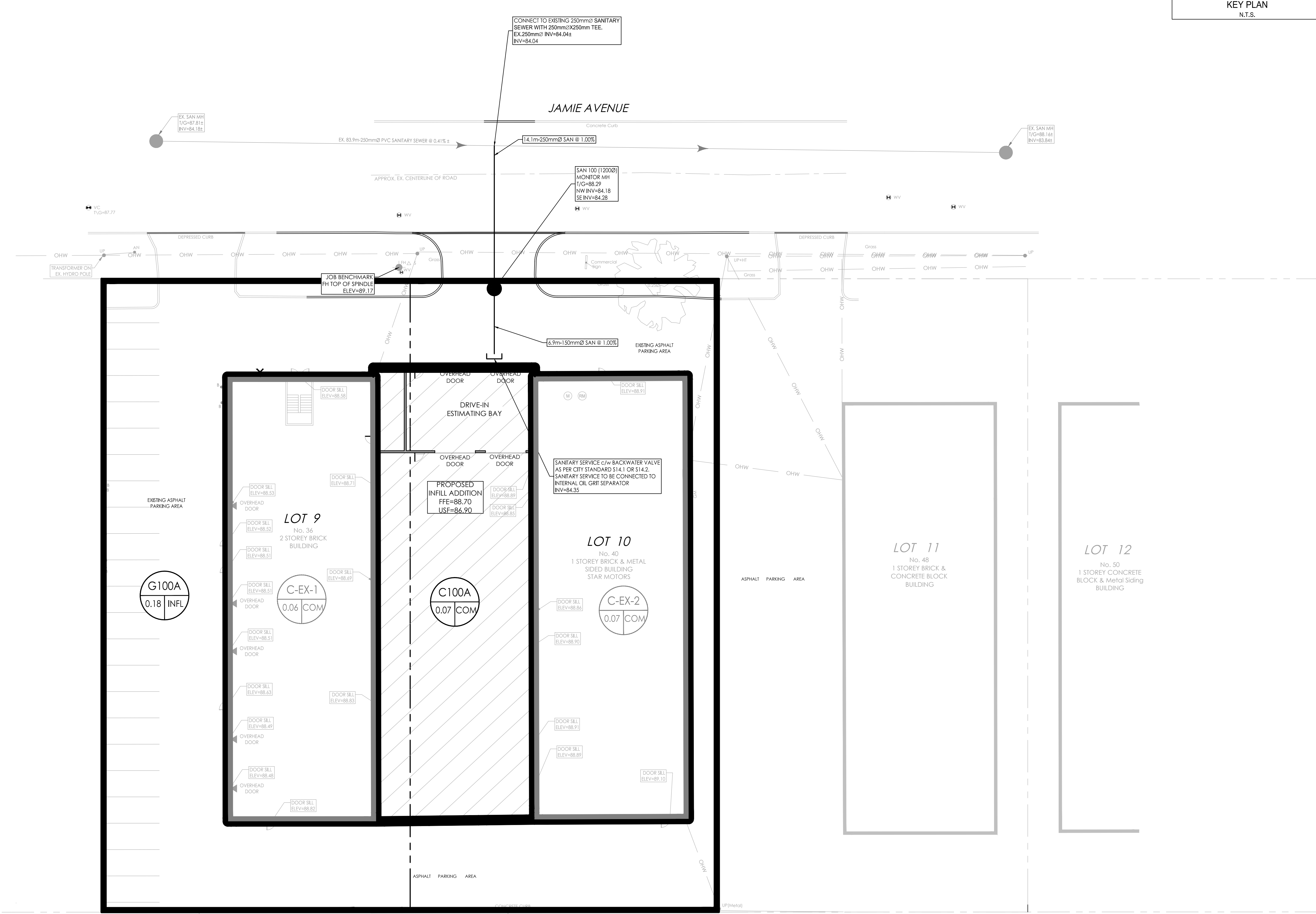

\\s1\apps\stc\160401647\design\drawing\160401647 DB.dwg
2022/02/11 10:51:41 AM 6/25/2022 JMS