

LOT 5 (East Dalhousie Street) REGISTERED PLAN 3 CITY OF OTTAWA

FARLEY, SMITH & DENIS SURVEYING LTD. 2020

Scale 1: 150

Metric Note Distances and coordinates on this plan are in metres and can be converted to feet by dividing by 0.3048.

Distance Note Distances shown on this plan are ground distances and can be converted to grid distances by multiplying by the combined scale factor of 0.99994.

Bearing Note Bearings are grid, derived from the easterly limit of Dalhousie Street having a bearing of N 30° 39' 30" W as shown on a plan by (AOC) dated October 1, 2018 and are referred to the Central Meridian of NAD 83 (Original).

For bearing comparisons, a rotation of 0°39'15" counter-clockwise was applied to bearings on P2 & P5.

Elevation Notes 1. Elevations shown are geodetic and are referred to Geodetic Datum CGVD-1928-1978. 2. It is the responsibility of the user of this information to verify that the job benchmark has not been altered or disturbed and that its relative elevation and description agrees with the information shown on this drawing.

Utility Notes 1. This drawing cannot be accepted as acknowledging all of the utilities and it will be the responsibility of the user to contact the respective utility authorities for confirmation. 2. Only visible surface utilities were located. 3. Underground utility data derived from City of Ottawa utility sheet reference: C-13-08, C-13-12 & 2679p&p1. 4. Sanitary and storm sewer grades and inverts were compiled from: City of Ottawa Plans. 5. A field location of underground plant by the pertinent utility authority is mandatory before any work involving breaking ground, probing, excavating etc.

Notes & Legend table listing symbols for Survey Monument Planted, Standard Iron Bar, Iron Bar, Round Iron Bar, Concrete Pin, Witness, Measured, Registered Plan 3, Plan SR-4494, Plan 4R-7911, Plan 4R-21500, Plan 4R-18070, Plan by (AOC) dated October 1, 2018 (Job No. 18673-18), Plan by (1692) dated January 4, 2019, Maintenance Hole (Sanitary), Maintenance Hole (Bell), Maintenance Hole (Hydro), Underground Storm Sewer, Underground Sanitary Sewer, Underground Water, Underground Power, Underground Gas, Underground Bell, Underground Traffic, Overhead Wires, Utility Pole, Anchor, Light Standard, Catch Basin, Fire Hydrant, Water Valve, Water Stand Post, Gas Meter, Bell Terminal Box, Cable Terminal Box, Sign, Diameter, Chain Link Fence, Board Fence, Invert, Invert Obtained per City of Ottawa Utility Plans, Top of Grate, Wood Post, Foundation, Underside of Eave, Top of Foundation, Centreline, Location of Elevations, Top of Concrete Curb Elevation, Property Line, Coniferous Tree.

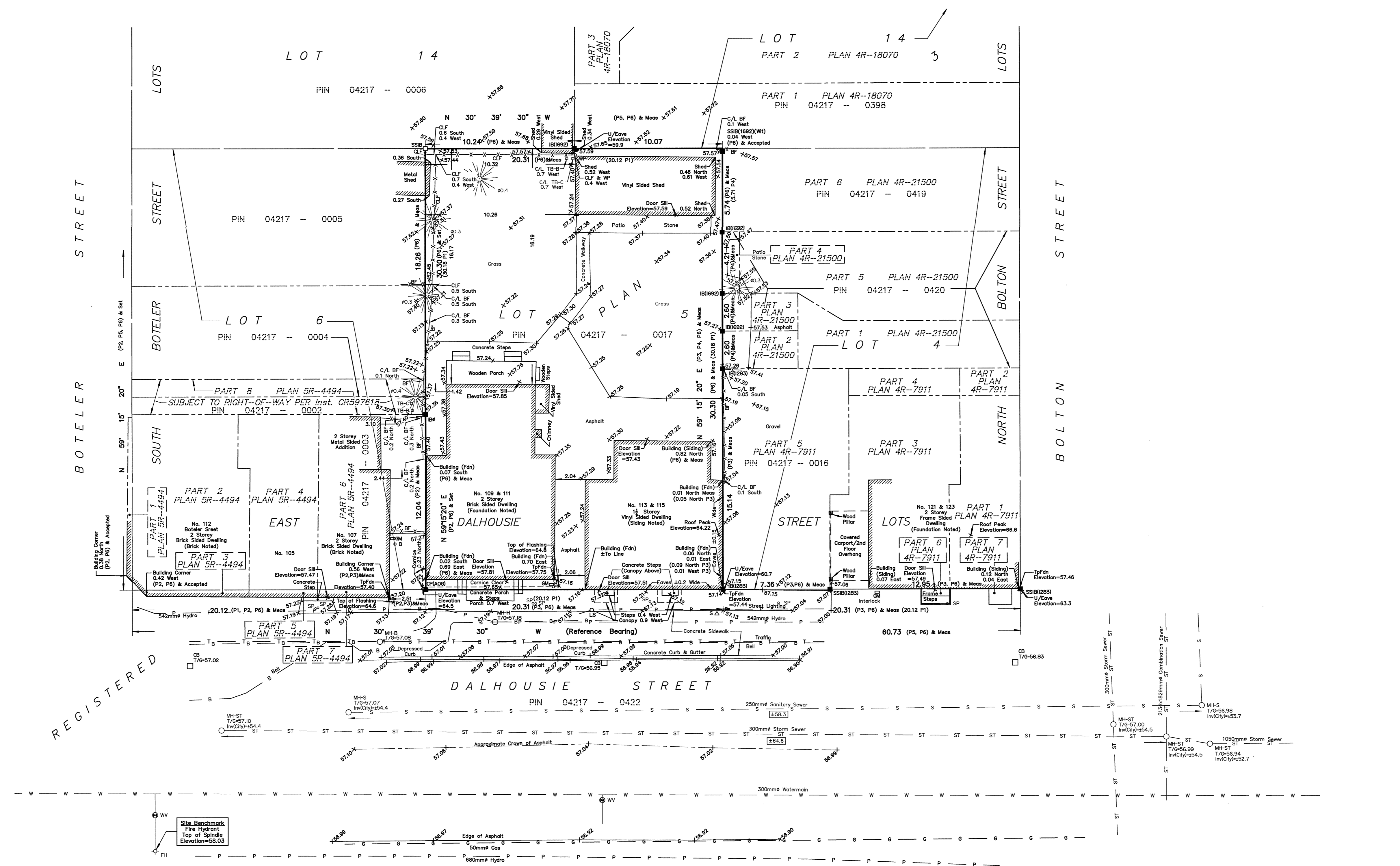

REGISTERED

WARNING NO PERSON MAY COPY, REPRODUCE, DISTRIBUTE OR ALTER THIS PLAN IN WHOLE OR IN PART WITHOUT THE WRITTEN PERMISSION OF FARLEY, SMITH & DENIS SURVEYING LTD. © FARLEY, SMITH & DENIS SURVEYING LTD., 2020.

Surveyor's Certificate section containing a declaration of accuracy, date (Sept. 28, 2020), and signature of Daniel Robinson, Ontario Land Surveyor.

FARLEY, SMITH & DENIS SURVEYING LTD.

190 COLONNADE ROAD, OTTAWA, ONTARIO K2E 7J5 TEL. (613) 727-8226 FAX. (613) 727-1826