

REVISIONS		
no.	description	date
2	VERIFIED METRIC DIMENSION	NOV8,2021
1	SUBMIT FOR PERMIT	JUNE 04, 21

NOTES:

ELEVATOR SHAFT SPECS TO BE CO
ORDINATED WITH ELEVATOR SUPPLIER AS
WELL AS ELEVATOR MECHANICAL ROOM

ALL PENETRATIONS IN FIRE SEPARATION SHALL BE
SEALED WITH FIRE RATED CAULKING

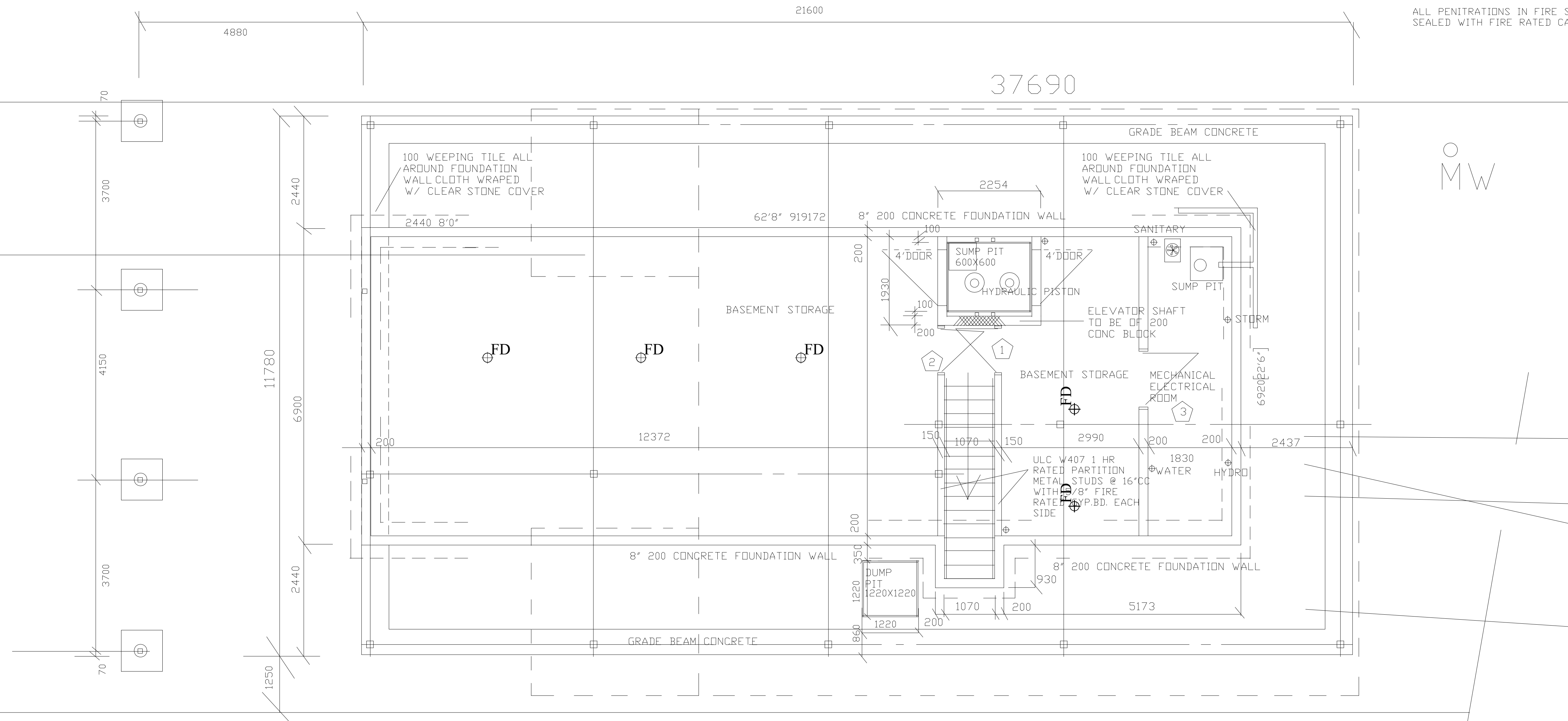

35360 BASEMENT FOUNDATION PLAN

SEE
STRUCTURAL
ENGINEERS
PLANS FOR
DETAILS
AND SPECS.

These plans remain the property of the designer and may be used only for the purpose for which they were issued; contractors shall check and verify all dimensions on the job site and report any errors or omissions to the designer before work continues or the contractor will be held responsible. Each contractor shall be responsible to ensure that the work is in accordance with the building code. The designer is not responsible for any errors or omissions if work commences before building permit is issued.

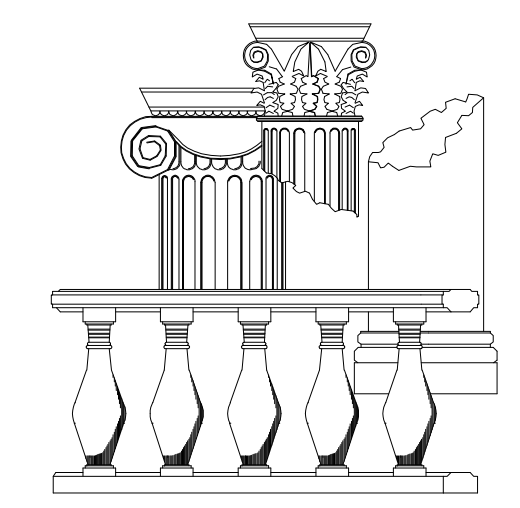

ewald zieger
design consultant
200 scotland pvt. blackburn hamlet
k1b 1e2
613 798 6958 ezjr8000@gmail.com

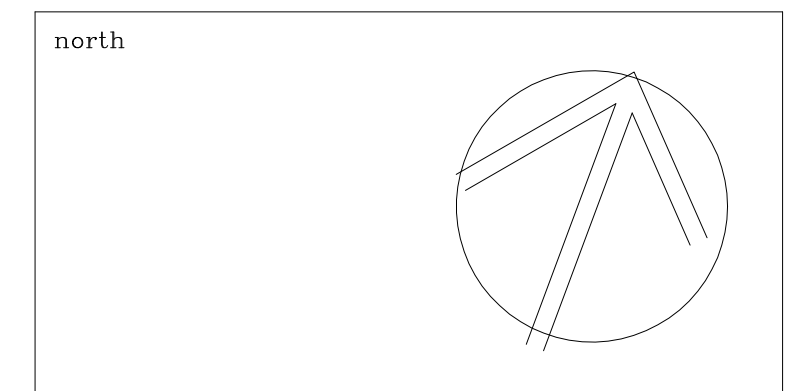

M Janczarski
P.ENG DESIGN
ark
CoA # 10005624ZIN # 3255
30 SAI CRT. OTTAWA ON. K1G 5N6
Tel: (613) 799 4962 Fax: (613) 888 2697 Egers.com

The undersigned has reviewed and taken responsibility for this design, and has the qualifications and meets the requirements set out in the Ontario Building Code.

Max Janczarski, P. Eng. [Signature]
Max Janczarski, P. Eng. [Signature]

title
PROPOSED NEW BUILDING
DUNROBIN DISTILLERIES LTD
1498 STITTSVILLE MAINSTREET

BASEMENT PARTITION PLAN

date	FEBRUARY 2021	R2
scale	1 : 50	
designer	MJ	
co ordinator		job no.
drawn by	ez.jr. b.arch.	dwg.no.
approved	date	A3
Not for construction until signed by client.		