

**LEGEND**

FFL	FINISHED FLOOR ELEVATION
USF	UNDERSIDE OF FOOTING
---	PROPERTY LINE
SAN	SANITARY SEWER
WS/WM	WATER SERVICE/WATERMAIN
+99.99	EXISTING GRADE ELEVATION
+99.99	PROPOSED GRADE ELEVATION
2%	PROPOSED SLOPE OF GRADE
---	CENTERLINE OF SWALE
---	SILT FENCE BARRIER
---	ASPHALT PAVEMENT
---	GRANULAR PAVEMENT
---	LANDSCAPE

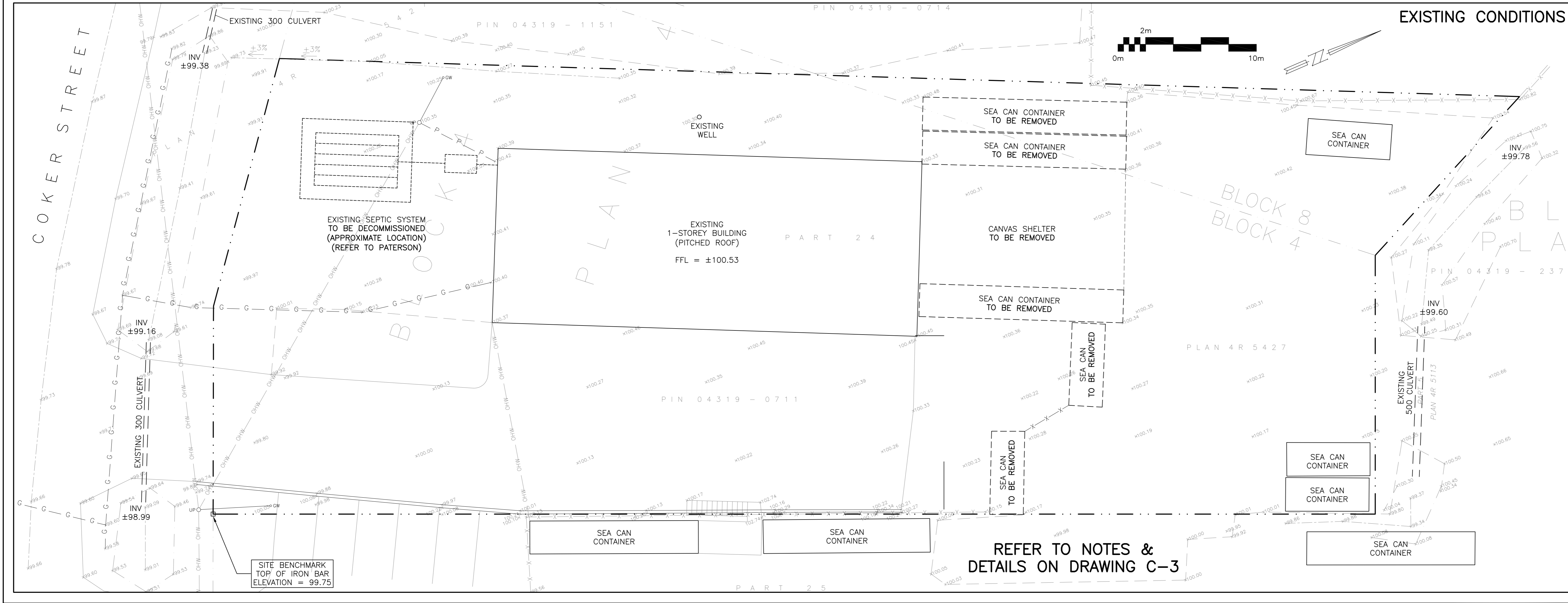
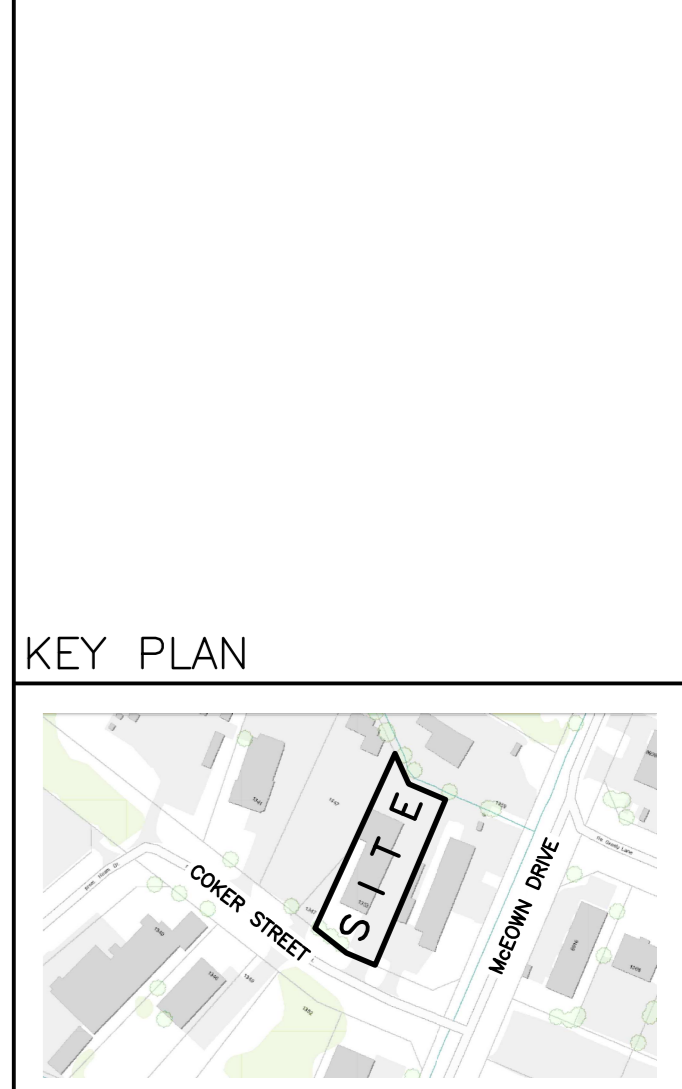

No.	DATE	REVISION
2	MAR 7-22	ISSUED FOR APPROVAL
1	FEB 15-22	ISSUED FOR COORDINATION

**D. B. GRAY ENGINEERING INC.**  
*Stormwater Management - Grading & Drainage - Storm & Sanitary Sewers - Watermain*  
 700 Long Point Circle 613-425-8044  
 Ottawa, Ontario d.gray@dbgrayengineering.com

Project  
**PROPOSED 1-STOREY WAREHOUSE**  
**1353 COKER STREET**  
 OTTAWA, ONTARIO

Drawing Title  
**SITE SERVICING PLAN AND EXISTING CONDITIONS**

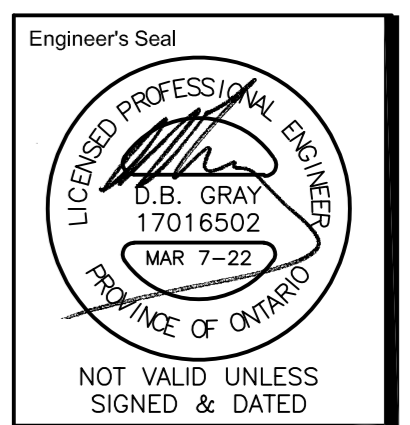

Drawn D.B.G.  
 H. Scale 1:150  
 V. Scale  
 Date FEB 15-22  
 Job No. 20127

Drawing No.  
**C-1**  
 of 4