

Drawing Remains the Property of/Copyright Reserved by Gino J. Aiello Landscape Architect. Do Not Use or Reproduce Without Approval of Gino J. Aiello. **NOT To Be Used For Construction Unless** indicated by Revision: **"FOR LANDSCAPE CONSTRUCTION"**. **Contractor is Responsible** for Verification of Site Locations of all Utilities. Report any Discrepancies Between Site and Drawing Immediately to Gino J. Aiello. Do NOT Proceed Until Clarified.

TURF AREAS TO BE SOD C/W 150MM DEPTH TOPSOIL ON APPROVED SUBGRADE | SOD TO BE #1 GRADE TURFGRASS NURSERY SOD per NSGA - Fine Fescue/Kentucky Bluegrass Sod | PLANTING MIX TO BE APPROVED BY LANDSCAPE ARCHITECT | PLANT MATERIAL TO MEET CNLA STANDARDS/BE APPROVED BY LANDSCAPE ARCHITECT PRIOR TO PLANTING | ALL MATERIALS & WORK TO BE MAINTAINED UNTIL FINAL ACCEPTANCE. (MOWING TURF, WEEDING BEDS, WATERING TURF & PLANTS) & INCLUDE 1 YEAR WARRANTY FROM DATE OF FINAL ACCEPTANCE | PROVIDE WATERING OF ALL PLANT MATERIAL AS REQUIRED FOR PROPER ESTABLISHMENT, UNTIL END OF WARRANTY PERIOD | REFER TO CIVIL ENGINEER'S DRAWING FOR ELEVATIONS / GRADING |

The Landscape Plan is to be read in conjunction with the grading, servicing, site and survey plan | Bare root material to be planted in season only | All plant material locations to be staked on site by the landscape contractor and checked by the landscape architect prior to planting | All trees to be preserved on or directly adjacent to the site will be protected | Plant material are to be installed a minimum of, 3.0m away from any part of any hydro transformer, 3.0m corridor between a fire hydrant and the curb, a 2.5m radius beside or behind a fire hydrant, 2.0m from any servicing/utility line or structure |

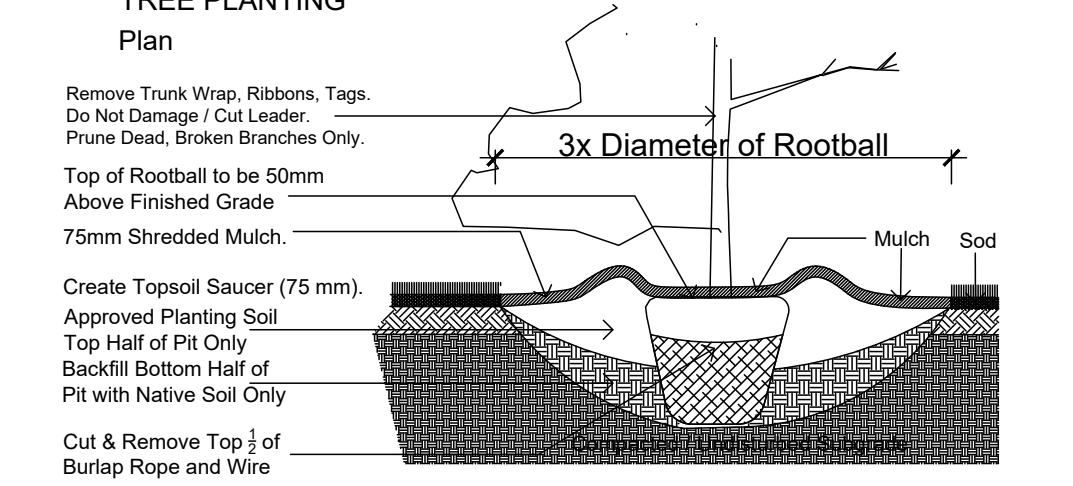
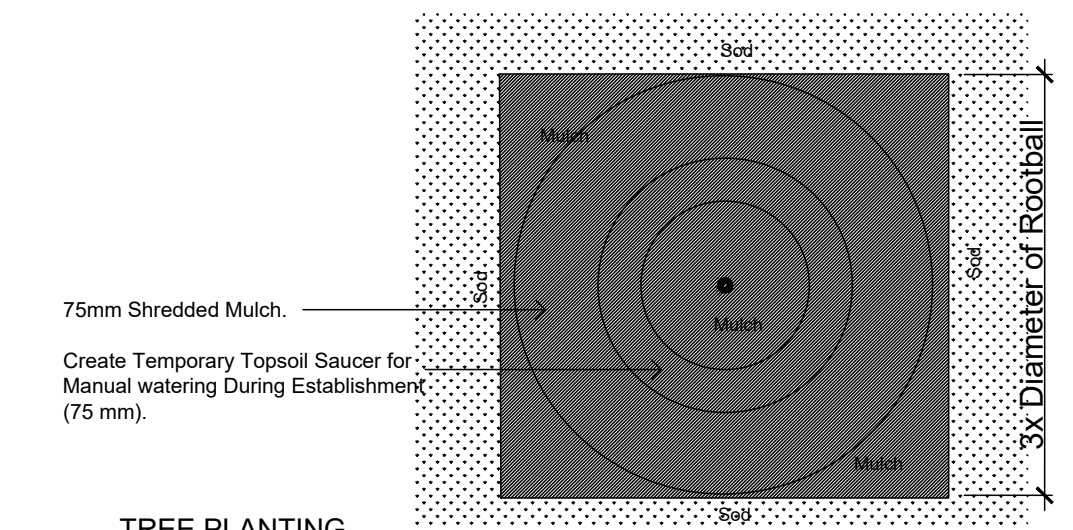

TREE PLANTING Section NTS

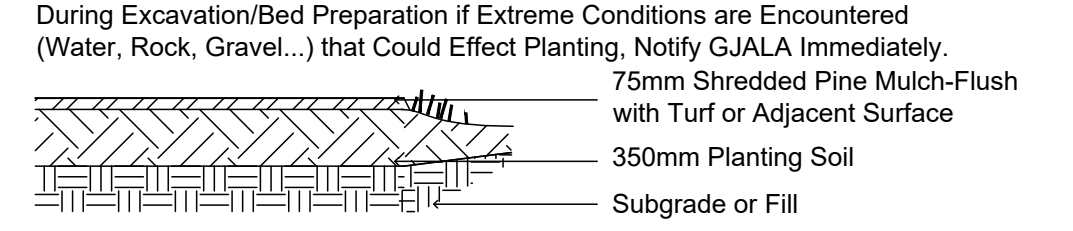

TYPICAL PLANTING BED NTS

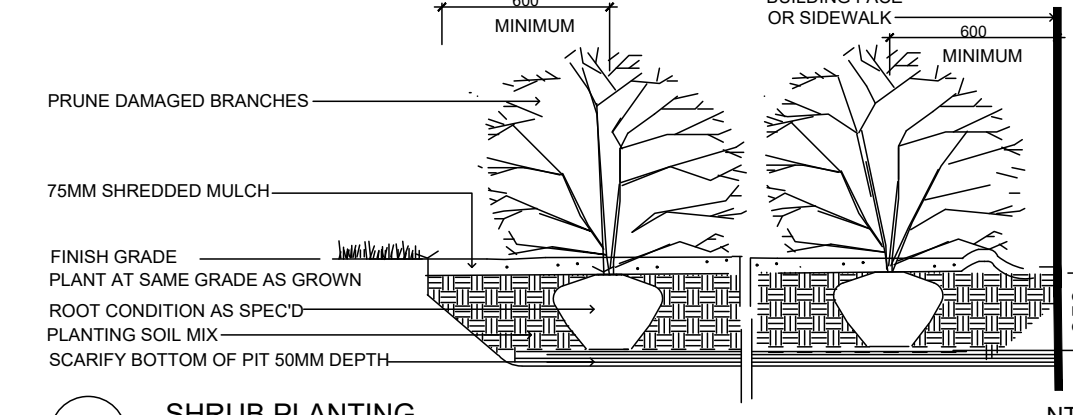

SHRUB PLANTING NTS

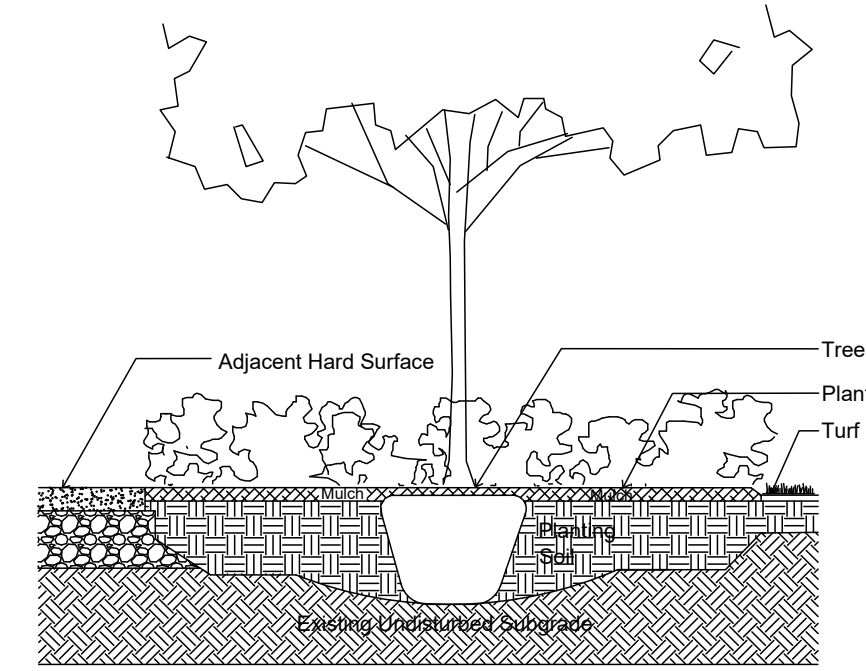

TREE PLANTING IN PLANTING BED Section NTS

CONCRETE -MAGNESIUM FLOAT:
ALL CONCRETE FINISHES TO BE APPROVED BY GJA LANDSCAPE ARCHITECT.
SAWCUT LAYOUT FOR ALL AREAS TO BE REVIEWED, ADJUSTED AND APPROVED BY GJA LANDSCAPE ARCHITECT-PRIOR TO ANY CUTTING.
EXPANSION JOINT LAYOUT FOR ALL AREAS TO BE REVIEWED, ADJUSTED AND APPROVED BY GJA LANDSCAPE ARCHITECT-PRIOR TO ANY CONCRETE POURING.
PROVIDE COLD JOINT DETAIL at End of Previous Pour/Beginning of New Pour, C/W REBAR DOWELS 500mm O.C.
FINISH: TOOL EDGE FIRST, THEN WIPE OFF TOOL MARKS WHILE APPLYING FINISH.

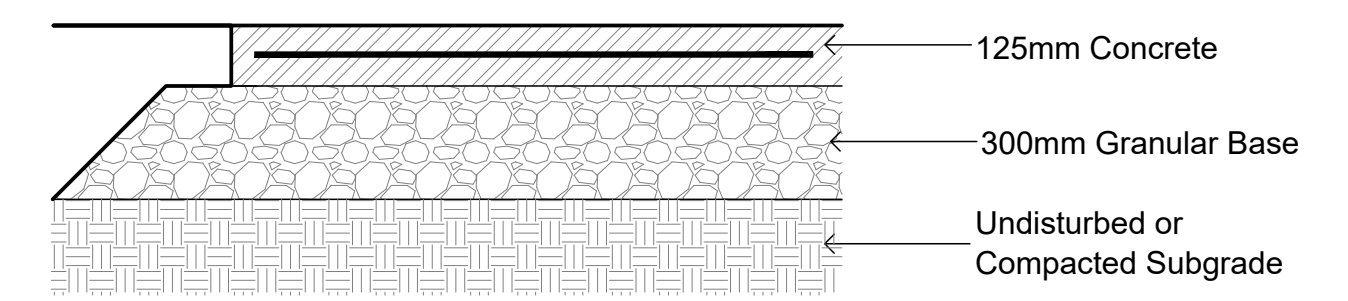

CONCRETE PAVING Section NTS

CALIPER B AND B TREES - CORKERY COMMUNITY HALL EXPANSION					
Code	Qty.	Botanical Name	Common Name	Size	Condition
AC	1	Amelanchier canadensis	Tree Serviceberry	60mm cal	B + B specimen
AG	1	Aesculus glabra	Ohio Buckeye	60mm cal	B + B specimen
AR	2	Acer rubrum	Red Maple	70mm cal	B + B specimen
AS	1	Acer saccharum	Sugar Maple	70mm cal	B + B specimen
CO	1	Celtis occidentalis	Common Hackberry	70mm cal	B + B specimen

SHRUBS - CORKERY COMMUNITY HALL EXPANSION					
Code	Qty.	Botanical Name	Common Name	Size	Condition
HK	150	Hypericum kalmianum	St. John's Wort	30cm Ht.	Pot

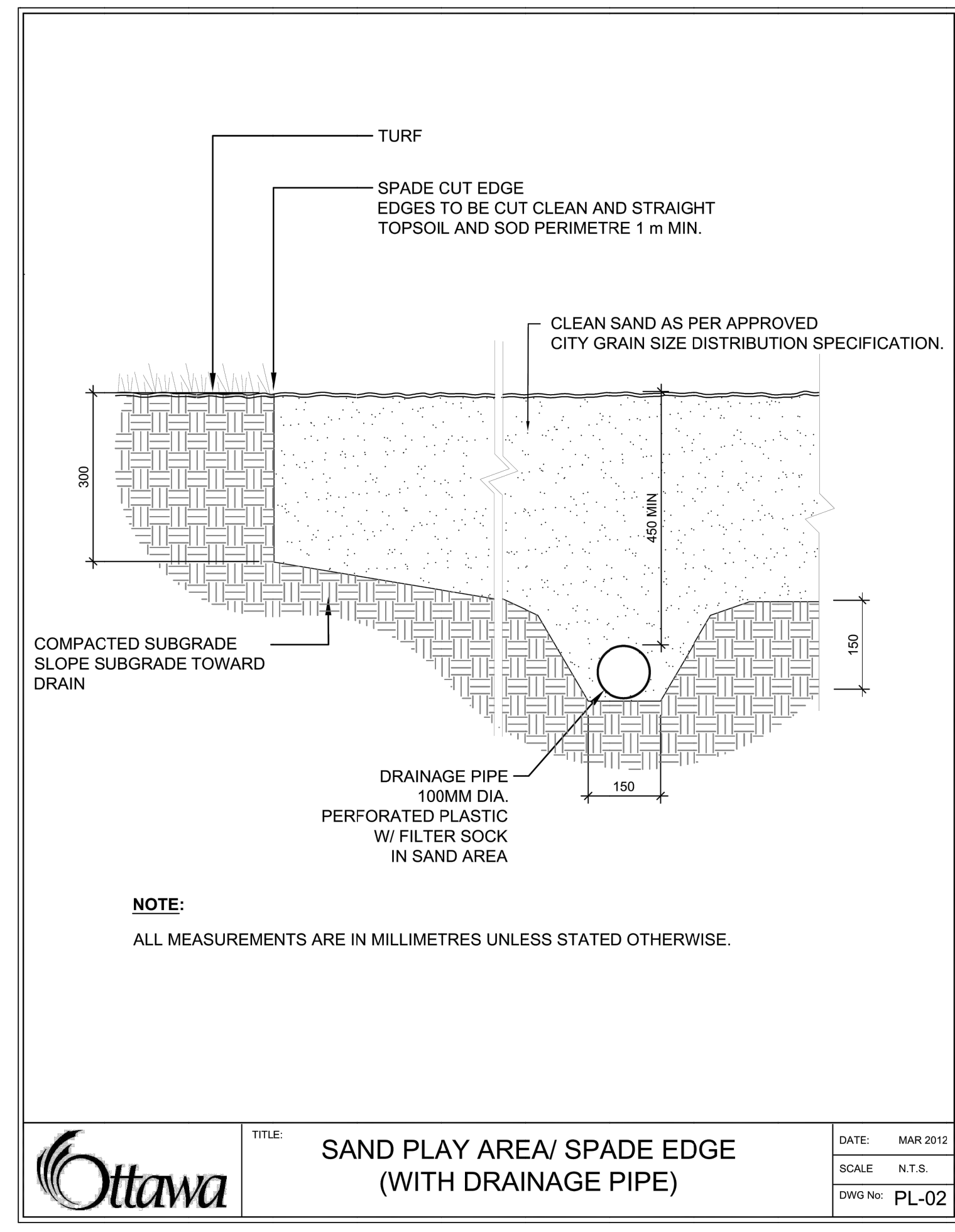

TITLE: SAND PLAY AREA/ SPADE EDGE (WITH DRAINAGE PIPE) DATE: MAR 2012 SCALE: N.T.S. DWG No: PL-02

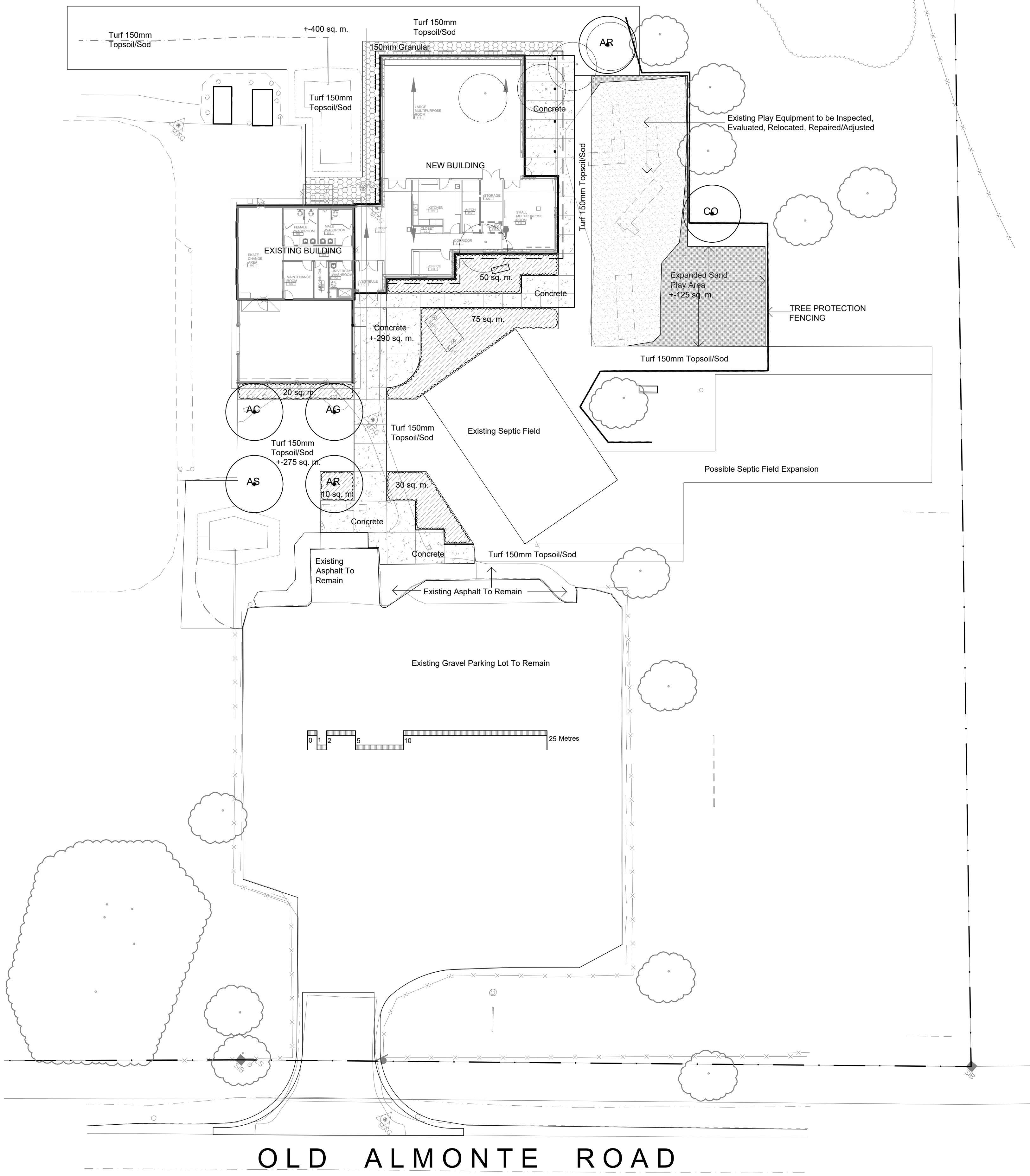

- 1 Existing Tree to Remain
- 1 Existing Tree to be Removed
- Protection for Existing Trees
- Proposed Coniferous Tree (PG)
- Proposed Deciduous Tree (CR)
- Proposed Planting Bed
- Proposed Riverwash Stone On Filter Cloth

BELOW GRADE SERVICES REFER TO CIVIL /CUP

No.	Revision	Date
4	SPC SUBMISSION 1 / TENDER	FEBRUARY 23 2022
3	99%	OCTOBER 27 2021
2	66%	SEPTEMBER 29 2021
1	33%	SEPTEMBER 2021
0	REVIEW / COORDINATION	SEPTEMBER 2021

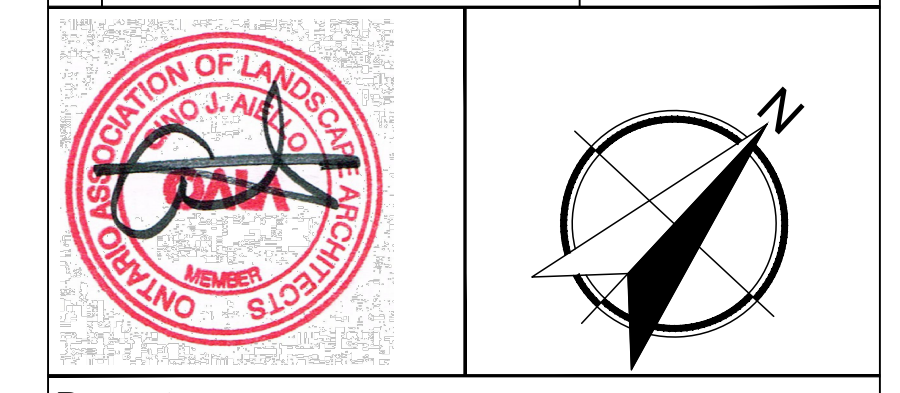

Property Owner: City of Ottawa

Gino J. Aiello | landscape architect GJALA.com
GJA Inc. Gino@GJALA.com (613) 286 5130
110 Dabury Road Unit # 9 | Ottawa Ontario | K2T 0C2

CORKERY COMMUNITY HALL EXPANSION
Project: 3447 Old Almonte Road

Drawing: **Landscape Plan**

Scale: 1:250
City of Ottawa
Dwg - #####

Sheet Number: **L1**

D07-###

OLD ALMONTE ROAD

OLD ALMONTE ROAD
CITY OF OTTAWA
PIN 04540-0204