

Drawing Remains the Property of Copyright Reserved by Gino J. Aiello Landscape Architect. Do Not Use or Reproduce Without Approval of Gino J. Aiello.
NOT To Be Used For Construction Unless indicated by Revision: **"FOR LANDSCAPE CONSTRUCTION"**.
Contractor is Responsible for Verification of Site Locations of all Utilities. Report any Discrepancies Between Site and Drawing Immediately to Gino J. Aiello. Do NOT Proceed Until Clarified.
 TURF AREAS TO BE SOD C/W 150MM DEPTH TOPSOIL ON APPROVED SUBGRADE | SOD TO BE #1 GRADE TURFGRASS NURSERY SOD per NSGA - Fine Fescue/Kentucky Bluegrass Sod | PLANTING MIX TO BE APPROVED BY LANDSCAPE ARCHITECT | PLANT MATERIAL TO MEET CNLA STANDARDS/BE APPROVED BY LANDSCAPE ARCHITECT PRIOR TO PLANTING | ALL MATERIALS & WORK TO BE MAINTAINED UNTIL FINAL ACCEPTANCE, (MOWING TURF, WEEDING BEDS, WATERING TURF & PLANTS) & INCLUDE 1 YEAR WARRANTY FROM DATE OF FINAL ACCEPTANCE | PROVIDE WATERING OF ALL PLANT MATERIAL AS REQUIRED FOR PROPER ESTABLISHMENT, UNTIL END OF WARRANTY PERIOD | REFER TO CIVIL ENGINEER'S DRAWING FOR ELEVATIONS / GRADING |
 The Landscape Plan is to be read in conjunction with the grading, servicing, site and survey plan | Bare root material to be planted in season only | All plant material locations to be staked on site by the landscape contractor and checked by the landscape architect prior to planting | All trees to be preserved on or directly adjacent to the site will be protected | Plant material are to be installed a minimum of: 3.0m away from any part of any hydro transformer, 3.0m corridor between a fire hydrant and the curb, a 2.5m radius beside or behind a fire hydrant, 2.0m from any servicing/utility line or structure |

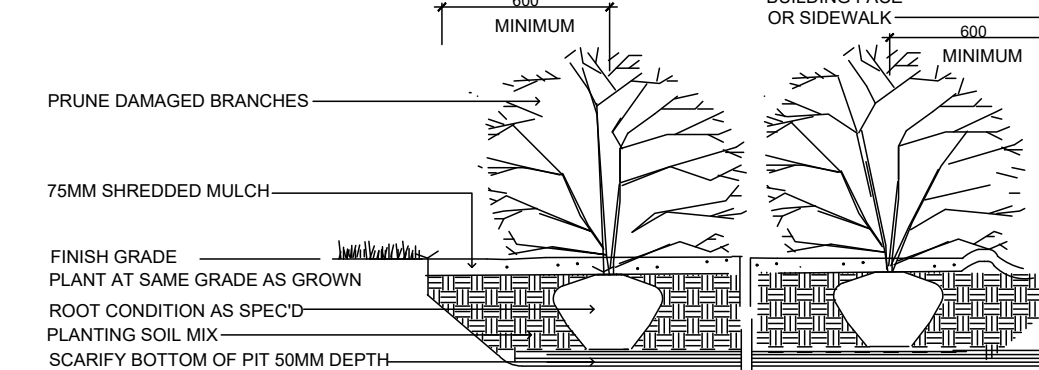

CONCRETE -MAGNESIUM FLOAT: ALL CONCRETE FINISHES TO BE APPROVED BY GJA LANDSCAPE ARCHITECT.
 SAWCUT LAYOUT FOR ALL AREAS TO BE REVIEWED, ADJUSTED AND APPROVED BY GJA LANDSCAPE ARCHITECT-PRIOR TO ANY CUTTING.
 EXPANSION JOINT LAYOUT FOR ALL AREAS TO BE REVIEWED, ADJUSTED AND APPROVED BY GJA LANDSCAPE ARCHITECT-PRIOR TO ANY CONCRETE POURING.
 PROVIDE COLD JOINT DETAIL at End of Previous Pour/Beginning of New Pour, CW REBAR DOWELS 500mm O.C.
 FINISH: TOOL EDGE FIRST, THEN WIPE OFF TOOL MARKS WHILE APPLYING FINISH.

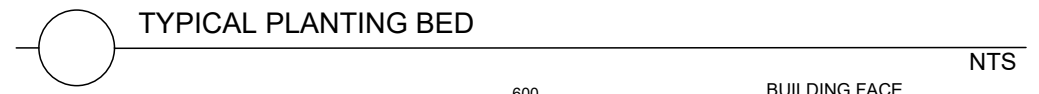
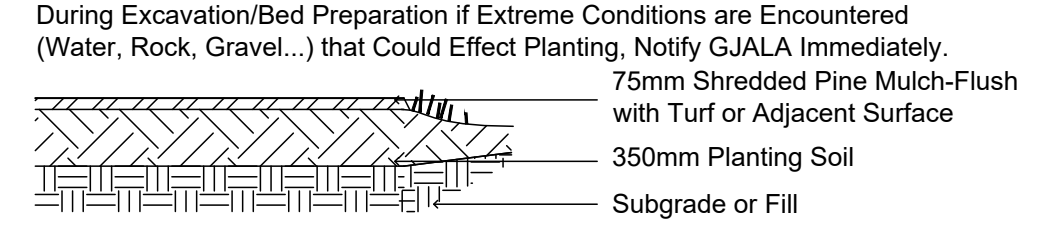
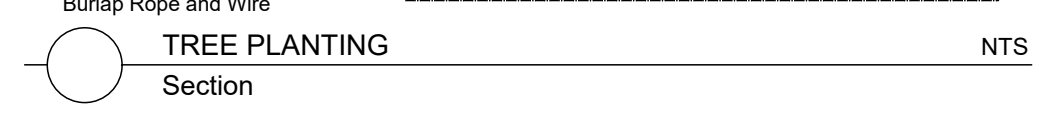
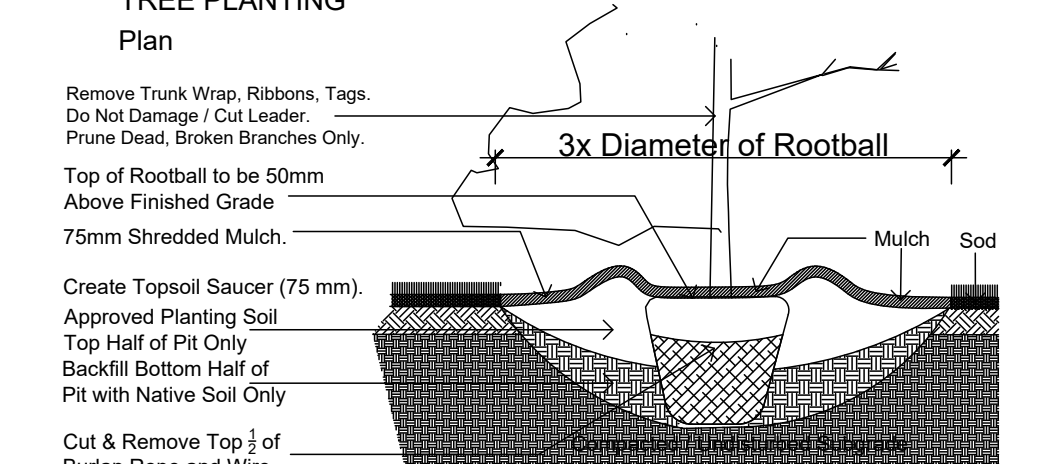
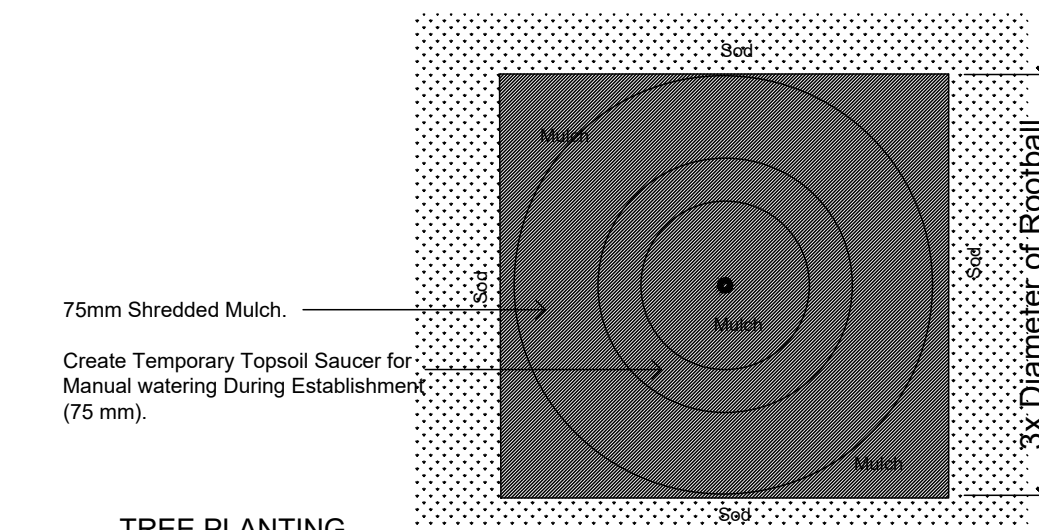
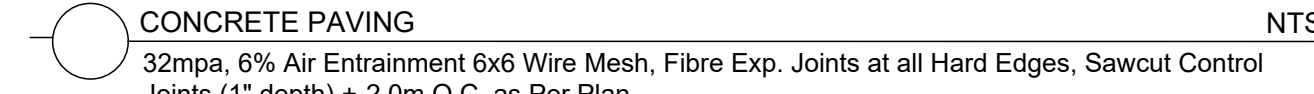
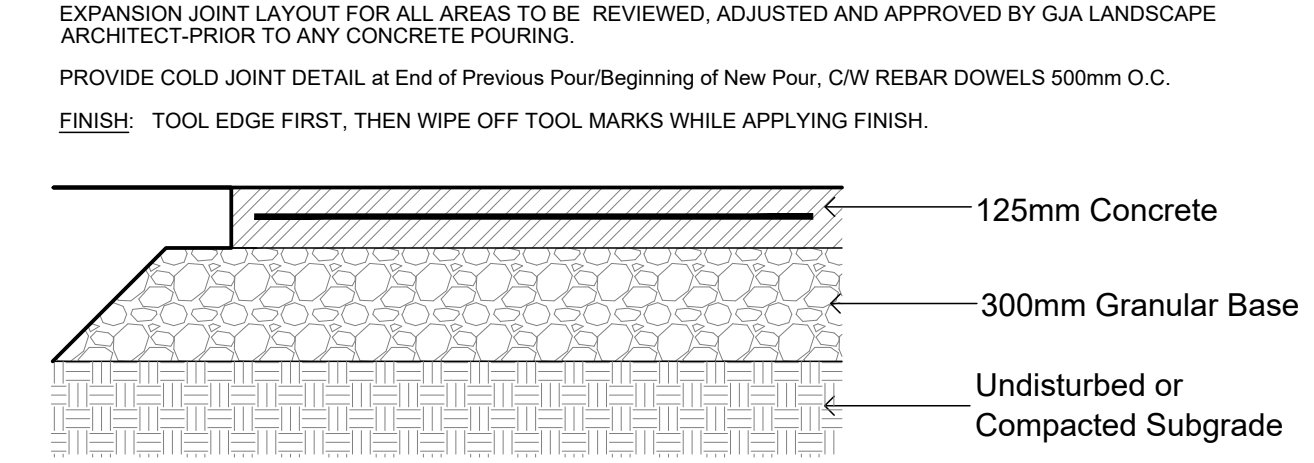

CALIPER B AND B TREES - CORKERY COMMUNITY HALL EXPANSION

Code	Qty.	Botanical Name	Common Name	Size	Condition
AR	3	Acer rubrum	Red Maple	70mm cal	B + B specimen
AS	3	Acer saccharum	Sugar Maple	70mm cal	B + B specimen
CO	3	Celtis occidentalis	Common Hackberry	70mm cal	B + B specimen
QM	3	Quercus macrocarpa	Bur Oak	70mm cal	B + B specimen

SHRUBS - CORKERY COMMUNITY HALL EXPANSION

Code	Qty.	Botanical Name	Common Name	Size	Condition
HK	150	Hypericum kalmianum	St. John's Wort	30cm Ht.	Pot

ARCHITECT
 CSV 190 Oconnor Street Ottawa K2P 2R3
 SURVEYOR
 City of Ottawa 110 Laurier Avenue Ottawa K1P 1J1
 CIVIL ENGINEER
 McIntosh Perry 115 Walgreen Rd. Carp K0A 1L0
 FORESTRY
 IFS ASSOCIATES PO Box 13593 Ottawa K2K 1X6

Tree Species	Notes
1 Apple (Malus spp.)	18' tree. Fair mature, healthy tree. Retain and protect.
2 Red maple (Acer rubrum)	18' tree. Fair mature, healthy tree. Retain and protect.
3 Norway spruce (Picea canadensis)	18' tree. Very good, healthy tree. Retain and protect.
4 Red maple (Acer rubrum)	18' tree. Very good, healthy tree. Retain and protect.
5 Red maple (Acer rubrum)	18' tree. Very good, healthy tree. Retain and protect.
6 Red maple (Acer rubrum)	18' tree. Very good, healthy tree. Retain and protect.
7 Red maple (Acer rubrum)	18' tree. Very good, healthy tree. Retain and protect.
8 Red maple (Acer rubrum)	18' tree. Very good, healthy tree. Retain and protect.
9 White spruce (Picea canadensis)	18' tree. Fair mature, healthy tree. Retain and protect.
10 White spruce (Picea canadensis)	18' tree. Fair mature, healthy tree. Retain and protect.
11 White spruce (Picea canadensis)	18' tree. Fair mature, healthy tree. Retain and protect.
12 White spruce (Picea canadensis)	18' tree. Fair mature, healthy tree. Retain and protect.
13 White spruce (Picea canadensis)	18' tree. Fair mature, healthy tree. Retain and protect.
14 Norway spruce (Picea canadensis)	18' tree. Fair mature, healthy tree. Retain and protect.
15 Red maple (Acer rubrum)	18' tree. Fair mature, healthy tree. Retain and protect.
16 Red maple (Acer rubrum)	18' tree. Fair mature, healthy tree. Retain and protect.
17 Maple (Acer spp.)	18' tree. Fair mature, healthy tree. Retain and protect.

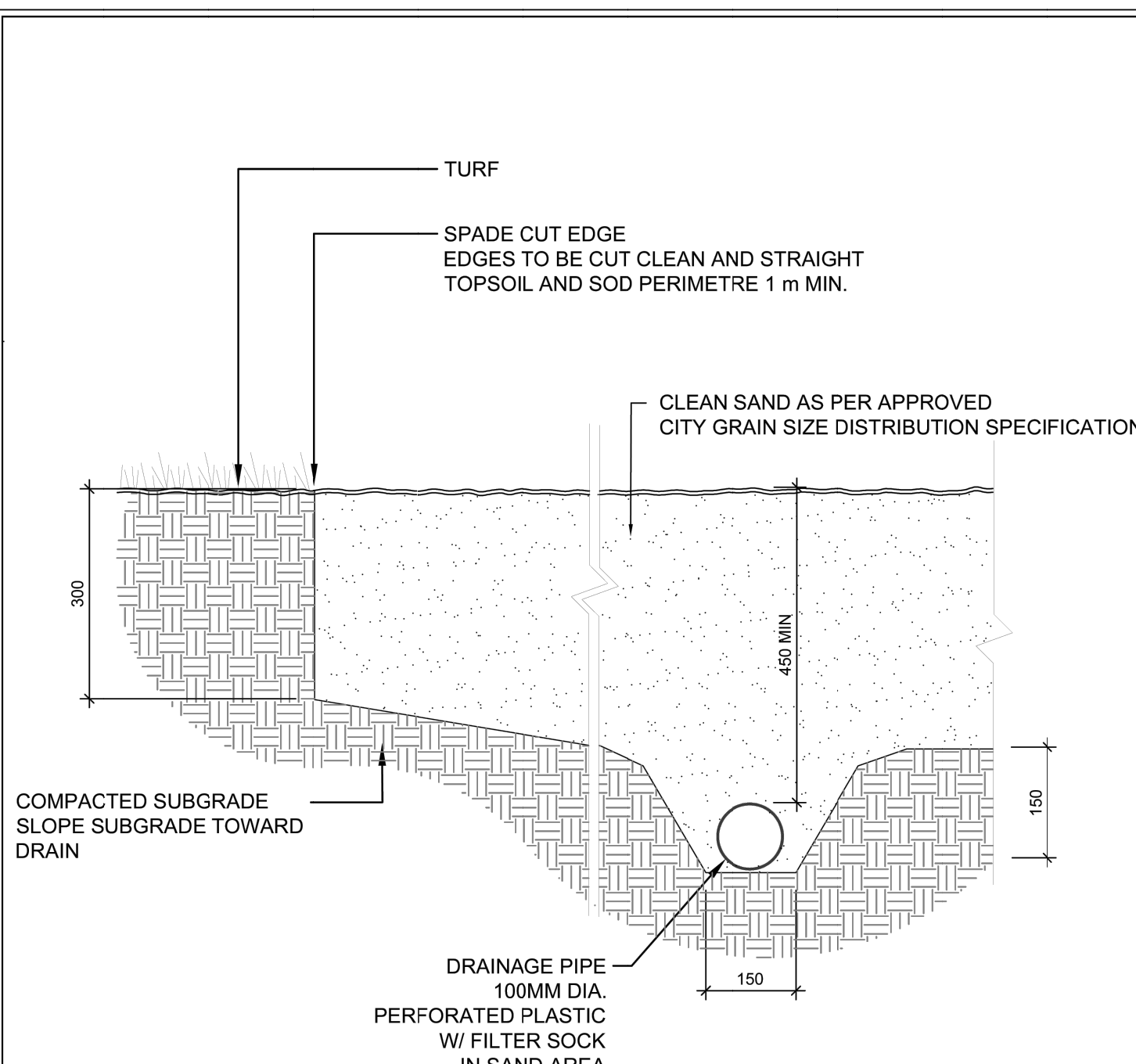

NOTE: ALL MEASUREMENTS ARE IN MILLIMETRES UNLESS STATED OTHERWISE.

TITLE: SAND PLAY AREA/ SPADE EDGE (WITH DRAINAGE PIPE)
 DATE: MAR 2012
 SCALE: N.T.S.
 DWG No: PL-02

REFER TO TREE CONSERVATION REPORT BY IFS ASSOCIATES FOR FULL AND LATEST REPORT FOR TREE PROTECTION, RETENTION, REMOVAL.

Sean Harrigan
SEAN HARRIGAN
 PLANNER
 PLANNING, REAL ESTATE & ECONOMIC DEVELOPMENT
 DEPARTMENT, CITY OF OTTAWA

APPROVED
 By Sean Harrigan at 8:51 am, Oct 20, 2023

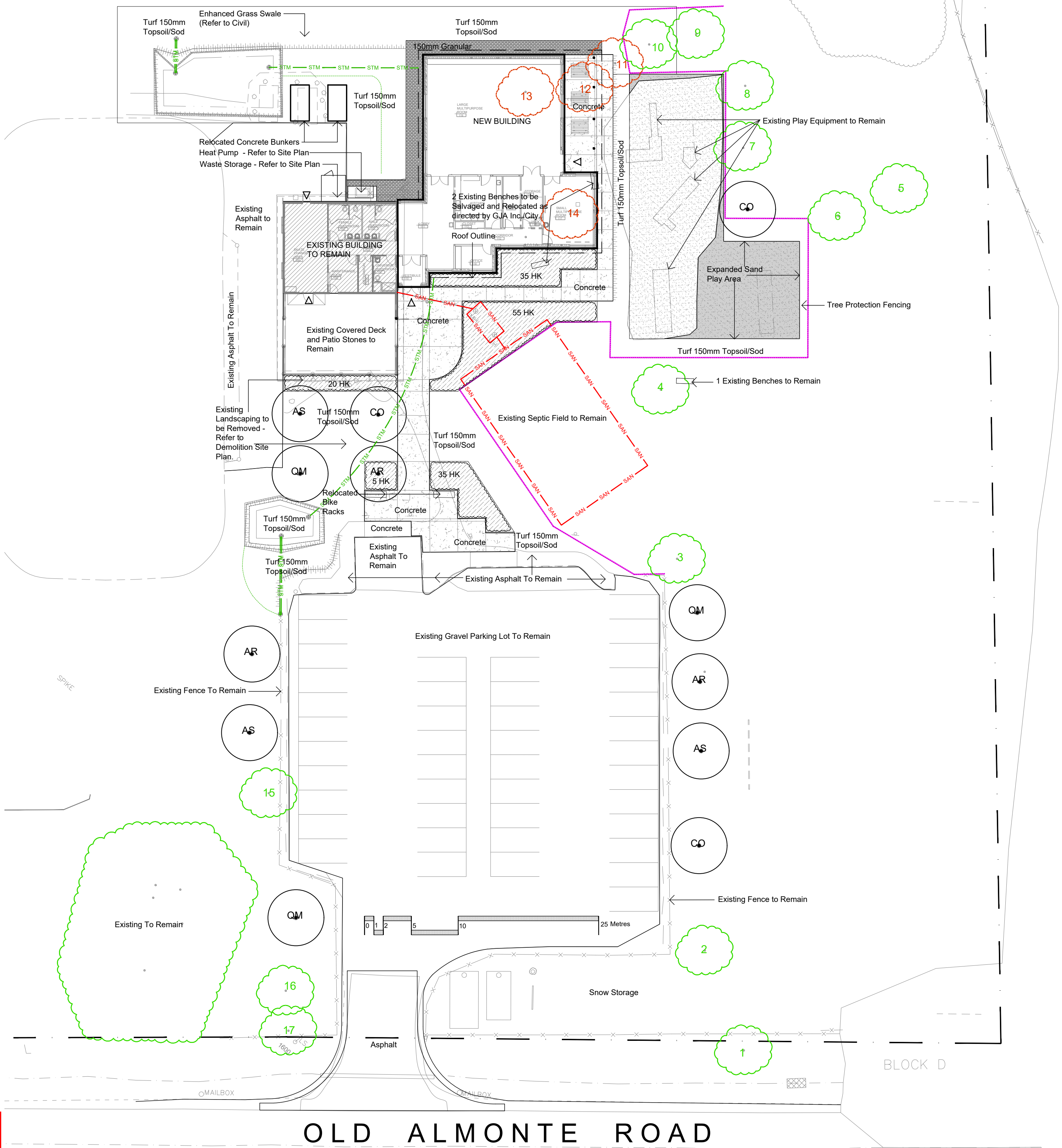

- REFER TO TCR BY IFS
- Existing Tree to Remain
 - Existing Tree to be Removed
 - Protection for Existing Trees

- LANDSCAPE PLAN LEGEND
- Proposed Deciduous Tree
 - Proposed Planting Bed
 - Proposed Riverwash Stone On Filter Cloth

No.	Revision	Date
9	SPC SUBMISSION	MAY 29 2023
8	SPC SUBMISSION	APRIL 25 2023
7	IFC	DECEMBER 15 2022
6	SPC SUBMISSION	DECEMBER 2 2022
5	IFC	NOVEMBER 4 2022
4	SPC SUBMISSION 1 / TENDER	FEBRUARY 23 2022
3	99%	OCTOBER 27 2021
2	66%	SEPTEMBER 29 2021
1	33%	SEPTEMBER 2021
0	REVIEW / COORDINATION	SEPTEMBER 2021

Property Owner: City of Ottawa
 110 Laurier Avenue Ottawa K1P 1J1

Gino J. Aiello | landscape architect
 GJALA.com
 GJA Inc. Gino@GJALA.com (613) 286 5130
 110 Dabury Road Unit # 9 | Ottawa Ontario | K2T 0C2

CORKERY COMMUNITY HALL EXPANSION
 Project: 3447 Old Almonte Road
 Drawing: Landscape Plan
 Sheet Number: L1
 Scale: 1:250

D07-12-22-0048