

SITE PLAN SYMBOLS LEGEND

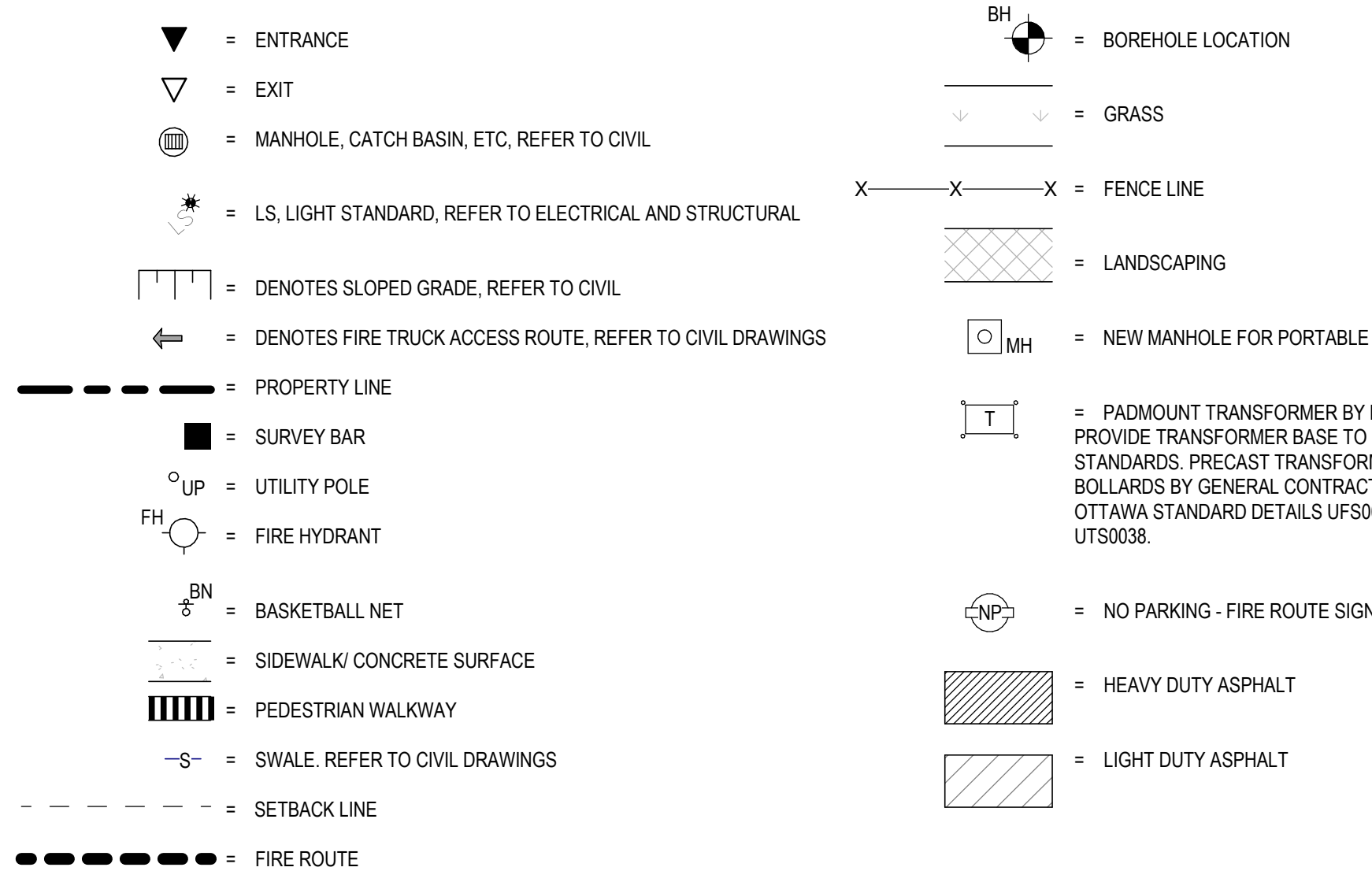

GENERAL SITE PLAN NOTES

- 0BC 3.2.5.5 (1) LOCATION OF ACCESS ROUTES
ACCESS ROUTES REQUIRED BY ARTICLE 3.2.5.4 SHALL BE LOCATED SO THAT THE PRINCIPLE ENTRANCE AND EVERY ACCESS OPENING REQUIRED BY ARTICLE 3.2.5.1 AND 3.2.5.2 ARE LOCATED NOT LESS THAN 3M AND NOT MORE THAN 15M FROM THE CLOSEST PORTION OF THE ACCESS ROUTE REQUIRED FOR FIRE DEPARTMENT USE, MEASURED HORIZONTALLY FROM THE FACE OF THE BUILDING.
- 0BC 3.2.5.6 (1) ACCESS ROUTE DESIGN
A PORTION OF A ROADWAY OR YARD PROVIDED AS A REQUIRED ACCESS ROUTE FOR FIRE DEPARTMENT USE SHALL (a) HAVE A CLEAR WIDTH OF NOT LESS THAN 3M UNLESS IT CAN BE SHOWN THAT LESSER WIDTHS ARE SATISFACTORY, (b) HAVE A CENTERLINE RADIUS NOT LESS THAN 10M (c) HAVE AN OVERHEAD CLEARANCE OF NOT LESS THAN 3M (d) HAVE A CHANGE OF GRADE NOT MORE THAN 1% IN 12.5 OVER A MINIMUM DISTANCE OF 15M (e) BE DESIGNED TO SUPPORT THE EXPECTED LOADS IMPOSED BY FIRE FIGHTING EQUIPMENT AND BE SURFACED WITH CONCRETE ASPHALT OR OTHER MATERIAL DESIGNED TO PERMIT ACCESSIBILITY UNDER ALL CLIMATIC CONDITIONS.
- PROVIDE 75mm THK HI-40 UNDER ALL EXTERIOR CONCRETE SIDEWALK AT ALL ENTRANCES/EXITS. EXTEND RIGID INSULATION MIN 1200 PAST THE EDGE OF CONCRETE SIDEWALKS.
- FOR CONCRETE SIDEWALK EXPANSION AND CONTRACTION JOINTS, REFER TO CIVIL DETAIL AND SPECIFICATIONS.
- REFER TO LANDSCAPING PLAN AND CIVIL PLANS FOR LOCATION OF SOD. ALL REMAINING AREAS NOT SLATED FOR SOD TO RECEIVE TOPSOIL AND SEED.
- REFER TO CIVIL DRAWINGS FOR LOCATIONS OF FIRE ROUTE SIGNAGE.
- REFER TO CIVIL DRAWINGS FOR TACTILE INDICATORS.
- ALL CURBS ADJACENT TO PARKING AREAS AND CURBS FORMING PART OF SIDEWALKS ADJACENT TO PARKING AREAS TO BE PAINTED YELLOW.
- ENSURE FINAL PLACEMENT OF FIRE DEPARTMENT CONNECTION IS NOT MORE THAN 45m FROM THE NEAREST FIRE HYDRANT AS PER CBC 3.2.5.16 (2).
- LEGAL SURVEY BOUNDARIES TAKEN FROM REGISTERED PLAN 4M 1619, DATED MARCH 12, 2019, FROM THE OFFICE OF ANNIS, O'SULLIVAN, VOLLEBEK LTD.(O.S.), JOB NO. 14777-14.
- TOPOGRAPHICAL INFORMATION TAKEN FROM TOPOGRAPHICAL PLAN OF SURVEY, BLOCKS 313 AND 314, REGISTERED PLAN 4M 1619, DATED MARCH 30, 2021, FROM THE OFFICE OF ANNIS, O'SULLIVAN, VOLLEBEK LTD.(O.S.), JOB NO. 21401-21.

TYPE OF BUILDING OR USE		SITE AND PARKING INFORMATION		PARKING CALCULATION	
SCHOOL (GROUP A-2 OCCUPANCY)				20 CLASSROOMS X 1.5 = 30 2 PER 100m ² OF DAYCARE GROSS FLOOR AREA (800m ²) = 7 12 PORTABLES X 1.5 = 18 TOTAL PARKING REQUIRED = 55 TOTAL PARKING PROVIDED = 58 BARRIER-FREE PARKING SPACES REQUIRED = 3 TOTAL SITE PARKING PROVIDED = 60	
ZONING	11A - MINOR INSTITUTIONAL ZONE, SUBZONE B1 R1Z RESIDENTIAL FIRST DENSITY, SUBZONE Z	REQUIREMENT (11A)	PROPOSED	BUILDING AREA	
MINIMUM LOT AREA, SEC. 170, TABLE 170A (b)	400m ²		28,889m ²	THE GFA FOR THE SCHOOL IS AS FOLLOWS: FIRST FLOOR = 3,329 m ² (EXCLUDING DAYCARE) DAYCARE = 260 m ² TOTAL BUILDING FOOTPRINT = 3,689m ² SECOND FLOOR = 1,192 m ² TOTAL AREA = 4,881 m ²	
MINIMUM LOT WIDTH, SEC. 170, TABLE 170A (a)	15.0m		± 104.61m	SITE AREA	
MINIMUM FRONT YARD, SEC. 170, TABLE 170A (c)	3.0m		6.15m	SITE AREA = 28,889 m ²	
MINIMUM REAR YARD, SEC. 170, TABLE 170A (d)	7.5m		± 55.54m	PARCEL IDENTIFICATION NUMBER	
MINIMUM EXTERIOR SIDE YARD	NO REQUIREMENT			PIN: 04450-1434	
MINIMUM INTERIOR SIDE YARD, SEC. 170, TABLE 170A (e)	7.5m		± 93.47m		
MINIMUM CORNER SIDE YARD, SEC. 170, TABLE 170A (f)	4.5m		± 16.48m		
MINIMUM LANDSCAPED OPEN SPACE	NO REQUIREMENT		5.3% WITH PARKING LOT		
MAXIMUM LOT COVERAGE	NO REQUIREMENT		12.8% LOT COVERAGE		
PERCENTAGE OF TOTAL SITE OCCUPIED BY VEGETATION AND LANDSCAPING	NO REQUIREMENT		77% SITE OCCUPIED		
MAXIMUM BUILDING HEIGHT, SEC. 170, TABLE 170A (g) (BY-LAW 2017-303)	15.0m		8.7m		
MINIMUM REQUIRED PARKING FOR NEW ELEMENTARY SCHOOL, SEC. 101, TABLE 101, N#1	1.5 PER CLASSROOM (w/ PORTABLES); DAYCARE - 2 PER 100 m ² OF GFA = 55		58		
MINIMUM REQ. WIDTH OF A LANDSCAPED BUFFER FOR PARKING LOT, SEC. 110, TABLE 110(a)	3.0m		3.6m		
MINIMUM NUMBER OF BARRIER-FREE PARKING SPACES, BY-LAW NO. 2017-301, SECTION 111	NO. OF REGULAR PARKING SPACES - MIN. NO. OF ACCESSIBLE PARKING SPACES - 3		3. SEE CALCULATION ABOVE		
MINIMUM NUMBER OF BICYCLE PARKING SPACES, SEC. 111, TABLE 111A (d)	SCHOOL: 1 PER 100m ² OF GFA OFFICE: 4781/100 = 47.81 ROUNDED TO 48 DAY CARE: 1 PER 250m ² OF GFA = 360/250 = 1.44 ROUNDED TO 2 TOTAL: 96		50		
BICYCLE PARKING DIMENSIONS, SEC. 111, TABLE 11B	HORIZONTAL: 0.6m by 1.8m		HORIZONTAL: 0.6m by 1.8m		

ARCHITECTURE 49

1345 ROSEMOUNT AVENUE
OTTAWA, ONTARIO, CANADA K2J 3E5
PHONE: 613-933-9914 | FAX: 613-936-0335 | WWW.ARCHITECTURE49.COM

WSP

300-2011 QUEENSWAY DRIVE
OTTAWA, ONTARIO, CANADA K2B 8K2
PHONE: 613-820-3900 | WWW.WSP.COM

Conseil des écoles publiques de l'Est de l'Ontario

2045 Bldg. B | Laurent Drive, ON K1G 5G3 | Tel: 613-724-8960 | Toll-free: 1-888-303-0300

ÉCOLE ÉLÉMENTAIRE KANATA - STITTSVILLE

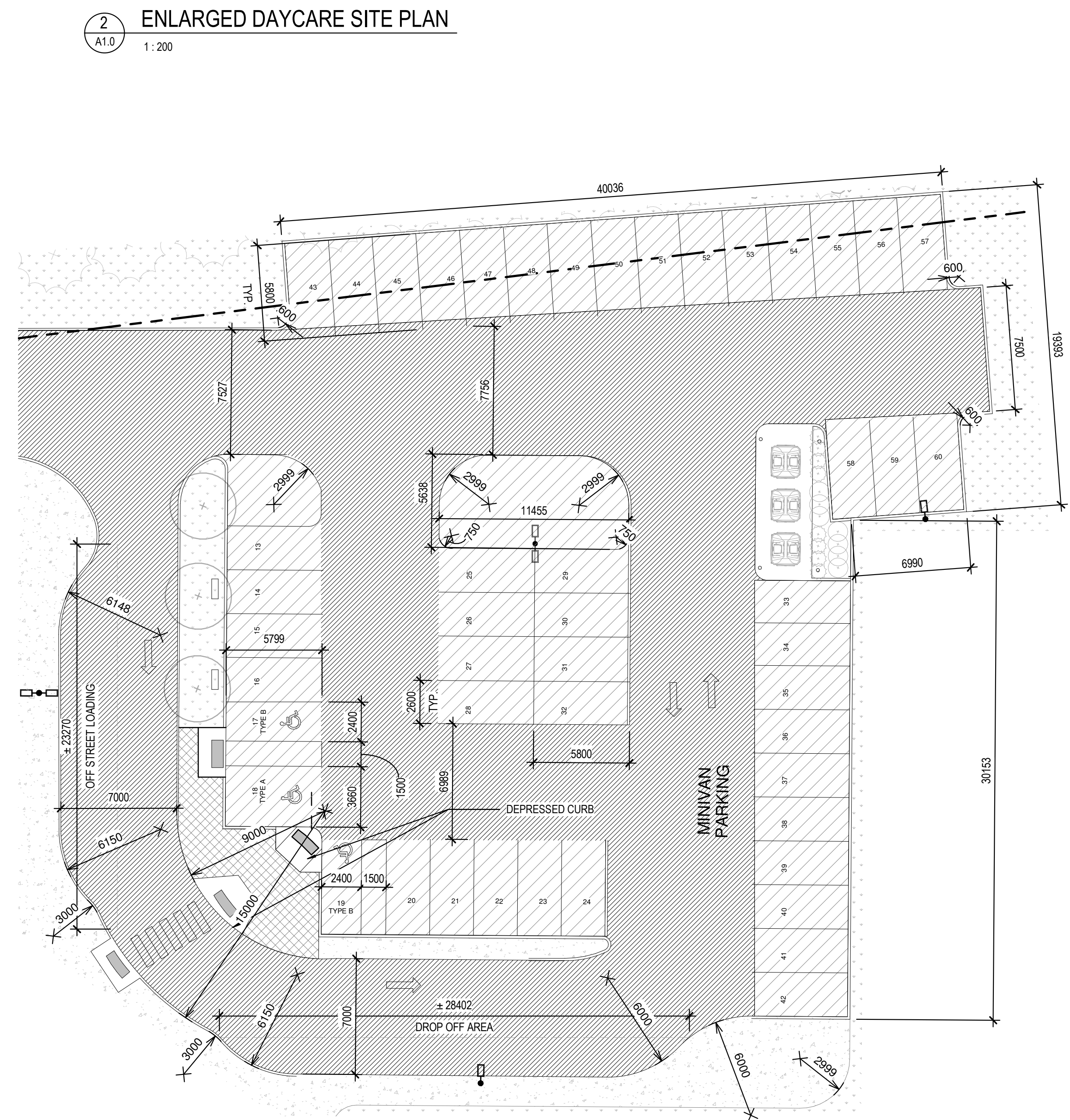
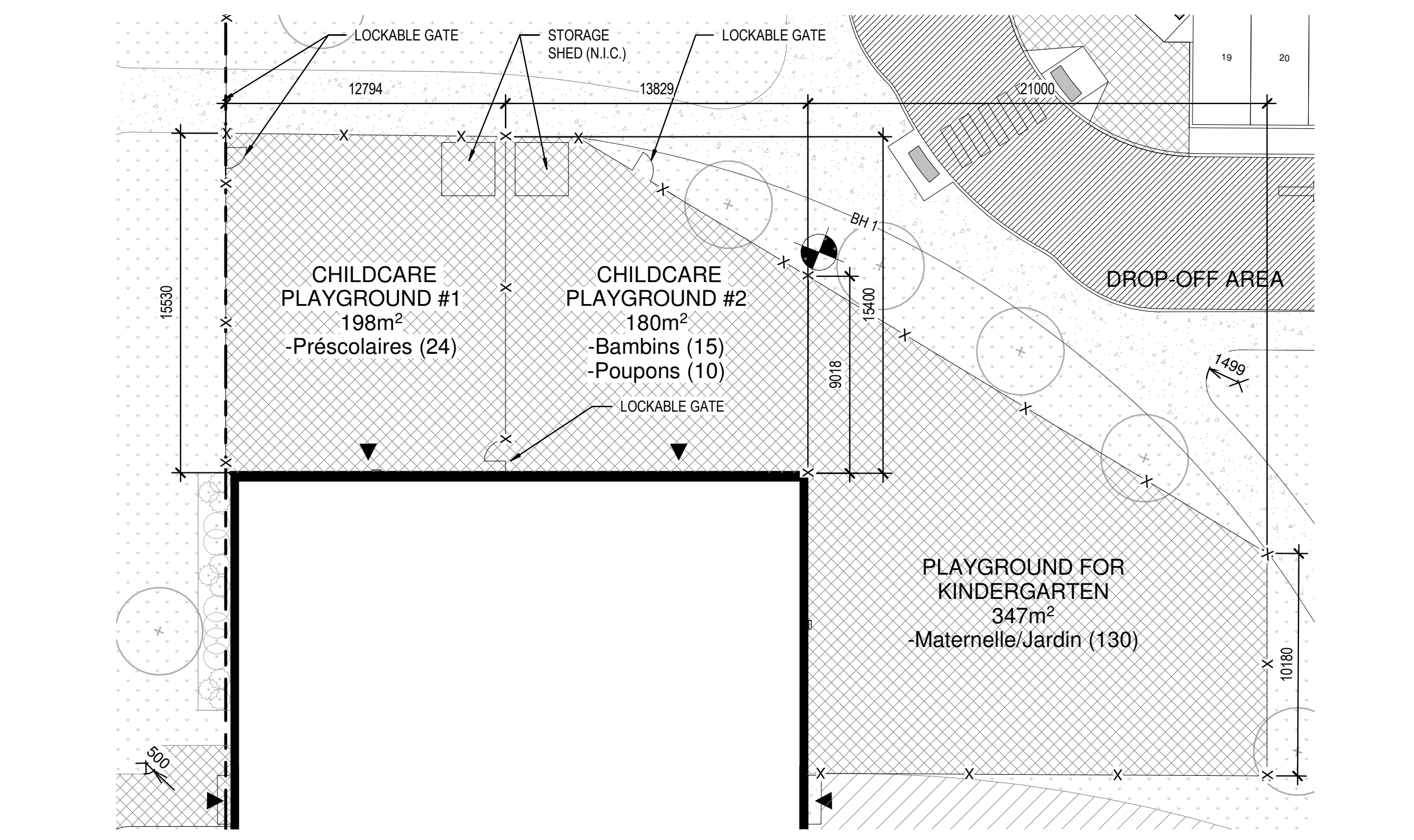

1 GENERAL SITE PLAN
A1.0 1:400

3 ENLARGED DROP OFF PLAN
A1.0 1:200

D07-12-22-0058
Plan #18734

NO.	DATE	DESCRIPTION
12	02 SEP 2022	UPDATED PER CITY COMMENTS
11	07 JUL 2022	ISSUED FOR SITE PLAN CONTROL
10	16 JUN 2022	BAR ADDRESS/NO. 1
9	31 MAR 2022	ISSUED FOR SITE PLAN CONTROL
8	30 MAR 2022	ISSUED FOR SITE PLAN CONTROL
7	21 MAR 2022	ISSUED FOR RIB AND PERMIT
6	14 JAN 2022	ISSUED FOR 99% CD REVIEW
5	19 NOV 2021	ISSUED FOR 85% CD REVIEW
4	26 SEP 2021	ISSUED FOR INFORMATION
3	24 SEP 2021	ISSUED FOR 60% CD REVIEW
2	27 AUG 2021	RE-ISSUED FOR 30% CD REVIEW
1	04 AUG 2021	30% CD REVIEW

PROJECT NO: 219-20074-00
PROJECT SCALE: As indicated
DESIGNED BY: J.C.
DRAWN BY: NMM SDI AS
CHECKED BY: M.M.C.
DISCIPLINE: ARCHITECTURAL
TITLE: GENERAL SITE PLAN
SHEET NO. OF: A1.0 OF 12
DATE OF: 2 SEP 2022