

CONSULTANTS

civil
TMIG
8800 Dufferin St., Suite 200, Vaughan, ON L4K 0C5
structural

RJC Engineers
1545 Carlin Ave., Suite 304, Ottawa, ON K1Z 8P9
sep

Smith+Andersen
1600 Carling Ave., Suite 530, Ottawa, ON K1Z 1G3
landscape

PFS Studio
1777 W 3rd Ave., Vancouver, BC V6J 1KJ

consultant
Two Row Architect
1804 6th Line, Oshawa, ON N8A 1M0

contractor
Eis&D
2800 Queensview Dr., Ottawa, ON K2B 6J9

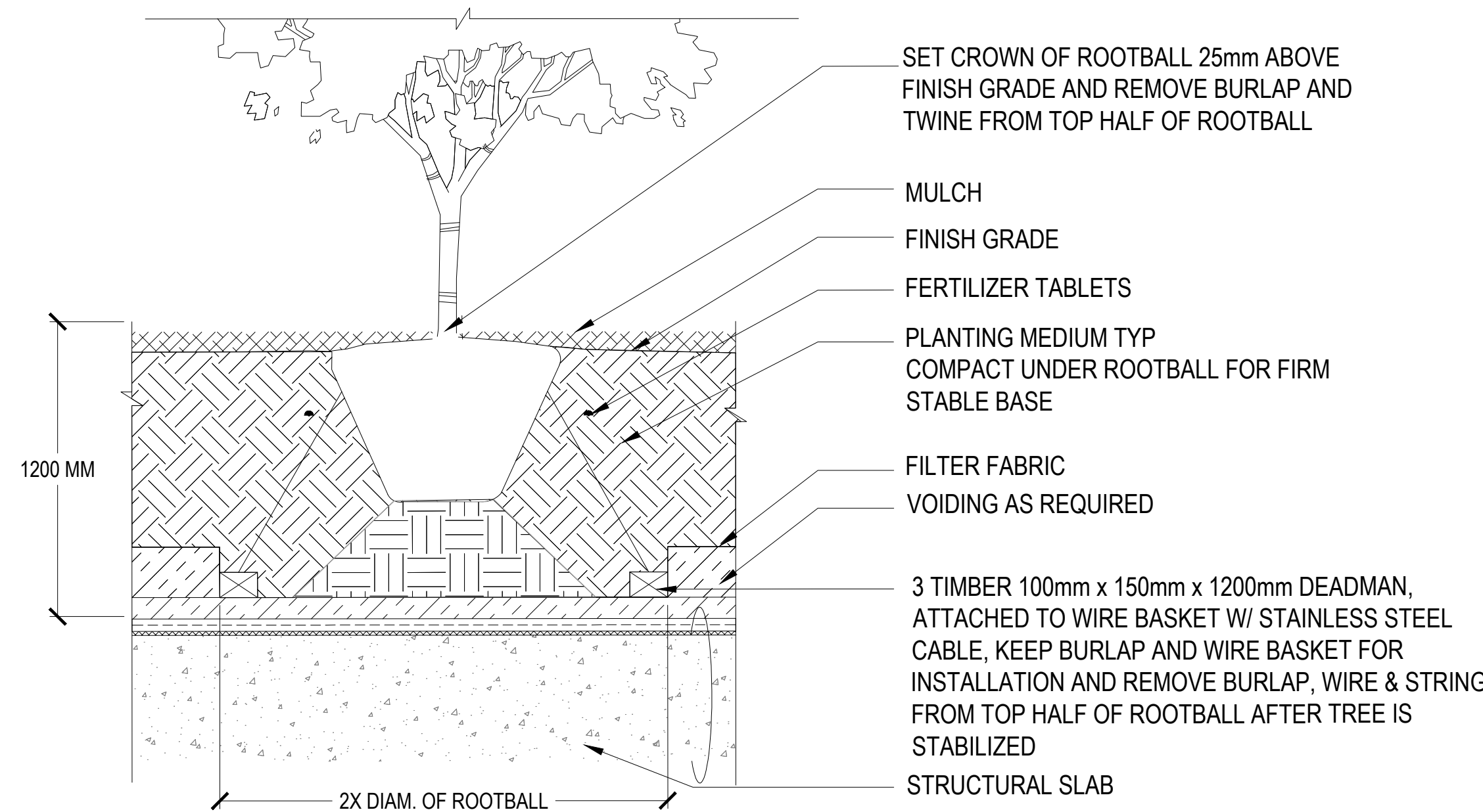

01 TREE PLANTING ON STRUCTURE
SCALE: NTS

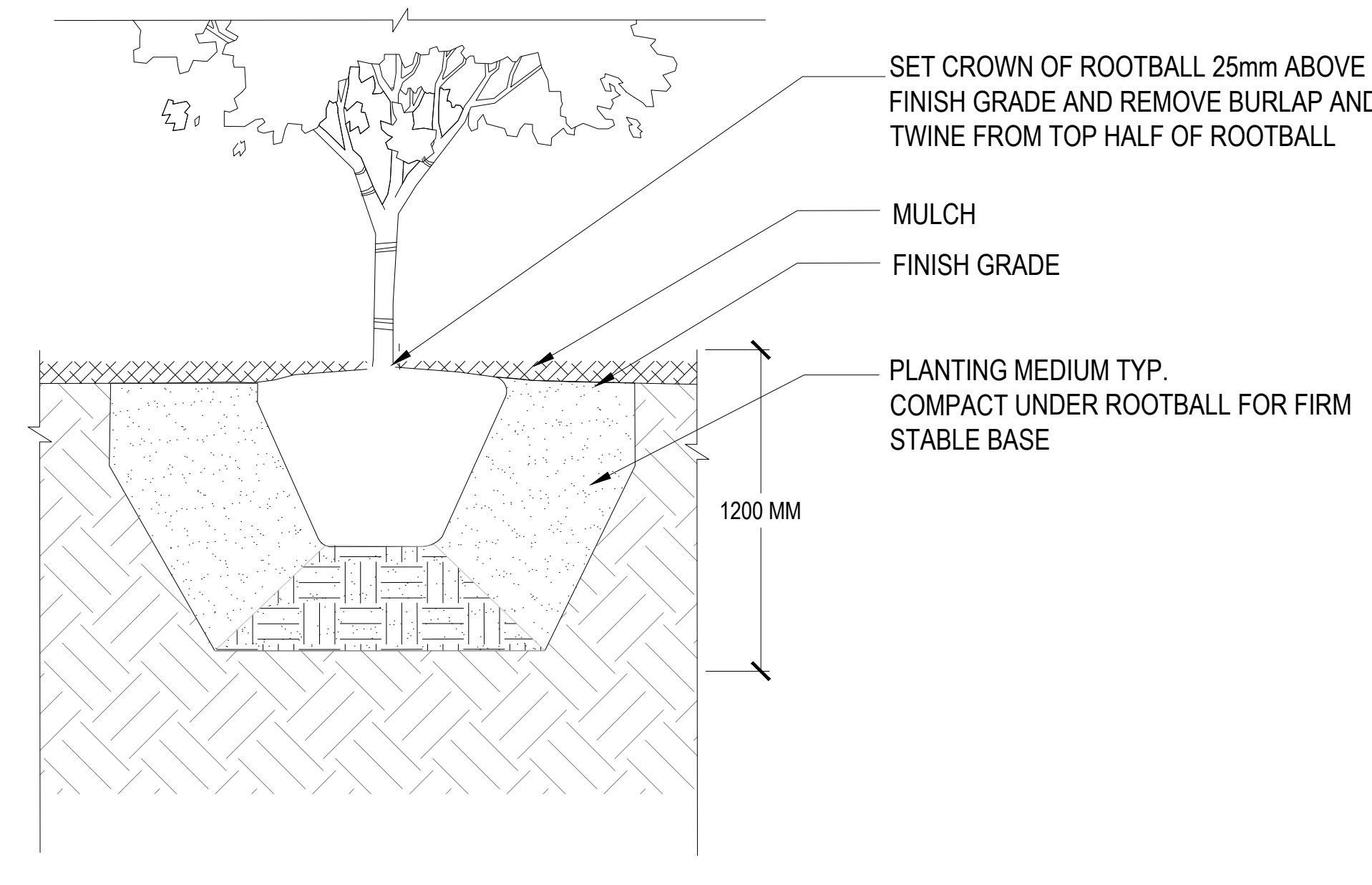

02 TREE PLANTING ON GRADE
SCALE: NTS

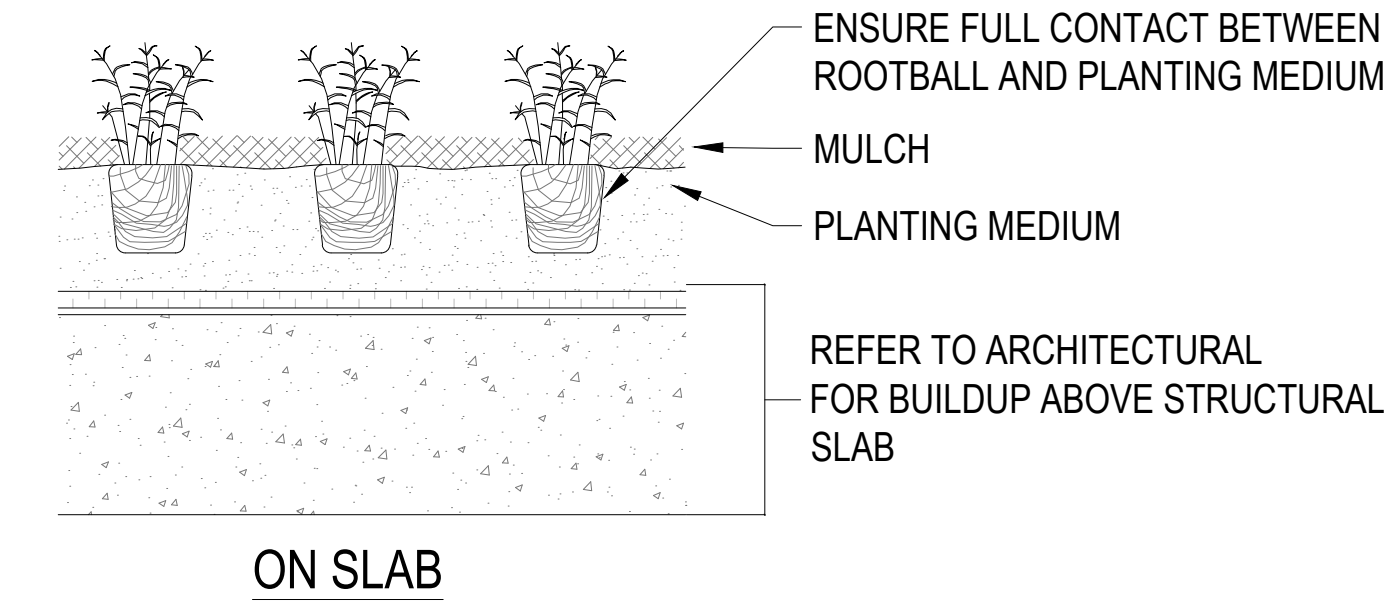

ON SLAB

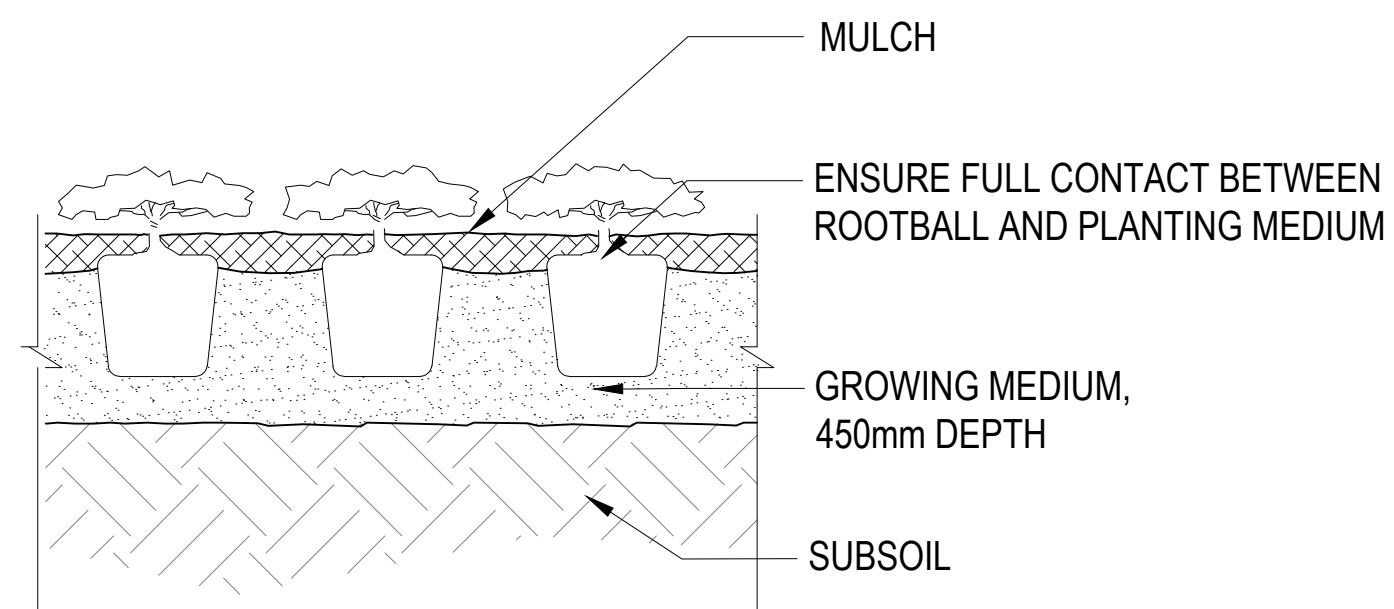

ON GRADE

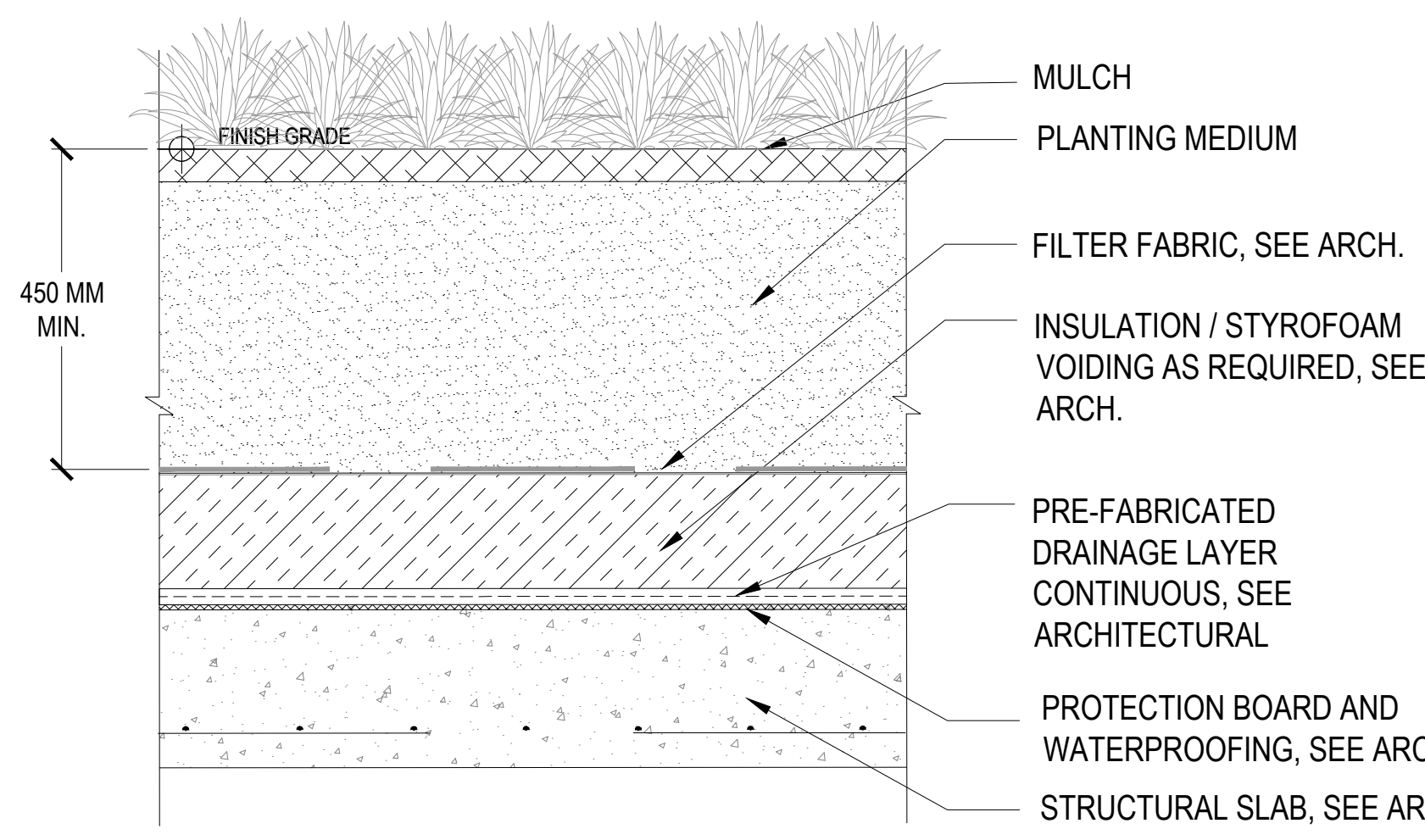

03 SHRUB PROFILE ON SLAB
SCALE: 1:10

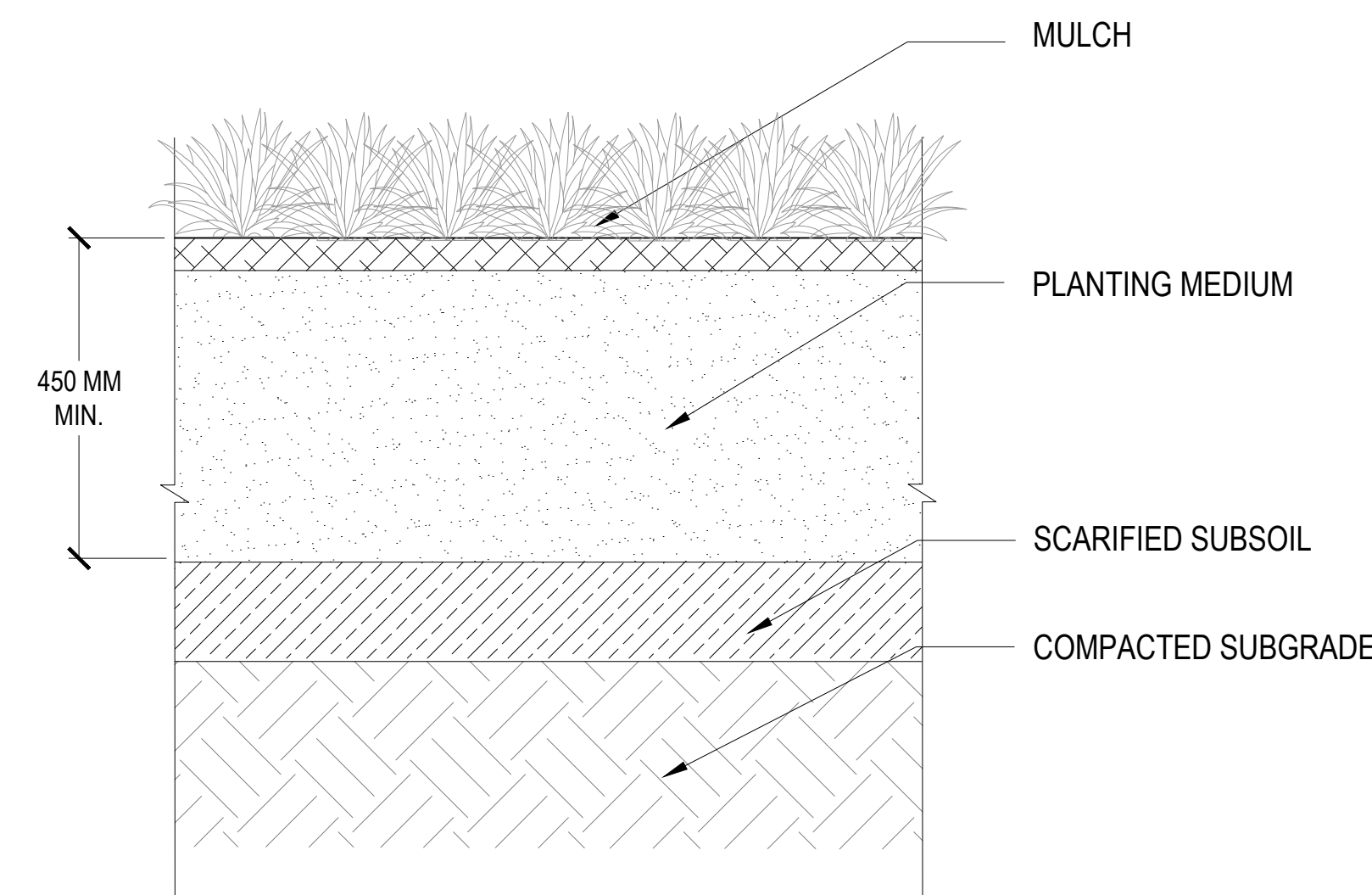

04 SHRUB PROFILE ON GRADE
SCALE: 1:10

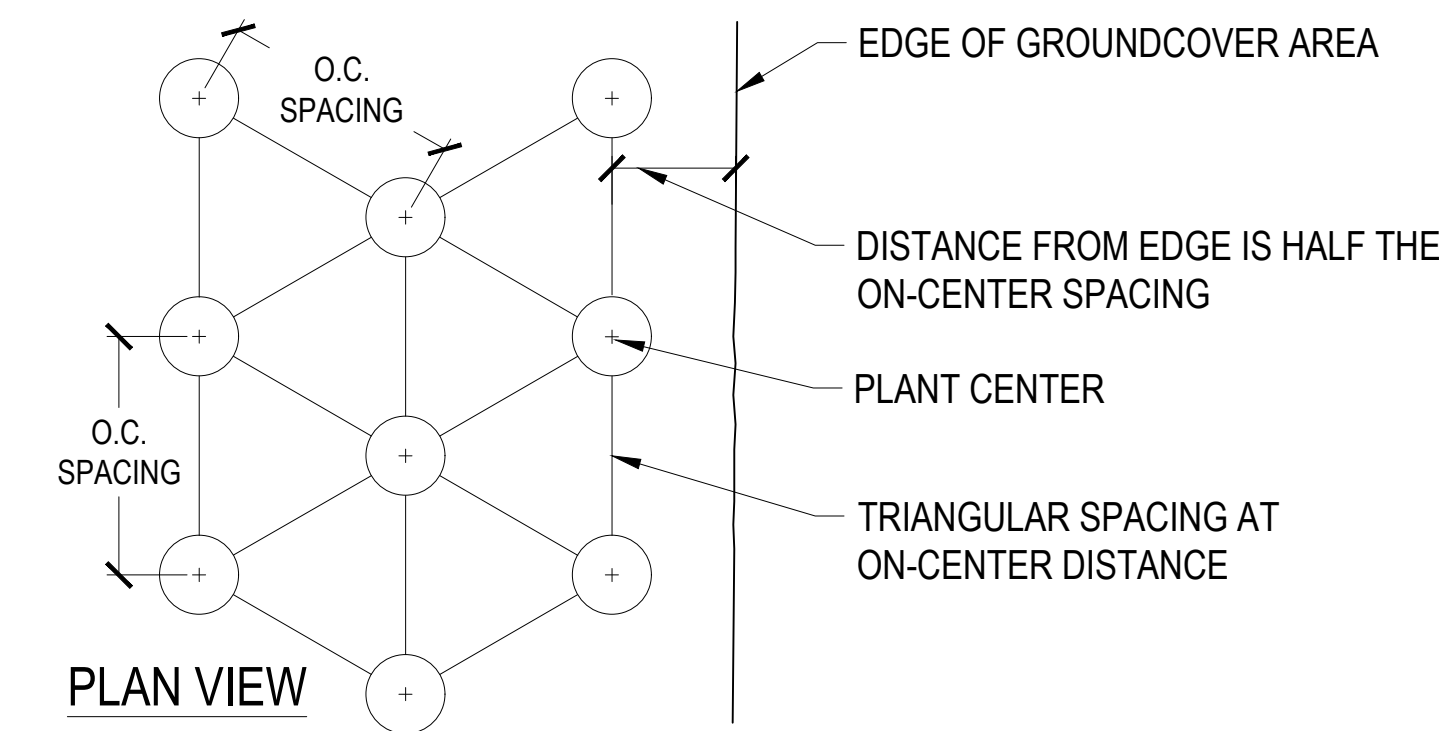

PLAN VIEW

05 GROUND COVER PLANTING
SCALE: NTS

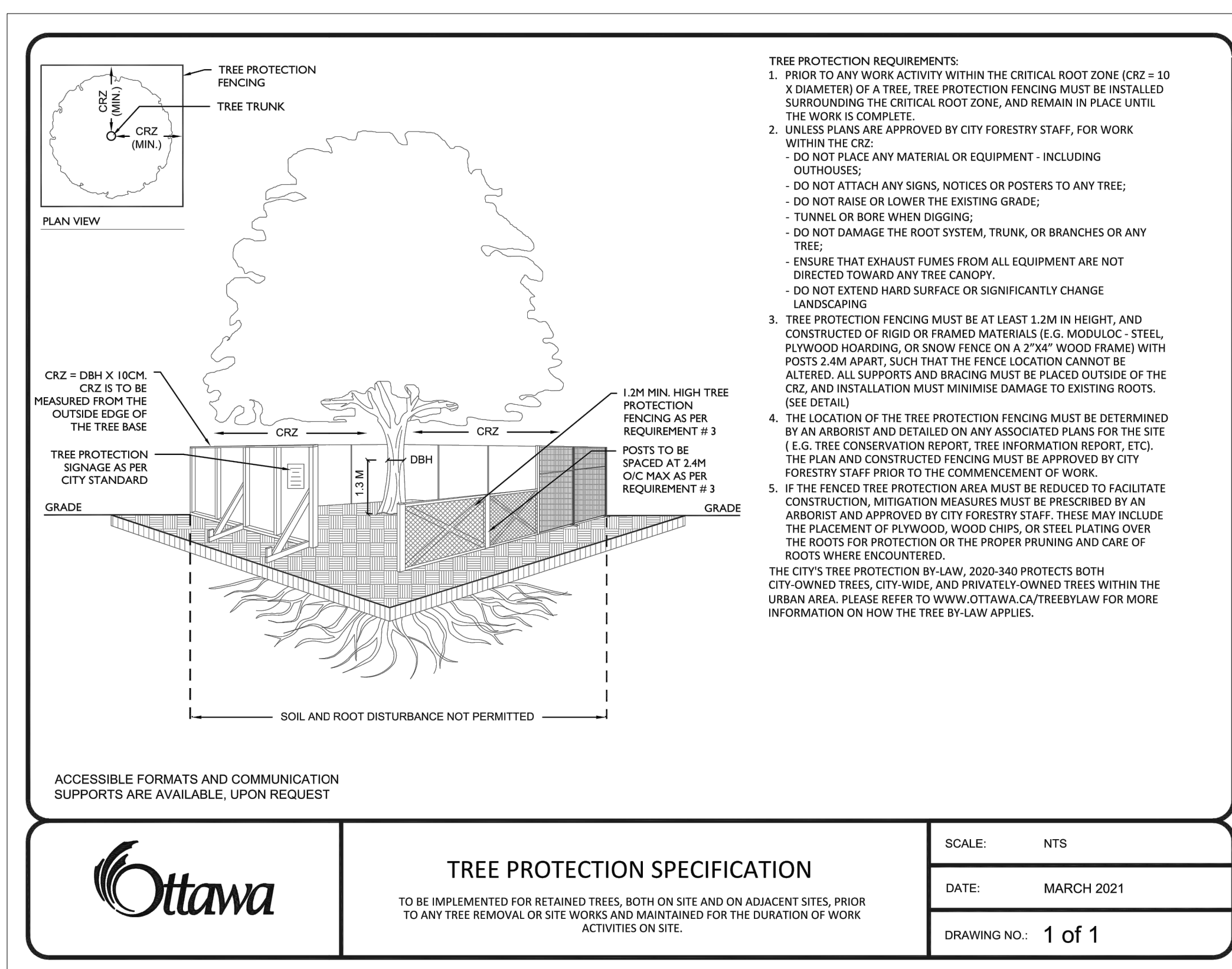

06 TREE PROTECTION FENCE
SCALE: NTS

Andrew McCreight

ANDREW MCCREIGHT
MANAGER (A), DEVELOPMENT REVIEW CENTRAL
PLANNING, REAL ESTATE & ECONOMIC DEVELOPMENT
DEPARTMENT, CITY OF OTTAWA

APPROVED
By Andrew McCreight at 2:08 pm, Dec 14, 2023

<p>TREE PROTECTION SPECIFICATION TO BE IMPLEMENTED FOR RETAINED TREES, BOTH ON SITE AND ON ADJACENT SITES, PRIOR TO ANY TREE REMOVAL OR SITE WORKS AND MAINTAINED FOR THE DURATION OF THE ACTIVITIES ON SITE.</p>	SCALE: NTS
	DATE: MARCH 2021
	DRAWING NO: 1 of 1

ISSUED FOR SITE PLAN CONTROL - NOT FOR CONSTRUCTION 2023-03-24

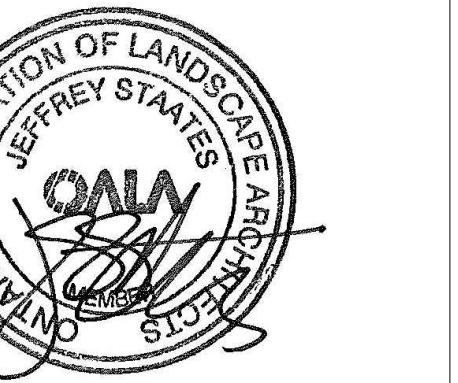

PROJECT

LEBRETON LIBRARY
PARCEL
665 Albert St
Ottawa, ON
Canada



DREAM
30 Adelaide St. E., Suite 301,
Toronto, ON M5C 3H1
KEYPLAN

ISSUE CHART

NO.	REVISION	DATE
1	ISSUED FOR SITE PLAN CONTROL	2023-03-24
2	REVISION FOR CIVIL REVIEW	2023-03-24
3	REVISION FOR CIVIL REVIEW	2023-03-24
4	REVISION FOR CIVIL REVIEW	2023-03-24

Job Number

TITLE

LANDSCAPE DETAILS
PLANTING

SHEET NUMBER

L09-10

© 2023 Perkins and Will

01/1916

NOTE: TREE PLANTING SUBSTRATE WILL BE COMPRISED OF A MIXTURE OF SOIL CELLS, GROWING MEDIUM, AND STRUCTURAL SOILS SUFFICIENT TO PROVIDE REQUIRED SOIL VOLUMES FOR HEALTHY TREE ROOT NETWORKS.

DELETED

01 TREE PLANTING SUBSTRATE AT STREET TREE PLANTING
SCALE: 1:15

02 TREE PLANTING SUBSTRATE UNDER WEDGE PLANTERS
SCALE: 1:15

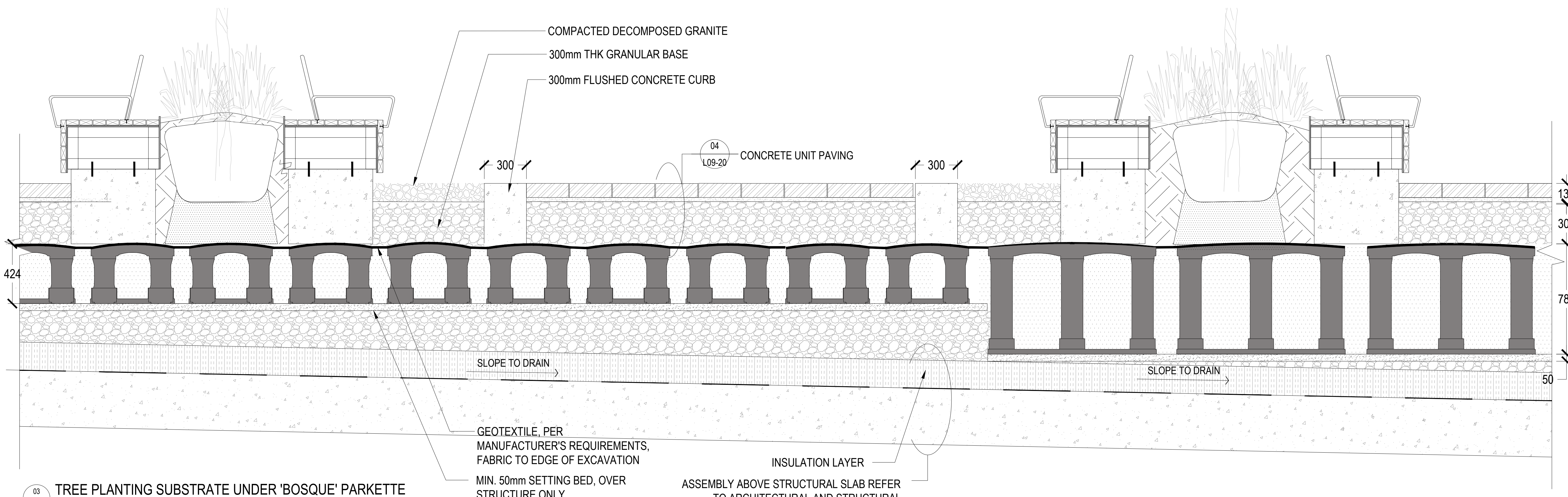
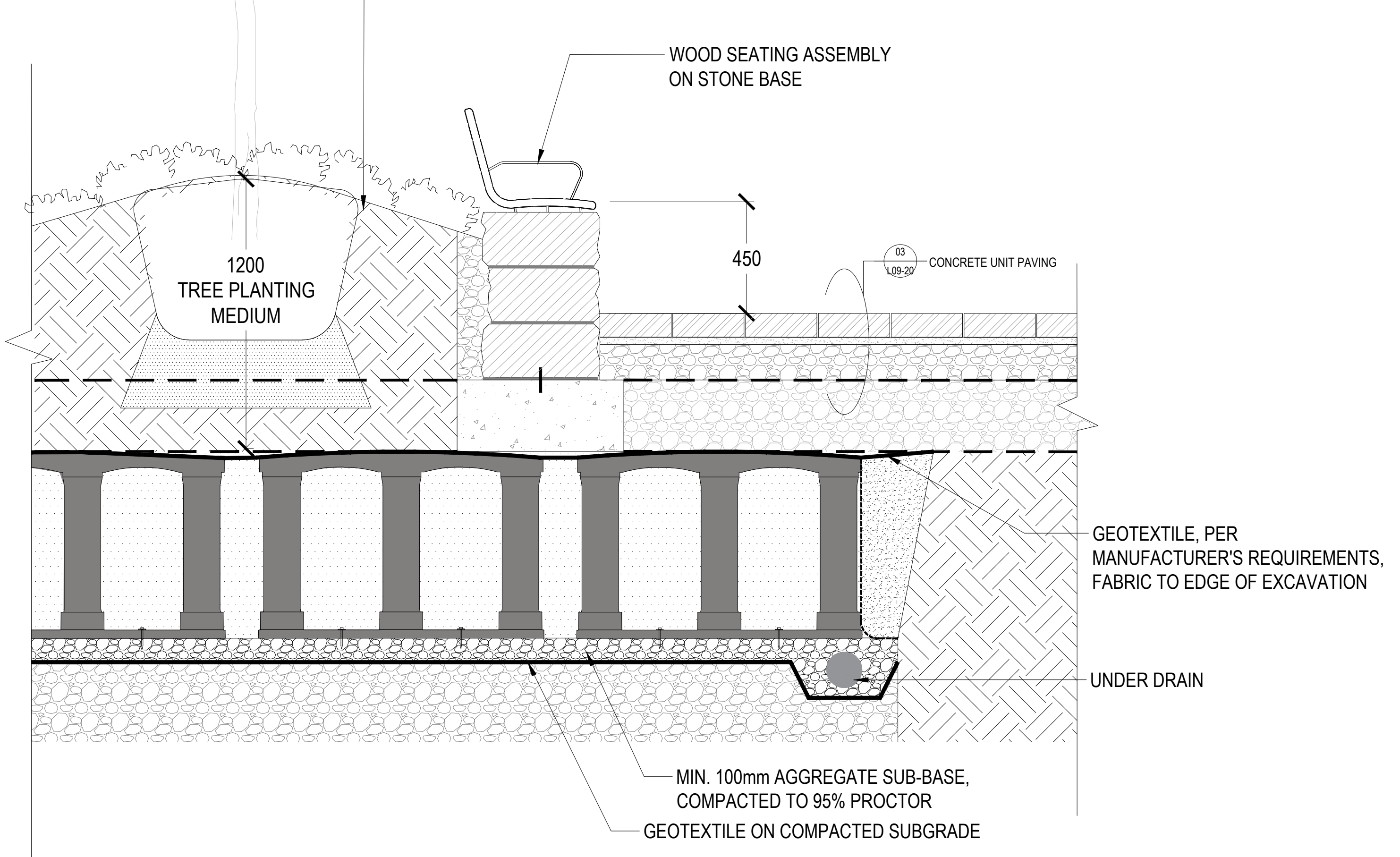

03 TREE PLANTING SUBSTRATE UNDER 'BOSQUE' PARKETTE
SCALE: 1:15

06 CITY GUIDELINE FOR ROOT BARRIER
SCALE: 1:30

Andrew McCreight
ANDREW MCCREIGHT
MANAGER (A), DEVELOPMENT REVIEW CENTRAL
PLANNING, REAL ESTATE & ECONOMIC DEVELOPMENT
DEPARTMENT, CITY OF OTTAWA

APPROVED
By Andrew McCreight at 2:08 pm, Dec 14, 2023

DELETED

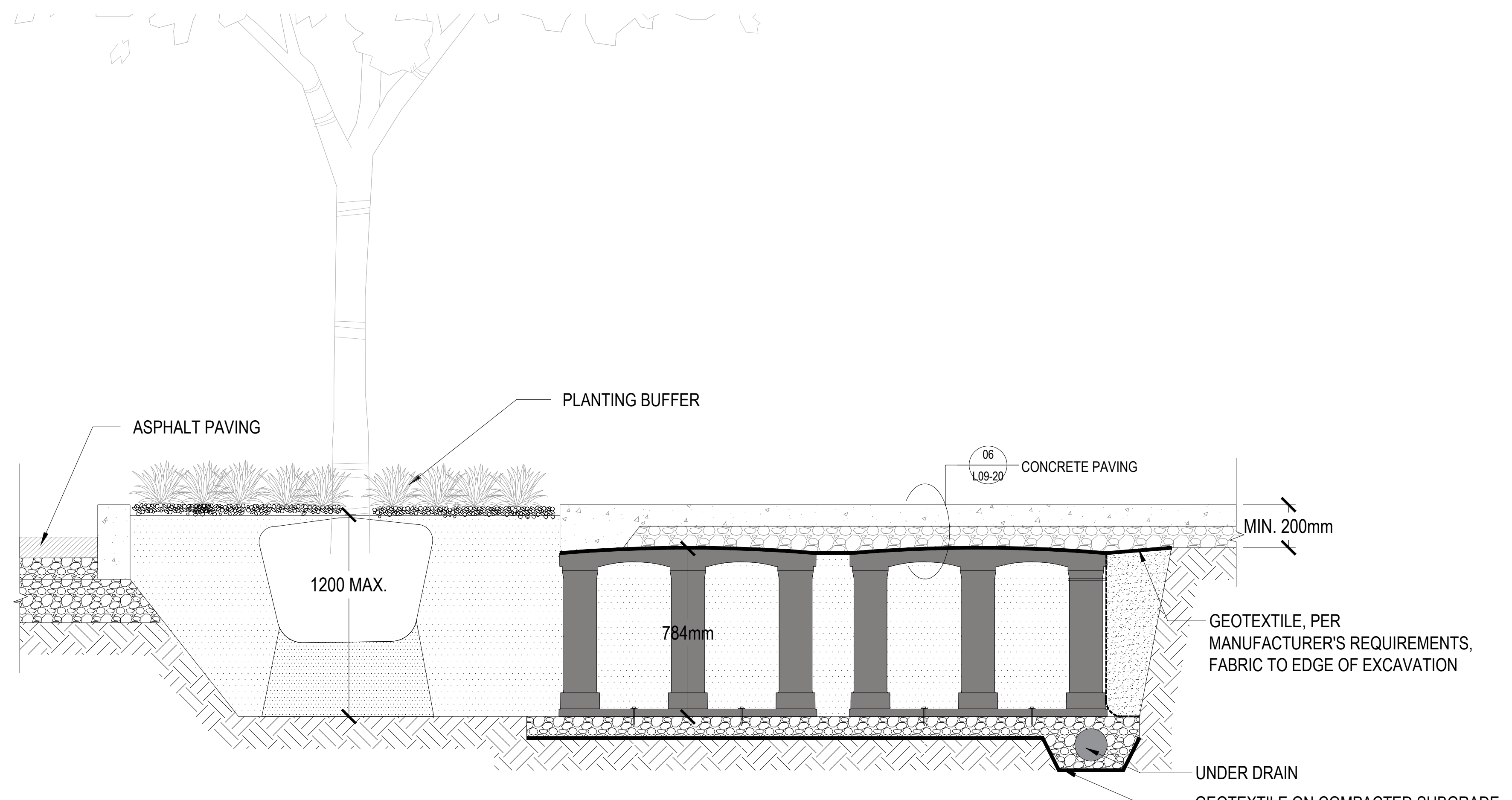

04 TREE PLANTING SUBSTRATE UNDER CONCRETE MUP
SCALE: 1:15

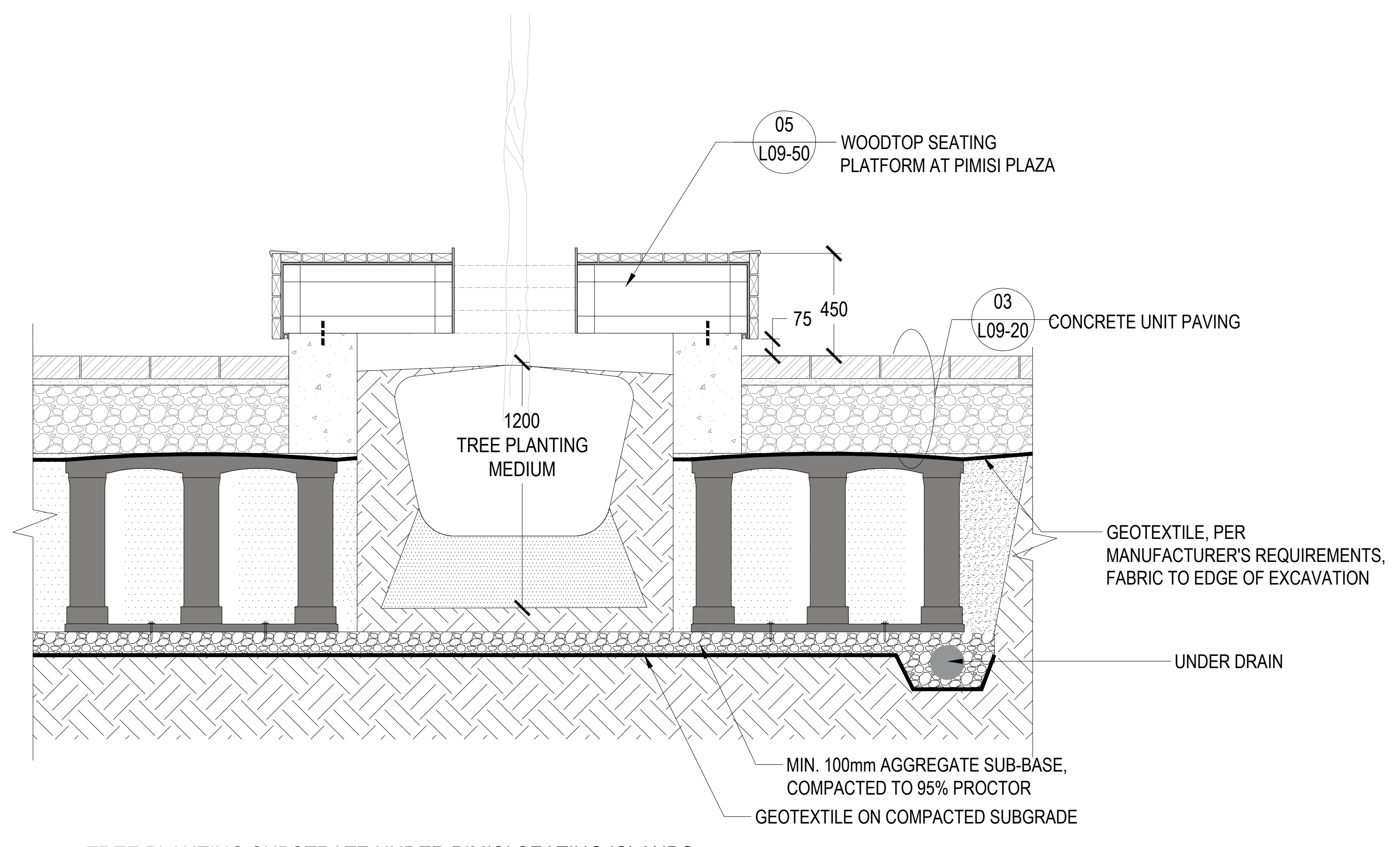

05 TREE PLANTING SUBSTRATE UNDER PIMISI SEATING ISLANDS
SCALE: 1:15

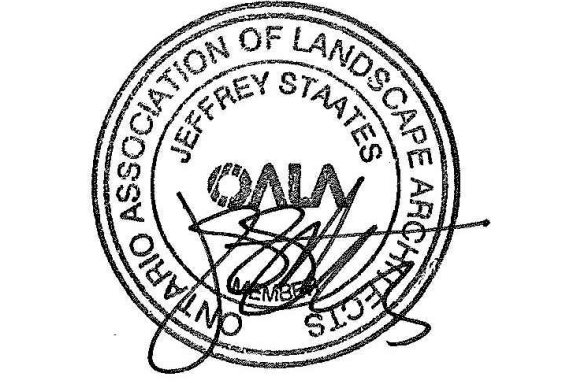

PROJECT

LEBRETON LIBRARY PARCEL
665 Albert St
Ottawa, ON
Canada

dream

DREAM
30 Adelaide St. E., Suite 301,
Toronto, ON M5C 3H1
KEYPLAN

ISSUED FOR SITE PLAN CONTROL - NOT FOR CONSTRUCTION 2023-03-24

ISSUE CHART

NO.	REVISION	DATE
1	ISSUED FOR SITE PLAN CONTROL	2023-03-24
2	REVISION FOR BAA REVIEW	2023-04-01
3	REVISION FOR CPA REVIEW	2023-11-28
4	REVISION FOR CPA REVIEW	2023-12-14

Job Number

TITLE
LANDSCAPE DETAILS
TREE PLANTING
SUBSTRATE

SHEET NUMBER

L09-12

CONSULTANTS

civil:
TMIG
8800 Dufferin St., Suite 200, Vaughan, ON L4R 0C5
structural:
RJC Engineers
1545 Carlin Ave., Suite 304, Ottawa, ON K1Z 8P9
sep
Smith+Andersen
1600 Carling Ave., Suite 530, Ottawa, ON K1Z 1G3
landscape:
PFS Studio
1777 W 3rd Ave., Vancouver, BC V6J 1KJ
consultant:
Two Row Architect
1804 6th Line, Oshawa, ON N6A 1M0
contractor:
Eli&Dan
2680 Queensview Dr., Ottawa, ON K2B 6J9

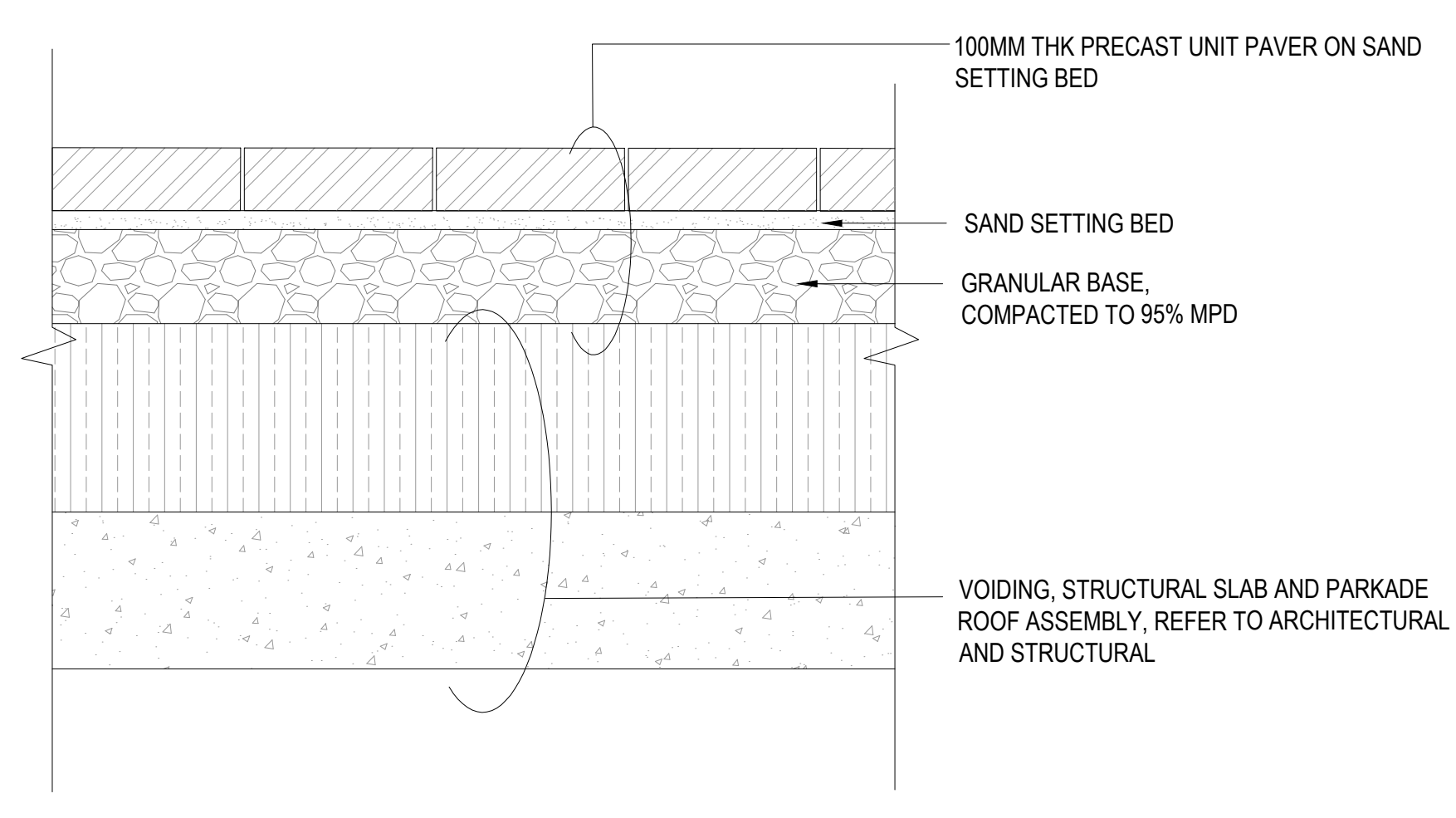

01 PEDESTRIAN PRECAST UNIT PAVING ON SLAB
SCALE: 1:10

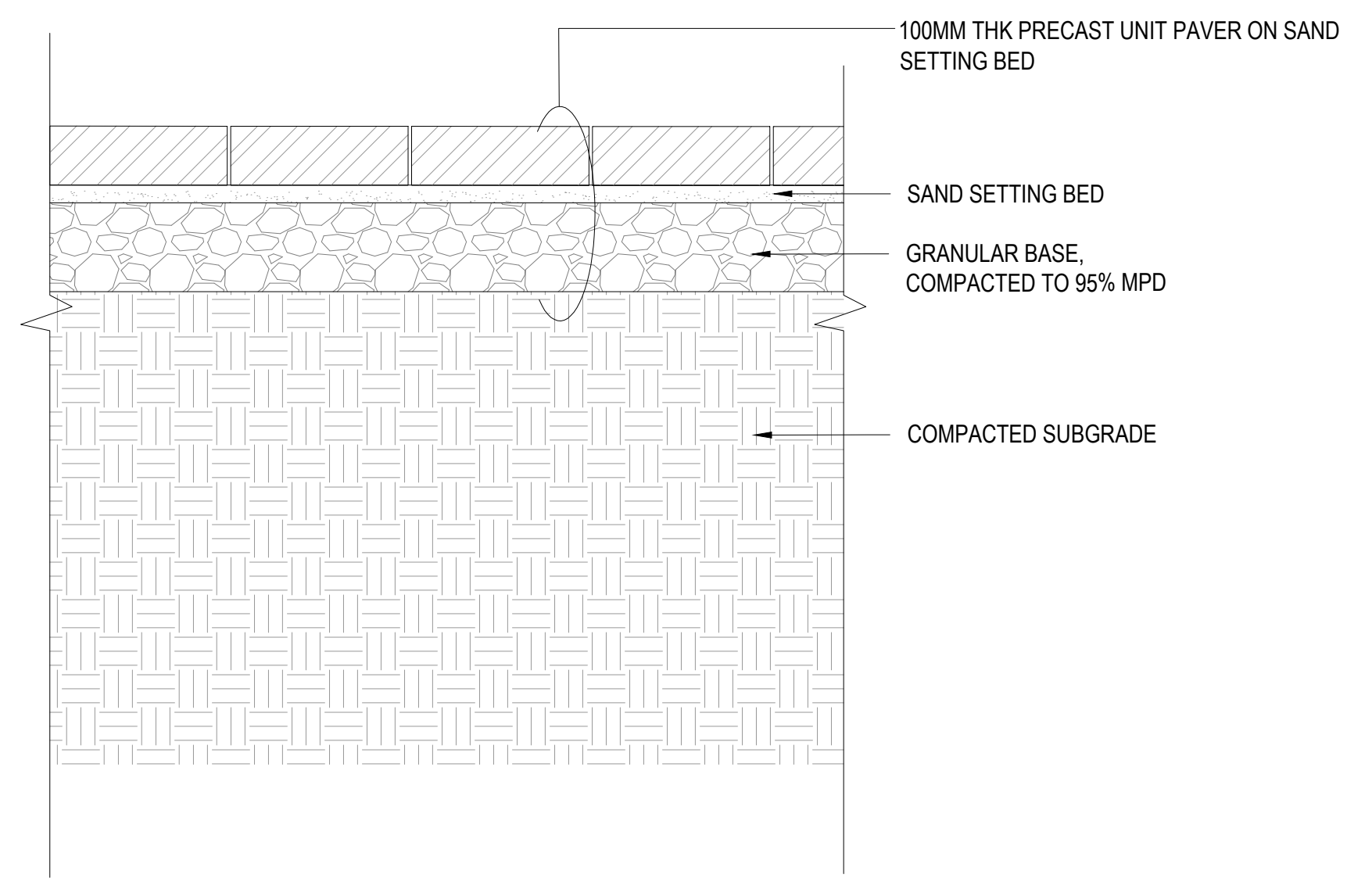

02 PEDESTRIAN PRECAST UNIT PAVING ON GRADE
SCALE: 1:10

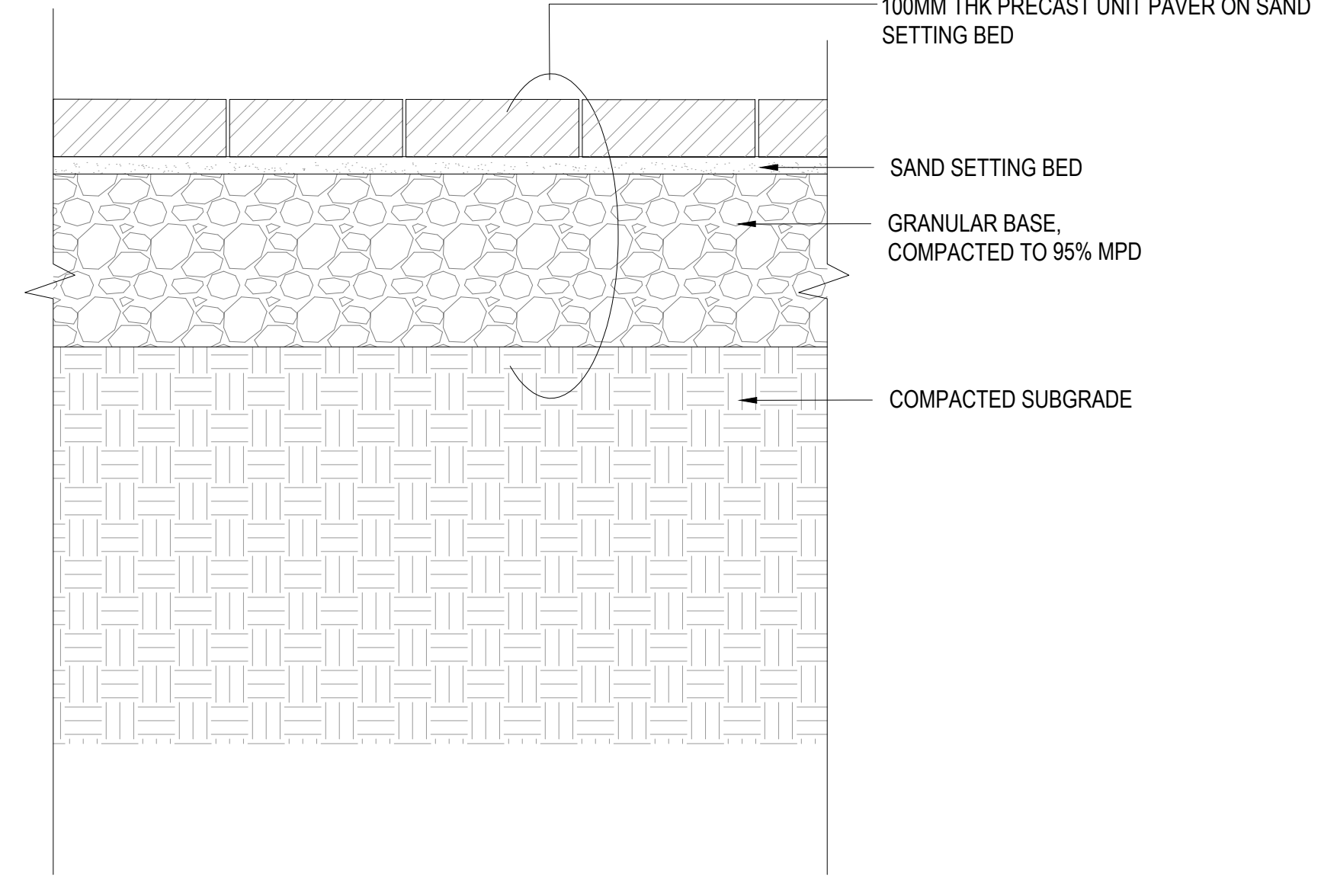

03 VEHICULAR PRECAST UNIT PAVING ON GRADE
SCALE: 1:10

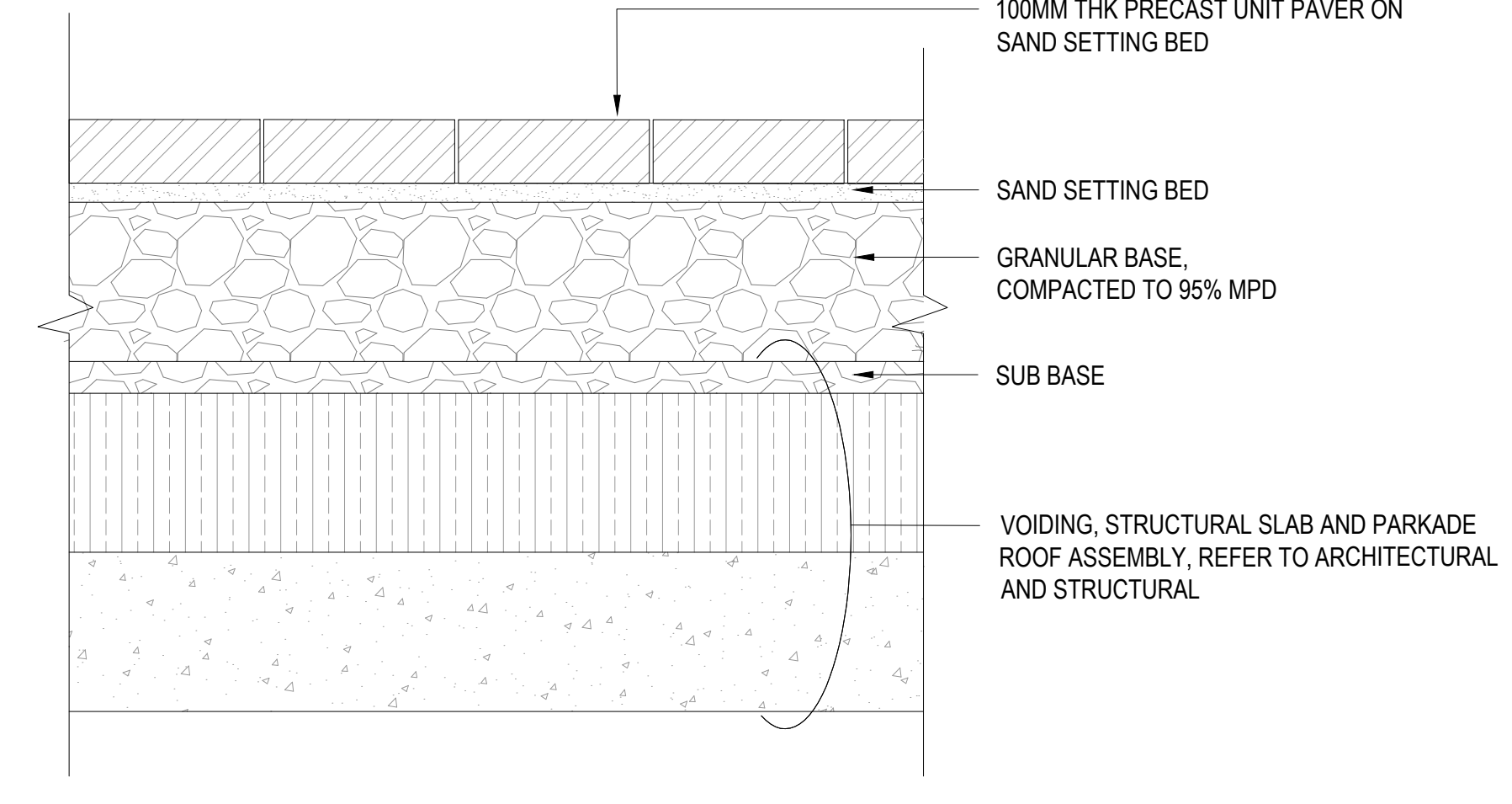

04 VEHICULAR CONCRETE UNIT PAVER ON SLAB
SCALE: 1:10

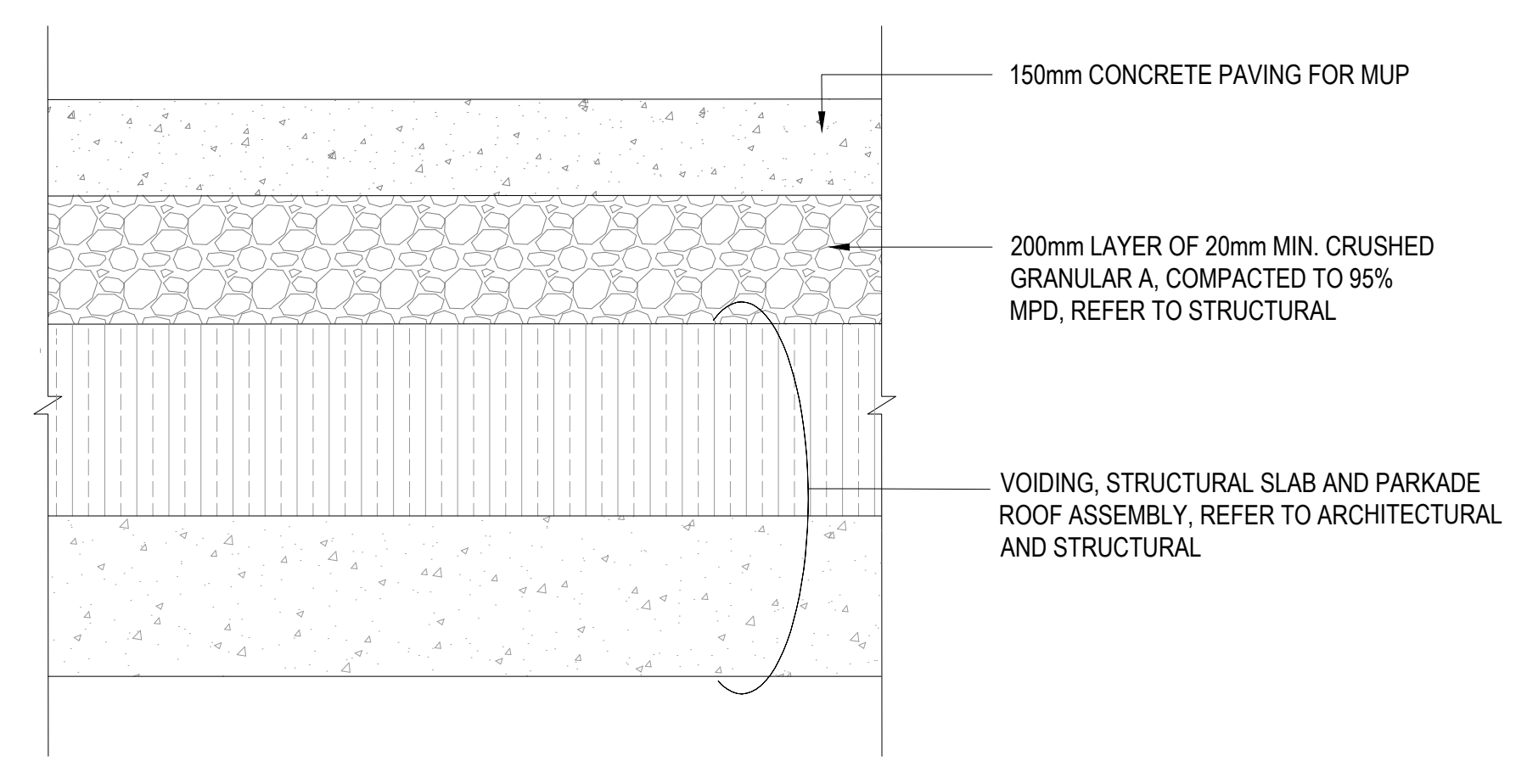

05 CONCRETE PAVING ON SLAB
SCALE: 1:10

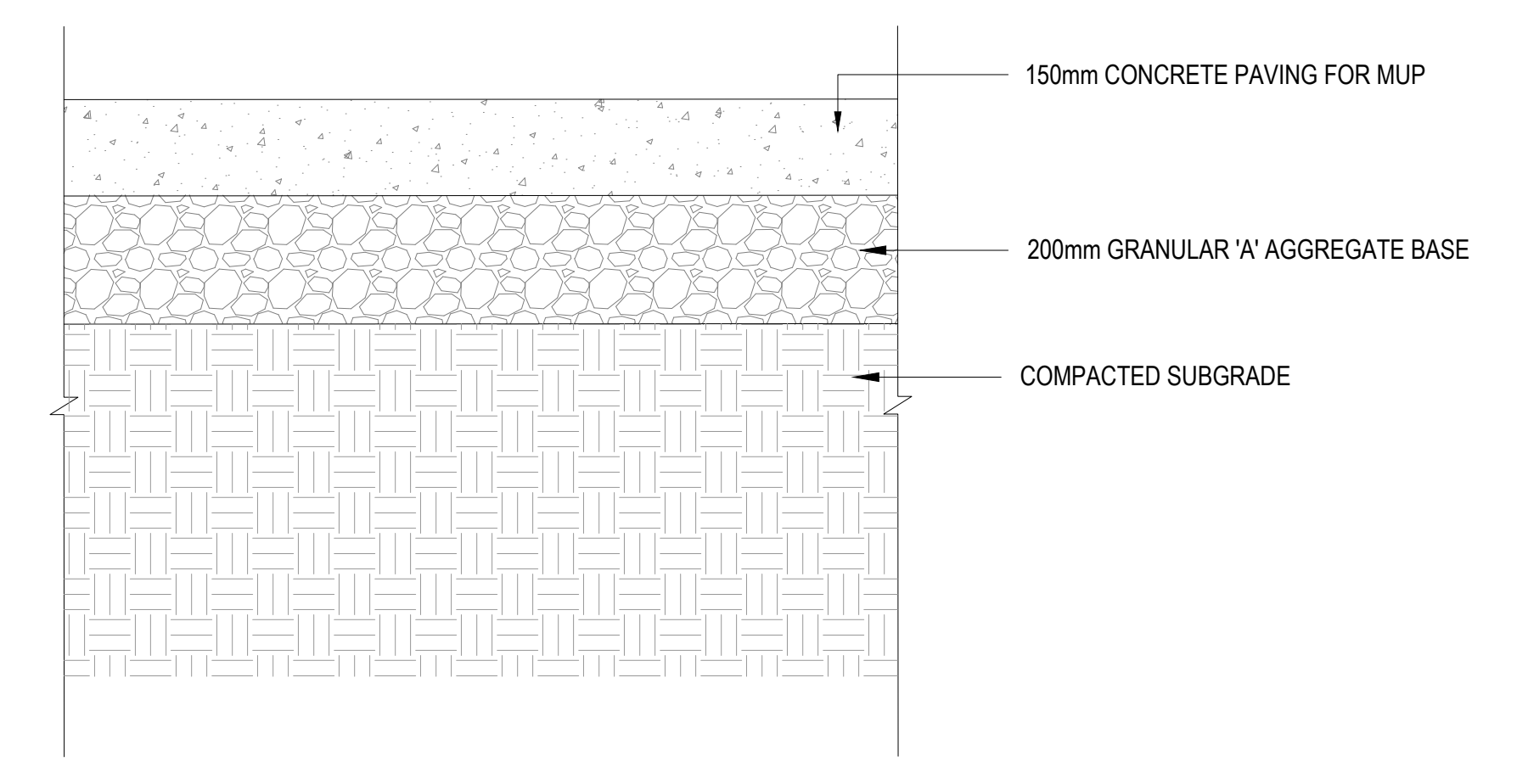

06 CONCRETE PAVING ON GRADE
SCALE: 1:10

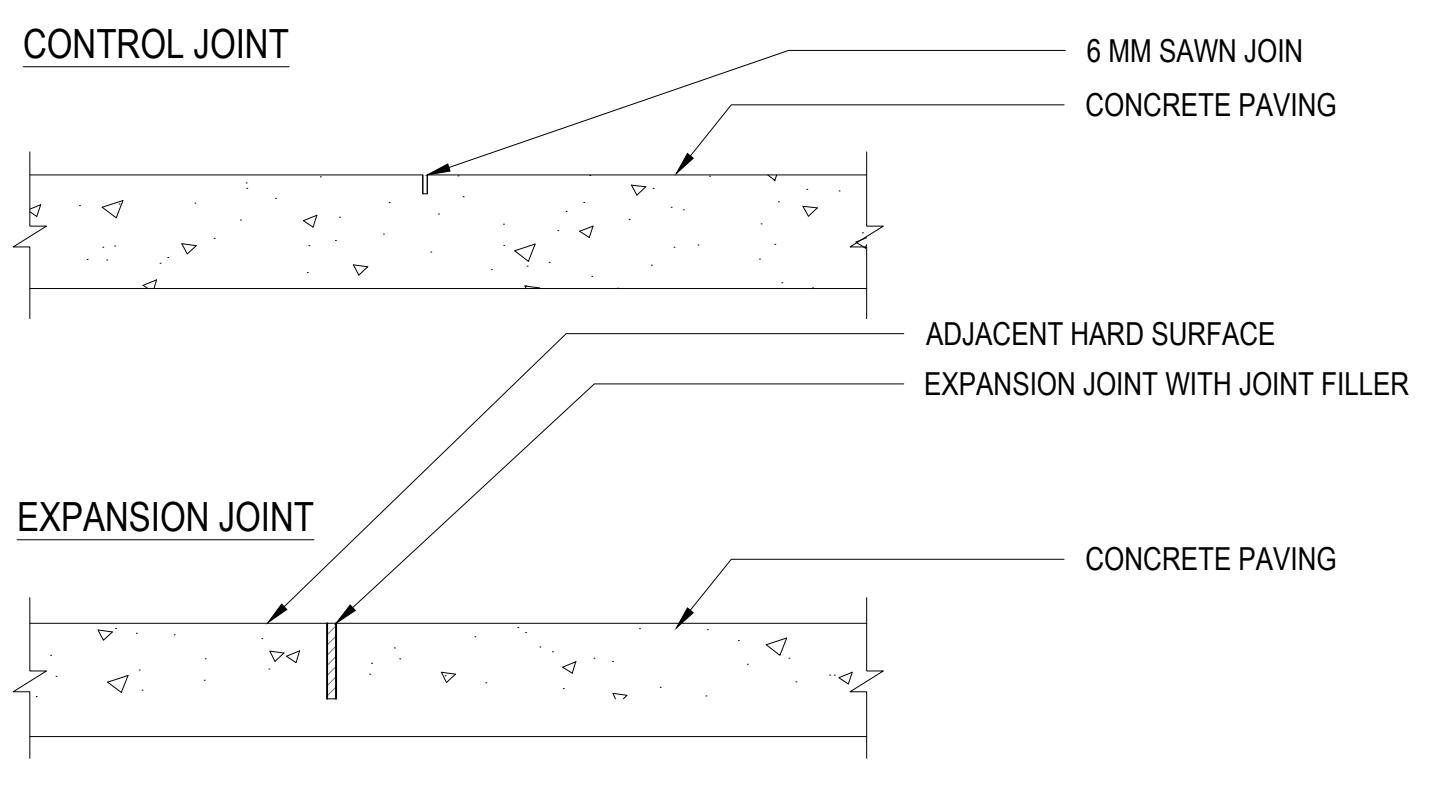

07 CONCRETE PAVING JOINTS
SCALE: 1:10

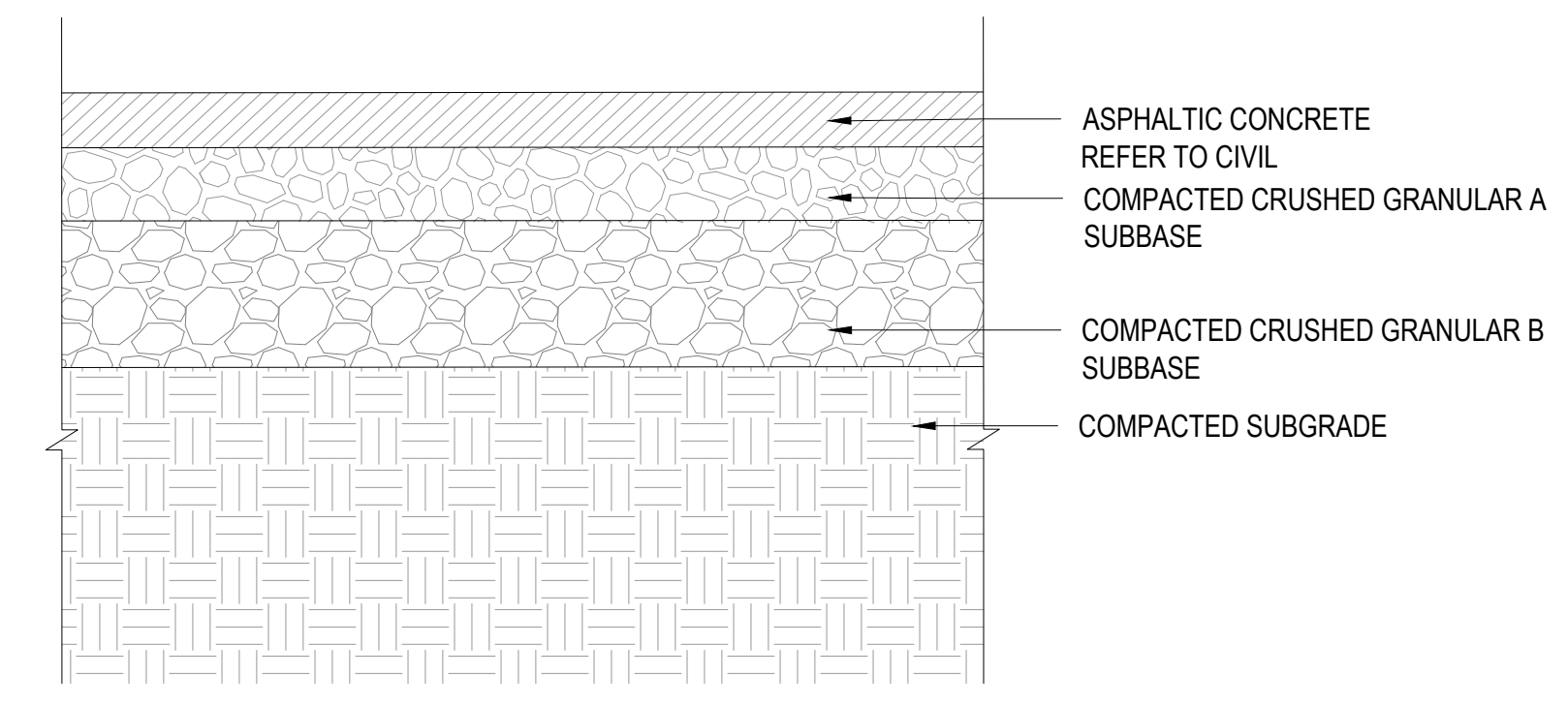

08 ASPHALT BIKE LANE
SCALE: 1:10

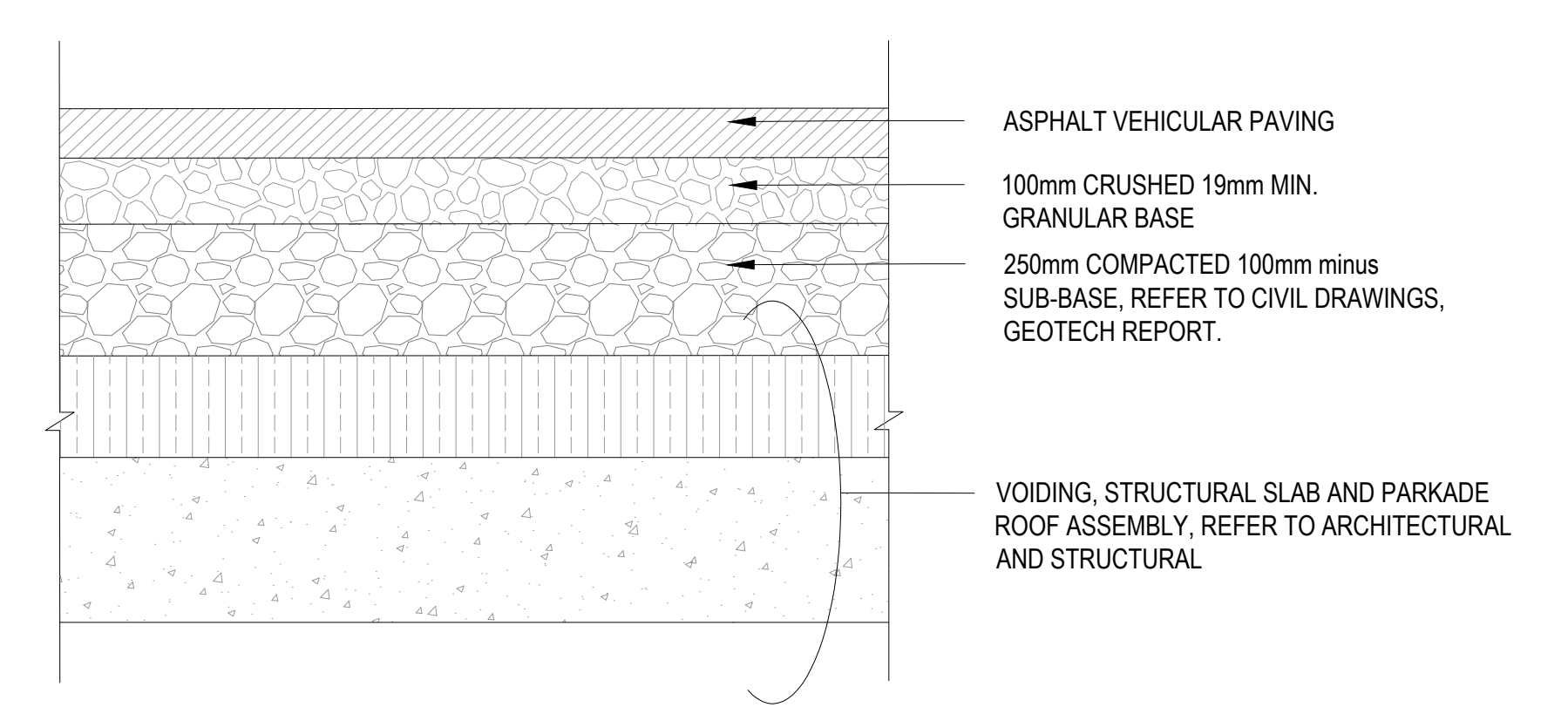

09 ASPHALT VEHICULAR PAVING ON SLAB
SCALE: 1:10

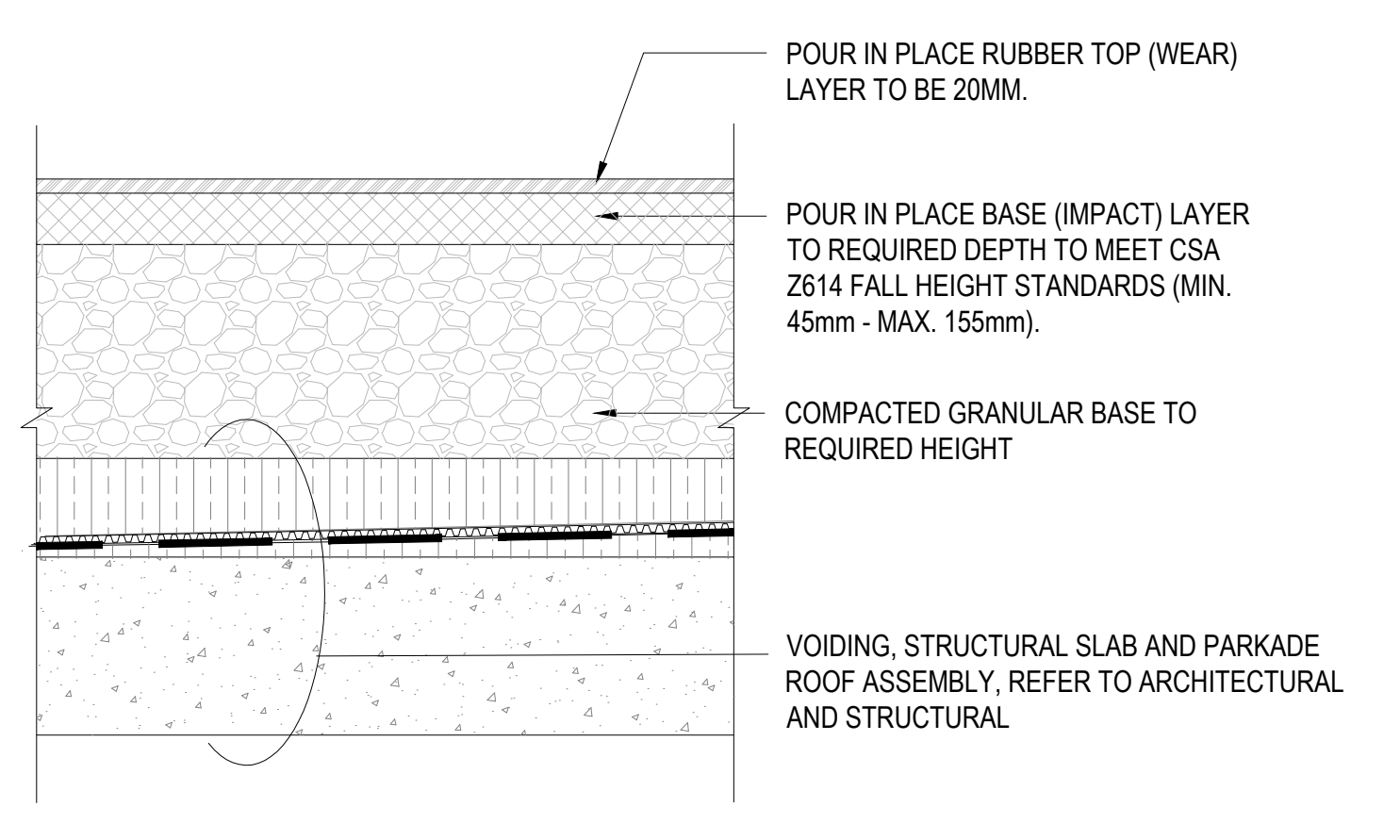

10 RESILIENT PLAY SURFACE AT 'BOSQUE'
SCALE: 1:10

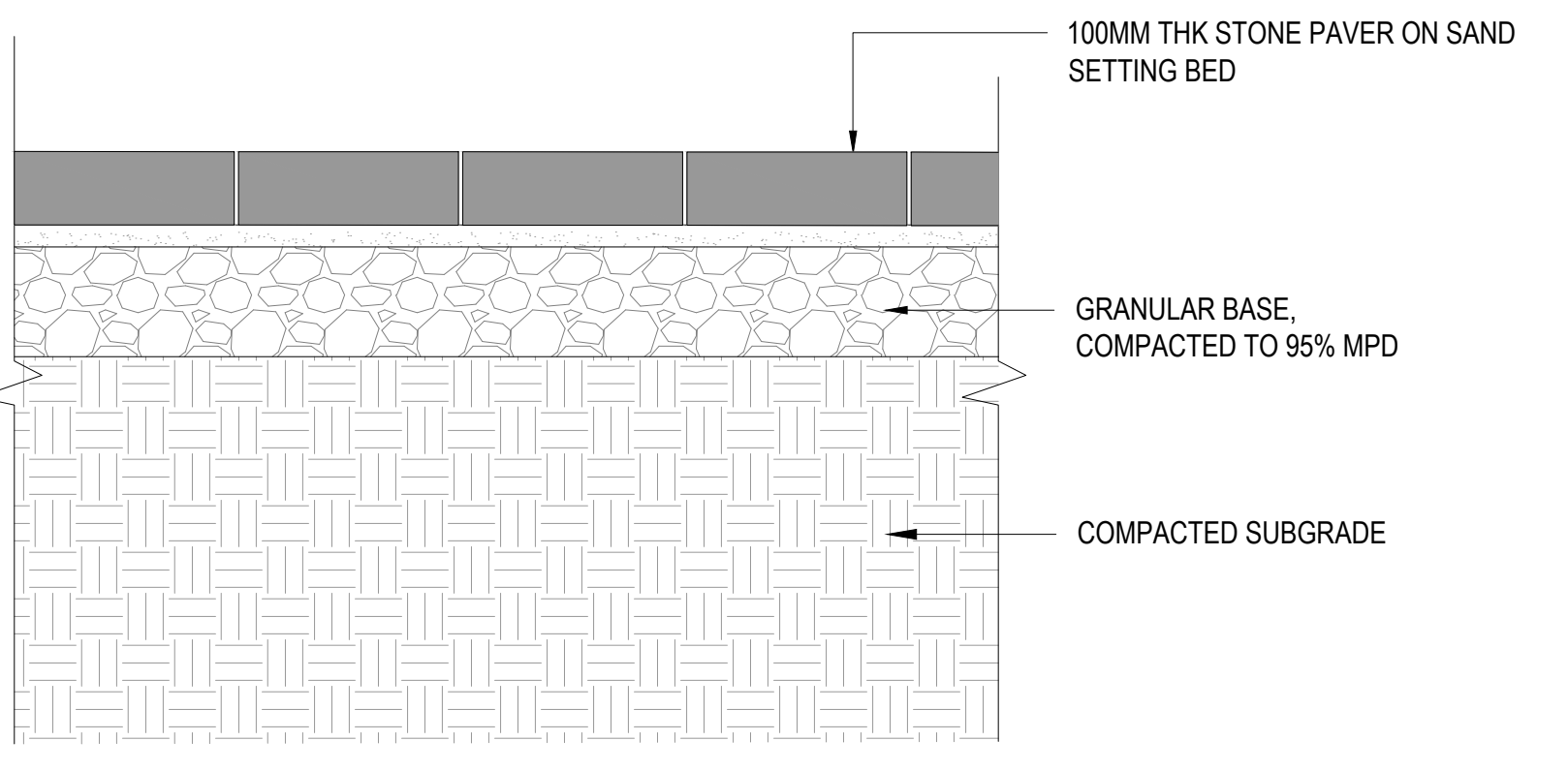

11 STONE PAVER AT GATHERING CIRCLE
SCALE: 1:10

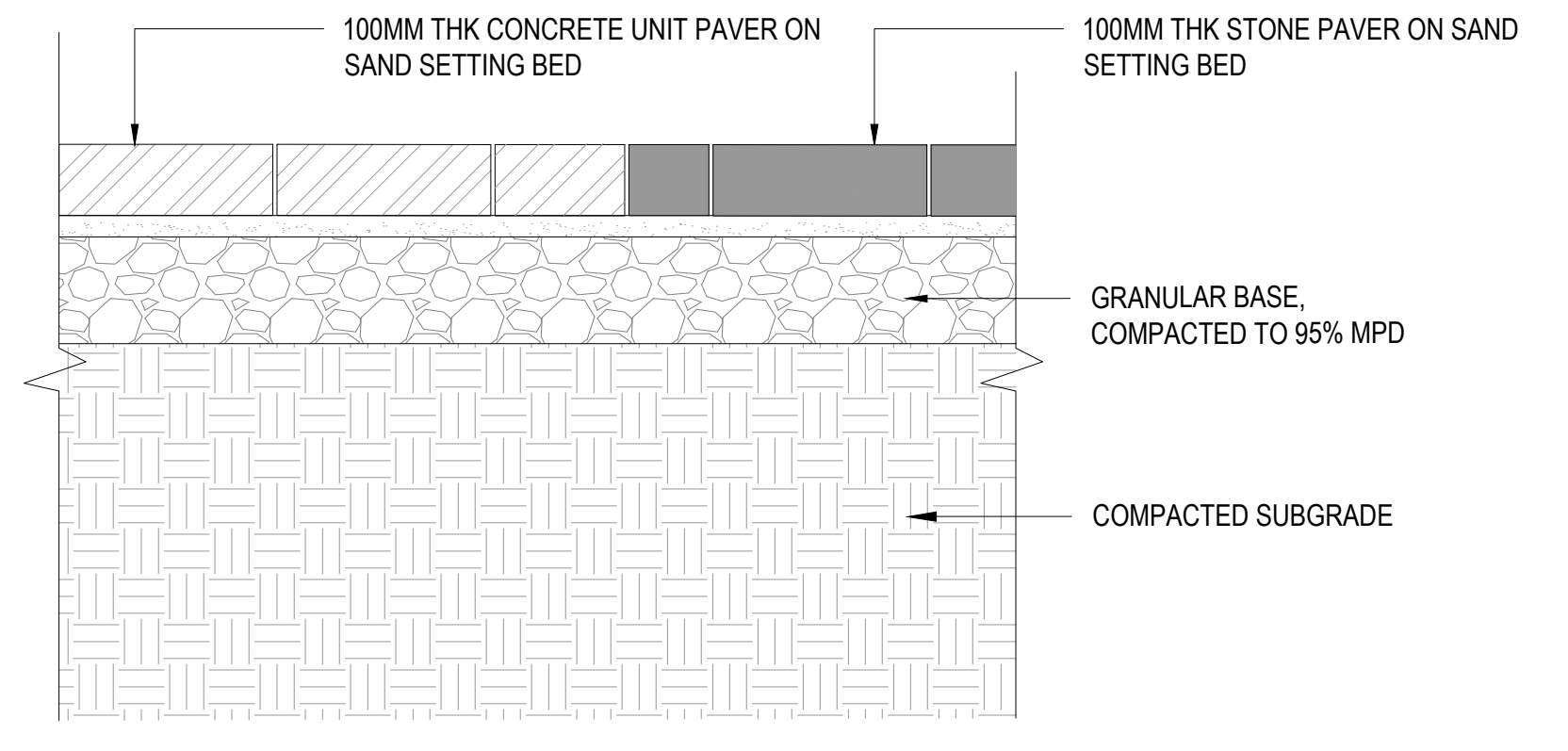

12 STONE AND CONCRETE UNIT PAVER JOINT
SCALE: 1:10



ISSUED FOR SITE PLAN CONTROL - NOT FOR CONSTRUCTION 2023-03-24

PROJECT

**LEBRETON LIBRARY
PARCEL**
665 Albert St
Ottawa, ON
Canada



DREAM
30 Adelaide St. E., Suite 301,
Toronto, ON M5C 3H1
KEYPLAN

ISSUE CHART

NO	REVISION	DATE
1	ISSUED FOR SITE PLAN CONTROL	2023-03-24
2	REVISION FOR MUP PAVING	2023-03-24
3	REVISION FOR CIVIL SUBBASE	2023-03-24
4	REVISION FOR CIVIL SUB-BASE	2023-03-24
5	REVISION FOR CIVIL SUB-BASE	2023-03-24

Job Number _____ TITLE _____

**LANDSCAPE DETAILS
PAVING**

SHEET NUMBER

L09-20

© 2023 Perkins and Will #18916

Andrew McCreight
ANDREW MCCREIGHT
MANAGER (A), DEVELOPMENT REVIEW CENTRAL
PLANNING, REAL ESTATE & ECONOMIC DEVELOPMENT
DEPARTMENT, CITY OF OTTAWA

APPROVED
By Andrew McCreight at 2:08 pm, Dec 14, 2023

CONSULTANTS

- cmv
- TMIG
8800 Dufferin St., Suite 200, Vaughan, ON L4K 0G5
STRUCTURAL
- RJC Engineers
1545 Carlin Ave., Suite 304, Ottawa, ON K1Z 8P9
SEP
- Smith+Anderson
1600 Carling Ave., Suite 500, Ottawa, ON K1Z 1G3
LANDSCAPE
- PFS Studio
1777 W 3rd Ave., Vancouver, BC V6J 1K1
CONSULTANT
- Two Row Architect
1804 6th Line, Chesham, ON N5A 1M0
CONTRACTOR
- ES&D
2680 Queensview Dr., Ottawa, ON K2B 8J9

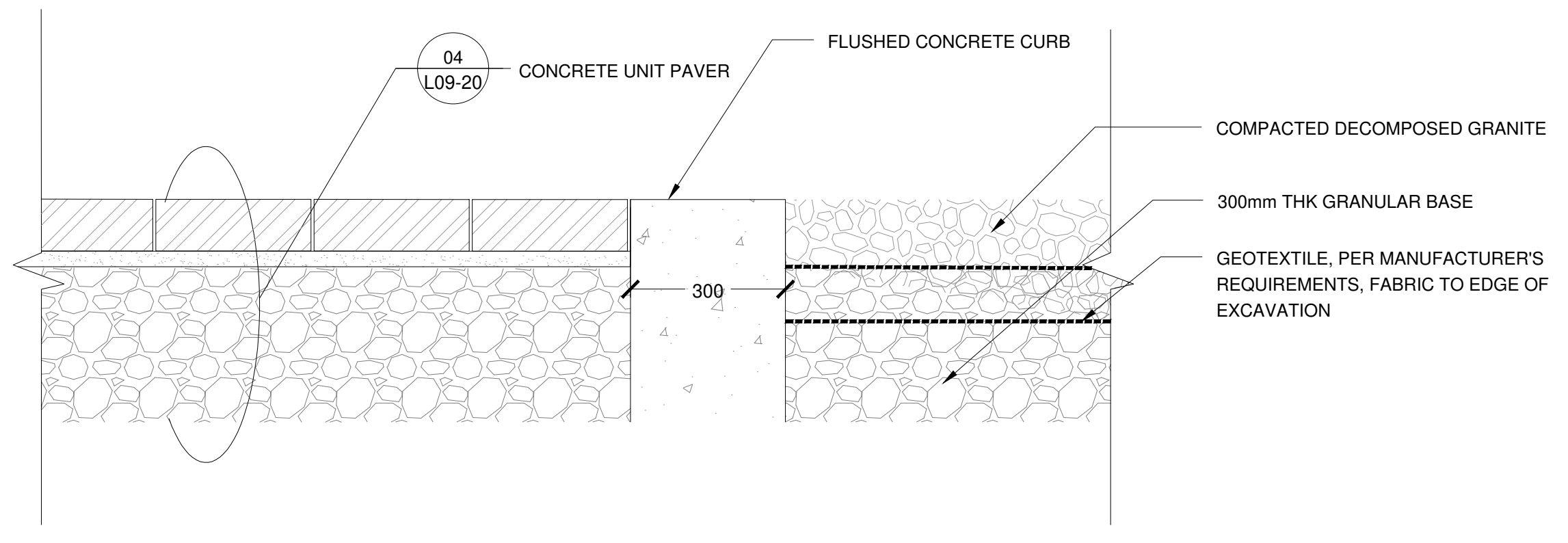

01 FLUSHED CONCRETE CURB AT DECOMPOSED GRANITE PAVING
SCALE: 1:10

DELETED

02 METAL EDGER AT STREET TREE PLANTING
SCALE: 1:10

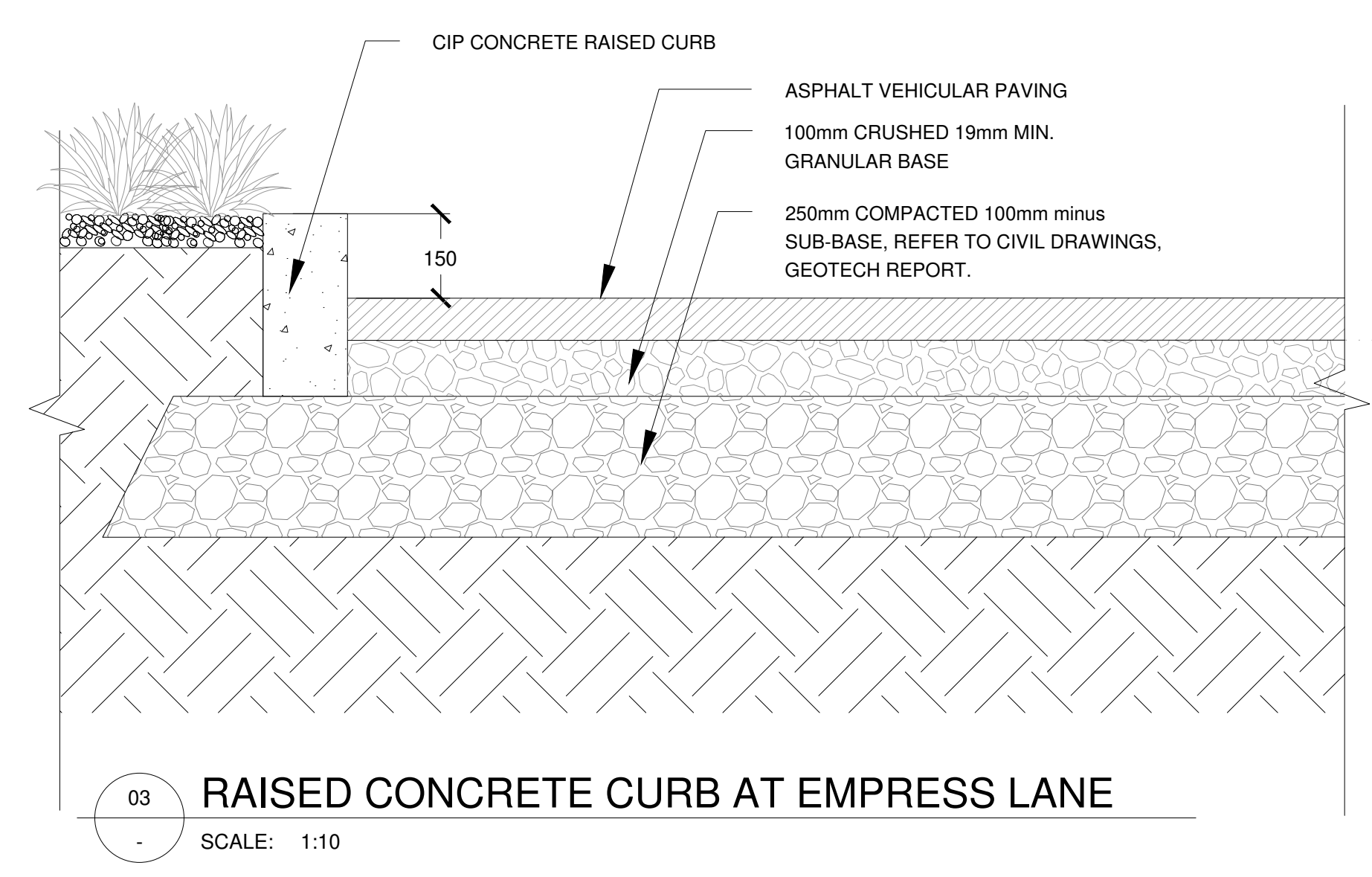

03 RAISED CONCRETE CURB AT EMPRESS LANE
SCALE: 1:10

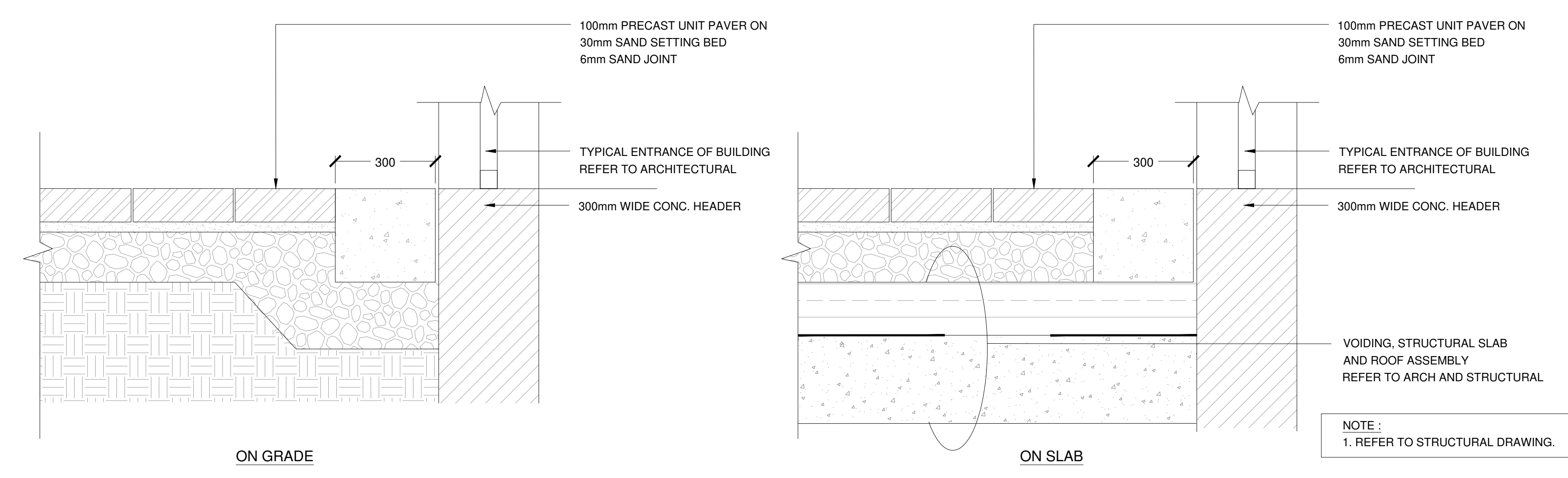

04 PRECAST UNIT PAVER AT BUILDING EDGE
SCALE: 1:10

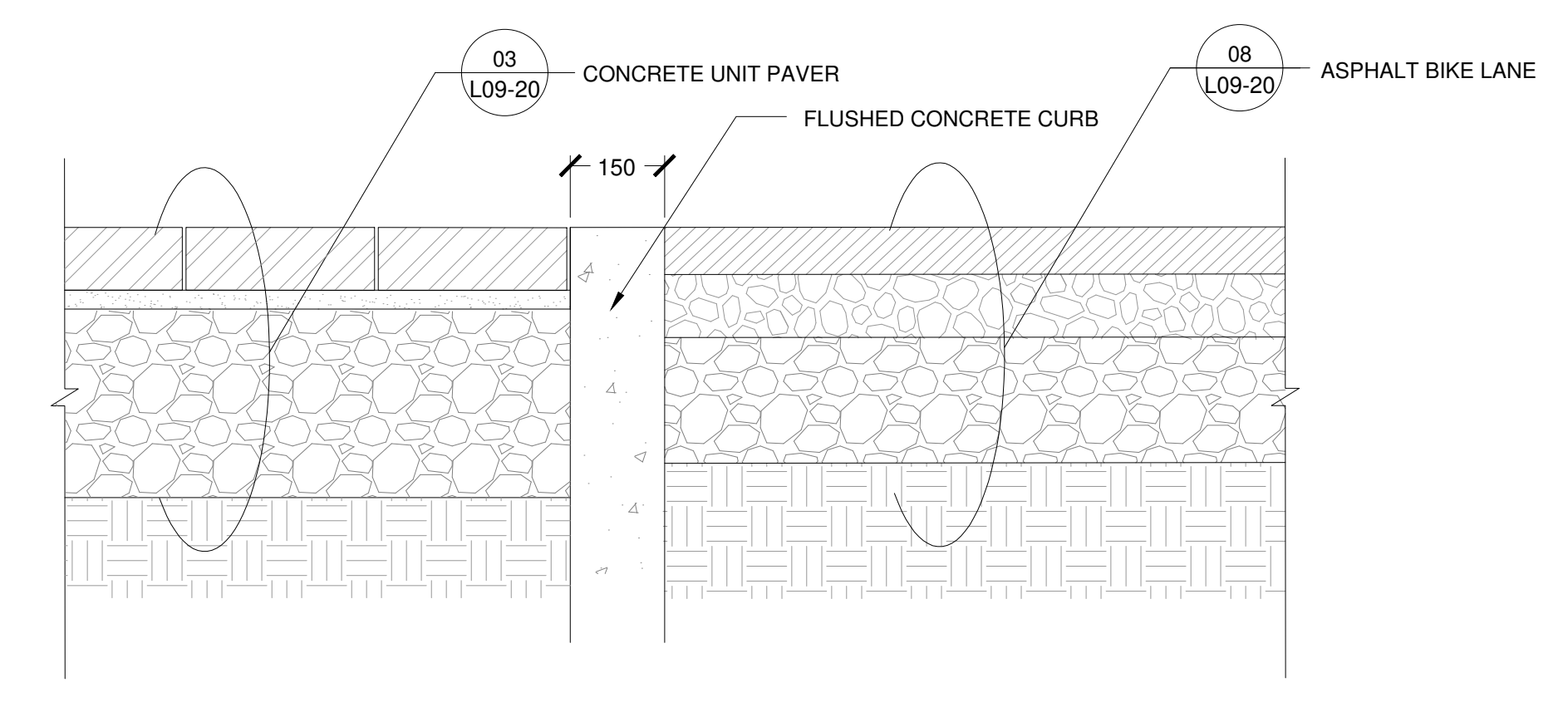

05 FLUSHED CONCRETE CURB AT ASPHALT BIKE LANE
SCALE: 1:10

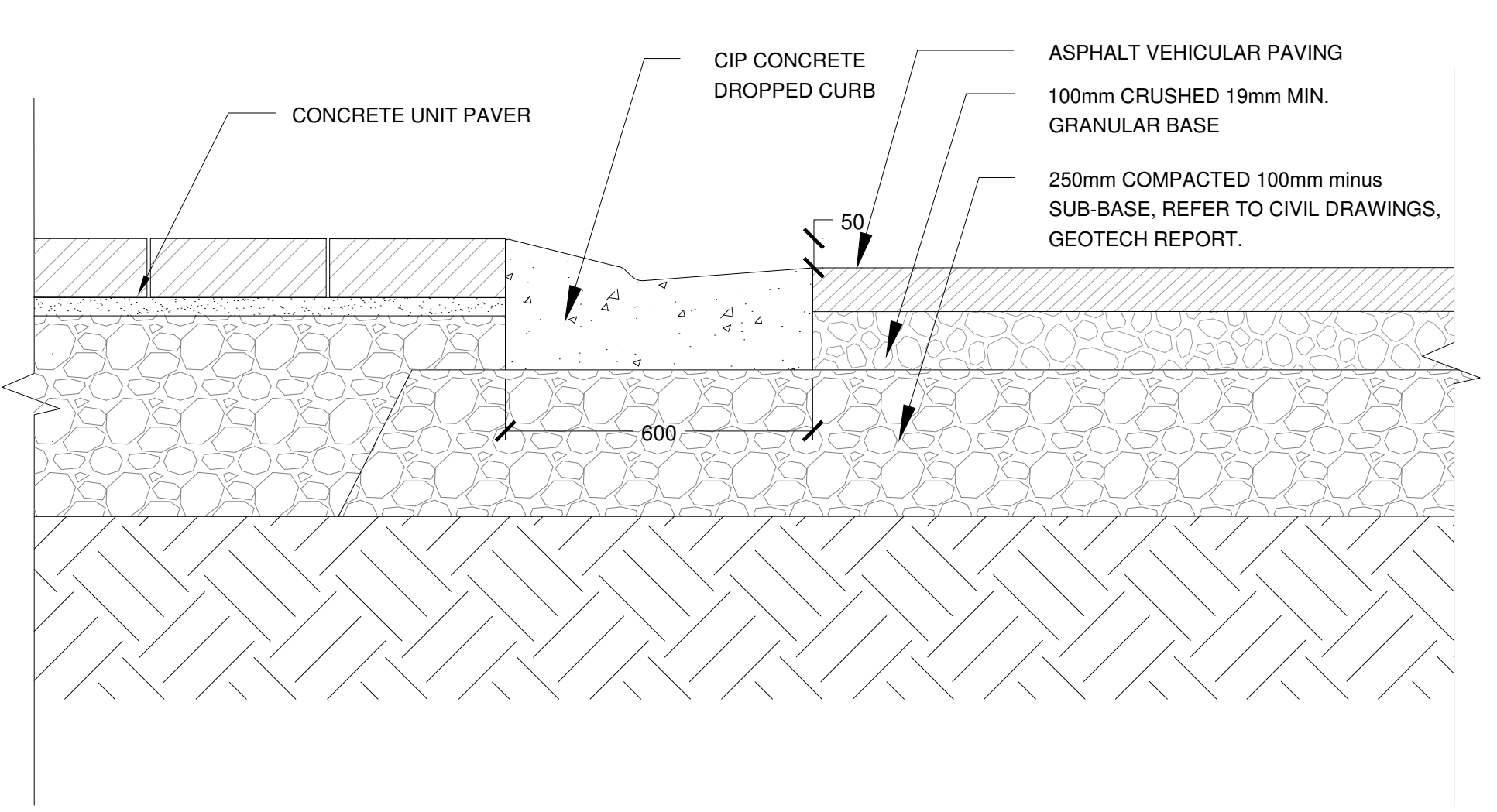

06 DEPRESSED CURB AT PARKING AND LOADING DOCK ENTRANCES
SCALE: 1:10

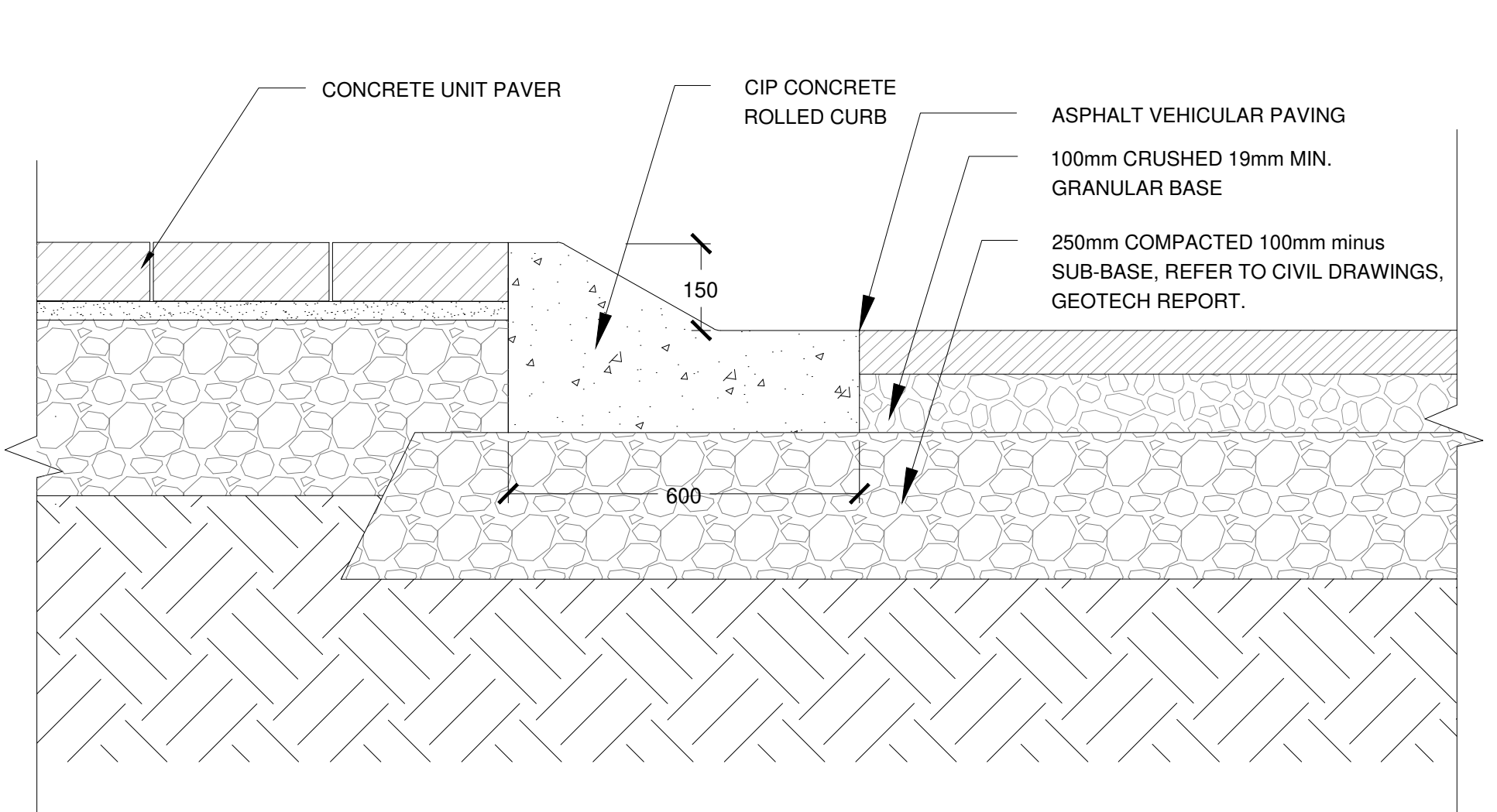

07 ROLLED CURB AT EMPRESS LANE
SCALE: 1:10

Andrew McCreight

ANDREW MCCREIGHT
MANAGER (A), DEVELOPMENT REVIEW CENTRAL
PLANNING, REAL ESTATE & ECONOMIC DEVELOPMENT
DEPARTMENT, CITY OF OTTAWA

APPROVED
By Andrew McCreight at 2:08 pm, Dec 14, 2023

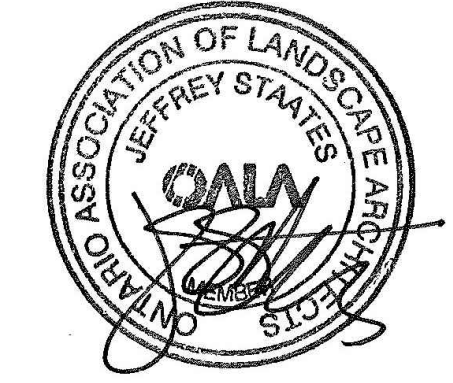

ISSUED FOR SITE PLAN CONTROL - NOT FOR CONSTRUCTION 2023-03-24

LEBRETON LIBRARY
PARCEL
665 Albert St
Ottawa, ON
Canada



DREAM
30 Adelaide St. E., Suite 301,
Toronto, ON M5C 3H1
KEYPLAN

ISSUE CHART

NO	REVISION	DATE
1	ISSUED FOR SITE PLAN CONTROL	2023-03-24
2	REVISED FOR PUBLIC REVIEW	2023-03-24
3	REVISED FOR PUBLIC SUBMISSION	2023-11-28
4	REVISED FOR FINAL SUBMISSION	2023-04-25
5	ISSUE	DATE

Job Number

TITLE

CURBS AND EDGING
DETAILS

SHEET NUMBER

L09-30