

LEGEND

| | |
|--------|--------------------------|
| FFL | FINISHED FLOOR ELEVATION |
| TOF | TOP OF FOUNDATION |
| BFL | BASEMENT FLOOR ELEVATION |
| USF | UNDERSIDE OF FOOTING |
| --- | PROPERTY LINE |
| CB | CATCH-BASIN |
| -99.99 | EXISTING GRADE ELEVATION |
| +99.99 | PROPOSED GRADE ELEVATION |
| 2% | PROPOSED SLOPE OF GRADE |
| --- | CENTERLINE OF SWALE |
| --- | 150mm BARRIER CURB |
| --- | PAVEMENT |
| --- | CONCRETE |

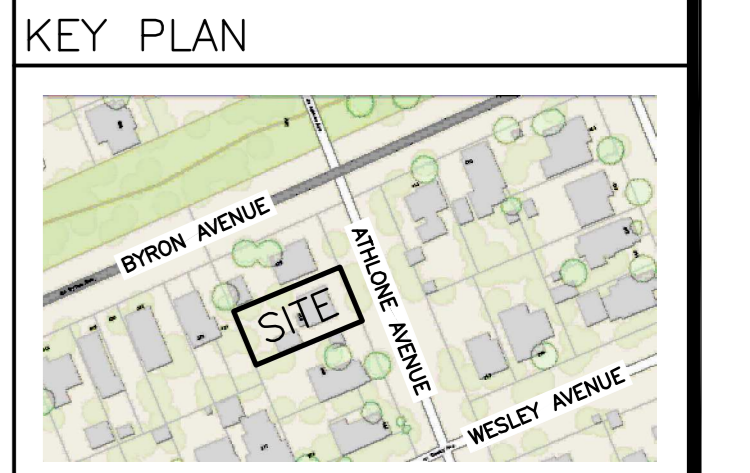

Andrew McCreight

ANDREW MCCREIGHT
MANAGER, DEVELOPMENT REVIEW CENTRAL
PLANNING, DEVELOPMENT & BUILDING SERVICES
DEVELOPMENT DEPARTMENT, CITY OF OTTAWA

APPROVED
 By Andrew McCreight at 2:38 pm, Jul 05, 2024

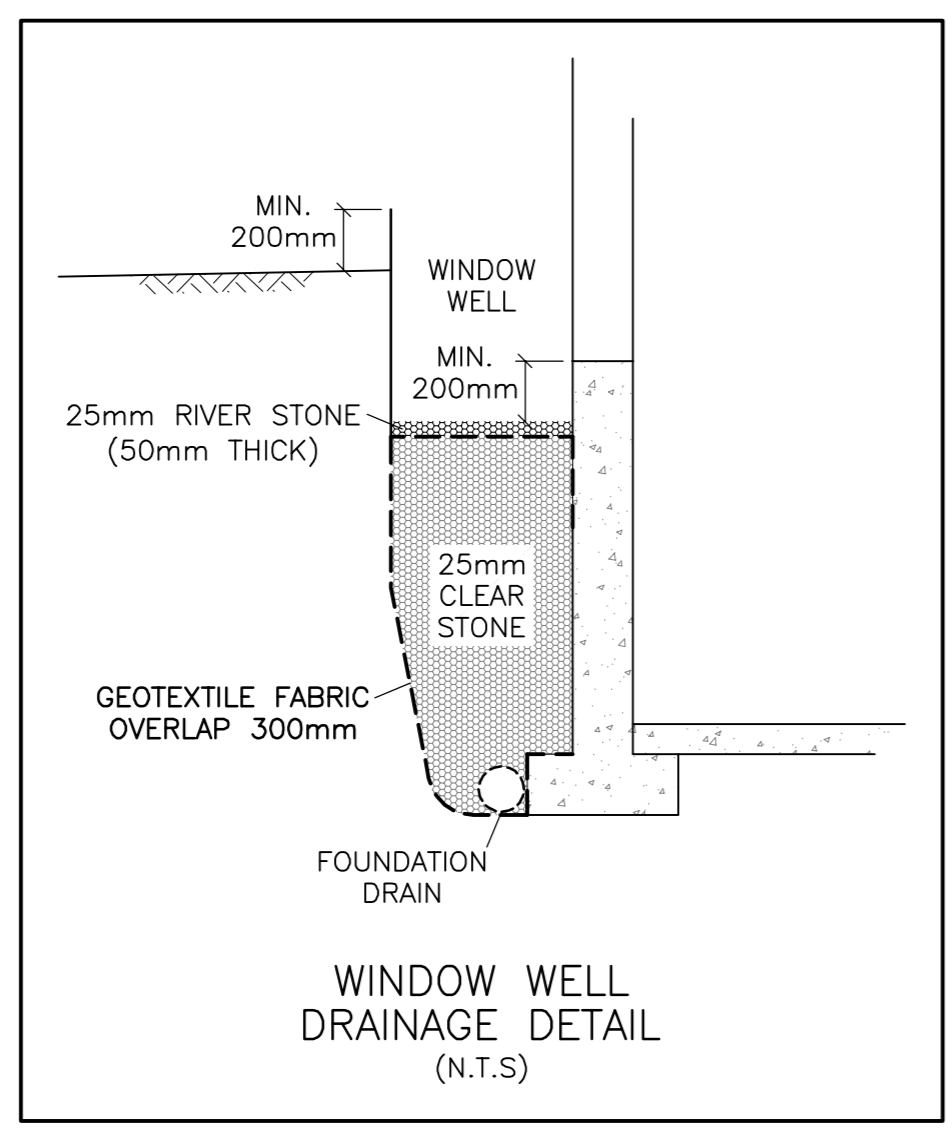
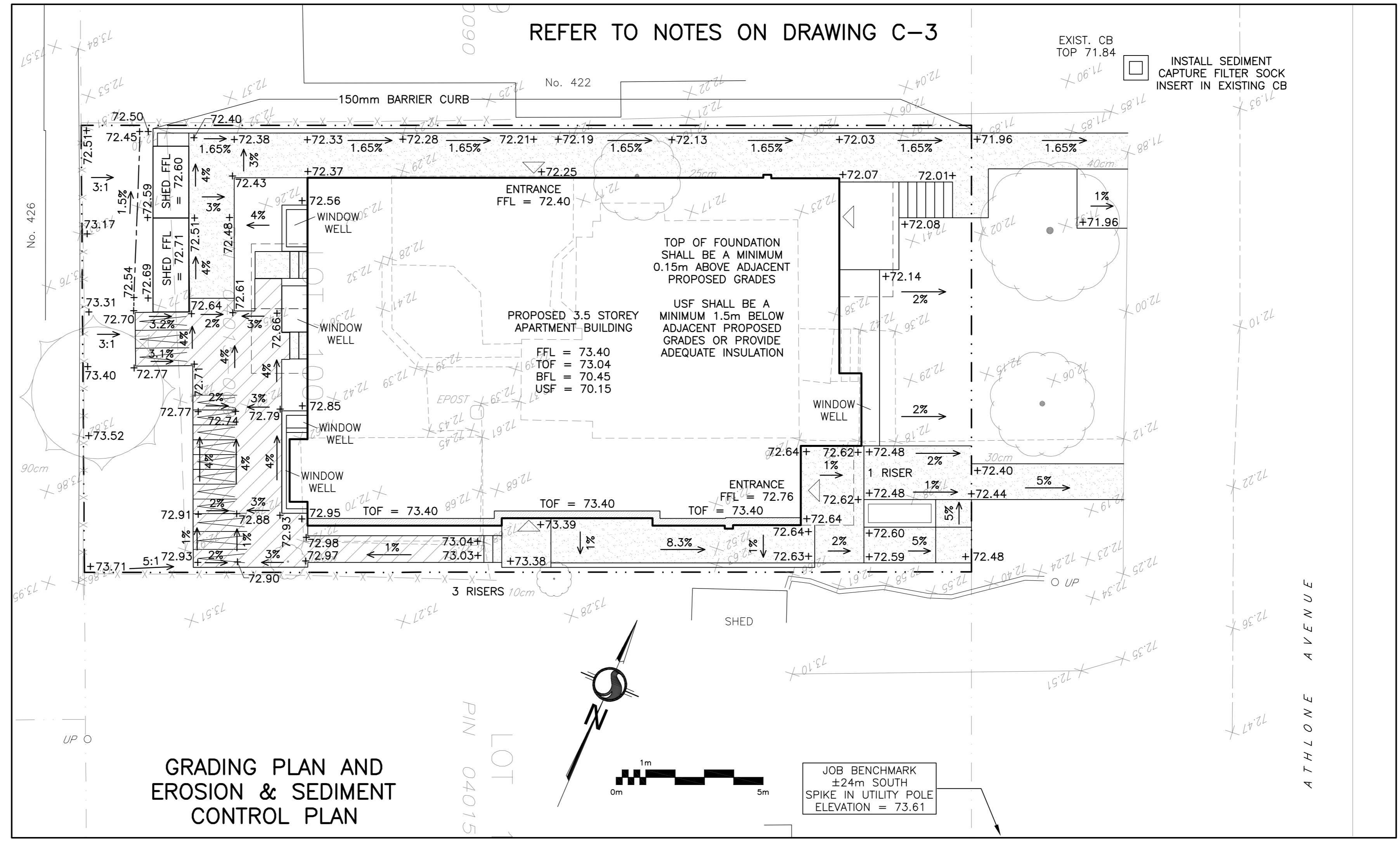

| No. | DATE | REVISION |
|-----|-----------|-------------------------|
| 5 | JUL 3-24 | RE-ISSUED FOR APPROVAL |
| 4 | MAY 21-24 | RE-ISSUED FOR APPROVAL |
| 3 | APR 3-23 | RE-ISSUED FOR APPROVAL |
| 2 | MAY 16-22 | ISSUED FOR APPROVAL |
| 1 | MAY 5-22 | ISSUED FOR COORDINATION |

D. B. GRAY ENGINEERING INC.
 Stormwater Management - Grading & Drainage - Storm & Sanitary Sewers - Watermain
 700 Long Point Circle 613-425-8044
 Ottawa, Ontario d.gray@dbgrayengineering.com

Project
PROPOSED 3.5-STORY APARTMENT BUILDING
436 ATHLONE AVENUE
 OTTAWA, ONTARIO

Drawing Title
EXISTING CONDITIONS, GRADING PLAN AND SEDIMENT CONTROL PLAN

Engineer's Seal: **D.B. GRAY**, 17016502, JUL 3-24, PROVINCE OF ONTARIO

Drawn: D.B.G.
 H. Scale: 1:100
 V. Scale:
 Date: MAY 5-22
 Job No.: 22027

Drawing No.: **C-2 of 3**

NOT VALID UNLESS SIGNED & DATED