

- GENERAL NOTES:**
- IT IS THE RESPONSIBILITY OF THE APPROPRIATE CONTRACTOR OR OFFICIAL TO REPORT ANY ERRORS, OMISSIONS OR DISCREPANCIES ON THIS PLAN WITH ACTUAL SITE CONDITIONS TO THE LANDSCAPE ARCHITECT BEFORE PROCEEDING WITH CONSTRUCTION.
 - THE CONTRACTOR IS TO NOTIFY ALL UTILITY COMPANIES AND AUTHORITIES PRIOR TO ANY EXCAVATION AND ASCERTAIN LOCATIONS OF UNDERGROUND SERVICES.
 - THE CONTRACTOR IS TO REINSTATE ALL AREAS AND ITEMS DAMAGED AS A RESULT OF CONSTRUCTION ACTIVITY.
 - THE CONTRACTOR IS TO COMPLY WITH ALL PERTINENT CODES AND BY-LAWS.
 - THE CONTRACTOR IS TO MAINTAIN A POSITIVE SURFACE RUN-OFF THROUGHOUT THE ENTIRE CONSTRUCTION PERIOD.
 - THE LANDSCAPE ARCHITECT IS NOT RESPONSIBLE FOR SUBSURFACE CONDITIONS.
 - THE CONTRACTOR IS TO IDENTIFY ALL EXISTING TREES TO REMAIN ON SITE WITH THE LANDSCAPE ARCHITECT PRIOR TO CONSTRUCTION.
 - THE CONTRACTOR IS TO STAKE THE PROPOSED LOCATION OF ALL PLANT MATERIAL IN CONJUNCTION WITH THE LANDSCAPE ARCHITECT PRIOR TO EXCAVATION.
 - MINIMUM DISTANCES FOR SELECTED DECIDUOUS TREES ARE AS FOLLOWS:
 - BUILDING FOUNDATIONS - 7.5M
 - SIDEWALKS - 1.5M
 - PUBLIC STREETS - 2.5M
 - UNDERGROUND INFRASTRUCTURE - 2.0M
 - ALL TREES WITHIN 1M OF UNDERGROUND UTILITY TRENCHES ARE TO BE EXCAVATED BY HAND.
 - REMOVE ALL PROTECTIVE WRAPPING FROM TREE TRUNKS AFTER INSTALLATION.
 - STAKING OF TREES SHALL ONLY BE PERFORMED IF NECESSARY.
 - ENSURE THAT MULCH IS PULLED BACK A MINIMUM DISTANCE OF 75MM FROM BASE OF TREE TRUNK.

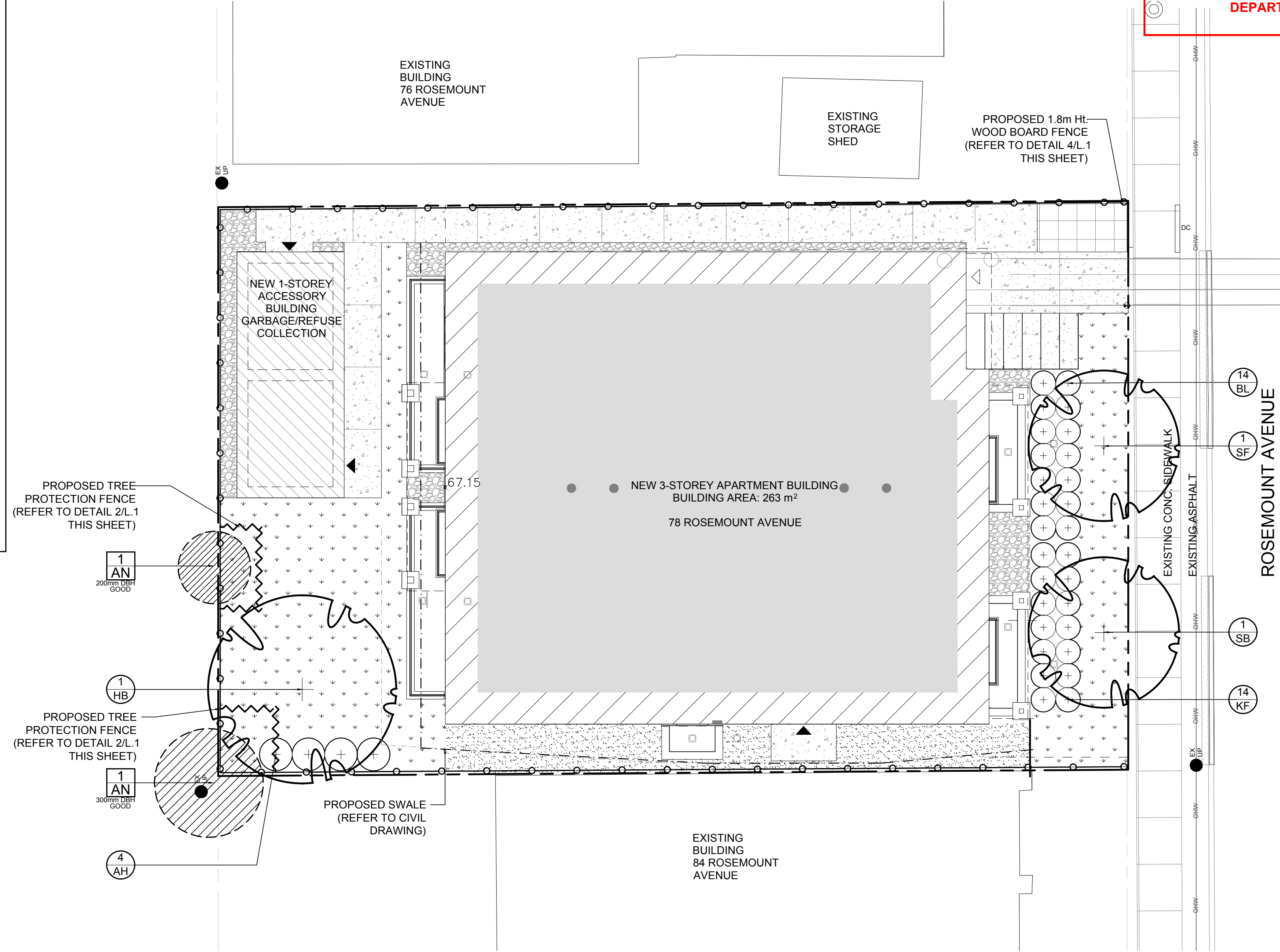

1 TREE CONSERVATION REPORT & LANDSCAPE PLAN
L.1 SCALE: 1:100

KEY	QTY.	BOTANICAL NAME	COMMON NAME	SIZE	CONDITION	REMARKS	OWNERSHIP
AN	2	<i>Acer negundo</i>	Manitoba Maple	300-200mm DBH	GOOD	To remain	11 Beverley Avenue

KEY	QTY.	BOTANICAL NAME	COMMON NAME	SIZE	CONDITION	REMARKS
TREES						
HB	1	<i>Celtis occidentalis</i>	Common Hackberry	60mm CAL.	B&B	
SB	1	<i>Amelanchier canadensis</i>	Serviceberry	60mm CAL.	B&B	Single leader
SF	1	<i>Amelanchier laevis</i> 'JSF-ARB'	Spring Flurry Serviceberry	60mm CAL.	B&B	Single leader
SHRUBS						
AH	4	<i>Hydrangea arborescens</i> 'Annabelle'	Annabelle Hydrangea	3 gallon pot	Potted	1000mm o.c.
ORNAMENTAL GRASSES						
BL	14	<i>Leymus arenarius</i> 'Blue Dune'	Blue Lyme Grass	250mm pot	Potted	800mm o.c.
KF	14	<i>Calamagrostis x acutiflora</i> 'Karl Foerster'	Feather Reed Grass	250mm pot	Potted	800mm o.c.

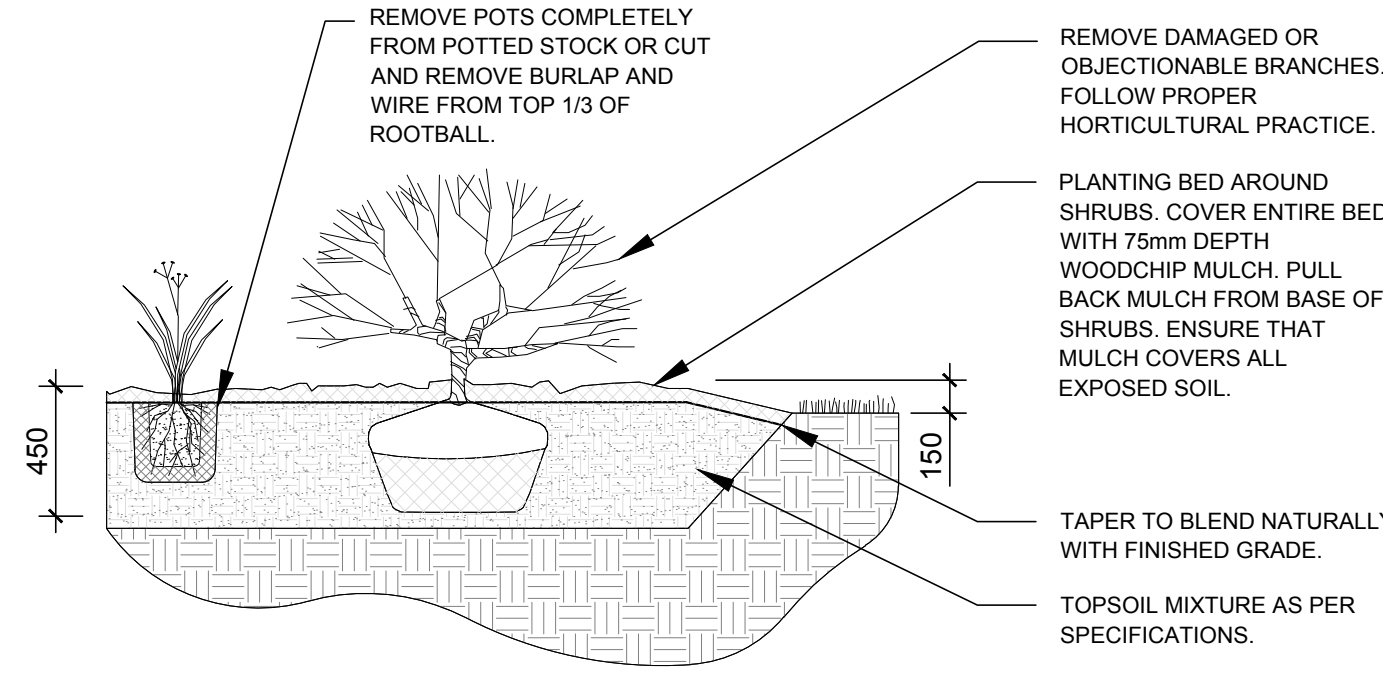

5 SHRUB / ORNAMENTAL GRASS PLANTING
L.1 SCALE: NTS

APPROVED
By John Bernier at 11:11 am, Oct 02, 2023

JOHN BERNIER
PLANNER
PLANNING, REAL ESTATE & ECONOMIC DEVELOPMENT
DEPARTMENT, CITY OF OTTAWA

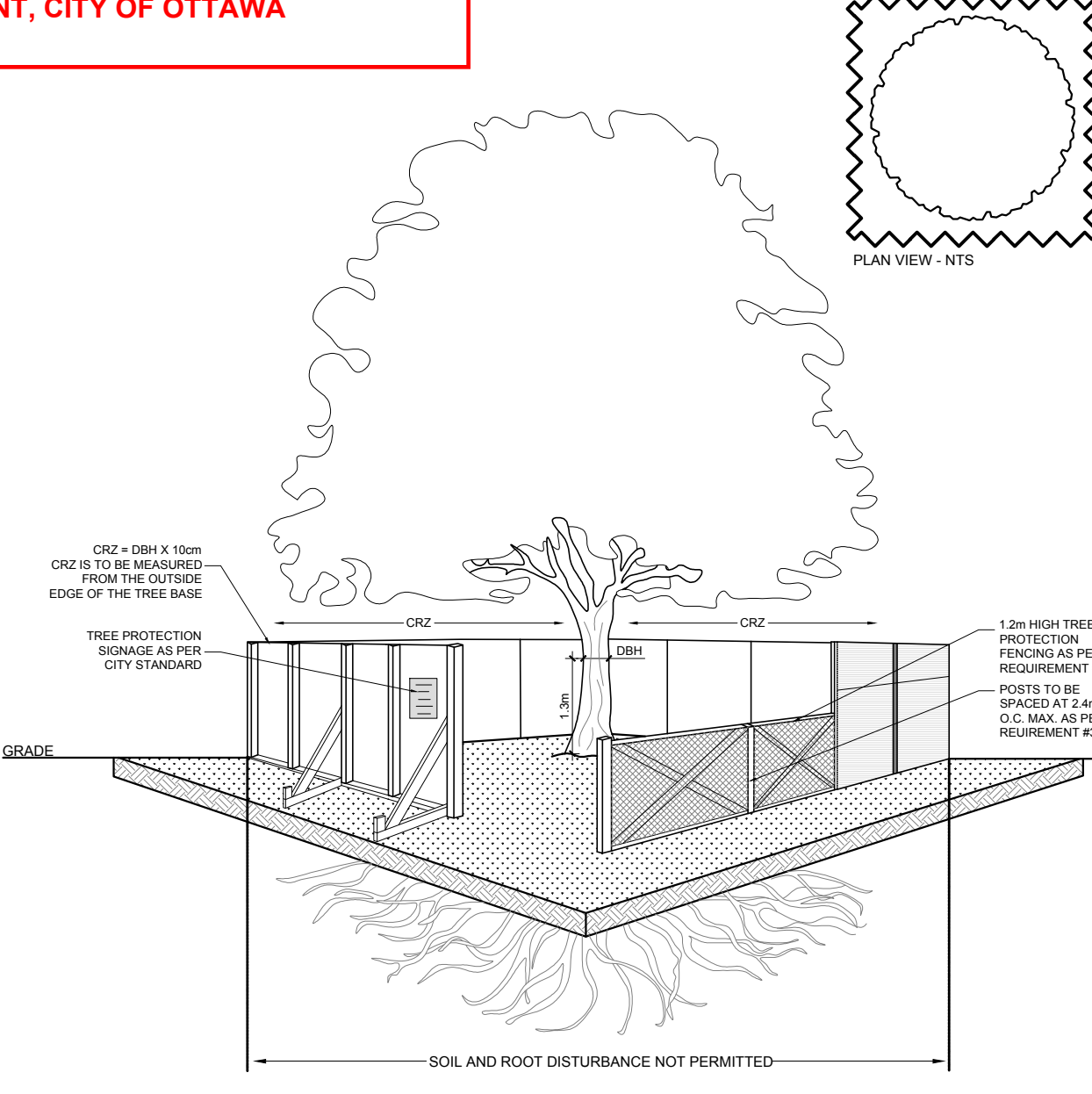

2 TREE PROTECTION FENCE
L.1 SCALE: NTS

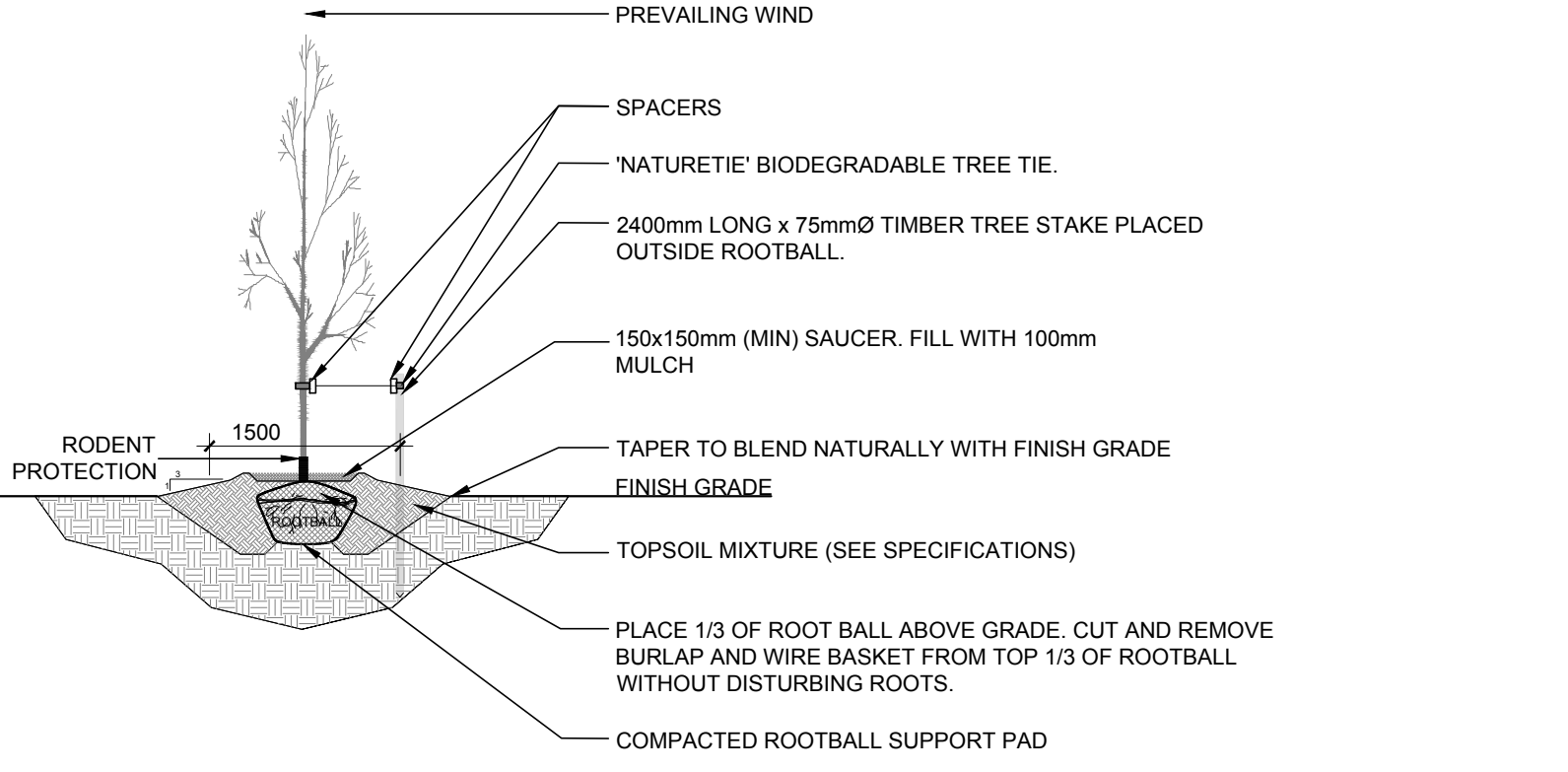

3 DECIDUOUS TREE PLANTING
L.1 SCALE: NTS

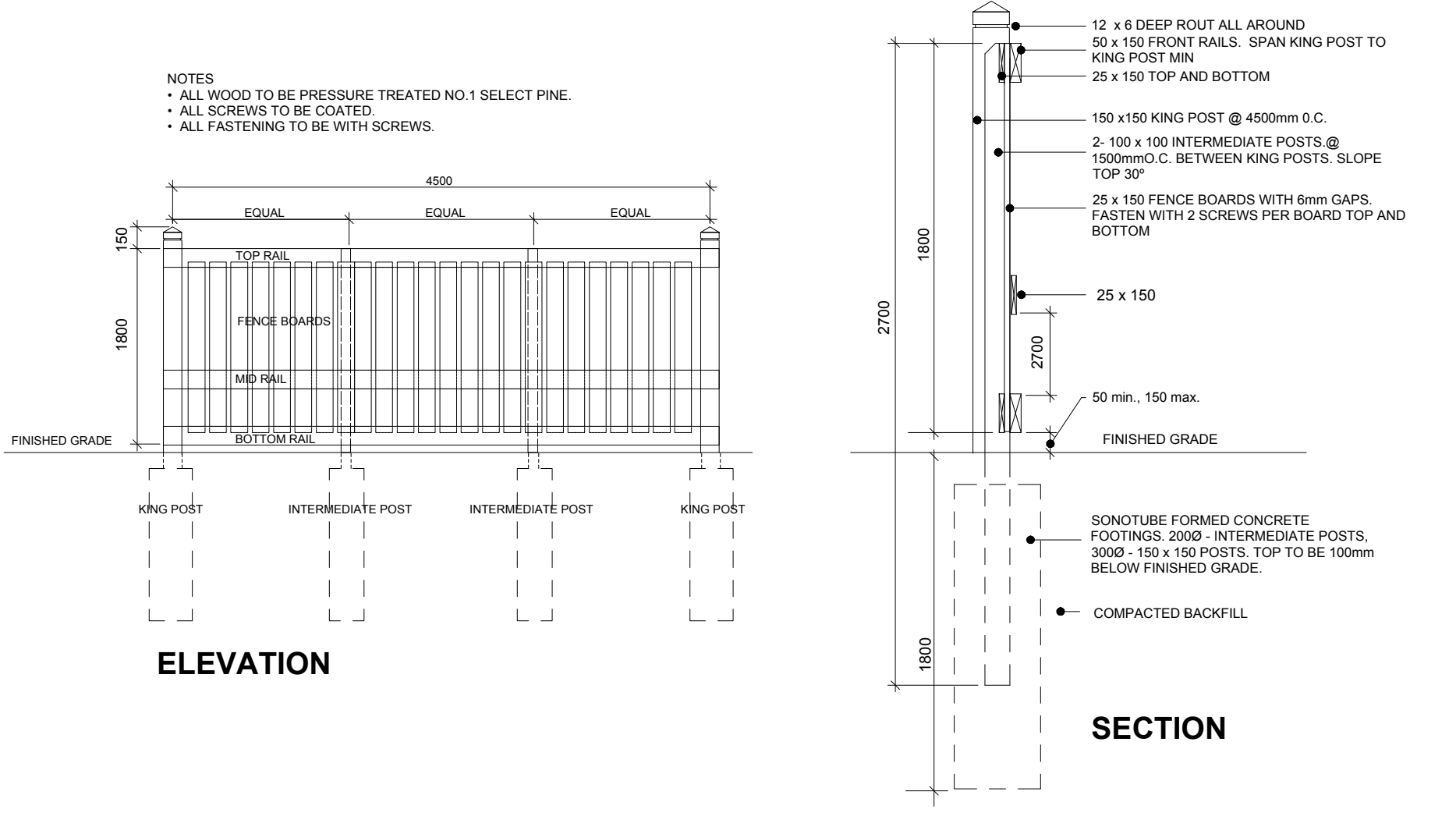

4 1.8m Ht. WOOD SCREEN FENCE
L.1 SCALE: NTS

- TREE PROTECTION REQUIREMENTS:**
- PRIOR TO ANY WORK ACTIVITY WITHIN THE CRITICAL ROOT ZONE (CRZ = 10x DIAMETER OF A TREE, TREE PROTECTION FENCING MUST BE INSTALLED SURROUNDING THE CRITICAL ROOT ZONE AND REMAIN IN PLACE UNTIL THE WORK IS COMPLETE.
 - UNLESS PLANS ARE APPROVED BY CITY FORESTRY STAFF, FOR WORK WITHIN THE CRZ:
 - DO NOT PLACE ANY MATERIAL OR EQUIPMENT INCLUDING OUTHOUSES.
 - DO NOT ATTACH ANY SIGNS, NOTICES OR POSTERS TO ANY TREE.
 - DO NOT RAISE OR LOWER THE EXISTING GRADE, TUNNEL, OR BORE WHEN DIGGING.
 - DO NOT DAMAGE THE ROOT SYSTEM, TRUNK, OR BRANCHES OF ANY TREE.
 - ENSURE THAT EXHAUST FUMES FROM ALL EQUIPMENT ARE NOT DIRECTED TOWARD ANY TREE CANOPY.
 - DO NOT EXTEND HARD SURFACE OR SIGNIFICANTLY CHANGE LANDSCAPING.
 - TREE PROTECTION FENCING MUST BE AT LEAST 1.2m IN HEIGHT, AND BE CONSTRUCTED OF RIGID OR FRAMED MATERIALS (E.G. MODULAR STEEL, PLYWOOD HOARDINGS, OR SNOW FENCE ON A 2"x4" WOOD FRAME) WITH POSTS 2.4m APART, SUCH THAT THE FENCE LOCATION CANNOT BE ALTERED. ALL SUPPORTS AND BRACING MUST BE PLACED OUTSIDE OF THE CRZ, AND INSTALLATION MUST MINIMISE DAMAGE TO EXISTING ROOTS. (SEE DETAIL).
 - THE LOCATION OF THE TREE PROTECTION FENCING MUST BE DETERMINED BY AN ARBORIST AND DETAILED ON ANY ASSOCIATED PLANS FOR THE SITE (E.G. TREE CONSERVATION REPORT, TREE DISCLOSURE REPORT, ETC.). THE PLAN AND CONSTRUCTED FENCING MUST BE APPROVED BY CITY FORESTRY STAFF PRIOR TO THE COMMENCEMENT OF WORK.
 - IF THE FENCED TREE PROTECTION AREA MUST BE REDUCED TO FACILITATE CONSTRUCTION, MITIGATION MEASURES MUST BE PRESCRIBED BY AN ARBORIST AND APPROVED BY CITY FORESTRY STAFF. THESE MAY INCLUDE THE PLACEMENT OF PLYWOOD, WOOD CHIPS, OR STEEL PLATING OVER THE ROOTS FOR PROTECTION OR THE PROPER PRUNING AND CARE OF ROOTS WHERE ENCOUNTERED.
- BY-LAWS:**
- ALL CITY-OWNED TREES ARE PROTECTED UNDER THE MUNICIPAL TREES AND NATURAL AREAS PROTECTION BY-LAW (2009-279) WITHIN THE URBAN AREA.
- PRIVATELY OWNED TREES GREATER THAN 50cm IN DIAMETER ON LOTS 1 HECTARE IN SIZE OR LESS, AND TREES GREATER THAN 10cm IN DIAMETER ON LOTS GREATER THAN 1 HECTARE, ARE PROTECTED UNDER THE URBAN TREE CONSERVATION BY-LAW (2009-200).

CLIENT

78 ROSEMOUNT AVE INC.

CONSULTANTS

ARCHITECTS:

CSV ARCHITECTS
sustainable design · conception écologique

613.564.8118 190 O'Connor Street, Suite 100
www.csv.ca Ottawa, Ontario, K2P 2R3

CIVIL ENGINEERS:

CIVIL ENGINEER
McIntosh Perry
115 Walgreen Road, R.R. 3
Carp, ON K0A 1L0
613-936-2184
www.mcintoshperry.com

- LEGEND**
- PROPOSED DECIDUOUS TREE
 - PROPOSED SHRUBS / ORNAMENTAL GRASSES
 - PROPOSED CLOVER SEED
 - PROPOSED PEASTONE MULCH
 - PROPOSED RIVERSTONE MULCH
 - PROPOSED PRECAST CONCRETE PAVERS
 - PROPOSED CONCRETE SIDEWALK
 - EXISTING TREE TO REMAIN
 - TREE PROTECTION FENCE
 - PROPOSED 1.8m Ht. WOOD SCREEN FENCE

No.	Issue	Date	DR	CK
2	REVISED PER CITY COMMENTS	01/18/2023	ML	JL
1	ISSUED FOR SITE PLAN CONTROL	08/04/2022	ML	JL

JAMES B. LENNOX & ASSOCIATES INC.
LANDSCAPE ARCHITECTS
3312 CARLING AVE. OTTAWA, ONTARIO K2H 5A8
Tel. (613) 722-5168 Fax. (1866) 343-3942

PROJECT

PROPOSED THREE STOREY APARTMENT BUILDING
78 ROSEMOUNT AVENUE, OTTAWA ON

DRAWING

TREE CONSERVATION REPORT & LANDSCAPE PLAN

STAMP	SCALE
	AS SHOWN
	START DATE
	JULY 2022
	PROJECT NO.

PROJECT NORTH

DRAWING NO.

L.1

PLOT SIZE ARCH-D