

PRINCE OF WALES DRIVE

COLONNADE ROAD

COLONNADE ROAD

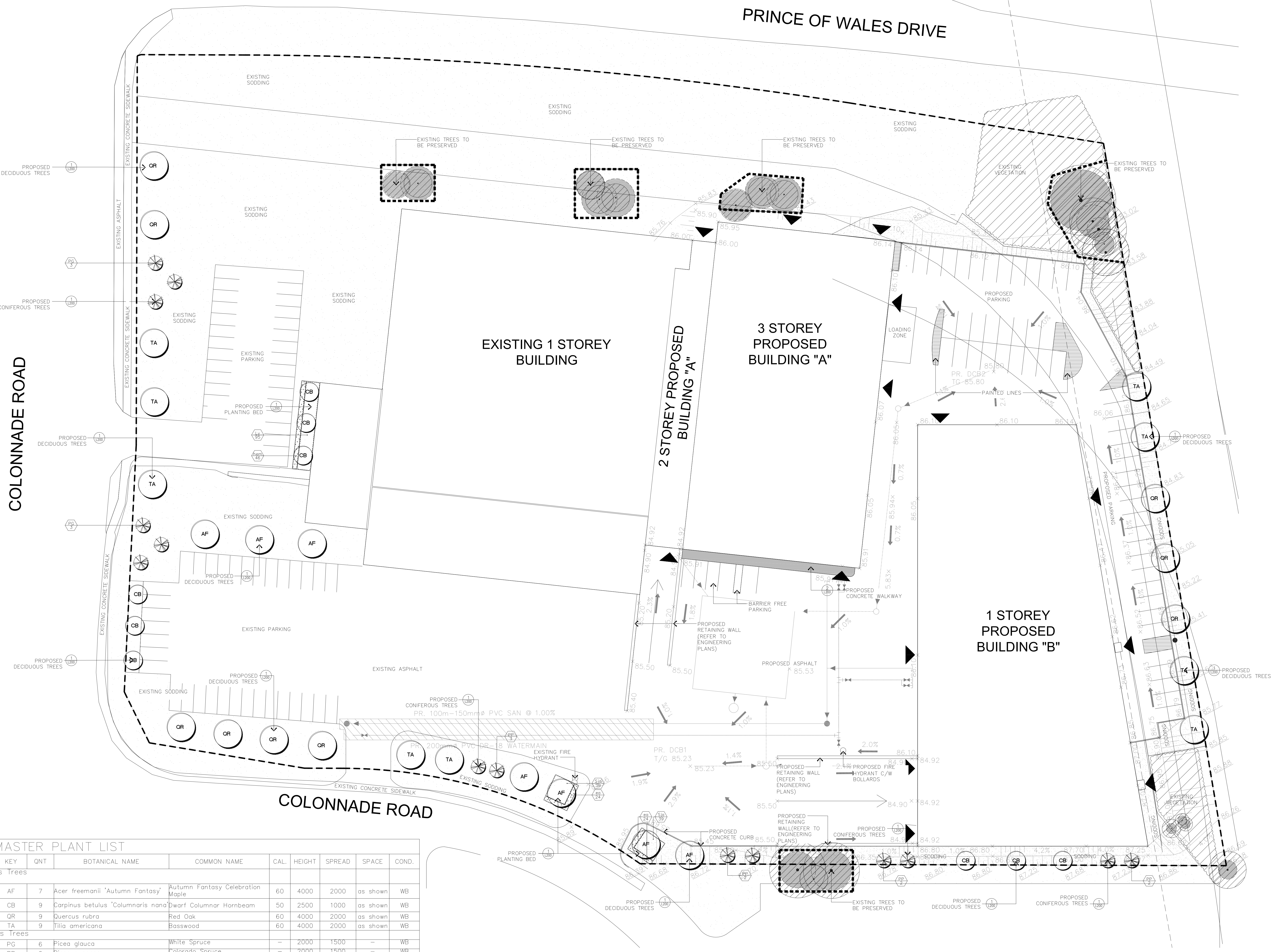

**GENERAL NOTES**

- VERIFY ALL DIMENSIONS.
- DO NOT SCALE DRAWINGS.
- REPORT ANY DISCREPANCIES, DISCOVERED ERRORS, OR OMISSIONS TO THE LANDSCAPE ARCHITECT BEFORE PROCEEDING.
- IT IS ADVISED THAT CONTRACTORS CONTACT THE LANDSCAPE ARCHITECT PRIOR TO CONSTRUCTION TO ENSURE THE USE OF THE LATEST REVISED DRAWINGS.
- DRAWINGS AND SPECIFICATIONS ARE THE PROPERTY OF THE LANDSCAPE ARCHITECT.



- LEGEND**
- EXISTING TREE TO BE PRESERVED
  - PROPOSED DECIDUOUS TREE
  - PROPOSED SHRUBS
  - PROPOSED PERENNIALS
  - EXISTING SODDING
  - NEW SODDING

No.	DATE	REVISION	BY
6.	MAY 19, 2022	REVISED AS PER LATEST GRADING AND SERVING PLAN	S.V.
5.	MAY 06, 2022	REVISED AS PER LATEST TREE INVENTORY	S.V.
4.	APR 28, 2022	REVISED AS PER LATEST GRADING AND SERVING PLAN	S.V.
3.	APR 13, 2022	ISSUED FOR REVIEW	S.V.
2.	APR 08, 2022	ISSUED FOR REVIEW	S.V.
1.	JAN 14, 2022	ISSUED FOR CLIENT REVIEW	S.V.

It is the responsibility of the Contractor and/or Owner to ensure that the drawings with the latest revisions are used for construction.

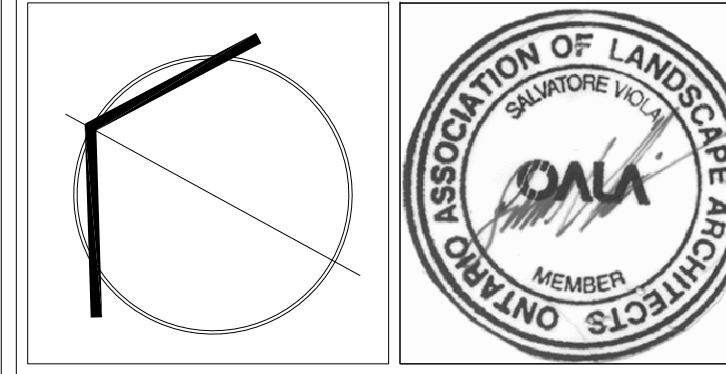

**SBK** 5770 HURONTARIO STREET, SUITE 320  
MISSISSAUGA, ONTARIO, L4R 3G5  
T: 416.695.4949 F: 905.712.3101  
WWW.STRYBOS.COM

**STRYBOS BARRON KING**  
LANDSCAPE ARCHITECTURE

PROJECT: **ACCESS STORAGE: PROPOSED BUILDING ADDITIONS**  
125 COLONNADE ROAD  
NEPEAN, OTTAWA

DRAWING TITLE: **LANDSCAPE PLAN**

SCALE: 1:300	PROJECT No. 5709
DATE: JANUARY 14, 2022	DRAWING No. L100
DRAWN BY: J.M./S.D.	CHECKED BY: S.V.

**MASTER PLANT LIST**

KEY	QNT	BOTANICAL NAME	COMMON NAME	CAL.	HEIGHT	SPREAD	SPACE	COND.
<b>Deciduous Trees</b>								
AF	7	Acer freemanii 'Autumn Fantasy'	Autumn Fantasy Celebration Maple	60	4000	2000	as shown	WB
CB	9	Carpinus betulus 'Columnaris nana'	Dwarf Columnar Hornbeam	50	2500	1000	as shown	WB
QR	9	Quercus rubra	Red Oak	60	4000	2000	as shown	WB
TA	9	Tilia americana	Basswood	60	4000	2000	as shown	WB
<b>Coniferous Trees</b>								
PG	6	Picea glauca	White Spruce	-	2000	1500	-	WB
PP	9	Picea pungens	Colorado Spruce	-	2000	1500	-	WB
<b>Deciduous Shrubs</b>								
Lv	95	Ligustrum x vicaryi	Golden Privet	-	600	-	750	CG
Sja	78	Spiraea japonica 'Anthony Waterer'	Anthony Waterer Spirea	-	250	-	750	CG
<b>Perennials</b>								
ea	48	Echinacea purpurea	Purple Coneflower	-	2 GAL	-	600	CG2
hem	46	Hemerocallis 'Stella D'Oro'	Stella D'Oro Daylily	-	2 GAL	-	500	CG2

NOTE:  
GIVEN THAT ALL PROPOSED TREE PLANTING ARE LOCATED WITHIN AN EXPANSIVE SODDED AREA, ALL CITY OF OTTAWA MINIMUM SOIL VOLUME REQUIREMENTS ARE ABLE TO BE MET

**GENERAL NOTES:**

**MAINTENANCE and ACCEPTANCE:**

- ALL PLANT MATERIAL SHALL BE MAINTAINED BY THE CONTRACTOR IMMEDIATELY AFTER ANY PLANTING HAS BEEN INSTALLED AND SHALL CONTINUE UNTIL THE DATE OF FINAL ACCEPTANCE.
- SUCH MAINTENANCE SHALL INCLUDE ALL MEASURES NECESSARY TO ESTABLISH AND MAINTAIN ALL PLANTS IN AN ACCEPTABLE, VIGOROUS AND HEALTHY GROWING CONDITION INCLUDING CULTIVATING AND WEEDING, WATERING, WHEN REQUIRED, PRUNING AND MAINTENANCE OF ALL ACCESSORIES.
- AT TIME OF INSPECTION FOR INITIAL & FINAL ACCEPTANCE, ALL PLANTING BEDS AND TREE PITS SHALL BE FRESHLY CULTIVATED, FREE OF WEEDS, LEAVES, BROKEN BRANCHES AND RUBBISH AND SHALL BE IN A NEAT AND TIDY CONDITION.
- ALL PLANT MATERIAL TO BE GUARANTEED FOR A PERIOD OF 2 (TWO) YEARS FROM THE DATE OF ACCEPTANCE BY THE LANDSCAPE ARCHITECT AND LOCAL AUTHORITY UNLESS OTHERWISE NOTED.
- MAINTAIN PLANTING BEDS AND TREE PITS FREE OF WEEDS THROUGHOUT THE GUARANTEE PERIOD.
- THE DEVELOPER SHALL REGULARLY REMOVE DEBRIS FROM THE WETLAND UNTIL THE COMPLETION OF ALL BUILDING CONSTRUCTION WITHIN THE DEVELOPMENT.

**UTILITIES:**

- APPLICANT IS RESPONSIBLE FOR OBTAINING NECESSARY APPROVALS FROM THE UTILITY COMPANIES FOR WORKS WITHIN THE MUNICIPAL BOULEVARD.
- ALL UTILITIES WITHIN THE BOULEVARDS MUST BE LOCATED PRIOR TO COMMENCING CONSTRUCTION WITHIN THE BOULEVARD.

**SODDING:**

- PREPARE A MINIMUM 150mm DEPTH OF TOPSOIL WITH A 10-6-4 COMMERCIAL FERTILIZER AT 7.3kg/100sq.m. AND SUPER PHOSPHATE AT 5kg/100sq.m. THE PROPORTIONS SPECIFIED ARE SUBJECT TO ADJUSTMENT DEPENDING ON TOPSOIL ANALYSIS REPORT.
- LAY No. 1 NURSERY SOD ON ALL AREAS OF THE PROJECT NOT COVERED BY BUILDINGS OR PAVING.
- IMMEDIATELY AFTER INSTALLATION, SOD MUST BE WATERED AND ROLLED.

**PLANTING:**

- (UNLESS OTHERWISE SPECIFIED)
- PREPARE PLANTING SOIL BY EVENLY MIXING FOUR PARTS SANDY TOPSOIL, ONE PART ORGANIC SOIL ADDITIVE WITH 500g BONE MEAL AND 750g COMMERCIAL FERTILIZER PER CUBIC METER. THE FOREGOING RATES ARE SUBJECT TO ADJUSTMENT ON RECEIPT OF TOPSOIL ANALYSIS REPORT.
- EXCAVATE AND PROVIDE PLANTING SOILS AS PER PLANTING DETAILS.
- PROVIDE ALL SHRUBS AND TREES ACCORDING TO THE GUIDE SPECIFICATIONS FOR NURSERY STOCK OF THE CANADIAN NURSERY TRADE ASSOCIATION WITH REGARD TO QUALITY AND GRADING AND SIZED AS PER PLANT LIST.
- SPRAY ALL PLANTINGS IN LEAF WITH ANTIDESICCANT. PROVIDE TREES WITH STAKES.
- PLANTS ARE TO BE No. 1 NURSERY GROWN, UNDER PROPER CULTURAL PRACTICES, IN PARTICULAR WITH RESPECT TO AMPLE SPACINGS, PEST AND DISEASE CONTROL, AND BRANCH AND ROOT PRUNING.
- TREES ARE TO HAVE STURDY, STRAIGHT TRUNKS.
- TREES SHALL BE WELL BRANCHED AND BALANCED WITH A STRONG CENTRAL LEADER.
- DECIDUOUS SHADE TREES SHALL BE FREE OF BRANCHES NOT LESS THAN 1.8m ABOVE THE GROUND.
- ALL SHRUBS ARE TO BE PLANTED IN CONTINUOUS BEDS.
- DO NOT SOD BETWEEN PLANTS. EXCAVATE ENTIRE AREA OF SHRUB BED UNIFORMLY TO SPECIFIED DEPTH AND FILL WITH SPECIFIED PLANTING SOIL.

**TREE LOCATION:**

- NO TREES SHALL BE PLANTED UNDER OVERHEAD WIRES OR OVER UNDERGROUND SERVICES.
- TREES ARE NOT TO BE PLANTED LESS THAN 1M FROM CURBS, UNDERGROUND UTILITIES, SIDEWALKS AND DRIVEWAYS, 2m FROM FIRE HYDRANTS AND TRANSFORMERS, AND 4m FROM LIGHT STANDARDS.
- THE CONTRACTOR IS TO STAKE OUT LOCATIONS OF TREE PITS. THIS STAKE OUT IS TO BE INSPECTED BEFORE THE EXCAVATION OF ANY TREE PITS.
- BEFORE THIS STAKE OUT, THE CONTRACTOR IS TO REQUEST A STAKE OUT ALL UNDERGROUND SERVICES.
- THE LANDSCAPE ARCHITECT AND THE MUNICIPALITY MAY, AT THEIR DISCRETION REDISTRIBUTE TREE LOCATIONS, PRIOR TO PLANTING, IN ORDER TO MINIMIZE CONFLICTS WITH UTILITIES, DRIVEWAYS AND INTERSECTION VISIBILITY.

**TOPSOIL:**

- USE EVENLY MIXED TOPSOIL OF FERTILE, FRIABLE NATURAL LOAM CONTAINING NOT LESS THAN 4% ORGANIC MATTER FOR CLAY LOAMS AND 2% MINIMUM ORGANIC MATTER FOR SAND LOAMS WITH AN ACIDITY RANGE OF 5.5 TO 7.5 pH.
- ALL TOPSOIL SHOULD BE FREE OF SUBSOILS, CLAY, STONES, ROOTS, EXCESS WATER, FROST AND OTHER EXTRANEEOUS MATTER.

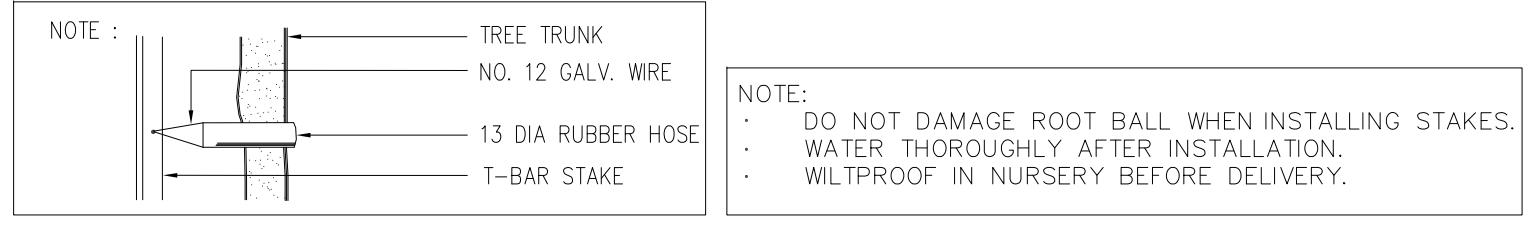
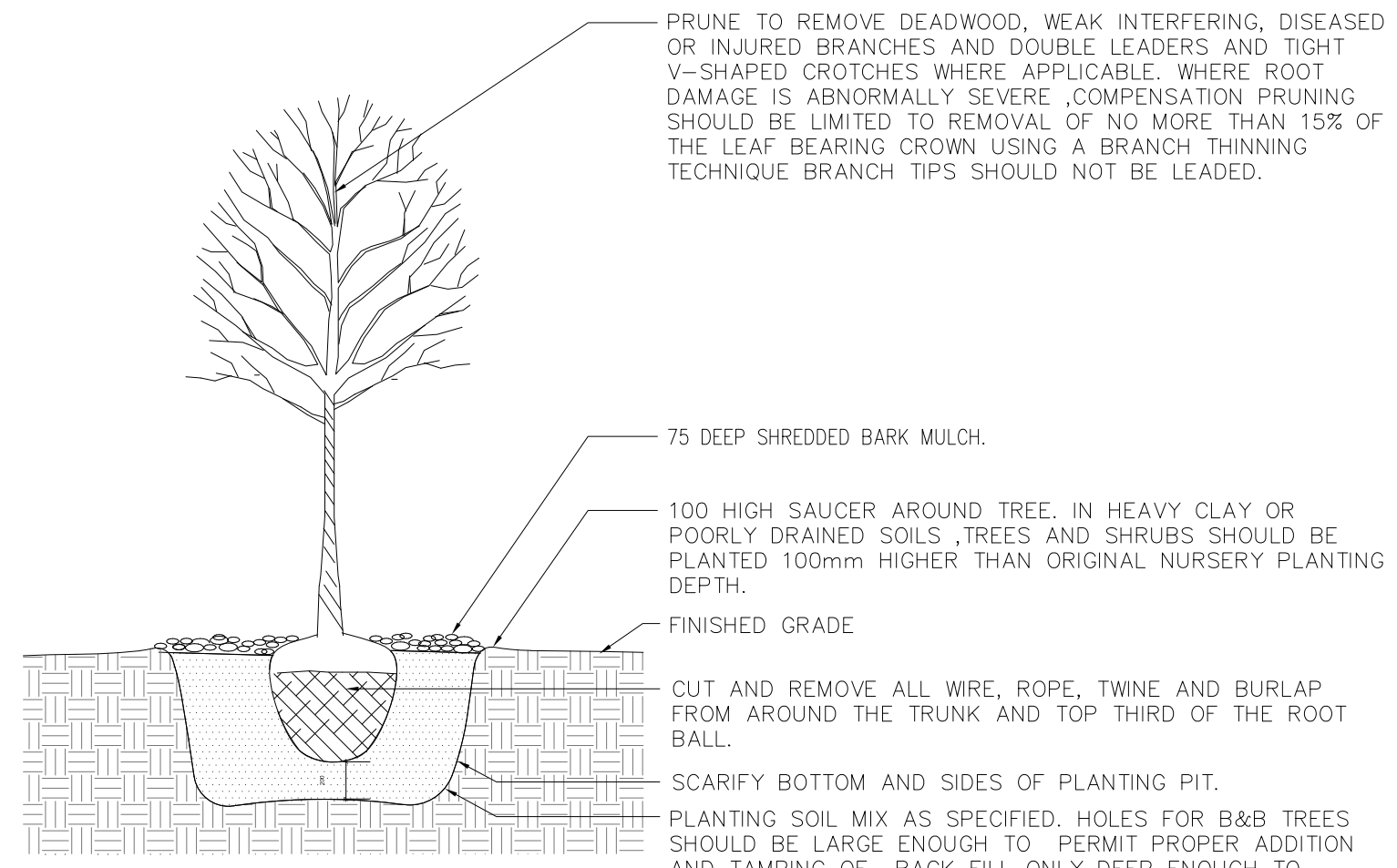

DECIDUOUS TREE PLANTING DETAIL

CONIFEROUS TREE PLANTING DETAIL

1 PLANTING DETAILS

L200

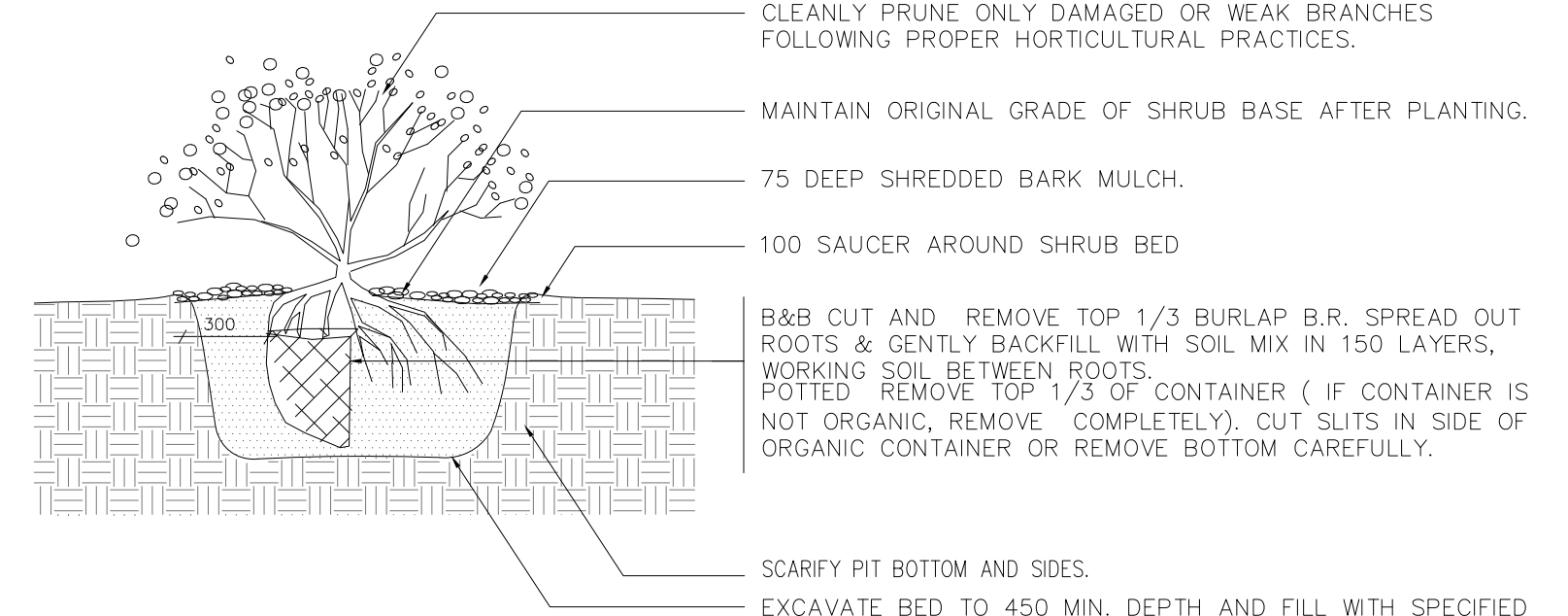

SHRUB PLANTING DETAIL

2 CONCRETE WALKWAY

L200

N.T.S.

N.T.S.

**GENERAL NOTES**

- VERIFY ALL DIMENSIONS.
- DO NOT SCALE DRAWINGS.
- REPORT ANY DISCREPANCIES, DISCOVERED ERRORS, OR OMISSIONS TO THE LANDSCAPE ARCHITECT BEFORE PROCEEDING.
- IT IS ADVISED THAT CONTRACTORS CONTACT THE LANDSCAPE ARCHITECT PRIOR TO CONSTRUCTION TO ENSURE THE USE OF THE LATEST REVISED DRAWINGS.
- DRAWINGS AND SPECIFICATIONS ARE THE PROPERTY OF THE LANDSCAPE ARCHITECT.

**KEY MAP (N.T.S.)**

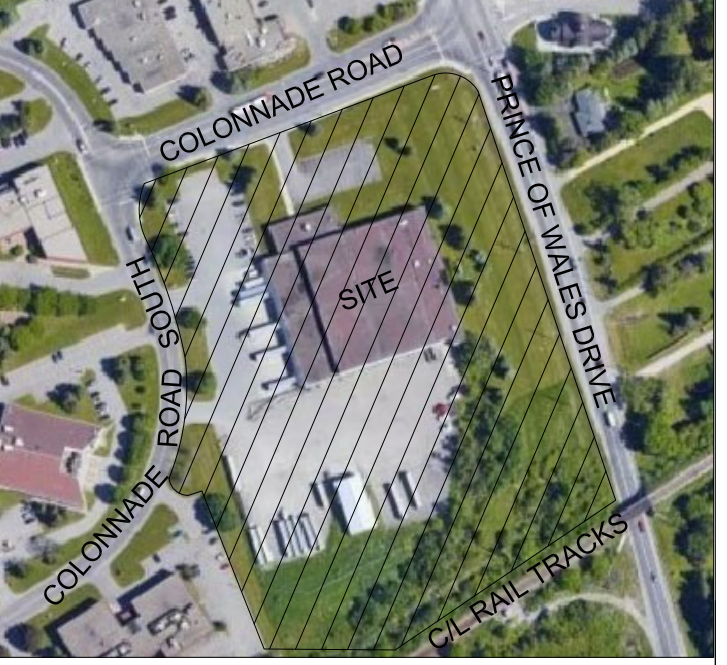

No.	DATE	REVISION	BY
6	MAY 19, 2022	ISSUED AS PER LATEST GRADING AND SERVING PLAN	S.V.
5	MAY 06, 2022	REVISED AS PER LATEST TREE INVENTORY PLAN	S.V.
4	APR 28, 2022	REVISED AS PER LATEST GRADING AND SERVING PLAN	S.V.
3	APR 13, 2022	ISSUED FOR REVIEW	S.V.
2	APR 08, 2022	ISSUED FOR REVIEW	S.V.
1	JAN 14, 2022	ISSUED FOR CLIENT REVIEW	S.V.

It is the responsibility of the Contractor and/or Owner to ensure that the drawings with the latest revisions are used for construction.

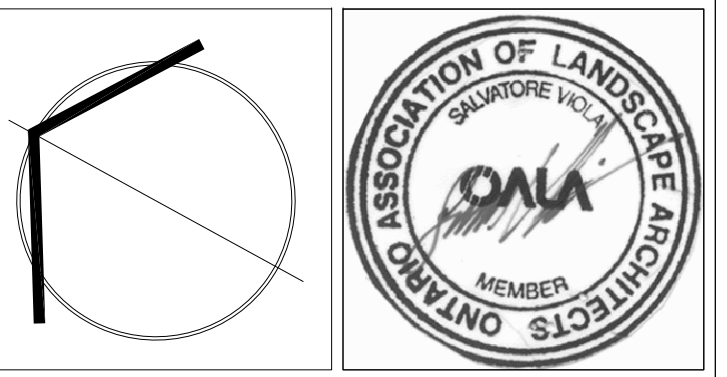

**SBK** 5770 HURONTARIO STREET, SUITE 320 MISSISSAUGA, ONTARIO, L5R 3G5 T: 416-695-4949 F: 905-712-3101 www.STRYBOS.COM

**STRYBOS BARRON KING**  
LANDSCAPE ARCHITECTURE

PROJECT:  
**ACCESS STORAGE:  
PROPOSED BUILDING ADDITIONS  
125 COLONNADE ROAD  
NEPEAN, OTTAWA**

DRAWING TITLE:  
**CONSTRUCTION DETAILS**

SCALE: 1:300	PROJECT No. <b>5709</b>
DATE: JANUARY 14, 2022	DRAWING No. <b>V100</b>
DRAWN BY: J.M./S.D.	
CHECKED BY: S.V.	