

# SECTION A-A

SCALE: HOR: 1:50  
VER: 1:50

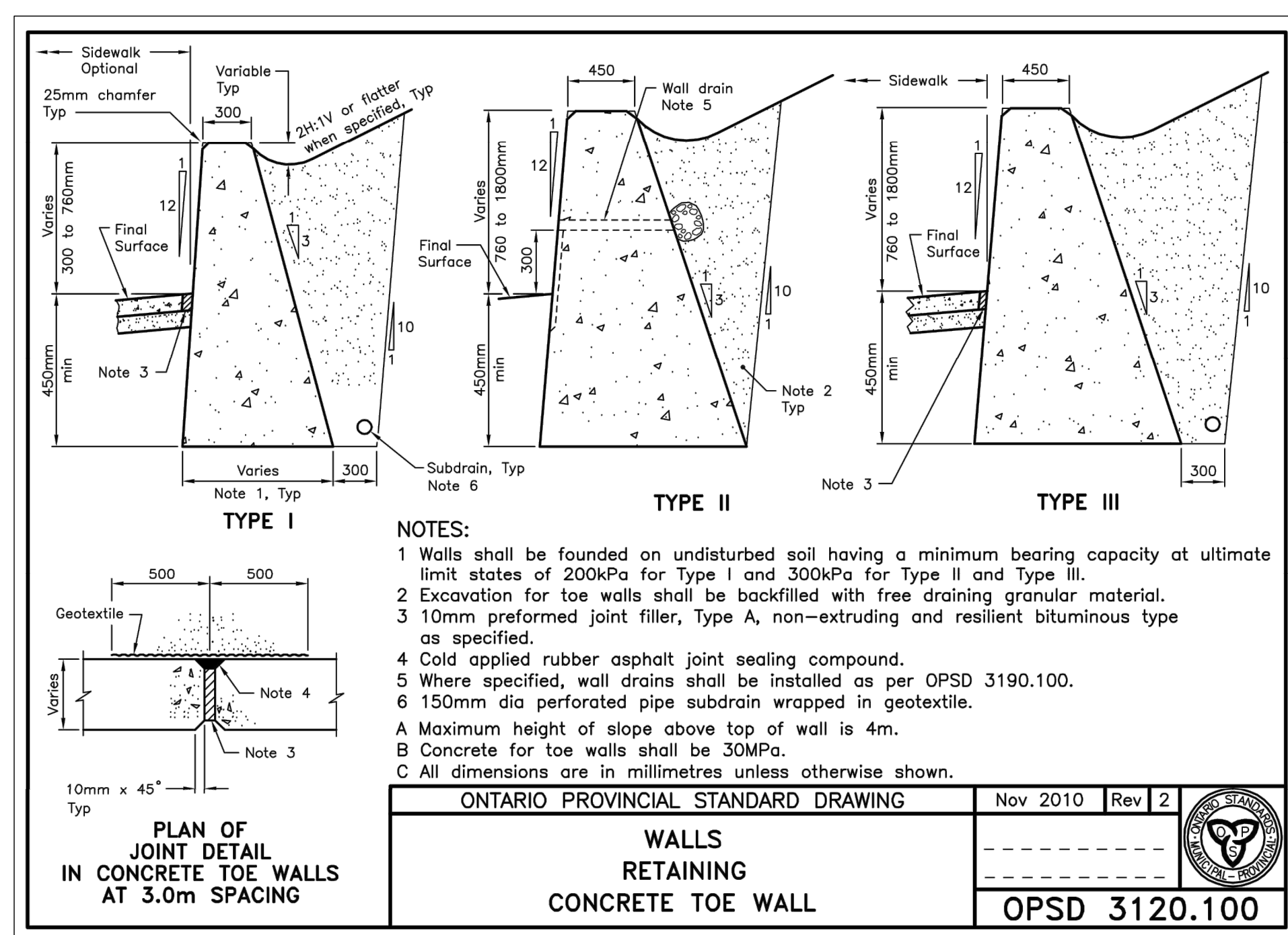
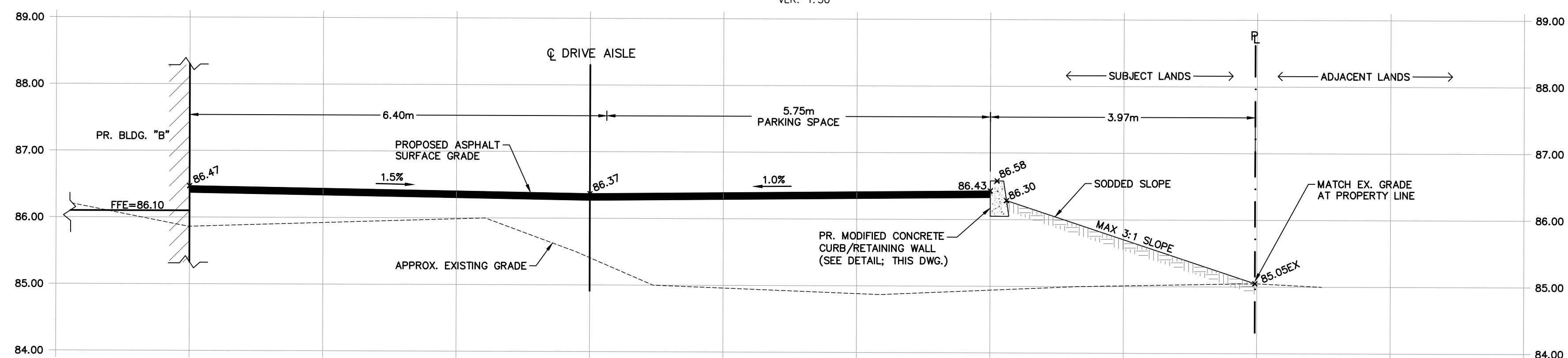

0	ISSUED FOR SITE PLAN APPLICATION	2022/MAY/17
No.	ISSUE / REVISION	YYYY/MM/DD

**ELEVATION NOTE:**  
ELEVATIONS SHOWN ARE GEODETIC AND ARE REFERRED TO GEODETIC DATUM CGVD-1928:1978. (SEE FSD FILE No. 531-20)  
IT IS THE RESPONSIBILITY OF THE SER OF THIS INFORMATION TO VERIFY THAT THE JOB BENCHMARK HAS NOT BEEN ALTERED OR DISTURBED AND THAT ITS RELATIVE ELEVATION AND DESCRIPTION AGREES WITH THE INFORMATION SHOWN ON THIS DRAWING.

**LOCAL BENCHMARK:**  
TOP SPINDLE OF FIRE HYDRANT LOCATED ON SOUTH SIDE OF COLONNADE ROAD, APPROXIMATELY 95.0m WEST OF PRINCE OF WHALES DRIVE.  
ELEVATION = 85.19m

**SURVEY NOTES:**  
SURVEY COMPLETED BY FARLEY, SMITH, & DENIS SURVEYING LTD. (2022/MAR/09)  
FILE No.: 101-21  
BEARINGS ARE GRID AND ARE REFERRED TO THE WESTERLY LIMIT OF PRINCE OF WHALES DRIVE HAVING A BEARING OF N 24° 04' 30" W, AS SHOWN ON PLAN 4R-18363.

**SITE PLAN NOTES:**  
DESIGN ELEMENTS ARE BASED ON SITE PLAN BY ARCHITECTURE 49.  
DRAWING No.: A1.2 (2022/FEB/25)  
PROJECT No.: 219-00058-00

**DRAWING NOTES:**  
THIS DRAWING IS THE EXCLUSIVE PROPERTY OF C.F. CROZIER & ASSOCIATES INC. AND THE REPRODUCTION OF ANY PART OF IT WITHOUT PRIOR WRITTEN CONSENT OF THIS OFFICE IS STRICTLY PROHIBITED.  
THE CONTRACTOR SHALL VERIFY ALL DIMENSIONS, LEVELS, AND DATUMS ON SITE AND REPORT ANY DISCREPANCIES OR OMISSIONS TO THIS OFFICE PRIOR TO CONSTRUCTION.  
THIS DRAWING IS TO BE READ AND UNDERSTOOD IN CONJUNCTION WITH ALL OTHER PLANS AND DOCUMENTS APPLICABLE TO THIS PROJECT. DO NOT SCALE THIS DRAWING.  
ALL EXISTING UNDERGROUND UTILITIES TO BE VERIFIED IN THE FIELD BY THE CONTRACTOR PRIOR TO CONSTRUCTION.

Project  
**125 COLONNADE ROAD**

Drawing  
**CONSTRUCTION DETAILS**

**NOT FOR CONSTRUCTION**

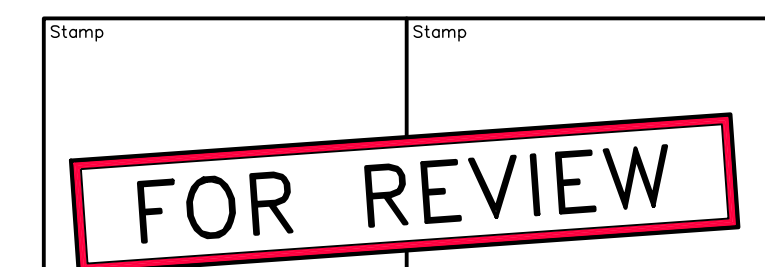

**CROZIER CONSULTING ENGINEERS**  
2800 HIGH POINT DRIVE  
SUITE 100  
MILTON, ON L9T 6P4  
905-875-0026 T  
905-875-4915 F  
WWW.CFCROZIER.CA

Drawn	M.I.M.	Design	B.P.	Project No.	<b>2112-6218</b>
Check	B.W.	Check	B.W.	Scale	1:500 Dwg. <b>C104</b>



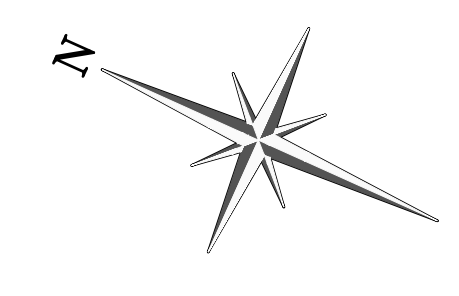

LEGEND	
	PROPERTY LINE
	EXISTING DITCH
	EXISTING GRADE
	EXISTING OVERLAND FLOW DIRECTION
	STORM DRAINAGE CATCHMENT
	CATCHMENT I.D.
	AREA (ha)   PERCENT IMPERVIOUS (%)

No.	ISSUE / REVISION	DATE
0	ISSUED FOR SITE PLAN APPLICATION	2022/MAY/17
	ISSUE / REVISION	YYYY/MM/DD

**ELEVATION NOTE:**  
 ELEVATIONS SHOWN ARE GEODETIC AND ARE REFERRED TO GEODETIC DATUM CGVD-1928:1978. (SEE FSD FILE No. 531-20)  
 IT IS THE RESPONSIBILITY OF THE SER OF THIS INFORMATION TO VERIFY THAT THE JOB BENCHMARK HAS NOT BEEN ALTERED OR DISTURBED AND THAT ITS RELATIVE ELEVATION AND DESCRIPTION AGREES WITH THE INFORMATION SHOWN ON THIS DRAWING.

**LOCAL BENCHMARK:**  
 TOP SPINDLE OF FIRE HYDRANT LOCATED ON SOUTH SIDE OF COLONNADE ROAD, APPROXIMATELY 95.0m WEST OF PRINCE OF WALES DRIVE.  
 ELEVATION = 85.19m

**SURVEY NOTES:**  
 SURVEY COMPLETED BY FARLEY, SMITH, & DENIS SURVEYING LTD. (2022/MAR/09)  
 FILE No.: 101-21  
 BEARINGS ARE GRID AND ARE REFERRED TO THE WESTERLY LIMIT OF PRINCE OF WALES DRIVE HAVING A BEARING OF N 24° 04' 30" W, AS SHOWN ON PLAN 4R-18363.

**SITE PLAN NOTES:**  
 DESIGN ELEMENTS ARE BASED ON SITE PLAN BY ARCHITECTURE 49.  
 DRAWING No.: A1.2 (2022/FEB/25)  
 PROJECT No.: 219-00058-00

**DRAWING NOTES:**  
 THIS DRAWING IS THE EXCLUSIVE PROPERTY OF C.F. CROZIER & ASSOCIATES INC. AND THE REPRODUCTION OF ANY PART OF IT WITHOUT PRIOR WRITTEN CONSENT OF THIS OFFICE IS STRICTLY PROHIBITED.  
 THE CONTRACTOR SHALL VERIFY ALL DIMENSIONS, LEVELS, AND DATUMS ON SITE AND REPORT ANY DISCREPANCIES OR OMISSIONS TO THIS OFFICE PRIOR TO CONSTRUCTION.  
 THIS DRAWING IS TO BE READ AND UNDERSTOOD IN CONJUNCTION WITH ALL OTHER PLANS AND DOCUMENTS APPLICABLE TO THIS PROJECT. DO NOT SCALE THIS DRAWING.  
 ALL EXISTING UNDERGROUND UTILITIES TO BE VERIFIED IN THE FIELD BY THE CONTRACTOR PRIOR TO CONSTRUCTION.

Project  
**125 COLONNADE ROAD**

Drawing  
**PRE-DEVELOPMENT DRAINAGE AREAS**

NOT FOR CONSTRUCTION

Stamp  
**FOR REVIEW**

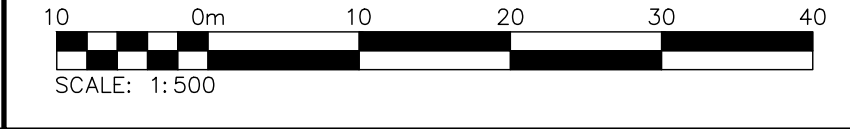

	<b>CROZIER CONSULTING ENGINEERS</b>		2800 HIGH POINT DRIVE SUITE 100 MILTON, ON L9T 6P4 905-875-0026 T 905-875-4915 F WWW.CFCROZIER.CA	
	Drawn M.I.M.	Design B.P.	Project No. <b>2112-6218</b>	Scale 1:500
Check B.W.	Check B.W.	Scale 1:500	Dwg. <b>FIG 1</b>	



**LEGEND**

- PROPERTY LINE
- - - EXISTING DITCH
- - - EXISTING GRADE
- EXISTING MAJOR OVERLAND FLOW DIRECTION
- PROPOSED MAJOR OVERLAND FLOW DIRECTION
- STORM DRAINAGE CATCHMENT
- ID CATCHMENT I.D.
- AREA (ha) | PERCENT IMPERVIOUS (%)

0	ISSUED FOR SITE PLAN APPLICATION	2022/MAY/17
No.	ISSUE / REVISION	YYYY/MM/DD

**ELEVATION NOTE:**  
 ELEVATIONS SHOWN ARE GEODETIC AND ARE REFERRED TO GEODETIC DATUM CGVD-1928:1978. (SEE FSD FILE No. 531-20)  
 IT IS THE RESPONSIBILITY OF THE SER OF THIS INFORMATION TO VERIFY THAT THE JOB BENCHMARK HAS NOT BEEN ALTERED OR DISTURBED AND THAT ITS RELATIVE ELEVATION AND DESCRIPTION AGREES WITH THE INFORMATION SHOWN ON THIS DRAWING.

**LOCAL BENCHMARK:**  
 TOP SPINDLE OF FIRE HYDRANT LOCATED ON SOUTH SIDE OF COLONNADE ROAD, APPROXIMATELY 95.0m WEST OF PRINCE OF WALES DRIVE.  
 ELEVATION = 85.19m

**SURVEY NOTES:**  
 SURVEY COMPLETED BY FARLEY, SMITH, & DENIS SURVEYING LTD. (2022/MAR/09)  
 FILE No.: 101-21  
 BEARINGS ARE GRID AND ARE REFERRED TO THE WESTERLY LIMIT OF PRINCE OF WALES DRIVE HAVING A BEARING OF N 24° 04' 30" W, AS SHOWN ON PLAN 4R-18363.

**SITE PLAN NOTES:**  
 DESIGN ELEMENTS ARE BASED ON SITE PLAN BY ARCHITECTURE 49.  
 DRAWING No.: A1.2 (2022/FEB/25)  
 PROJECT No.: 219-00058-00

**DRAWING NOTES:**  
 THIS DRAWING IS THE EXCLUSIVE PROPERTY OF C.F. CROZIER & ASSOCIATES INC. AND THE REPRODUCTION OF ANY PART OF IT WITHOUT PRIOR WRITTEN CONSENT OF THIS OFFICE IS STRICTLY PROHIBITED.  
 THE CONTRACTOR SHALL VERIFY ALL DIMENSIONS, LEVELS, AND DATUMS ON SITE AND REPORT ANY DISCREPANCIES OR OMISSIONS TO THIS OFFICE PRIOR TO CONSTRUCTION.  
 THIS DRAWING IS TO BE READ AND UNDERSTOOD IN CONJUNCTION WITH ALL OTHER PLANS AND DOCUMENTS APPLICABLE TO THIS PROJECT. DO NOT SCALE THIS DRAWING.  
 ALL EXISTING UNDERGROUND UTILITIES TO BE VERIFIED IN THE FIELD BY THE CONTRACTOR PRIOR TO CONSTRUCTION.

Project  
 125 COLONNADE ROAD

Drawing  
 POST-DEVELOPMENT DRAINAGE PLAN

NOT FOR CONSTRUCTION

Stamp  
**FOR REVIEW**

**CROZIER CONSULTING ENGINEERS**  
 2800 HIGH POINT DRIVE  
 SUITE 100  
 MILTON, ON L9T 6P4  
 905-875-0026 T  
 905-875-4915 F  
 WWW.CFCROZIER.CA

Drawn	M.I.M.	Design	B.P.	Project No.	2112-6218
Check	B.W.	Check	B.W.	Scale	1:500
				Dwg.	FIG 2

