

Label Save: 2022-08-22 12:50:12 PM
 File Location: Z:\Projects\2096-01 50 The Driveway\Drawings\TCR\2096-01 50 The Driveway_Rec-Zoning\01 TCR_R5.dwg

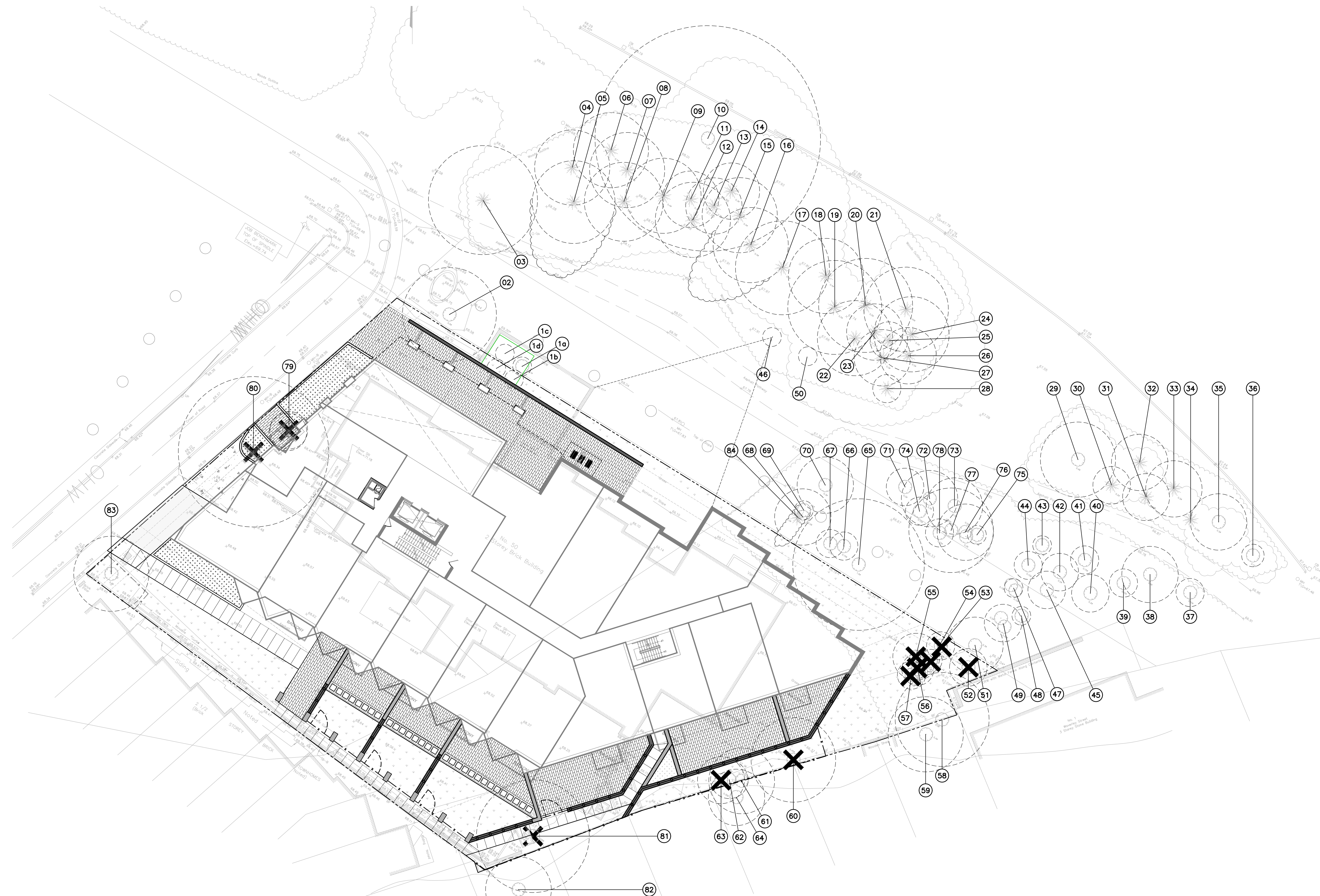

LEGEND

- 00 TREE IDENTIFICATION NUMBER
- EXTENT OF CRITICAL ROOT ZONE
- EXISTING TREE WITH TRUNK LOCATION
- EXISTING TREE TO BE REMOVED
- EXISTING TREE - UNDER REVIEW (REFER TO TCR02)
- TREE PROTECTION FENCE

No.	Revision	Date
5.	REISSUED FOR SPA	27 MAR, 2023
4.	ISSUED FOR NCC REVIEW	22 SEP, 2022
3.	ISSUED FOR SPA	14 JUN, 2022
2.	REISSUED FOR RE-ZONING	07 DEC, 2021
1.	ISSUED FOR RE-ZONING	15 JUL, 2021

North:	Stamp:

CSW

Landscape Architecture
 Urban Design
 Site Planning
 Recreation and Park Planning
 Project Management

319 McRae Avenue, Suite 502, Ottawa, Ontario K1Z 0B9
 Tel: (613) 729-4536 Fax: (855) 736-9161

1. All measurements in millimeters unless specified otherwise. Do not scale drawing. All drawings to be read in conjunction with written specifications.
2. Copyright reserved. This drawing is the exclusive property of CSW Landscape Architects Ltd. and shall not be used without the consent thereof.
3. This Drawing may not be used for construction until signed by the landscape architect. It is the responsibility of the contractor to:
 - check and verify all dimensions on site;
 - report all errors and/or omissions to the landscape architect;
 - comply with all pertinent codes and by-laws;
 - check and verify locations of all underground services with all local utilities prior to any digging.

Project:
50 THE DRIVEWAY
 50 THE DRIVEWAY
 OTTAWA, ONTARIO

Drawing:
TREE CONSERVATION REPORT

Scale: 1:200	Date: JULY, 2021
Design By: AC	Drawn By: SMc
Project Number: 2096-01	Sheet Number: TCR 01

Tree #	Botanical Name	Common Name	Caliper (cm)	Condition	High Quality Tree	Rare Tree	Comments	To Be Preserved
1a	Amelanchier canadensis	Canadian Serviceberry	4 @ 10	Good	No	No	NCC owned, Symmetrical canopy, Die-back: ~10% @ canopy, Pruned @ branches, Multi-stem, Bark rot @ limbs, Included bark. Modifications proposed for NCC review to mitigate impact and retain tree.	Retained
1b	Amelanchier canadensis	Canadian Serviceberry	5 @ 10	Good	No	No	NCC owned, Symmetrical canopy, Die-back: ~10% @ canopy, Pruned @ branches, Multi-stem	Retained
1c	Amelanchier canadensis	Canadian Serviceberry	4 @ 10	Good	No	No	NCC owned, Symmetrical canopy, Die-back: ~10% @ canopy, Pruned @ branches, Multi-stem. Modifications proposed for NCC review to mitigate impact and retain tree.	Retained
1d	Amelanchier canadensis	Canadian Serviceberry	4 @ 10	Good	No	No	NCC owned, Symmetrical canopy, Die-back: ~10% @ canopy, Pruned @ branches, Multi-stem	Retained
2	Tilia cordata	Little-leaf Linden	48	Good	No	No	NCC owned, Symmetrical canopy, Pruned @ limbs, Single stem, Co-dominant leaders: 2 @ ~6m above grade, Included bark. Modifications to design proposed for NCC review to mitigate impact and retain tree - Refer to TCR 03	Retained
3	Picea pungens	Blue Spruce	58	Good	No	No	NCC owned, Asymmetrical canopy, Die-back: ~5% @ canopy, Pruned @ branches, Single stem	Retained
4	Pinus nigra	Austrian Pine	40	Good	No	No	NCC owned, Asymmetrical canopy, Die-back: ~5% @ branches, Limbed up, Single stem	Retained
5	Pinus nigra	Austrian Pine	44	Moderate	No	No	NCC owned, Asymmetrical canopy, Pruned @ OH Utilities, Poor branch angle, Single stem, Leaning - Refer to Page TCR 03	Retained
6	Pinus nigra	Austrian Pine	30	Good	No	No	NCC owned, Asymmetrical canopy, Die-back: ~5% @ branches, Limbed up, Single stem	Retained
7	Pinus nigra	Austrian Pine	35	Good	No	No	NCC owned, Symmetrical canopy, Broken limbs, Limbed up, Ex feature: Tree tag	Retained
8	Pinus nigra	Austrian Pine	42	Good	No	No	NCC owned, Symmetrical canopy, Limbed up, Single stem, Leaning	Retained
9	Pinus nigra	Austrian Pine	40	Good	No	No	NCC owned, Asymmetrical canopy, Die-back: ~5% @ branches, Broken limbs, Limbed up, Single stem, Bark rot @ trunk, Ex feature: Tree tag	Retained
10	Platanus occidentalis	American Sycamore	120	Good	Yes	Yes	NCC owned, Asymmetrical canopy, Die-back: ~5% @ canopy, Broken limbs, Single stem, Bark rot @ cavities	Retained
11	Pinus nigra	Austrian Pine	30	Good	No	No	NCC owned, Asymmetrical canopy, Single stem	Retained
12	Pinus nigra	Austrian Pine	40	Good	No	No	NCC owned, Asymmetrical canopy, Broken limbs, Pruned @ limbs, Single stem, Leaning	Retained
13	Pinus nigra	Austrian Pine	32	Good	No	No	NCC owned, Asymmetrical canopy, Die-back: ~5% @ branches, Single stem	Retained
14	Pinus nigra	Austrian Pine	30	Good	No	No	NCC owned, Asymmetrical canopy, Die-back: ~15% @ canopy, Limbed up, Single stem, Ex feature: Tree tag	Retained
15	Pinus nigra	Austrian Pine	40	Good	No	No	NCC owned, Asymmetrical canopy, Die-back: ~5% @ canopy, Limbed up, Single stem, Ex feature: Tree tag	Retained
16	Pinus nigra	Austrian Pine	40	Good	No	No	NCC owned, Asymmetrical canopy, Limbed up, Single stem, Ex feature: Tree tag - Proposed to be pruned - Refer to TCR 03	Retained
17	Pinus nigra	Austrian Pine	50	Good	No	No	NCC owned, Asymmetrical canopy, Limbed up, Single stem	Retained
18	Pinus nigra	Austrian Pine	40	Good	No	No	NCC owned, Symmetrical canopy, Limbed up, Single stem	Retained
19	Pinus nigra	Austrian Pine	50	Good	No	No	NCC owned, Asymmetrical canopy, Single stem	Retained
20	Pinus nigra	Austrian Pine	50	Moderate	No	No	NCC owned, Asymmetrical canopy, Die-back: ~10% @ canopy, Limbed up, Single stem, Ex feature: Tree tag	Retained
21	Pinus nigra	Austrian Pine	45	Good	No	No	NCC owned, Asymmetrical canopy, Limbed up, Single stem	Retained
22	Pinus nigra	Austrian Pine	40	Good	No	No	NCC owned, Asymmetrical canopy, Single stem	Retained
23	Pinus nigra	Austrian Pine	30	Moderate	No	No	NCC owned, Asymmetrical canopy, Die-back: ~15% @ crown, Limbed up, Single stem	Retained
24	Pinus nigra	Austrian Pine	40	Moderate	No	No	NCC owned, Asymmetrical canopy, Single stem, Ex feature: Tree tag	Retained
25	Picea pungens	Blue Spruce	20	Moderate	No	No	NCC owned, Symmetrical canopy, Die-back: ~5% @ canopy, Single stem, Ex feature: Tree tag, Dead leader	Retained
26	Pinus nigra	Austrian Pine	30	Good	No	No	NCC owned, Asymmetrical canopy, Single stem, Leaning, Ex feature: Tree tag	Retained
27	Picea pungens	Blue Spruce	45	Good	No	No	NCC owned, Asymmetrical canopy, Die-back: ~5% @ canopy, Broken limbs, Limbed up, Single stem	Retained
28	Pinus nigra	Austrian Pine	15	Good	No	No	NCC owned, Symmetrical canopy, Single stem	Retained
29	Acer freemanii	Freeman Maple	40	Good	No	No	NCC owned, Symmetrical canopy, Single stem, Included bark	Retained
30	Picea pungens	Blue Spruce	20	Good	No	No	NCC owned, Symmetrical canopy, Die-back: ~10% @ branches, Single stem	Retained
31	Pinus nigra	Austrian Pine	30	Good	No	No	NCC owned, Symmetrical canopy, Single stem	Retained
32	Picea pungens	Blue Spruce	25	Good	No	No	NCC owned, Symmetrical canopy, Single stem	Retained
33	Pinus nigra	Austrian Pine	30	Good	No	No	NCC owned, Die-back: ~10% @ branches, Single stem	Retained
34				Dead	No	No		
35	Acer freemanii	Freeman Maple	30	Good	No	No	NCC owned, Symmetrical canopy, Single stem, Included bark	Retained
36	Acer saccharum	Sugar Maple	12	Good	No	No	NCC owned, Symmetrical canopy, Single stem	Retained
37	Acer freemanii	Freeman Maple	15	Good	No	No	NCC owned, Symmetrical canopy, Single stem, Included bark	Retained
38	Phellodendron amurense	Amur cork tree	30	Good	No	No	NCC owned, Symmetrical canopy, Pruned @ limbs, Bark rot @ crotches	Retained
39	Acer ginnala	Amur Maple	15	Moderate	No	No	NCC owned, Asymmetrical canopy, Die-back: ~40% @ canopy, Single stem	Retained
40	Syringa reticulata	Japanese Tree Lilac	4 @ 20	Good	No	No	NCC owned, Symmetrical canopy, Die-back: ~20% @ canopy, Broken limbs, Multi-stem: 4	Retained
41	Rhamus spp	Buckthorn	5 @ 10	Moderate	No	No	NCC owned, Asymmetrical canopy, Die-back: ~15% @ canopy, Broken limbs, Multi-stem: 5	Retained
42	Syringa reticulata	Japanese Tree Lilac	4 @ 20	Good	No	No	NCC owned, Asymmetrical canopy, Broken limbs, Multi-stem: 4, Included bark	Retained
43	Rhamus spp	Buckthorn	3 @ 10	Moderate	No	No	NCC owned, Asymmetrical canopy, Multi-stem: 3	Retained
44	Rhamus spp	Buckthorn	3 @ 10	Good	No	No	NCC owned, Asymmetrical canopy, Pruned @ limbs, Multi-stem: 3	Retained
45	Rhamus spp	Buckthorn	5 @ 8	Moderate	No	No	NCC owned, Asymmetrical canopy, Broken limbs, Multi-stem: 5	Retained
46	Euonymus spp.	Euonymus	5 @ 10	Good	No	No	NCC owned, Asymmetrical canopy, Multi-stem: 5, pruned limbs	Retained
47	Acer ginnala	Amur Maple	7 @ 10	Good	No	No	NCC owned, Asymmetrical canopy, Multi-stem: 7	Retained

48	Acer ginnala	Amur Maple	2 @ 10	Moderate	No	No	NCC owned, Asymmetrical canopy, Multi-stem: 2	Retained
49	Acer negundo	Manitoba Maple	5 @ 18	Moderate	No	No	NCC owned, Asymmetrical canopy, Die-back: ~15% @ canopy, Broken limbs, Multi-stem: 5	Retained
50	Pinus nigra	Austrian Pine	10	Good	No	No	NCC owned, Asymmetrical canopy, Single stem, Co-dominant leaders: 2 @ ~1m above grade	Retained
51	Acer negundo	Manitoba Maple	22	Good	No	No	NCC owned, Symmetrical canopy, Die-back: ~15% @ branches, Single stem	Retained
52	Acer platanoides	Norway Maple	20	Good	No	No	Privately owned, Symmetrical canopy, Single stem. Invasive species identified for preferred retention by others. Preservation status under review.	Removed
53	Acer negundo	Manitoba Maple	2 @ 20	Good	No	No	Privately owned, Symmetrical canopy, Multi-stem: 2, Leaning. Identified for preferred retention by others. Preservation status under review due to poor form.	Removed
54	Acer negundo	Manitoba Maple	17	Good	No	No	Privately owned, Die-back: ~10% @ canopy, Single stem. Identified for preferred retention by others. Preservation status under review due to poor form.	Removed
55	Acer negundo	Manitoba Maple	2 @ 25	Good	No	No	Privately owned, Asymmetrical canopy, Multi-stem: 2, Leaning. Identified for preferred retention by others. Preservation status under review due to poor form.	Removed
56	Acer negundo	Manitoba Maple	12	Good	No	No	Privately owned, Asymmetrical canopy, Single stem, Leaning. Identified for preferred retention by others. Preservation status under review due to poor form.	Removed
57	Acer negundo	Manitoba Maple	17	Moderate	No	No	Privately owned, Asymmetrical canopy, Single stem, Bark rot @ trunk, Leaning. Identified for preferred retention by others. Preservation status under review due to poor form.	Removed
58	Tilia americana	Basswood	50	Good	No	No	Privately owned, Symmetrical canopy, Die-back: ~5% @ branches, Single stem	Retained
59	Tilia americana	Basswood	40	Good	No	No	Privately owned, Symmetrical canopy, Single stem	Retained
60	Acer negundo	Boxelder Maple	10	Good	No	No	Privately owned, Asymmetrical canopy, Single stem, Leaning	Removed
61	Acer platanoides	Norway Maple		Good	No	No	Privately owned, Asymmetrical canopy, Single stem	Retained
62				Dead	No	No		
63	Acer platanoides	Norway Maple	20	Poor	No	No	Privately owned, Asymmetrical canopy, Die-back: ~90% @ canopy, Pruned @ leader, single stem	Removed
64	Acer platanoides	Norway Maple	25	Good	No	No	Privately owned, Asymmetrical canopy, Broken limbs, Single stem	Retained
65	Gymnocladus dioicis	Kentucky Coffee-tree	74	Good	No	No	NCC owned, Symmetrical canopy, Die-back: ~5% @ branches, Broken limbs, Single stem - Special treatment proposed to retain tree - Refer to TCR 03	Retained
66	Acer platanoides	Norway Maple	13	Good	No	No	NCC owned, Asymmetrical canopy, Die-back: ~10% @ branches, Single stem, Included bark	Retained
67	Gymnocladus dioicis	Kentucky Coffee-tree	13	Good	No	No	NCC owned, Asymmetrical canopy, Single stem	Retained
68	Gymnocladus dioicis	Kentucky Coffee-tree	25	Good	No	No	NCC owned, Asymmetrical canopy, Die-back: ~5% @ branches, Single stem	Retained
69	Acer negundo	Manitoba Maple	30	Moderate	No	No	NCC owned, Asymmetrical canopy, Single stem, Leaning - due to main stem leaning significantly onto adjacent property it is proposed to be removed and compensation offered - subject to NCC approval. Refer to TCR 03	Removed
70	Acer platanoides	Norway Maple	2 @ 25	Good	No	No	NCC owned, Asymmetrical canopy, Single stem, Co-dominant leaders: 2 @ ~1m above grade, Included bark	Retained
71	Pinus nigra	Austrian Pine	20	Good	No	No	NCC owned, Asymmetrical canopy, Die-back: ~10% @ canopy, Broken limbs, Single stem, Ex feature: Tree tag	Retained
72	Pinus nigra	Austrian Pine	30	Good	No	No	NCC owned, Asymmetrical canopy, Die-back: ~15% @ branches, Single stem, Ex feature: Tree tag	Retained
73	Pinus nigra	Austrian Pine	30	Moderate	No	No	NCC owned, Asymmetrical canopy, Die-back: ~40% @ branches, Broken limbs, Single stem, Chlorosis @ canopy	Retained
74	Pinus nigra	Austrian Pine	15	Moderate	No	No	NCC owned, Asymmetrical canopy, die-back: ~35% @ canopy, Broken limbs, Single stem	Retained
75	Gymnocladus dioicis	Kentucky Coffee-tree	3 @ 10	Good	No	No	NCC owned, Asymmetrical canopy, Multi-stem: 3, Leaning	Retained
76	Gymnocladus dioicis	Kentucky Coffee-tree	2 @ 25	Good	No	No	NCC owned, Symmetrical canopy, Multi-stem: 2	Retained
77	Gymnocladus dioicis	Kentucky Coffee-tree	12	Good	No	No	NCC owned, Single stem	Retained
78	Gymnocladus dioicis	Kentucky Coffee-tree	20	Good	No	No	NCC owned, Asymmetrical canopy, Single stem	Retained
79	Syringa reticulata	Japanese Tree Lilac	20	Good	No	No	Privately owned, Symmetrical canopy, Pruned @ limbs, Single stem, Included bark	Removed
80	Quercus rubra	Northern Red Oak	80	Good	No	No	Privately owned, Symmetrical canopy, Die-back: ~5% @ canopy, Single stem	Removed
81	Acer negundo	Manitoba Maple	60	Good	No	No	Privately owned, Asymmetrical canopy, Single stem	Removed
82	Acer negundo	Manitoba Maple	35	Moderate	No	No	Privately owned, Asymmetrical canopy, Single stem	Retained
83	Tilia cordata	Little-leaf Linden	40	Good	No	No	Privately owned, Symmetrical canopy, Pruned @ limbs, Single stem. CRZ impacted by proposed pavements - potential for retention under review.	Retained
84				Missing				

TREE PRESERVATION:

- ALL TREES SHOWN AS RETAINED WILL BE PROTECTED USING TREE PROTECTION FENCING. EXACT LOCATIONS OF FENCING TO BE DETERMINED WHEN EXTENTS OF EXCAVATION ARE KNOWN.
- FOR TREES ON NCC PROPERTY, ADDITIONAL PROTECTION MEASURES TO BE DETERMINED TO THE NCC'S APPROVAL, WHEN EXTENTS OF EXCAVATION AND ACCESS REQUIREMENTS ARE KNOWN. PLANS TO BE DEVELOPED WITH NCC INPUT PRIOR TO ANY CONSTRUCTION AND ALL MEASURES AND IMPACTS WILL BE MONITORED THROUGHOUT THE CONSTRUCTION PERIOD. LETTERS OF CREDIT FOR THE COST OF HIGH-VALUE TREES WILL BE PROVIDED TO THE NCC FOR COMPENSATION IN THE EVENT OF THE TREES' DECLINE OR DEATH, PER NCC REQUEST.

No.	Revision	Date
5.	REISSUED FOR SPA	27 MAR, 2023
4.	ISSUED FOR NCC REVIEW	22 SEP, 2022
3.	ISSUED FOR SPA	14 JUN, 2022
2.	REISSUED FOR RE-ZONING	07 DEC, 2021
1.	ISSUED FOR RE-ZONING	15 JUL, 2021

LEGEND

- TREE IDENTIFICATION NUMBER
- EXTENT OF CRITICAL ROOT ZONE
- EXISTING TREE WITH TRUNK LOCATION
- EXISTING TREE TO BE REMOVED
- EXISTING TREE - UNDER REVIEW (REFER TO TCR02)
- TREE PROTECTION FENCE

North:

Stamp:

CSW
Landscape Architecture
Urban Design
Site Planning
Recreation and Park Planning
Project Management

319 McRae Avenue, Suite 502, Ottawa, Ontario K1Z 0B9
Tel: (613) 729-4536 Fax: (855) 736-9161

- All measurements in millimeters unless specified otherwise. Do not scale drawing. All drawings to be read in conjunction with written specifications.
- Copyright reserved. This drawing is the exclusive property of CSW Landscape Architects Ltd. and shall not be used without the consent thereof.
- This Drawing may not be used for construction until signed by the landscape architect. It is the responsibility of the contractor to:
 - check and verify all dimensions on site;
 - report all errors and/or omissions to the landscape architect;
 - comply with all pertinent codes and by-laws;
 - check and verify locations of all underground services with all local utilities prior to any digging.

Project:
50 THE DRIVEWAY

50 THE DRIVEWAY
OTTAWA, ONTARIO

Drawing:
TREE CONSERVATION REPORT

Scale: N.T.S.	Date: JULY, 2021
Design By: AC	Drawn By: SMc
Project Number: 2096-01	Sheet Number: TCR 02

 319 McRae Avenue Suite 502 Ottawa, Ontario K1Z 0B9 TEL: 1(613)729-4536		TRUNK FORMULA METHOD	TREE #: 02
PROJECT:	50 The Driveway		
APPRAISER:	Lisa MacDonald		
FIELD OBSERVATIONS:			
1. TREE SPECIES	Tilia Cordata		
2. CONDITION RATING	75 %		
3. TRUNK DIAMETER	48 cm		
4. TRUNK AREA	1810 cm ²		
5. LOCATION RATING (LINE 6+7+8) / 3	72 %		
6. SITE POSITION	90 %		
7. SITE CONTRIBUTION	90 %		
8. SITE PLACEMENT	35 %		
PLANT APPRAISAL			
9. SPECIES RATING	67 %		
10. REPLACEMENT TREE DIAMETER	10 cm		
11. REPLACEMENT TRUNK AREA	79 cm ²		
12. REPLACEMENT TREE COST (LINE 13 +14)	\$ 1,250		
13. SUPPLY AND INSTALL	\$ 750		
14. WARRANTY & ESTABLISHMENT	\$ 500		
15. UNIT TREE COST (LINE 13 / 11)	\$ 9.55 cm ²		
CALCULATIONS			
16. APPRAISED TRUNK VALUE (LINE 4 - 10)	1800 cm ²		
17. APPRAISED TRUNK INCREASE (LINE 16 - 11)	1721 cm ²		
18. BASIC TREE COST (LINE 17 x 15 + 12)	\$ 17,685		
19. APPRAISED VALUE (LINE 18 x 2 x 5 x 9)	\$ 6,369		
20. APPRAISED VALUE (ROUNDED TO NEAREST \$25)	\$ 6,375		

- Condition Rating: 'Good'
 No significant damage or disease, normal vigour, good form. Double leader with cracking constitutes a defect, though it may be mitigated.
 - Location Rating:
 Site Position and Contribution are good, however placement very close to property line is unfortunate.
 - Species Rating:
 Lower end of range of values was chosen due to invasive status of Tilia cordata in Ottawa region.

1 EVALUATION OF TREE #2

 319 McRae Avenue Suite 502 Ottawa, Ontario K1Z 0B9 TEL: 1(613)729-4536		TRUNK FORMULA METHOD	TREE #: 65
PROJECT:	50 The Driveway		
APPRAISER:	Lisa MacDonald		
FIELD OBSERVATIONS:			
1. TREE SPECIES	Gymnocladus dioicus		
2. CONDITION RATING	80 %		
3. TRUNK DIAMETER	74 cm		
4. TRUNK AREA	4301 cm ²		
5. LOCATION RATING (LINE 6+7+8) / 3	73 %		
6. SITE POSITION	90 %		
7. SITE CONTRIBUTION	90 %		
8. SITE PLACEMENT	40 %		
PLANT APPRAISAL			
9. SPECIES RATING	81 %		
10. REPLACEMENT TREE DIAMETER	10 cm		
11. REPLACEMENT TRUNK AREA	79 cm ²		
12. REPLACEMENT TREE COST (LINE 13 +14)	\$ 1,250		
13. SUPPLY AND INSTALL	\$ 750		
14. WARRANTY & ESTABLISHMENT	\$ 500		
15. UNIT TREE COST (LINE 13 / 11)	\$ 9.55 cm ²		
CALCULATIONS			
16. APPRAISED TRUNK VALUE (LINE 4 - 10)	4291 cm ²		
17. APPRAISED TRUNK INCREASE (LINE 16 - 11)	4212 cm ²		
18. BASIC TREE COST (LINE 17 x 15 + 12)	\$ 41,475		
19. APPRAISED VALUE (LINE 18 x 2 x 5 x 9)	\$ 19,709		
20. APPRAISED VALUE (ROUNDED TO NEAREST \$25)	\$ 19,700		

- Condition Rating: 'Good'
 No significant damage or disease, normal vigour, good form. No significant structural defects.
 - Location Rating:
 Site Position and Contribution are good, however placement very close to property line is unfortunate.

2 EVALUATION OF TREE #65

 319 McRae Avenue Suite 502 Ottawa, Ontario K1Z 0B9 TEL: 1(613)729-4536		TRUNK FORMULA METHOD	TREE #: 69
PROJECT:	50 The Driveway		
APPRAISER:	Lisa MacDonald		
FIELD OBSERVATIONS:			
1. TREE SPECIES	Acer negundo		
2. CONDITION RATING	40 %		
3. TRUNK DIAMETER	30 cm		
4. TRUNK AREA	707 cm ²		
5. LOCATION RATING (LINE 6+7+8) / 3	57 %		
6. SITE POSITION	90 %		
7. SITE CONTRIBUTION	40 %		
8. SITE PLACEMENT	40 %		
PLANT APPRAISAL			
9. SPECIES RATING	38 %		
10. REPLACEMENT TREE DIAMETER	10 cm		
11. REPLACEMENT TRUNK AREA	79 cm ²		
12. REPLACEMENT TREE COST (LINE 13 +14)	\$ 1,250		
13. SUPPLY AND INSTALL	\$ 750		
14. WARRANTY & ESTABLISHMENT	\$ 500		
15. UNIT TREE COST (LINE 13 / 11)	\$ 9.55 cm ²		
CALCULATIONS			
16. APPRAISED TRUNK VALUE (LINE 4 - 10)	697 cm ²		
17. APPRAISED TRUNK INCREASE (LINE 16 - 11)	618 cm ²		
18. BASIC TREE COST (LINE 17 x 15 + 12)	\$ 7,155		
19. APPRAISED VALUE (LINE 18 x 2 x 5 x 9)	\$ 616		
20. APPRAISED VALUE (ROUNDED TO NEAREST \$25)	\$ 625		

- Condition Rating: 'Fair'
 No significant damage or disease, normal vigour, good form. Severe leaning/ bowing not correctable.
 - Location Rating:
 Site position as part of a larger grouping of trees is a beneficial factor, however the position and leaning of the tree is a liability.

3 EVALUATION OF TREE #69

Rating Category	Health	Condition Components Structure	Form	Percentage Rating
Excellent	Nearly perfect vigor and health with little or no twig dieback, discoloration or defoliation. Applicable to small-diameter plants that are well-established.	Nearly ideal and free of defects.	Nearly ideal or generally symmetric. Consistent with the species and/or the intended use.	80 to 100%
Good	No significant damage due to diseases or pests. Vigor is normal for the species. Any twig dieback, defoliation or discoloration is minor. Any dead branches are small in size.	Well-developed structure. Defects are minor and can be corrected.	Minor asymmetries/deviations from species norm and/or the design intent. Function and aesthetics are not compromised.	60 to 80%
Fair	Normal to slightly reduced vigor. Significant damage due to insects or diseases but is unlikely to be fatal. Twig dieback, defoliation, discoloration and/or dead branches may comprise up to 50% of the crown.	Multiple defects in structure. Most cannot be corrected.	Major asymmetries/deviations from species norm and/or design intent. Function and aesthetics are compromised.	40 to 60%
Poor	Unhealthy and declining in appearance. Overmature in development or severely stressed. Poor vigor. Twig dieback, poor foliage density and poor foliage color are present.	Significant defects in structure. Recent change in orientation. Observed structural problems cannot be fully corrected	Largely asymmetric/abnormal. Detracts from function and aesthetics to a significant degree.	20 to 40%

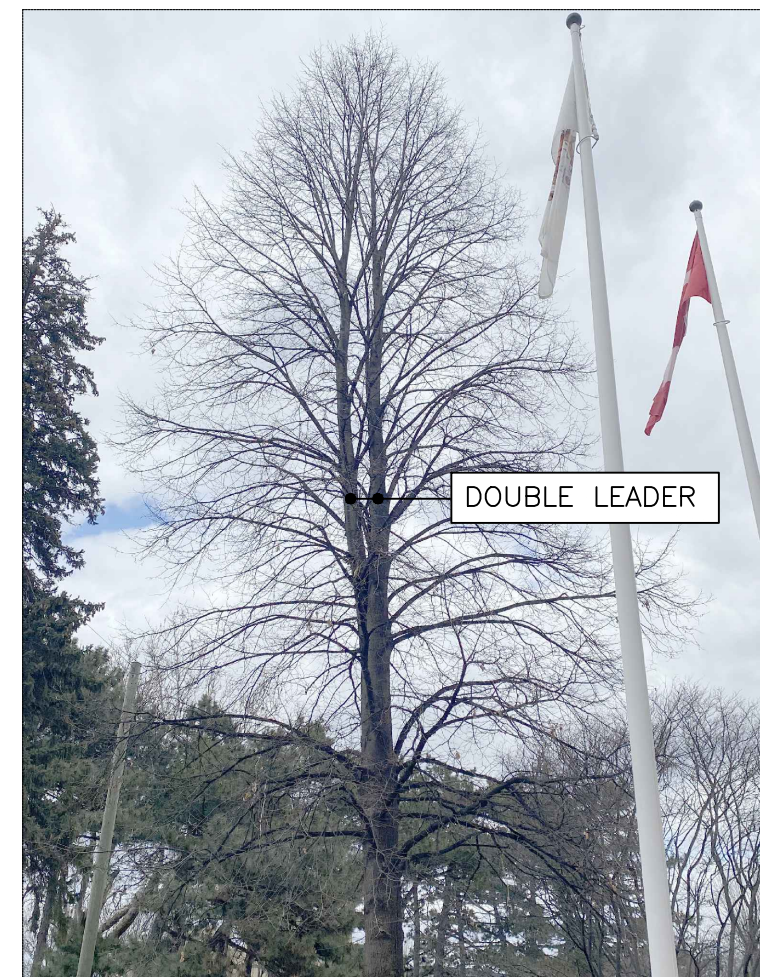

DOUBLE LEADER



CRACKING

5 TREE #2 - PHOTOS

3 TABLE 4-1. ASSESSMENT OF PLANT CONDITION
ISA - GUIDE FOR PLANT APPRAISAL, 10TH ED.
CHAPTER 4. DATA COLLECTION AND ANALYSIS



6 TREE #5 - PHOTO
CANOPY EXTENDS BEYOND CRITICAL ROOT ZONE - STAGING BOUNDARIES ADJUSTED FOR PROTECTION



7 TREE #16 - PHOTO
LIMBS EXTEND BEYOND CRITICAL ROOT ZONE - PRUNING IS PROPOSED FOR STAGING AREA

LEGEND		
	TREE IDENTIFICATION NUMBER	
	EXTENT OF CRITICAL ROOT ZONE	
	EXISTING TREE WITH TRUNK LOCATION	
	EXISTING TREE TO BE REMOVED	
	EXISTING TREE - UNDER REVIEW (REFER TO TCR02)	
TREE PROTECTION FENCE		
5.	REISSUED FOR SPA	27 MAR, 2023
4.	ISSUED FOR NCC REVIEW	22 SEP, 2022
3.	ISSUED FOR SPA	14 JUN, 2022
2.	REISSUED FOR RE-ZONING	07 DEC, 2021
1.	ISSUED FOR RE-ZONING	15 JUL, 2021
No.	Revision	Date

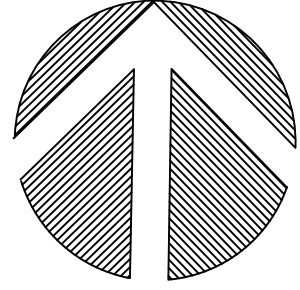
North: 

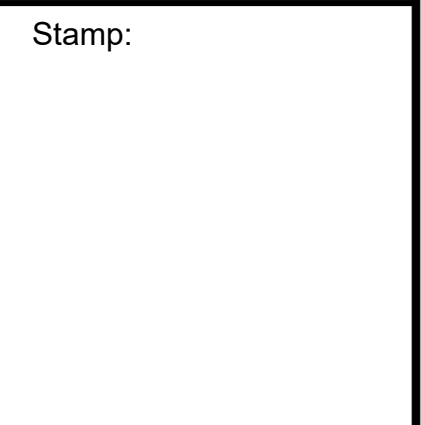
Stamp: 

 Landscape Architecture
 Urban Design
 Site Planning
 Recreation and Park Planning
 Project Management

319 McRae Avenue, Suite 502, Ottawa, Ontario K1Z 0B9
 Tel: (613) 729-4536 Fax: (855) 736-9161

- All measurements in millimeters unless specified otherwise. Do not scale drawing. All drawings to be read in conjunction with written specifications.
- Copyright reserved. This drawing is the exclusive property of CSW Landscape Architects Ltd. and shall not be used without the consent thereof.
- This Drawing may not be used for construction until signed by the landscape architect. It is the responsibility of the contractor to:
 - check and verify all dimensions on site;
 - report all errors and/or omissions to the landscape architect;
 - comply with all pertinent codes and by-laws;
 - check and verify locations of all underground services with all local utilities prior to any digging.

Project:

50 THE DRIVEWAY

50 THE DRIVEWAY
OTTAWA, ONTARIO

Drawing:

TREE CONSERVATION REPORT

Scale:	Date:
N.T.S.	JULY, 2021
Design By:	Drawn By:
AC	SMc
Project Number:	Sheet Number:
2096-01	TCR 03