

REFER TO NOTES &
DETAILS ON DRAWING C-5

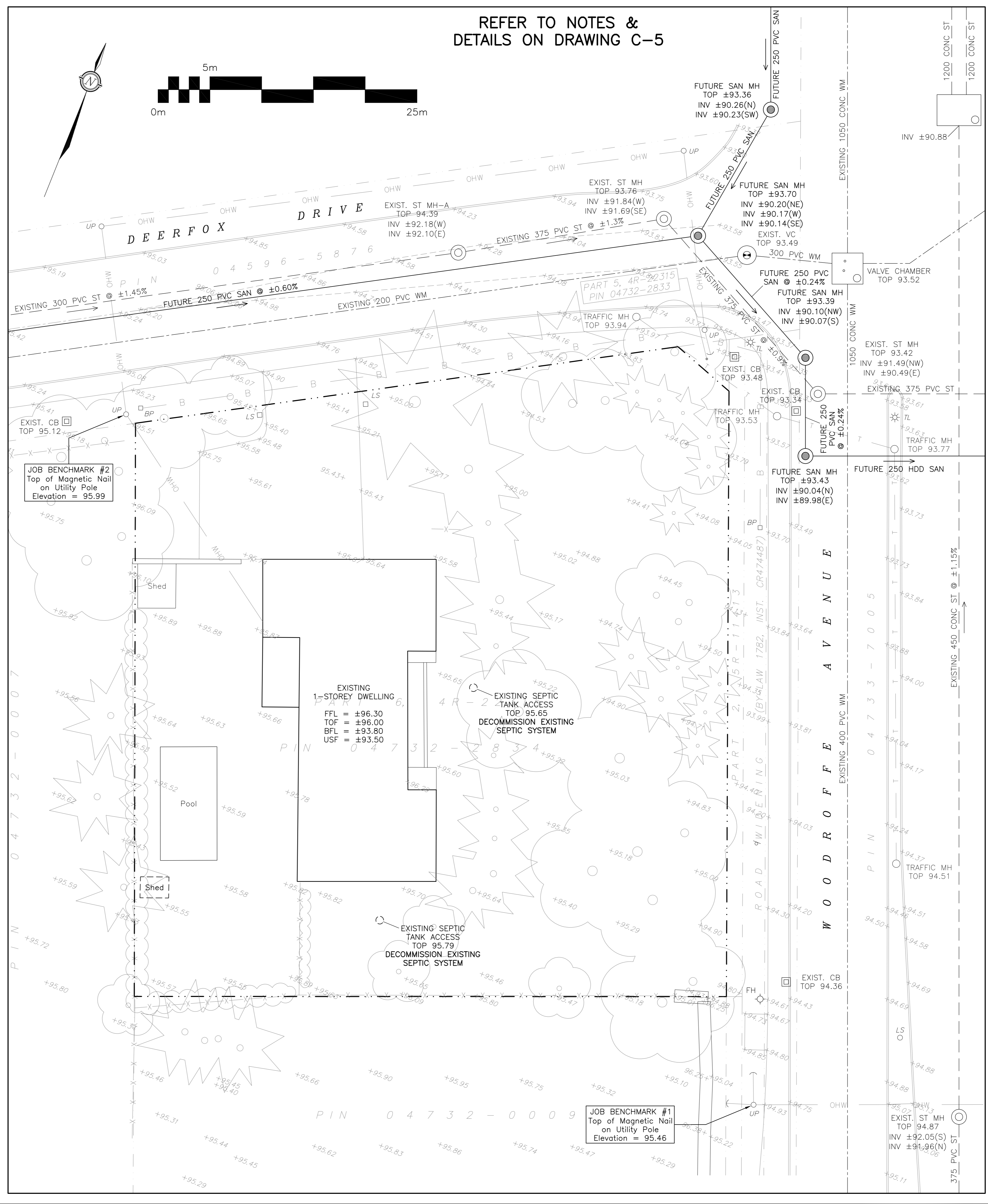

JOB BENCHMARK #2
Top of Magnetic Nail
on Utility Pole
Elevation = 95.99

EXISTING
1-STOREY DWELLING
FFL = ±96.30
TOF = ±96.00
BFL = ±93.80
USF = ±93.50

EXISTING SEPTIC
TANK ACCESS
TOP 95.65
DECOMMISSION EXISTING
SEPTIC SYSTEM

EXISTING SEPTIC
TANK ACCESS
TOP 95.79
DECOMMISSION EXISTING
SEPTIC SYSTEM

JOB BENCHMARK #1
Top of Magnetic Nail
on Utility Pole
Elevation = 95.46

EXIST. ST MH
TOP 94.87
INV ±92.05(S)
INV ±91.96(N)
INV ±91.06

LEGEND

- FFL FINISHED FLOOR ELEVATION
- TOF TOP OF FOUNDATION
- BFL BASEMENT FLOOR ELEVATION
- USF UNDERSIDE OF FOOTING
- PROPERTY LINE
- CB CATCH-BASIN
- MH STORM MANHOLE
- CB/MH CATCH-BASIN/MANHOLE
- MH SANITARY MANHOLE
- VC VALVE CHAMBER
- FH FIRE HYDRANT
- CS CURB STOP & STANDPOST
- SAN SANITARY SEWER
- ST STORM SEWER
- WS/WM WATER SERVICE/WATERMAIN
- SPL SPRINGLINE OF PIPE
- INV INVERT OF PIPE
- EXISTING GRADE ELEVATION
- 150mm BARRIER CURB

KEY PLAN



No.	DATE	REVISION
2	JUN 2-22	ISSUED FOR APPROVAL
1	MAY 16-22	ISSUED FOR COORDINATION

D. B. GRAY ENGINEERING INC.
Stormwater Management - Grading & Drainage - Storm & Sanitary Sewers - Watermain
700 Long Point Circle 613-425-8044
Ottawa, Ontario d.gray@dbgrayengineering.com

Project
EXHALO SPA
3150 WOODROFFE AVENUE
OTTAWA, ONTARIO

Drawing Title
EXISTING CONDITIONS,
REMOVALS &
DECOMMISSIONING

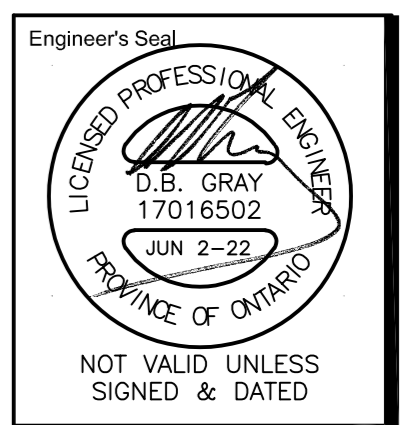

Drawn D.B.G.
H. Scale 1:200
V. Scale
Date MAR 21-22
Job No. 22017

Drawing No.
C-2
of 7

NOT VALID UNLESS
SIGNED & DATED