

Assumption: 1m soil depth
(0.5m imported soil, 0.5m existing subsoil.)

TREE TYPE / SIZE	RECOMMENDED SOIL VOLUME (m3)	SHARED SOIL VOLUME (m3)	SOIL VOLUME - CSC SOIL	SHARED SOIL VOLUME - CSC SOIL	MAX DEPTH (m)
Ornamental	15	9	20	12	1
Columnar	15	9	20	12	1
Small	20	12	25	15	1
Medium	25	15	30	18	1.2
Large	30	18	35	20	1.3
Evergreen	25	15	30	18	1.2

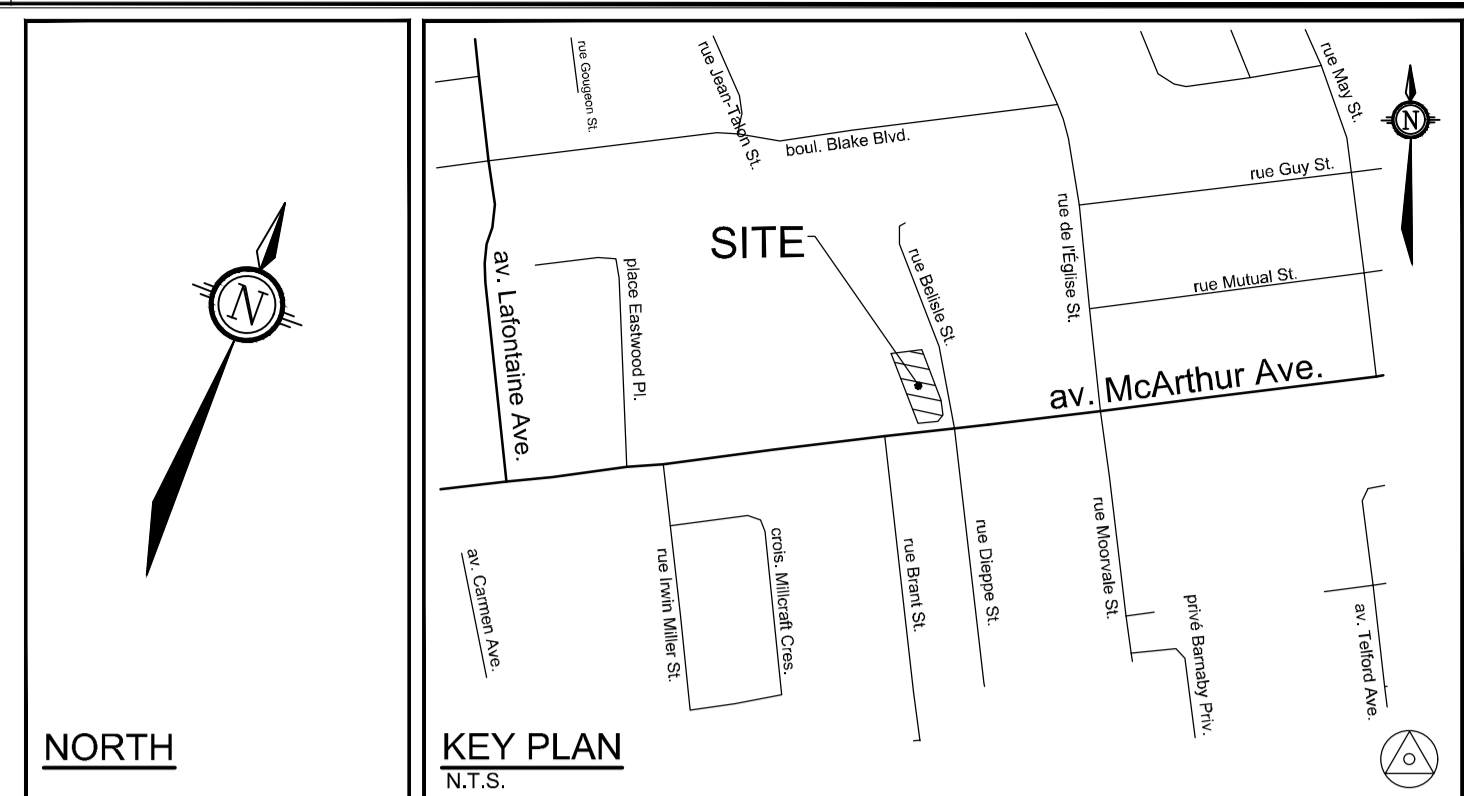

- LEGEND**
- PROPERTY LIMIT
 - [Pattern] PROPOSED CONCRETE
 - [Pattern] PROPOSED PRIVATE SPACE PAVERS
 - [Pattern] PROPOSED PUBLIC SPACE PAVERS
 - [Pattern] PROPOSED COMMERCIAL SPACE PAVERS
 - [Pattern] SOD
 - [Pattern] PERENNIALS
 - [Pattern] ORNAMENTAL GRASSES
 - [Pattern] GROUNDCOVER/VINE
 - [Symbol] PROPOSED DECIDUOUS TREE
 - [Symbol] EXISTING TREE TO REMOVE
 - [Symbol] PROPOSED SHRUBS
 - [Symbol] SPECIES (SEE PLANT LIST)
 - [Symbol] QUANTITY
 - [Symbol] PROPOSED WOOD PRIVACY FENCE 1.8m HT
 - OVERHANG/BALCONY ABOVE
 - [Symbol] PROPOSED PRIVACY SCREEN
 - [Symbol] PROPOSED RETAINING WALL

- GENERAL**
- Read and interpret this drawing/ drawing set in conjunction with all the contract details and specifications, including related civil, utility, structural, architectural, mechanical, electrical, environmental, geotechnical, and survey information.
 - The Contractor is to determine the exact location, size, material, and elevation of all existing utilities prior to commencing construction. Protect and assume responsibility for all existing utilities regardless of being shown on the drawings.
 - It is essential to use the plans and details in conjunction with the specifications and notes.
 - Do not scale drawings. Work to dimensions only.
 - Protect all existing and retained vegetation for the duration of construction according to the contract details and specifications.
 - Reinstate all areas and items damaged or disturbed, beyond the Limit of Work, because of construction activities, including but not limited to construction staging areas, haul roads, stockpile areas, etc. to the satisfaction of the Consultant. Unless otherwise noted, Contractor is to reinstate all areas to pre-construction condition or better to the satisfaction of the Contract Administrator.
- PLANTING**
- Plant material to be No. 1 Grade and is to comply with Canadian Standards for Nursery Stock (latest edition) published by the Canadian Nursery Landscape Association. Use structurally sound plant material with strong fibrous root system free of disease, defects, and injuries. Use trees with straight trunks, well and characteristically branched for species. Obtain approval from consultant of plant material at source prior to digging. All trees and shrubs to be container grown, potted, W/B or B/B, as indicated on Plant List. Bare root plants are only acceptable for certain species and as approved by the Landscape Architect.
 - Plant material substitutions are not permitted without the written approval from the Consultant, with 48 hours notice, prior to shipping plant material.
 - Plant locations are schematic / approximate only. Contractor is to stake out locations on site for approval by the Landscape Architect prior to installation. Contractor will assume full responsibility if the Landscape Architect is not notified.
 - The illustrated number of plants shown in the Planting Plan supersedes the estimated number in the Plant List. Contractor to report any discrepancies to the Landscape Architect prior to installation. Contractor will assume full responsibility if the Landscape Architect is not notified.
 - Ensure trees are thoroughly watered following planting. Monitor material and ensure adequate moisture until acceptance.
 - In heavy clay or poorly drained soils, set root ball with root collar 75-100mm higher than finished grade.
 - Approved topsoil depths are as follows:
 - Plant Beds - 450mm continuous depth. Applies to shrubs, perennials, vines, and groundcovers.
 - Sod/Seed Areas - 100mm depth.
 - Sod to be No. 1 Kentucky Bluegrass Sod grown from minimum mixture of 3 Kentucky Bluegrass cultivars. Quality and source are to comply with Canadian Standards for Nursery Stock, Section 17, (latest edition) published by the Canadian Nursery Landscape Nursery Landscape Association.
 - Apply the following unless soil tests show other requirements:
 - Plant Beds - (8-32-16), i.e. 8% Nitrogen, 32% Phosphorus, 16% Potash per manufacturer specifications.
 - Sod Areas - (8-32-16), i.e. 8% Nitrogen, 32% Phosphorus, 16% Potash at a rate of 350kg/ha.
 - Where applicable, for any plant areas with a mix of species/cultivars notes, Contractor is to cluster like plants in groups of 3-5 and evenly distribute these in the noted area.

PLANT LIST

KEY	QTY	BOTANICAL NAME	COMMON NAME	SIZE	COND	SPACING
Deciduous Trees						
UAP	1	<i>Amenanchier canadensis</i> (single stem)	Dowry Serviceberry	50mm Cal	WB	As Shown
UAP	1	<i>Ulmus americana</i> 'Princeton'	Princeton Elm	50mm Cal	WB	As Shown
Coniferous Shrubs						
Psm	22	<i>Pinus mugo</i> 'Stomound'	Stomound Mugo Pine	3g	PT	100cm O.C
Tlg	4	<i>Thuja occidentalis</i> 'Little Giant'	Little Giant Globe Cedar	3g	PT	70cm O.C
Deciduous Shrubs						
Csk	34	<i>Cornus sericea</i> 'Kelsey'	Kelsey Dogwood	2g	PT	60cm O.C
Dsf	25	<i>Diervilla splendens</i> 'Firefly Nightglow'	Firefly Nightglow Bush Honeysuckle	60cm HT	PT	80cm O.C
Rag	14	<i>Rhus aromatica</i> 'Gro-Low'	Gro-Low Fragrant Sumac	3g	PT	80cm O.C
Rtb	8	<i>Rhus typhina</i> 'Baltiger'	Tiger Eyes Cutleaf Staghorn Sumac	3g	PT	As Shown
Perennials						
Pso	77	<i>Hemerocallis</i> 'Stella D'oro'	Stella D'oro Daylily	1g	PT	50cm O.C
Hkr	28	<i>Hosta</i> 'Krossa Regal'	Krossa Regal Hosta	1g	PT	90cm O.C
Rfl	81	<i>Rudbeckia fulgida</i> 'Little Goldstar'	Little Goldstar Black-Eyed Susan	1g	PT	40 cm O.C
Groundcovers/Vines						
ora	6	<i>Campsis radicans</i>	Trumpet Vine	1g	PT	As Shown
psc	167	<i>Phlox subulata</i> 'Candy Stripe'	Candy Stripe Moss Phlox	1g	PT	50cm O.C
Ornamental Grasses						
cbk	48	<i>Calamagrostis brachytricha</i>	Korean Feather Reed Grass	1g	PT	70cm O.C
msp	15	<i>Miscanthus sinensis</i> 'Purpureosens'	Orange Flame Grass	2g	PT	70cm O.C
pvs	27	<i>Panicum virgatum</i> 'Shenandoah'	Shenandoah Switch Grass	1g	PT	70cm O.C

NOTE:
THE POSITION OF ALL POLE LINES, CONDUITS, WATERMANS, SEWERS AND OTHER UNDERGROUND AND OVERGROUND UTILITIES AND STRUCTURES IS NOT NECESSARILY SHOWN ON THE CONTRACT DRAWINGS, AND WHERE SHOWN, THE ACCURACY OF THE POSITION OF SUCH UTILITIES AND STRUCTURES IS NOT GUARANTEED, BEFORE STARTING WORK, DETERMINE THE EXACT LOCATION OF ALL SUCH UTILITIES AND STRUCTURES AND ASSUME ALL LIABILITY FOR DAMAGE TO THEM.

NOT FOR CONSTRUCTION

No.	REVISION	DATE	BY
5.	ISSUED FOR SITE PLAN RESUBMISSION	MAR 7/24	RGJ
4.	ISSUED FOR SITE PLAN RESUBMISSION	NOV 9/23	RGJ
3.	ISSUED FOR SITE PLAN RESUBMISSION	JUNE 9/23	RGJ
2.	ISSUED FOR SITE PLAN RESUBMISSION	DEC 16/22	RGJ
1.	ISSUED FOR SITE PLAN APPLICATION	JUNE 20/22	RGJ

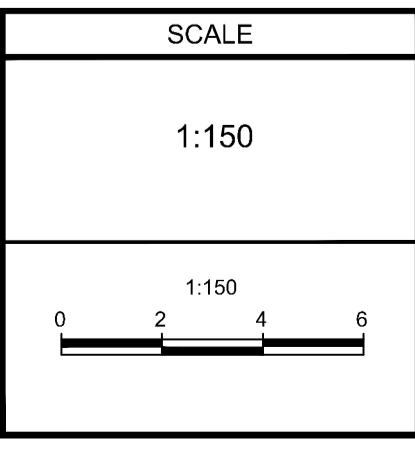

DESIGN	JMK
CHECKED	RGJ
DRAWN	JMK
CHECKED	RGJ
APPROVED	RGJ

FOR REVIEW ONLY

NOVATECH
Engineers, Planners & Landscape Architects
Suite 200, 240 Michael Cowpland Drive
Ottawa, Ontario, Canada K2M 1P6
Telephone (613) 254-9643
Facsimile (613) 254-5867
Website www.novatech-eng.com

LOCATION CITY OF OTTAWA 393 MCARTHUR AVE	PROJECT No. 121085
DRAWING NAME LANDSCAPE PLAN	REV # 5
	DRAWING No. 121085-L1

M:\2021\121085\CADD\Landscapes\121085_L1.dwg, L1 (Landscape), Nov 07 2023 - 4:35pm, Karaliov