

NOTE:
A GEOTECHNICAL ENGINEER LICENSED IN THE PROVINCE OF ONTARIO IS TO INSPECT ALL SUBGRADE SURFACES FOR FOOTING AND PAVEMENT STRUCTURES PRIOR TO CONSTRUCTION

NOTE:
ALL EXISTING POST & WIRE FENCE, CULVERTS, UTILITY WIRE / POLES, TREES, SHRUBS ETC. WITHIN LOTS, BLOCKS AND ROADS TO BE REMOVED, UNLESS OTHERWISE NOTED

NOTE RE: PERFORATED PIPE
PERFORATED PIPE IS REQUIRED FOR SWALE SLOPE LESS THAN 1.5%. REFER TO CITY STD. S29, S30 FOR REAR YARD TRENCH AND PIPE DETAIL ONLY

NOTE:
ALL SWALES SHALL BE 0.15m DEEP WITH 3:1 SIDE SLOPES UNLESS OTHERWISE INDICATED

ANY DISTURBED AREA DURING CONSTRUCTION TO BE RESTORED TO THE ORIGINAL CONDITION OR BETTER TO THE SATISFACTION OF THE AUTHORITIES HAVING JURISDICTION

CONTRACTOR TO VERIFY THE PRECISE LOCATIONS AND INVERT ELEVATIONS OF EX. UNDERGROUND SERVICES AND EX. UTILITIES PRIOR TO STARTING CONSTRUCTION

PERMISSION REQUIRED FOR WORK ON ADJACENT LANDS

RETAINING WALL
MAX HEIGHT=1.90m
(DESIGN TO BE PROVIDED BY STRUCTURAL ENGINEER)

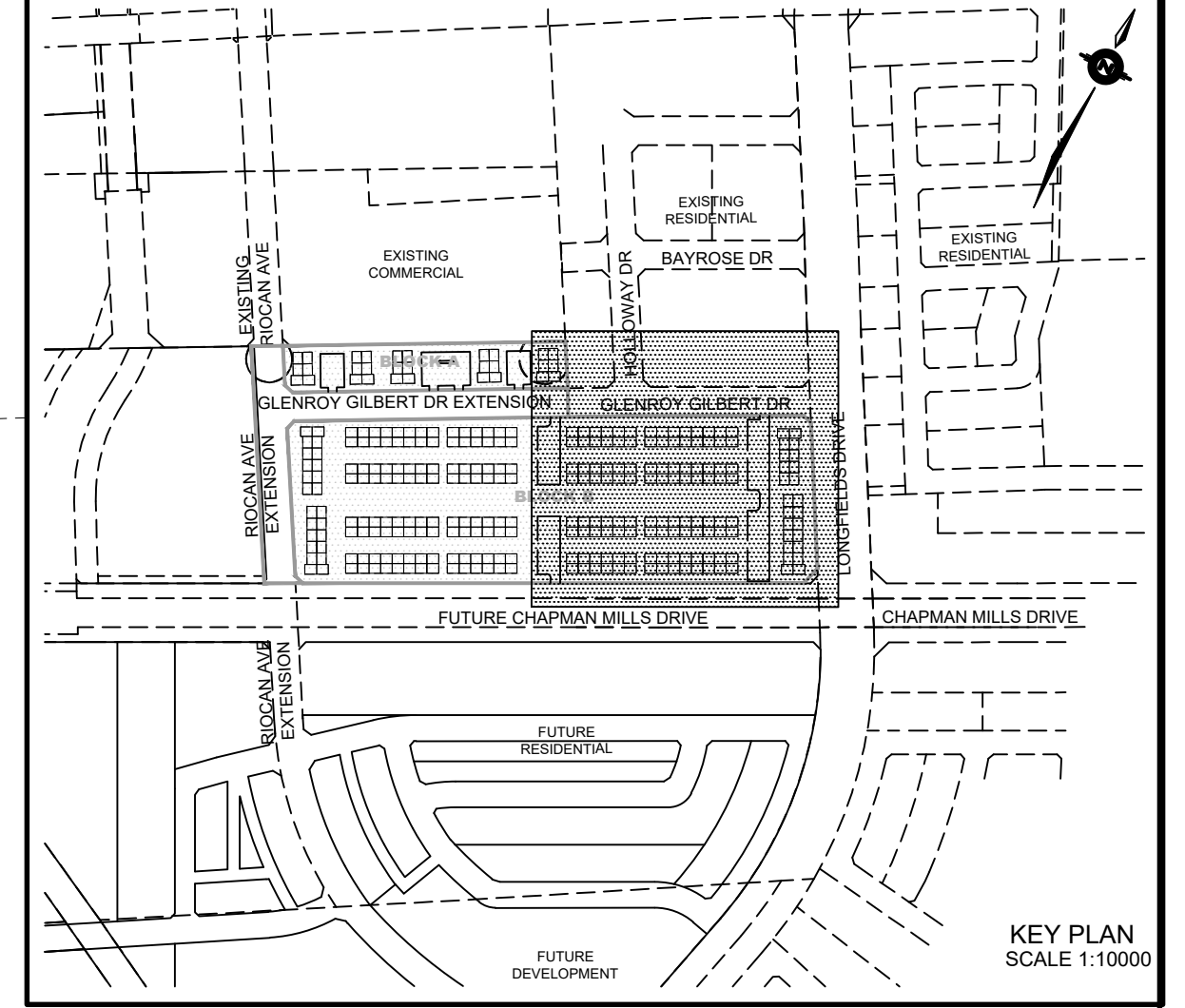
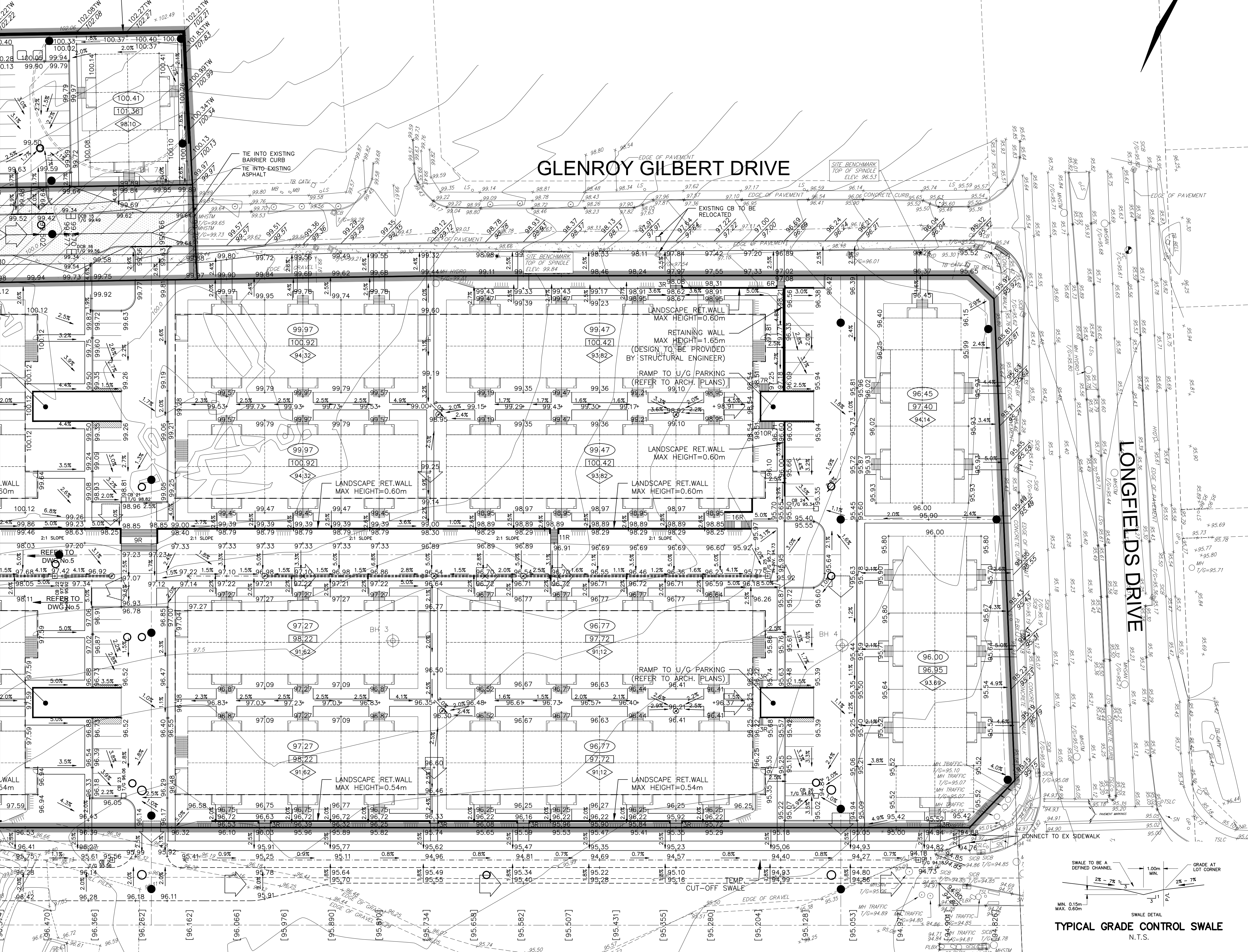

LEGEND

PROPOSED ELEVATION	103.45	OVERLAND FLOW DIRECTION	→
EXISTING ELEVATION	102.73	EXTERNAL OVERLAND FLOW DIRECTION	→
FUTURE ELEVATION	[93.00]	EMERGENCY OVERLAND FLOW DIRECTION	→
PROPOSED SWALE GRADE	1.5%	RETAINING WALL AND ELEVATIONS	1/7m=103.10 8/7m=102.44
HIGH POINT	102.16	CHAIN LINK FENCE (1.5m UNLESS OTHERWISE NOTED)	— —
STREET CATCHBASIN	○	VALVE & VC	⊕
STREET CATCHBASIN WITH CLOSED LID	○	VALVE & VB	⊕
CATCHBASIN MANHOLE	○	NOISE BARRIER (3.0m UNLESS OTHERWISE NOTED)	— —
TEE CATCHBASIN	○	DECORATIVE FENCE (SEE LANDSCAPE DWGS FOR DETAIL)	— —
ELBOW CATCHBASIN	○	CONSTRUCTION FENCE	— —
ELBOW CATCHBASIN	○	FINISHED FLOOR ELEVATION (FFE)	— —
HYDRANT, VALVE & VB	⊕	UNDERSIDE OF FOOTING ELEVATION (USF)	— —
VALVE & VC	⊕	UNITS REQUIRING WATER PRESSURE REDUCING VALVES	— —
VALVE & VB	⊕	WALKOUT UNITS	— —
BUILDING ENVELOPE	— —	SLAB ON GRADE	— —
TOP OF FOUNDATION (TOF)	— —	250µ PVC PERFORATED PIPE (REFER TO CITY STD S29 FOR REAR YARD TRENCH AND PIPE DETAILS ONLY)	— —
PROPERTY BOUNDARY	— —	3:1 TERRACING MAXIMUM SLOPE	— —
PRV	— —	HYDRO SWITCHGEAR	— —
FOUNDING AREA WITH SPILLWAY ELEVATION (MAXIMUM 0.30m)	— —	HYDRO TRANSFORMER	— —
W.O.	— —	STREET LIGHT STANDARD	— —
SOG	— —	TACTILE WALKING SURFACE INDICATOR (AS PER CITY OF OTTAWA STD. SC6)	— —
250µ PVC PERFORATED PIPE (REFER TO CITY STD S29 FOR REAR YARD TRENCH AND PIPE DETAILS ONLY)	— —	PREVIOUS PHASES / PHASES NOT PART OF CURRENT GRADING APPROVAL	— —
3:1 TERRACING MAXIMUM SLOPE	— —		

NOT FOR CONSTRUCTION

1	S.L.M.	22-06-10	1ST SUBMISSION
No.	BY	DATE	DESCRIPTION

TOPOGRAPHIC INFORMATION
TOPOGRAPHIC INFORMATION PROVIDED BY STANTEC GEOMATICS LTD., PROJECT No. 161614291-111, DATED MARCH 1, 2022

SITE PLAN INFORMATION
SITE PLAN PROVIDED BY SRN ARCHITECTS LTD., PROJECT No. S21001, DATED FEBRUARY 3, 2022

LEGAL INFORMATION
CALCULATED PLAN PROVIDED BY STANTEC GEOMATICS LTD., PROJECT No. 161614291-111, DATED MARCH 1, 2022

BENCH MARK
ELEVATIONS ARE REFERRED TO THE CANADIAN GEODETIC VERTICAL DATUM (CGVD-1928:1978) AND ARE DERIVED FROM BENCHMARK MONUMENT No. 196530071*, HAVING A PUBLISHED ELEVATION OF 99.742 METRES

MINTO COMMUNITIES INC. **BARRHAVEN TOWN CENTRE STAGE 1**

DSEL
120 Ier Road Unit 103
Slittsville, Ontario, K2S 1E9
Tel. (613) 836-0856
Fax. (613) 836-7183
www.DSEL.ca

S.L. MERRICK
100166523
2022-06-10
PROVINCE OF ONTARIO

Ottawa
110 Laurier Ave W
Ottawa, Ontario, K1P 1J1
Tel. (613) 580-2400
www.Ottawa.ca

GRADING PLAN

DRAWN BY: AM CHECKED BY: BC PROJECT No. 15-816
DESIGNED BY: BC CHECKED BY: SM

SCALE: 1:400 HORIZ. 1:500 SHEET No. 6

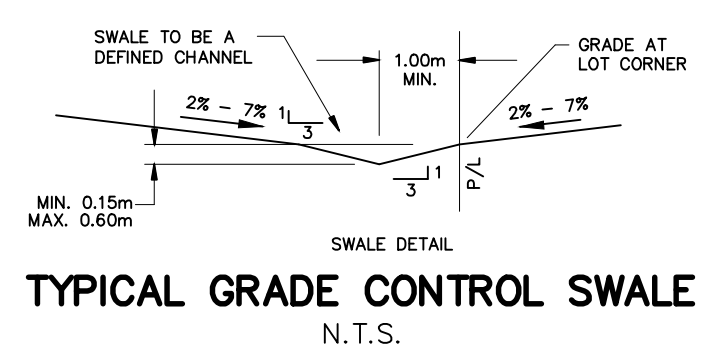

CITY PLAN No. XXXXX
CITY FILE No. D07-XX-XX-XXXX