

**NOTE:**  
A GEOTECHNICAL ENGINEER LICENSED IN THE PROVINCE OF ONTARIO IS TO INSPECT ALL SUBGRADE SURFACES FOR FOOTING AND PAVEMENT STRUCTURES PRIOR TO CONSTRUCTION

**NOTE:**  
ALL EXISTING POST & WIRE FENCE, CULVERTS, UTILITY WIRE / POLES, TREES, SHRUBS ETC. WITHIN LOTS, BLOCKS AND ROADS TO BE REMOVED, UNLESS OTHERWISE NOTED

**NOTE RE: PERFORATED PIPE**  
PERFORATED PIPE IS REQUIRED FOR SWALE SLOPE LESS THAN 1.5% REFER TO CITY STD. S29, S30 FOR REAR YARD TRENCH AND PIPE DETAIL ONLY

**NOTE:**  
ALL SWALES SHALL BE 0.15m DEEP WITH 3:1 SIDE SLOPES UNLESS OTHERWISE INDICATED

**NOTE:**  
ENTRANCES TO PRIVATE SITE PER SC7.1

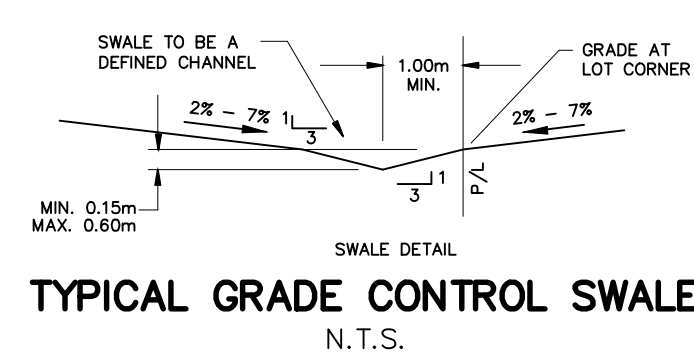

ANY DISTURBED AREA DURING CONSTRUCTION TO BE RESTORED TO THE ORIGINAL CONDITION OR BETTER TO THE SATISFACTION OF THE AUTHORITIES HAVING JURISDICTION

CONTRACTOR TO VERIFY THE PRECISE LOCATIONS AND INVERT ELEVATIONS OF EX. UNDERGROUND SERVICES AND EX. UTILITIES PRIOR TO STARTING CONSTRUCTION

PERMISSION REQUIRED FOR WORK ON ADJACENT LANDS

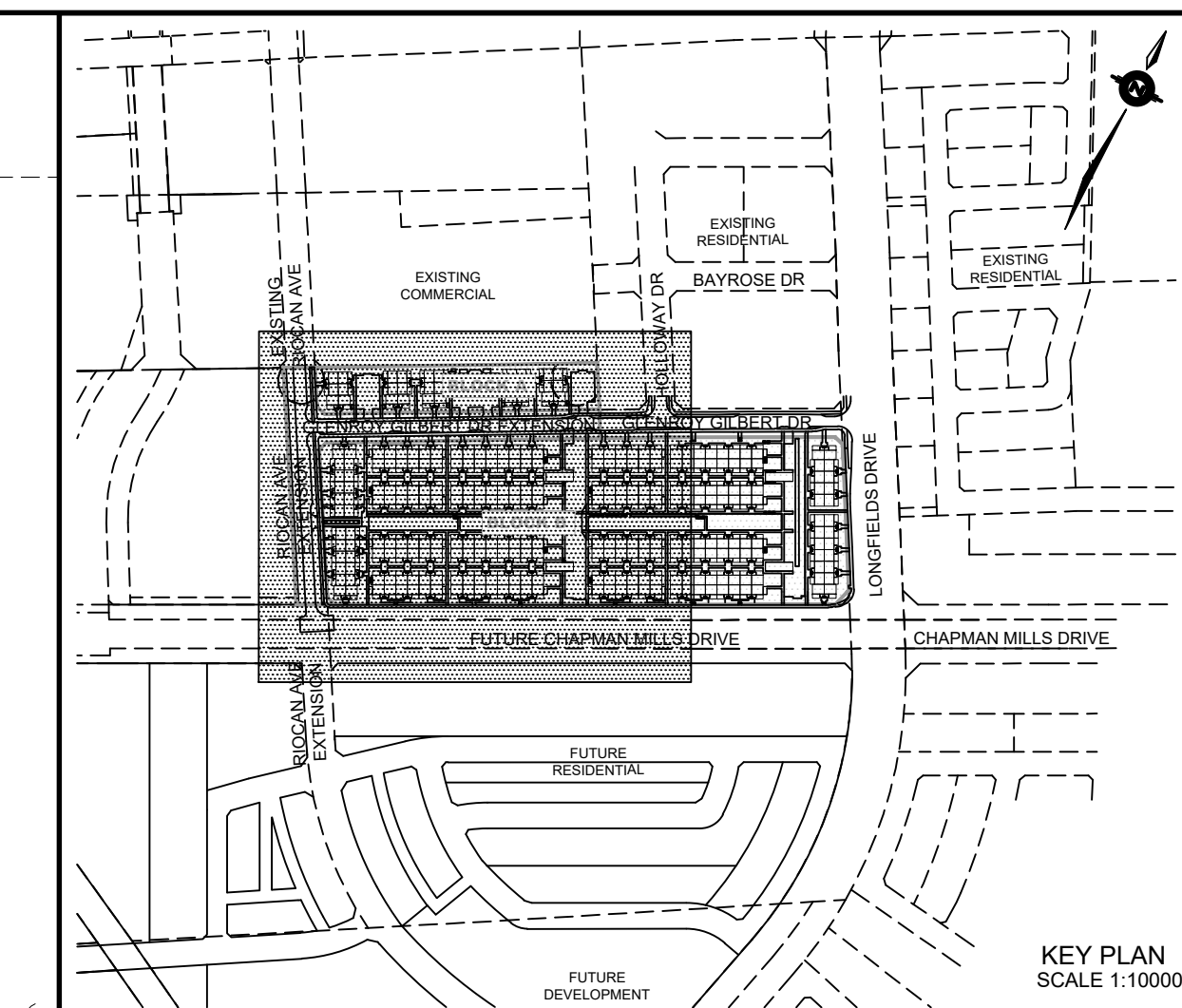

**LEGEND**

PROPOSED ELEVATION	103.45	OVERLAND FLOW DIRECTION	→
EXISTING ELEVATION	102.73	EXTERNAL OVERLAND FLOW DIRECTION	→
FUTURE ELEVATION	[93.900]	EMERGENCY OVERLAND FLOW DIRECTION	→
PROPOSED SWALE GRADE	1.5%	RETAINING WALL AND ELEVATIONS	1/7m-103.10
HIGH POINT	102.16	CHAINLINK FENCE (1.5m UNLESS OTHERWISE NOTED)	— —
STREET CATCHBASIN		VALVE & VB	— —
STREET CATCHBASIN WITH CLOSED LID		VALVE & VC	— —
CATCHBASIN MANHOLE		BUILDING ENVELOPE	— —
TEE CATCHBASIN		TOP OF FOUNDATION (TOF)	— —
ELBOW CATCHBASIN		FINISHED FLOOR ELEVATION (FFE)	— —
HYDRANT, VALVE & VB		UNDERSIDE OF FOOTING ELEVATION (USF)	— —
VALVE & VC		UNITS REQUIRING WATER PRESSURE REDUCING VALVES	— —
NOISE BARRIER (3.0m UNLESS OTHERWISE NOTED)		WALKOUT UNITS	— —
DECORATIVE FENCE (SEE LANDSCAPE DWGS FOR DETAIL)		SLAB ON GRADE	— —
CONSTRUCTION FENCE		LANDS MAX	— —
PROPERTY BOUNDARY		HYDRO SWITCHGEAR	— —
3:1 TERRACING MAXIMUM SLOPE		STREET LIGHT STANDARD	— —
PRV		TACTILE WALKING SURFACE INDICATOR (AS PER CITY OF OTTAWA STD. SC6)	— —
W.O.		PREVIOUS PHASES / PHASES NOT PART OF CURRENT GRADING APPROVAL	— —
SOG			
250# PVC PERFORATED PIPE (REFER TO CITY STD S29 FOR REAR YARD TRENCH AND PIPE DETAILS ONLY)			
(SUBIRAN APPLIED FOR SLOPE LESS THAN 1.5%)			

**NOT FOR CONSTRUCTION**

No.	BY	DATE	DESCRIPTION
3	S.L.M.	23-06-30	3RD SUBMISSION
2	S.L.M.	23-03-10	2ND SUBMISSION
1	S.L.M.	22-06-10	1ST SUBMISSION

**TOPOGRAPHIC INFORMATION**  
TOPOGRAPHIC INFORMATION PROVIDED BY STANTEC GEOMATICS LTD., PROJECT No. 161614291-111, DATED MARCH 1, 2022

**SITE PLAN INFORMATION**  
SITE PLAN PROVIDED BY SRN ARCHITECTS LTD., PROJECT No. S21001, DATED JUNE 27, 2023

**LEGAL INFORMATION**  
CALCULATED DRAFT PLAN PROVIDED BY STANTEC GEOMATICS LTD., PROJECT No. 161614291-111, DATED MAY 9, 2022

**BENCH MARK**  
ELEVATIONS ARE REFERRED TO THE CANADIAN GEODETIC VERTICAL DATUM (CGVD-1928:1978) AND ARE DERIVED FROM BENCHMARK MONUMENT No. 196530071-1, HAVING A PUBLISHED ELEVATION OF 99.742 METRES

MINTO COMMUNITIES INC.  
BARRHAVEN TOWN CENTRE  
GLENROY GILBERT DRIVE RIOCAN AVENUE & CHAPMAN MILLS DRIVE EXTENSION

Ottawa  
110 Laurier Ave W  
Ottawa, Ontario, K1P 1J1  
Tel. (613) 580-2400  
www.Ottawa.ca

**CITY ROW GRADING PLAN WEST**

DRAWN BY: AM	CHECKED BY: BC	PROJECT No. 15-816
DESIGNED BY: BC	CHECKED BY: SM	SHEET No. 10
SCALE: 1:500		

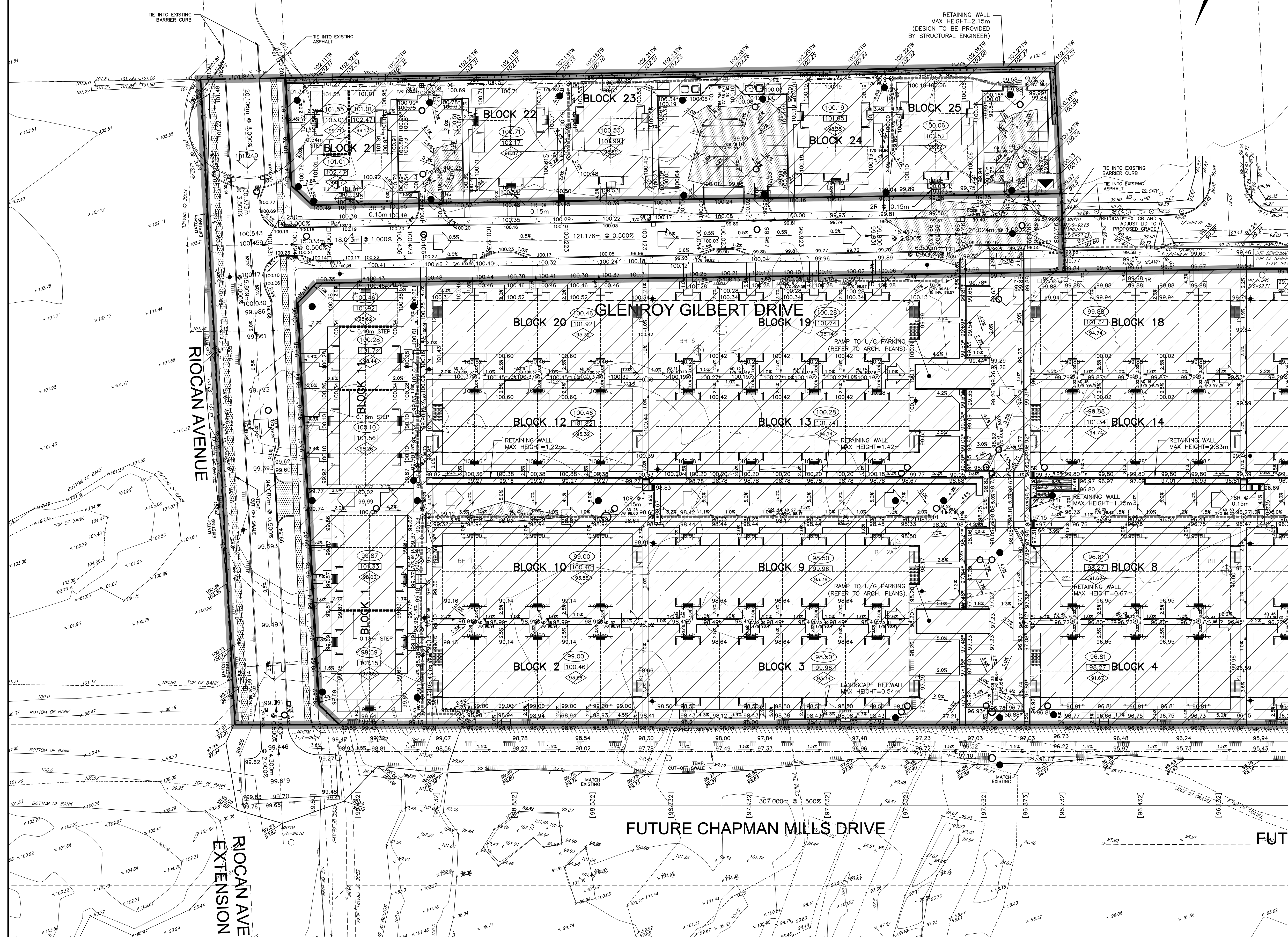

CITY PLAN No. 18822  
CITY FILE No. D07-12-22-0104