

- Legend**
- Concrete Sidewalk
  - Tactile Walking Surface Indicator (TWSI) as per SC 7.3
  - Depressed Curb
  - Catch Basin
  - Storm Maintenance Hole
  - Sanitary Maintenance Hole

NOTE 01: 5m RADIUS ON ALL DOUBLE INTERSECTION NARROWING PER "R7" UNLESS OTHERWISE SPECIFIED

NOTE 02: 5m RADIUS ON ALL SINGLE INTERSECTIONS NARROWING PER "R8" UNLESS OTHERWISE SPECIFIED

NOTE 03: THE FUTURE SIDEWALK AND CYCLE TRACKS ON THE WEST SIDE OF RIOCAN AVENUE ARE SHOWN TO DEMONSTRATE THE ULTIMATE BUILD-OUT OF THE CROSS-SECTION. THIS INFRASTRUCTURE IS NOT PLANNED AS PART OF CONSTRUCTION.

03	Issued for Review	AN	2023-10-16
REV:	DESCRIPTION:	BY:	DATE:
STATUS:			

**CGH Transportation**  
 6 Plaza Court  
 Ottawa, ON  
 K2H 7W1  
 (343) 999-9117

CLIENT: Minto Communities

ARCHITECT:

SITE: **Minto Town Centre**

TITLE: **Geometric Road Design Drawings**



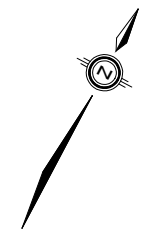
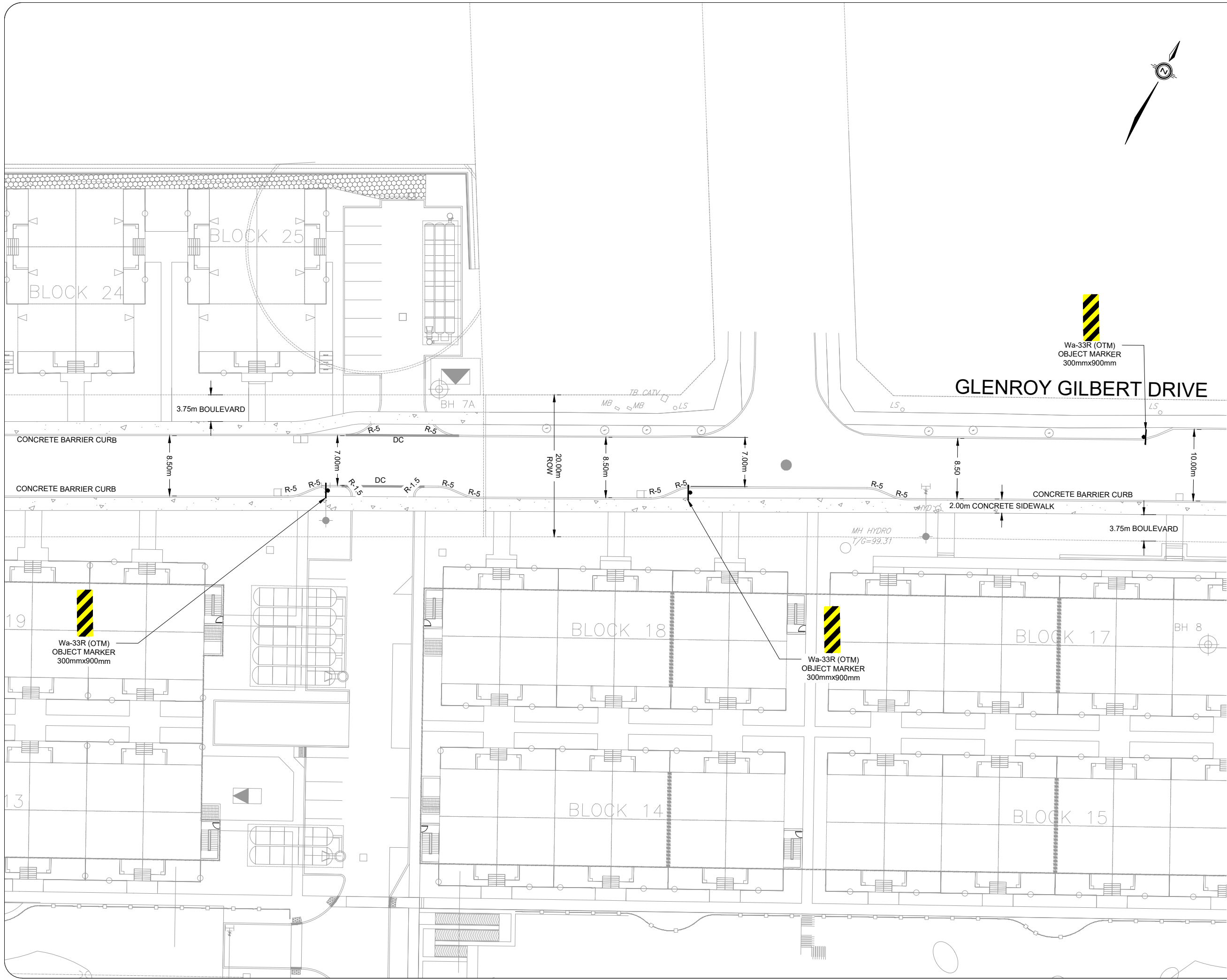

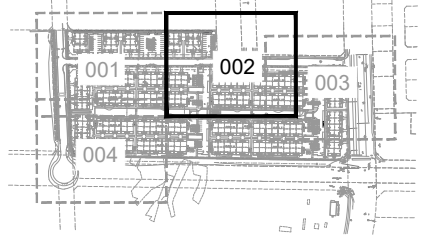

SCALE AT A3:	DATE:	DRAWN:	CHECKED:
NTS	2023-10-16	AN	AL
PROJECT NO:	DRAWING NO:	REVISION:	
2020-85	001	03	



KEY PLAN



Legend

-  Concrete Sidewalk
-  Tactile Walking Surface Indicator (TWSI) as per SC 7.3
-  Depressed Curb
-  Catch Basin
-  Storm Maintenance Hole
-  Sanitary Maintenance Hole

NOTE 01: 5m RADIUS ON ALL DOUBLE INTERSECTION NARROWING PER "R7" UNLESS OTHERWISE SPECIFIED

NOTE 02: 5m RADIUS ON ALL SINGLE INTERSECTIONS NARROWING PER "R8" UNLESS OTHERWISE SPECIFIED

NOTE 03: THE FUTURE SIDEWALK AND CYCLE TRACKS ON THE WEST SIDE OF RIOCAN AVENUE ARE SHOWN TO DEMONSTRATE THE ULTIMATE BUILD-OUT OF THE CROSS-SECTION. THIS INFRASTRUCTURE IS NOT PLANNED AS PART OF CONSTRUCTION.

03	Issued for Review	AN	2023-10-16
REV:	DESCRIPTION:	BY:	DATE:
STATUS:			



**CGH Transportation**  
 6 Plaza Court  
 Ottawa, ON  
 K2H 7W1  
 (343) 999-9117

CLIENT:	Minto Communities
ARCHITECT:	



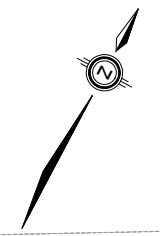
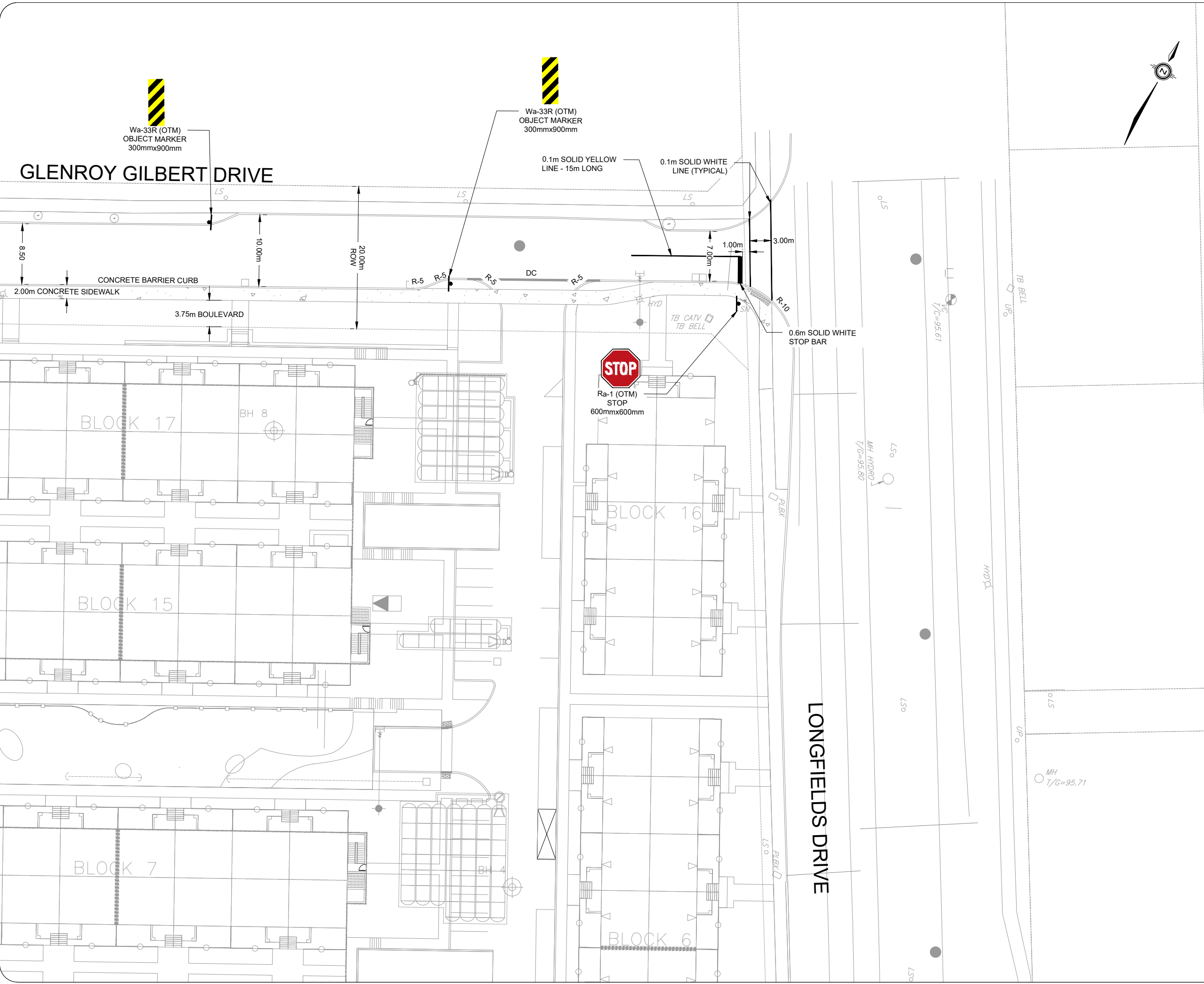

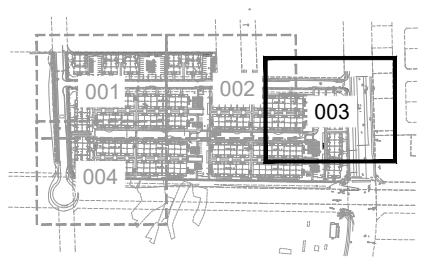

SITE:	Minto Town Centre		
TITLE:	Geometric Road Design Drawings		
SCALE AT A3:	DATE:	DRAWN:	CHECKED:
NTS	2023-10-16	AN	AL
PROJECT NO:	DRAWING NO:	REVISION:	
2020-85	002	03	



**KEY PLAN**



**Legend**

-  Concrete Sidewalk
-  Tactile Walking Surface Indicator (TWSI) as per SC 7.3
-  Depressed Curb
-  Catch Basin
-  Storm Maintenance Hole
-  Sanitary Maintenance Hole

**NOTE 01:** 5m RADIUS ON ALL DOUBLE INTERSECTION NARROWING PER "R7" UNLESS OTHERWISE SPECIFIED

**NOTE 02:** 5m RADIUS ON ALL SINGLE INTERSECTIONS NARROWING PER "R8" UNLESS OTHERWISE SPECIFIED

**NOTE 03:** THE FUTURE SIDEWALK AND CYCLE TRACKS ON THE WEST SIDE OF RIOCAN AVENUE ARE SHOWN TO DEMONSTRATE THE ULTIMATE BUILD-OUT OF THE CROSS-SECTION. THIS INFRASTRUCTURE IS NOT PLANNED AS PART OF CONSTRUCTION.

03	Issued for Review	AN	2023-10-16
REV:	DESCRIPTION:	BY:	DATE:
STATUS:			

**CGH Transportation**  
 6 Plaza Court  
 Ottawa, ON  
 K2H 7W1  
 (343) 999-9117

CLIENT: **Minto Communities**

ARCHITECT:

SITE: **Minto Town Centre**

TITLE: **Geometric Road Design Drawings**



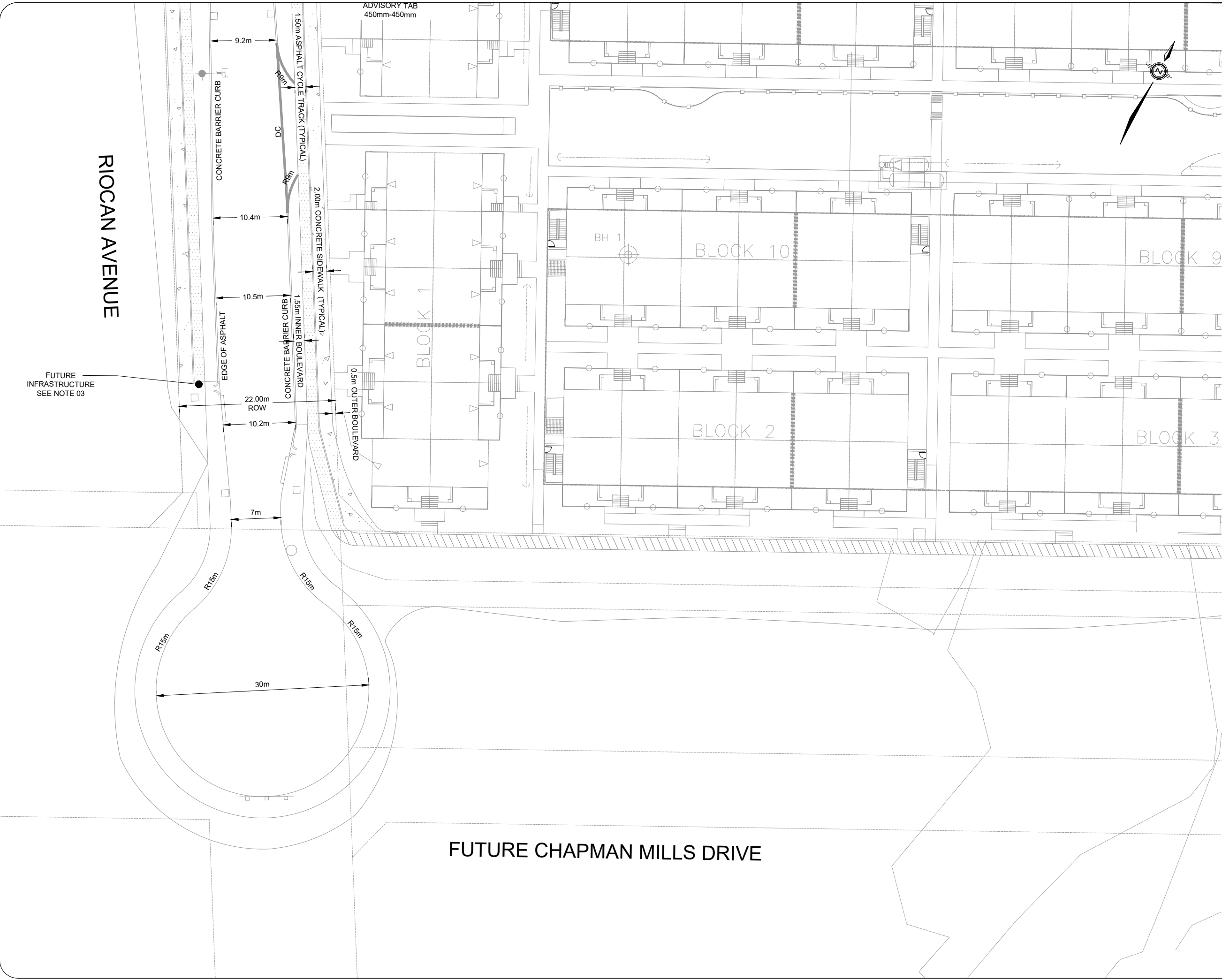

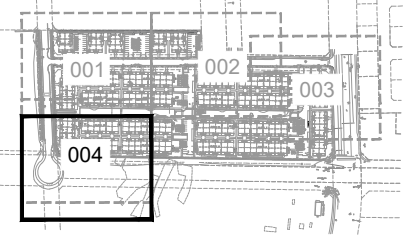

SCALE AT A3:	DATE:	DRAWN:	CHECKED:
NTS	2023-10-16	AN	AL
PROJECT NO:	DRAWING NO:	REVISION:	
2020-85	003	03	



KEY PLAN



Legend

-  Concrete Sidewalk
-  Tactile Walking Surface Indicator (TWSI) as per SC 7.3
-  Depressed Curb
-  Catch Basin
-  Storm Maintenance Hole
-  Sanitary Maintenance Hole

NOTE 01: 5m RADIUS ON ALL DOUBLE INTERSECTION NARROWING PER "R7" UNLESS OTHERWISE SPECIFIED

NOTE 02: 5m RADIUS ON ALL SINGLE INTERSECTIONS NARROWING PER "R8" UNLESS OTHERWISE SPECIFIED

NOTE 03: THE FUTURE SIDEWALK AND CYCLE TRACKS ON THE WEST SIDE OF RIOCAN AVENUE ARE SHOWN TO DEMONSTRATE THE ULTIMATE BUILD-OUT OF THE CROSS-SECTION. THIS INFRASTRUCTURE IS NOT PLANNED AS PART OF CONSTRUCTION.

03	Issued for Review	AN	2023-10-16
REV:	DESCRIPTION:	BY:	DATE:
STATUS:			



CGH Transportation  
6 Plaza Court  
Ottawa, ON  
K2H 7W1  
(343) 999-9117

CLIENT: Minto Communities

ARCHITECT:

SITE: Minto Town Centre

TITLE: Geometric Road Design Drawings

SCALE AT A3: NTS	DATE: 2023-10-16	DRAWN: AN	CHECKED: AL
PROJECT NO: 2020-85	DRAWING NO: 004	REVISION: 03	