

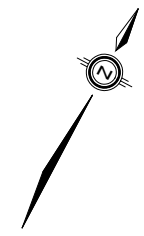

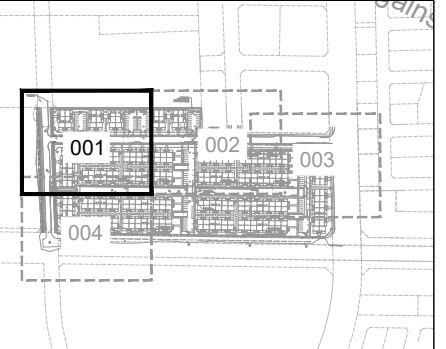



TIE INTO EXISTING BARRIER CURB



KEY PLAN



Legend

-  Concrete Sidewalk
-  Tactile Walking Surface Indicator (TWSI) as per SC 7.3
-  Depressed Curb
-  Catch Basin
-  Storm Maintenance Hole
-  Sanitary Maintenance Hole

NOTE 01: 5m RADIUS ON ALL DOUBLE INTERSECTION NARROWING PER "R7" UNLESS OTHERWISE SPECIFIED

NOTE 02: 5m RADIUS ON ALL SINGLE INTERSECTIONS NARROWING PER "R8" UNLESS OTHERWISE SPECIFIED

NOTE 03: THE FUTURE SIDEWALK AND CYCLE TRACKS ON THE WEST SIDE OF RIOCAN AVENUE ARE SHOWN TO DEMONSTRATE THE ULTIMATE BUILD-OUT OF THE CROSS-SECTION. THIS INFRASTRUCTURE IS NOT PLANNED AS PART OF CONSTRUCTION.

02	Issued for Review	AN	2023-06-29
01	Issued for Review	BB	2023-04-24
REV:	DESCRIPTION:	BY:	DATE:
STATUS:			



CGH Transportation
 6 Plaza Court
 Ottawa, ON
 K2H 7W1
 (343) 999-9117

CLIENT: Minto Communities

ARCHITECT:

SITE: Minto Town Centre





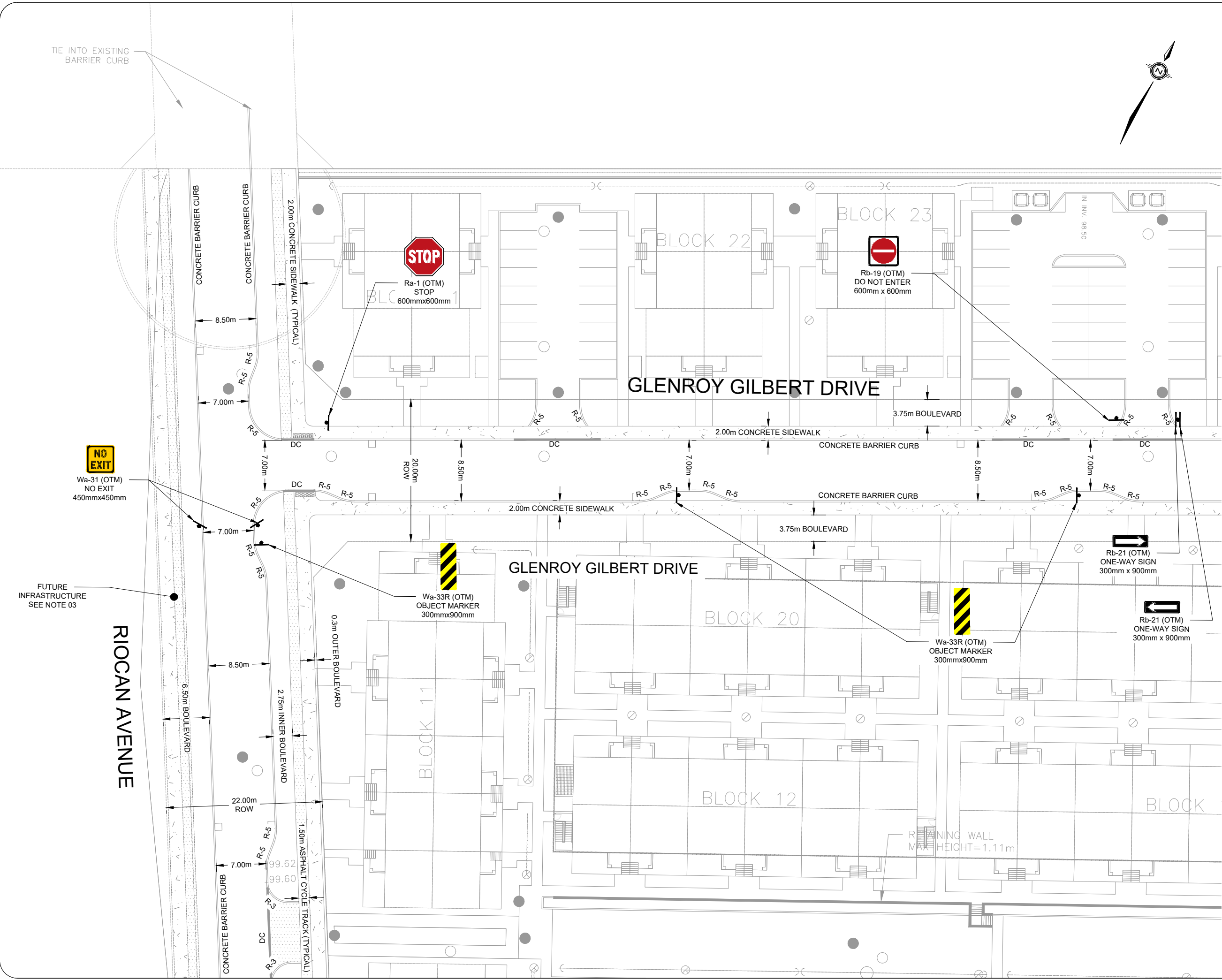

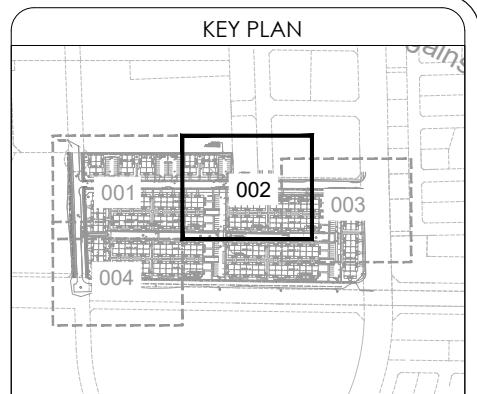
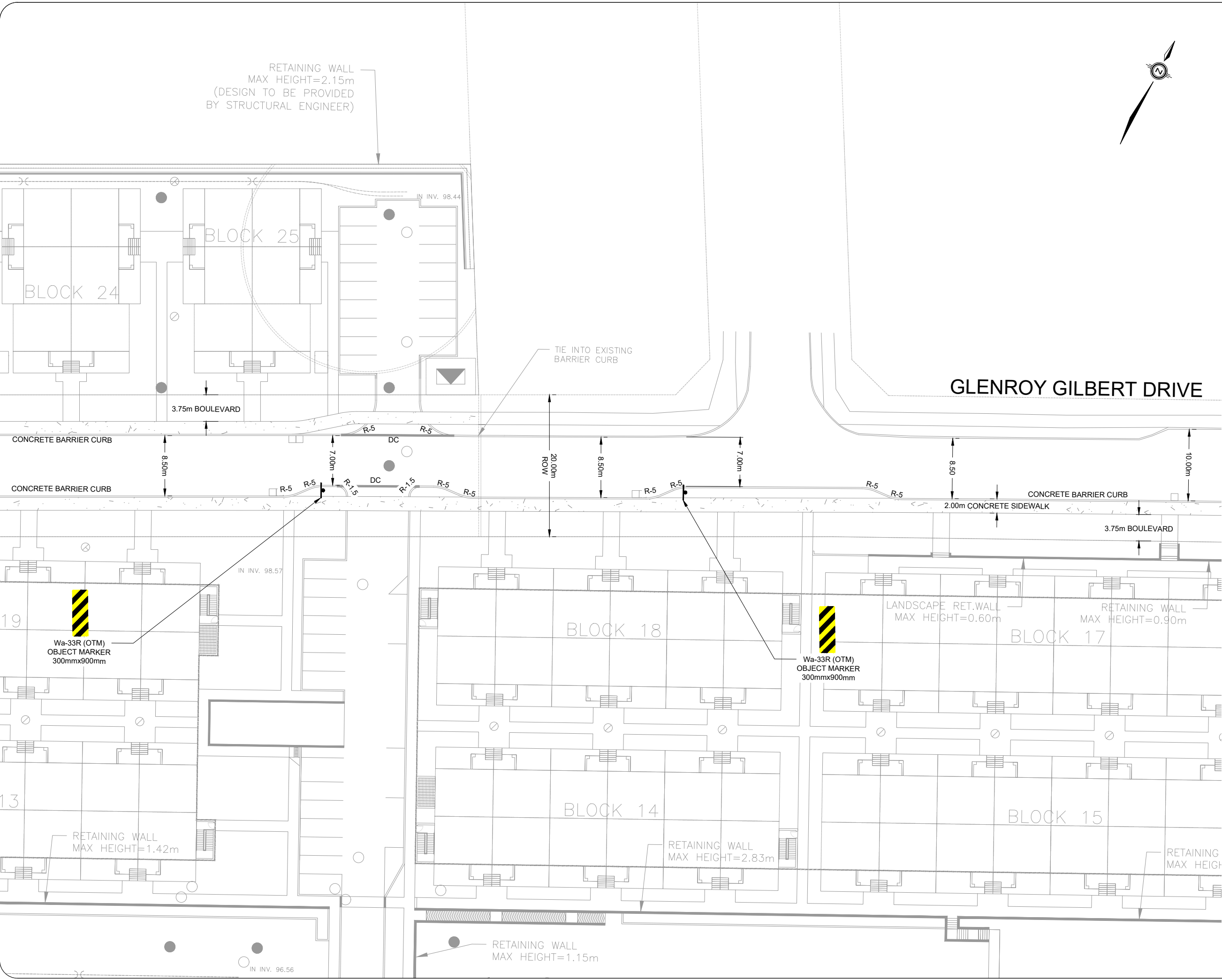
TITLE: Geometric Road Design Drawings

SCALE AT A3: NTS	DATE: 2023-06-29	DRAWN: AN	CHECKED: AL
PROJECT NO: 2020-85	DRAWING NO: 001	REVISION: 02	





Legend

-  Concrete Sidewalk
-  Tactile Walking Surface Indicator (TWSI) as per SC 7.3
-  Depressed Curb
-  Catch Basin
-  Storm Maintenance Hole
-  Sanitary Maintenance Hole

NOTE 01: 5m RADIUS ON ALL DOUBLE INTERSECTION NARROWING PER "R7" UNLESS OTHERWISE SPECIFIED

NOTE 02: 5m RADIUS ON ALL SINGLE INTERSECTIONS NARROWING PER "R8" UNLESS OTHERWISE SPECIFIED

NOTE 03: THE FUTURE SIDEWALK AND CYCLE TRACKS ON THE WEST SIDE OF RIOCAN AVENUE ARE SHOWN TO DEMONSTRATE THE ULTIMATE BUILD-OUT OF THE CROSS-SECTION. THIS INFRASTRUCTURE IS NOT PLANNED AS PART OF CONSTRUCTION.

02	Issued for Review	AN	2023-06-29
01	Issued for Review	BB	2023-04-24
REV:	DESCRIPTION:	BY:	DATE:
STATUS:			



CGH Transportation
 6 Plaza Court
 Ottawa, ON
 K2H 7W1
 (343) 999-9117

CLIENT: Minto Communities

ARCHITECT:

SITE: **Minto Town Centre**

TITLE: **Geometric Road Design Drawings**

SCALE AT A3: NTS	DATE: 2023-06-29	DRAWN: AN	CHECKED: AL
PROJECT NO: 2020-85	DRAWING NO: 002	REVISION: 02	

GLENROY GILBERT DRIVE

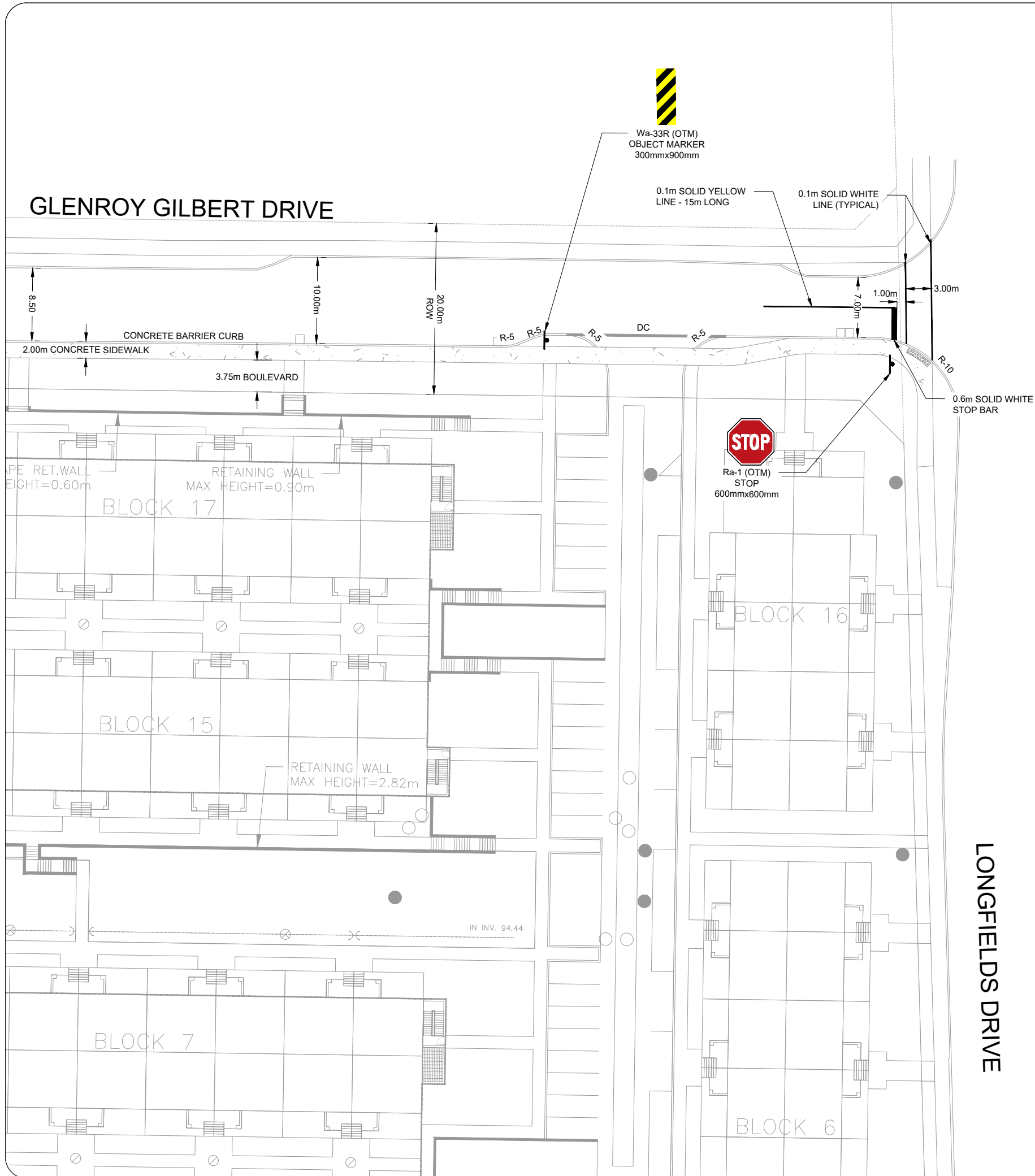

LONGFIELDS DRIVE

KEY PLAN

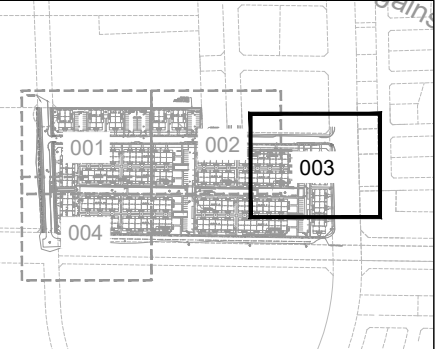

Legend

- Concrete Sidewalk
- Tactile Walking Surface Indicator (TWSI) as per SC 7.3
- Depressed Curb
- Catch Basin
- Storm Maintenance Hole
- Sanitary Maintenance Hole

NOTE 01: 5m RADIUS ON ALL DOUBLE INTERSECTION NARROWING PER "R7" UNLESS OTHERWISE SPECIFIED

NOTE 02: 5m RADIUS ON ALL SINGLE INTERSECTIONS NARROWING PER "R8" UNLESS OTHERWISE SPECIFIED

NOTE 03: THE FUTURE SIDEWALK AND CYCLE TRACKS ON THE WEST SIDE OF RIOCAN AVENUE ARE SHOWN TO DEMONSTRATE THE ULTIMATE BUILD-OUT OF THE CROSS-SECTION. THIS INFRASTRUCTURE IS NOT PLANNED AS PART OF CONSTRUCTION.

02	Issued for Review	AN	2023-06-29
01	Issued for Review	BB	2023-04-24
REV:	DESCRIPTION:	BY:	DATE:
STATUS:			

CGH Transportation
6 Plaza Court
Ottawa, ON
K2H 7W1
(343) 999-9117

CLIENT: Minto Communities

ARCHITECT:

SITE: Minto Town Centre

TITLE: Geometric Road Design Drawings

SCALE AT A3: NTS	DATE: 2023-06-29	DRAWN: AN	CHECKED: AL
PROJECT NO: 2020-85	DRAWING NO: 003	REVISION: 02	

RIOCAN AVENUE



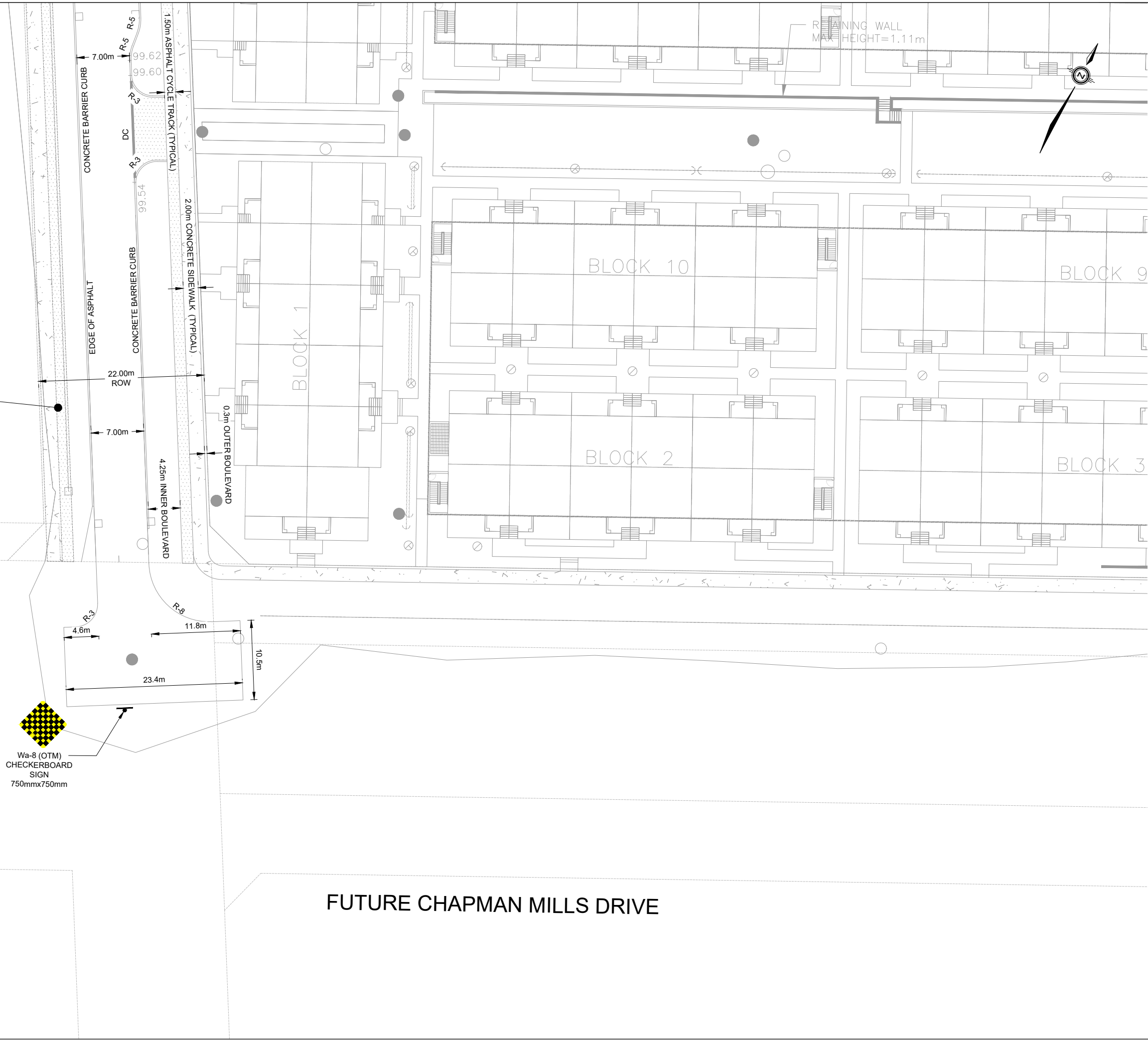

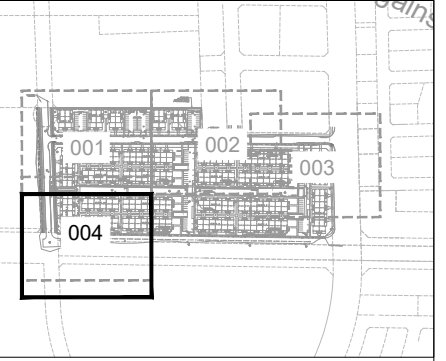

FUTURE INFRASTRUCTURE SEE NOTE 03



KEY PLAN



Legend

-  Concrete Sidewalk
-  Tactile Walking Surface Indicator (TWSI) as per SC 7.3
-  Depressed Curb
-  Catch Basin
-  Storm Maintenance Hole
-  Sanitary Maintenance Hole

NOTE 01: 5m RADIUS ON ALL DOUBLE INTERSECTION NARROWING PER "R7" UNLESS OTHERWISE SPECIFIED

NOTE 02: 5m RADIUS ON ALL SINGLE INTERSECTIONS NARROWING PER "R8" UNLESS OTHERWISE SPECIFIED

NOTE 03: THE FUTURE SIDEWALK AND CYCLE TRACKS ON THE WEST SIDE OF RIOCAN AVENUE ARE SHOWN TO DEMONSTRATE THE ULTIMATE BUILD-OUT OF THE CROSS-SECTION. THIS INFRASTRUCTURE IS NOT PLANNED AS PART OF CONSTRUCTION.

02	Issued for Review	AN	2023-06-29
01	Issued for Review	BB	2023-04-24
REV:	DESCRIPTION:	BY:	DATE:
STATUS:			



CGH Transportation
6 Plaza Court
Ottawa, ON
K2H 7W1
(343) 999-9117

CLIENT:	Minto Communities
ARCHITECT:	

SITE:	Minto Town Centre
TITLE:	Geometric Road Design Drawings

SCALE AT A3:	DATE:	DRAWN:	CHECKED:
NTS	2023-06-29	AN	AL
PROJECT NO:	DRAWING NO:	REVISION:	
2020-85	004	02	

FUTURE CHAPMAN MILLS DRIVE