

KEY PLAN

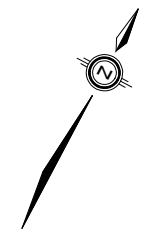
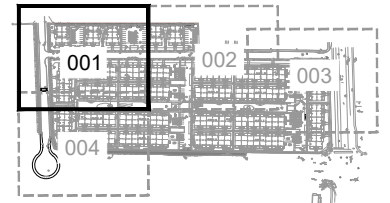

Legend

- Concrete Sidewalk
- Tactile Walking Surface Indicator (TWSI) as per SC 7.3
- Depressed Curb
- Catch Basin
- Storm Maintenance Hole
- Sanitary Maintenance Hole

NOTE 01: 5m RADIUS ON ALL DOUBLE INTERSECTION NARROWING PER "R" UNLESS OTHERWISE SPECIFIED

NOTE 02: 5m RADIUS ON ALL SINGLE INTERSECTIONS NARROWING PER "R8" UNLESS OTHERWISE SPECIFIED

NOTE 03: THE FUTURE SIDEWALK AND CYCLE TRACKS ON THE WEST SIDE OF RIOCAN AVENUE ARE SHOWN TO DEMONSTRATE THE ULTIMATE BUILD-OUT OF THE CROSS-SECTION. THIS INFRASTRUCTURE IS NOT PLANNED AS PART OF CONSTRUCTION.

NOTE 04: PROPOSED CYCLE TRACK RAMP DOWN TRANSITION TO ON ROAD SHARED FACILITY (PER SC39) TO BE USED AS PART OF INTERIM CONDITIONS

04	Updated Site Plan	AN	2024-02-21
REV:	DESCRIPTION:	BY:	DATE:
STATUS:			

CGH Transportation
 6 Plaza Court
 Ottawa, ON
 K2H 7W1
 (343) 999-9117

CLIENT: Minto Communities

ARCHITECT:

SITE: **Minto Town Centre**

TITLE: **Geometric Road Design Drawings**

SCALE AT A3:	DATE:	DRAWN:	CHECKED:
NTS	2024-02-21	AN	AL
PROJECT NO:	DRAWING NO:	REVISION:	
2020-85	001	04	

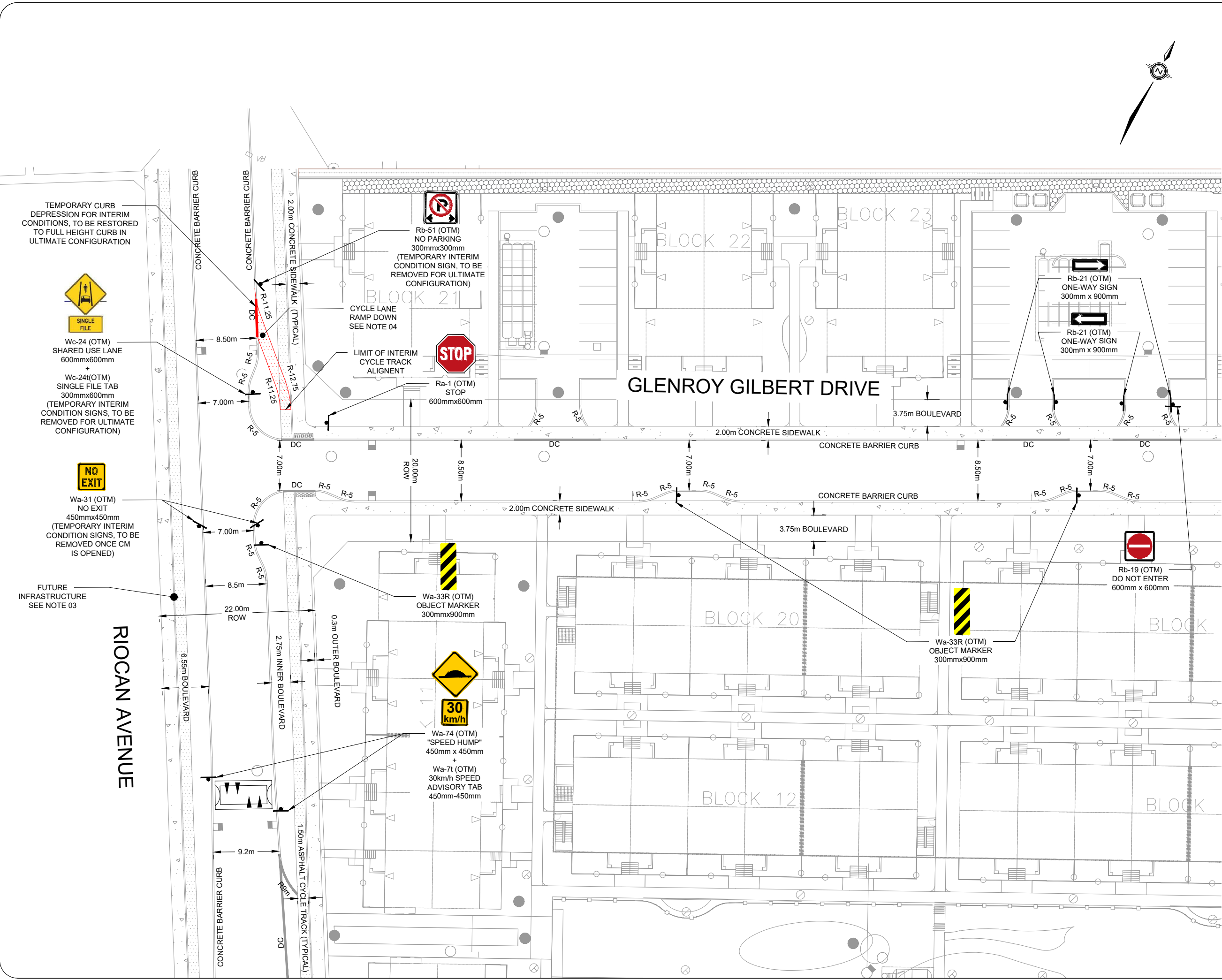

TEMPORARY CURB DEPRESSION FOR INTERIM CONDITIONS, TO BE RESTORED TO FULL HEIGHT CURB IN ULTIMATE CONFIGURATION



Wc-24 (OTM) SHARED USE LANE 600mmx600mm + Wc-24i(OTM) SINGLE FILE TAB 300mmx600mm (TEMPORARY INTERIM CONDITION SIGNS, TO BE REMOVED FOR ULTIMATE CONFIGURATION)



Wa-31 (OTM) NO EXIT 450mmx450mm (TEMPORARY INTERIM CONDITION SIGNS, TO BE REMOVED ONCE CM IS OPENED)

FUTURE INFRASTRUCTURE SEE NOTE 03

RIOCAN AVENUE



Rb-51 (OTM) NO PARKING 300mmx300mm (TEMPORARY INTERIM CONDITION SIGN, TO BE REMOVED FOR ULTIMATE CONFIGURATION)



Ra-1 (OTM) STOP 600mmx600mm



Wa-74 (OTM) "SPEED HUMP" 450mm x 450mm + Wa-7i (OTM) 30km/h SPEED ADVISORY TAB 450mm-450mm



Rb-19 (OTM) DO NOT ENTER 600mm x 600mm



Wa-33R (OTM) OBJECT MARKER 300mmx900mm

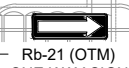

Rb-21 (OTM) ONE-WAY SIGN 300mm x 900mm

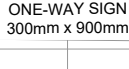



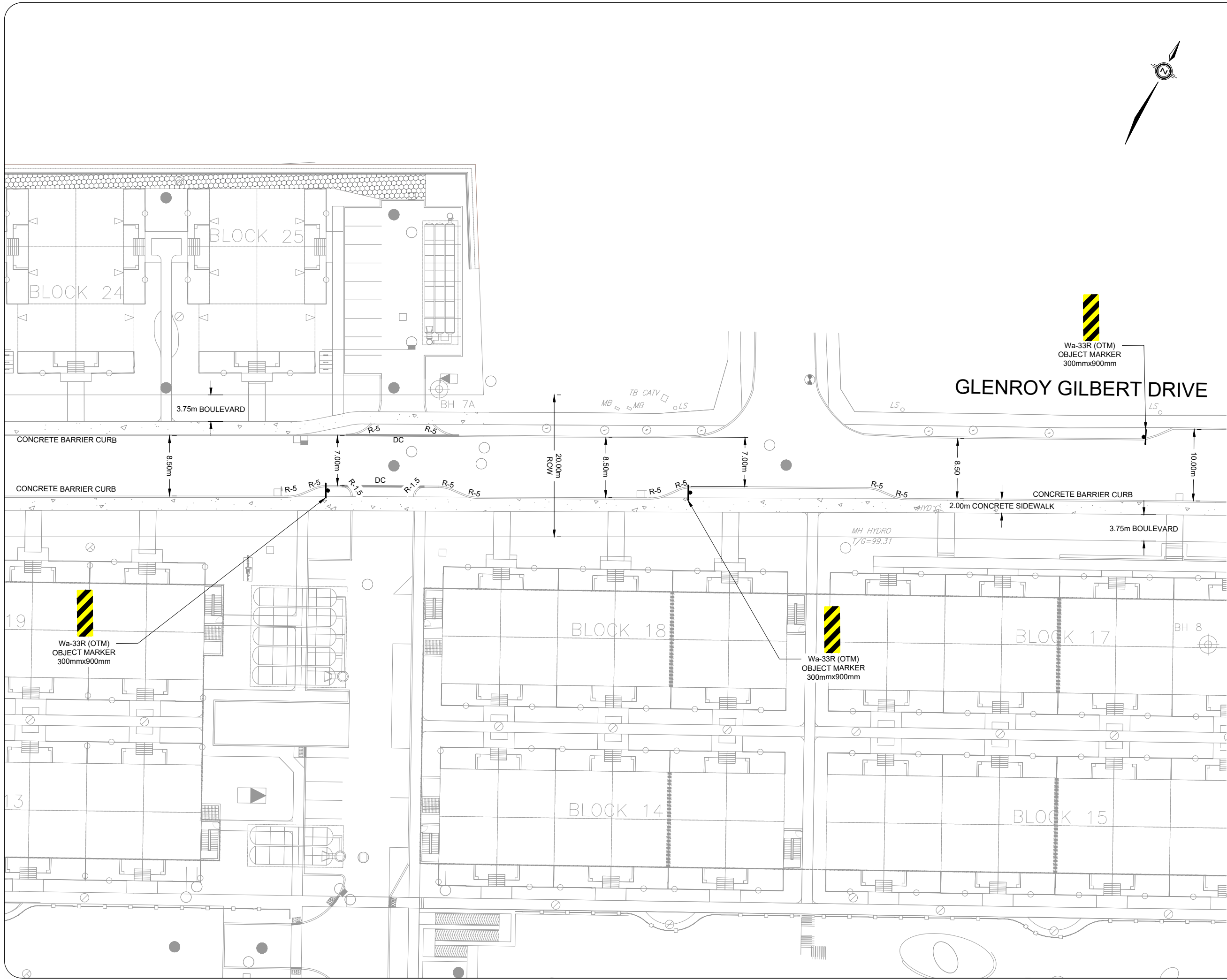

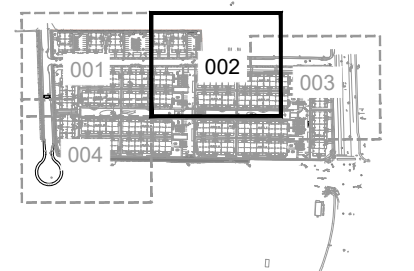

Rb-21 (OTM) ONE-WAY SIGN 300mm x 900mm



KEY PLAN



Legend

-  Concrete Sidewalk
-  Tactile Walking Surface Indicator (TWSI) as per SC 7.3
-  Depressed Curb
-  Catch Basin
-  Storm Maintenance Hole
-  Sanitary Maintenance Hole

NOTE 01: 5m RADIUS ON ALL DOUBLE INTERSECTION NARROWING PER "R7" UNLESS OTHERWISE SPECIFIED

NOTE 02: 5m RADIUS ON ALL SINGLE INTERSECTIONS NARROWING PER "R8" UNLESS OTHERWISE SPECIFIED

NOTE 03: THE FUTURE SIDEWALK AND CYCLE TRACKS ON THE WEST SIDE OF RIOCAN AVENUE ARE SHOWN TO DEMONSTRATE THE ULTIMATE BUILD-OUT OF THE CROSS-SECTION. THIS INFRASTRUCTURE IS NOT PLANNED AS PART OF CONSTRUCTION.

NOTE 04: PROPOSED CYCLE TRACK RAMP DOWN TRANSITION TO ON ROAD SHARED FACILITY (PER SC39) TO BE USED AS PART OF INTERIM CONDITIONS

04	Updated Site Plan	AN	2024-02-21
REV:	DESCRIPTION:	BY:	DATE:
STATUS:			



CGH Transportation
 6 Plaza Court
 Ottawa, ON
 K2H 7W1
 (343) 999-9117

CLIENT: Minto Communities

ARCHITECT:

SITE: Minto Town Centre

TITLE: Geometric Road Design Drawings



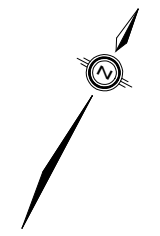
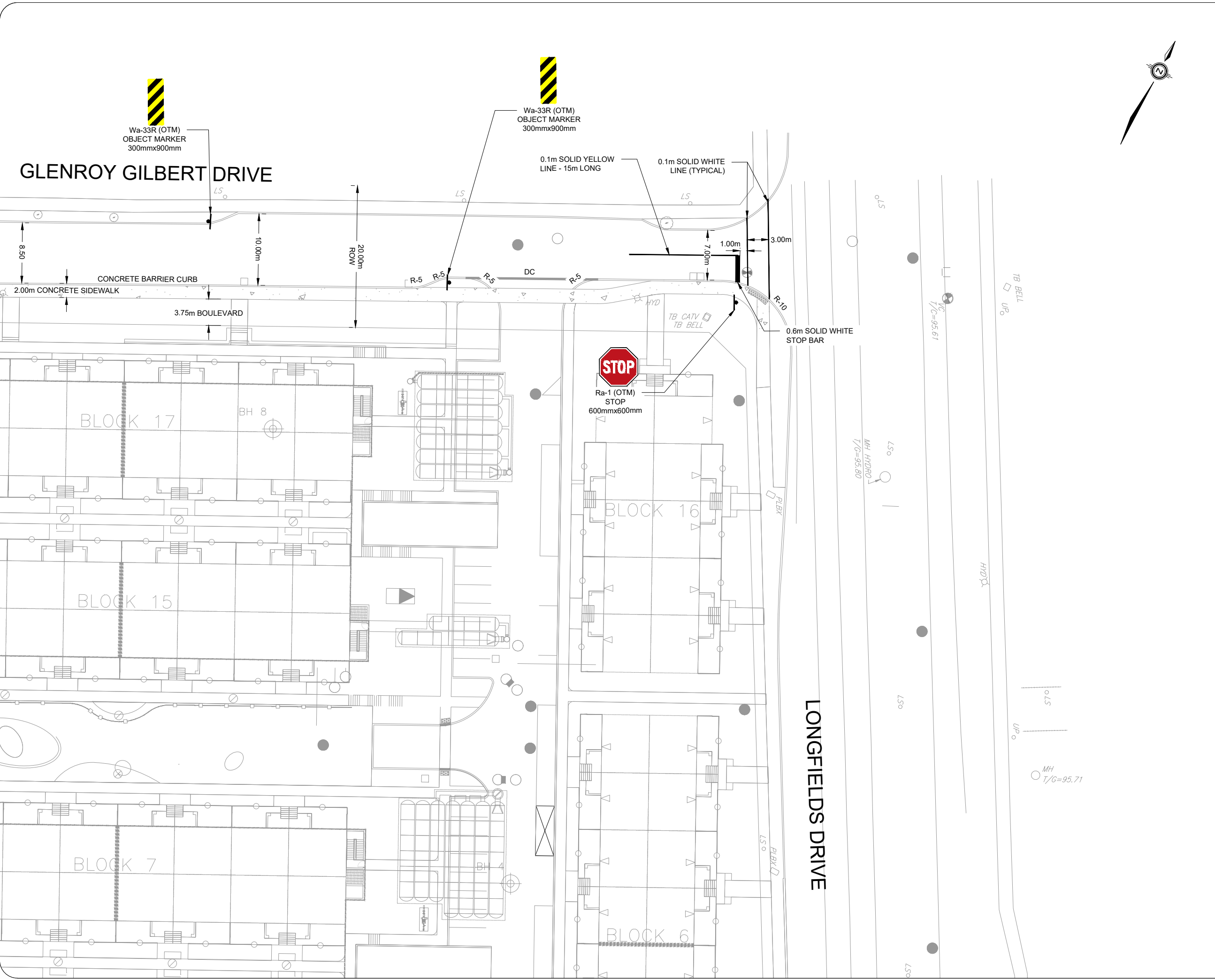

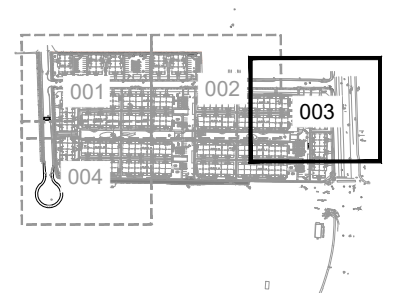

SCALE AT A3:	DATE:	DRAWN:	CHECKED:
NTS	2024-02-21	AN	AL
PROJECT NO:	DRAWING NO:	REVISION:	
2020-85	002	04	



KEY PLAN



Legend

-  Concrete Sidewalk
-  Tactile Walking Surface Indicator (TWSI) as per SC 7.3
-  Depressed Curb
-  Catch Basin
-  Storm Maintenance Hole
-  Sanitary Maintenance Hole

NOTE 01: 5m RADIUS ON ALL DOUBLE INTERSECTION NARROWING PER "R7" UNLESS OTHERWISE SPECIFIED

NOTE 02: 5m RADIUS ON ALL SINGLE INTERSECTIONS NARROWING PER "R8" UNLESS OTHERWISE SPECIFIED

NOTE 03: THE FUTURE SIDEWALK AND CYCLE TRACKS ON THE WEST SIDE OF RIOCAN AVENUE ARE SHOWN TO DEMONSTRATE THE ULTIMATE BUILD-OUT OF THE CROSS-SECTION. THIS INFRASTRUCTURE IS NOT PLANNED AS PART OF CONSTRUCTION.

NOTE 04: PROPOSED CYCLE TRACK RAMP DOWN TRANSITION TO ON ROAD SHARED FACILITY (PER SC39) TO BE USED AS PART OF INTERIM CONDITIONS

04	Updated Site Plan	AN	2024-02-21
REV:	DESCRIPTION:	BY:	DATE:
STATUS:			



CGH Transportation
 6 Plaza Court
 Ottawa, ON
 K2H 7W1
 (343) 999-9117

CLIENT: Minto Communities

ARCHITECT:

SITE: Minto Town Centre			
TITLE: Geometric Road Design Drawings			
SCALE AT A3: NTS	DATE: 2024-02-21	DRAWN: AN	CHECKED: AL
PROJECT NO: 2020-85	DRAWING NO: 003	REVISION: 04	

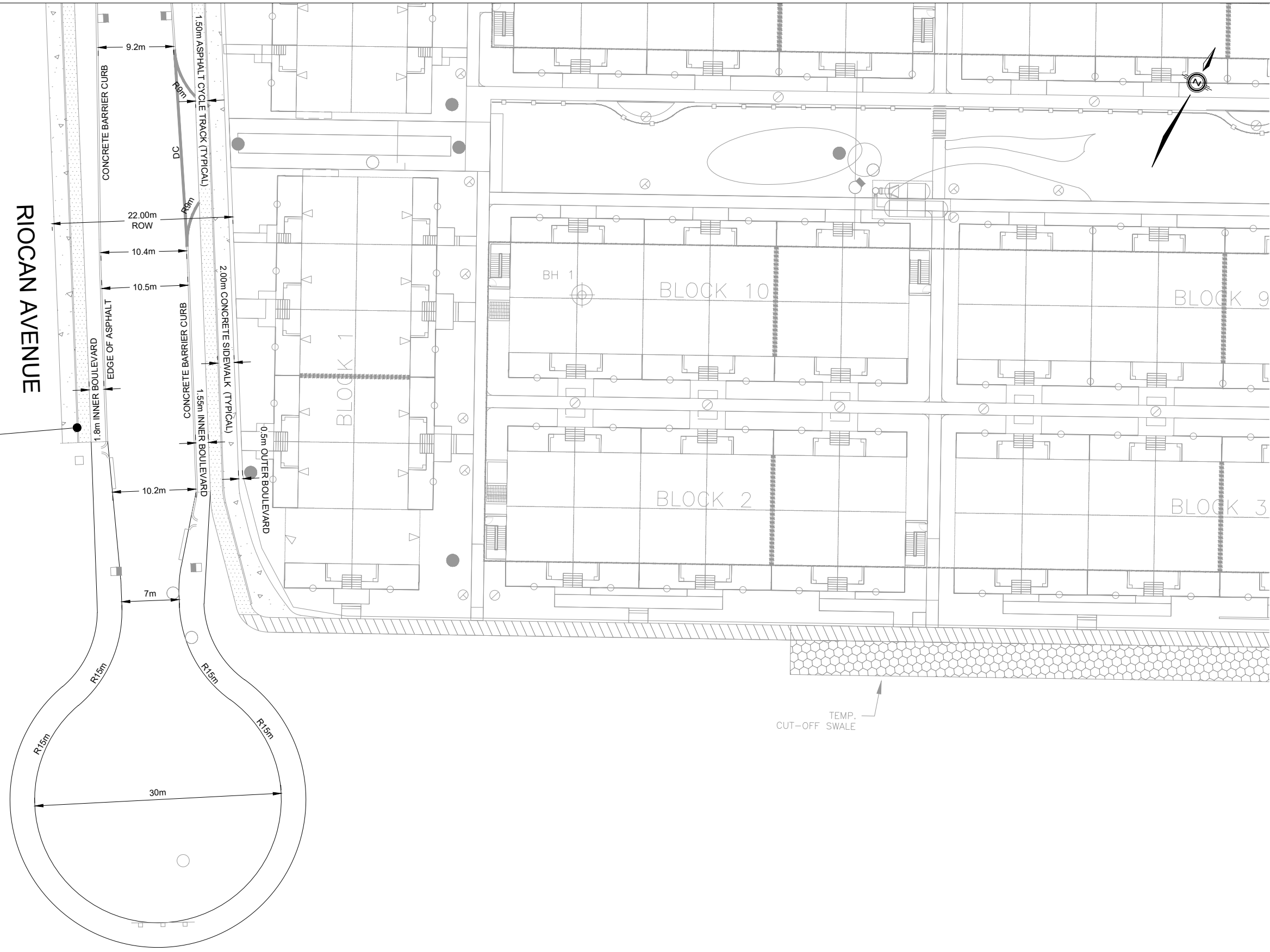

FUTURE INFRASTRUCTURE SEE NOTE 03

KEY PLAN

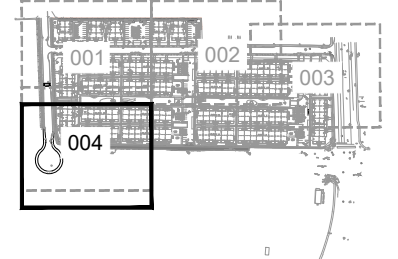

Legend

- Concrete Sidewalk
- Tactile Walking Surface Indicator (TWSI) as per SC 7.3
- Depressed Curb
- Catch Basin
- Storm Maintenance Hole
- Sanitary Maintenance Hole

NOTE 01: 5m RADIUS ON ALL DOUBLE INTERSECTION NARROWING PER "R7" UNLESS OTHERWISE SPECIFIED

NOTE 02: 5m RADIUS ON ALL SINGLE INTERSECTIONS NARROWING PER "R8" UNLESS OTHERWISE SPECIFIED

NOTE 03: THE FUTURE SIDEWALK AND CYCLE TRACKS ON THE WEST SIDE OF RIOCAN AVENUE ARE SHOWN TO DEMONSTRATE THE ULTIMATE BUILD-OUT OF THE CROSS-SECTION. THIS INFRASTRUCTURE IS NOT PLANNED AS PART OF CONSTRUCTION.

NOTE 04: PROPOSED CYCLE TRACK RAMP DOWN TRANSITION TO ON ROAD SHARED FACILITY (PER SC39) TO BE USED AS PART OF INTERIM CONDITIONS

04	Updated Site Plan	AN	2024-02-21
REV:	DESCRIPTION:	BY:	DATE:
STATUS:			

CGH Transportation
 6 Plaza Court
 Ottawa, ON
 K2H 7W1
 (343) 999-9117

CLIENT: Minto Communities

ARCHITECT:

SITE: Minto Town Centre

TITLE: Geometric Road Design Drawings

SCALE AT A3: NTS	DATE: 2024-02-21	DRAWN: AN	CHECKED: AL
PROJECT NO: 2020-85	DRAWING NO: 004	REVISION: 04	

FUTURE CHAPMAN MILLS DRIVE