

NOTE:
ALL WATERMAIN CONNECTIONS AND DECOMMISSIONING OF EXISTING WATERMANS TO BE COMPLETED BY CITY FORCES. TRENCH BACKFILL/REINSTATEMENT TO BE COMPLETED BY THE CONTRACTOR TO THE SATISFACTION OF THE CITY OF OTTAWA.

NOTE-RE: TEST PIT/BOREHOLE EXCAVATIONS
ANY DISTURBED MATERIAL ENCOUNTERED BELOW THE SUBGRADE LEVEL WITHIN A BUILDING FOOTPRINT TO BE SUB-EXCAVATED AND BACKFILLED WITH COMPACTED ENGINEERED FILL AS PER GEOTECHNICAL ENGINEERS RECOMMENDATION.

CONTRACTOR TO VERIFY THE PRECISE LOCATIONS AND INVERT ELEVATIONS OF EX. UNDERGROUND SERVICES AND EX UTILITIES PRIOR TO STARTING CONSTRUCTION

NOTE:
FOR WATERMAIN CROSSING BELOW AND ABOVE SEWERS, REFER TO CITY STD. W25 AND W25.2, RESPECTIVELY, WHERE APPLICABLE

ANY DISTURBED AREA DURING CONSTRUCTION TO BE RESTORED TO THE ORIGINAL CONDITION OR BETTER TO THE SATISFACTION OF THE AUTHORITIES HAVING JURISDICTION

NOTE:
FOR WATERMAIN STUDS, 2.4m MIN. COVER TO BE PROVIDED

NOTE:
ALL EXISTING TREES, SHRUBS ETC. WITHIN LOTS, BLOCKS AND ROADS TO BE REMOVED, UNLESS OTHERWISE NOTED

NOTE:
FOR HOUSE CONNECTIONS INSTALLED UNDER DRIVEWAYS, SLEEVE SHALL BE USED

NOTE:
THE COVER OF EX. MH, CB, CHAMBER AND OTHER ABOVEGROUND FEATURES TO BE ADJUSTED TO SUIT THE NEW FINISHED GRADE, WHERE APPLICABLE

PERMISSION REQUIRED FOR WORK ON ADJACENT LANDS

NOTE: RE: WATERMAIN / WATER SERVICE
1. INSULATION REQUIRED FOR WATERMAIN / WATER SERVICE WHERE THE SEPARATION BETWEEN WATERMAIN / WATER SERVICE AND OTHER SERVICES AND STRUCTURES IS LESS THAN 1.2m AND THE COVER IS LESS THAN 2.4m. REFER TO CITY STD. W23 FOR DETAIL.
2. FOR SERVICE INSTALLATION AT SEWER CROSSING, REFER TO CITY STD. W38 FOR DETAIL.

NOTE: ICD
FOR CATCHBASIN INFO AND ICD INFORMATION, REFER TO DRAWING No. 3 FOR DETAIL.

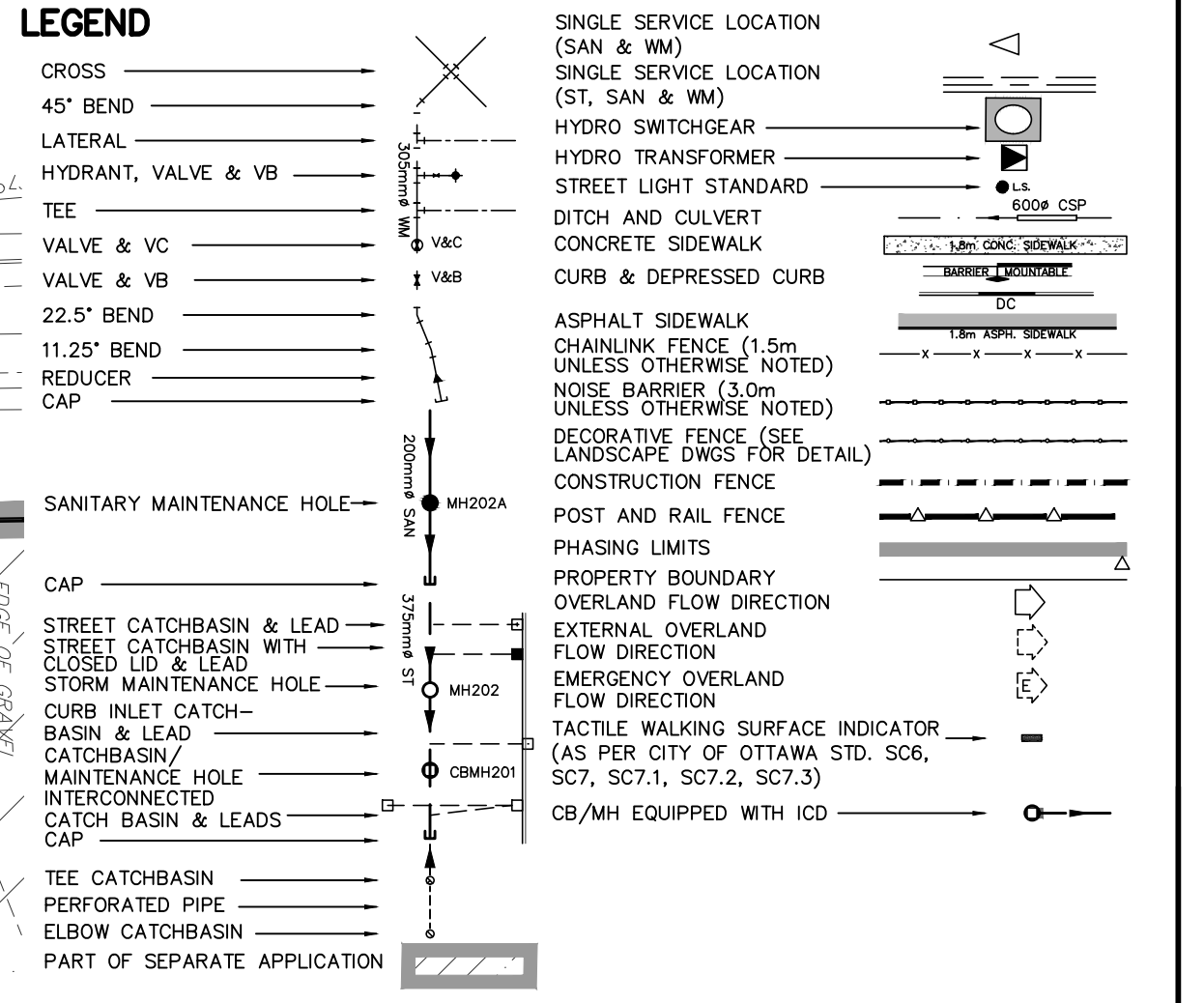
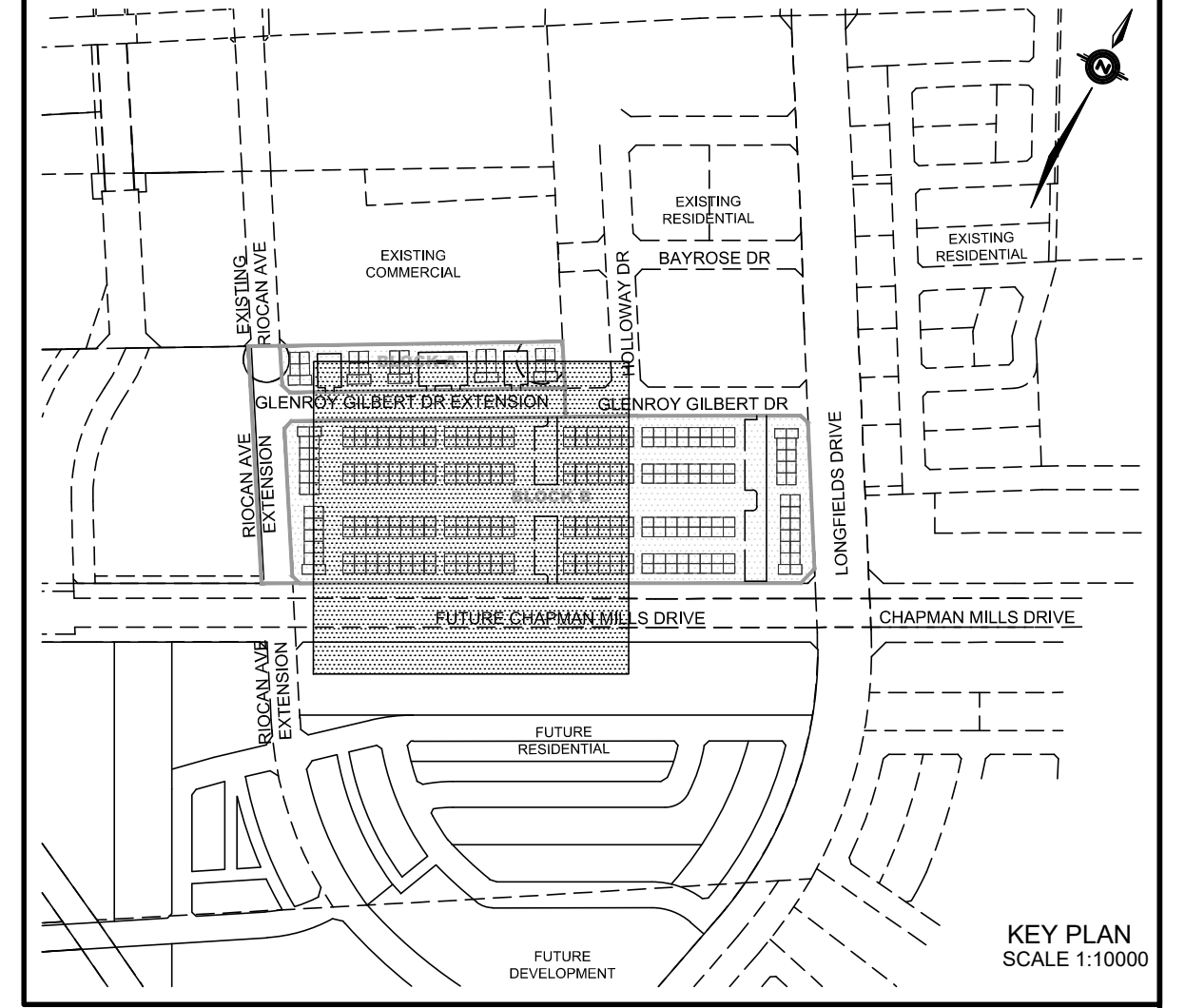
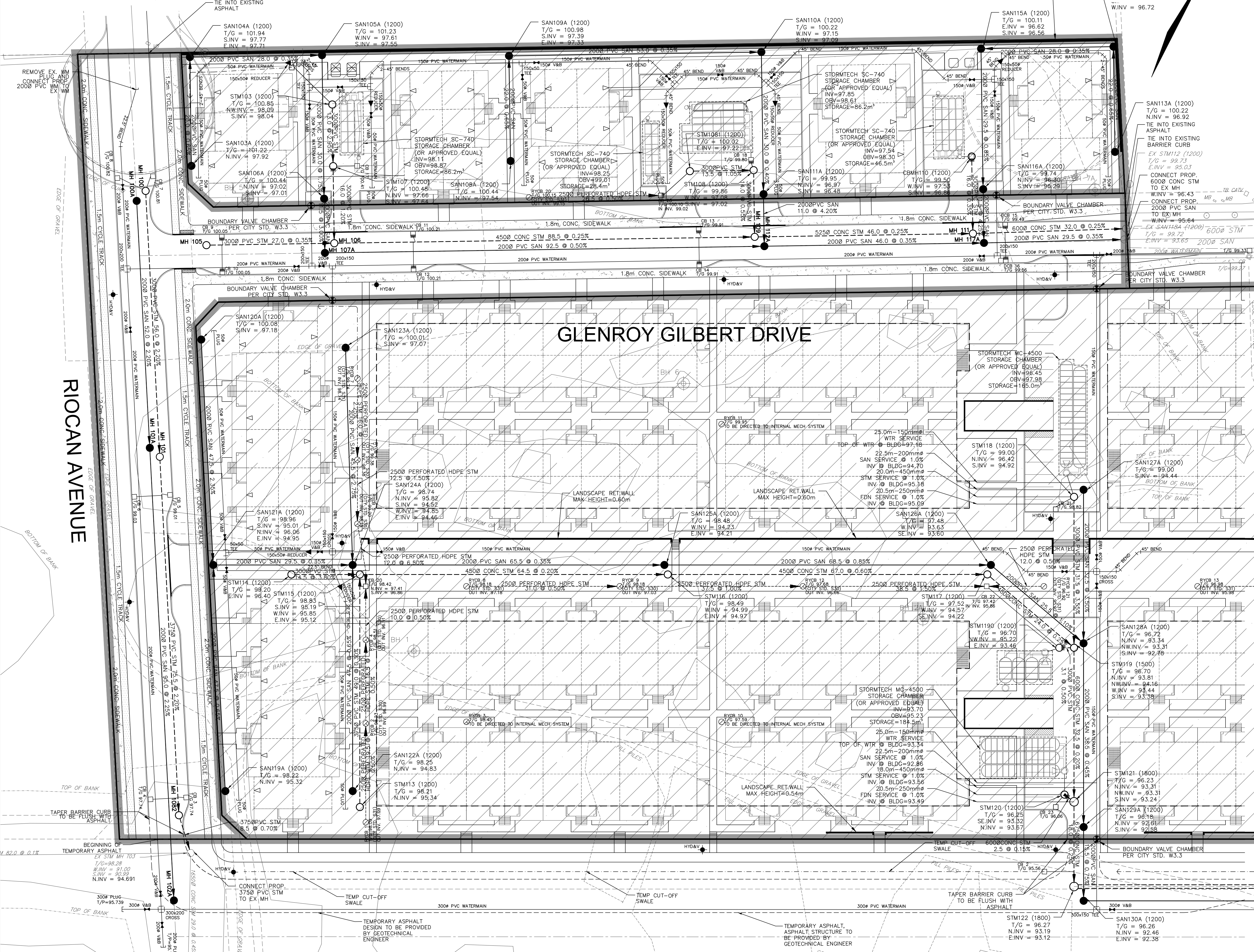

NOT FOR CONSTRUCTION

1 S.L.M. 22-06-10 1ST SUBMISSION		NO. BY DATE DESCRIPTION	
TOPOGRAPHIC INFORMATION			
TOPOGRAPHIC INFORMATION PROVIDED BY STANTEC GEOMATICS LTD., PROJECT No. 161614291-111, DATED MARCH 1, 2022			
SITE PLAN INFORMATION			
SITE PLAN PROVIDED BY SRN ARCHITECTS LTD., PROJECT No. S21001, DATED FEBRUARY 3, 2022			
LEGAL INFORMATION			
CALCULATED M-PLAN PROVIDED BY STANTEC GEOMATICS LTD., PROJECT No. 161614291-111, DATED MARCH 1, 2022			
BENCH MARK			
ELEVATIONS ARE REFERRED TO THE CANADIAN GEODETIC VERTICAL DATUM (CGVD-1928:1978) AND ARE DERIVED FROM BENCHMARK MONUMENT No. 196530071*, HAVING A PUBLISHED ELEVATION OF 99.742 METRES			
MINTO COMMUNITIES INC.		BARRHAVEN TOWN CENTRE	
		GLENROY GILBERT DRIVE & RIOCAN AVENUE ROADWAY EXTENSIONS	
120 Ber Road Unit 103 Slittsville, Ontario, K2S 1E9 Tel. (613) 836-0856 Fax. (613) 836-7183 www.DSEL.ca		110 Laurier Ave W Ottawa, Ontario, K1P 1J1 Tel. (613) 580-2400 www.Ottawa.ca	
GENERAL PLAN			
DRAWN BY: AM		CHECKED BY: BC	
DESIGNED BY: BC		CHECKED BY: SM	
SCALE: 1:400		PROJECT No. 15-816	
		SHEET No. 4	

CITY PLAN No. XXXXX
D07-XX-XX-XX-XXXX