

ANY DISTURBED AREA DURING CONSTRUCTION TO BE RESTORED TO THE ORIGINAL CONDITION OR BETTER TO THE SATISFACTION OF THE AUTHORITIES HAVING JURISDICTION

CONTRACTOR TO VERIFY THE PRECISE LOCATIONS AND INVERT ELEVATIONS OF EX. UNDERGROUND SERVICES AND EX. UTILITIES PRIOR TO STARTING CONSTRUCTION

NOTE:
ALL EXISTING TREES, SHRUBS ETC. WITHIN LOTS, BLOCKS AND ROADS TO BE REMOVED, UNLESS OTHERWISE NOTED

PERMISSION REQUIRED FOR WORK ON ADJACENT LANDS

NOTE: CATCHBASIN DATA
FOR CATCHBASIN DATA, REFER TO DRAWING No. 3 FOR DETAIL.

NOTE
FOR WATERMAIN STUBS, 2.4m MIN. COVER TO BE PROVIDED

NOTE-RE: TEST PIT/BOREHOLE EXCAVATIONS
ANY DISTURBED MATERIAL ENCOUNTERED BELOW THE SUBGRADE LEVEL WITHIN A BUILDING FOOTPRINT TO BE SUB-EXCAVATED AND BACKFILLED WITH COMPACTED ENGINEERED FILL AS PER GEOTECHNICAL ENGINEERS RECOMMENDATION.

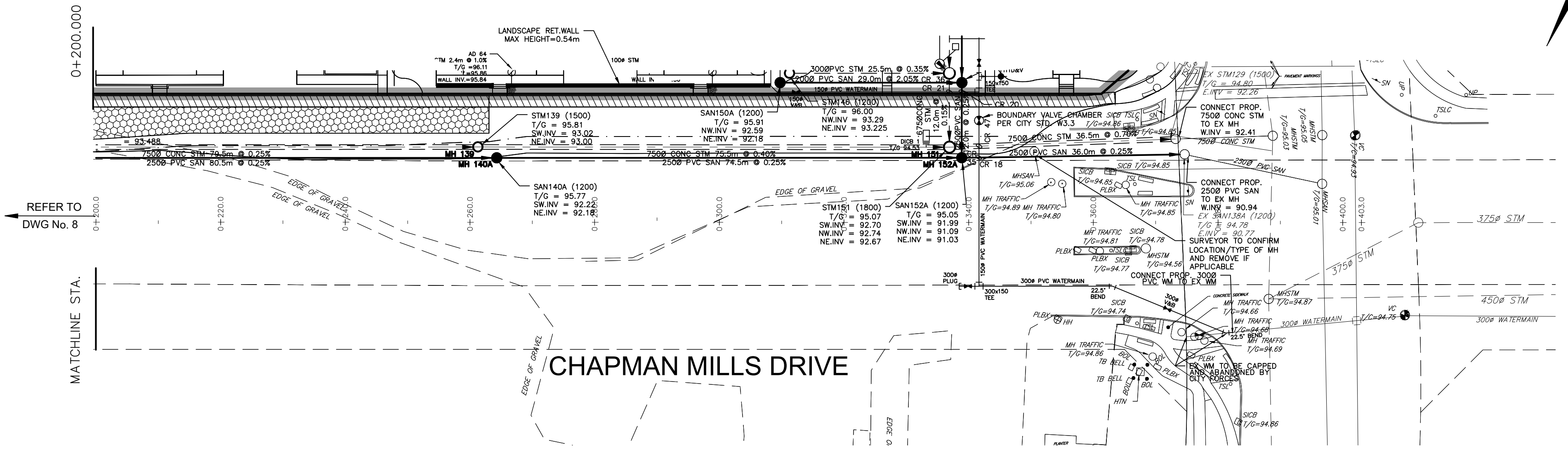

LONGFIELDS DRIVE

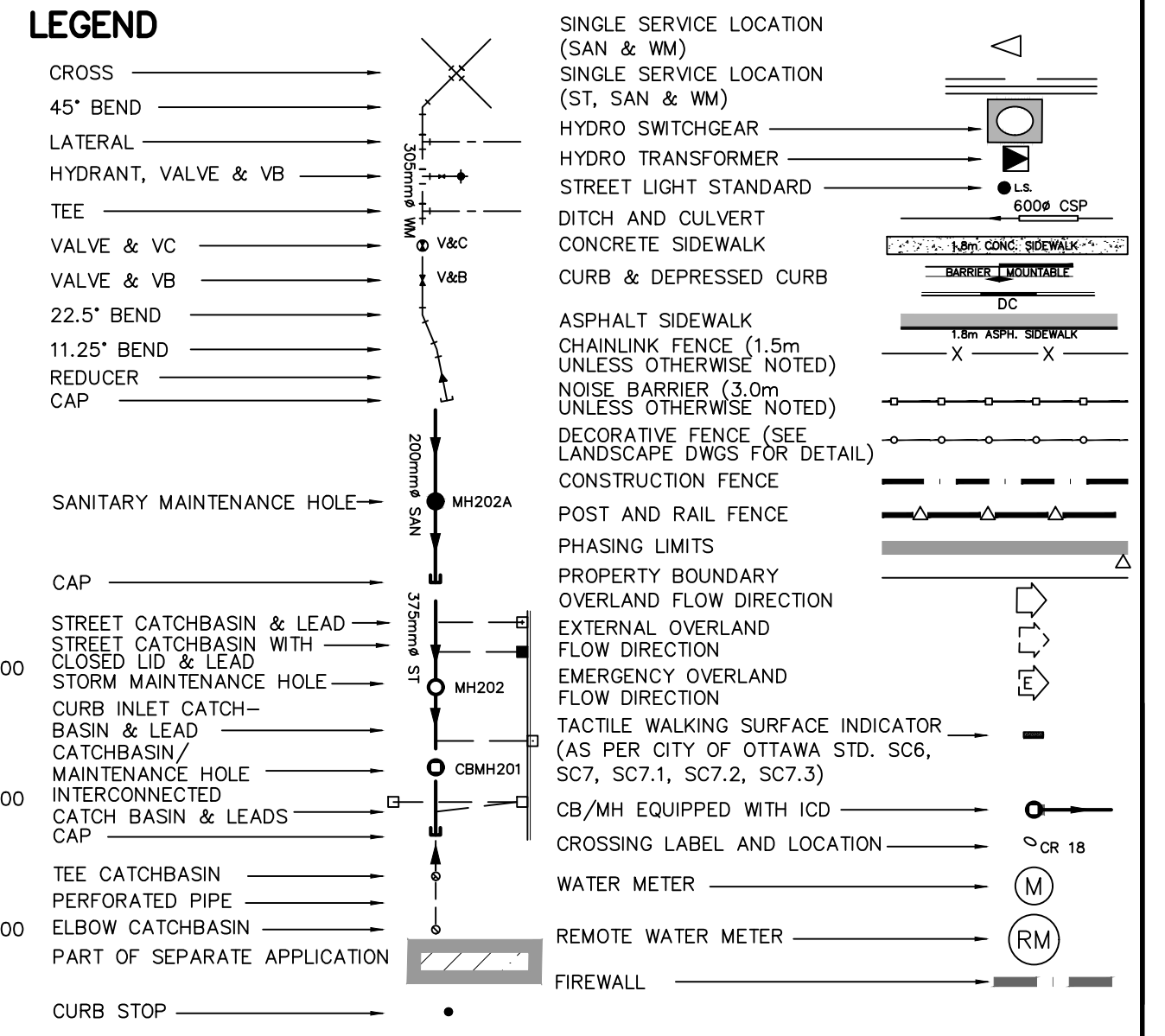
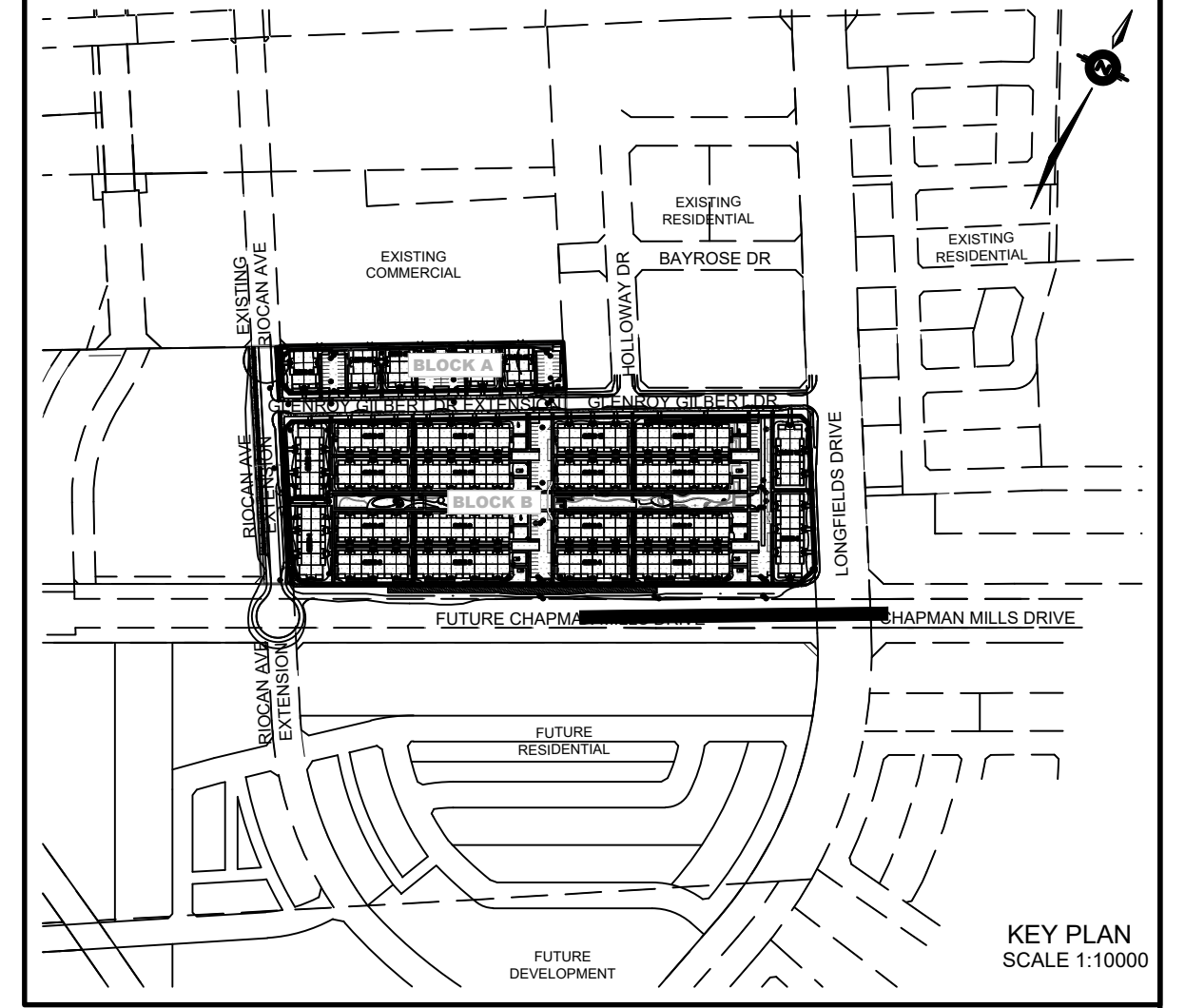

NOT FOR CONSTRUCTION

No.	BY	DATE	DESCRIPTION
7	S.L.M.	24-02-09	SUBMISSION 5
6	S.L.M.	23-10-06	ISSUED FOR TENDER
5	S.L.M.	23-09-22	ISSUED FOR TENDER
4	S.L.M.	23-09-06	ISSUED FOR TENDER

TOPOGRAPHIC INFORMATION
TOPOGRAPHIC INFORMATION PROVIDED BY STANTEC GEOMATICS LTD., PROJECT No. 161614291-111, DATED MARCH 1, 2022

SITE PLAN INFORMATION
SITE PLAN PROVIDED BY SRN ARCHITECTS LTD., PROJECT No. S21001, DATED OCTOBER 5, 2023

LEGAL INFORMATION
CALCULATED DRAFT PLAN PROVIDED BY STANTEC GEOMATICS LTD., PROJECT No. 161614291-131, DATED AUGUST 9, 2023

BENCH MARK
ELEVATIONS ARE REFERRED TO THE CANADIAN GEODETIC VERTICAL DATUM (CGVD-1928:1978) AND ARE DERIVED FROM BENCHMARK MONUMENT No. 196530071*, HAVING A PUBLISHED ELEVATION OF 99.742 METRES

MINTO COMMUNITIES INC. BARRHAVEN TOWN CENTRE GLENROY GILBERT DRIVE RIOCAN AVENUE & CHAPMAN MILLS DRIVE EXTENSION

Ottawa 110 Laurier Ave W Ottawa, Ontario, K1P 1J1 Tel. (613) 580-2400 www.Ottawa.ca

PLAN AND PROFILE OF CHAPMAN MILLS DRIVE STA 0+200.000 TO STA 0+420.000

DRAWN BY: AM	CHECKED BY: BC	PROJECT No. 15-816
DESIGNED BY: BC	CHECKED BY: SM	SHEET No. 9
SCALE: HORZ: 1:500	VERT: 1:50	

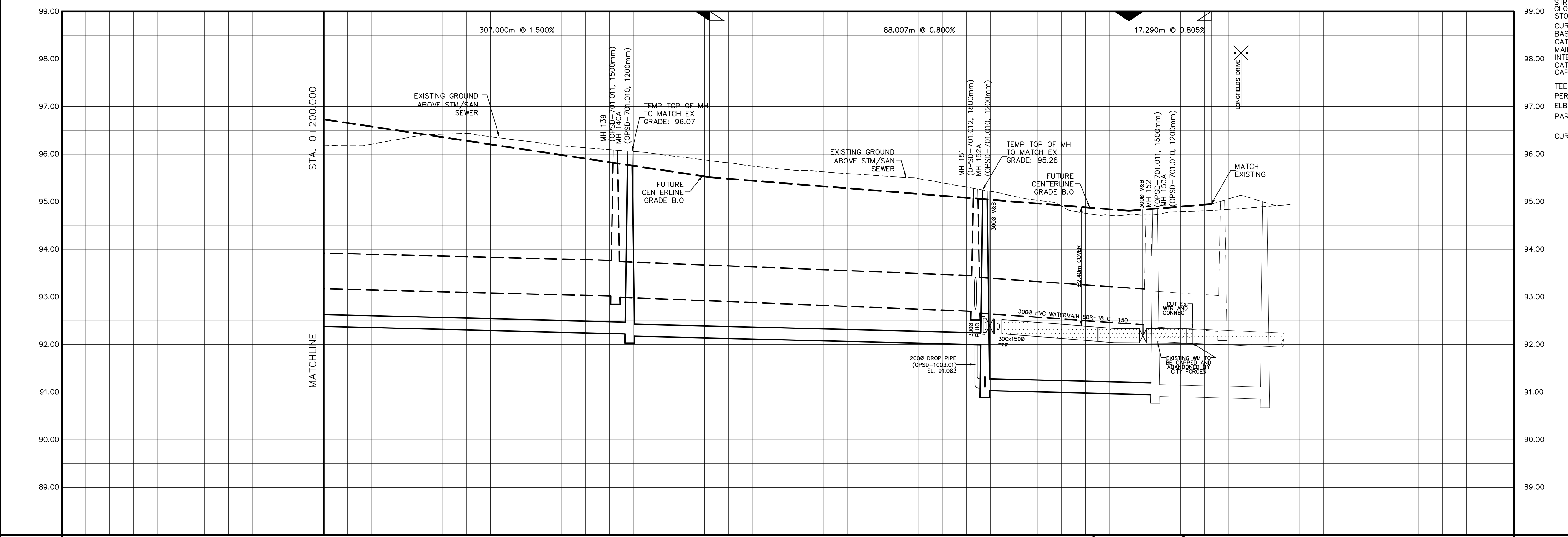

TOP OF WATERMAIN	SANITARY INVERT	STORM INVERT	PROPOSED GRADES	CENTERLINE CHAINAGE	TOP OF WATERMAIN	SANITARY INVERT	STORM INVERT	PROPOSED GRADES	CENTERLINE CHAINAGE
				0+200.000					0+200.000
				0+220.000					0+220.000
				0+240.000					0+240.000
				0+260.000					0+260.000
				0+280.000					0+280.000
				0+300.000					0+300.000
				0+320.000					0+320.000
				0+340.000					0+340.000
				0+360.000					0+360.000
				0+380.000					0+380.000
				0+400.000					0+400.000
				0+420.000					0+420.000

CITY PLAN No. 18822 CITY FILE No. D07-12-22-0104