

**PAVEMENT DESIGN**  
 40mm SUPERPAVE 12.5 ASPHALTIC CONCRETE  
 50mm SUPERPAVE 19.0 ASPHALTIC CONCRETE  
 50mm SUPERPAVE 19.0 ASPHALTIC CONCRETE  
 150mm OPSS GRANULAR A CRUSHED STONE  
 600mm OPSS GRANULAR B TYPE II

ANY DISTURBED AREA DURING CONSTRUCTION TO BE RESTORED TO THE ORIGINAL CONDITION OR BETTER TO THE SATISFACTION OF THE AUTHORITIES HAVING JURISDICTION

CONTRACTOR TO VERIFY THE PRECISE LOCATIONS AND INVERT ELEVATIONS OF EX. UNDERGROUND SERVICES AND EX. UTILITIES PRIOR TO STARTING CONSTRUCTION

**NOTE:**  
 ALL EXISTING TREES, SHRUBS ETC. WITHIN LOTS, BLOCKS AND ROADS TO BE REMOVED, UNLESS OTHERWISE NOTED

PERMISSION REQUIRED FOR WORK ON ADJACENT LANDS

**NOTE: CATCHBASIN DATA**  
 FOR CATCHBASIN DATA, REFER TO DRAWING No. 3 FOR DETAIL.

**NOTE**  
 FOR WATERMAIN STUBS, 2.4m MIN. COVER TO BE PROVIDED

**NOTE-RE: TEST PIT/BOREHOLE EXCAVATIONS**  
 ANY DISTURBED MATERIAL ENCOUNTERED BELOW THE SUBGRADE LEVEL WITHIN A BUILDING FOOTPRINT TO BE SUB-EXCAVATED AND BACKFILLED WITH COMPACTED ENGINEERED FILL AS PER GEOTECHNICAL ENGINEERS RECOMMENDATION.

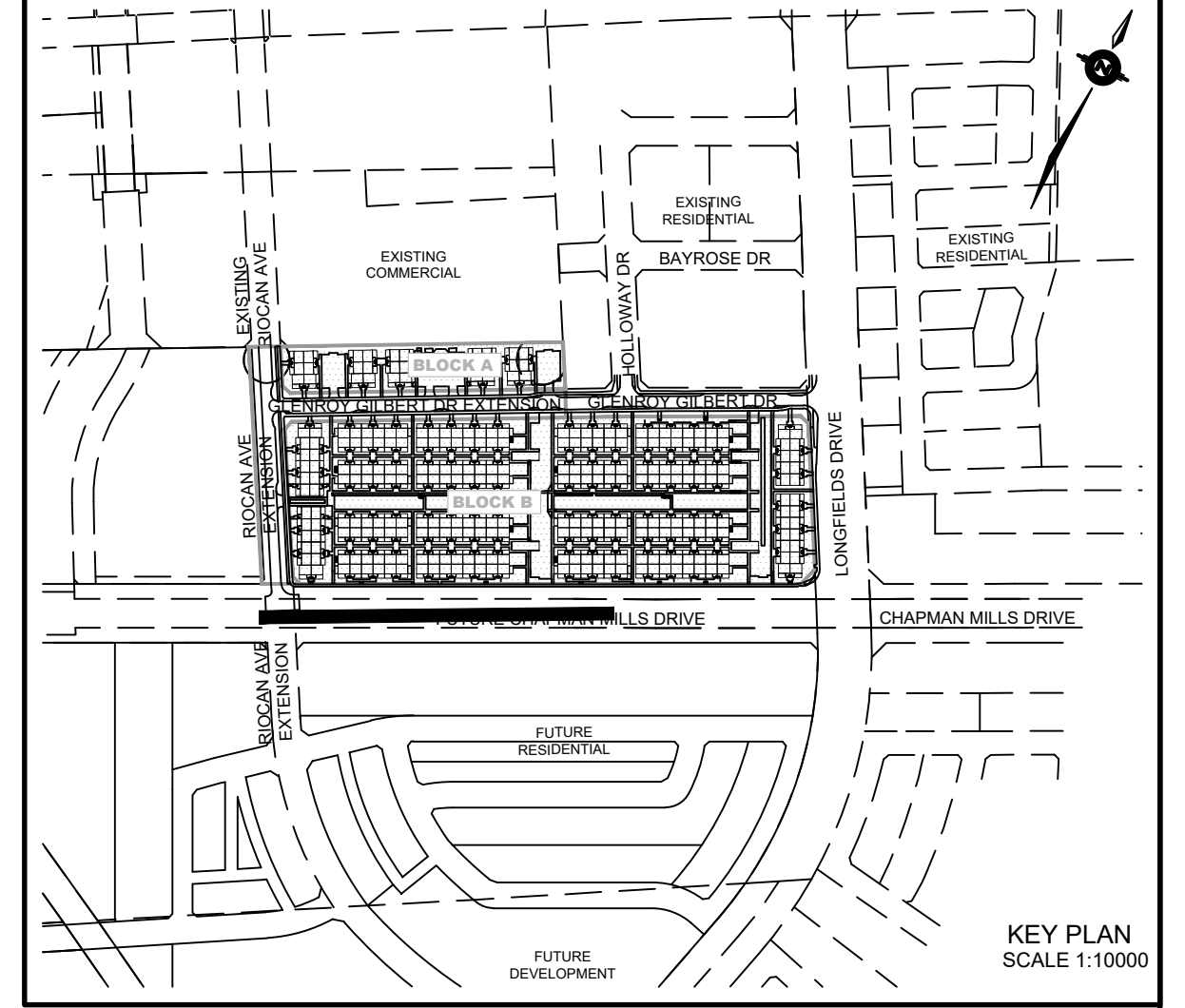
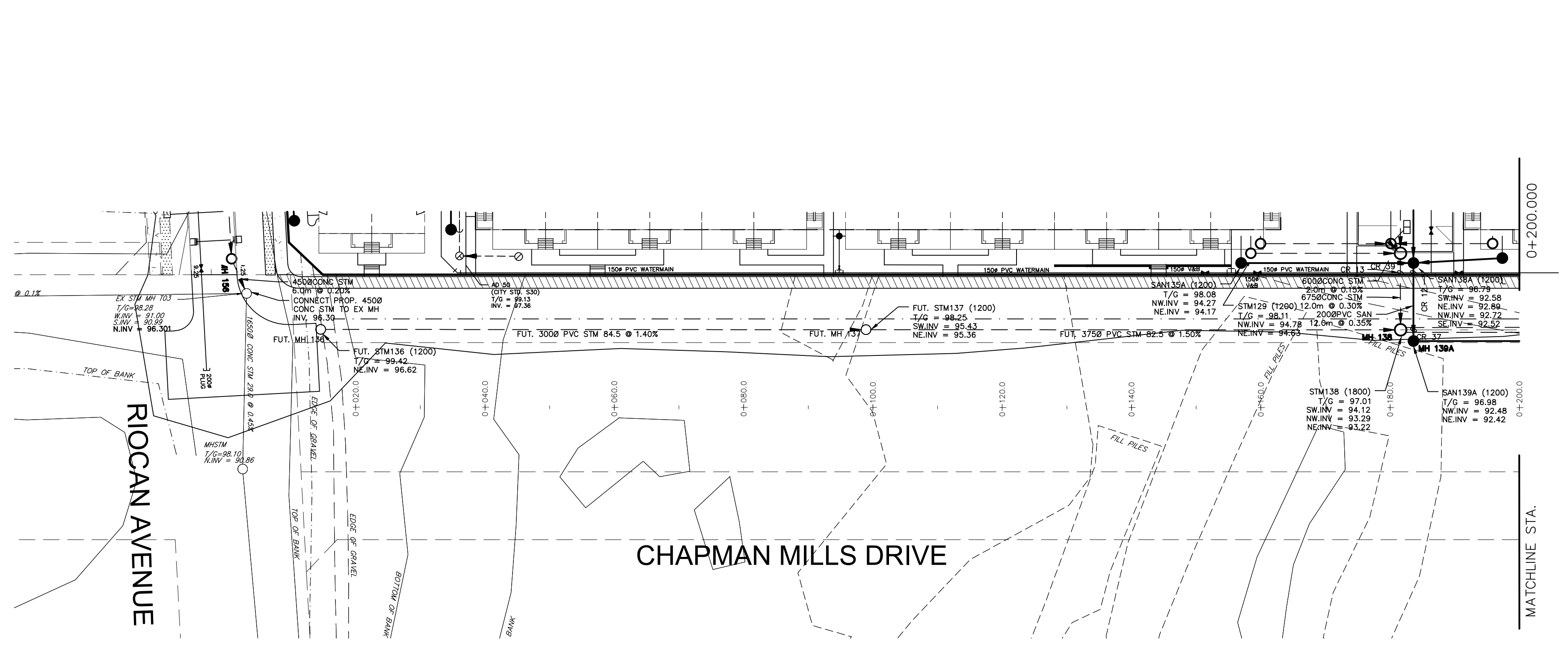

REFER TO DWG No. 9

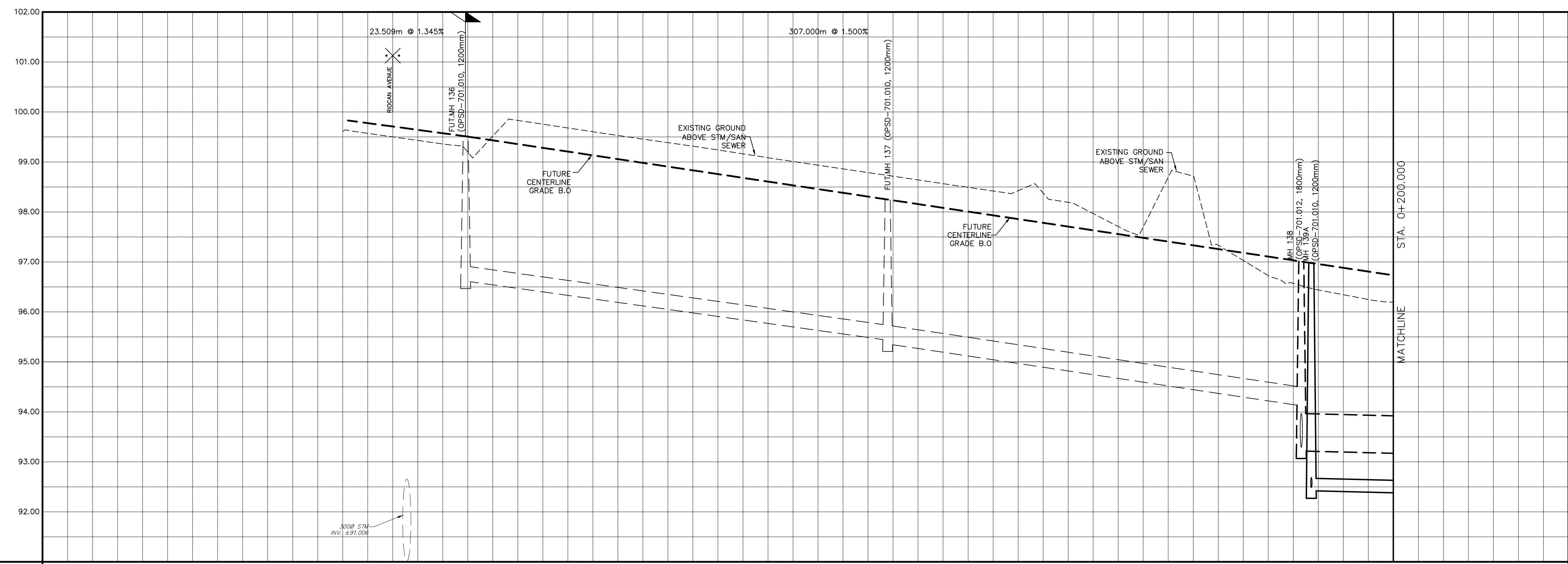

**LEGEND**

CROSS	SINGLE SERVICE LOCATION (SAN & WM)
45° BEND	SINGLE SERVICE LOCATION (ST, SAN & WM)
LATERAL	HYDRO SWITCHGEAR
HYDRANT, VALVE & VB	HYDRO TRANSFORMER
TEE	STREET LIGHT STANDARD
VALVE & VC	DITCH AND CULVERT
VALVE & VB	CONCRETE SIDEWALK
22.5° BEND	CURB & DEPRESSIONED CURB
11.25° BEND	ASPHALT SIDEWALK
REDUCER	CHAINLINK FENCE (1.5m UNLESS OTHERWISE NOTED)
CAP	NOISE BARRIER (3.0m UNLESS OTHERWISE NOTED)
	DECORATIVE FENCE (SEE LANDSCAPE DWGS FOR DETAIL)
	CONSTRUCTION FENCE
	POST AND RAIL FENCE
	PHASING LIMITS
	PROPERTY BOUNDARY
	OVERLAND FLOW DIRECTION
	EXTERNAL OVERLAND FLOW DIRECTION
	CLOSED LID & LEAD
	STORM MAINTENANCE HOLE
	EMERGENCY OVERLAND FLOW DIRECTION
	CURB INLET CATCH-BASIN & LEAD
	TACTILE WALKING SURFACE INDICATOR (AS PER CITY OF OTTAWA STD. SC6, SC7, SC7.1, SC7.2, SC7.3)
	MAINTENANCE HOLE
	INTERCONNECTED CATCH BASIN & LEADS
	CB/MH EQUIPPED WITH ICD
	CROSSING LABEL AND LOCATION
	TEE CATCHBASIN
	PERFORATED PIPE
	ELBOW CATCHBASIN
	WATER METER
	PART OF SEPARATE APPLICATION
	REMOTE WATER METER

**NOT FOR CONSTRUCTION**

No.	BY	DATE	DESCRIPTION
3	S.L.M.	23-06-30	3RD SUBMISSION
2	S.L.M.	23-03-10	2ND SUBMISSION
1	S.L.M.	22-06-10	1ST SUBMISSION

**TOPOGRAPHIC INFORMATION**  
 TOPOGRAPHIC INFORMATION PROVIDED BY STANTEC GEOMATICS LTD., PROJECT No. 161614291-111, DATED MARCH 1, 2022

**SITE PLAN INFORMATION**  
 SITE PLAN PROVIDED BY SRN ARCHITECTS LTD., PROJECT No. S21001, DATED JUNE 27, 2023

**LEGAL INFORMATION**  
 CALCULATED DRAFT PLAN PROVIDED BY STANTEC GEOMATICS LTD., PROJECT No. 161614291-111, DATED MAY 9, 2022

**BENCH MARK**  
 ELEVATIONS ARE REFERRED TO THE CANADIAN GEODETIC VERTICAL DATUM (CGVD-1928:1978) AND ARE DERIVED FROM BENCHMARK MONUMENT No. 196530071\*, HAVING A PUBLISHED ELEVATION OF 99.742 METRES

MINTO COMMUNITIES INC.  
 BARRHAVEN TOWN CENTRE  
 GLENROY GILBERT DRIVE RIOCAN AVENUE & CHAPMAN MILLS DRIVE EXTENSION

**Ottawa**  
 110 Laurier Ave W  
 Ottawa, Ontario, K1P 1J1  
 Tel. (613) 580-2400  
 www.Ottawa.ca

PLAN AND PROFILE OF  
**CHAPMAN MILLS DRIVE**  
 STA 0+000.000 TO STA 0+200.00

DRAWN BY: AM	CHECKED BY: BC	PROJECT No. <b>15-816</b>
DESIGNED BY: BC	CHECKED BY: SM	SHEET No. <b>8</b>
SCALE: HORZ. 1:500	VERT. 1:50	

TOP OF WATERMAIN	SANITARY INVERT	STORM INVERT	PROPOSED GRADES	CENTERLINE CHAINAGE	TOP OF WATERMAIN	SANITARY INVERT	STORM INVERT	PROPOSED GRADES	CENTERLINE CHAINAGE
			99.732	0+000.000					
			99.432	0+014.568					
			98.832	0+020.000					
			98.532	0+040.000					
			97.632	0+060.000					
			97.332	0+080.000					
			96.732	0+100.000					
				0+120.000					
				0+140.000					
				0+160.000					
				0+180.000					
				0+200.000					

CITY PLAN No. 18822  
 CITY FILE No. D07-12-22-0104