

NOTE:
ALL WATERMAIN CONNECTIONS AND DECOMMISSIONING OF EXISTING WATERMANS TO BE COMPLETED BY CITY FORCES. TRENCH BACKFILL/REINSTATEMENT TO BE COMPLETED BY THE CONTRACTOR TO THE SATISFACTION OF THE CITY OF OTTAWA.

CONTRACTOR TO VERIFY THE PRECISE LOCATIONS AND INVERT ELEVATIONS OF EX. UNDERGROUND SERVICES AND EX UTILITIES PRIOR TO STARTING CONSTRUCTION

ANY DISTURBED AREA DURING CONSTRUCTION TO BE RESTORED TO THE ORIGINAL CONDITION OR BETTER TO THE SATISFACTION OF THE AUTHORITIES HAVING JURISDICTION

NOTE:
ALL EXISTING TREES, SHRUBS ETC. WITHIN LOTS, BLOCKS AND ROADS TO BE REMOVED, UNLESS OTHERWISE NOTED

NOTE:
THE COVER OF EX. MH, CB, CHAMBER AND OTHER ABOVEGROUND FEATURES TO BE ADJUSTED TO SUIT THE NEW FINISHED GRADE, WHERE APPLICABLE

NOTE: RE: WATERMAIN / WATER SERVICE
1. INSULATION REQUIRED FOR WATERMAIN / WATER SERVICE WHERE THE SEPARATION BETWEEN WATERMAIN / WATER SERVICE AND OTHER SERVICES AND STRUCTURES IS LESS THAN 1.2m AND THE COVER IS LESS THAN 2.4m. REFER TO CITY STD. W3 FOR DETAIL.
2. FOR SERVICE INSTALLATION AT SEWER CROSSING, REFER TO CITY STD. W38 FOR DETAIL.

NOTE: RE: TEST PIT / BOREHOLE EXCAVATIONS
ANY DISTURBED MATERIAL ENCOUNTERED BELOW THE SUBGRADE LEVEL WITHIN A BUILDING FOOTPRINT TO BE SUB-ELEVATED AND BACKFILLED WITH COMPACTED ENGINEERED FILL AS PER GEOTECHNICAL ENGINEERS RECOMMENDATION.
NOTE:
FOR DEAD-END WATERMAIN LAYOUTS REFER TO CITY STD. W37.2

NOTE: CROSSINGS
FOR CROSSING INFO, REFER TO DRAWING No.2 CROSSING TABLE
NOTE:
WATER AND SANITARY SERVICES TO BE SLEEVED UNDER U/G STORAGE TANKS

NOTE:
FOR WATERMAIN CROSSING BELOW AND ABOVE SEWERS, REFER TO CITY STD. W25 AND W25.2, RESPECTIVELY, WHERE APPLICABLE

NOTE:
FOR WATERMAIN STUDS, 2.4m MIN. COVER TO BE PROVIDED

NOTE:
FOR HOUSE CONNECTIONS INSTALLED UNDER DRIVEWAYS, SLEEVE SHALL BE USED

PERMISSION REQUIRED FOR WORK ON ADJACENT LANDS

NOTE: ICD
FOR CATCHBASIN INFO AND ICD INFORMATION, REFER TO DRAWING No.2 FOR DETAIL.

NOTE:
STORM CONNECTIONS TO UG STORAGE TANKS TO BE 375mm @ 0.5% UNLESS OTHERWISE NOTED

NOTE:
ENTRANCES TO PRIVATE SITE PER SC7.1

NOTE:
FOR FOUNDATION SERVICES, CONNECT 2500 PVC PIPE TO STORM MAIN AT OBY SLOPING AT 1.0% UNLESS OTHERWISE NOTED.

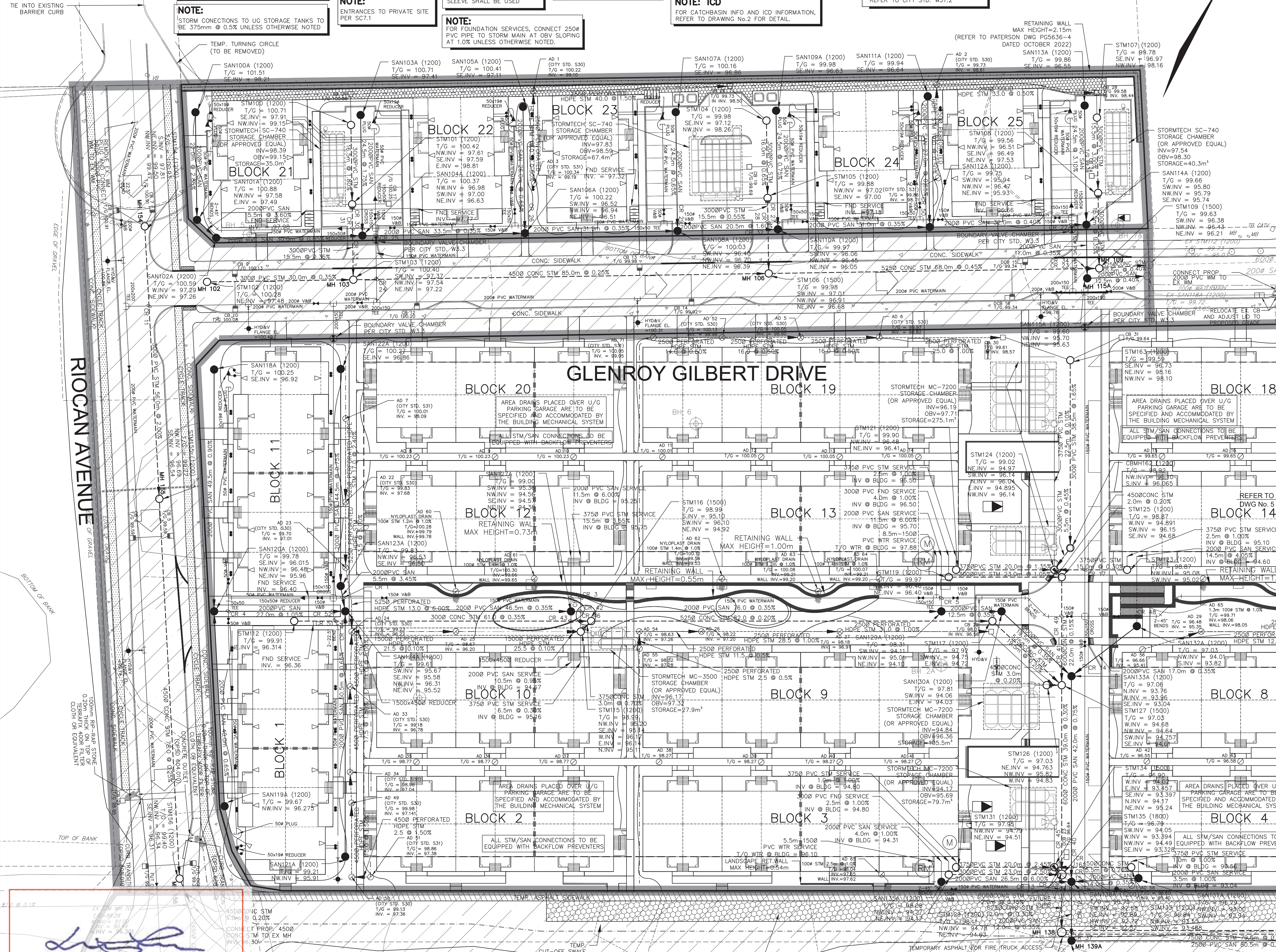
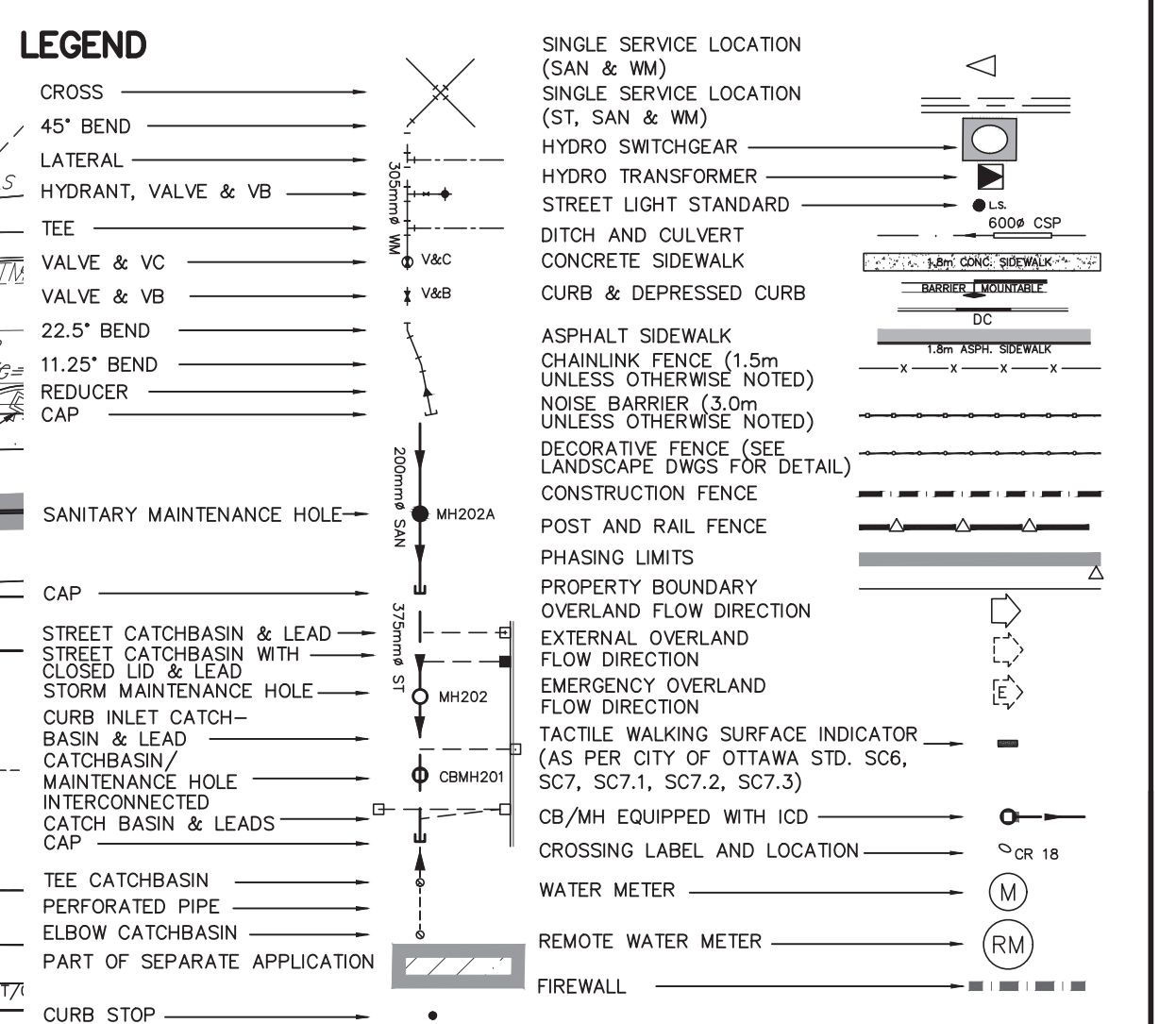
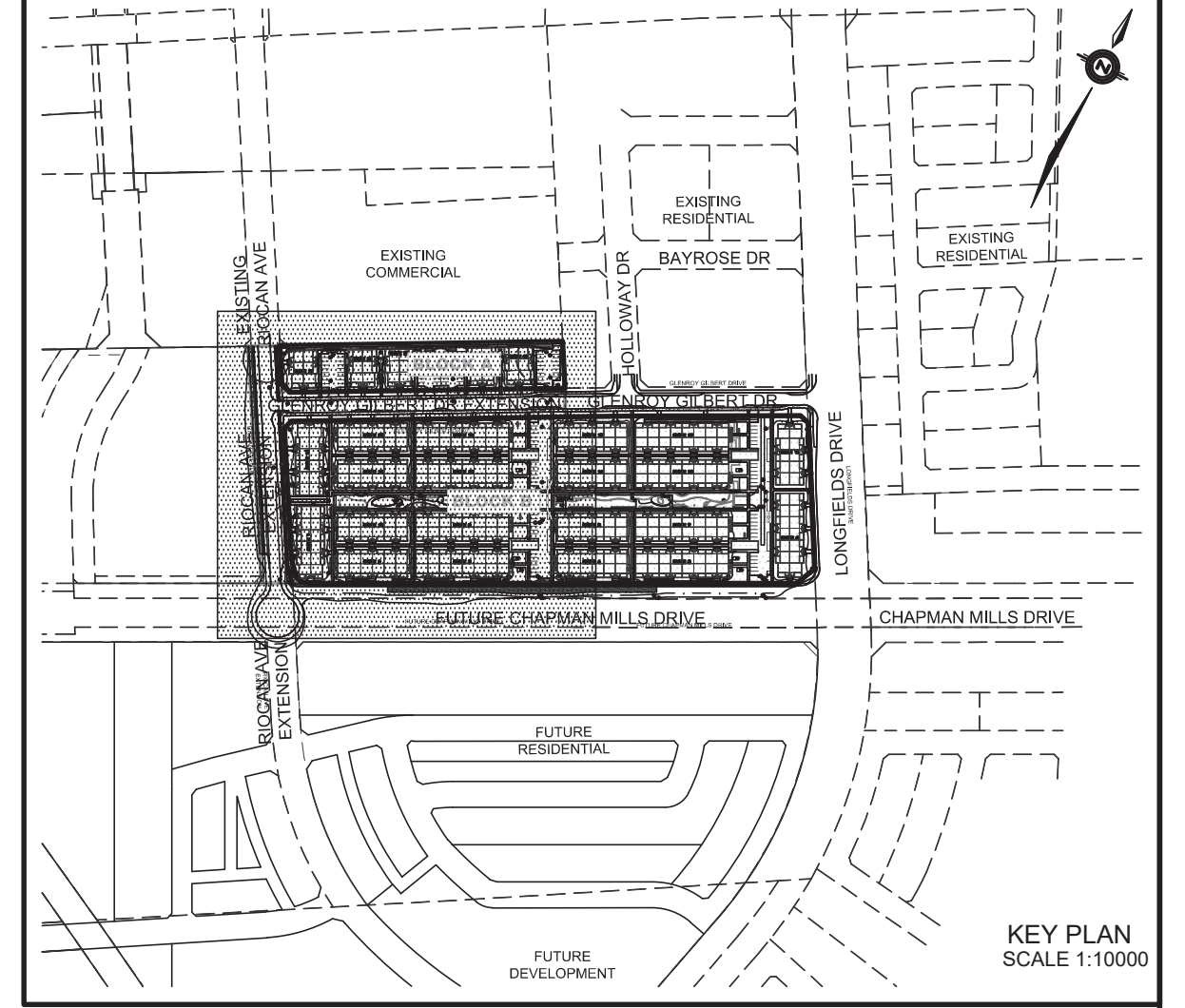

NOT FOR CONSTRUCTION

No.	BY	DATE	DESCRIPTION
8	S.L.M.	24-03-18	UPDATED LEGAL LINES
7	S.L.M.	24-02-04	5TH SUBMISSION
6	S.L.M.	23-10-06	4TH SUBMISSION
5	S.L.M.	23-09-22	ISSUED FOR TENDER

TOPOGRAPHIC INFORMATION
TOPOGRAPHIC INFORMATION PROVIDED BY STANTEC GEOMATICS LTD., PROJECT No. 161614291-111, DATED MARCH 1, 2022

SITE PLAN INFORMATION
SITE PLAN PROVIDED BY SRN ARCHITECTS LTD., PROJECT No. S21001, DATED DECEMBER 14, 2023

LEGAL INFORMATION
CALCULATED DRAFT PLAN PROVIDED BY STANTEC GEOMATICS LTD., PROJECT No. 161614291-132, RECEIVED MARCH 13, 2024

BENCH MARK
ELEVATIONS ARE REFERRED TO THE CANADIAN GEODETIC VERTICAL DATUM (CGVD-1928/1978) AND ARE DERIVED FROM BENCHMARK MONUMENT No. 19653007171, HAVING A PUBLISHED ELEVATION OF 99.742 METRES

MINTO COMMUNITIES INC.
BARRHAVEN TOWN CENTRE STAGE 1

Ottawa
110 Laurier Ave W
Ottawa, Ontario, K1P 1J1
Tel. (613) 580-2400
www.Ottawa.ca

GENERAL PLAN WEST

DRAWN BY: AM	CHECKED BY: BC	PROJECT No. 15-816
DESIGNED BY: BC	CHECKED BY: SM	SHEET No. 4
SCALE: 1:400		

LILY XU, MCIP, RPP
3rd MANAGER, DEVELOPMENT REVIEW SOUTH
PLANNING, INFRASTRUCTURE & ECONOMIC DEVELOPMENT DEPARTMENT, CITY OF OTTAWA

APPROVED
By Lily Xu at 11:54 am, Apr 03, 2024

CITY PLAN No. 18822
CITY FILE No. D07-12-22-0104