

**NOTE:**  
ALL WATERMAIN CONNECTIONS AND DECOMMISSIONING OF EXISTING WATERMANS TO BE COMPLETED BY CITY FORCES. TRENCH BACKFILL/REINSTATEMENT TO BE COMPLETED BY THE CONTRACTOR TO THE SATISFACTION OF THE CITY OF OTTAWA.

**NOTE-RE: TEST PIT/BOREHOLE EXCAVATIONS**  
ANY DISTURBED MATERIAL ENCOUNTERED BELOW THE SUBGRADE LEVEL WITHIN A BUILDING FOOTPRINT TO BE SUB-EXCAVATED AND BACKFILLED WITH COMPACTED ENGINEERED FILL AS PER GEOTECHNICAL ENGINEERS RECOMMENDATION.

**CONTRACTOR TO VERIFY THE PRECISE LOCATIONS AND INVERT ELEVATIONS OF EX. UNDERGROUND SERVICES AND EX UTILITIES PRIOR TO STARTING CONSTRUCTION**

**NOTE:**  
FOR WATERMAIN CROSSING BELOW AND ABOVE SEWERS, REFER TO CITY STD. W25 AND W25.2, RESPECTIVELY, WHERE APPLICABLE

**NOTE:**  
ENTRANCES TO PRIVATE SITE PER SC7.1

**ANY DISTURBED AREA DURING CONSTRUCTION TO BE RESTORED TO THE ORIGINAL CONDITION OR BETTER TO THE SATISFACTION OF THE AUTHORITIES HAVING JURISDICTION**

**NOTE:**  
FOR WATERMAIN STUDS, 2.4m MIN. COVER TO BE PROVIDED

**NOTE:**  
WATER AND SANITARY SERVICES TO BE SLEEVED UNDER U/G STORAGE TANKS

**NOTE:**  
FOR FOUNDATION SERVICES, CONNECT 250P PVC PIPE TO STORM MAIN AT OVB SLOPING AT 1.0% UNLESS OTHERWISE NOTED.

**NOTE:**  
ALL EXISTING TREES, SHRUBS ETC. WITHIN LOTS, BLOCKS AND ROADS TO BE REMOVED, UNLESS OTHERWISE NOTED

**NOTE:**  
FOR HOUSE CONNECTIONS INSTALLED UNDER DRIVEWAYS, SLEEVE SHALL BE USED

**PERMISSION REQUIRED FOR WORK ON ADJACENT LANDS**

**NOTE: RE: WATERMAIN / WATER SERVICE**  
1. INSULATION REQUIRED FOR WATERMAIN / WATER SERVICE WHERE THE SEPARATION BETWEEN WATERMAIN / WATER SERVICE AND OTHER SERVICES AND STRUCTURES IS LESS THAN 1.2m AND THE COVER IS LESS THAN 2.4m. REFER TO CITY STD. W23 FOR DETAIL.  
2. FOR SERVICE INSTALLATION AT SEWER CROSSING, REFER TO CITY STD. W38 FOR DETAIL.

**NOTE: ICD**  
FOR CATCHBASIN INFO AND ICD INFORMATION, REFER TO DRAWING No. 3 FOR DETAIL.

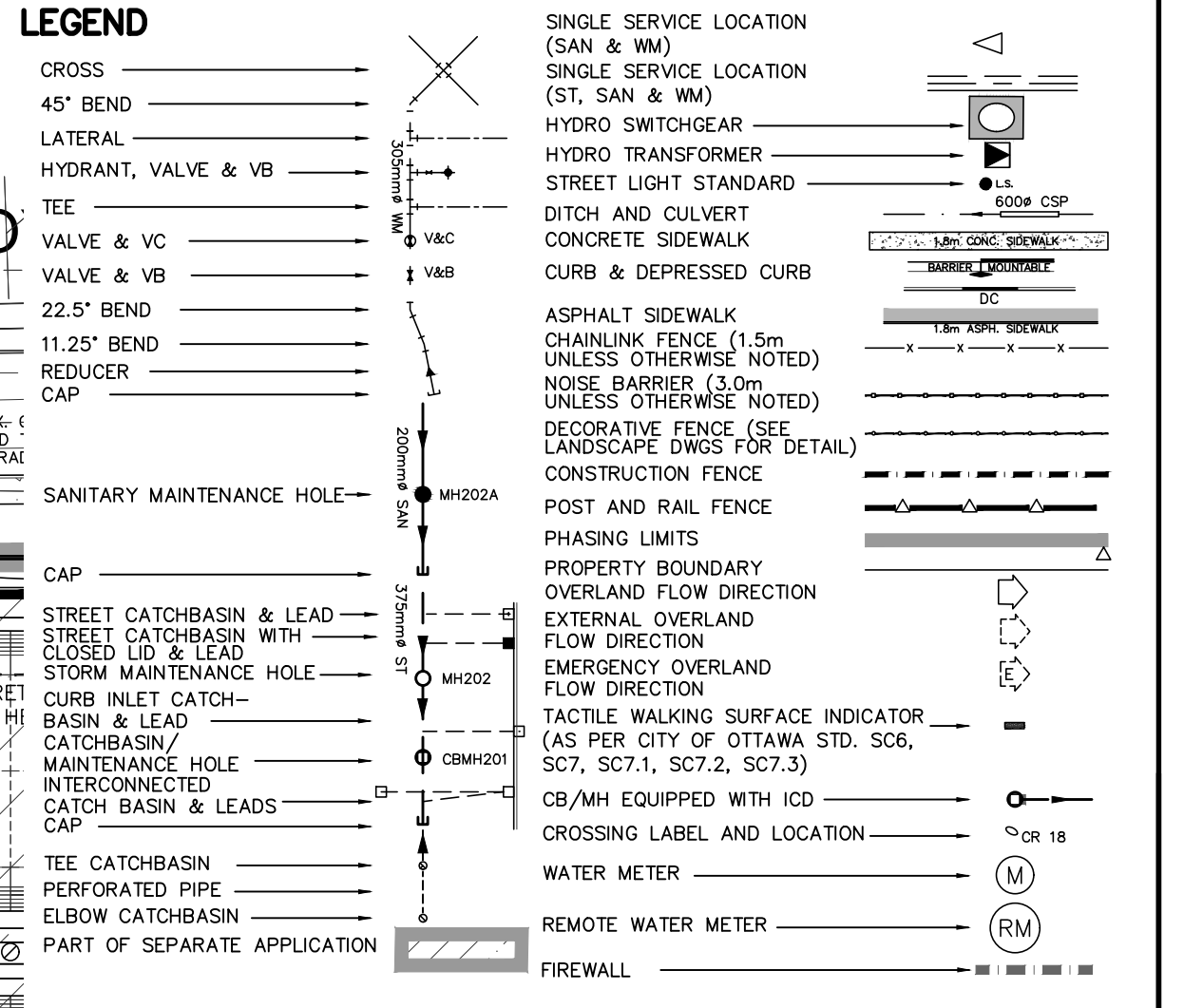
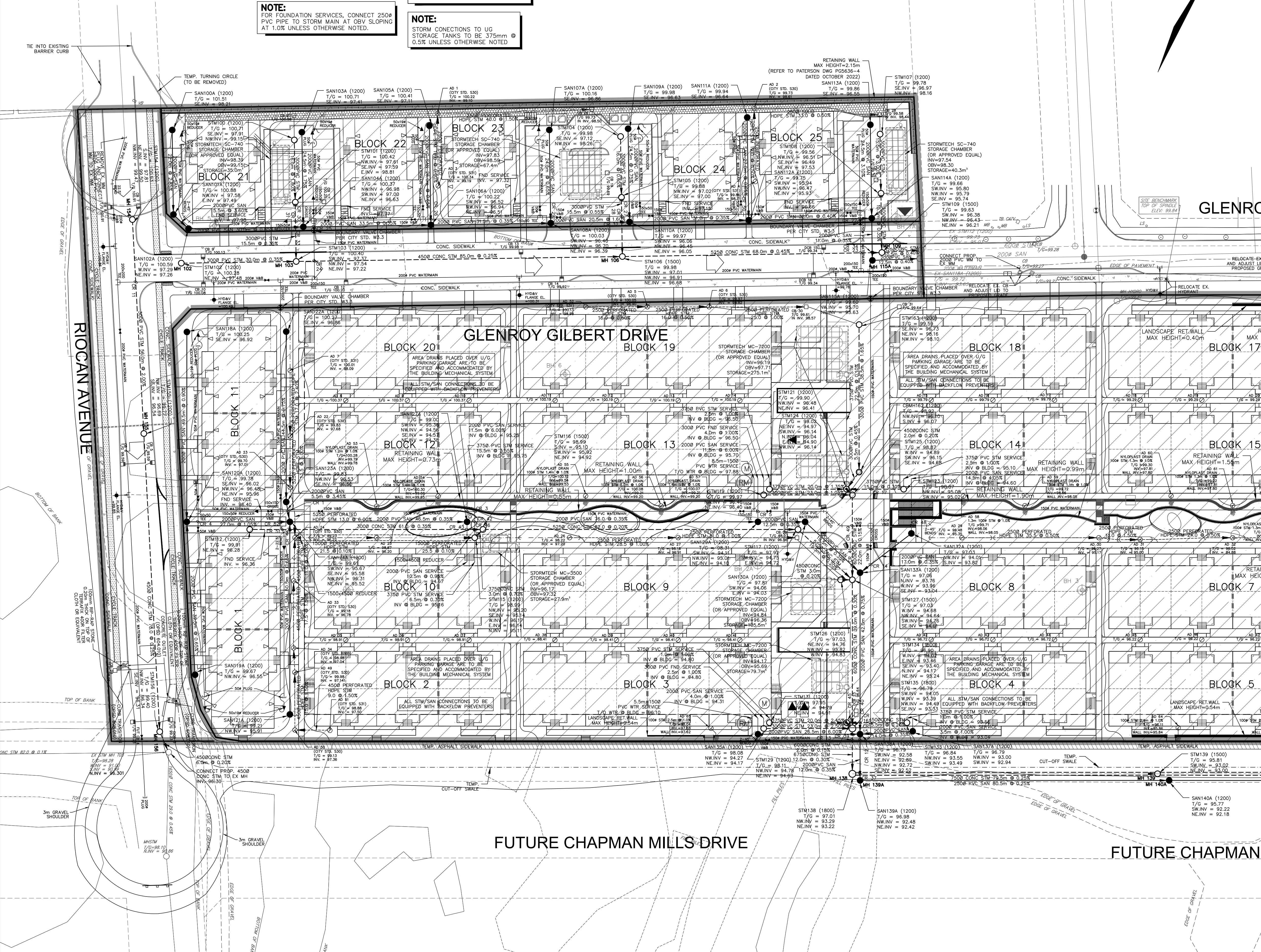
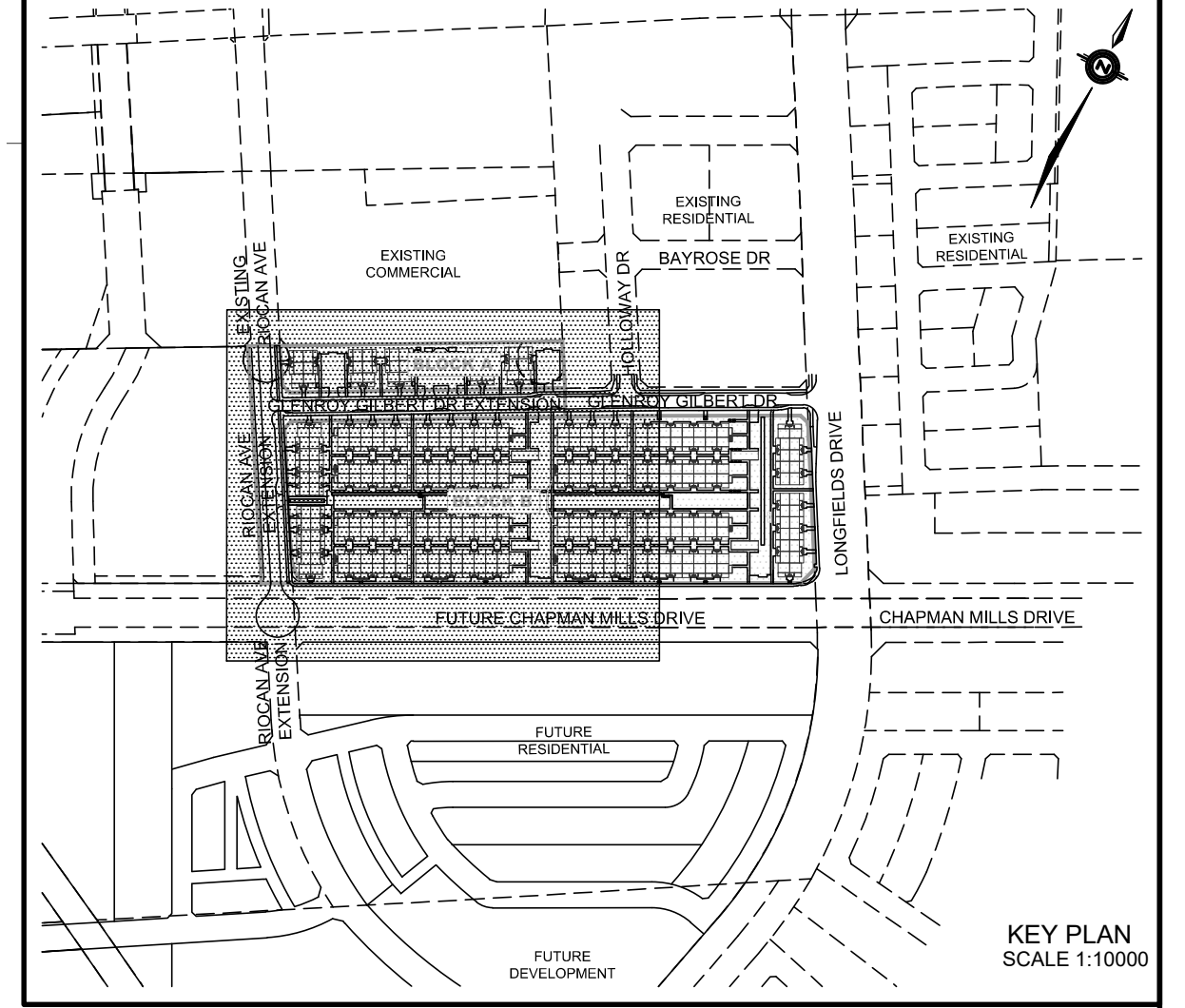

**NOT FOR CONSTRUCTION**

No.	BY	DATE	DESCRIPTION
6	S.L.M.	23-10-08	ISSUED FOR TENDER
5	S.L.M.	23-09-22	ISSUED FOR TENDER
4	S.L.M.	23-09-06	ISSUED FOR TENDER
3	S.L.M.	23-06-30	3RD SUBMISSION

**TOPOGRAPHIC INFORMATION**  
TOPOGRAPHIC INFORMATION PROVIDED BY STANTEC GEOMATICS LTD., PROJECT No. 161614291-111, DATED MARCH 1, 2022

**SITE PLAN INFORMATION**  
SITE PLAN PROVIDED BY SRN ARCHITECTS LTD., PROJECT No. S21001, DATED OCTOBER 5, 2023

**LEGAL INFORMATION**  
CALCULATED DRAFT PLAN PROVIDED BY STANTEC GEOMATICS LTD., PROJECT No. 161614291-131, DATED AUGUST 9, 2023

**BENCH MARK**  
ELEVATIONS ARE REFERRED TO THE CANADIAN GEODETIC VERTICAL DATUM (CGVD-1928:1978) AND ARE DERIVED FROM BENCHMARK MONUMENT No. 196530071\*, HAVING A PUBLISHED ELEVATION OF 99.742 METRES

**MINTO COMMUNITIES INC.**  
BARRHAVEN TOWN CENTRE  
GLENROY GILBERT DRIVE RIOCAN AVENUE & CHAPMAN MILLS DRIVE EXTENSION



**DSEL**  
120 Ier Road Unit 103  
Slittsville, Ontario, K2S 1E9  
Tel. (613) 836-0856  
Fax. (613) 836-7183  
www.DSEL.ca

**Ottawa**  
110 Laurier Ave W  
Ottawa, Ontario, K1P 1J1  
Tel. (613) 580-2400  
www.Ottawa.ca

**CITY ROW GENERAL PLAN WEST**

DRAWN BY: AM	CHECKED BY: BC	PROJECT No. 15-816
DESIGNED BY: BC	CHECKED BY: SM	SHEET No. 4
SCALE: 1:500		

CITY PLAN No. 18822  
CITY FILE No. D07-12-22-0104