

GENERAL NOTES:

1. ALL WORK TO CONFORM TO THE LATEST CITY OF OTTAWA STANDARD DRAWINGS AND SPECIFICATIONS AS WELL AS THE LATEST ONTARIO PROVINCIAL STANDARD DRAWINGS AND SPECIFICATIONS.
2. UNLESS INDICATED OTHERWISE, ALL WORK WITHIN THE CITY RIGHT-OF-WAY SHALL BE UNDERTAKEN IN ACCORDANCE WITH CITY OF OTTAWA DESIGN STANDARDS AND SPECIFICATION. ONTARIO PROVINCIAL STANDARDS MAY BE SUBJECT TO THE APPROVAL OF THE CITY OF OTTAWA. BE USED WHERE NO STANDARD OR SPECIFICATION IS NOTED.
3. ANY DISCREPANCIES BETWEEN SITE CONDITIONS AND THE DRAWINGS MUST BE REPORTED TO THE CONSULTANT PRIOR TO COMMENCEMENT OF CONSTRUCTION AND APPROPRIATE ACTION TAKEN TO THE SATISFACTION OF THE CITY OF OTTAWA.
4. SIDEWALK SPACE TO MAINTAIN A MINIMUM 2.0M PEDESTRIAN CLEARWAY.
5. THE CONTRACTOR SHALL REVIEW ALL DRAWINGS AND SPECIFICATIONS TO DETERMINE THE TOTAL SCOPE OF WORK AND ALL REQUIRED COORDINATIONS.

6. THE CONTRACTOR IS RESPONSIBLE FOR A THOROUGH SITE EXAMINATION TO SATISFY HIM OR HERSELF AS TO THE ACTUAL SITE CONDITIONS PRIOR TO SUBMISSION OF BIDS.
7. CONTRACTOR SHALL VERIFY ALL EXISTING UTILITY LOCATIONS PRIOR TO EXCAVATION.
8. ALL PROPOSED WORK LINES ARE PARALLEL OR PERPENDICULAR TO THE LINES FROM WHICH THEY ARE MEASURED UNLESS OTHERWISE NOTED.
9. THE CONTRACTOR SHALL BE RESPONSIBLE FOR DOCUMENTING THE LOCATIONS OF ALL SITE ELEMENTS TO BE RESET IN THEIR SAME HORIZONTAL LOCATION.
10. ANY AREA OUTSIDE THE LIMIT OF WORK THAT IS DISTURBED SHALL BE RESTORED TO ITS ORIGINAL CONDITION BY THE CONTRACTOR AT NO COST TO THE OWNER.
11. REQUIRED SHOP DRAWINGS SHALL BE BASED ON FIELD MEASUREMENT AND LAYOUT VERIFICATION BY THE CONTRACTOR.

12. ALL LINE AND GRADE WORK AS PER DRAWINGS AND SPECIFICATIONS SHALL BE LAID OUT BY A REGISTERED CIVIL ENGINEER OR SURVEYOR ENGAGED BY THE GENERAL CONTRACTOR.
13. STORAGE AREAS FOR CONTRACTOR'S EQUIPMENT AND MATERIALS SHALL BE IN AND WITHIN LIMITS OF WORK AS SHOWN ON PLANS AND AS APPROVED BY THE LANDSCAPE ARCHITECT.
14. REFER TO CIVIL DRAWING FOR GRADING AND SERVICING PLANS

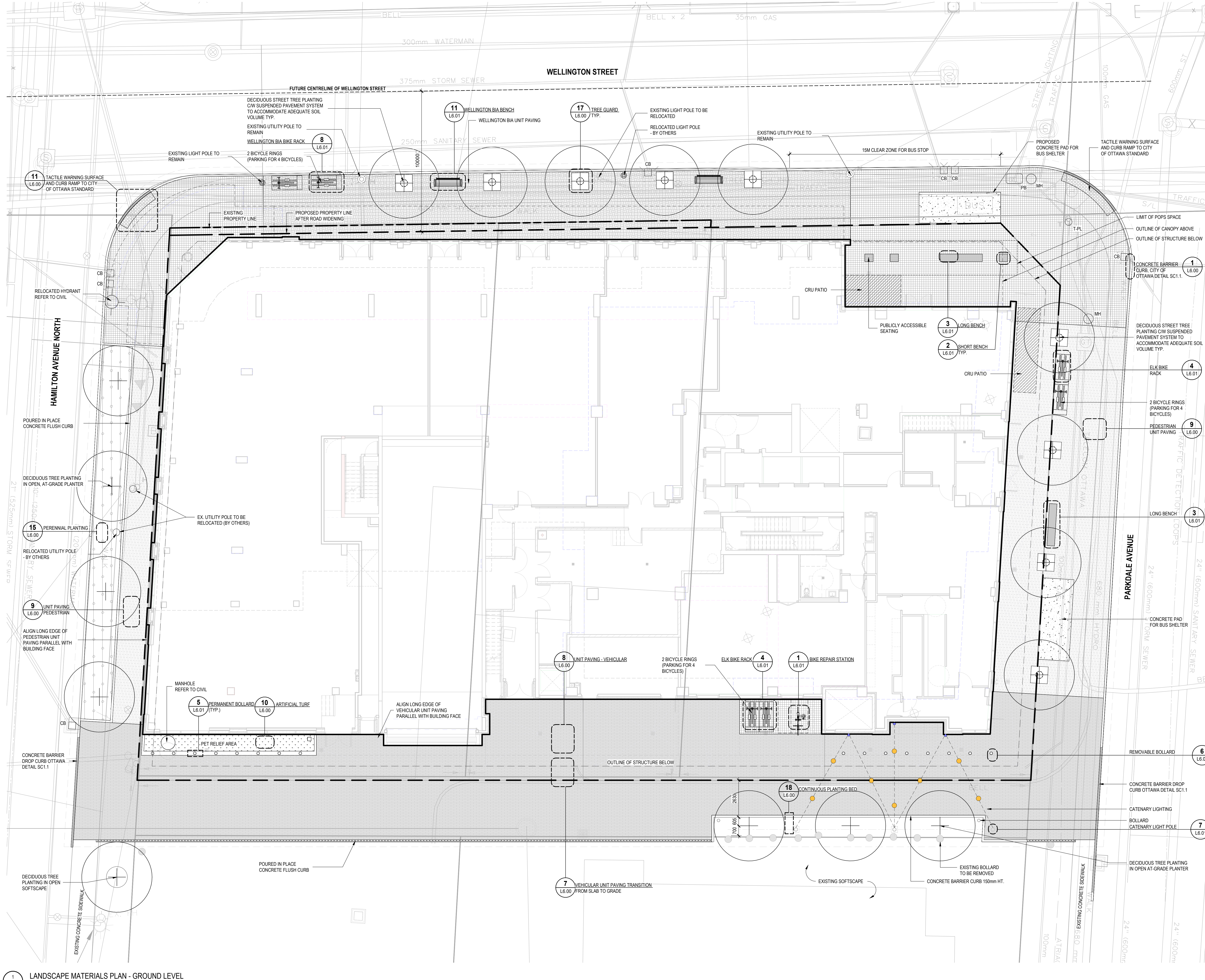

1 LANDSCAPE MATERIALS PLAN - GROUND LEVEL
SCALE: 1:100

SITE SYMBOL LEGEND

- PROPERTY LINE
- OVERHEAD CANOPY
- UNDERGROUND STRUCTURE
- BUILDING BOUNDARY
- UNIT PAVING - PEDESTIAN
AVENUE 100 PAVEMENT BY BOLDUC
100 X 100 X 40 mm
- UNIT PAVING - VEHICULAR
AVENUE 100 RL PAVEMENT BY BOLDUC
100 X 100 X 40 mm
- ACCENT UNIT PAVING - PEDESTRIAN
HEXAGON 80 PAVEMENT BY BOLDUC
80 X 200 X 230 mm
- WELLINGTON STREETSCAPE
BIA PAVING
- CONCRETE PAVING
- WOOD DECKING
BENCHMARK ASH DECKING 1X4
GROOVED BY THERMOXY
- TACTILE SURFACE
- PLANTING BED
- SOD
- FLUSH CURB
- CRU PATIO

- BIKE RACK
- UTILITY POLE
- LIGHT POLE
- BOLLARD
- PROPOSED TREE
- WOOD BENCH
- WELLINGTON WEST BIA BENCH
- TREE GUARD

DIALOG®

ISSUED FOR

- 1 2021-06-25 ISSUED FOR OPAZBLA
- 2 2021-11-19 RE-ISSUED FOR OPAZBLA
- 3 2022-06-30 ISSUED FOR SPA
- 4 2022-12-09 ISSUED FOR SPA
- 5 2023-04-06 ISSUED FOR SPA
- 6 2023-09-15 ISSUED FOR 33% DD
- 7 2023-12-08 ISSUED FOR 66% DD
- 8 2024-06-20 ISSUED FOR BUILDING PERMIT
- 9 2024-09-20 ISSUED FOR 99% TENDER
- 10 2024-09-27 ISSUED FOR TENDER
- 11 2024-11-08 RE-ISSUED FOR SPA
- 12 2024-11-21 ISSUED FOR FINAL SPA
- 13 2024-11-29 ISSUED FOR FINAL SPA
- 14 2024-11-29 ISSUED FOR BUILDING PERMIT
- 15 2025-03-10 ISSUED FOR FINAL SPA REGISTRATION

METRIC

THIS DRAWING IS COPYRIGHTED AND MUST NOT BE USED, REPRODUCED, OR REVISED WITHOUT WRITTEN PERMISSION. ALL DIMENSIONS ARE IN MILLIMETERS UNLESS OTHERWISE NOTED. VERIFY DIMENSIONS. DO NOT SCALE THIS DRAWING. REPORT INCONSISTENCIES AND OMISSIONS TO THE CONSULTANT FOR CLARIFICATION BEFORE COMMENCING WITH THE WORK. DEVIATIONS FROM THE CONTRACT DOCUMENTS WITHOUT WRITTEN APPROVAL FROM THE CONSULTANT ARE SUBJECT TO CORRECTION AT THE CONTRACTOR'S EXPENSE.

CLIENT

WELLDALE LIMITED PARTNERSHIP
200-180 KENT STREET
OTTAWA, ON K1P 0B6
Tel: 613-230-7051

ARCHITECT

DIALOG
35 JOHN STREET #500
TORONTO, ON M5V 3G6
Tel: 416-966-0220

URBAN PLANNER

POTEN
396 COOPER ST. SUITE 300
OTTAWA, ON K2P 2H7
Tel: 613-230-5728

LANDSCAPE ARCHITECT

DIALOG
35 JOHN STREET #500
TORONTO, ON M5V 3G6
Tel: 416-966-0220

ENVIRONMENTAL/GEOTECHNICAL

TERRAPIN CONSULTANTS
20 GURDWARA ROAD, UNIT 1
OTTAWA, ON K2E 6B3
Tel: 613-745-6471

HERITAGE CONSULTANT

MTBA
222 LAURIER AVENUE EAST, STUDIO 201
OTTAWA, ON K1N 6P2
Tel: 613-244-2323

CIVIL ENGINEER

DESL
120 BER ROAD, SUITE 103
OTTAWA, ON K2S 1E9
Tel: 613-836-0556

TRAFFIC CONSULTANT

CGH TRANSPORTATION
6 PLAZA COURT
OTTAWA, ON K2H 7W1
Tel: 613-697-3797

SURVEY

STANTEC
1331 CLYDE AVE. SUITE 400
OTTAWA, ON K2C 3G4
Tel: 613-722-4400

NOISE/WIND CONSULTANT

GRADIENT WIND
127 WALGREEN ROAD
OTTAWA, ON K0A 1L0
Tel: 613-836-0934

KEYPLAN

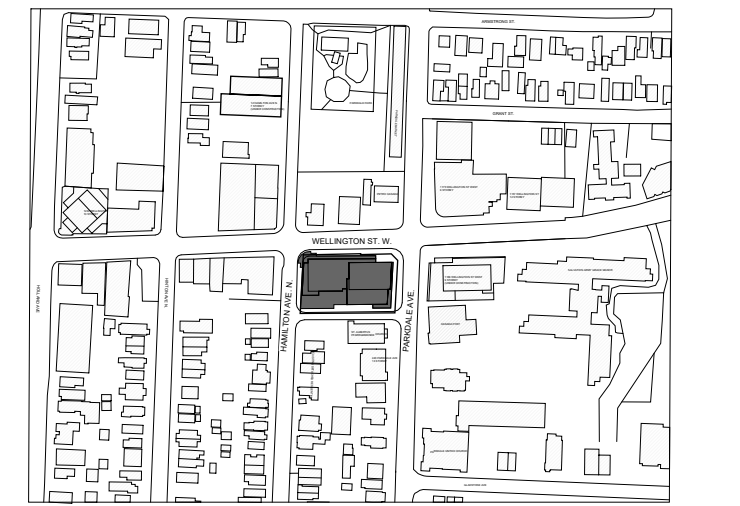

SEAL

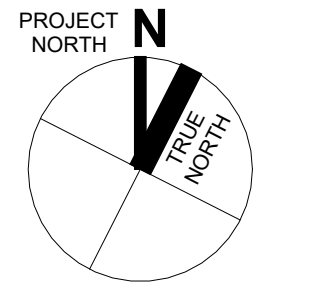

1186-1194
WELLINGTON ST W

1186-1194 Wellington St W
Ottawa, ON K1Y 2Z5

LANDSCAPE
MATERIALS PLAN -
GROUND LEVEL

DRAWN: AC/EB CHECKED: BM
PLOT DATE: 3/10/2025 1:42:16 PM

L1.00

ON100020 - WELLINGTON

CITY PLAN No.: 18573
CITY FILE No.: D07-12-22-0150

ANDREW MCCREIGHT
MANAGER, DEVELOPMENT REVIEW CENTRAL
PLANNING, DEVELOPMENT & BUILDING SERVICES
DEVELOPMENT DEPARTMENT, CITY OF OTTAWA

APPROVED
By Andrew McCreight at 12:27 pm, Mar 13, 2025

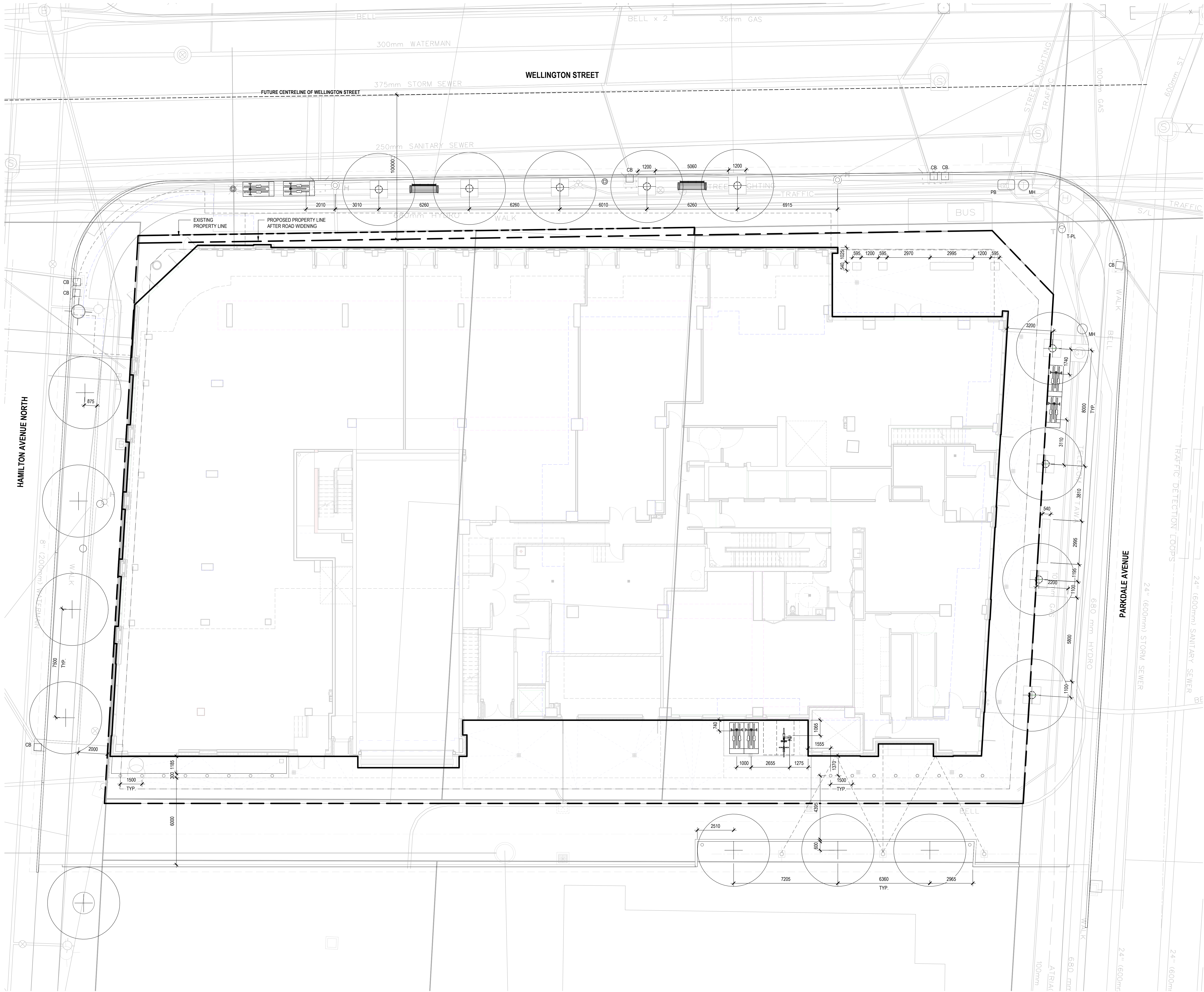

SITE SYMBOL LEGEND

- PROPERTY LINE
- OVERHEAD CANOPY
- UNDERGROUND STRUCTURE
- BUILDING BOUNDARY

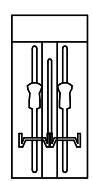

UTILITY POLE

LIGHT POLE

BOLLARD

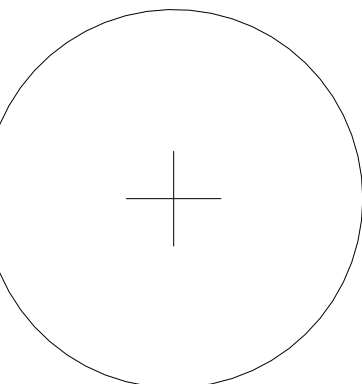

PROPOSED TREE

WOOD BENCH



WELLINGTON WEST BIA BENCH

TREE GUARD

EXISTING CATCH BASIN

EXISTING MANHOLE

EXISTING PULLBOX

EXISTING TRAFFIC POLE

EXISTING LIGHT POLE

EXISTING HYDRANT



ANDREW MCCREIGHT
MANAGER, DEVELOPMENT REVIEW CENTRAL
PLANNING, DEVELOPMENT & BUILDING SERVICES
DEVELOPMENT DEPARTMENT, CITY OF OTTAWA

APPROVED
By Andrew McCreight at 12:27 pm, Mar 13, 2025

GENERAL NOTES:

- ALL WORK TO CONFORM TO THE LATEST CITY OF OTTAWA STANDARD DRAWINGS AND SPECIFICATIONS AS WELL AS THE LATEST ONTARIO PROVINCIAL STANDARD DRAWINGS AND SPECIFICATIONS.
- UNLESS INDICATED OTHERWISE, ALL WORK WITHIN THE CITY RIGHT OF WAY SHALL BE UNDERTAKEN IN ACCORDANCE WITH CITY OF OTTAWA DESIGN STANDARDS AND SPECIFICATION, ONTARIO PROVINCIAL STANDARDS MAY, SUBJECT TO THE APPROVAL OF THE CITY OF OTTAWA, BE USED WHERE NO STANDARD OR SPECIFICATION IS NOTED.
- ANY DISCREPANCIES BETWEEN SITE CONDITIONS AND THE DRAWINGS MUST BE REPORTED TO THE CONSULTANT PRIOR TO COMMENCEMENT OF CONSTRUCTION AND APPROPRIATE ACTION TAKEN TO THE SATISFACTION OF THE CITY OF OTTAWA.
- SIDEWALK SPACE TO MAINTAIN A MINIMUM 2.0M PEDESTRIAN CLEARWAY.
- THE CONTRACTOR SHALL REVIEW ALL DRAWINGS AND SPECIFICATIONS TO DETERMINE THE TOTAL SCOPE OF WORK AND ALL REQUIRED COORDINATIONS.
- THE CONTRACTOR IS RESPONSIBLE FOR A THOROUGH SITE EXAMINATION TO SATISFY HIM OR HERSELF AS TO THE ACTUAL SITE CONDITIONS PRIOR TO SUBMISSION OF BIDS.
- CONTRACTOR SHALL VERIFY ALL EXISTING UTILITY LOCATIONS PRIOR TO EXCAVATION.
- ALL PROPOSED WORK LINES ARE PARALLEL OR PERPENDICULAR TO THE LINES FROM WHICH THEY ARE MEASURED UNLESS OTHERWISE NOTED.
- THE CONTRACTOR SHALL BE RESPONSIBLE FOR DOCUMENTING THE LOCATIONS OF ALL SITE ELEMENTS TO BE RESET IN THEIR SAME HORIZONTAL LOCATION.
- ANY AREA OUTSIDE THE LIMIT OF WORK THAT IS DISTURBED SHALL BE RESTORED TO ITS ORIGINAL CONDITION BY THE CONTRACTOR AT NO COST TO THE OWNER.
- REQUIRED SHOP DRAWINGS SHALL BE BASED ON FIELD MEASUREMENT AND LAYOUT VERIFICATION BY THE CONTRACTOR.
- ALL LINE AND GRADE WORK AS PER DRAWINGS AND SPECIFICATIONS SHALL BE LAID OUT BY A REGISTERED CIVIL ENGINEER OR SURVEYOR, ENGAGED BY THE GENERAL CONTRACTOR.
- STORAGE AREAS FOR CONTRACTOR'S EQUIPMENT AND MATERIALS SHALL BE IN AND WITHIN LIMITS OF WORK AS SHOWN ON PLANS AND AS APPROVED BY THE LANDSCAPE ARCHITECT.
- REFER TO CIVIL DRAWING FOR GRADING AND SERVICING PLANS

ISSUED FOR

- | | | |
|----|------------|-----------------------------------|
| 8 | 2024-08-20 | ISSUED FOR BUILDING PERMIT |
| 9 | 2024-09-20 | ISSUED FOR 99% TENDER |
| 10 | 2024-09-27 | ISSUED FOR TENDER |
| 11 | 2024-11-08 | RE-ISSUED FOR SPA |
| 12 | 2024-11-21 | ISSUED FOR FINAL SPA |
| 13 | 2024-11-29 | ISSUED FOR FINAL SPA |
| 14 | 2024-11-29 | ISSUED FOR BUILDING PERMIT |
| 15 | 2025-03-10 | ISSUED FOR FINAL SPA REGISTRATION |

METRIC

THIS DRAWING IS COPYRIGHTED AND MUST NOT BE USED, REPRODUCED, OR REVISED WITHOUT WRITTEN PERMISSION. NOTED: VERIFY DIMENSIONS. DO NOT SCALE THIS DRAWING. REPORT INCONSISTENCIES AND OMISSIONS TO THE CONSULTANT FOR CLARIFICATION BEFORE COMMENCING WITH THE WORK. DEVIATIONS FROM THE CONTRACT DOCUMENTS WITHOUT WRITTEN APPROVAL FROM THE CONSULTANT ARE SUBJECT TO CORRECTION AT THE CONTRACTOR'S EXPENSE.

CLIENT

WELLDAL LIMITED PARTNERSHIP
200-180 KENT STREET
OTTAWA, ON K1P 0B6
Tel: 613-230-7051

ARCHITECT

DIALOG
35 JOHN STREET #500
TORONTO, ON M5V 3G6
Tel: 416-966-0220

URBAN PLANNER

POTEN
396 COOPER ST. SUITE 300
OTTAWA, ON K2P 2H7
Tel: 613-730-5795

LANDSCAPE ARCHITECT

DIALOG
35 JOHN STREET #500
TORONTO, ON M5V 3G6
Tel: 416-966-0220

ENVIRONMENTAL/GEOTECHNICAL

TERRAPIN ENVIRONMENTAL
20 GURDWARA ROAD, UNIT 1
OTTAWA, ON K2E 1B3
Tel: 613-745-6471

HERITAGE CONSULTANT

MTBA
22 LAURIER AVENUE EAST, STUDIO 201
OTTAWA, ON K1N 6P2
Tel: 613-244-2323

CIVIL ENGINEER

DEL
120 BIER ROAD, SUITE 103
OTTAWA, ON K2C 3G4
Tel: 613-836-0559

TRAFFIC CONSULTANT

CGH TRANSPORTATION
6 PLAZA COURT
OTTAWA, ON K2H 7W1
Tel: 613-697-3797

SURVEY

STATCO
1331 CLYDE AVE. SUITE 400
OTTAWA, ON K2C 3G4
Tel: 613-732-4400

NOISE/WIND CONSULTANT

GRADIENT WIND
127 WALGREEN ROAD
OTTAWA, ON K0A 1L0
Tel: 613-836-0934

KEYPLAN

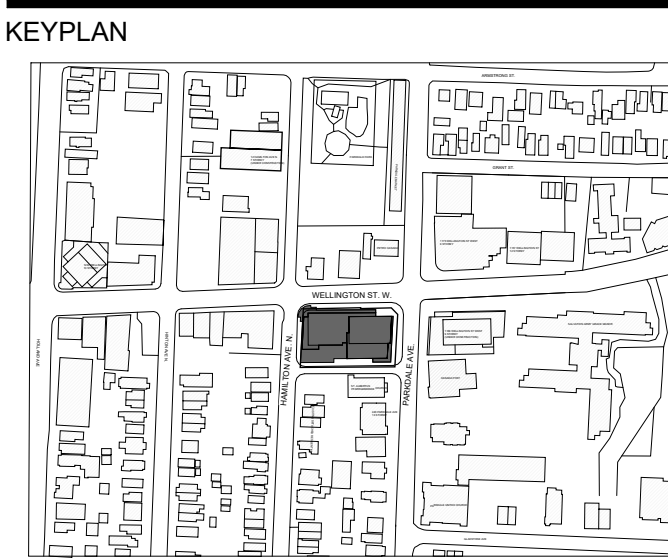

SEAL

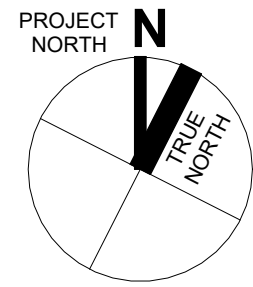

1186-1194
WELLINGTON ST W

1186-1194 Wellington St W
Ottawa, ON K1Y 2Z5

LANDSCAPE
LAYOUT & COMPOSITE
UTILITY PLAN

DRAWN: Author CHECKED: Checker

PLOT DATE: 3/10/2025 1:42:19 PM

L2.00

ON100020 - WELLINGTON

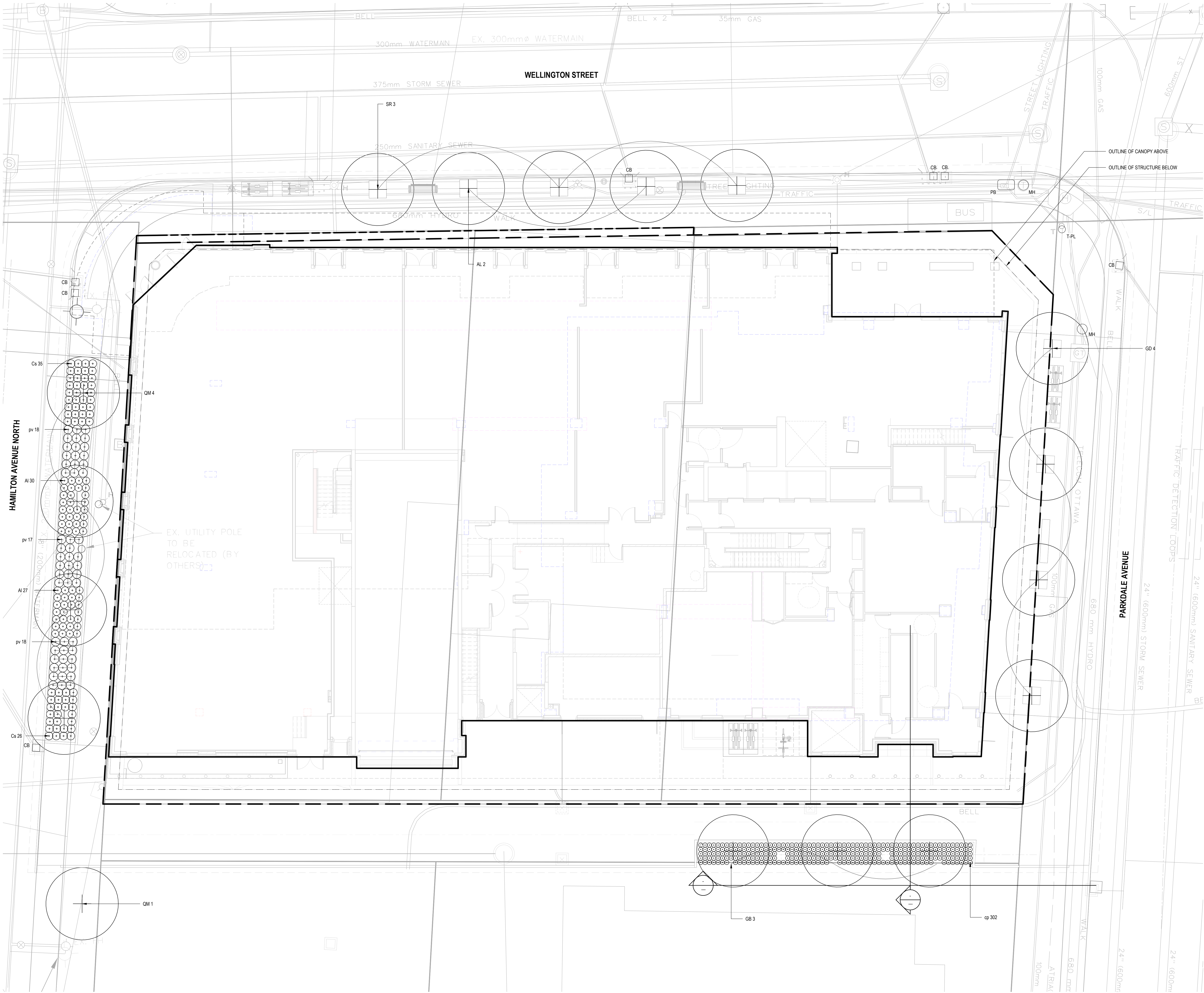

SITE SYMBOL LEGEND

- PROPERTY LINE
OVERHEAD CANOPY
UNDERGROUND STRUCTURE
BUILDING BOUNDARY
- BIKE RACK
LIGHT POLE
BOLLARD
PROPOSED TREE
PROPOSED SHRUB & PERENNIAL
EXISTING CATCH BASIN
EXISTING MANHOLE
EXISTING PULLBOX
EXISTING TRAFFIC POLE
EXISTING LIGHT POLE
EXISTING HYDRANT

ISSUED FOR

- 1 2021-06-25 ISSUED FOR OPA/ZBLA
2 2021-11-19 RE-ISSUED FOR OPA/ZBLA
3 2022-06-30 ISSUED FOR SPA
4 2022-12-09 ISSUED FOR SPA
5 2023-04-06 ISSUED FOR SPA
6 2023-09-15 ISSUED FOR 33% DD
7 2023-12-08 ISSUED FOR 66% DD
8 2024-08-20 ISSUED FOR BUILDING PERMIT
9 2024-09-20 ISSUED FOR 99% TENDER
10 2024-09-27 ISSUED FOR TENDER
11 2024-11-08 RE-ISSUED FOR SPA
12 2024-11-21 ISSUED FOR FINAL SPA
13 2024-11-29 ISSUED FOR FINAL SPA
14 2024-11-29 ISSUED FOR BUILDING PERMIT
15 2025-03-10 ISSUED FOR FINAL SPA REGISTRATION

METRIC

THIS DRAWING IS COPYRIGHTED AND MUST NOT BE USED, REPRODUCED, OR REVISED WITHOUT WRITTEN PERMISSION.
ALL DIMENSIONS ARE IN MILLIMETERS UNLESS OTHERWISE NOTED.
VERIFY DIMENSIONS.
DO NOT SCALE THIS DRAWING.
REPORT INCONSISTENCIES AND OMISSIONS TO THE CONSULTANT FOR CLARIFICATION BEFORE COMMENCING WITH THE WORK.
DEVIATIONS FROM THE CONTRACT DOCUMENTS WITHOUT WRITTEN APPROVAL FROM THE CONSULTANT ARE SUBJECT TO CORRECTION AT THE CONTRACTOR'S EXPENSE.

CLIENT

WELLDAL LIMITED PARTNERSHIP
200-180 KENT STREET
OTTAWA, ON K1P 0B6
Tel: 613-230-7051

ARCHITECT

DIALOG
35 JOHN STREET #500
TORONTO, ON M5V 3G6
Tel: 416-966-0220

URBAN PLANNER

396 COOPER ST. SUITE 300
OTTAWA, ON K2P 2H7
Tel: 613-730-5785

LANDSCAPE ARCHITECT

DIALOG
35 JOHN STREET #500
TORONTO, ON M5V 3G6
Tel: 416-966-0220

ENVIRONMENTAL/GEOTECHNICAL

TERRAPIN ENVIRONMENTAL
20 GURDWARA ROAD, UNIT 1
OTTAWA, ON K2E 6B3
Tel: 613-745-6471

HERITAGE CONSULTANT

MTBA
222 LAURIER AVENUE EAST, STUDIO 201
OTTAWA, ON K1N 6P2
Tel: 613-244-2323

CIVIL ENGINEER

DSEL
120 BEEB ROAD, SUITE 103
OTTAWA, ON K2G 1E9
Tel: 613-836-0556

TRAFFIC CONSULTANT

CGH TRANSPORTATION
6 PLAZA COURT
OTTAWA, ON K2H 7W1
Tel: 613-697-3797

SURVEY

STANTEC
1331 CLYDE AVE. SUITE 400
OTTAWA, ON K2C 3G4
Tel: 613-722-4400

NOISE/WIND CONSULTANT

GRADIENT WIND
127 WALGREEN ROAD
OTTAWA, ON K0A 1L0
Tel: 613-836-0934

KEYPLAN



SEAL

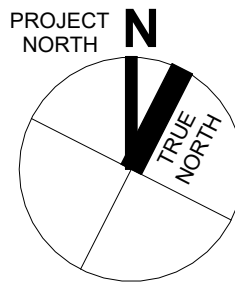

1186-1194
WELLINGTON ST W

1186-1194 Wellington St W
Ottawa, ON K1Y 2Z5

PLANTING PLAN

DRAWN: AC/EB
PLOT DATE: 3/10/2025 1:42:33 PM
CHECKED: BM

L3.00

ON100020 - WELLINGTON

PLANTING SCHEDULE						
KEY	BOTANICAL NAME	COMMON NAME	QTY	SPACING	SIZE	
TREE						
AL	Amelanchier laevis 'Cumulus'	Cumulus Serviceberry	2	AS SHOWN	50mm WB	
GB	Ginkgo biloba 'Autumn Gold'	Autumn Gold Manderhai Tree	3	AS SHOWN	50mm WB	
GD	Gymmodaidus dioica 'Espresso'	Espresso Kentucky Coffee Tree	4	AS SHOWN	50mm WB	
QM	Quercus macrocarpa	Burr Oak	5	AS SHOWN	50mm WB	
SR	Syringa reticulata 'Ivory Silk'	Ivory Silk Tree Lilac	5	AS SHOWN	50mm WB	
SHRUB						
AI	Aronia x Low Scape Mound	Low Scape Mound Chokeberry	57	450mm O.C.	30cm 2 gal	
Cs	Cornus sericea 'Kelsey'	Kelsey Red Osier Dogwood	61	500mm O.C.	50cm 3 gal	
PERENNIAL						
cp	Carex pensylvanica	Pennsylvania sedge	302	300mm O.C.	20cm 1 gal	
pv	Panicum virgatum 'Northwind'	Northwind Switch Grass	53	600mm O.C.	40cm 1 gal	
			TOTAL:490			

PLANTING NOTES:

1. PLANTING BEDS: CONTINUOUS 100mm MULCH AROUND TREES AND SHRUBS, 150mm AWAY FROM TREE TRUNKS OF NEW TREES. INSTALL CONTINUOUS DEPTH OF 450mm DEPTH OF PLANTING SOIL IN SHRUB BEDS.
2. SCARIFY SURFACE OF SUBSOIL PRIOR TO PLANTING.
3. PRUNING: PRUNE TREE AND SHRUB BRANCHES AS REQUIRED ONLY TO REMOVE DEAD OR DAMAGED BRANCHES AND AS DIRECTED BY LANDSCAPE ARCHITECT. DO NOT PRUNE OR DAMAGE LEADER. RETAIN NORMAL TREE/SHRUB FORM.
4. CUT AND REMOVE BURLAP FROM TOP 2/3 OF BURLAPPED TREE ROOTBALLS. CUT TWO RUNS OF WIRE FROM TOP OF WIRE BASKETS.
5. REMOVE SHRUBS FROM FIBRE POT.
6. TREE STAKES TO BE REMOVED AT THE END OF THE GUARANTEE PERIOD, PRIOR TO THE RELEASE OF THE LETTER OF CREDIT.
7. LIGHTLY COMPACT PLANTING SOIL MIX TO ELIMINATE AIR POCKETS AND PREVENT SETTLEMENT.
8. INSTALL PLASTIC RODENT GUARD TO BE WRAPPED AROUND TREE TRUNKS.
9. TREES TO BE WATERED WEEKLY DURING NON-DORMANT SEASONS THROUGHOUT THE 2-YEAR PLANTING WARRANTY PERIOD.

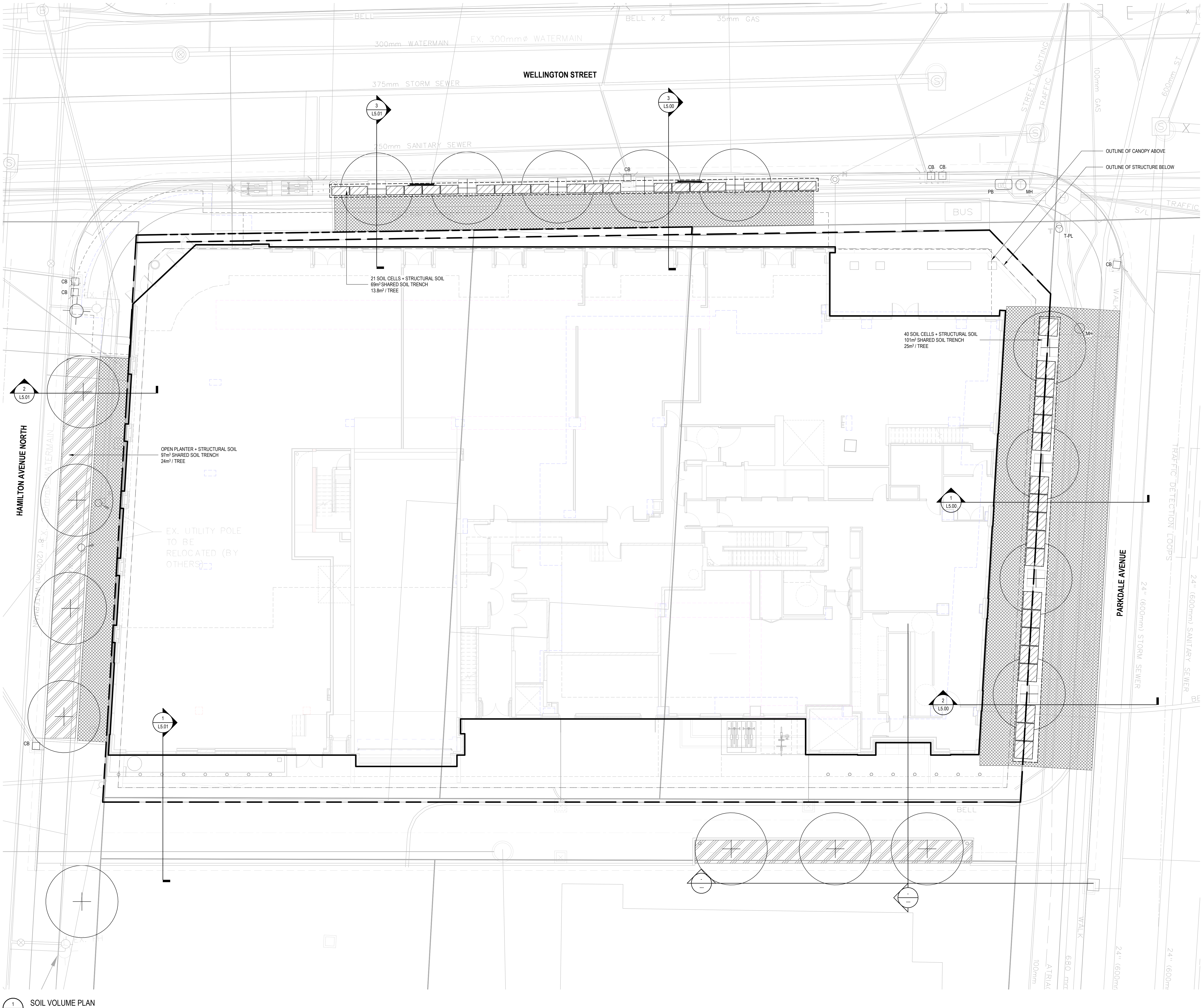

SITE SYMBOL LEGEND

	PROPERTY LINE
	OVERHEAD CANOPY
	UNDERGROUND STRUCTURE
	SOIL TRENCH
	BUILDING BOUNDARY
	STRUCTURAL SOIL
	PLANTING SOIL
	SOIL CELL
	BIKE RACK
	LIGHT POLE
	BOLLARD
	PROPOSED TREE
	EXISTING CATCH BASIN
	EXISTING MANHOLE
	EXISTING PULLBOX
	EXISTING TRAFFIC POLE
	EXISTING LIGHT POLE
	EXISTING HYDRANT

ISSUED FOR

1	2021-06-25	ISSUED FOR OPA/ZBLA
2	2021-11-19	RE-ISSUED FOR OPA/ZBLA
3	2022-06-30	ISSUED FOR SPA
4	2022-12-09	ISSUED FOR SPA
5	2023-04-06	ISSUED FOR SPA
6	2023-09-15	ISSUED FOR 33% DD
7	2023-12-08	ISSUED FOR 66% DD
8	2024-05-20	ISSUED FOR BUILDING PERMIT
9	2024-09-20	ISSUED FOR 99% TENDER
10	2024-09-27	ISSUED FOR TENDER
11	2024-11-08	RE-ISSUED FOR SPA
12	2024-11-21	ISSUED FOR FINAL SPA
13	2024-11-29	ISSUED FOR FINAL SPA
14	2024-11-29	ISSUED FOR BUILDING PERMIT
15	2025-03-10	ISSUED FOR FINAL SPA REGISTRATION

METRIC

THIS DRAWING IS COPYRIGHTED AND MUST NOT BE USED, REPRODUCED, OR REVISED WITHOUT WRITTEN PERMISSION. ALL DIMENSIONS ARE IN MILLIMETERS UNLESS OTHERWISE NOTED. VERIFY DIMENSIONS. DO NOT SCALE THIS DRAWING. REPORT INCONSISTENCIES AND OMISSIONS TO THE CONSULTANT FOR CLARIFICATION BEFORE COMMENCING WITH THE WORK. DEVIATIONS FROM THE CONTRACT DOCUMENTS WITHOUT WRITTEN APPROVAL FROM THE CONSULTANT ARE SUBJECT TO CORRECTION AT THE CONTRACTOR'S EXPENSE.

CLIENT

WELLDAL LIMITED PARTNERSHIP
200-180 KENT STREET
OTTAWA, ON K1P 0B6
Tel: 613-230-7051

ARCHITECT

DIALOG
35 JOHN STREET #500
TORONTO, ON M5V 3G6
Tel: 416-966-0220

URBAN PLANNER

POTEN
396 COOPER ST. SUITE 300
OTTAWA, ON K2P 2H7
Tel: 613-730-8789

LANDSCAPE ARCHITECT

DIALOG
35 JOHN STREET #500
TORONTO, ON M5V 3G6
Tel: 416-966-0220

ENVIRONMENTAL/GEOTECHNICAL

TERRAPIN ENVIRONMENTAL
20 GURDWARA ROAD, UNIT 1
OTTAWA, ON K2E 6B3
Tel: 613-745-6471

HERITAGE CONSULTANT

MTBA
222 LAURIER AVENUE EAST, STUDIO 201
OTTAWA, ON K1N 6P2
Tel: 613-244-2323

CIVIL ENGINEER

DSEL
120 BER ROAD, SUITE 103
OTTAWA, ON K2S 1E9
Tel: 613-836-0556

TRAFFIC CONSULTANT

CGH TRANSPORTATION
6 PLAZA COURT
OTTAWA, ON K2H 7W1
Tel: 613-697-3797

SURVEY

STATICS
1331 CLYDE AVE. SUITE 400
OTTAWA, ON K2C 3G4
Tel: 613-722-4400

NOISE/WIND CONSULTANT

GRADIENT WIND
107 WALGREEN ROAD
OTTAWA, ON K0A 1L0
Tel: 613-836-0934

KEYPLAN



SEAL

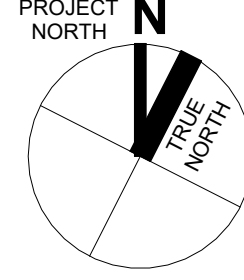

1186-1194
WELLINGTON ST W

1186-1194 Wellington St W
Ottawa, ON K1Y 2Z5

DRAWN: AC/EB CHECKED: BM

PLOT DATE: 3/10/2025 1:42:36 PM

ON100020 - WELLINGTON