

ALL CONTRACTORS TO VERIFY ALL DIMENSIONS ON SITE AND TO REPORT ALL ERRORS AND/OR OMISSIONS TO THE ARCHITECT.

ALL CONTRACTORS MUST COMPLY WITH ALL CODES AND BYLAWS AND OTHER AUTHORITIES HAVING JURISDICTION OVER THE WORK.

DO NOT SCALE DRAWINGS.

THIS DRAWING MAY NOT BE USED FOR CONSTRUCTION UNTIL SIGNED BY THE ARCHITECT.

COPYRIGHT RESERVED.

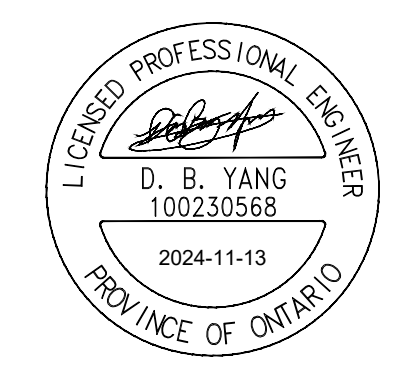

SUBJECT TO APPROVAL

NO.	REVISION	DD/MM/YY DATE
6	ISSUED FOR ZBA/SPA RESUBMISSION	2024-11-13
5	ISSUED FOR CLASS C ESTIMATE	2024-09-17
4	ISSUED FOR ZBA/SPA RESUBMISSION	2024-08-28
3	ISSUED FOR ZBA/SPA RESUBMISSION	2023-03-28
2	REVISED AS PER CITY COMMENTS	2023-02-16
1	ISSUED FOR SPA	2022-08-19



CONSULTANTS:
STRUCTURAL –
MECHANICAL –
ELECTRICAL –
LANDSCAPING –

15 OBLATS AVENUE
OTTAWA

REMOVAL PLAN

221-02976-00	
DRAWN BY: SM	
DESIGNED BY: SM	
CHECKED BY: DY	C004

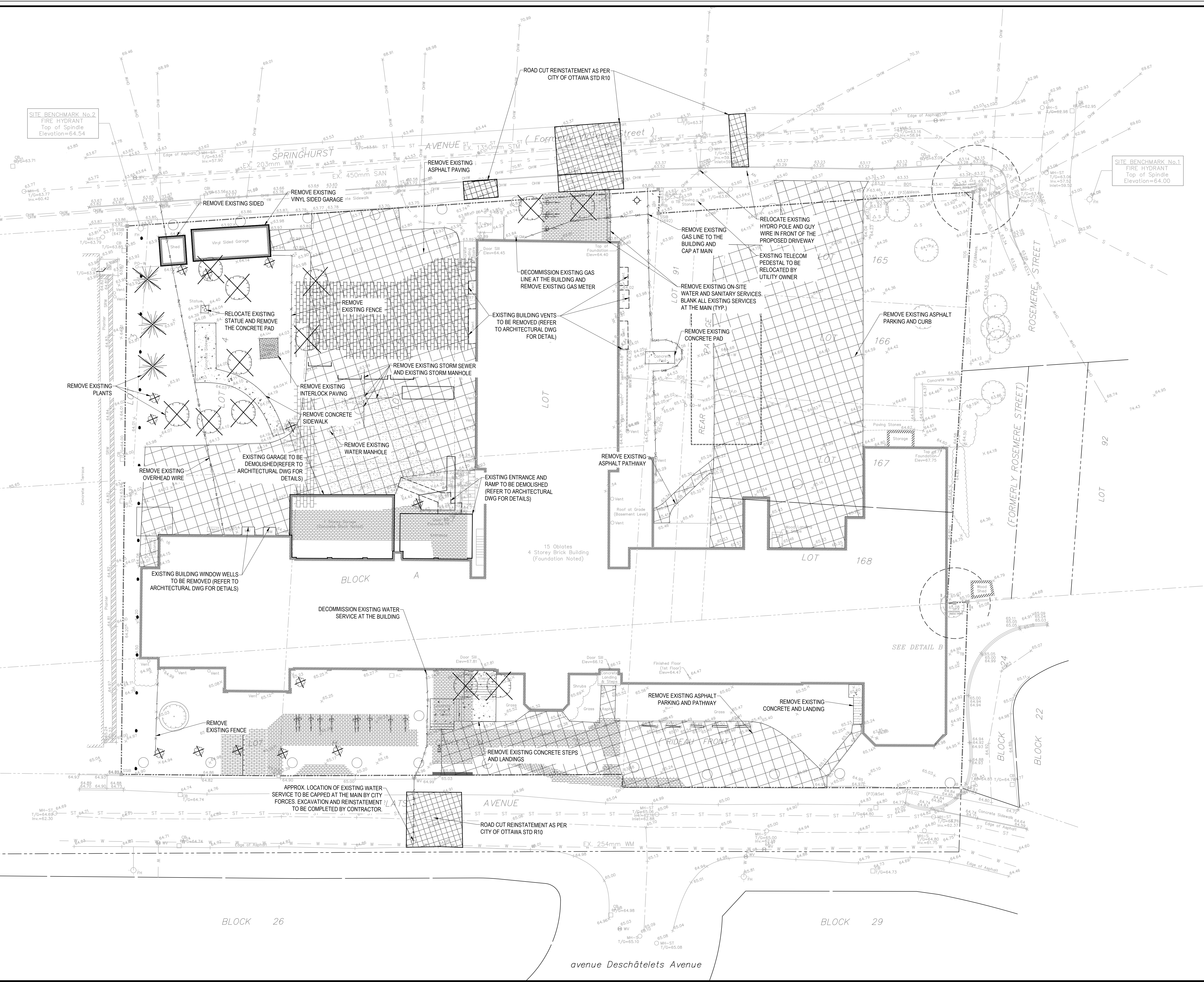

EXISTING LEGEND

- ◊ 64.99 EXISTING ELEVATION
- ⊙ MH-ST EXISTING STORM MANHOLE
- ⊙ CB EXISTING CATCHBASIN
- ⊙ WH-S EXISTING SANITARY MANHOLE
- ⊙ WV EXISTING WATER VALVE
- ⊙ B EXISTING BOLLARD
- ⊙ UB EXISTING UTILITY PEDESTAL
- ⊙ D EXISTING DECIDUOUS TREE
- ⊙ S EXISTING SHRUBS
- ⊙ C EXISTING CONIFEROUS TREE
- ⊙ FH EXISTING FIRE HYDRANT
- ⊙ UP EXISTING UTILITY POLE
- ⊙ AN EXISTING ANCHOR
- W — EXISTING WATERMAIN
- ST — EXISTING STORM SEWER
- SS — EXISTING SANITARY SEWER
- OHW — EXISTING OVERHEAD WIRE
- P — EXISTING POWER LINE
- G — EXISTING GAS
- — EXISTING EDGE OF ASPHALT
- — — — — PROPERTY LINE

LEGEND

- ◊ PROPOSED CATCHBASIN
- ⊙ STMH PROPOSED STORM MANHOLE
- ⊙ SANMH PROPOSED SANITARY MANHOLE
- ⊙ V&B PROPOSED VALVE AND BOX
- STM — PROPOSED STORM SEWER
- SAN — PROPOSED SANITARY SEWER
- W — PROPOSED WATER SERVICE
- × T/G 64.55 PROPOSED TOP OF GRATE
- × FFE 64.55 FINISH FLOOR ELEVATION
- × T/C 63.50 PROPOSED TOP AND BOTTOM OF CURB
- × B/C 63.45
- × TL 63.55 PROPOSED TOP AND BOTTOM OF LANDING ELEVATION
- × BL 63.45
- × T/S 64.60 PROPOSED TOP AND BOTTOM OF SLOPE
- × B/S 64.27
- × 63.25
- ◊ 63.98 PROPOSED ELEVATION
- 3:1 — PROPOSED 3:1 SLOPE
- SILT SACK FILTER
- SF — LIGHT DUTY SILT DENCE
- ➔ OVERLAND FLOW DIRECTION

