

Lighting • Controls • Shades



Control the Experience

Project name	Project number	Date		2936 Baseline Road, Suite 100 Tel: 613-592-9948 Ottawa, Ontario Fax: 613-592-9984 K2H 1B3 <a href="http://www.fluxlighting.ca">www.fluxlighting.ca</a>
4 CAMPBELL REID COURT	23080	E CARMICHAEL	2023.06.19	
Drawing name	Drawing number	Drawn by	Checked by	
PHOTOMETRIC SUMMARY	PP-01	E CARMICHAEL		



**DRAWING INFORMATION**

- ① LUMINAIRE MOUNTING HEIGHTS INDICATED IN DRAWINGS BY EC
- ② WALL SCONCE - M/H INDICATED IS DISTANCE FROM FLOOR TO CENTER OF FIXTURE
- ③ REFER TO ENGINEERED DRAWINGS FOR FURTHER SITE INFORMATION
- ④ CALCULATION POINT PLANE INDICATED IN SCHEDULE BY EC

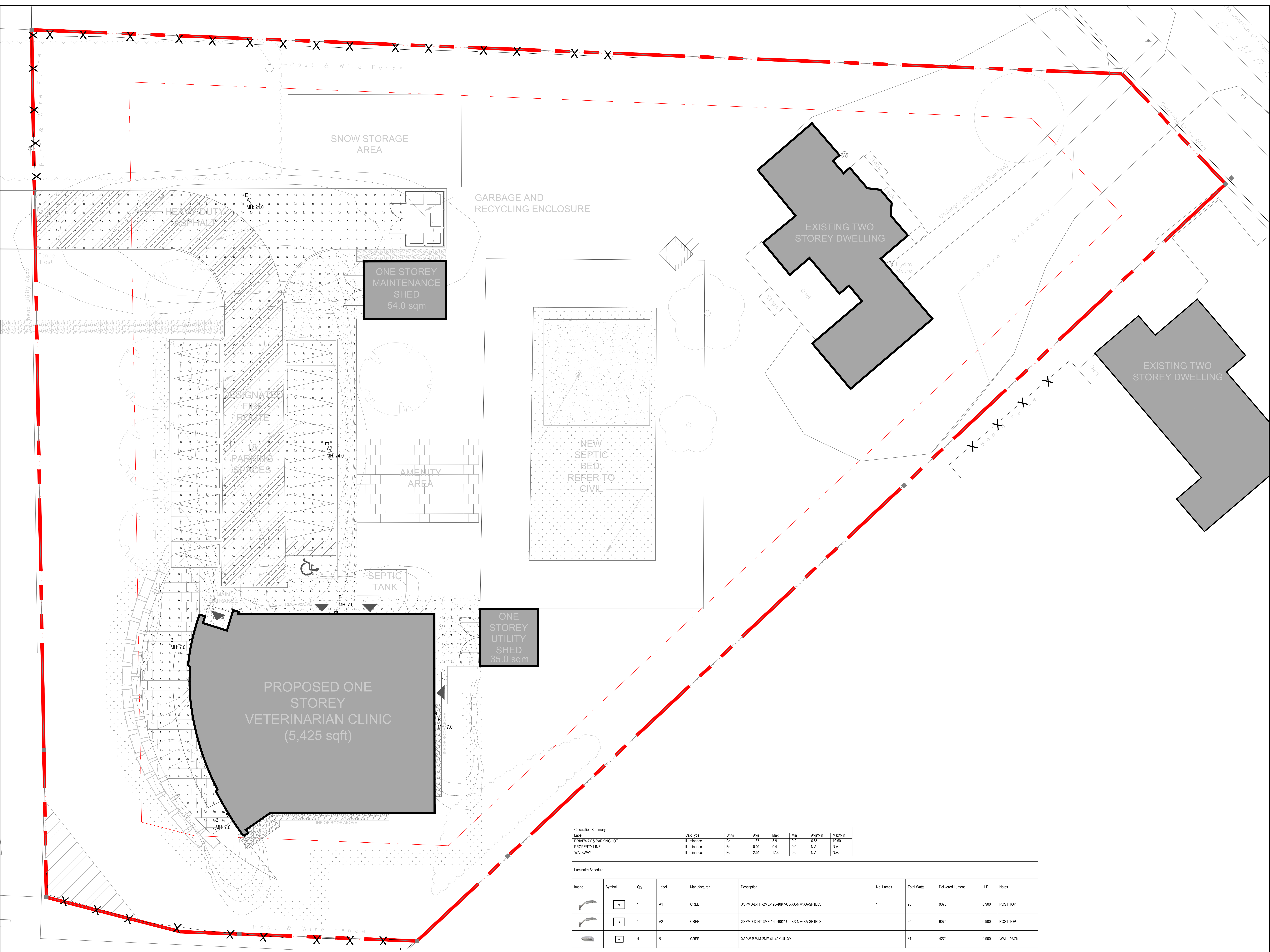

Label	Calc Type	Units	Avg	Max	Min	Avg/Min	Max/Min
DRIVEWAY & PARKING LOT	Illuminance	Fc	1.37	3.9	0.2	6.85	19.50
PROPERTY LINE	Illuminance	Fc	0.01	0.4	0.0	N.A.	N.A.
WALKWAY	Illuminance	Fc	2.51	17.6	0.0	N.A.	N.A.

Image	Symbol	Qty	Label	Manufacturer	Description	No. Lamps	Total Watts	Delivered Lumens	LLF	Notes
	+	1	A1	CREE	XSPMD-D-HT-2ME-12L-40K7-UL-XX-N w XX-SP18LS	1	95	9075	0.900	POST TOP
	+	1	A2	CREE	XSPMD-D-HT-3ME-12L-40K7-UL-XX-N w XX-SP18LS	1	95	9075	0.900	POST TOP
	+	4	B	CREE	XSPW-B-WM-2ME-4L-40K-UL-XX	1	31	4270	0.900	WALL PACK

① POINT BY POINT PHOTOMETRIC CALCULATION  
L-02 SCALE: 1:120

② SCHEDULE AND CALCULATION SUMMARY  
L-02 SCALE: NTS

2	ISSUED FOR SITE PLAN APPLICATION	SEPT 13, 23
1	ISSUES FOR REVIEW	
REV.	DESCRIPTION	DATE
STAMP		



Project Name: 4 CAMPBELL REID COURT  
Drawing Name: PHOTOMETRIC SUMMARY

Scale: AS SHOWN	Drawn by: E CARMICHAEL
Date: 2023.06.19	Checked by:
Project Number: 23080	Drawing Number: PP-02

Lighting • Controls • Shades  
**FUX**  
Control the Experience