

INTERNAL SWM STORAGE SYSTEM

DESIGN EVENT	STORAGE SYSTEM CONTROLLED FLOW	STORAGE VOLUMES	
		REQUIRED	PROVIDED
1:2 YR		5.7 m ³	>30 m ³
1:5 YR		9.1 m ³	
1:100 YR		23.0 m ³	
1:100+20%		29.5 m ³	

NOTES:
 1. ALL DRAINAGE FROM AREA A-2 (PROPOSED AMENITY AREA DECK DRAINS AND ALL ROOF DRAINS) TO BE DIRECTED TO THE INTERNAL STORMWATER STORAGE SYSTEM. REFER TO ARCHITECTURAL AND MECHANICAL PLANS FOR DETAILS.
 2. REFER TO ARCHITECTURAL AND STRUCTURAL PLANS FOR EXACT SIZE AND DETAILS OF INTERNAL STORMWATER STORAGE SYSTEM.
 3. REFER TO ARCHITECTURAL AND MECHANICAL PLANS FOR LOCATION AND CONNECTIONS AND DETAILS OF THE INTERNAL STORMWATER STORAGE SYSTEM.

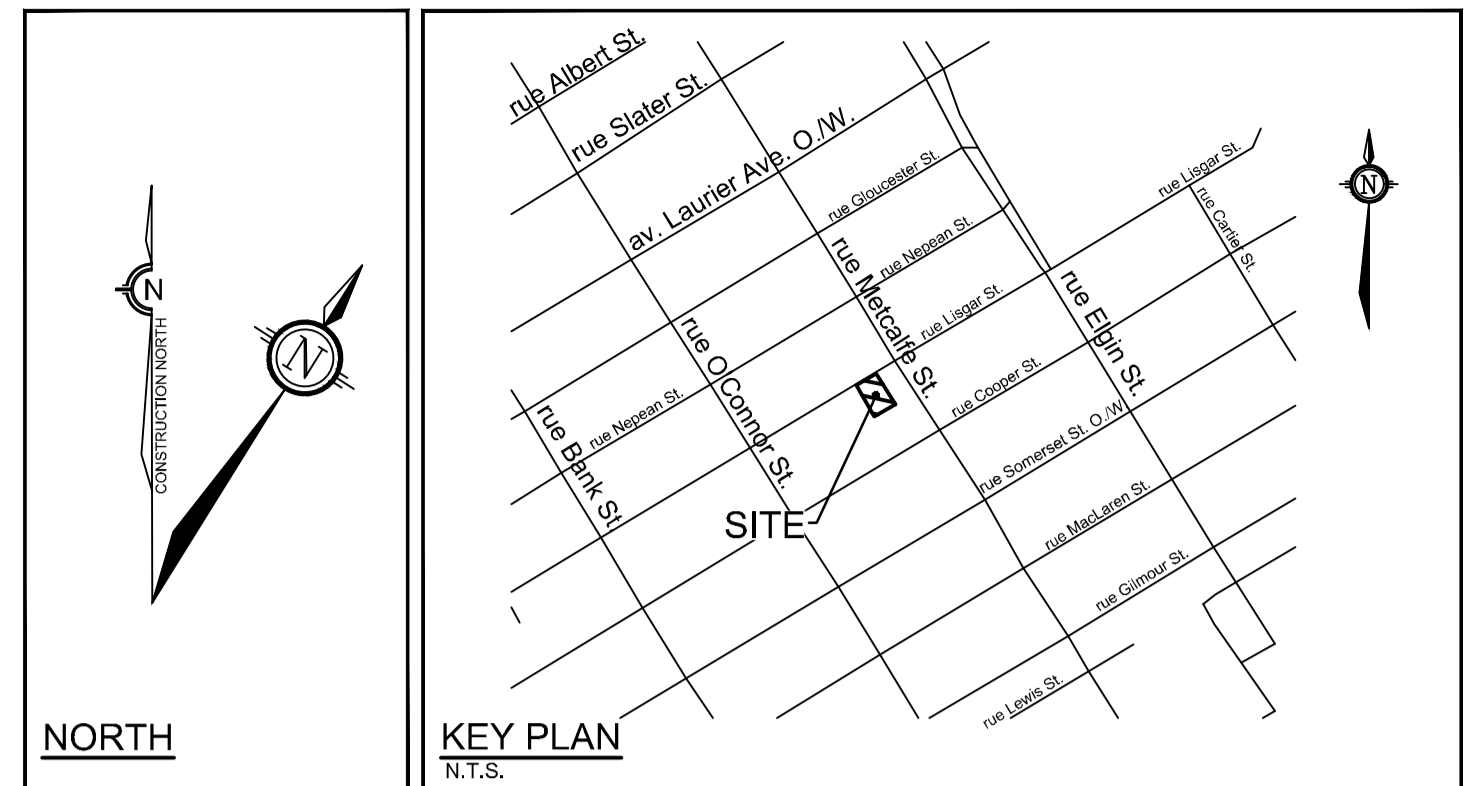
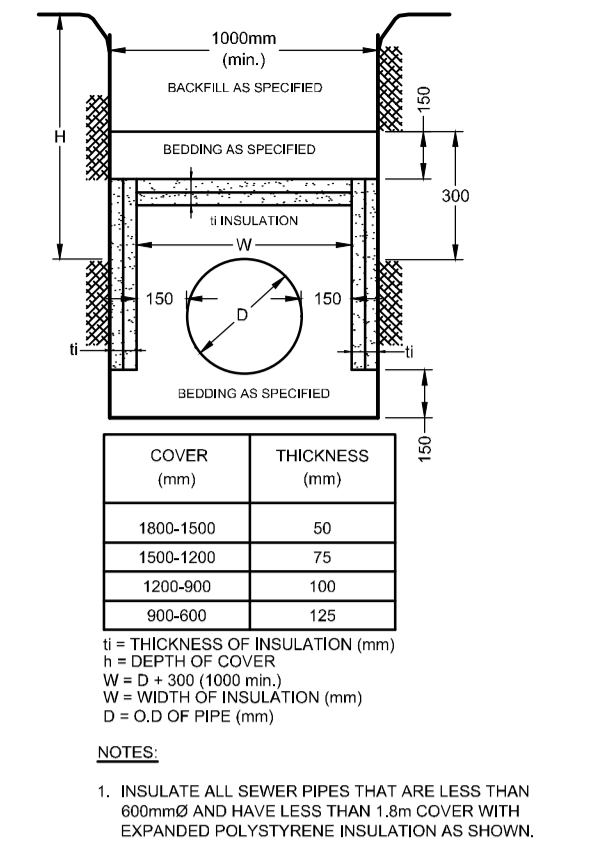

- ### GENERAL NOTES:
- COORDINATE AND SCHEDULE ALL WORK WITH OTHER TRADES AND CONTRACTORS.
 - DETERMINE THE EXACT LOCATION, SIZE, MATERIAL AND ELEVATION OF ALL EXISTING UTILITIES PRIOR TO COMMENCING CONSTRUCTION. PROTECT AND ASSUME RESPONSIBILITY FOR ALL EXISTING UTILITIES WHETHER OR NOT SHOWN ON THIS DRAWING.
 - OBTAIN ALL NECESSARY PERMITS AND APPROVALS FROM THE CITY OF OTTAWA BEFORE COMMENCING CONSTRUCTION.
 - BEFORE COMMENCING CONSTRUCTION OBTAIN AND PROVIDE PROOF OF COMPREHENSIVE, ALL RISK AND OPERATIONAL LIABILITY INSURANCE FOR \$5,000,000.00. INSURANCE POLICY TO NAME OWNERS, ENGINEERS AND ARCHITECTS AS CO-INSURED.
 - COMPLETE ALL WORKS IN ACCORDANCE WITH THE MOST CURRENT CITY OF OTTAWA STANDARDS AND SPECIFICATIONS USING THE CURRENT GUIDELINES, BYLAWS AND STANDARDS INCLUDING MATERIALS OF CONSTRUCTION, DISINFECTANT AND ALL RELEVANT REFERENCES TO OPSS, OPSD & AWWA GUIDELINES - ALL CURRENT VERSIONS AND AS AMENDED.
 - RESTORE ALL DISTURBED AREAS ON-SITE AND OFF-SITE, INCLUDING TRENCHES AND SURFACES ON PUBLIC ROAD ALLOWANCES TO EXISTING CONDITIONS OR BETTER TO THE SATISFACTION OF MUNICIPAL AUTHORITIES.
 - REMOVE FROM SITE ALL EXCESS EXCAVATED MATERIAL, ORGANIC MATERIAL AND DEBRIS UNLESS OTHERWISE INSTRUCTED BY ENGINEER. EXCAVATE AND REMOVE FROM SITE ANY CONTAMINATED MATERIAL. ALL CONTAMINATED MATERIAL SHALL BE DISPOSED OF AT A LICENSED LANDFILL FACILITY.
 - ALL ELEVATIONS ARE GEODETIC.
 - REFER TO GEOTECHNICAL INVESTIGATION REPORT (PG6401-1, DATED OCTOBER 26, 2022), PREPARED BY PATERSON GROUP INC., CONSTRUCTION RECOMMENDATIONS AND GEOTECHNICAL INSPECTION REQUIREMENTS. THE GEOTECHNICAL CONSULTANT IS TO REVIEW ON-SITE CONDITIONS AFTER EXCAVATION PRIOR TO PLACEMENT OF THE GRANULAR MATERIAL.
 - REFER TO ARCHITECT'S AND LANDSCAPE ARCHITECT'S DRAWINGS FOR BUILDING AND HARD SURFACED AREAS AND DIMENSIONS.
 - REFER TO THE 'DEVELOPMENT SERVICING STUDY AND STORMWATER MANAGEMENT REPORT' (R-2022-151) PREPARED BY NOVATECH.
 - SAW CUT AND KEYGRIND ASPHALT AT ALL ROAD CUTS AND ASPHALT TIE-IN POINTS AS PER CITY OF OTTAWA STANDARDS (R10).

LEGEND

---	PROPERTY LINE
---	PROPOSED SANITARY SEWER
---	PROPOSED STORM SEWER
---	PROPOSED THERMAL INSULATION
○	PROPOSED CATCHBASIN MANHOLE
□	AREA DRAIN
○	ROOF DRAIN
○	PROPOSED WATER METER AND REMOTE METER
○	PROPOSED BARRIER CURB
---	PROPOSED DEPRESSED CURB
---	PROPOSED WATER SERVICE AND DIAMETER
---	PROPOSED STAND POST / VALVE & VALVE BOX
---	PROPOSED TEE CW THRUST BLOCK
---	ROAD REINSTATEMENT LIMIT
Y	PROPOSED SIMESE CONNECTION
⊥	PROPOSED CAP
---	PROPOSED BUILDING ENTRANCE
---	UNDERGROUND PARKING LIMIT
---	RETAINING WALL
X	REMOVALS
---	FINISHED FLOOR ELEVATION
---	TOP OF FOUNDATION WALL ELEVATION
---	UNDERSIDE OF FOOTING ELEVATION
---	EXISTING CONCRETE CURB
---	EXISTING SANITARY SEWER
---	EXISTING STORM SEWER
---	EXISTING CATCHBASIN CW CATCHBASIN LEAD
---	EXISTING WATERMAIN AND WATER KEY
---	EXISTING UTILITY POLE CW ANCHOR WIRES
---	EXISTING RETAINING WALL

- ### SEWER NOTES:
- SUPPLY AND CONSTRUCT ALL SEWERS AND APPURTENANCES IN ACCORDANCE WITH THE MOST CURRENT CITY OF OTTAWA STANDARDS AND SPECIFICATIONS - ALL CURRENT VERSIONS AND AS AMENDED.
 - SPECIFICATIONS:

ITEM	SPEC. No.	REFERENCE
STORM / SANITARY MANHOLE (12000)	701.010	OPSD
SANITARY MANHOLE FRAME AND COVER	401.010 - TYPE 'A'	OPSD
STORM/CATCHBASIN MANHOLE (18000)	701.012	OPSD
STORM/CBHM FRAME AND COVER	401.010 - TYPE 'B'	OPSD
WATERTIGHT MANHOLE FRAME AND COVER	401.030	OPSD
CATCHBASIN (60000)	705.010	OPSD
CATCHBASIN FRAME & COVER	S19	CITY OF OTTAWA
SEWER TRENCH	S6	CITY OF OTTAWA
STORM SEWER	PVC DR 35 (450mm Ø PIPE AND SMALLER)	
SANITARY SEWER	CONCRETE 65-D (600mm Ø PIPE AND LARGER)	
	PVC DR 35	
 - THE SANITARY SERVICE LATERAL SHALL BE EQUIPPED WITH BACKFLOW PREVENTERS WITHIN THE BUILDING FOOTPRINT AS PER CITY OF OTTAWA STANDARD DETAILS S14.1 OR S14.2. REFER TO MECHANICAL PLANS FOR DETAILS.
 - THE STORM SERVICE LATERAL SHALL BE EQUIPPED WITH A BACKFLOW PREVENTER WITHIN THE BUILDING FOOTPRINT AS PER CITY OF OTTAWA STANDARD DETAILS S14. REFER TO MECHANICAL PLANS FOR DETAILS.
 - SERVICES ARE TO BE CONSTRUCTED TO 1.0m FROM FACE OF BUILDING AT A MINIMUM SLOPE OF 1.0%.
 - PIPE BEDDING, COVER AND BACKFILL ARE TO BE COMPACTED TO AT LEAST 95% OF THE STANDARD PROCTOR MAXIMUM DRY DENSITY. THE USE OF CLEAR CRUSHED STONE AS A BEDDING LAYER SHALL NOT BE PERMITTED.
 - INSULATE ALL PIPES (SAN / STM) THAT HAVE LESS THAN 1.8m COVER WITH HI-40 INSULATION PER INSULATION DETAIL FOR SHALLOW SEWERS. PROVIDE 150mm CLEARANCE BETWEEN PIPE AND INSULATION.
 - CONCRETE MANHOLES ARE TO BE 1200mm Ø STRUCTURES UNLESS OTHERWISE NOTED ON THE DRAWING. FLEXIBLE CONNECTIONS ARE REQUIRED FOR CONNECTING PIPES TO MANHOLES (FOR EXAMPLE KOR-N-SEAL, PSX: POSITIVE SEAL AND DURASEAL). THE CONCRETE CRADLE FOR THE PIPE CAN BE ELIMINATED.
 - TYPICAL STORM MANHOLES AND CATCHBASIN MANHOLES ARE TO HAVE 300mm SUMP UNLESS OTHERWISE INDICATED.
 - THE CONTRACTOR IS TO TELEVIEW (CCTV) ALL PROPOSED SEWERS, 200mm Ø OR GREATER PRIOR TO BASE COURSE ASPHALT. UPON COMPLETION OF CONTRACT, THE CONTRACTOR IS RESPONSIBLE TO FLUSH AND CLEAN ALL SEWERS & APPURTENANCES. PROVIDE A COPY OF ALL CCTV INSPECTION REPORTS TO THE ENGINEER FOR REVIEW.
 - CONTRACTOR TO PROVIDE THE CONSULTANT WITH A GENERAL PLAN OF SERVICES INDICATING ALL APPLICABLE SERVICING AS-BUILT INFORMATION SHOWN ON THIS PLAN. AS-BUILT INFORMATION MUST INCLUDE: PIPE MATERIAL, SIZES, LENGTHS, SLOPES, INVERT AND T/G ELEVATIONS, STRUCTURE LOCATIONS AND ANY ALIGNMENT CHANGES, ETC.
 - THE OWNER SHALL REQUIRE THAT THE SITE SERVICING CONTRACTOR PERFORM FIELD TESTS FOR QUALITY CONTROL OF ALL SANITARY SEWERS. LEAKAGE TESTING SHALL BE COMPLETED IN ACCORDANCE WITH OPSS 410.07.16, 410.07.16.04 AND 407.07.24. DYE TESTING IS TO BE COMPLETED ON ALL SANITARY SERVICES TO CONFIRM PROPER CONNECTION TO THE SANITARY SEWER MAIN. THE FIELD TESTS SHALL BE PERFORMED IN THE PRESENCE OF A CERTIFIED PROFESSIONAL ENGINEER WHO SHALL SUBMIT A CERTIFIED COPY OF THE TEST RESULTS.

PROPOSED 150mm Ø WATER SERVICE TABLE

Station	F/G ELEVATION	TOP OF WATERMAIN	DESCRIPTION
0+000.00	71.13	68.93	ROLL 150mm Ø WM CONNECTION TO EX. 300mm Ø DI WM
0+007.83	71.39	68.84	VALVE AND VALVE BOX (SP) 0.5m OFF OF CAP (AT PROPERTY LINE)
0+008.11	71.41	68.85	CAP AT 1.0m FROM FOUNDATION WALL

* CONNECTION TO EXISTING 300mm Ø DUCTILE IRON WATERMAIN, EXACT ELEVATION TO BE FIELD DETERMINED.
 ** PROVIDE THERMAL INSULATION AS PER CITY OF OTTAWA DETAIL W22 IN SHALLOW TRENCHES AND/OR CITY OF OTTAWA W23 ADJACENT TO OPEN STRUCTURES.

- ### BENCHMARK NOTES:
- ELEVATIONS ARE GEODETIC AND ARE REFERRED TO CITY OF OTTAWA CONTROL POINT 2011-0007 HAVING A PUBLISHED ELEVATION OF 80.55 METRES.
 - IT IS THE RESPONSIBILITY OF THE USER OF THIS INFORMATION TO VERIFY THAT THE SITE BENCHMARKS HAVE NOT BEEN ALTERED OR DISTURBED AND THAT ITS RELATIVE ELEVATION AND DESCRIPTION AGREES WITH THE INFORMATION SHOWN ON THIS DRAWING.
 - BENCHMARK WAS PROVIDED ON SURVEYOR'S REAL PROPERTY REPORT WITH TOPOGRAPHIC DETAILS PART 1 - PLAN SHOWING LOT 47 (SOUTH SIDE OF LISGAR STREET), REGISTERED PLAN NO. 12281, CITY OF OTTAWA, SURVEYED BY J.D. BARNES LIMITED (REF. # 21-10-108-00).

- ### WATERMAIN NOTES:
- SUPPLY AND CONSTRUCT ALL WATERMANS AND APPURTENANCES IN ACCORDANCE WITH THE CITY OF OTTAWA STANDARDS AND SPECIFICATIONS - ALL CURRENT VERSIONS AND AS AMENDED.
 - SPECIFICATIONS:

ITEM	SPEC. No.	REFERENCE
WATERMAIN TRENCHING	W17	CITY OF OTTAWA
HYDRANT INSTALLATION	W19	CITY OF OTTAWA
THERMAL INSULATION IN SHALLOW TRENCHES	W22	CITY OF OTTAWA
THERMAL INSULATION BY OPEN STRUCTURES	W23	CITY OF OTTAWA
VALVE BOX ASSEMBLY	W24	CITY OF OTTAWA
WATERMAIN CROSSING BELOW SEWERS	W25	CITY OF OTTAWA
CATHODIC PROTECTION FOR PVC WATERMANS	W40	CITY OF OTTAWA
WATERMAIN MATERIAL	PVC DR 18 (100mm AND LARGER)	
 - EXCAVATION, INSTALLATION, BACKFILL AND RESTORATION OF ALL WATERMANS BY THE CONTRACTOR. CONNECTIONS AND SHUT-OFFS AT THE MAIN AND CHLORINATION OF THE WATER SYSTEM SHALL BE PERFORMED BY CITY OFFICIALS.
 - WATERMAIN SHALL BE MINIMUM 2.4m DEPTH BELOW GRADE UNLESS OTHERWISE INDICATED.
 - PROVIDE MINIMUM 0.5m CLEARANCE BETWEEN OUTSIDE OF PIPES AT ALL CROSSINGS, UNLESS OTHERWISE INDICATED.
 - WATER SERVICE IS TO BE CONSTRUCTED TO WITHIN 1.0m OF FOUNDATION WALL AND CAPPED, UNLESS OTHERWISE INDICATED.

NOTE:
 THE POSITION OF ALL POLE LINES, CONDUITS, WATERMANS, SEWERS AND OTHER UNDERGROUND AND OVERGROUND UTILITIES AND STRUCTURES IS NOT NECESSARILY SHOWN ON THE CONTRACT DRAWINGS, AND WHERE SHOWN, THE ACCURACY OF THE POSITION OF SUCH UTILITIES AND STRUCTURES IS NOT GUARANTEED. BEFORE STARTING WORK, DETERMINE THE EXACT LOCATION OF ALL SUCH UTILITIES AND STRUCTURES AND ASSUME ALL LIABILITY FOR DAMAGE TO THEM.

OWNER INFORMATION

230 LISGAR STREET INC.
 c/o THE FALSETTO COMPANY INC.
 1524 ARNHEM ST.
 OTTAWA, ON, K2C 1V1

CONTACT: ALBERT FALSETTO
 Tel: (613) 281-5224
 Email: a.falsetto@rogers.com

No.	REVISION	DATE	BY
3.	RE-ISSUED FOR SPC APPLICATION	JULY 21/23	FST
2.	REVISED PER CITY COMMENTS	MAY 19/23	FST
1.	ISSUED FOR SPC APPLICATION	NOV 11/22	FST

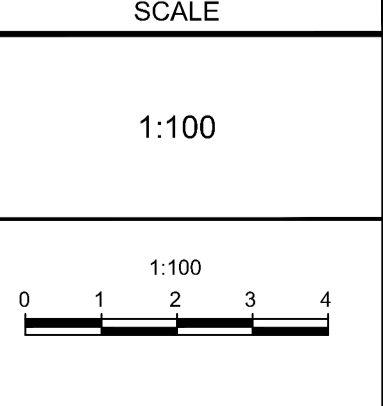

FOR REVIEW ONLY

DESIGN	CV
CHECKED	FST
DRAWN	CV
CHECKED	FST
APPROVED	FST

NOVATECH
 Engineers, Planners & Landscape Architects
 Suite 200, 240 Michael Cowpland Drive
 Ottawa, Ontario, Canada K2M 1P6

Telephone: (613) 254-9643
 Facsimile: (613) 254-5867
 Website: www.novatech-eng.com

LOCATION	
CITY OF OTTAWA 230-232 LISGAR STREET	
DRAWING NAME	
GENERAL PLAN OF SERVICES	
PROJECT No.	122160
REV	REV # 3
DRAWING No.	122160-GP

M:\2023\122160\CAD\Civil\122160-GP.dwg, GP, May 25, 2023, 4:19pm, szll

D07-12-22-0166