



OTTAWA-CARLETON DISTRICT SCHOOL BOARD

4	0	23/06/14	RE-ISSUED FOR SITE PLAN CONTROL
3	0	23/06/04	RE-ISSUED FOR SITE PLAN CONTROL
2	0	23/03/28	RE-ISSUED FOR SITE PLAN CONTROL
1	0	22/12/02	ISSUED FOR SITE PLAN CONTROL

ISSUE NO.	REV. NO.	DATE	ISSUE
-----------	----------	------	-------

LES IDÉES, CONCEPTS, DISPOSITIONS ET PLANS MONTRÉS OU REPRÉSENTÉS PAR CE DESSIN APPARTIENNENT À EDWARD J. CUHACI AND ASSOCIATES ARCHITECTS INC. ET ONT ÉTÉ CRÉÉS, ET DÉVELOPPÉS POUR ÊTRE UTILISÉS DANS LE CADRE DU PRÉSENT PROJET. ILS NE DOIVENT PAS ÊTRE UTILISÉS À D'AUTRES FINS NI COMMUNIQUÉS À QUI QUE CE SOIT SANS LA PERMISSION ÉCRITE DE EDWARD J. CUHACI AND ASSOCIATES ARCHITECTS INC.

L'ARCHITECTE DÉCLINE TOUTE RESPONSABILITÉ DÉCOULANT DE PROBLÈMES FAISANT SUITE AU NON RESPECT DES PLANS ET DEVIS OU DE L'INTENTION DU CONCEPT QU'ILS TRANSMETTENT, OU DE TOUTS PROBLÈMES POUVANT RÉSULTER DU DÉFAUT DE TIERS D'OBTENIR OU DE SUIVRE LES INSTRUCTIONS DE L'ARCHITECTE RELATIVEMENT AUX ERREURS, OMISSIONS, INCOHÉRENCES, AMBIGUITÉS OU CONTRADICTIONS ALLÉGUÉES.

L'ENTREPRENEUR DOIT VÉRIFIER TOUTES LES DIMENSIONS SUR PLACE ET INFORMER L'ARCHITECTE DE TOUT ÉCART AVANT LE DÉBUT DES TRAVAUX. NE PAS MESURER LES DESSINS À L'ÉCHELLE.

ALL IDEAS, DESIGNS, ARRANGEMENTS, AND PLANS INDICATED OR REPRESENTED BY THIS DRAWING ARE OWNED BY AND THE PROPERTY OF EDWARD J. CUHACI AND ASSOCIATES INC. AND WERE CREATED, EVOLVED, AND DEVELOPED FOR USE ON AND IN CONNECTION WITH THE SPECIFIED PROJECT. NONE OF THE IDEAS, DESIGNS, ARRANGEMENTS OR PLANS SHALL BE USED BY OR DISCLOSED TO ANY PERSON, FIRM, OR CORPORATION FOR ANY PURPOSE WHATSOEVER WITHOUT THE WRITTEN PERMISSION OF EDWARD J. CUHACI AND ASSOCIATES INC.

THE ARCHITECT WAIVES ANY AND ALL RESPONSIBILITY AND LIABILITY FOR PROBLEMS WHICH ARISE FROM FAILURE TO FOLLOW THESE PLANS, SPECIFICATIONS, AND THE DESIGN INTENT THEY CONVEY, OR FOR PROBLEMS WHICH ARISE FROM OTHERS' FAILURE TO OBTAIN AND/OR FOLLOW THE ARCHITECT'S GUIDANCE WITH RESPECT TO ANY ERRORS, OMISSIONS, INCONSISTENCIES, AMBIGUITIES OR CONFLICTS WHICH ARE ALLEGED.

CONTRACTOR TO VERIFY ALL DIMENSIONS AND NOTIFY THE ARCHITECT OF ANY DISCREPANCIES BEFORE WORK COMMENCES. DO NOT SCALE DRAWINGS

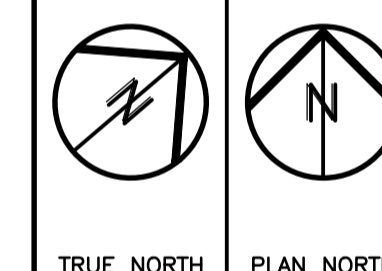

TRUE NORTH PLAN NORTH

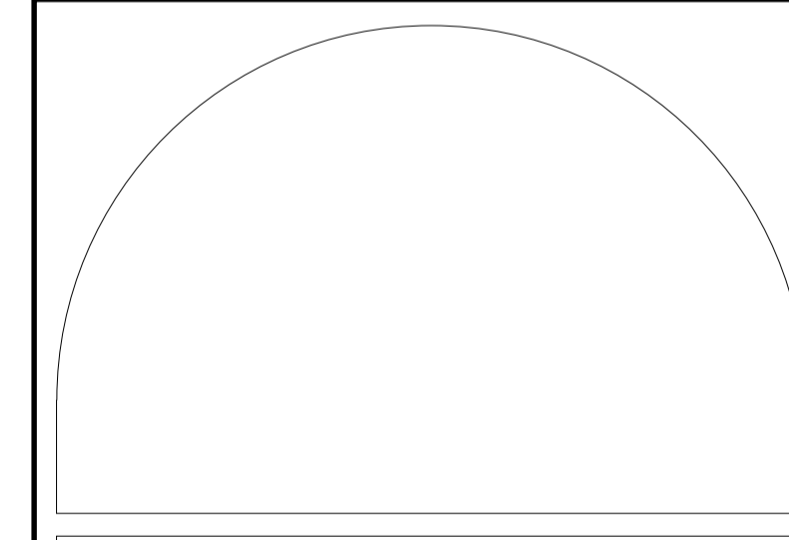

EDWARD J CUHACI & ASSOCIATES ARCHITECTS Inc.
171 Slater St, Suite 100, Ottawa, Ontario, K1P 5H7
Fax: (613) 236-1944 Telephone: (613) 236-7135 E-mail: info@cuhaci.com

PROJECT/TITRE DU PROJET
STITTSVILLE PUBLIC SCHOOL DROP OFF LANE
40 GRANITE RIDGE DRIVE
STITTSVILLE, ON

OTTAWA-CARLETON DISTRICT SCHOOL BOARD
133 GREENBANK ROAD
NEPEAN, ON

DRAWING/TITRE DU DESSIN
NEW PLAN AND DETAILS

SCALE	AS SHOWN	PROJ. No	2233	ISSUE No	4	REV. No	0
ECHELLE							
DRAWN BY	SL	DRAWING/DESSIN					
DESIGNÉ PAR							
CHECKED BY	XF						
VÉRIFIÉ PAR							
DATE	MAY 2023	ACAD FILE/CHIER: 2233-A2.DWG					

A2

#18896

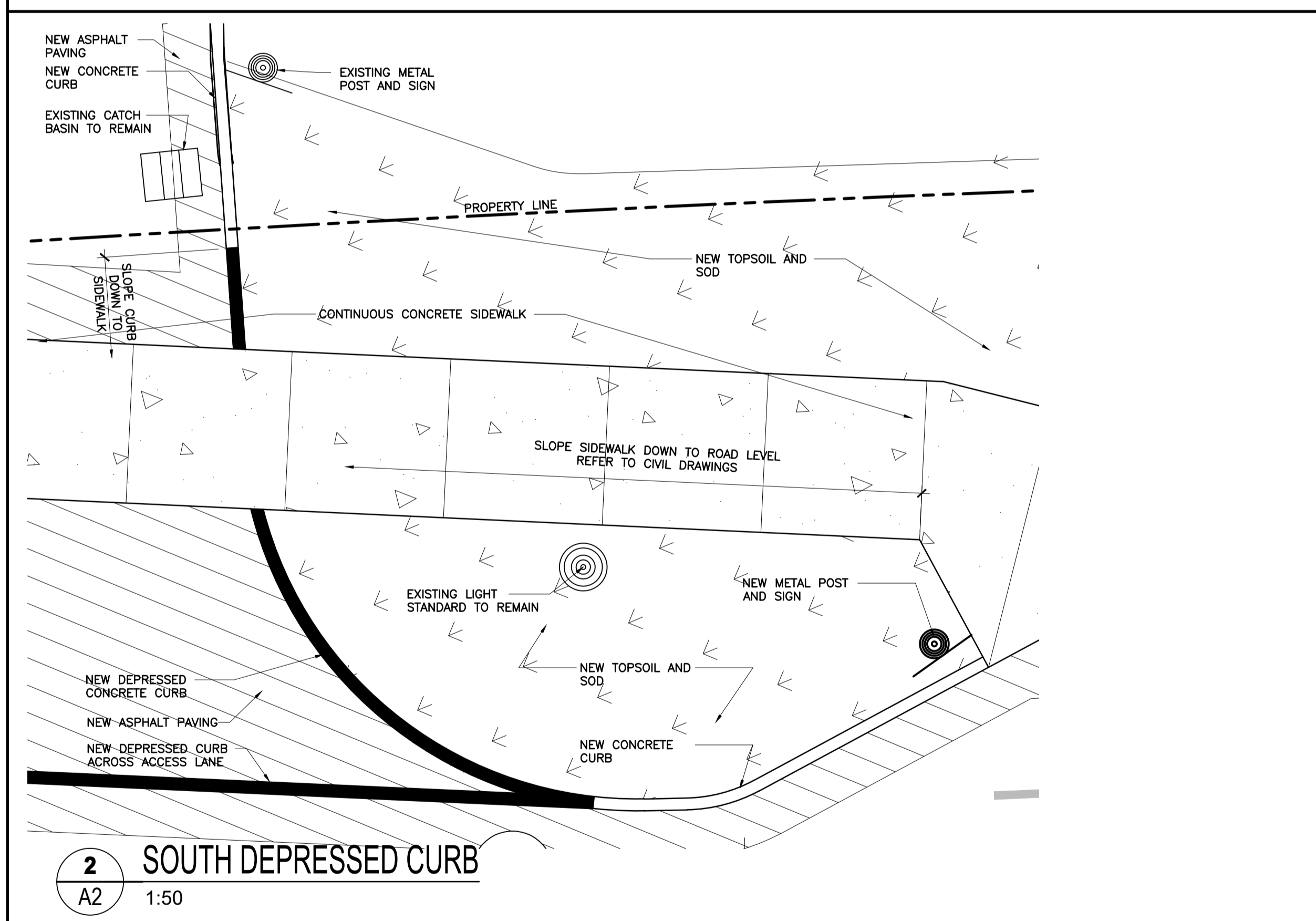
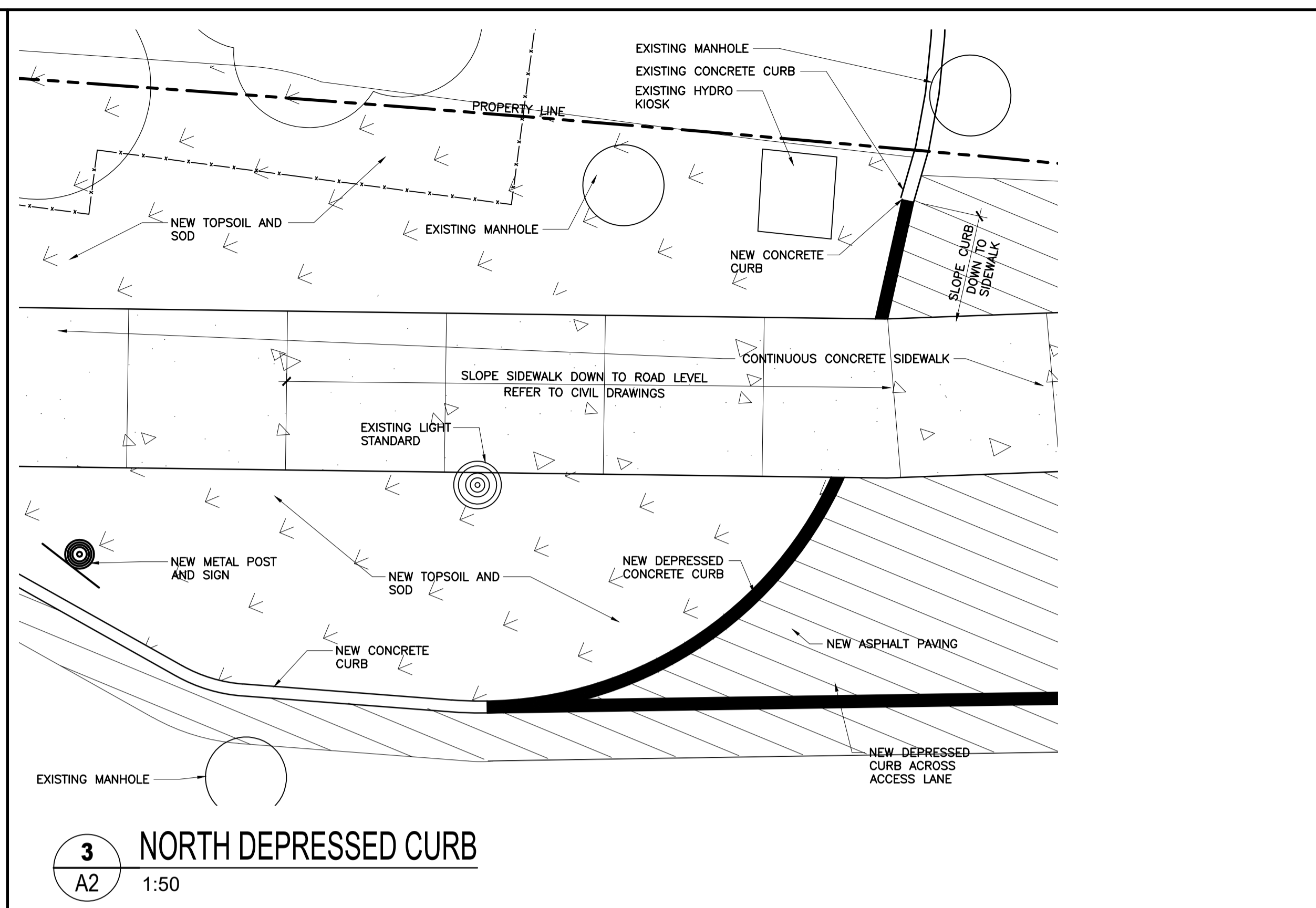

GENERAL NOTES	DRAWING LEGEND	DRAWING NOTES
1. ALL WORK ON CITY OF OTTAWA PROPERTY SHALL COMPLY WITH CITY OF OTTAWA STANDARDS	NEW ASPHALT PAVING	1 NEW MONOLITHIC CONCRETE CURB AND SIDEWALK
2. ALSO REFER TO CIVIL DRAWINGS FOR ADDITIONAL INFORMATION AND REQUIREMENTS	NEW CONCRETE SIDEWALK WITH SAWCUTS	2 NEW CONCRETE CURB
3. EXISTING TREES TO BE PROTECTED FROM DAMAGE FOR DURATION OF WORK	NEW TOPSOIL AND SOD	3 NEW ASPHALT PAVING
	PROPERTY LINE	4 NEW CONTINUOUS CONCRETE SIDEWALK. REINSTATE ASPHALT ON EITHER SIDE AS REQUIRED WHERE SIDEWALK CROSSES EXISTING LANES
	CENTRELINE OF ROAD	5 NEW TOP SOIL AND SOD MIN. 1200MM WIDE
	NEW METAL POST AND 'NO PARKING, DROP OFF ONLY' SIGN	6 NEW METAL POST AND 'NO PARKING' SIGN
	DEPRESSED CURB	7 SLOPE CURB DOWN TO SIDEWALK
	TREE PROTECTION FENCING AROUND CRITICAL ROOT ZONE PER CITY OF OTTAWA STANDARD. SEE DETAIL ON A1	8 LINE OF PREVIOUS EXISTING CURB
		9 EXISTING CONCRETE CURB TO REMAIN
		10 NEW LINE PAINTING
		11 TREE PROTECTION FENCING AS PER CITY OF OTTAWA STANDARD. SEE DETAIL ON A1
		12 DEPRESSED CURB PER CITY OF OTTAWA STANDARD SC7.1. ALSO REFER TO CIVIL
		13 EXISTING YELLOW PAINTED CENTRELINE TO BE REPAINTED AS REQUIRED TO ENSURE 3.5m WIDE TRAVEL LANE IS PROVIDED IN EACH DIRECTION

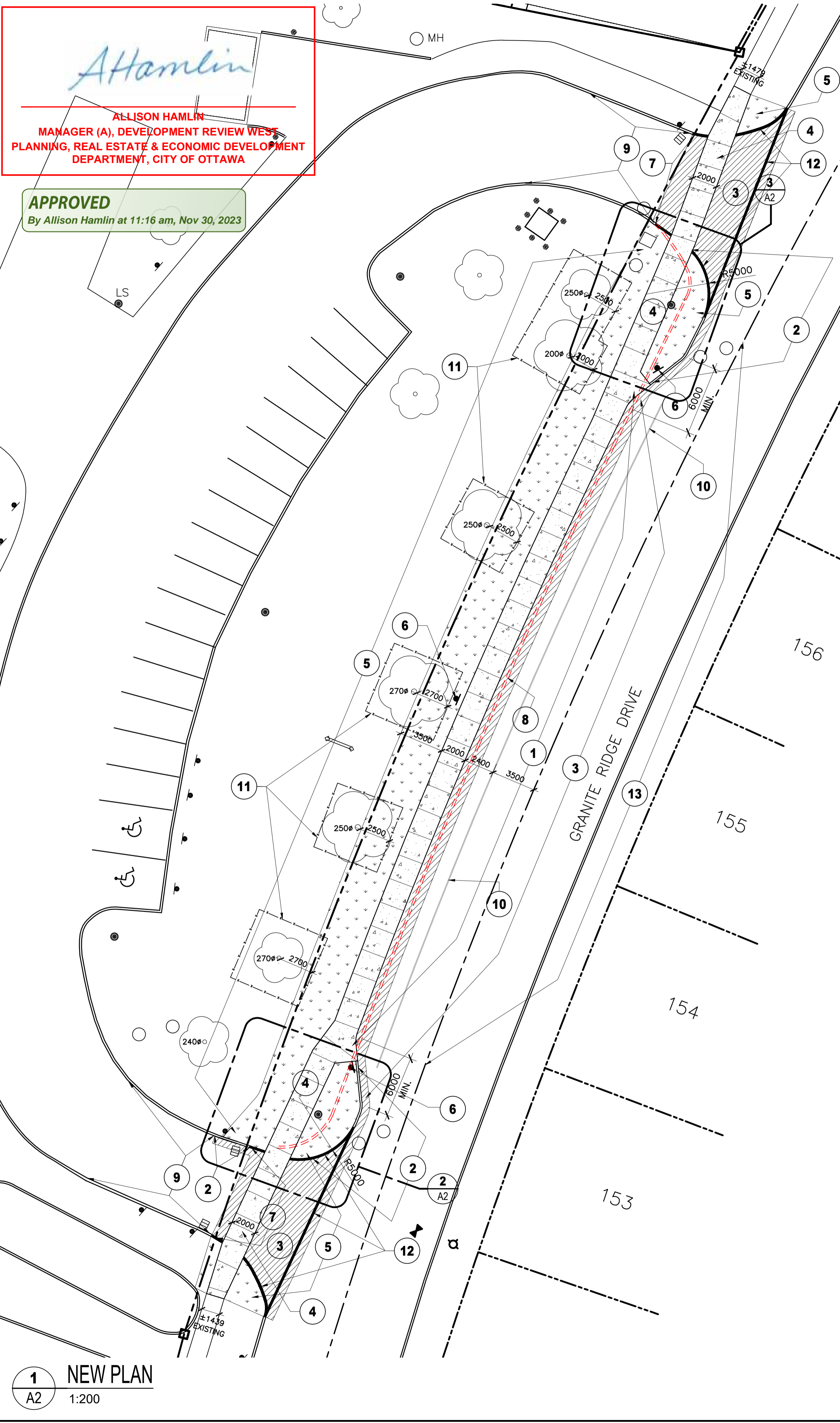

Allison Hamlin
ALLISON HAMLIN
MANAGER (A), DEVELOPMENT REVIEW WEST
PLANNING, REAL ESTATE & ECONOMIC DEVELOPMENT
DEPARTMENT, CITY OF OTTAWA

APPROVED
By Allison Hamlin at 11:16 am, Nov 30, 2023