

Attamlin

ALLISON HAMLIN
MANAGER (A), DEVELOPMENT REVIEW WEST
PLANNING, REAL ESTATE & ECONOMIC DEVELOPMENT
DEPARTMENT, CITY OF OTTAWA

APPROVED
By Allison Hamlin at 5:17 pm, Feb 29, 2024

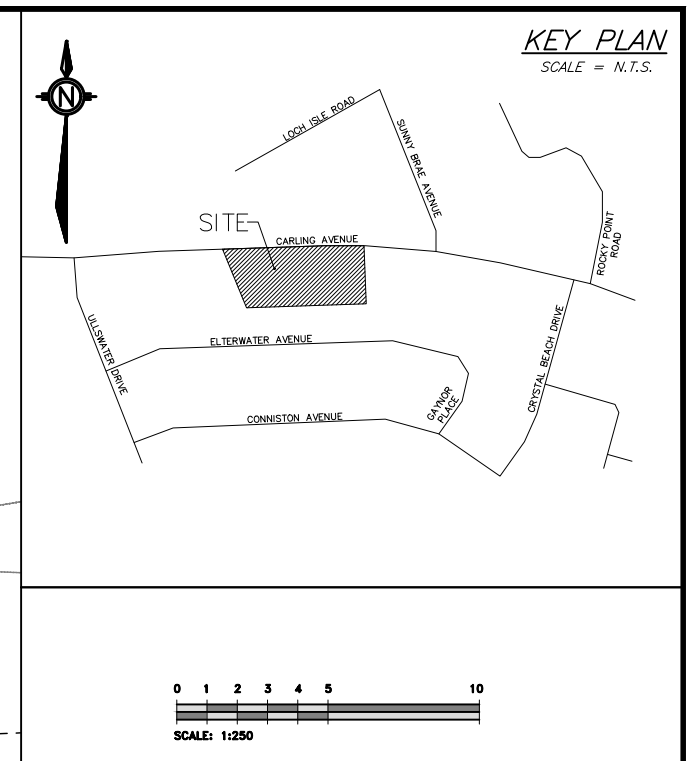

JOB BENCHMARK
PINE HYDRAUL
TOP OF SPINDLE
ELEV=68.53

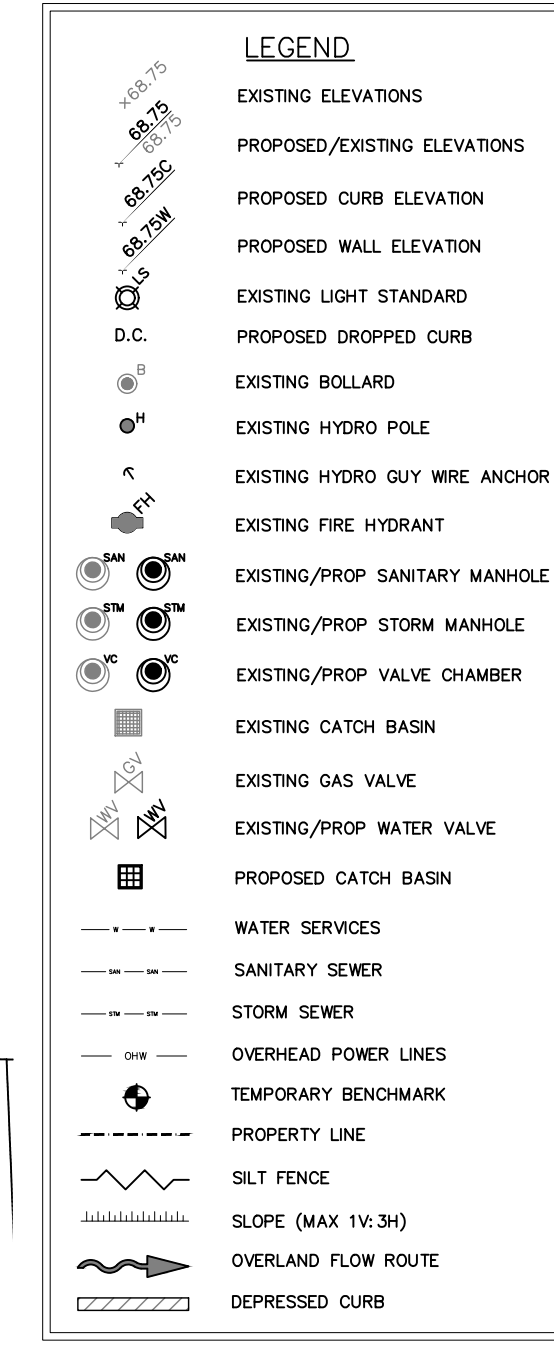
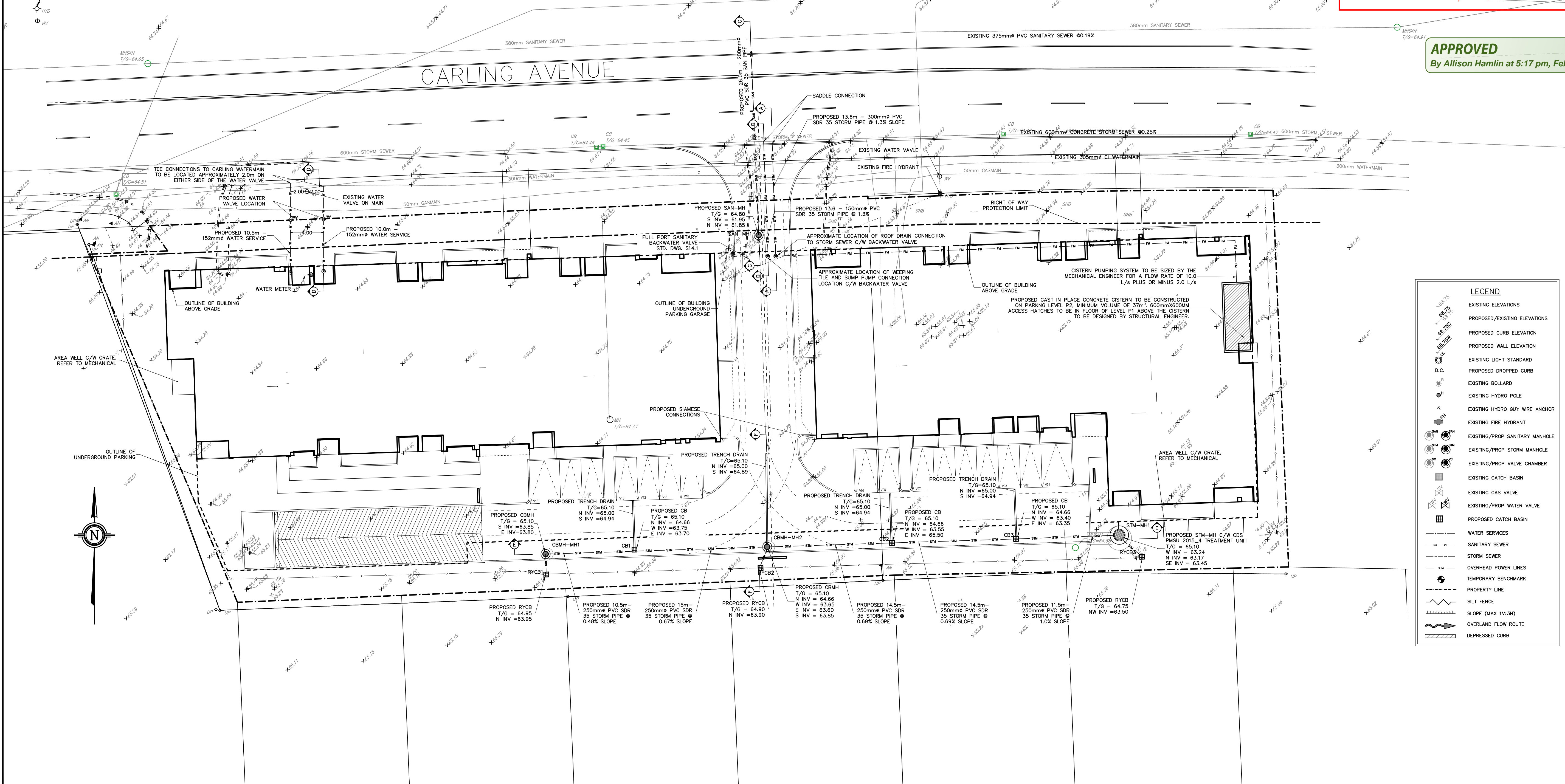

- SEWER NOTES: 1. SUPPLY AND CONSTRUCT ALL SEWERS AND APPURTENANCES IN ACCORDANCE WITH THE CITY OF OTTAWA STANDARDS AND SPECIFICATIONS AND ONTARIO PROVINCIAL STANDARDS FOR ROADS AND PUBLIC WORKS. 2. SPECIFICATIONS: ITEM SEC. No. CITY STD. DWG. No. ... WATERMAIN NOTES: 1. CITY TO SUPPLY, INSTALL & DISINFECT THE WATER SERVICE CONTRACTOR TO EXCAVATE, BACKFILL AND REINSTATE THE ROADWAY AS PER STD DWG R10.

SITE SERVICING PLAN
SCALE = 1:250

NOTES: 1. ALL DIMENSIONS ARE IN METRES, UNLESS OTHERWISE SPECIFIED. TOPOGRAPHIC SURVEY WAS PROVIDED BY STANTEC GEOMATICS LTD. TOPOGRAPHIC SURVEY IS GEODETIC AND REFERRED TO THE CGVD-1928:1978 GEODETIC DATUM. BEARINGS ARE GRID, DERIVED FROM CAN-NET VRS NETWORK. GPS OBSERVATIONS ARE REFERENCED TO SPECIFIED CONTROL POINTS 01919680005 AND 19773035 AND 19680191, NTM ZONE 9 (76°30' WEST LONGITUDE) NAD-83 (ORIGINAL). 2. THIS IS NOT A LEGAL SURVEY. 3. BOUNDARY INFORMATION DERIVED FROM STANTEC GEOMATICS LTD. 4. EXISTING SERVICES INFORMATION SHOWN ARE BASED ON BEST CURRENT INFORMATION. CONTRACTOR TO VERIFY EXACT LOCATION AND REPORT ANY DISCREPANCIES TO KOLLAARD ASSOCIATES INC. 5. CLIENT IS RESPONSIBLE FOR ACQUIRING ALL NECESSARY PERMITS. 6. CONTRACTOR TO VERIFY THAT APPROPRIATE PERMITS HAVE BEEN ACQUIRED PRIOR TO ANY CONSTRUCTION. 7. CONTRACTOR IS RESPONSIBLE FOR LOCATION AND PROTECTION OF UTILITIES. 8. ALL DIMENSIONS TO BE VERIFIED ON SITE BY CONTRACTOR PRIOR TO CONSTRUCTION. 9. THIS DRAWING IS NOT FOR CONSTRUCTION UNTIL ALL APPROVALS HAVE BEEN GRANTED. 10. INSPECTION OF ROUGH GRADE BY KOLLAARD ASSOCIATES INC. AND CITY OF OTTAWA MUST BE CONDUCTED PRIOR TO PLACEMENT OF TOPSOIL OR SOD. 11. HYDRO, GAS, COMMUNICATIONS SERVICE TO BE INSTALLED ACCORDING TO THE SPECIFICATIONS OF SERVICE PROVIDER AND THE MECHANICAL ENGINEER. 12. ALL MATERIALS AND CONSTRUCTION TO BE IN ACCORDANCE WITH CITY OF OTTAWA STANDARDS AND ONTARIO PROVINCIAL STANDARDS AND SPECIFICATIONS. 13. ANY CHANGES MADE TO THIS PLAN MUST BE VERIFIED AND APPROVED BY KOLLAARD ASSOCIATES, INC. 14. THIS DRAWING IS PART OF KOLLAARD ASSOCIATES DESIGN REPORT #220978.

No.	REVISION	DATE	BY
1	UPDATED SERVICE LOCATIONS	12.DEC.2023	NJR
2	UPDATED SERVICE LOCATIONS	11.DEC.2023	NJR
3	UPDATED SERVICE LOCATIONS	17.NOV.2023	NJR
4	UPDATED SERVICE LOCATIONS	23.AUG.2023	NJR
5	RESPONSE TO REVIEW COMMENTS	24.JUL.2023	NJR
6	RESPONSE TO 1ST REVIEW COMMENTS	28.MAR.2023	NJR
7	ISSUED FOR SITE PLAN CONTROL	14.DEC.2022	NJR

CONSULTANTS

DESIGN: NJR, DRAWN: NJR, CHECKED: SD, APPROVED: SD

CLIENT NAME: ROHIT COMMUNITIES INC.	PROJECT No: 220978
PROJECT NAME: PROPOSED RESIDENTIAL DEVELOPMENT	DATE: 14.DEC.2022
PROJECT LOCATION: 3430 CARLING AVENUE, OTTAWA, ONTARIO	SCALE: 1:250
DRAWING: SITE SERVICING PLAN	DRAWING No: 220978 - SER

Allison Hamlin

ALLISON HAMLIN
MANAGER (A), DEVELOPMENT REVIEW WEST
PLANNING, REAL ESTATE & ECONOMIC DEVELOPMENT
DEPARTMENT, CITY OF OTTAWA

APPROVED
 By Allison Hamlin at 5:17 pm, Feb 29, 2024

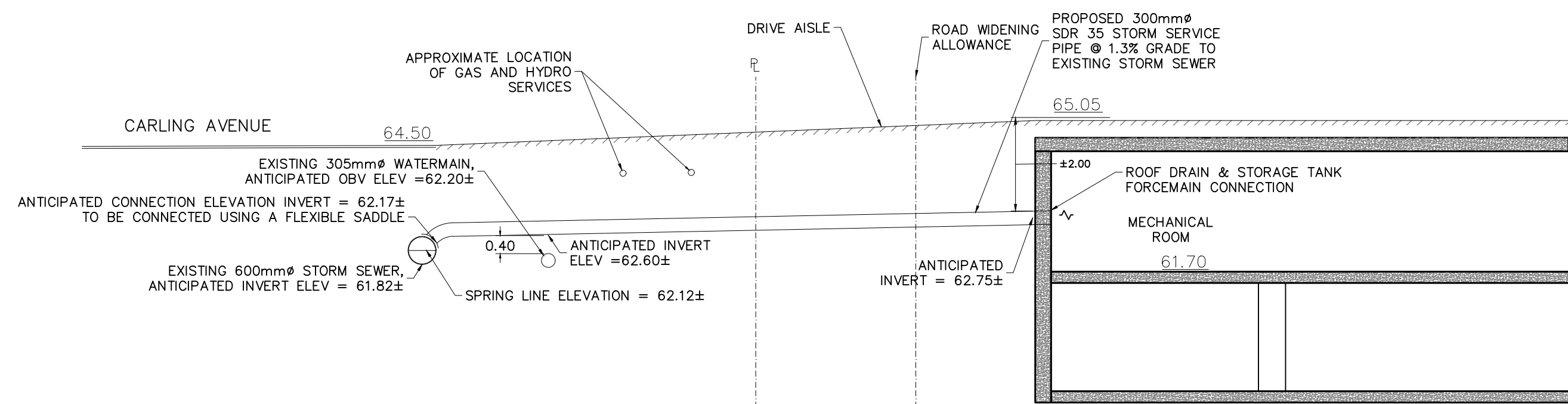

SECTION A-A STORM
 SCALE = N.T.S.

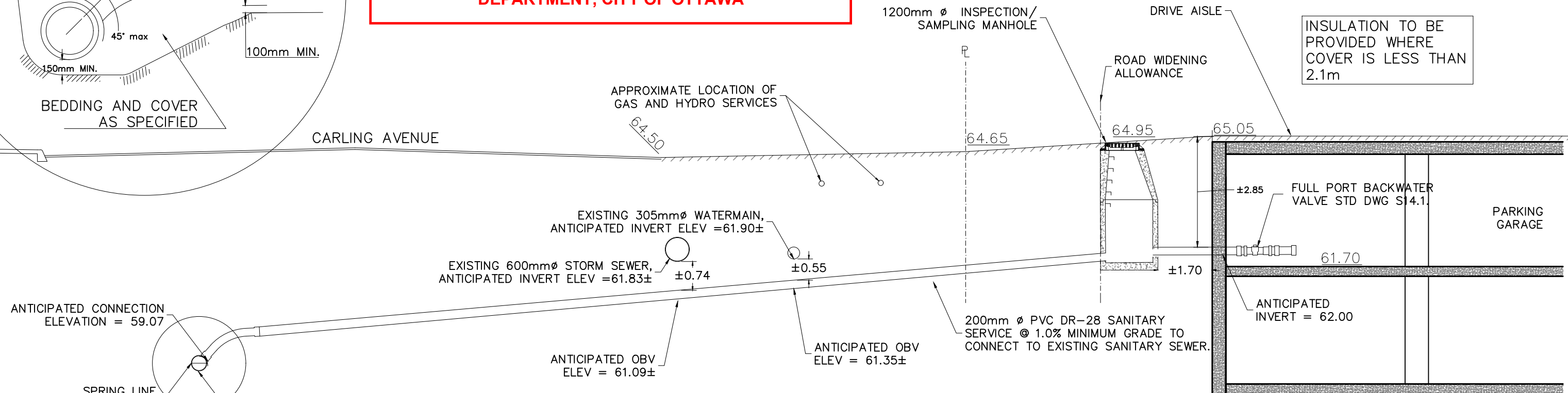
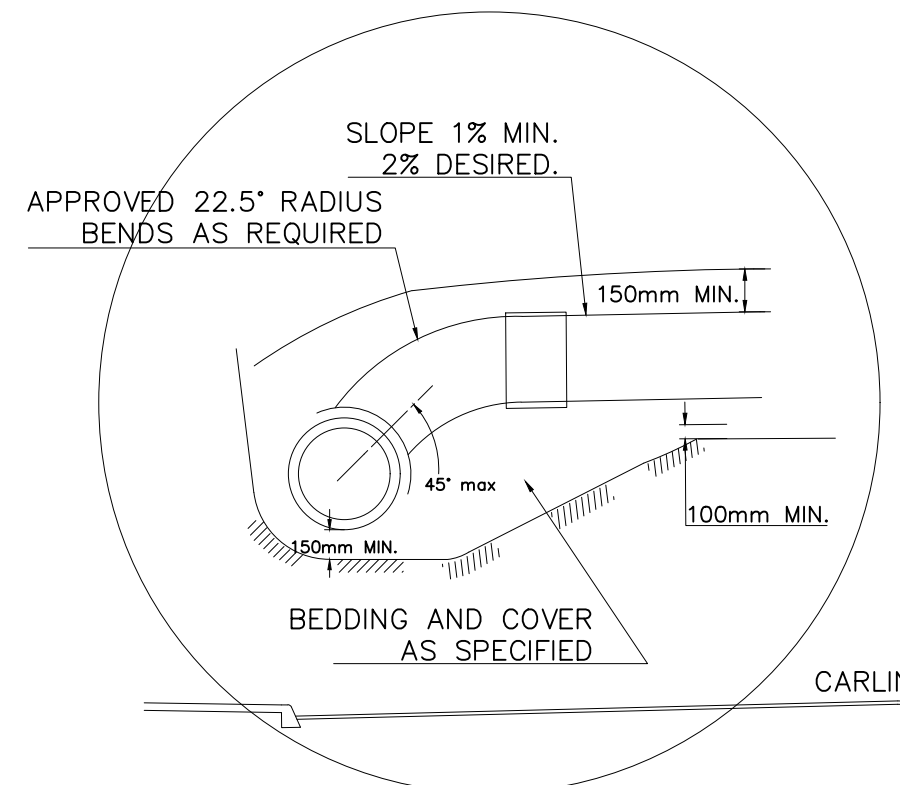

SECTION C-C SANITARY
 SCALE = N.T.S.

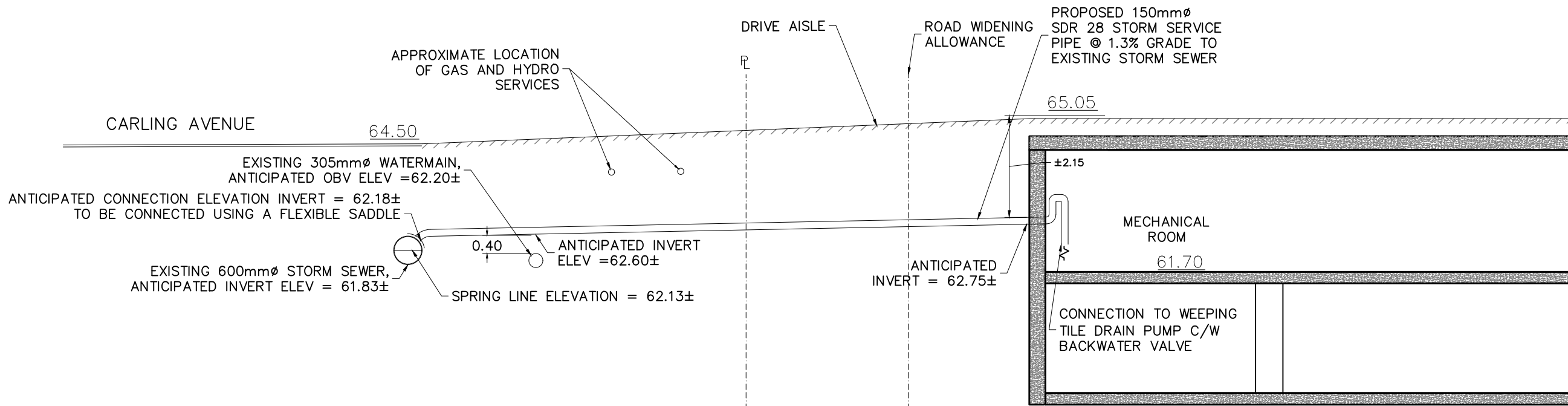

SECTION B-B STORM-WEeping TILE DRAIN
 SCALE = N.T.S.

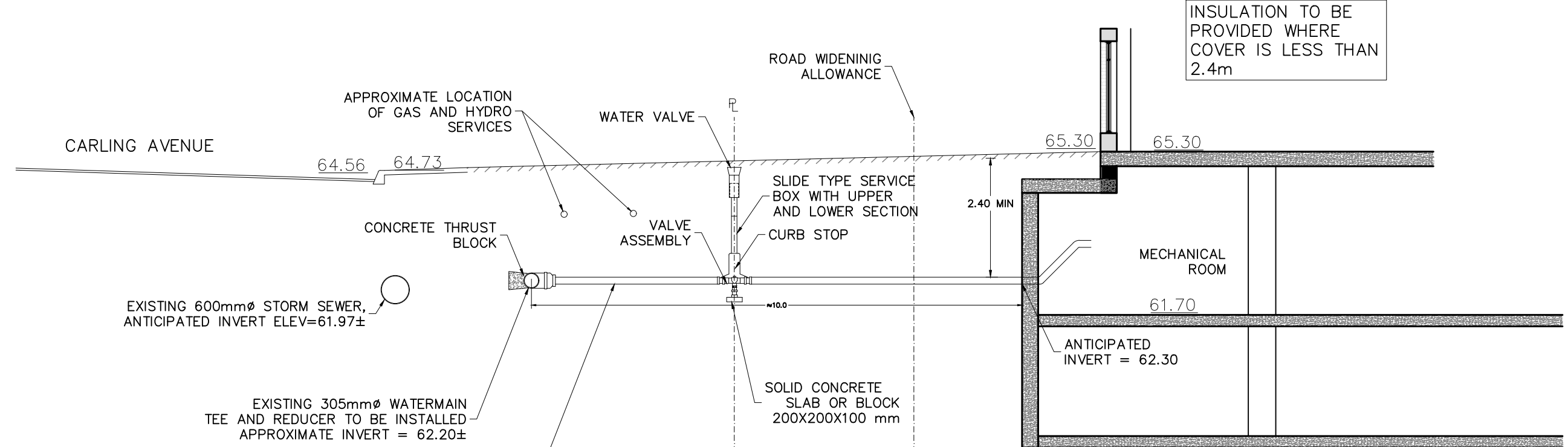

SECTION D-D WATER
 SCALE = N.T.S.

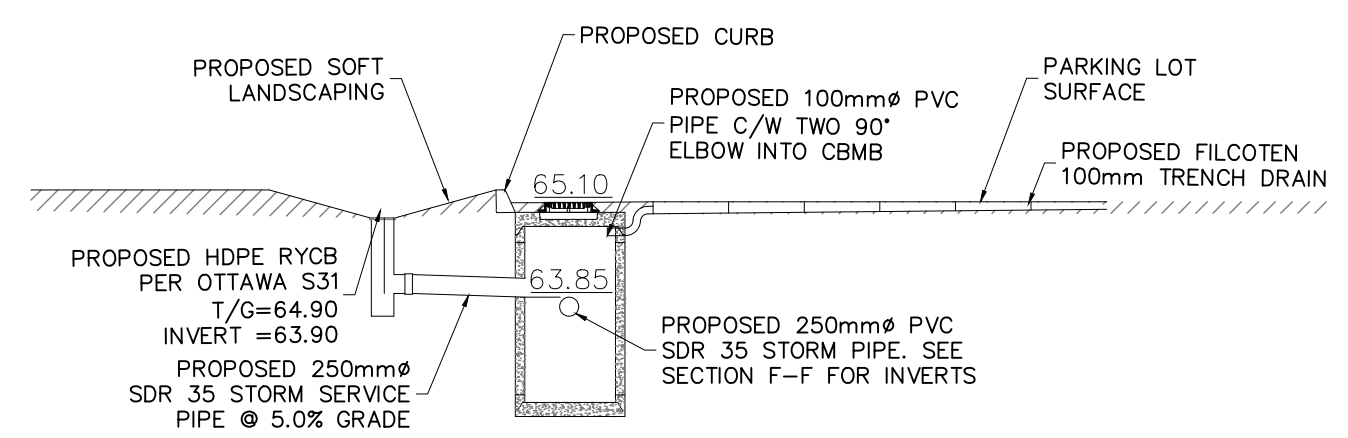

SECTION F-F STORM
 SCALE = N.T.S.

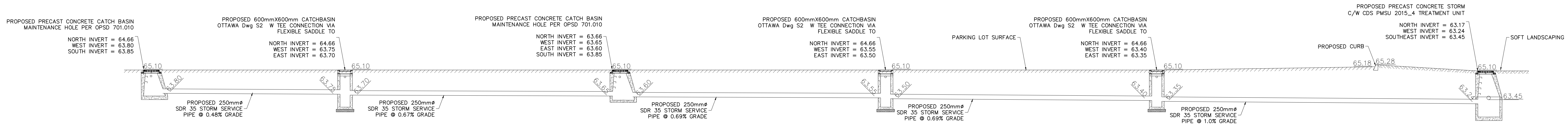

SECTION E-E STORM
 SCALE = N.T.S.

NOTES:

- ALL DIMENSIONS ARE IN METRES, UNLESS OTHERWISE SPECIFIED. TOPOGRAPHIC SURVEY WAS PROVIDED BY STANTEC GEOMATICS LTD. TOPOGRAPHIC SURVEY IS GEODETIC AND REFERRED TO THE CAN-1928-1978 GEODETIC DATUM. BEARINGS ARE GRID, DERIVED FROM CAN-NET VRS NETWORK. GPS OBSERVATIONS ARE REFERENCED TO SPECIFIED CONTROL POINTS 01919680005 AND 19773035 AND 19680191, MTM ZONE 9 (76°30' WEST LONGITUDE) NAD-83 (ORIGINAL).
- THIS IS NOT A LEGAL SURVEY.
- BOUNDARY INFORMATION DERIVED FROM STANTEC GEOMATICS LTD.
- EXISTING SERVICES INFORMATION SHOWN ARE BASED ON BEST CURRENT INFORMATION. CONTRACTOR TO VERIFY EXACT LOCATION AND REPORT ANY DISCREPANCIES TO KOLLAARD ASSOCIATES INC.
- CLIENT IS RESPONSIBLE FOR ACQUIRING ALL NECESSARY PERMITS.
- CONTRACTOR TO VERIFY THAT APPROPRIATE PERMITS HAVE BEEN ACQUIRED PRIOR TO ANY CONSTRUCTION.
- CONTRACTOR IS RESPONSIBLE FOR LOCATION AND PROTECTION OF UTILITIES.
- ALL DIMENSIONS TO BE VERIFIED ON SITE BY CONTRACTOR PRIOR TO CONSTRUCTION.
- THIS DRAWING IS NOT FOR CONSTRUCTION UNTIL ALL APPROVALS HAVE BEEN GRANTED.
- INSPECTION OF ROUGH GRADE BY KOLLAARD ASSOCIATES INC. AND CITY OF OTTAWA MUST BE CONDUCTED PRIOR TO PLACEMENT OF TOPSOIL OR SOIL.
- HYDRO, GAS, COMMUNICATIONS SERVICE TO BE INSTALLED ACCORDING TO THE SPECIFICATIONS OF SERVICE PROVIDER AND THE MECHANICAL ENGINEER.
- ALL MATERIALS AND CONSTRUCTION TO BE IN ACCORDANCE WITH CITY OF OTTAWA STANDARDS AND ONTARIO PROVINCIAL STANDARDS AND SPECIFICATIONS.
- ANY CHANGES MADE TO THIS PLAN MUST BE VERIFIED AND APPROVED BY KOLLAARD ASSOCIATES, INC.
- THIS DRAWING IS PART OF KOLLAARD ASSOCIATES DESIGN REPORT #220978.

NO.	REVISION	DATE	BY
1	ISSUED FOR SITE PLAN CONTROL	14-DEC-2022	NJR
2	RESPONSE TO 1ST REVIEW COMMENTS	28-MAR-2023	NJR
3	UPDATED SOUTHERN BERM LOCATION	23-AUG-2023	NJR
4	UPDATED SERVICE LOCATIONS	17-NOV-2023	NJR
5	UPDATED SERVICE LOCATIONS	11-DEC-2023	NJR
6	UPDATED SERVICE LOCATIONS	12-DEC-2023	NJR

Rohit COMMUNITIES

Kollaard Associates Engineers

BOX 189
 210 PRESOTT STREET
 KEMPVILLE, ONTARIO
 K0G 1J0
 FACSIMILE (613) 258-0475

(613) 860-0923

LICENCED PROFESSIONAL ENGINEER

12-DEC-2023
 S.E. deWit
 100079612

PROVINCE OF ONTARIO

CLIENT NAME	ROHIT COMMUNITIES INC.	PROJECT No.	220978
PROJECT NAME	PROPOSED RESIDENTIAL DEVELOPMENT	DATE	14-DEC-2022
PROJECT LOCATION	3430 CARLING AVENUE, OTTAWA, ONTARIO	SCALE	N.T.S.
DRAWING	SITE SERVICING DETAILS	DRAWING No.	220978 - DET

Allison Hamlin
MANAGER (A), DEVELOPMENT REVIEW WEST
PLANNING, REAL ESTATE & ECONOMIC DEVELOPMENT
DEPARTMENT, CITY OF OTTAWA

APPROVED
By Allison Hamlin at 5:17 pm, Feb 29, 2024

- EROSION AND SEDIMENT CONTROL NOTES:**
- THE CONTRACTOR SHALL IMPLEMENT BEST MANAGEMENT PRACTICES, TO PROVIDE FOR PROTECTION OF THE STORM SEWER SYSTEM, DURING CONSTRUCTION ACTIVITIES. THE CONTRACTOR ACKNOWLEDGES THAT FAILURE TO IMPLEMENT APPROPRIATE EROSION AND SEDIMENT CONTROL MEASURES MAY BE SUBJECT TO PENALTIES IMPOSED BY ANY APPLICABLE REGULATORY AGENCY.
 - THE OWNER (AND/OR CONTRACTOR) AGREES TO PREPARE AND IMPLEMENT AN EROSION AND SEDIMENT CONTROL PLAN AT LEAST EQUAL TO THE STATED MINIMUM REQUIREMENTS AND TO THE SATISFACTION OF THE CITY OF OTTAWA, APPROPRIATE TO THE SITE CONDITIONS, PRIOR TO UNDERTAKING ANY SITE ALTERATIONS (FILLING, GRADING, REMOVAL OF VEGETATION, ETC.) AND DURING ALL PHASES OF SITE PREPARATION AND CONSTRUCTION IN ACCORDANCE WITH THE CURRENT BEST MANAGEMENT PRACTICES FOR EROSION AND SEDIMENT CONTROL.
 - THE CONTRACTOR IS TO ENSURE THAT THE SITE ACCESS POINTS AND ADJACENT STREETS TO THE ACCESS POINTS ARE MAINTAINED AND KEPT CLEAN OF CONSTRUCTION MATERIALS SUCH AS, BUT NOT LIMITED TO, MUD, DIRT, CLAY AND GRANULARS ON A DAILY BASIS OR AS NECESSARY, TO THE SATISFACTION OF THE CITY OF OTTAWA.
 - EVERY EFFORT WILL BE MADE TO ENSURE THAT ALL DISTURBED AREAS ARE TOPSOILED AND SEEDED AS SOON AS REASONABLY POSSIBLE.
 - THE SEDIMENT AND EROSION CONTROL PLAN IS A LIVING DOCUMENT WHICH MAY BE AMENDED BY ONSITE REQUIREMENTS AT THE APPROVAL OF THE MUNICIPALITY AND THE CONSERVATION AUTHORITY.
 - ALL SEDIMENT AND EROSION CONTROL MEASURES TO BE INSPECTED/CLEANED AFTER RAIN EVENTS.
 - MUD MAT OR MECHANICAL TRACKOUT PLATE TO BE INSTALLED AT CONSTRUCTION SITE ENTRANCE.
- MINIMUM EROSION AND SEDIMENT CONTROL PLAN REQUIREMENTS:**
- TIME THE DEMOLITION AND EXCAVATION ACTIVITIES SO THAT THEY OCCUR NO SOONER THAN IS NECESSARY FOR SUBSEQUENT CONSTRUCTION ACTIVITIES.
 - LANDSCAPE THE SITE AS SOON AS PRACTICALLY POSSIBLE.
 - USE SILT FENCES AROUND ANY STRUCTURES TO BE CONSTRUCTED.
 - PRIOR TO CONSTRUCTION, SILT FENCE BARRIERS (OPSD 219.110) WILL BE PLACED ALONG THE PROPERTY LINES AS ON THE DRAWING.
 - THE SILT FENCE SHOULD BE REMOVED ONLY WHEN THE SITE IS STABILIZED.
 - FILTER SOCKS SHOULD BE INSTALLED ACROSS EXISTING STORM MANHOLE AND CATCH BASIN LIDS, AS WELL AS WELL FILTER SOCKS SHOULD BE INSTALLED ACROSS THE PROPOSED CATCH BASIN AND MANHOLE LIDS IMMEDIATELY AFTER THE STRUCTURES ARE PLACED. THE FILTER SOCKS SHOULD ONLY BE REMOVED ONCE THE ASPHALTIC CONCRETE IS INSTALLED AND THE SITE IS CLEANED.

LEGEND

- EXISTING ELEVATIONS
- PROPOSED/EXISTING ELEVATIONS
- PROPOSED CURB ELEVATION
- PROPOSED WALL ELEVATION
- EXISTING LIGHT STANDARD
- EXISTING DROPPED CURB
- EXISTING BOLLARD
- EXISTING HYDRO POLE
- EXISTING HYDRO GUY WIRE ANCHOR
- EXISTING FIRE HYDRANT
- EXISTING/PROP SANITARY MANHOLE
- EXISTING/PROP STORM MANHOLE
- EXISTING/PROP VALVE CHAMBER
- EXISTING CATCH BASIN
- EXISTING GAS VALVE
- EXISTING/PROP WATER VALVE
- PROPOSED CATCH BASIN
- WATER SERVICES
- SANITARY SEWER
- STORM SEWER
- OVERHEAD POWER LINES
- TEMPORARY BENCHMARK
- PROPERTY LINE
- SILT FENCE
- SLOPE (MAX 1V:3H)
- OVERLAND FLOW ROUTE
- DEPRESSED CURB

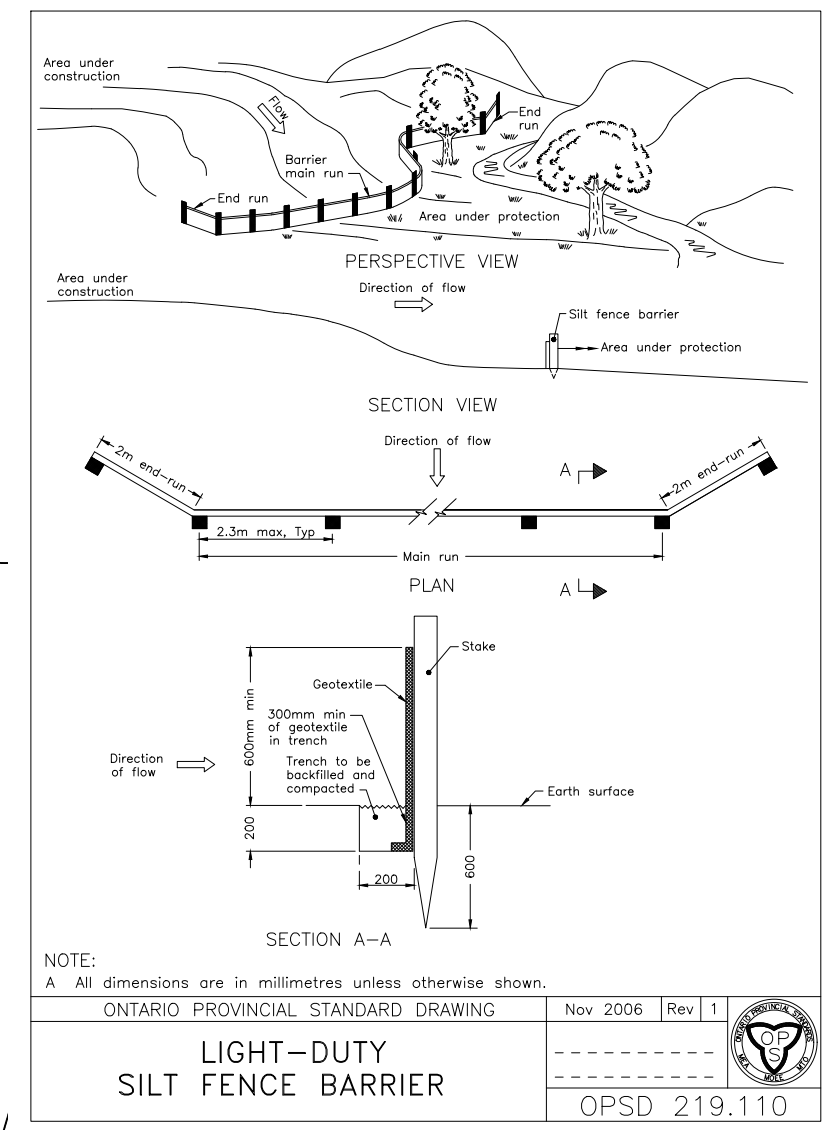

EROSION CONTROL PLAN
SCALE = 1:250

- NOTES:**
- ALL DIMENSIONS ARE IN METRES, UNLESS OTHERWISE SPECIFIED. TOPOGRAPHIC SURVEY WAS PROVIDED BY STANTEC GEOMATICS LTD. TOPOGRAPHIC SURVEY IS GEODETIC AND REFERRED TO THE CAN-1928-1978 GEODETIC DATUM. BEARINGS ARE GRID, DERIVED FROM CAN-NET VRS NETWORK. GPS OBSERVATIONS ARE REFERENCED TO SPECIFIED CONTROL POINTS 01919680005 AND 19773035 AND 19680191, MTM ZONE 9 (76°30' WEST LONGITUDE) NAD-83 (ORIGINAL).
 - THIS IS NOT A LEGAL SURVEY.
 - BOUNDARY INFORMATION DERIVED FROM STANTEC GEOMATICS LTD.
 - EXISTING SERVICES INFORMATION SHOWN ARE BASED ON BEST CURRENT INFORMATION. CONTRACTOR TO VERIFY EXACT LOCATION AND REPORT ANY DISCREPANCIES TO KOLLAARD ASSOCIATES INC.
 - CLIENT IS RESPONSIBLE FOR ACQUIRING ALL NECESSARY PERMITS.
 - CONTRACTOR TO VERIFY THAT APPROPRIATE PERMITS HAVE BEEN ACQUIRED PRIOR TO ANY CONSTRUCTION.
 - CONTRACTOR IS RESPONSIBLE FOR LOCATION AND PROTECTION OF UTILITIES.
 - ALL DIMENSIONS TO BE VERIFIED ON SITE BY CONTRACTOR PRIOR TO CONSTRUCTION.
 - THIS DRAWING IS NOT FOR CONSTRUCTION UNTIL ALL APPROVALS HAVE BEEN GRANTED.
 - INSPECTION OF ROUGH GRADE BY KOLLAARD ASSOCIATES INC. AND CITY OF OTTAWA MUST BE CONDUCTED PRIOR TO PLACEMENT OF TOPSOIL OR SOD.
 - HYDRO, GAS, COMMUNICATIONS SERVICE TO BE INSTALLED ACCORDING TO THE SPECIFICATIONS OF SERVICE PROVIDER AND THE MECHANICAL ENGINEER.
 - ALL MATERIALS AND CONSTRUCTION TO BE IN ACCORDANCE WITH CITY OF OTTAWA STANDARDS AND ONTARIO PROVINCIAL STANDARDS AND SPECIFICATIONS.
 - ANY CHANGES MADE TO THIS PLAN MUST BE VERIFIED AND APPROVED BY KOLLAARD ASSOCIATES, INC.
 - THIS DRAWING IS PART OF KOLLAARD ASSOCIATES DESIGN REPORT #220978.

NO.	REVISION	DATE	BY
6	NO CHANGES TO THIS SHEET	12.DEC.2023	NJR
5	NO CHANGES TO THIS SHEET	11.DEC.2023	NJR
4	NO CHANGES TO THIS SHEET	17.NOV.2023	NJR
3	NO CHANGES TO THIS SHEET	23.AUG.2023	NJR
2	NO CHANGES TO THIS SHEET	24.JUL.2023	NJR
1	NO CHANGES TO THIS SHEET	28.MAR.2023	NJR
0	ISSUED FOR SITE PLAN CONTROL	14.DEC.2022	NJR

CONSULTANTS

Rohit Communities	210 PRESOTT STREET KENTVILLE, ONTARIO K0G 1J0 FACSIMILE (613) 258-0475
--------------------------	---

Kollaard Associates Engineers

12.DEC.2023
S.E. deWit
100079612
PROVINCE OF ONTARIO

DESIGN	NJR
DRAWN	NJR
CHECKED	SD
APPROVED	SD

CLIENT NAME
ROHIT COMMUNITIES INC.

PROJECT NAME
PROPOSED RESIDENTIAL DEVELOPMENT

PROJECT LOCATION
3430 CARLING AVENUE, OTTAWA, ONTARIO

DRAWING
EROSION CONTROL PLAN

PROJECT NO.	220978
DATE	14.DEC.2022
SCALE	1:250
DRAWING NO.	220978-ER