

GENERAL NOTES:

- 1. COORDINATE AND SCHEDULE ALL WORK WITH OTHER TRADES AND CONTRACTORS.
2. DETERMINE THE EXACT LOCATION, SIZE, MATERIAL AND ELEVATION OF ALL EXISTING UTILITIES PRIOR TO COMMENCING CONSTRUCTION...

SEWER NOTES:

- 1. SUPPLY AND CONSTRUCT ALL SEWERS AND APPURTENANCES IN ACCORDANCE WITH THE MOST CURRENT CITY OF OTTAWA STANDARDS AND SPECIFICATIONS...
2. SPECIFICATIONS: ITEM, CATCHBASIN (600x600mm), STORM / SANITARY MANHOLE (1200mmØ)...

EROSION AND SEDIMENT CONTROL NOTES:

THE CONTRACTOR SHALL IMPLEMENT BEST MANAGEMENT PRACTICES, TO PROVIDE FOR PROTECTION OF THE AREA DRAINAGE SYSTEM AND THE RECEIVING WATERCOURSE, DURING CONSTRUCTION ACTIVITIES...

- 1. ALL EROSION AND SEDIMENT CONTROLS ARE TO BE INSTALLED TO THE SATISFACTION OF THE ENGINEER AND THE CITY OF OTTAWA.
2. EROSION AND SEDIMENT CONTROL MEASURES WILL BE IMPLEMENTED DURING CONSTRUCTION IN ACCORDANCE WITH THE 'GUIDELINES ON EROSION AND SEDIMENT CONTROL FOR URBAN CONSTRUCTION SITES'...

WATERMAIN NOTES:

- 1. SUPPLY AND CONSTRUCT ALL WATERMANS AND APPURTENANCES IN ACCORDANCE WITH THE CITY OF OTTAWA STANDARDS AND SPECIFICATIONS...
2. SPECIFICATIONS: ITEM, WATERMAIN TRENCHING, HYDRANT INSTALLATION, THERMAL INSULATION IN SHALLOW TRENCHES...

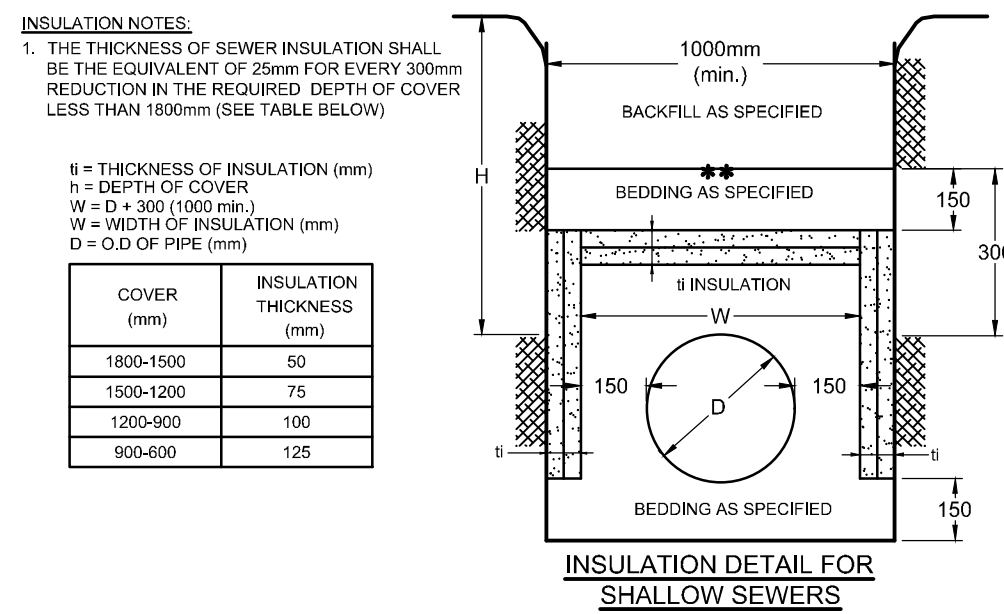

PROPOSED 300mmØ WATERMAIN TABLE: OFF-SITE EXTENSION

Table with columns: STATION, SURFACE ELEVATION, TWM ELEVATION, COMMENTS. Lists stationing from 5+000 to 5+091.7 with corresponding elevations and comments like 'INSULATE WATERMAIN AT CROSSING BELOW ROADSIDE DITCH'.

- CONNECTIONS TO EXISTING 300mmØ and 200mmØ WATERMANS. EXACT ELEVATIONS TO BE FIELD DETERMINED.
PROVIDE THERMAL INSULATION AS PER CITY OF OTTAWA DETAILS W22 IN SHALLOW TRENCHES WHERE COVER IS LESS THAN 2.4m AND/OR W23 ADJACENT TO OPEN STRUCTURES.

INLET CONTROL DEVICE DATA TABLE: AREA A-1 (OUTLET PIPE OF CB 01)

Table with columns: DESIGN EVENT, ICD TYPE (PLUG TYPE), DIAMETER OF OUTLET PIPE (mm), PEAK DESIGN FLOW (L/s), DESIGN HEAD (m), WATER ELEVATION (m), VOLUME (m³), AVAILABLE STORAGE. Lists events for 1.2 YR, 1.5 YR, and 11.00 YR.

PROPOSED 300mmØ WATERMAIN TABLE: EAST / WEST ON-SITE LOOP

Main watermain table with columns: STATION, SURFACE ELEVATION, TWM ELEVATION, COMMENTS. Lists stationing from 0+000 to 4+004.9 with various comments including 'CONNECTION TO EXISTING 300mmØ WATERMAIN TEE' and 'CROSS BELOW 250mmØ STM'.

- CONNECTIONS TO EXISTING 300mmØ and 200mmØ WATERMANS. EXACT ELEVATIONS TO BE FIELD DETERMINED.
PROVIDE THERMAL INSULATION AS PER CITY OF OTTAWA DETAILS W22 IN SHALLOW TRENCHES WHERE COVER IS LESS THAN 2.4m AND/OR W23 ADJACENT TO OPEN STRUCTURES.

INLET CONTROL DEVICE DATA TABLE: AREA A-4 (OUTLET PIPE OF STM MH 04)

Table with columns: DESIGN EVENT, ICD TYPE (PLUG TYPE), DIAMETER OF OUTLET PIPE (mm), PEAK DESIGN FLOW (L/s), DESIGN HEAD (m), WATER ELEVATION (m), VOLUME (m³), AVAILABLE STORAGE. Lists events for 1.2 YR, 1.5 YR, and 11.00 YR.

LEGEND

Legend defining symbols for SITE BOUNDARY, PROPOSED ELEVATION, PROPOSED SWALE ELEVATION, PROPOSED TERRACE ELEVATION, PARKING GRADE AND DIRECTION, PROPOSED FINISHED FLOOR ELEVATION, PROPOSED UNDER SIDE OF FOOTING ELEVATION, PROPOSED BUILDING ENTRANCE, PROPOSED LIMIT OF BUILDING OVERHANG, TOP OF GRATE ELEVATION, PROPOSED STORM MANHOLE, PROPOSED CATCHBASIN, PROPOSED CATCHBASIN WITH TEMPORARY SILTSACK, PROPOSED CATCHBASIN TEE, PROPOSED CATCHBASIN ELBOW, PROPOSED STORM SEWER AND DIRECTION OF FLOW, PROPOSED CATCHBASIN LEAD AND DIRECTION OF FLOW, PROPOSED CATCHBASIN SUBDRAIN TOP AND DIRECTION OF FLOW, PROPOSED SANITARY MANHOLE, PROPOSED SANITARY SEWER AND DIRECTION OF FLOW, PROPOSED WATERMAIN, PROPOSED BEND AND THRUSTBLOCK, PROPOSED VALVE AND VALVE BOX, PROPOSED HYDRANT CW VALVE & LEAD, PROPOSED CAP, PIPE CROSSING LOCATION, PROPOSED ROOF DRAIN, PROPOSED BARRIER CURB, PROPOSED DEPRESSED CURB, TACTILE WALKING SURFACE INDICATOR (TWSI), CURB CUTOUT, PROPOSED LIGHT STANDARD, PROPOSED SIAMENSE CONNECTION, PROPOSED GAS METER LOCATION, PROPOSED HYDRO METER LOCATION, PROPOSED TRANSFORMER PAD CW BOLLARDS, CLAY DIKE AS PER CITY OF OTTAWA DETAIL S8, SILT FENCE AS PER OPSD 219.110, MAJOR OVERLAND FLOW ROUTE, STRAW BALES AS PER OPSD 219.100, CONSTRUCTION ACCESS MUD MAT, PROPOSED INLET CONTROL DEVICE, APPROXIMATE PONDING LIMITS, STORM DRAINAGE BOUNDARY, AREA (ha), SUB-CATCHMENT AREA ID, 1.5 YR POST-DEVELOPMENT RUNOFF COEFFICIENT, EXISTING ELEVATION, EXISTING STORM MANHOLE AND SEWER, EXISTING SANITARY MANHOLE AND SEWER, EXISTING WATERMAIN, EXISTING WATER MANHOLE, EXISTING VALVE AND VALVE BOX, EXISTING FIRE HYDRANT, EXISTING CATCHBASIN, EXISTING TOP OF GRATE, EXISTING UTILITY POLE C/W GUY WIRES, EXISTING LIGHT STANDARD, EXISTING TRAFFIC STREET LIGHT, EXISTING FENCE, EXISTING UNDERGROUND GASMAIN, EXISTING UNDERGROUND HYDRO, EXISTING UNDERGROUND BELL CABLE, EXISTING BELL PEDESTAL, EXISTING TREES / SHRUBS, HEAVY DUTY ASPHALT/FIRE ROUTE, INTERLOCK PAVING STONES, ROADCUIT REINSTATEMENT, WATERMAIN INSULATION AREA AS PER CITY OF OTTAWA DETAIL W22

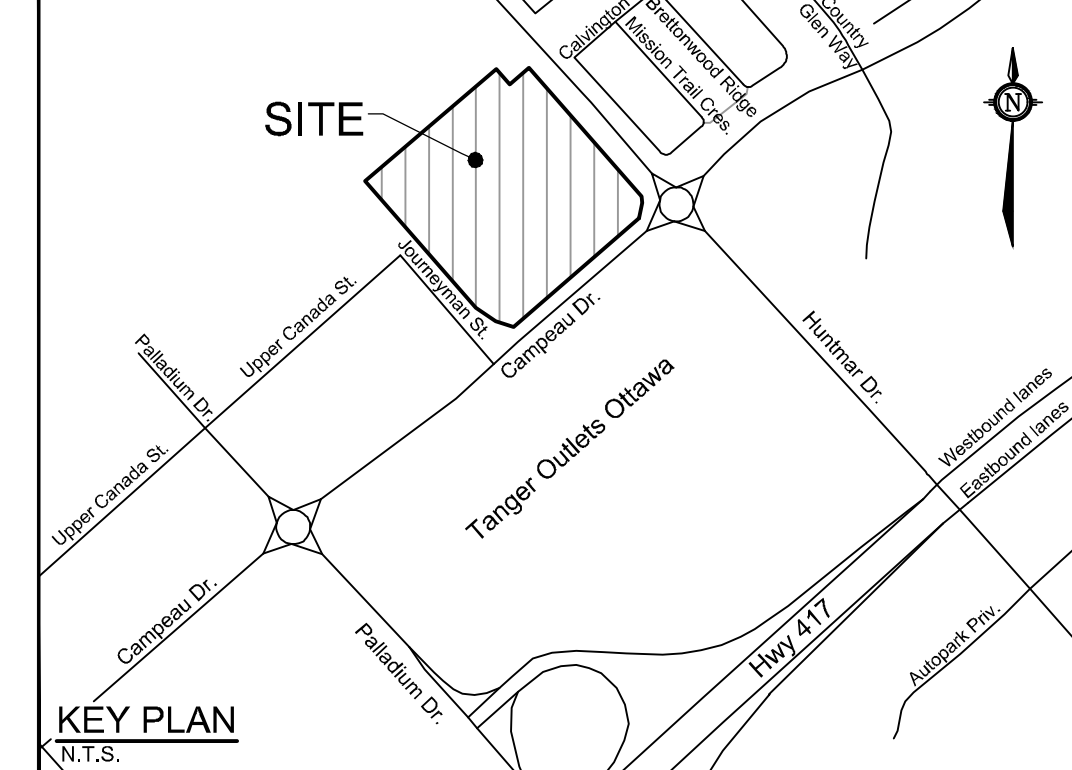

BENCHMARK INFO: OLS JOB BENCHMARK No. 2 ON THE TOP OF SPINDLE OF THE EXISTING MUNICIPAL FIRE HYDRANT LOCATED NEAR THE NORTH-EAST CORNER OF THE INTERSECTION OF JOURNEYMAN STREET AND CAMPEAU DRIVE...

CRITICAL SEWER PIPE CROSSING TABLE. Table with columns: CROSSING, LOWER PIPE, HIGHER PIPE, CLEARANCE, SURFACE ELEVATION. Lists crossings for 250mmØ SAN, 200mmØ STM, 150mmØ STM, 100mmØ STM, 300mmØ STM, 200mmØ STM, 150mmØ STM, 100mmØ STM, 300mmØ TWM, 250mmØ STM.

ALL PROJECT NOTES, DETAILS AND SPECIFICATIONS ARE TO MEET THE MOST CURRENT AND AMENDED VERSIONS OF THE CITY OF OTTAWA AND PROVINCIAL STANDARDS

THIS PLAN IS TO BE READ IN CONJUNCTION WITH CIVIL PLANS 122151-GP1&2, 122151-GR1&2 AND 122151-PR1

NOTE: THE POSITION OF ALL POLE LINES, CONDUITS, WATERMANS, SEWERS AND OTHER UNDERGROUND AND OVERGROUND UTILITIES AND STRUCTURES IS NOT NECESSARILY SHOWN ON THE CONTRACT DRAWINGS, AND WHERE SHOWN, THE ACCURACY OF THE POSITION OF SUCH UTILITIES AND STRUCTURES IS NOT GUARANTEED. BEFORE STARTING WORK, DETERMINE THE EXACT LOCATION OF ALL SUCH UTILITIES AND STRUCTURES AND ASSUME ALL LIABILITY FOR DAMAGE TO THEM.

SCALE: NOT TO SCALE. DESIGN: SM / BM / DDB. CHECKED: DDB. DRAWN: SM. CHECKED: BM / DDB. APPROVED: DDB. FOR REVIEW ONLY. Includes a professional engineer seal for D.D. Blair.

NOVATECH logo and contact information: Engineers, Planners & Landscape Architects, Suite 200, 240 Michael Cowpland Drive, Ottawa, Ontario, Canada K2M 1P6. Phone: (613) 254-9643. Website: www.novatech-eng.com. Includes project name: CITY OF OTTAWA 405 HUNTMAR DRIVE - WAREHOUSE DEVELOPMENT. Drawing name: NOTES, LEGEND AND DETAILS. Project No: 122151. Rev #2. Drawing No: 122151-ND1. Includes a large number #18906.