

LEGEND

- 3-D1** DETAIL SHEET # NOVATECH OR CITY
EG. L1, L2, ETC. DETAIL NUMBER SEE LIST
FOR CODE
- PROPERTY LIMIT
- PROPOSED CONCRETE
- PROPOSED PLANTING BED
- SOD
- SEED MIX A - SEE NOTE
- SEED MIX B - SEE NOTE
- SEED MIX C - SEE NOTE
- PROPOSED DECIDUOUS TREE
- PROPOSED CONIFEROUS TREE
- EXISTING TREE TO REMAIN
- EXISTING HEDGEROW TO REMAIN

GENERAL

1. Read and interpret this drawing/ drawing set in conjunction with all the contract details and specifications, including related civil, utility, structural, architectural, mechanical, electrical, environmental, geotechnical, and survey information.
2. The Contractor is to determine the exact location, size, material, and elevation of all existing utilities prior to commencing construction. Protect and assume responsibility for all existing utilities regardless of being shown on the drawings.
3. It is essential to use the plans and details in conjunction with the specifications and notes.
4. Do not scale drawings. Work to dimensions only.
5. Protect all existing and retained vegetation for the duration of construction according to the contract details and specifications.
6. Reinstatement all areas and items damaged or disturbed, beyond the Limit of Work, because of construction activities, including but not limited to construction staging areas, haul roads, stockpile areas, etc. to the satisfaction of the Consultant. Unless otherwise noted, Contractor is to reinstate all areas to pre-construction condition or better to the satisfaction of the Contract Administrator.

CITY DETAILS

Related details from City of Ottawa Standard Tender Documents Volume No. 2 Standard Detail Drawings.

SC4. Typical Concrete Sidewalk in Boulevard
SC5. Sidewalk Construction Joints

NOVATECH DETAILS

- Found on Sheet L7.
- D1. Standard Deciduous Tree Planting
 - D2. Standard Coniferous Tree Planting
 - D3. Shrub and Perennial Planting
 - D4. Tree Protection Fence
 - D5. Bike Layout
 - D6. Site furniture installation
 - D7. Reforestation
 - D8. Riverstone

PRODUCT INFORMATION

- Install products as per manufacturer specifications. Shop drawings required.
- SITE FURNITURE**
Fasten all site furnishing to surface with stainless steel anti-vandal anchors.
- Accessible 400 Bench by Maglin
Product Number: MMP-0400-00034
Size: 72.75" Length
Frame colour: Gunmetal
Slats: Ipe
Options: Steel ends, end arms and centre arm 9" ht.
 - Mug Bike Rack by Maglin
Product Number: MBR-0500-00001
Fixture: Direct Burial
Colour: Gunmetal Gloss Post

EXISTING VEGETATION

1. No clearing of vegetation should occur between April 15th and August 15. Should clearing be necessary during this time, a survey is to be conducted by a biologist (approved by the Landscape Architect) to determine that no nesting is occurring within 5 days prior to clearing.
2. Should any clearing be required before April 15th, a pre-clearing survey for active stick nests and cavity nests must also occur between April 1 and April 15, to identify and protect early-nesting owls and raptors.

TREE PLANTING IN SENSITIVE CLAY

1. The landscape plans have been developed in accordance with the Geotechnical Report (Geotechnical Investigation Proposed Warehouse Buildings Campeau Drive at Huntmar Drive Ottawa, Ontario, Maha K. Saleh, Sept 1, 2022), which includes the letter/memo (Maha K. Saleh, Sept 1, 2022), and map (Tree Planting Setback Recommendations, Sept 1, 2022) that confirms the categories and locations of clay soils.
2. The following City of Ottawa clay soils guideline applies: Guidelines for Tree Planting in Sensitive Marine Clay Soils (2017). The soil volumes provided are sufficient for a reasonable chance of tree survival. Unless otherwise noted, all new trees on City property meet the minimum soil volume requirements of the following, based on a depth of 1.5m below finished grade, and subtracting the volume of utility trenches.
 - a. Small tree (mature height up to 7.5m) - 25m³/ minimum soil volume provided.
 - b. Medium tree (mature height 7.5-14m) - 30m³/ minimum soil volume provided.
3. Where trees share a continuous greenspace:
 - c. Two (2) small trees - 15m³/ minimum soil volume provided per tree.
 - d. Two (2) medium trees - 18m³/ minimum soil volume provided per tree.

CALIPER TREES PLANT LIST

Code	Quantity	Species	Common Name	Caliper	Width	Height	Status
AR	2	<i>Acer rubrum</i>	Red Maple	50mm Cal	WB	As Shown	
AFCM	8	<i>Acer x freemanii 'Celtam'</i>	Celebration Maple	50mm Cal	WB	As Shown	
AI	3	<i>Alnus incana ssp. rugosa</i>	Speckled Alder	50mm Cal	WB	As Shown	
ALS	1	<i>Amelanchier laevis 'Spring Flurry'</i>	Spring Flurry Serviceberry	50mm Cal	WB	As Shown	
AXB	10	<i>Amelanchier x grandiflora 'Ballarina'</i>	Ballarina Serviceberry	50mm Cal	WB	As Shown	
BPM	3	<i>Betula papyrifera (multistem)</i>	Multistem Paper Birch	50mm Cal	WB	As Shown	
CEL	4	<i>Celtis occidentalis</i>	Hackberry	50mm Cal	WB	As Shown	
COU	8	<i>Celtis occidentalis 'Ultra'</i>	Ultra Hackberry	50mm Cal	WB	As Shown	
CRC	4	<i>Crataegus crus-galli 'Inermis'</i>	Thornless Cockspur Hawthorn	50mm Cal	WB	As Shown	
GTH	7	<i>Gleditsia triacanthos var. inermis 'Impcolt'</i>	Imperial Honeylocust	50mm Cal	WB	As Shown	
GTH	12	<i>Gleditsia triacanthos var. inermis 'Halka'</i>	Halka Honeylocust	50mm Cal	WB	As Shown	
MPS	13	<i>Malus 'Pink Spires'</i>	Pink Spires Crabapple	50mm Cal	WB	As Shown	
UAB	9	<i>Ulmus americana 'Brandon'</i>	Brandon Elm	50mm Cal	WB	As Shown	
UF	13	<i>Ulmus americana 'Frontier'</i>	Frontier Elm	50mm Cal	WB	As Shown	
UAP	3	<i>Ulmus americana 'Princeton'</i>	Princeton Elm	50mm Cal	WB	As Shown	
Coniferous Trees							
LL	5	<i>Larix laricina</i>	Tamarack	200cm HT	WB	As Shown	
PP	8	<i>Picea pungens</i>	Colorado Spruce	200cm HT	WB	As Shown	
PBB	3	<i>Picea pungens 'Baby Blue'</i>	Baby Blue Colorado Spruce	175cm HT	WB	As Shown	
TO	8	<i>Thuja occidentalis</i>	Eastern White Cedar	200cm HT	WB	As Shown	

Total Number of Deciduous Trees: 100
Total Number of Coniferous Trees: 24
Total Number of Trees: 124

NOTE:
THE POSITION OF ALL POLE LINES, CONDUITS, WATERMANS, SEWERS AND OTHER UNDERGROUND AND OVERGROUND UTILITIES AND STRUCTURES IS NOT NECESSARILY SHOWN ON THE CONTRACT DRAWINGS, AND WHERE SHOWN, THE ACCURACY OF THE POSITION OF SUCH UTILITIES AND STRUCTURES IS NOT GUARANTEED. BEFORE STARTING WORK, DETERMINE THE EXACT LOCATION OF ALL SUCH UTILITIES AND STRUCTURES AND ASSUME ALL LIABILITY FOR DAMAGE TO THEM.

Owner:
Rosefellow
c/o Julian Nini
750 Marie-Laurin, Suite 210
Saint-Laurent, QC H4M 2M4
Phone: (514) 532-1080

NOT FOR CONSTRUCTION

No.	REVISION	DATE	BY
2.	REVISED PER CITY COMMENTS	MAR 30/23	RGJ
1.	ISSUED FOR CITY OF OTTAWA REVIEW	DEC 16/22	RGJ

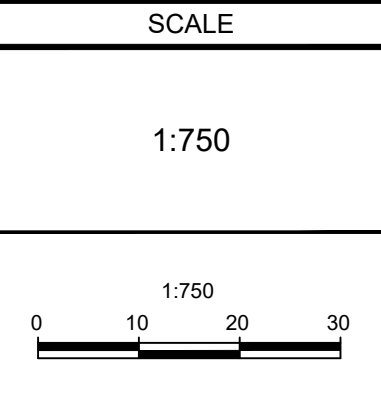

DESIGN	KW
CHECKED	RGJ
DRAWN	TB
CHECKED	KW
APPROVED	RGJ

FOR REVIEW ONLY

NOVATECH
Engineers, Planners & Landscape Architects
Suite 200, 240 Michael Cowpland Drive
Ottawa, Ontario, Canada K2M 1P6

Telephone (613) 254-9643
Facsimile (613) 254-5867
Website www.novatech-eng.com

LOCATION
CITY OF OTTAWA
405 HUNTMAR DRIVE - WAREHOUSE DEVELOPMENT

DRAWING NAME
OVERALL LANDSCAPE PLAN

PROJECT No. 122151
REV # 2
DRAWING No. 122151-L1

SEE 122151-L4

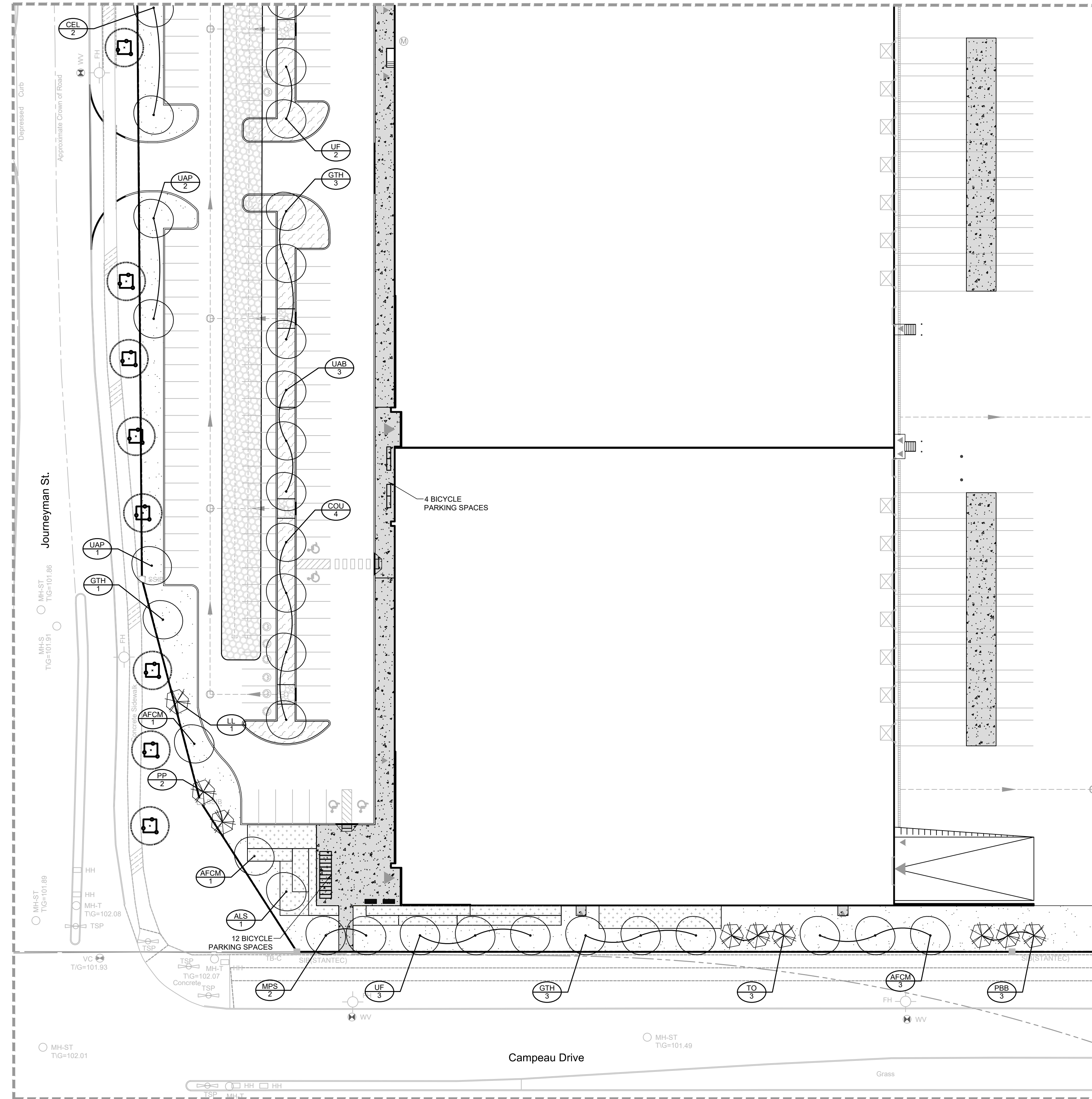

SEE 122151-L3

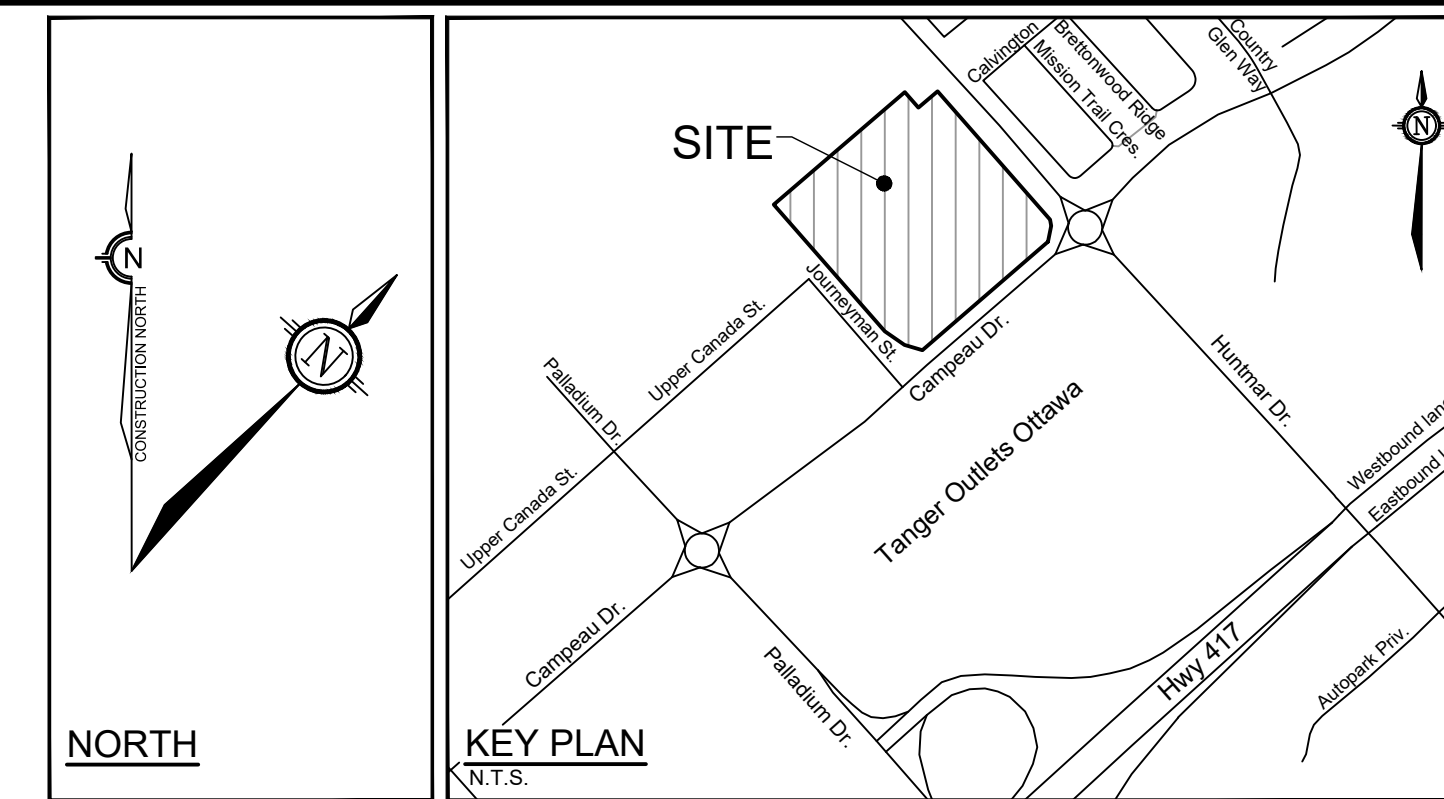

LEGEND - LANDSCAPE

- 3-D1** DETAIL SHEET # NOVATECH OR CITY
EG. L1, L2, ETC. DETAIL NUMBER SEE LIST
FOR CODE
- PROPERTY LIMIT
- TREE PROTECTION FENCE
- PROPOSED CONCRETE
- RIVERSTONE
- PROPOSED PLANTING BED
- SOD
- SEED MIX A - SEE NOTE
- SEED MIX B - SEE NOTE
- SEED MIX C - SEE NOTE
- PROPOSED WET SHRUB MIX,
REFER TO SHEET L6
- PROPOSED DRY SHRUB MIX,
REFER TO SHEET L6
- PROPOSED DECIDUOUS TREE
- PROPOSED CONIFEROUS TREE
- PROPOSED SHRUBS
- EXISTING TREE TO REMAIN
- EXISTING HEDGEROW TO REMAIN
- BENCH
- KEY
SPECIES (SEE PLANT LIST)
QUANTITY

TREE PROTECTION

- Implement the following protection measures for retained trees, both on site and on adjacent sites, prior to any work activity, including tree removal. Maintain tree protection fence in place and in good condition for the duration of site works:
- The Landscape Architect or Certified Arborist is to determine the location of the tree protection fencing and detail it on any associated plans for the site (e.g. tree conservation report, tree disclosure report, etc.).
 - Under the guidance of a Landscape Architect or Certified Arborist, erect a fence at the critical root zone (CRZ) of trees. Diameter at breast height (DBH) is the trunk diameter measured at 1.3m height on the tree trunk. The CRZ is calculated as DBH x 10. Refer to the Tree Protection Fence detail.
 - Refer to the Tree Protection Plan for fence location. City Forestry Staff are to approve both the plan and the installed fence prior to work commencement.
 - Do not place any material or equipment within 2m of the CRZ of any tree, including outhouses.
 - Do not attach any signs, notices, or posters to any tree.
 - Do not disturb, raise, or lower the existing grade within the CRZ without approval.
 - Only tunnel or bore when digging within the CRZ of a tree. Hand work only where required within the CRZ, absolutely no machinery permitted.
 - Do not damage the root system, trunk, or branches, or any tree.
 - Do not extend hard surface or significantly change landscaping.
 - Ensure that exhaust fumes from all equipment are directed away from any tree canopy.
 - When trees marked for removal overlap with the CRZ of trees marked for preservation: cut roots at the edge of the CRZ and grind down stumps after tree removals, do not pull out stumps. Ensure there is no root pulling or disturbance of the ground within the CRZ.
 - Prior to work taking place, notify and consult the Landscape Architect and City Forestry Staff. Roots must be cut. Roots 20mm or larger should be cut at right angles with clean, sharp horticultural tools without tearing, crushing, or pulling. Refer to City of Ottawa Specification S.P. F-8011 Tree Protection, Excavation of Root Zone.
 - If damaged or objectionable branches are observed, consult the Landscape Architect, before any work is conducted. Do not prune leaders. Do not prune more than 1/4 of crown.
 - Set up a water and fertilizing program, if trees are being affected by site works, to the satisfaction of the Landscape Architect.
 - The Landscape Architect is to prescribe mitigation measures if the protected fenced area must be reduced to facilitate construction. Measures may include the placement of plywood, wood chips, or steel plating over the roots for protection. City Forestry Staff are to approve said measures prior to fence movement.
 - City of Ottawa By-law: Protects municipal trees and municipal natural areas in the City of Ottawa and trees on private property in the urban area of the City of Ottawa (2020-340).

PLANTING

- Plant material to be No. 1 Grade and is to comply with Canadian Standards for Nursery Stock (latest edition) published by the Canadian Nursery Landscape Association.
- Use structurally sound plant material with strong fibrous root system free of disease, defects, and injuries. Use trees with straight trunks, well and characteristically branched for species. Obtain approval from consultant of plant material at source prior to digging. All trees and shrubs to be container grown, potted, W/B or B/B, as indicated on Plant List. Bare root plants are only acceptable for certain species and as approved by the Landscape Architect.
- Plant material substitutions are not permitted without the written approval from the consultant, with 48 hours notice, prior to shipping plant material.
- Plant locations are schematic, approximate only. Contractor is to stake out locations on site for approval by the Landscape Architect prior to installation.
- The illustrated number of plants shown in the Planting Plan supersedes the estimated number in the Plant List. Contractor to report any discrepancies to the Landscape Architect prior to installation. Contractor will assume full responsibility if the Landscape Architect is not notified.
- Ensure trees are thoroughly watered following planting. Monitor material and ensure adequate moisture until acceptance.
- In heavy clay or poorly drained soils, set root ball with root collar 75-100mm higher than finished grade.
- Approved topsoil depths are as follows:
 - Plant Beds - 450mm continuous depth. Applies to shrubs, perennials, vines, and groundcovers.
 - Sod/Seed Areas - 100mm depth.
- Sod to be No. 1 Kentucky Bluegrass Sod grown from minimum mixture of 3 Kentucky Bluegrass cultivars. Quality and source are to comply with Canadian Standards for Nursery Stock, Section 17, (latest edition) published by the Canadian Nursery Landscape Nursery Landscape Association.
- Apply the following mineral fertilizer unless soil tests show other requirements:
 - Plant Beds - (8-32-16), i.e. 8% Nitrogen, 32% Phosphorus, 16% Potash per manufacturer specifications.
 - Sod Areas - (8-32-16), i.e. 8% Nitrogen, 32% Phosphorus, 16% Potash at a rate of 350kg/ha.
- Where applicable, for any plant areas with a mix of species/cultivars notes, Contractor is to cluster like plants in groups of 3-5 and evenly distribute these in the noted area.

CITY DETAILS

Related details from City of Ottawa Standard Tender Documents Volume No. 2 Standard Detail Drawings.

- SC4. Typical Concrete Sidewalk in Boulevard
- SC5. Sidewalk Construction Joints

NOVATECH DETAILS

Found on Sheet L7.

- D1. Standard Deciduous Tree Planting
- D2. Standard Coniferous Tree Planting
- D3. Shrub and Perennial Planting
- D4. Tree Protection Fence
- D5. Bike Layout
- D6. Site furniture installation
- D7. Reforestation
- D8. Riverstone

SEED MIX AND APPLICATION

For areas steeper than 3:1, Contractor to apply erosion control blanket. Erosion control blanket to be machine woven mats made from natural wood, coco or cotton fiber, or combination depending on manufacturer, with stitching between two photo-degradable natural organic fiber nettings. Submit products for approval by Consultant. OPSS 804 applies except as may be amended and extended herein.

In addition to the specified seed mixes, all applications are to include a nurse crop as noted.

- NURSE CROP
 - 40% Oats (Avena sativa)
 - 45% Barley (Hordeum vulgare)
 - 15% Canada Wild Rye (Elymus canadensis)
 - Seeding Rate: 15kg/hectare

- SEED MIX C
 - CUSTOM NATIVE PARKING ISLAND SEED MIX BY DLF
 - Seeding Rate: 25kg/hectare

NOTE:
THE POSITION OF ALL POLE LINES, CONDUITS, WATERMANS, SEWERS AND OTHER UNDERGROUND AND OVERGROUND UTILITIES AND STRUCTURES IS NOT NECESSARILY SHOWN ON THE CONTRACT DRAWINGS, AND WHERE SHOWN, THE ACCURACY OF THE POSITION OF SUCH UTILITIES AND STRUCTURES IS NOT GUARANTEED. BEFORE STARTING WORK, DETERMINE THE EXACT LOCATION OF ALL SUCH UTILITIES AND STRUCTURES AND ASSUME ALL LIABILITY FOR DAMAGE TO THEM.

Owner:
Rosefellow
c/o Julian Nini
750 Mariek Laurin, Suite 210
Saint-Laurent, QC H4M 2M4
Phone: (514) 532-1080

NOT FOR CONSTRUCTION

No.	REVISION	DATE	BY
2.	REVISED PER CITY COMMENTS	MAR 30/23	RGJ
1.	ISSUED FOR CITY OF OTTAWA REVIEW	DEC 16/22	RGJ

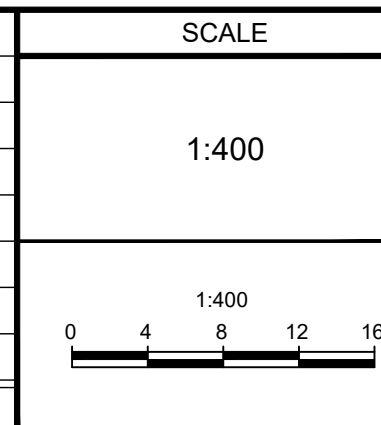

DESIGN	KW
CHECKED	RGJ
DRAWN	TB
CHECKED	KW
APPROVED	RGJ

FOR REVIEW ONLY

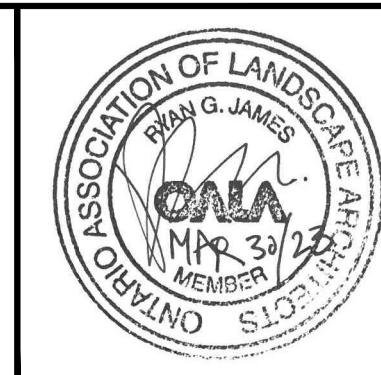

NOVATECH
Engineers, Planners & Landscape Architects
Suite 200, 240 Michael Cowpland Drive
Ottawa, Ontario, Canada K2M 1P6
Telephone: (613) 254-9643
Facsimile: (613) 254-5867
Website: www.novatech-eng.com

LOCATION CITY OF OTTAWA 405 HUNTMAR DRIVE - WAREHOUSE DEVELOPMENT	PROJECT No. 122151
DRAWING NAME LANDSCAPE PLAN	REV # 2
	DRAWING No. 122151-L2

#18906

SEE 122151-L5

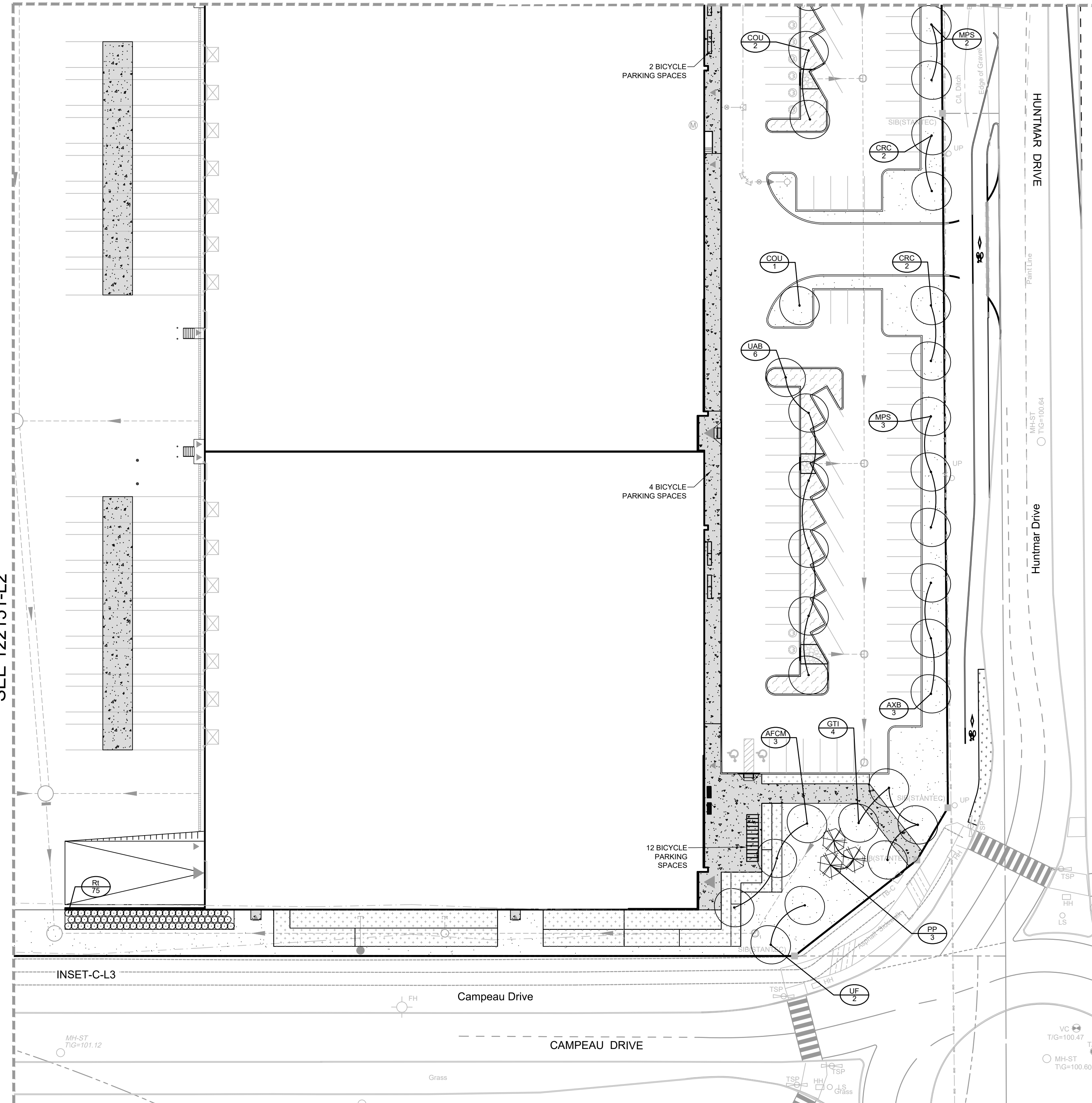

SEE 122151-L2

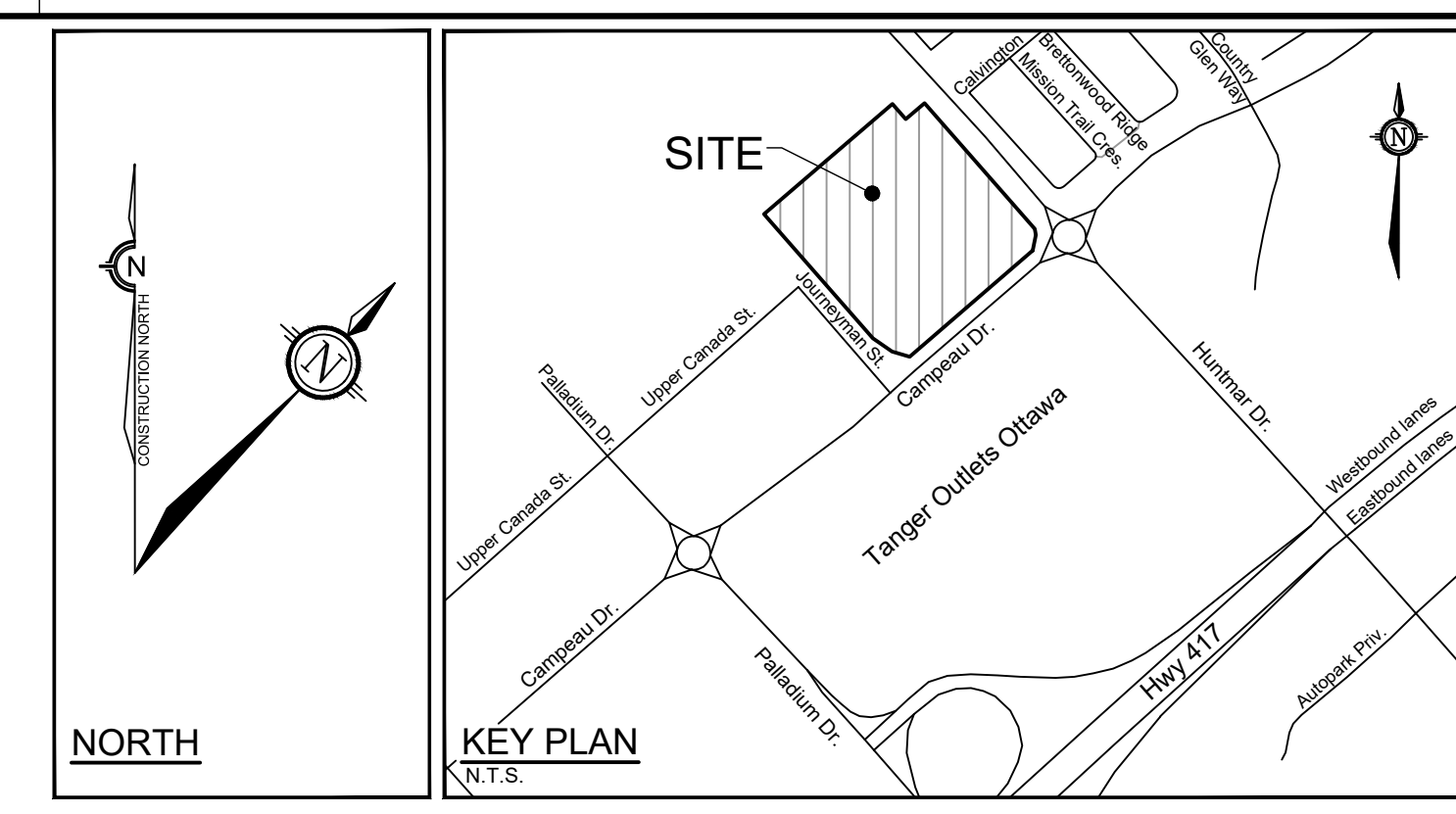

LEGEND - LANDSCAPE

- 3-D1** DETAIL SHEET # NOVATECH OR CITY DETAIL NUMBER SEE LIST FOR CODE
- PROPERTY LIMIT
- TREE PROTECTION FENCE
- PROPOSED CONCRETE
- RIVERSTONE
- PROPOSED PLANTING BED
- SOD
- SEED MIX A - SEE NOTE
- SEED MIX B - SEE NOTE
- SEED MIX C - SEE NOTE
- PROPOSED WET SHRUB MIX, REFER TO SHEET L6
- PROPOSED DRY SHRUB MIX, REFER TO SHEET L6
- PROPOSED DECIDUOUS TREE
- PROPOSED CONIFEROUS TREE
- PROPOSED SHRUBS
- EXISTING TREE TO REMAIN
- EXISTING HEDGEROW TO REMAIN
- BENCH
- SPECIES (SEE PLANT LIST)
- ## QUANTITY

TREE PROTECTION

1. Implement the following protection measures for retained trees, both on site and on adjacent sites, prior to any work activity, including tree removal. Maintain tree protection fence in place and in good condition for the duration of site works:
1. The Landscape Architect or Certified Arborist is to determine the location of the tree protection fencing and detail it on any associated plans for the site (e.g. tree conservation report, tree disclosure report, etc.).
2. Under the guidance of a Landscape Architect or Certified Arborist, erect a fence at the critical root zone (CRZ) of trees. Diameter at breast height (DBH) is the trunk diameter measured at 1.3m height on the tree trunk. The CRZ is calculated as DBH x 10. Refer to the Tree Protection Fence detail.
3. Refer to the Tree Protection Plan for fence location. City Forestry Staff are to approve both the plan and the installed fence prior to work commencement.
4. Do not place any material or equipment within 2m of the CRZ of any tree, including outhouses.
5. Do not attach any signs, notices, or posters to any tree.
6. Do not disturb, raise, or lower the existing grade within the CRZ without approval.
7. Only tunnel or bore when digging within the CRZ of a tree. Hand work only where required within the CRZ, absolutely no machinery permitted.
8. Do not damage the root system, trunk, or branches, or any tree.
9. Do not extend hard surface or significantly change landscaping.
10. Ensure that exhaust fumes from all equipment are directed away from any tree canopy.
11. When trees marked for removal overlap with the CRZ of trees marked for preservation: cut roots at the edge of the CRZ and grind down stumps after tree removals, do not pull out stumps. Ensure there is not root pulling or disturbance of the ground within the CRZ.
12. Prior to work taking place, notify and consult the Landscape Architect and City Forestry Staff if roots must be cut. Roots 20mm or larger should be cut at right angles with clean, sharp horticultural tools without tearing, crushing, or pulling. Refer to City of Ottawa Specification S.P. F-8011 Tree Protection, Excavation of Root Zone.
13. If damaged or objectionable branches are observed, consult the Landscape Architect, before any work is conducted. Do not prune leaders. Do not prune more than 1/4 of crown.
14. Set up a water and fertilizing program, if trees are being affected by site works, to the satisfaction of the Landscape Architect.
15. The Landscape Architect is to prescribe mitigation measures if the protected fenced area must be reduced to facilitate construction. Measures may include the placement of plywood, wood chips, or steel plating over the roots for protection. City Forestry Staff are to approve said measures prior to fence movement.
16. City of Ottawa By-law: Protects municipal trees and municipal natural areas in the City of Ottawa and trees on private property in the urban area of the City of Ottawa (2020-340).

PLANTING

1. Plant material to be No. 1 Grade and is to comply with Canadian Standards for Nursery Stock (latest edition) published by the Canadian Nursery Landscape Association. Use structurally sound plant material with strong fibrous root system free of disease, defects, and injuries. Use trees with straight trunks, well and characteristically branched for species. Obtain approval from consultant of plant material at source prior to digging. All trees and shrubs to be container grown, potted, W/B or B/B, as indicated on Plant List. Bare root plants are only acceptable for certain species and as approved by the Landscape Architect.
2. Plant material substitutions are not to be permitted without the written approval from the Consultant, with 48 hours notice, prior to shipping plant material.
3. The illustrated number of plants shown in the Planting Plan supersedes the estimated number in the Plant List. Contractor to report any discrepancies to the Landscape Architect prior to installation. Contractor will assume full responsibility if the Landscape Architect is not notified.
4. Ensure trees are thoroughly watered following planting. Monitor material and ensure adequate moisture until acceptance.
5. In heavy clay or poorly drained soils, set root ball with root collar 75-100mm higher than finished grade.
6. Approved topsoil depths are as follows:
 - a. Plant Beds - 450mm continuous depth. Applies to shrubs, perennials, vines, and groundcovers.
 - b. Sod/Seed Areas - 100mm depth.
7. Sod to be No. 1 Kentucky Bluegrass Sod grown from minimum mixture of 3 Kentucky Bluegrass cultivars. Quality and source are to comply with Canadian Standards for Nursery Stock, Section 17, (latest edition) published by the Canadian Nursery Landscape Nursery Landscape Association.
8. Apply the following mineral fertilizer unless soil tests show other requirements:
 - a. Plant Beds - (8-32-16), i.e. 8% Nitrogen, 32% Phosphorus, 16% Potash per manufacturer specifications.
 - b. Sod Areas - (8-32-16), i.e. 8% Nitrogen, 32% Phosphorus, 16% Potash at a rate of 350kg/ha.
9. Where applicable, for any plant areas with a mix of species/cultivars notes, Contractor is to cluster like plants in groups of 3-5 and evenly distribute these in the noted area.

CITY DETAILS

Related details from City of Ottawa Standard Tender Documents Volume No. 2 Standard Detail Drawings.
 SC4 Typical Concrete Sidewalk in Boulevard
 SC5 Sidewalk Construction Joints

NOVATECH DETAILS

Found on Sheet L7.
 D1 Standard Deciduous Tree Planting
 D2 Standard Coniferous Tree Planting
 D3 Shrub and Perennial Planting
 D4 Tree Protection Fence
 D5 Bike Layout
 D6 Site furniture installation
 D7 Reforestation
 D8 Riverstone

SEED MIX AND APPLICATION

For areas steeper than 3:1, Contractor to apply erosion control blanket. Erosion control blanket to be machine woven mats made from natural wood, coco or cotton fiber, or combination depending on manufacturer, with stitching between two photo-degradable natural organic fiber nettings. Submit products for approval by Consultant. OPSS 804 applies except as may be amended and extended herein.
 In addition to the specified seed mixes, all applications are to include a nurse crop as noted.
 NURSE CROP
 40% Oats (Avena sativa)
 45% Barley (Hordeum vulgare)
 15% Canada Wild Rye (Elymus canadensis)
 Seeding Rate: 15kg/hectare
 SEED MIX C
 CUSTOM NATIVE PARKING ISLAND SEED MIX BY DLF
 Seeding Rate: 25kg/hectare

PARKING LOT - PLANT LIST

Deciduous Shrubs	Quantity	Species	Height	Planting Time	Notes
Rt	75	Rhus typhina	60cm Ht.	PT	100cm O.C.

NOTE:
 THE POSITION OF ALL POLE LINES, CONDUITS, WATERMANS, SEWERS AND OTHER UNDERGROUND AND OVERGROUND UTILITIES AND STRUCTURES IS NOT NECESSARILY SHOWN ON THE CONTRACT DRAWINGS, AND WHERE SHOWN, THE ACCURACY OF THE POSITION OF SUCH UTILITIES AND STRUCTURES IS NOT GUARANTEED. BEFORE STARTING WORK, DETERMINE THE EXACT LOCATION OF ALL SUCH UTILITIES AND STRUCTURES AND ASSUME ALL LIABILITY FOR DAMAGE TO THEM.

Owner:
 Rosefield
 c/o Julian Nini
 750 Marie-Laurin, Suite 210
 Saint-Laurent, QC H4M 2M4
 Phone: (514) 532-1080

NOT FOR CONSTRUCTION

No.	REVISION	DATE	BY
2.	REVISED PER CITY COMMENTS	MAR 30/23	RGJ
1.	ISSUED FOR CITY OF OTTAWA REVIEW	DEC 16/22	RGJ

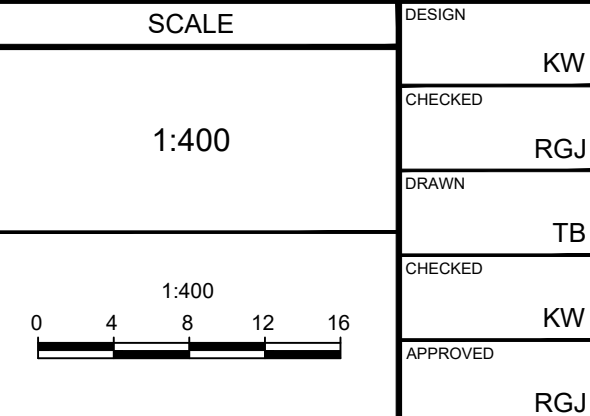

DESIGN	CHECKED	DRAWN	CHECKED	APPROVED
KW	RGJ	TB	KW	RGJ

FOR REVIEW ONLY

NOVATECH
 Engineers, Planners & Landscape Architects
 Suite 200, 240 Michael Cowpland Drive
 Ottawa, Ontario, Canada K2M 1P6
 Telephone: (613) 254-9643
 Facsimile: (613) 254-5867
 Website: www.novatech-eng.com

LOCATION
 CITY OF OTTAWA
 405 HUNTMAR DRIVE - WAREHOUSE DEVELOPMENT

DRAWING NAME
LANDSCAPE PLAN

PROJECT No. 122151
 REV # 2
 DRAWING No. 122151-L3

#18906

M:\2022\122151\CD\122151-L3.dwg, L3, Mar 30, 2023, 3:03pm, tkw@novatech.com

D07-12-22-0186

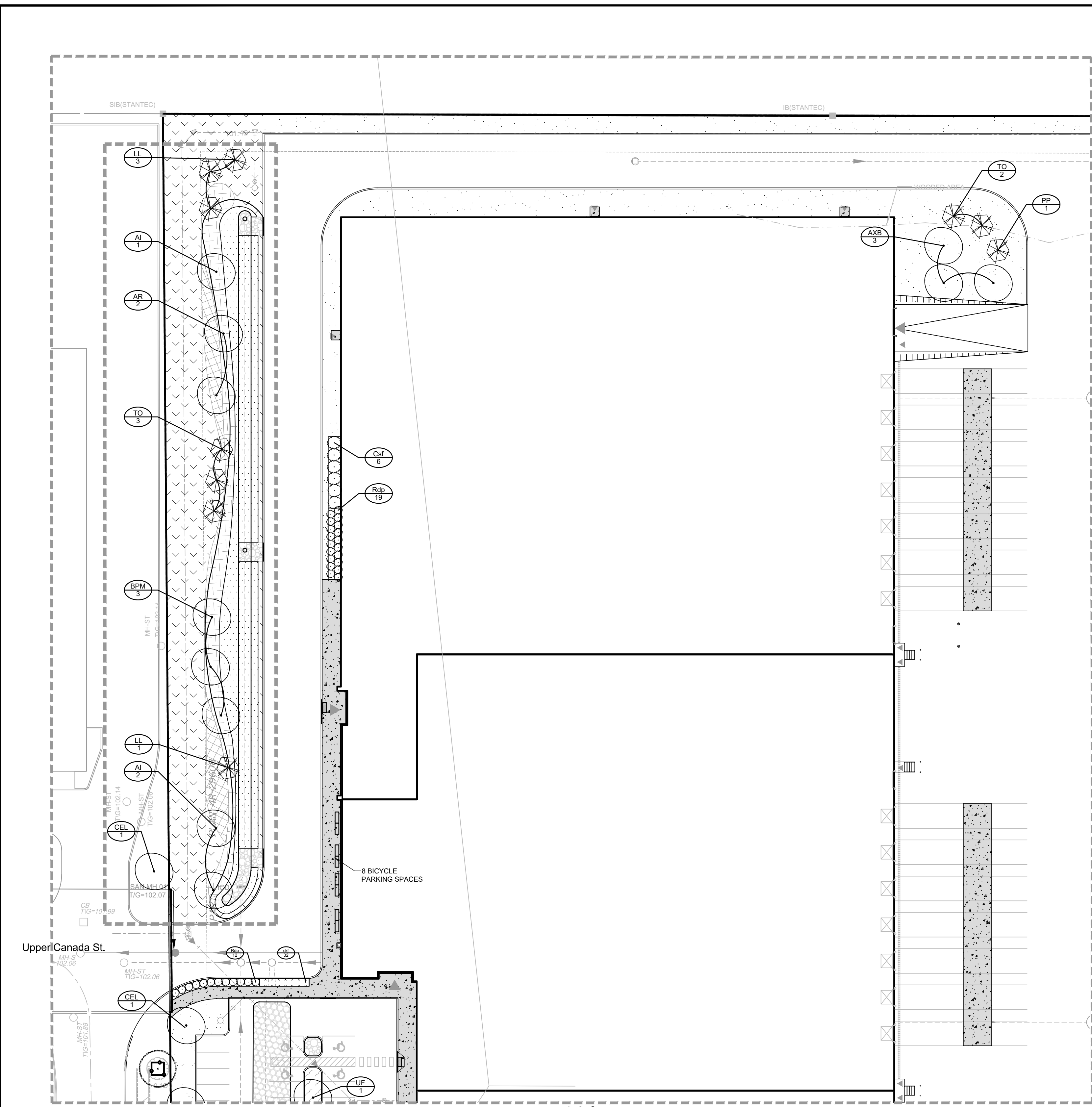

SEE 122151-L5

SEE 122151-L2

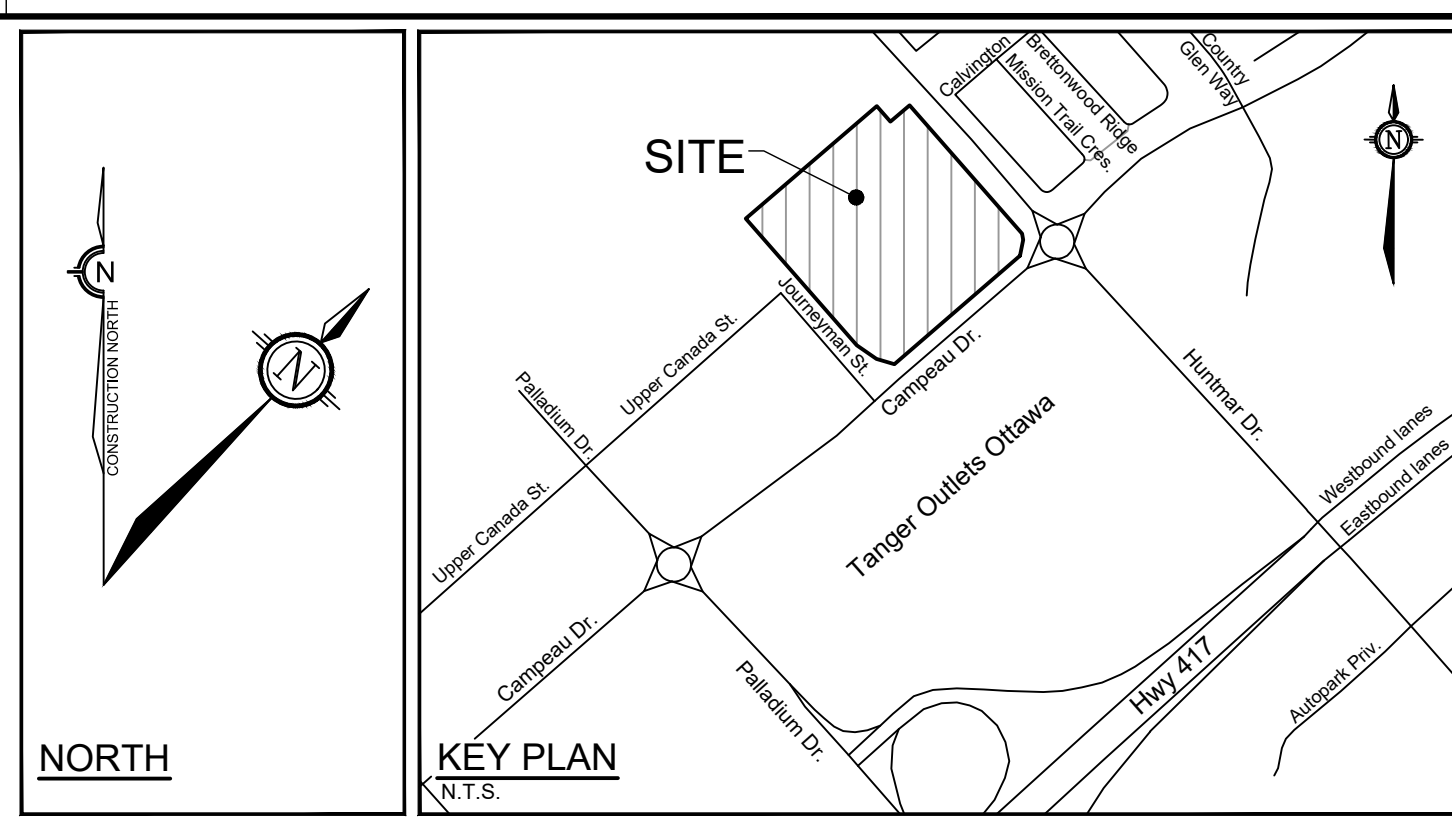

LEGEND

- 3-D1** DETAIL SHEET # NOVATECH OR CITY DETAIL NUMBER SEE LIST FOR CODE
- PROPERTY LIMIT
- TREE PROTECTION FENCE
- [Pattern] PROPOSED CONCRETE
- [Pattern] RIVERSTONE
- [Pattern] PROPOSED PLANTING BED
- [Pattern] SOD
- [Pattern] SEED MIX A - SEE NOTE
- [Pattern] SEED MIX B - SEE NOTE
- [Pattern] SEED MIX C - SEE NOTE
- [Pattern] PROPOSED WET SHRUB MIX, REFER TO SHEET L6
- [Pattern] PROPOSED DRY SHRUB MIX, REFER TO SHEET L6
- [Symbol] PROPOSED DECIDUOUS TREE
- [Symbol] PROPOSED CONIFEROUS TREE
- [Symbol] PROPOSED SHRUBS
- [Symbol] EXISTING TREE TO REMAIN
- [Symbol] EXISTING HEDGEROW TO REMAIN
- [Symbol] BENCH
- [Symbol] SPECIES (SEE PLANT LIST)
- [Symbol] QUANTITY

TREE PROTECTION

- Implement the following protection measures for retained trees, both on site and on adjacent sites, prior to any work activity, including tree removal. Maintain tree protection fence in place and in good condition for the duration of site works:
- The Landscape Architect or Certified Arborist is to determine the location of the tree protection fencing and detail it on any associated plans for the site (e.g. tree conservation report, tree disclosure report, etc.).
 - Under the guidance of a Landscape Architect or Certified Arborist, erect a fence at the critical root zone (CRZ) of trees. Diameter at breast height (DBH) is the trunk diameter measured at 1.3m height on the tree trunk. The CRZ is calculated as DBH x 10. Refer to the Tree Protection Fence detail.
 - Refer to the Tree Protection Plan for fence location. City Forestry Staff are to approve both the plan and the installed fence prior to work commencement.
 - Do not place any material or equipment within 2m of the CRZ of any tree, including outhouses.
 - Do not attach any signs, notices, or posters to any tree. Do not disturb, raise, or lower the existing grade within the CRZ without approval.
 - Only tunnel or bore when digging within the CRZ of a tree. Hand work only where required within the CRZ, absolutely no machinery permitted.
 - Do not damage the root system, trunk, or branches, or any tree.
 - Do not extend hard surface or significantly change landscaping.
 - Ensure that exhaust fumes from all equipment are directed away from any tree canopy.
 - When trees marked for removal overlap with the CRZ of trees marked for preservation: cut roots at the edge of the CRZ and grind down stumps after tree removals, do not pull out stumps. Ensure there is no root pulling or disturbance of the ground within the CRZ.
 - Prior to work taking place, notify and consult the Landscape Architect and City Forestry Staff: roots must be cut. Roots 20mm or larger should be cut at right angles with clean, sharp horticultural tools without tearing, crushing, or pulling. Refer to City of Ottawa Specification S.P. F-8011 Tree Protection, Excavation of Root Zone.
 - If damaged or objectionable branches are observed, consult the Landscape Architect, before any work is conducted. Do not prune leaders. Do not prune more than 1/4 of crown.
 - Set up a water and fertilizing program, if trees are being affected by site works, to the satisfaction of the Landscape Architect.
 - The Landscape Architect is to prescribe mitigation measures if the protected fenced area must be reduced to facilitate construction. Measures may include the placement of plywood, wood chips, or steel plating over the roots for protection. City Forestry Staff are to approve said measures prior to fence movement.
 - City of Ottawa By-law: Protects municipal trees and municipal natural areas in the City of Ottawa and trees on private property in the urban area of the City of Ottawa (2020-340).

PLANTING

- Plant material to be No. 1 Grade and is to comply with Canadian Standards for Nursery Stock (latest edition) published by the Canadian Nursery Landscape Association. Use structurally sound plant material with strong fibrous root system free of disease, defects, and injuries. Use trees with straight trunks, well and characteristically branched for species. Obtain approval from consultant of plant material at source prior to digging. All trees and shrubs to be container grown, potted, W/B or B/B, as indicated on Plant List. Bare root plants are only acceptable for certain species and as approved by the Landscape Architect.
- Plant material substitutions are not permitted without the written approval from the Consultant, with 48 hours notice, prior to shipping plant material.
- Plant locations are schematic / approximate only. Contractor is to stake out locations on site for approval by the Landscape Architect prior to installation.
- The illustrated number of plants shown in the Planting Plan supersedes the estimated number in the Plant List. Contractor to report any discrepancies to the Landscape Architect prior to installation. Contractor will assume full responsibility if the Landscape Architect is not notified.
- Ensure trees are thoroughly watered following planting. Monitor material and ensure adequate moisture until acceptance.
- In heavy clay or poorly drained soils, set root ball with root collar 75-100mm higher than finished grade.
- Approved topsoil depths are as follows:
 - Plant Beds - 450mm continuous depth. Applies to shrubs, perennials, vines, and groundcovers.
 - Sod/Seed Areas - 100mm depth.
- Sod to be No. 1 Kentucky Bluegrass Sod grown from minimum mixture of 3 Kentucky Bluegrass cultivars. Quality and source are to comply with Canadian Standards for Nursery Stock, Section 17, (latest edition) published by the Canadian Nursery Landscape Nursery Landscape Association.
- Apply the following mineral fertilizer unless soil tests show other requirements:
 - Plant Beds - (8-32-16), i.e. 8% Nitrogen, 32% Phosphorus, 16% Potash per manufacturer specifications.
 - Sod Areas - (8-32-16), i.e. 8% Nitrogen, 32% Phosphorus, 16% Potash at a rate of 350kg/ha.
- Where applicable, for any plant areas with a mix of species/cultivars notes, Contractor is to cluster like plants in groups of 3-5 and evenly distribute them in the noted area.

CITY DETAILS

Related details from City of Ottawa Standard Tender Documents Volume No. 2 Standard Detail Drawings.

SC4. Typical Concrete Sidewalk in Boulevard
 SC5. Sidewalk Construction Joints

NOVATECH DETAILS

- Found on Sheet L7.
- D1. Standard Deciduous Tree Planting
 - D2. Standard Coniferous Tree Planting
 - D3. Shrub and Perennial Planting
 - D4. Tree Protection Fence
 - D5. Bike Layout
 - D6. Site furniture installation
 - D7. Reforestation
 - D8. Riverstone

SEED MIX AND APPLICATION

For areas steeper than 3:1, Contractor to apply erosion control blanket. Erosion control blanket to be machine woven mats made from natural wood, coco or cotton fiber, or combination depending on manufacturer, with stitching between two photo-degradable natural organic fiber nettings. Submit products for approval by Consultant. OPSS 804 applies except as may be amended and extended herein.

In addition to the specified seed mixes, all applications are to include a nurse crop as noted.

- NURSE CROP**
 40% Oats (Avena sativa)
 45% Barley (Hordeum vulgare)
 15% Canada Wild Rye (Elymus canadensis)
 Seeding Rate: 15kg/hectare
- SEED MIX C**
 CUSTOM NATIVE PARKING ISLAND SEED MIX BY DLF
 Seeding Rate: 25kg/hectare

PARKING LOT - PLANT LIST

Deciduous Shrubs		Ornamental Grasses	
Csf	6 <i>Cornus sericea 'Flaviramea'</i>	Yellow Twig Dogwood	60cm HT PT 200cm O.C.
Rdp	31 <i>Rosa 'Dwarf Pavement'</i>	Dwarf Pavement Rose	60cm HT PT 120cm O.C.
ckf	32 <i>Calamagrostis acutiflora 'Karl Foerster'</i>	Karl Foerster Feather Reed Grass	1g PT 60cm O.C.

NOTE:
 THE POSITION OF ALL POLE LINES, CONDUITS, WATERMANS, SEWERS AND OTHER UNDERGROUND AND OVERGROUND UTILITIES AND STRUCTURES IS NOT NECESSARILY SHOWN ON THE CONTRACT DRAWINGS, AND WHERE SHOWN, THE ACCURACY OF THE POSITION OF SUCH UTILITIES AND STRUCTURES IS NOT GUARANTEED. BEFORE STARTING WORK, DETERMINE THE EXACT LOCATION OF ALL SUCH UTILITIES AND STRUCTURES AND ASSUME ALL LIABILITY FOR DAMAGE TO THEM.

Owner:
 Rosefellow
 c/o Julian Nini
 750 Marie-Laurin, Suite 210
 Saint-Laurent, QC H4M 2M4
 Phone: (514) 532-1080

NOT FOR CONSTRUCTION

No.	REVISION	DATE	BY
2.	REVISED PER CITY COMMENTS	MAR 30/23	RGJ
1.	ISSUED FOR CITY OF OTTAWA REVIEW	DEC 16/22	RGJ

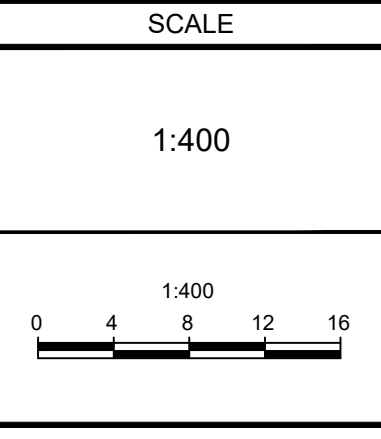

DESIGN: KW
 CHECKED: RGJ
 DRAWN: TB
 CHECKED: KW
 APPROVED: RGJ

FOR REVIEW ONLY

NOVATECH
 Engineers, Planners & Landscape Architects
 Suite 200, 240 Michael Cowpland Drive
 Ottawa, Ontario, Canada K2M 1P6

Telephone: (613) 254-9643
 Facsimile: (613) 254-5867
 Website: www.novatech-eng.com

LOCATION
 CITY OF OTTAWA
 405 HUNTMAR DRIVE - WAREHOUSE DEVELOPMENT

DRAWING NAME
LANDSCAPE PLAN

PROJECT No. 122151
 REV # 2
 DRAWING No. 122151-L4

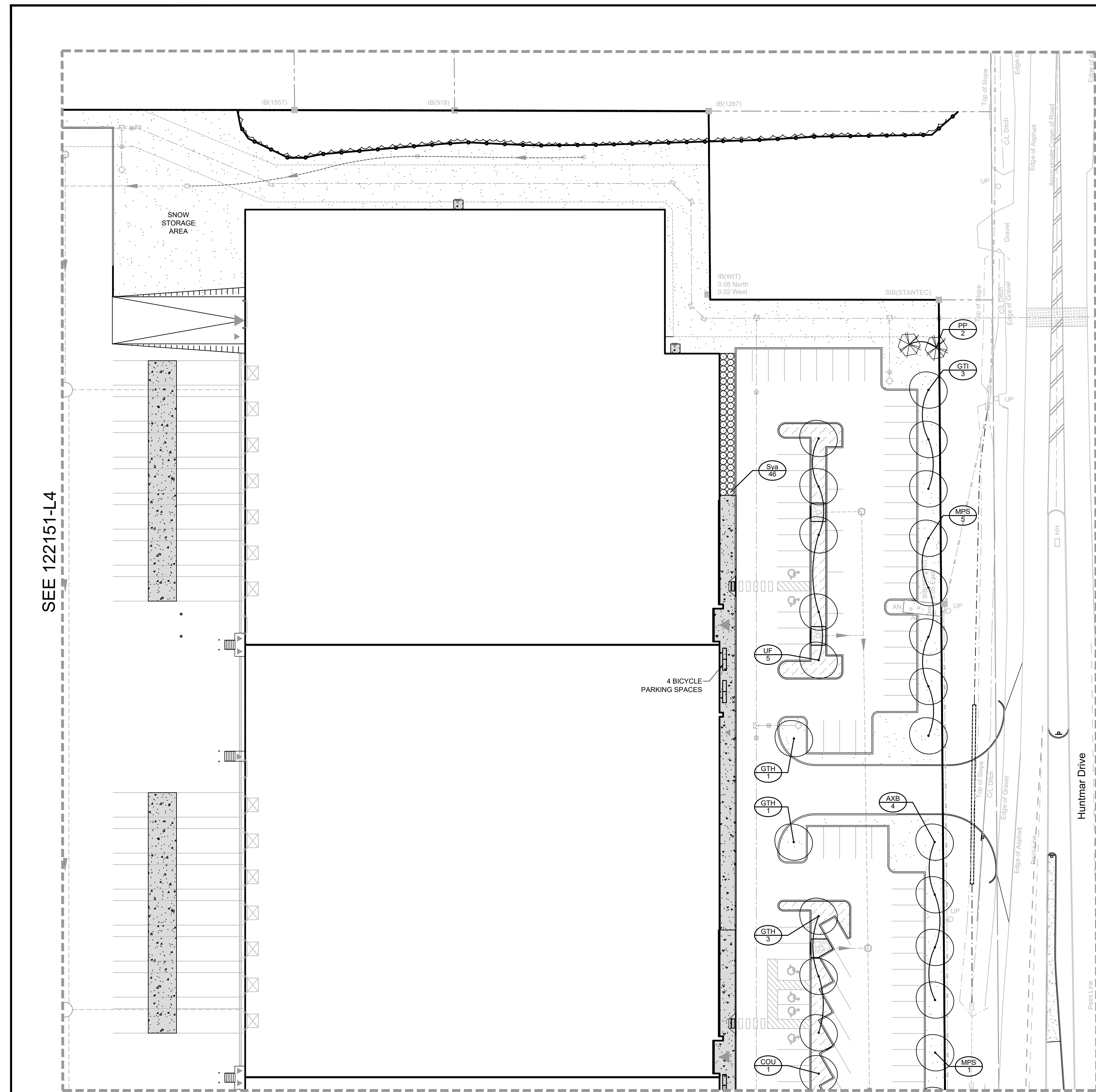

SEE 122151-L4

SEE 122151-L3

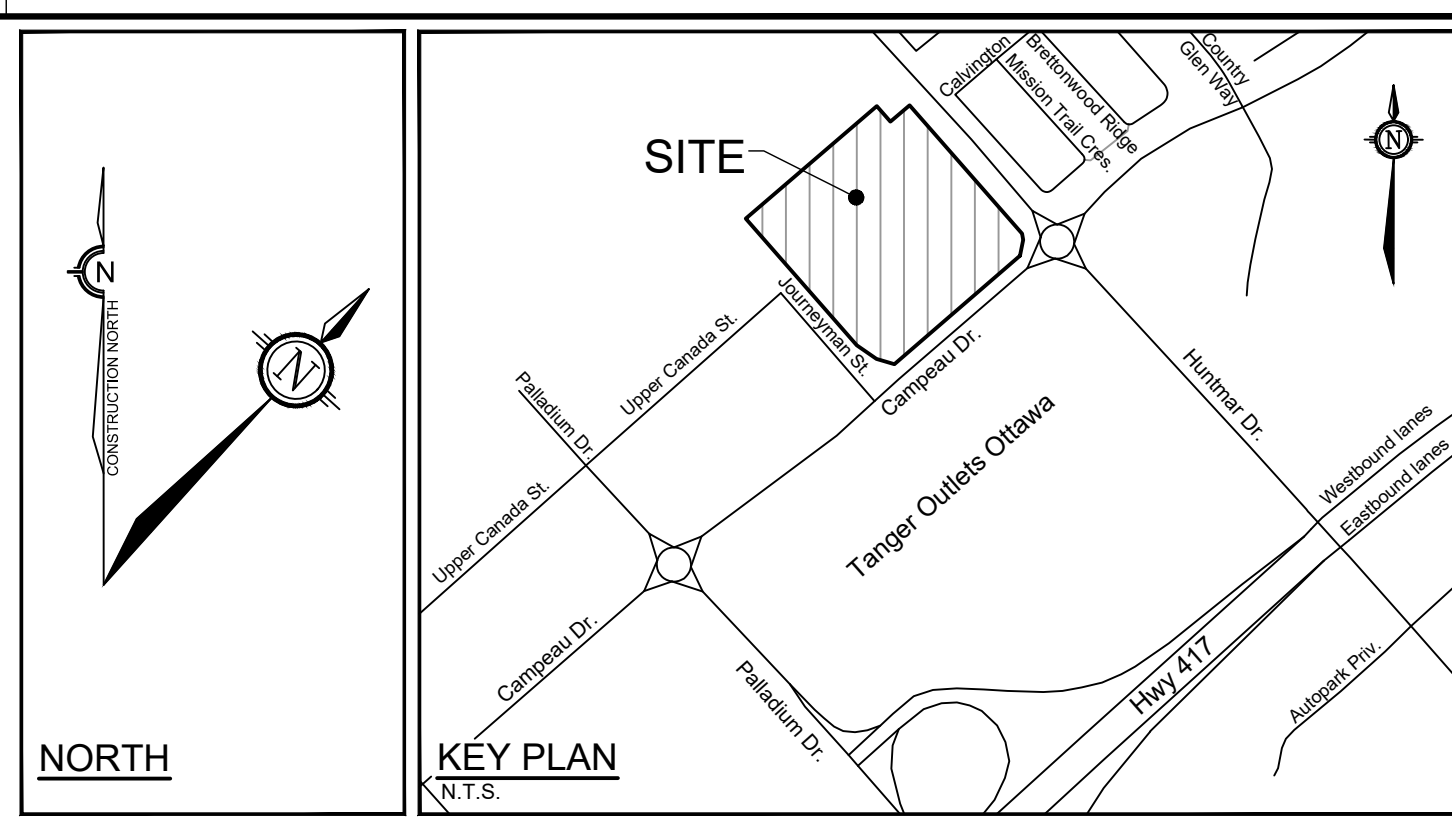

LEGEND - LANDSCAPE

- 3-D1** DETAIL SHEET # NOVATECH OR CITY DETAIL NUMBER SEE LIST FOR CODE
- PROPERTY LIMIT
- TREE PROTECTION FENCE
- PROPOSED CONCRETE
- RIVERSTONE
- PROPOSED PLANTING BED
- SOD
- SEED MIX A - SEE NOTE
- SEED MIX B - SEE NOTE
- SEED MIX C - SEE NOTE
- PROPOSED WET SHRUB MIX, REFER TO SHEET L6
- PROPOSED DRY SHRUB MIX, REFER TO SHEET L6
- PROPOSED DECIDUOUS TREE
- PROPOSED CONIFEROUS TREE
- PROPOSED SHRUBS
- EXISTING TREE TO REMAIN
- EXISTING HEDGEROW TO REMAIN
- BENCH
- SPECIES (SEE PLANT LIST)
- QUANTITY

TREE PROTECTION

- Implement the following protection measures for retained trees, both on site and on adjacent sites, prior to any work activity, including tree removal. Maintain tree protection fence in place and in good condition for the duration of site works:
- The Landscape Architect or Certified Arborist is to determine the location of the tree protection fencing and detail it on any associated plans for the site (e.g. tree conservation report, tree disclosure report, etc.).
 - Under the guidance of a Landscape Architect or Certified Arborist, erect a fence at the critical root zone (CRZ) of trees. Diameter at breast height (DBH) is the trunk diameter measured at 1.3m height on the tree trunk. The CRZ is calculated as DBH x 10. Refer to the Tree Protection Fence detail.
 - Refer to the Tree Protection Plan for fence location. City Forestry Staff are to approve both the plan and the installed fence prior to work commencement.
 - Do not place any material or equipment within 2m of the CRZ of any tree, including outhouses.
 - Do not attach any signs, notices, or posters to any tree.
 - Do not disturb, raise, or lower the existing grade within the CRZ without approval.
 - Only tunnel or bore when digging within the CRZ of a tree. Hand work only where required within the CRZ, absolutely no machinery permitted.
 - Do not damage the root system, trunk, or branches, or any tree.
 - Do not extend hard surface or significantly change landscaping.
 - Ensure that exhaust fumes from all equipment are directed away from any tree canopy.
 - When trees marked for removal overlap with the CRZ of trees marked for preservation: cut roots at the edge of the CRZ and grind down stumps after tree removals, do not pull out stumps. Ensure there is no root pulling or disturbance of the ground within the CRZ.
 - Prior to work taking place, notify and consult the Landscape Architect and City Forestry Staff if roots must be cut. Roots 20mm or larger should be cut at right angles with clean, sharp horticultural tools without tearing, crushing, or pulling. Refer to City of Ottawa Specification S.P. F-8011 Tree Protection, Excavation of Root Zone.
 - If damaged or objectionable branches are observed, consult the Landscape Architect, before any work is conducted. Do not prune leaders. Do not prune more than 1/4 of crown.
 - Set up a water and fertilizing program, if trees are being affected by site works, to the satisfaction of the Landscape Architect.
 - The Landscape Architect is to prescribe mitigation measures if the protected fenced area must be reduced to facilitate construction. Measures may include the placement of plywood, wood chips, or steel plating over the roots for protection. City Forestry Staff are to approve said measures prior to fence movement.
 - City of Ottawa By-law: Protects municipal trees and municipal natural areas in the City of Ottawa and trees on private property in the urban area of the City of Ottawa (2020-340).

PLANTING

- Plant material to be No. 1 Grade and is to comply with Canadian Standards for Nursery Stock (latest edition) published by the Canadian Nursery Landscape Association. Use structurally sound plant material with strong fibrous root system free of disease, defects, and injuries. Use trees with straight trunks, well and characteristically branched for species. Obtain approval from consultant of plant material at source prior to digging. All trees and shrubs to be container grown, potted, W/B or B/B, as indicated on Plant List. Bare root plants are only acceptable for certain species and as approved by the Landscape Architect.
- Plant material substitutions are not to be permitted without the written approval from the Consultant, with 48 hours notice, prior to shipping plant material.
- Plant locations are schematic / approximate only. Contractor is to stake out locations on site for approval by the Landscape Architect prior to installation.
- The illustrated number of plants shown in the Planting Plan supersedes the estimated number in the Plant List. Contractor to report any discrepancies to the Landscape Architect prior to installation. Contractor will assume full responsibility if the Landscape Architect is not notified.
- Ensure trees are thoroughly watered following planting. Monitor material and ensure adequate moisture until acceptance.
- In heavy clay or poorly drained soils, set root ball with root collar 75-100mm higher than finished grade.
- Approved topsoil depths are as follows:
 - Plant Beds - 450mm continuous depth. Applies to shrubs, perennials, vines, and groundcovers.
 - Sod/Seed Areas - 100mm depth.
- Sod to be No. 1 Kentucky Bluegrass Sod grown from minimum mixture of 3 Kentucky Bluegrass cultivars: Quality and source are to comply with Canadian Standards for Nursery Stock, Section 17, (latest edition) published by the Canadian Nursery Landscape Nursery Landscape Association.
- Install a 1.2m sod strip adjacent to all hard surfaces. Note, sod is not typically graphically shown on plans.
- Apply the following mineral fertilizer unless soil tests show other requirements:
 - Plant Beds - (8-32-16), i.e. 8% Nitrogen, 32% Phosphorus, 16% Potash per manufacturer specifications.
 - Sod Areas - (8-32-16), i.e. 8% Nitrogen, 32% Phosphorus, 16% Potash at a rate of 350kg/ha.
- Where applicable, for any plant areas with a mix of species/cultivars notes, Contractor is to cluster like plants in groups of 3-5 and evenly distribute these in the noted area.

CITY DETAILS

Related details from City of Ottawa Standard Tender Documents Volume No. 2 Standard Detail Drawings.

SC4. Typical Concrete Sidewalk in Boulevard
SC5. Sidewalk Construction Joints

NOVATECH DETAILS

Found on Sheet L7.

D1: Standard Deciduous Tree Planting
D2: Standard Coniferous Tree Planting
D3: Shrub and Perennial Planting
D4: Tree Protection Fence
D5: Bike Layout
D6: Site furniture installation
D7: Reforestation
D8: Riverstone

SEED MIX AND APPLICATION

For areas steeper than 3:1, Contractor to apply erosion control blanket. Erosion control blanket to be machine woven mats made from natural wood, coco or cotton fiber, or combination depending on manufacturer, with stitching between two photo-degradable natural organic fiber nettings. Submit products for approval by Consultant. OPSS 804 applies except as may be amended and extended herein.

In addition to the specified seed mixes, all applications are to include a nurse crop as noted.

NURSE CROP
40% Oats (Avena sativa)
45% Barley (Hordeum vulgare)
15% Canada Wild Rye (Elymus canadensis)
Seeding Rate: 15kg/hectare

SEED MIX C
CUSTOM NATIVE PARKING ISLAND SEED MIX BY DLF
Seeding Rate: 25kg/hectare

PARKING LOT - PLANT LIST

Deciduous Shrubs	Quantity	Species	Notes
Sya	46	Symphoricarpos albus	Snowberry
			50cm HT PT 90cm O.C.

NOTE:
THE POSITION OF ALL POLE LINES, CONDUITS, WATERMANS, SEWERS AND OTHER UNDERGROUND AND OVERGROUND UTILITIES AND STRUCTURES IS NOT NECESSARILY SHOWN ON THE CONTRACT DRAWINGS, AND WHERE SHOWN, THE ACCURACY OF THE POSITION OF SUCH UTILITIES AND STRUCTURES IS NOT GUARANTEED. BEFORE STARTING WORK, DETERMINE THE EXACT LOCATION OF ALL SUCH UTILITIES AND STRUCTURES AND ASSUME ALL LIABILITY FOR DAMAGE TO THEM.

Owner:
Rosefellow
c/o Julian Nini
750 Marie-Laurin, Suite 210
Saint-Laurent, QC H4M 2M4
Phone: (514) 532-1080

NOT FOR CONSTRUCTION

No.	REVISION	DATE	BY
2.	REVISED PER CITY COMMENTS	MAR 30/23	RGJ
1.	ISSUED FOR CITY OF OTTAWA REVIEW	DEC 16/22	RGJ

DESIGN	CHECKED	DRAWN	CHECKED	APPROVED
KW	RGJ	TB	KW	RGJ

FOR REVIEW ONLY

NOVATECH
Engineers, Planners & Landscape Architects
Suite 200, 240 Michael Cowpland Drive
Ottawa, Ontario, Canada K2M 1P6
Telephone: (613) 254-9643
Facsimile: (613) 254-5867
Website: www.novatech-eng.com

LOCATION
CITY OF OTTAWA
405 HUNTMAR DRIVE - WAREHOUSE DEVELOPMENT

DRAWING NAME
LANDSCAPE PLAN

PROJECT No. 122151
REV # 2
DRAWING No. 122151-L5

#18906

M:\2022\122151\122151-L5.dwg L5_Mar-30-2023 3:05pm I:\workfiles

D07-12-22-0186

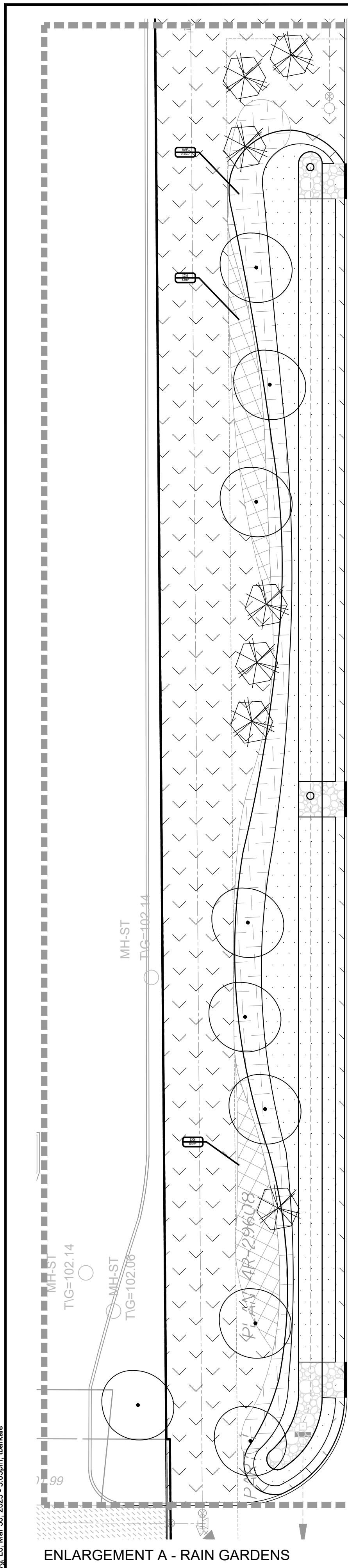

ENLARGEMENT A : PLANT LISTS

Dry Shrub Mix (DS)					
107 m ² 1500 mm O.C. 0.51 pcs/m ²					
25%	14	<i>Ceanothus americanus</i>	New Jersey Tea	0.60m Ht	BR 1.5m O.C.
20%	11	<i>Diervilla lonicera</i>	Bush Honeysuckle	0.60m Ht	BR 1.5m O.C.
5%	3	<i>Physocarpus opulifolius</i>	Common Ninebark	0.60m Ht	BR 1.5m O.C.
5%	3	<i>Rhus aromatica</i>	Fragrant Sumac	0.60m Ht	BR 1.5m O.C.
25%	14	<i>Rubus odoratus</i>	Flowering Raspberry	0.60m Ht	BR 1.5m O.C.
20%	11	<i>Symphoricarpos alba</i>	Snowberry	0.60m Ht	BR 1.5m O.C.

Wet Shrub Mix (WS)					
250 m ² 1500 mm O.C. 0.51 pcs/m ²					
20%	26	<i>Aronia melanocarpa</i>	Black Chokeberry	0.60m Ht	BR 1.5m O.C. 1.3 1.0
15%	19	<i>Cephalanthus occidentalis</i>	Butterbush	0.60m Ht	BR 1.5m O.C. 3.0 6.0
20%	26	<i>Cornus sericea</i>	Red Osier Dogwood	0.60m Ht	BR 1.5m O.C. 2.0 2.5
5%	6	<i>Myrica gale</i>	Sweet Gale	0.60m Ht	BR 1.5m O.C. 1.3 1.0
5%	6	<i>Salix petiolaris</i>	Slender Willow	0.60m Ht	BR 1.5m O.C. 3.0 3.0
20%	26	<i>Spiraea alba</i>	White Meadowsweet	0.60m Ht	BR 1.5m O.C. 1.5 1.5
15%	19	<i>Rosa palustris</i>	Swamp Rose	0.60m Ht	BR 1.5m O.C. 3.0 2.4

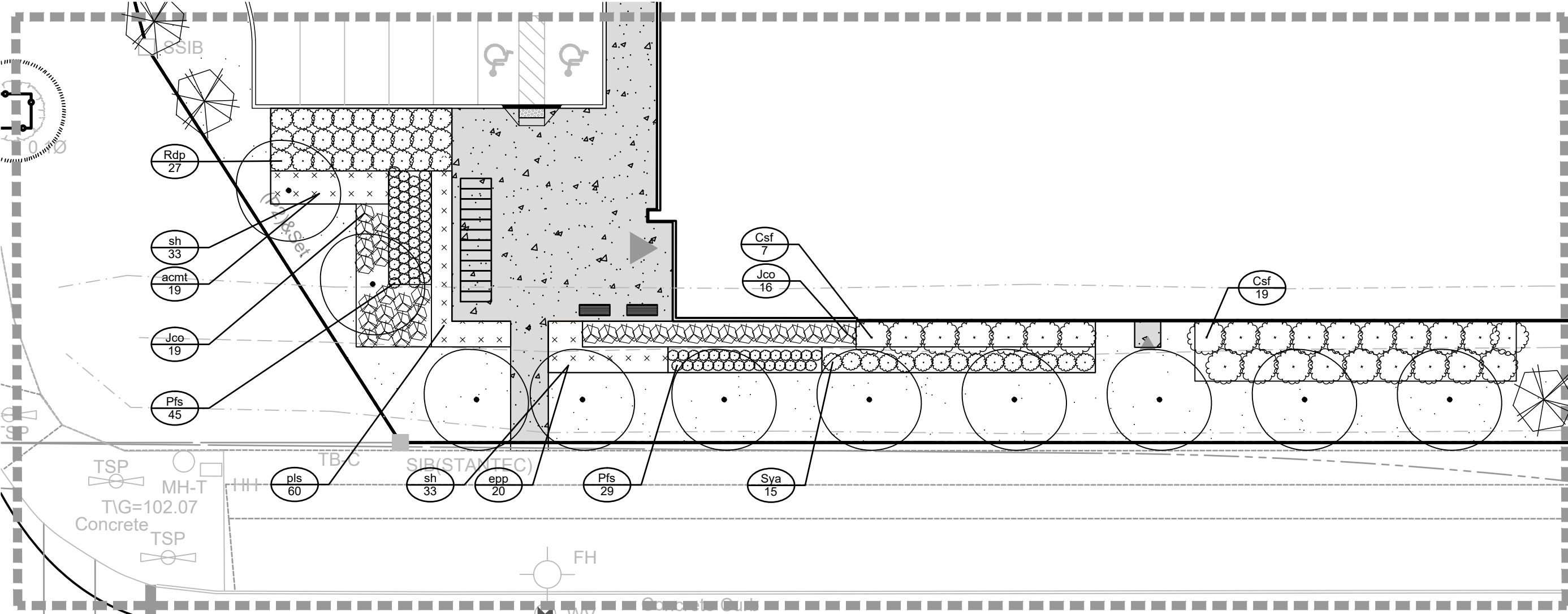

ENLARGEMENT B - BUILDING ENTRANCE - SOUTH

ENLARGEMENT B : PLANT LISTS

Coniferous Shrubs					
Jco	1	35	<i>Juniperus horizontalis 'Plumosa Compacta'</i>	Compact Andorra Juniper	60cm Spr PT 100cm O.C.
Deciduous Shrubs					
Csf	7		<i>Cornus sericea 'Flaviramea'</i>	Yellow Twig Dogwood	60cm Ht PT 200cm O.C.
Pfs	74		<i>Potentilla fruticosa 'Bella Sol'</i>	Bella Sol Potentilla	40cm Ht PT 60cm O.C.
Rdp	27		<i>Rosa 'Dwarf Pavement'</i>	Dwarf Pavement Rose	60cm Ht PT 120cm O.C.
Sya	15		<i>Symphoricarpos albus</i>	Snowberry	50cm Ht PT 100cm O.C.
Perennials					
scmt	19		<i>Achillea millefolium 'Terra Cotta'</i>	Terra Cotta Yarrow	1ltr PT 45cm O.C.
epp	20		<i>Echinacea purpurea</i>	Purple Coneflower	1g PT 45cm O.C.
pls	60		<i>Perovskia atriplicifolia 'Little Spire'</i>	Dwarf Russian Sage	1g PT 60cm O.C.
Ornamental Grasses					
sh	66		<i>Sporobolus heterolepis</i>	Prairie Dropseed	1g PT 60cm O.C.

ENLARGEMENT C : PLANT LISTS

Coniferous Shrubs					
Jco	24		<i>Juniperus horizontalis 'Plumosa Compacta'</i>	Compact Andorra Juniper	60cm Spr PT 100cm O.C.
Pnh	5		<i>Pinus nigra 'Helga'</i>	Helga Austrian Pine	60cm Spr PT 240cm O.C.
Deciduous Shrubs					
Csa	20		<i>Cornus sericea 'Farrow'</i>	Arctic Fire Dogwood	60cm Ht PT 120cm O.C.
Pfs	32		<i>Potentilla fruticosa 'Bella Sol'</i>	Bella Sol Potentilla	40cm Ht PT 60cm O.C.
Rdp	38		<i>Rosa 'Dwarf Pavement'</i>	Dwarf Pavement Rose	60cm Ht PT 120cm O.C.
Perennials					
scmt	16		<i>Achillea millefolium 'Terra Cotta'</i>	Terra Cotta Yarrow	1ltr PT 45cm O.C.
epp	32		<i>Echinacea purpurea</i>	Purple Coneflower	1g PT 45cm O.C.
pls	41		<i>Perovskia atriplicifolia 'Little Spire'</i>	Dwarf Russian Sage	1g PT 60cm O.C.
Ornamental Grasses					
sh	81		<i>Sporobolus heterolepis</i>	Prairie Dropseed	1g PT 60cm O.C.

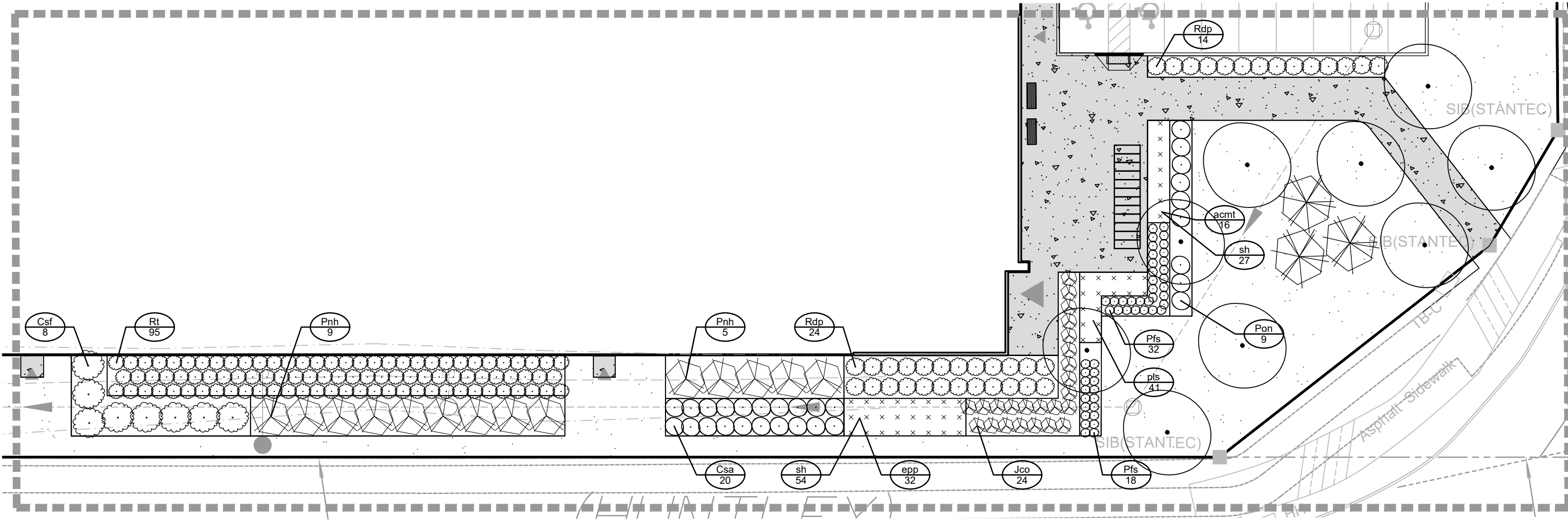

ENLARGEMENT C - BUILDING ENTRANCE - EAST

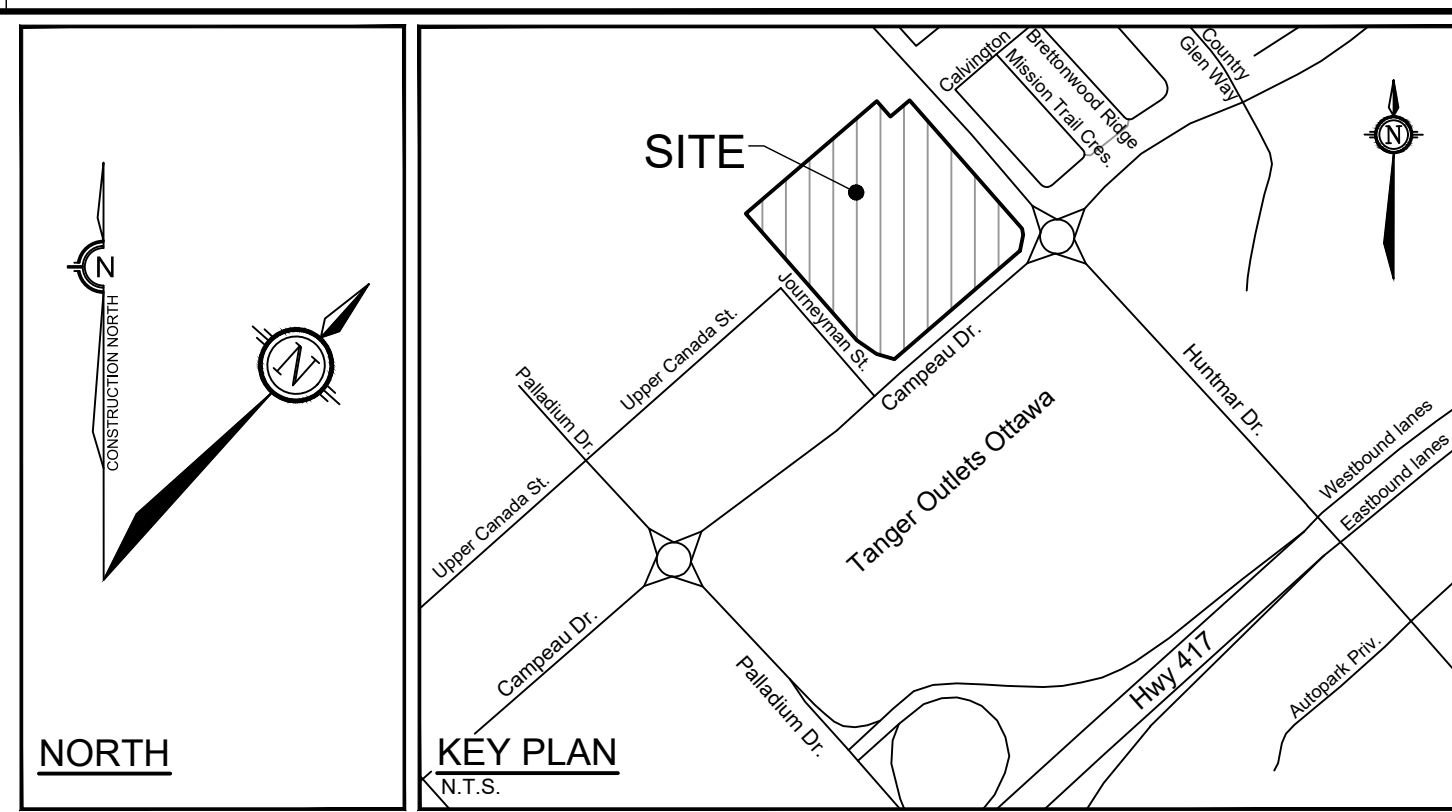

LEGEND

- 3-D1 DETAIL SHEET # NOVATECH OR CITY
EG. L1, L2, ETC. DETAIL NUMBER SEE LIST FOR CODE
- PROPERTY LIMIT
- PROPOSED CONCRETE
- PROPOSED RIVER STONE
- SOD
- SEED MIX A
- SEED MIX B
- PROPOSED DRY SHRUB MIX
- PROPOSED WET SHRUB MIX
- PROPOSED DECIDUOUS TREE
- PROPOSED CONIFEROUS TREE
- PROPOSED SHRUBS
- BENCH
- KEY SPECIES (SEE PLANT LIST)
- QUANTITY
- NATURALIZATION MIX
- AREA

TREE PROTECTION

- Implement the following protection measures for retained trees, both on site and on adjacent sites, prior to any work activity, including tree removal. Maintain tree protection fence in place and in good condition for the duration of site works:
- The Landscape Architect or Certified Arborist is to determine the location of the tree protection fencing and detail it on any associated plans for the site (e.g. tree conservation report, tree disclosure report, etc.).
 - Under the guidance of a Landscape Architect or Certified Arborist, erect a fence at the critical root zone (CRZ) of trees. Diameter at breast height (DBH) is the trunk diameter measured at 1.3m height on the tree trunk. The CRZ is calculated as DBH x 10. Refer to the Tree Protection Fence detail.
 - Refer to the Tree Protection Plan for fence location. City Forestry Staff are to approve both the plan and the installed fence prior to work commencement.
 - Do not place any material or equipment within 2m of the CRZ of any tree, including outhouses.
 - Do not attach any signs, notices, or posters to any tree.
 - Do not disturb, raise, or lower the existing grade within the CRZ without approval.
 - Only tunnel or bore when digging within the CRZ of a tree. Hand work only where required within the CRZ, absolutely no machinery permitted.
 - Do not damage the root system, trunk, or branches, or any tree.
 - Do not extend hard surface or significantly change landscaping.
 - Ensure that exhaust fumes from all equipment are directed away from any tree canopy.
 - When trees marked for removal overlap with the CRZ of trees marked for preservation, cut roots at the edge of the CRZ and grind down stumps after tree removals, do not pull out stumps. Ensure there is no root pulling or disturbance of the ground within the CRZ.
 - Prior to work taking place, notify and consult the Landscape Architect and City Forestry Staff if roots must be cut. Roots 20mm or larger should be cut at right angles with clean, sharp horticultural tools without tearing, crushing, or pulling. Refer to City of Ottawa Specification S.P. F-8011 Tree Protection, Excavation of Root Zone.
 - If damaged or objectionable branches are observed, consult the Landscape Architect, before any work is conducted. Do not prune leaders. Do not prune more than 1/4 of crown.
 - Set up a water and fertilizing program, if trees are being affected by site works, to the satisfaction of the Landscape Architect.
 - The Landscape Architect is to prescribe mitigation measures if the protected fenced area must be reduced to facilitate construction. Measures may include the placement of plywood, wood chips, or steel plating over the roots for protection. City Forestry Staff are to approve said measures prior to fence movement.
 - City of Ottawa By-law: Protects municipal trees and municipal natural areas in the City of Ottawa and trees on private property in the urban area of the City of Ottawa (2020-340).

CITY DETAILS

Related details from City of Ottawa Standard Tender Documents
Volume No. 2 Standard Detail Drawings.

SC4. Typical Concrete Sidewalk in Boulevard
SC5. Sidewalk Construction Joints

NOVATECH DETAILS

- Found on Sheet L7.
- D1. Standard Deciduous Tree Planting
 - D2. Standard Coniferous Tree Planting
 - D3. Shrub and Perennial Planting
 - D4. Tree Protection Fence
 - D5. Bike Layout
 - D6. Site furniture installation
 - D7. Reforestation
 - D8. Riverstone

SEED MIX AND APPLICATION

For areas steeper than 3:1, Contractor to apply erosion control blanket. Erosion control blanket to be machine woven mats made from natural wood, coco or cotton fiber, or combination depending on manufacturer, with stitching between two photo-degradable natural organic fiber nettings. Submit products for approval by Consultant. OPSS 804 applies except as may be amended and extended herein.

In addition to the specified seed mixes, all applications are to include a nurse crop as noted.

NURSE CROP
40% Oats (*Avena sativa*)
45% Barley (*Hordeum vulgare*)
15% Canada Wild Rye (*Elymus canadensis*)
Seeding Rate: 15kg/hectare

SEED MIX A
RETENTION AREA BY DLF
Seeding Rate: 25kg/hectare

SEED MIX B
CUSTOM GREENFIELD MIX (230314) BY DLF
Seeding Rate: 25kg/hectare

- In heavy clay or poorly drained soils, set root ball with root collar 75-100mm higher than finished grade.
- Approved topsoil depths are as follows:
 - a. Plant Beds - 450mm continuous depth. Applies to shrubs, perennials, vines, and groundcovers.
 - b. Sod/ Seed Areas - 100mm depth.
 - c. Reforestation - 300mm depth.
- Sod to be No. 1 Kentucky Bluegrass Sod grown from minimum mixture of 3 Kentucky Bluegrass cultivars. Quality and source are to comply with Canadian Standards for Nursery Stock, Section 17, (latest edition) published by the Canadian Nursery Landscape Nursery Landscape Association.
- Apply the following mineral fertilizer unless soil tests show other requirements:
 - a. Plant Beds - (8-32-16), i.e. 8% Nitrogen, 32% Phosphorus, 16% Potash per manufacturer specifications.
 - b. Sod Areas - (8-32-16), i.e. 8% Nitrogen, 32% Phosphorus, 16% Potash at a rate of 350kg/ha.
- Where applicable, for any plant areas with a mix of species/cultivars notes, Contractor is to cluster like plants in groups of 3-5 and evenly distribute these in the noted area.

NOTE:
THE POSITION OF ALL POLE LINES, CONDUITS, WATERMANS, SEWERS AND OTHER UNDERGROUND AND OVERGROUND UTILITIES AND STRUCTURES IS NOT NECESSARILY SHOWN ON THE CONTRACT DRAWINGS, AND WHERE SHOWN, THE ACCURACY OF THE POSITION OF SUCH UTILITIES AND STRUCTURES IS NOT GUARANTEED. BEFORE STARTING WORK, DETERMINE THE EXACT LOCATION OF ALL SUCH UTILITIES AND STRUCTURES AND ASSUME ALL LIABILITY FOR DAMAGE TO THEM.

Owner:
Rosefellow
c/o Julian Nihi
750 Marie-Laurin, Suite 210
Saint-Laurent, QC H4M 2M4
Phone: (514) 532-1080



No.	REVISION	DATE	BY
2.	REVISED PER CITY COMMENTS	MAR 30/23	RGJ
1.	ISSUED FOR CITY OF OTTAWA REVIEW	DEC 16/22	RGJ

SCALE	DESIGN	CHECKED	DRAWN
1:250	KW	RGJ	TB
	KW		RGJ

FOR REVIEW ONLY

LOCATION
CITY OF OTTAWA
405 HUNTMAR DRIVE - WAREHOUSE DEVELOPMENT

DRAWING NAME
LANDSCAPE ENLARGEMENTS

PROJECT No. 122151

REV #2 122151-L6

NOVATECH
Engineers, Planners & Landscape Architects
Suite 200, 240 Michael Copland Drive
Ottawa, Ontario, Canada K2M 1P6

Telephone (613) 254-9643
Facsimile (613) 254-5867
Website www.novatech-eng.com

ASSOCIATION OF LANDSCAPE ARCHITECTS
CITY OF OTTAWA
MEMBER SINCE 2012

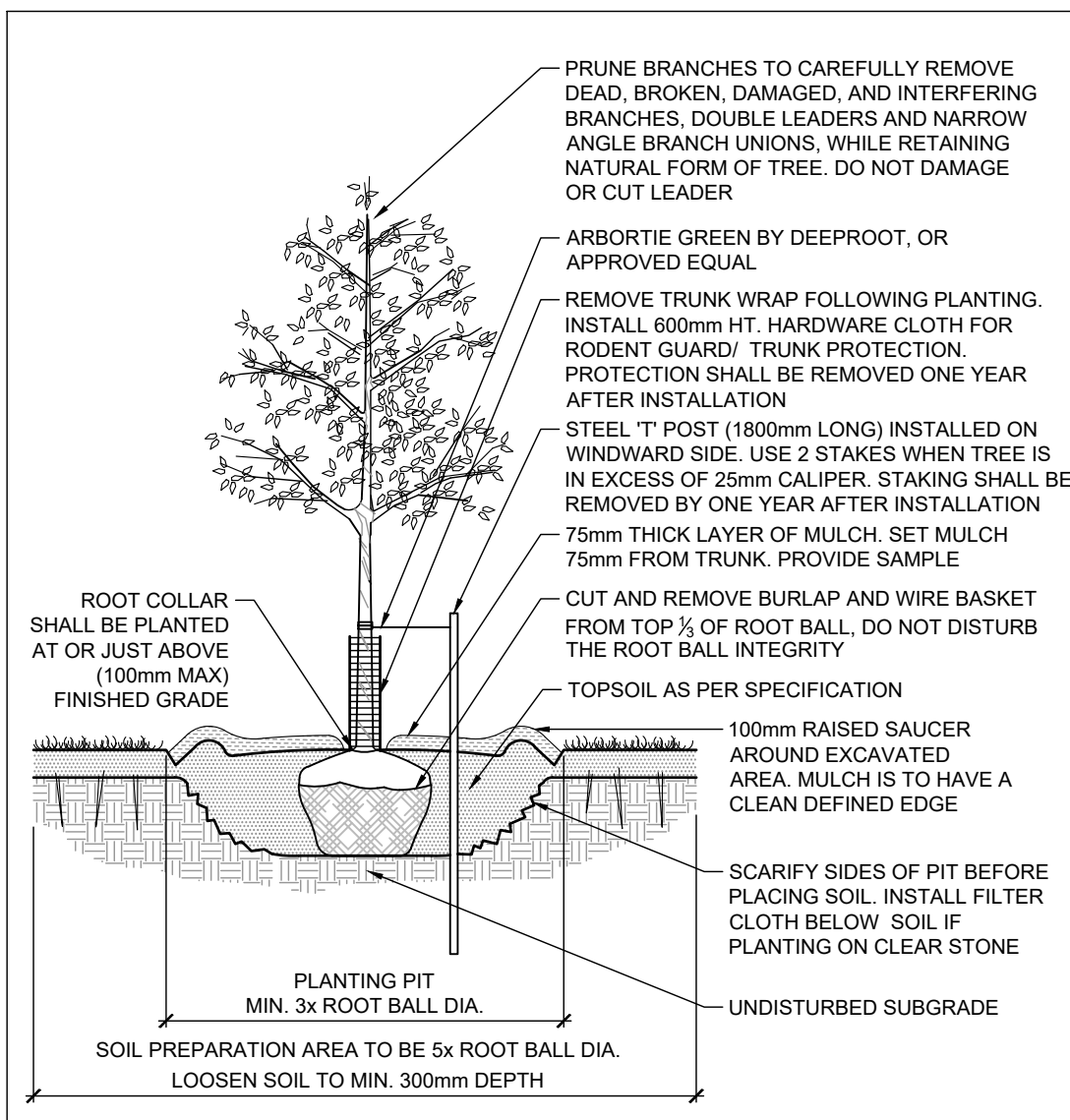

STANDARD DECIDUOUS TREE PLANTING D1

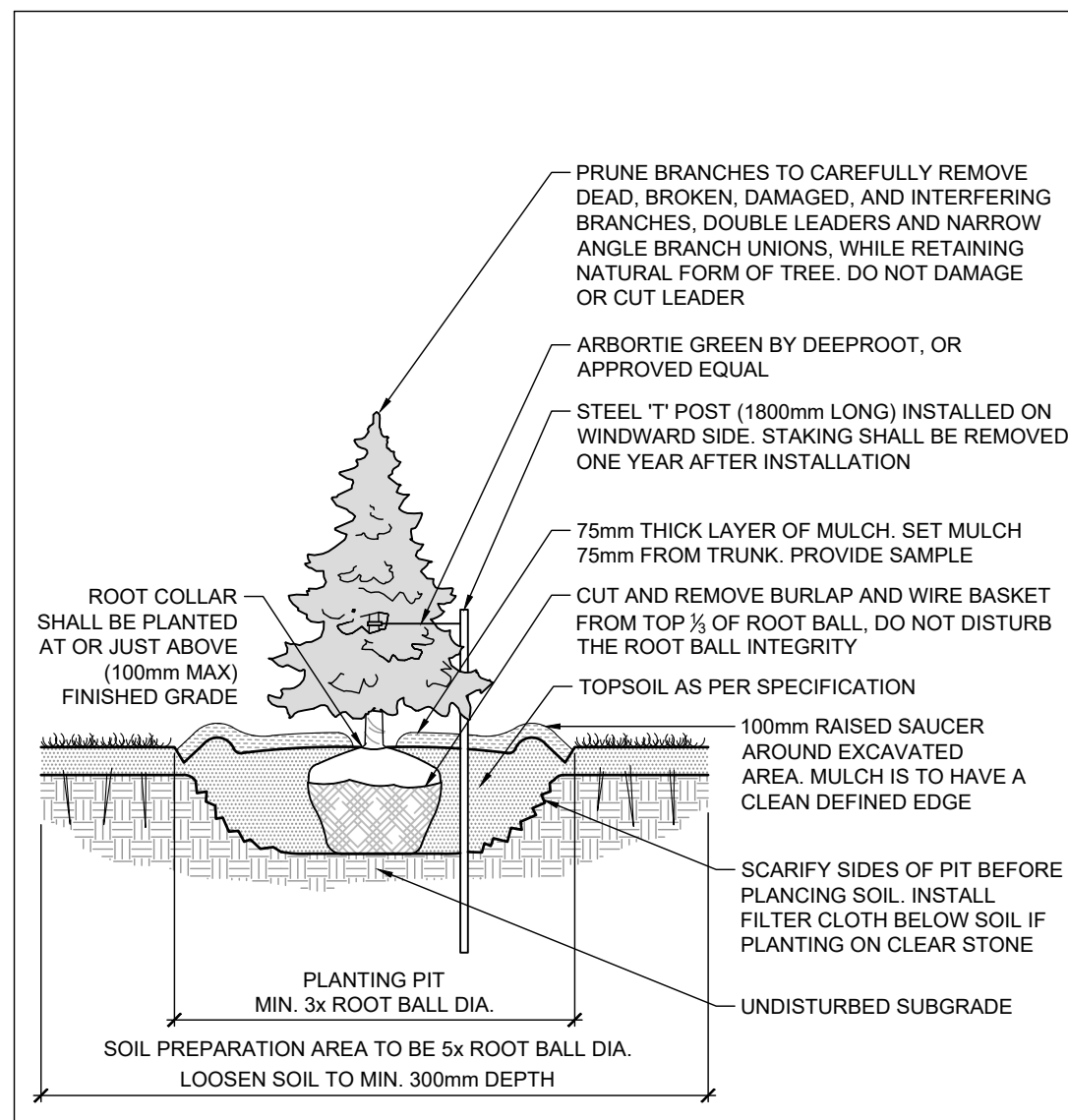

STANDARD CONIFEROUS TREE PLANTING D2

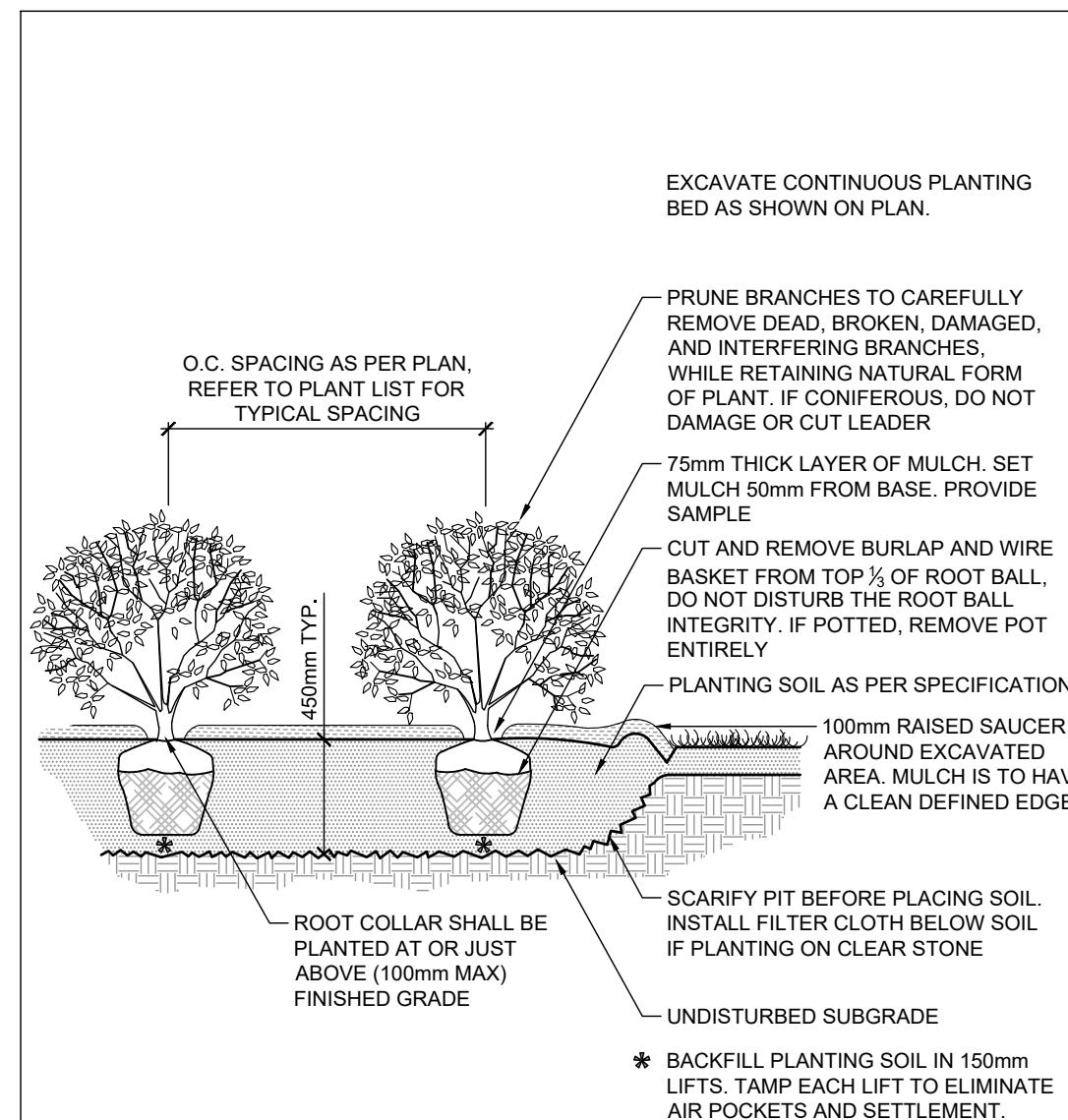

SHRUB AND PERENNIAL PLANTING D3

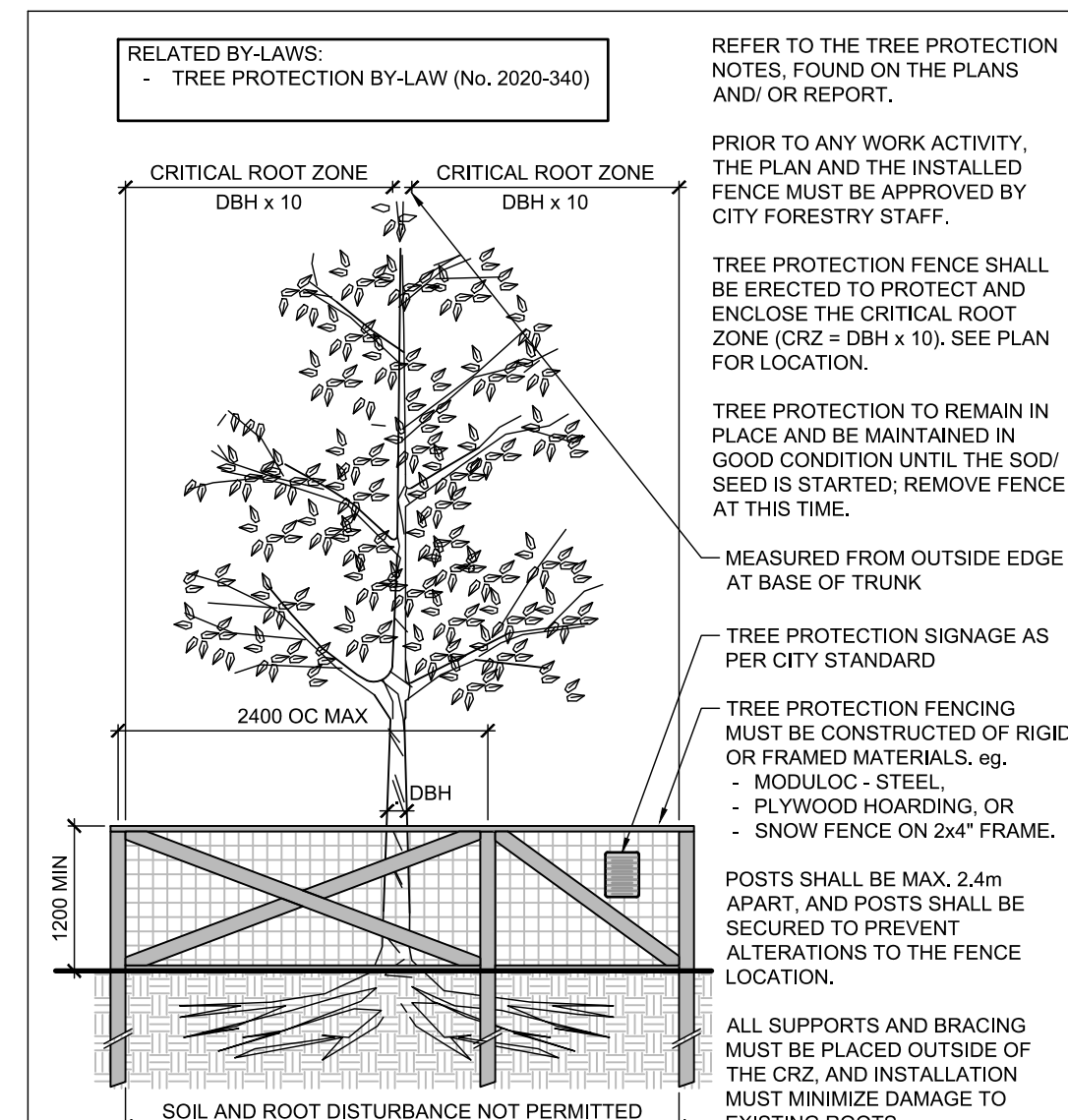

TREE PROTECTION FENCE D4

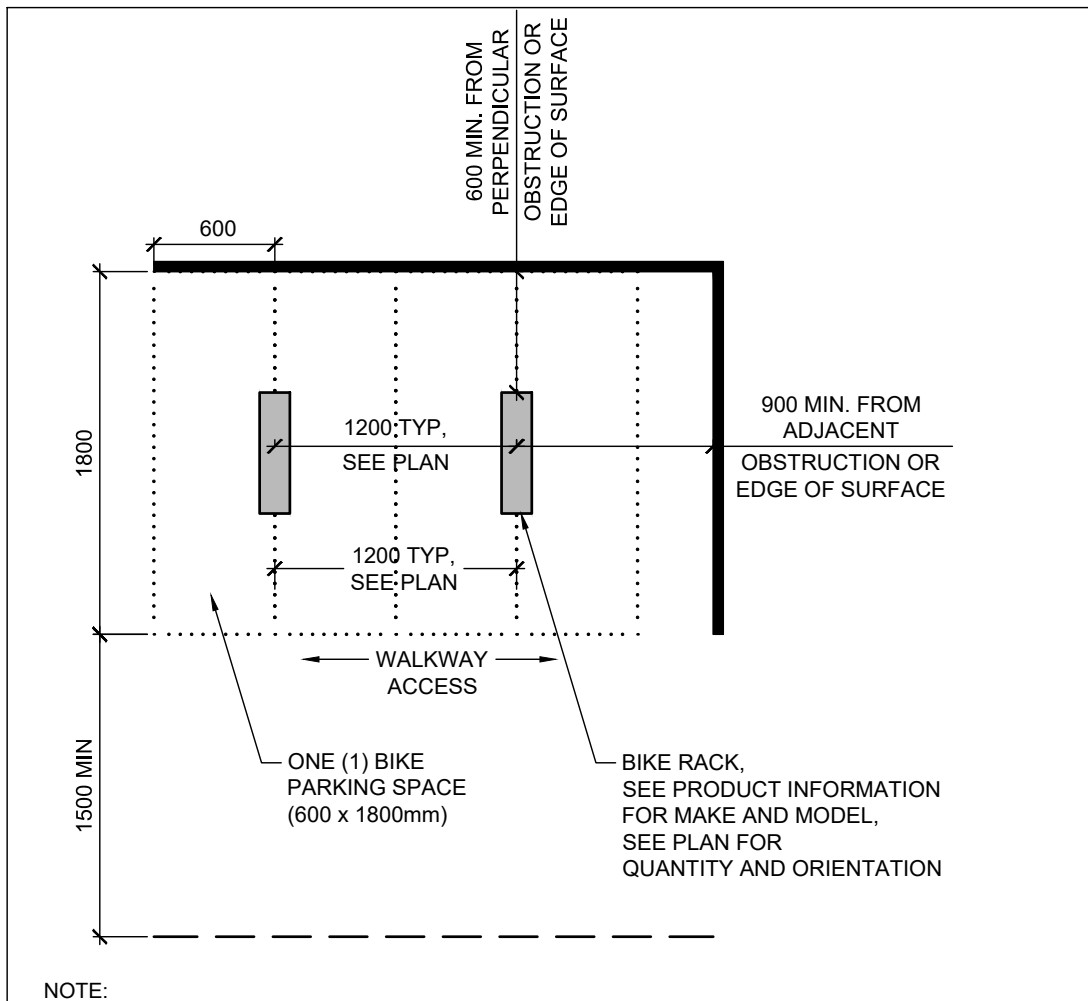

BIKE LAYOUT D5

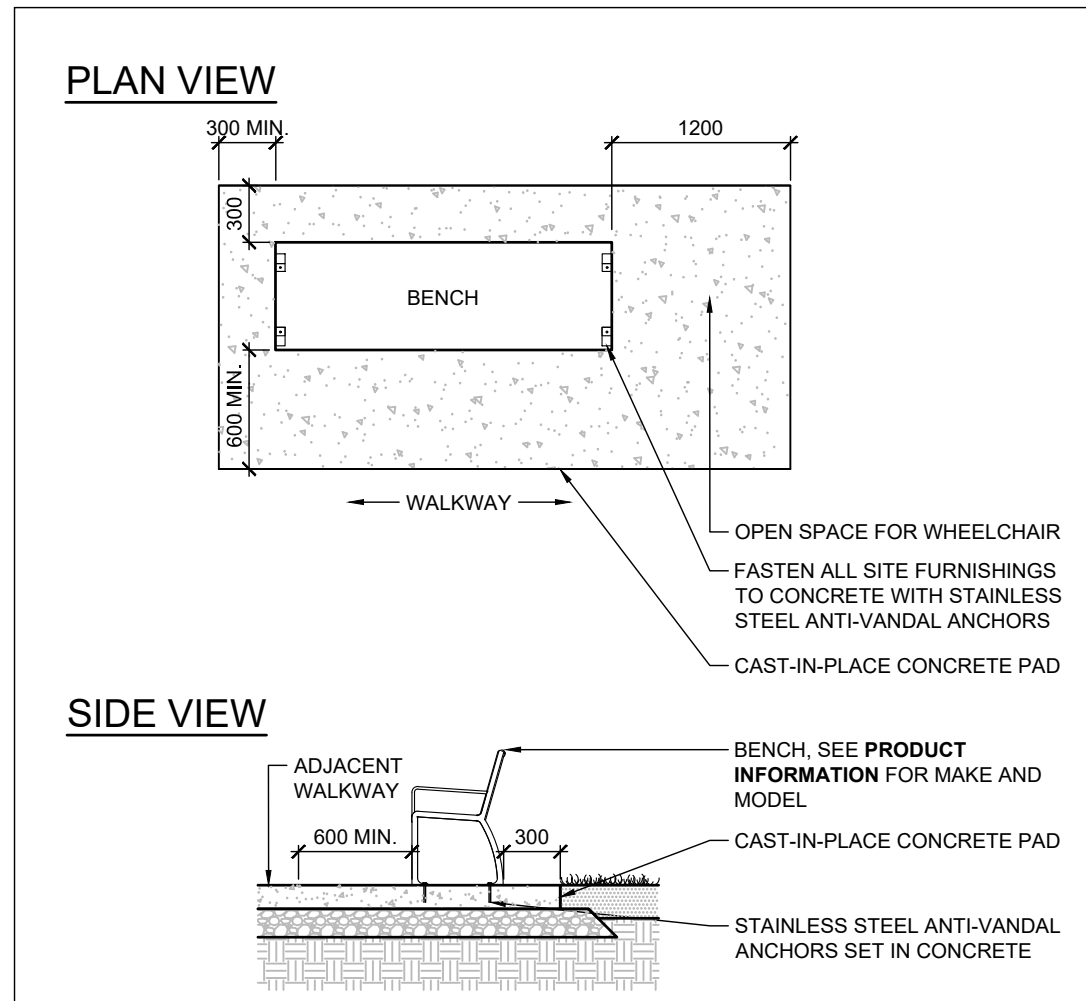

SITE FURNITURE INSTALLATION D6

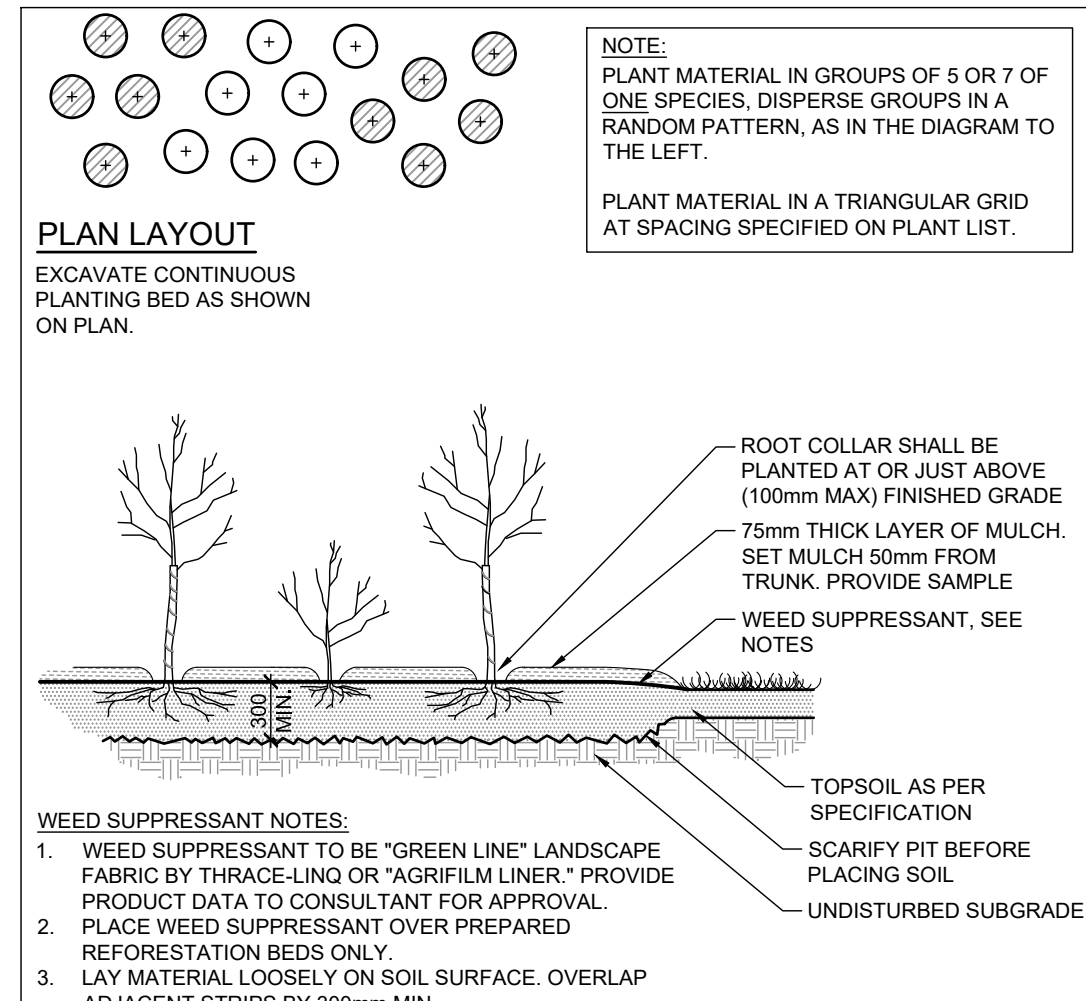

SHRUB NATURALIZATION D7

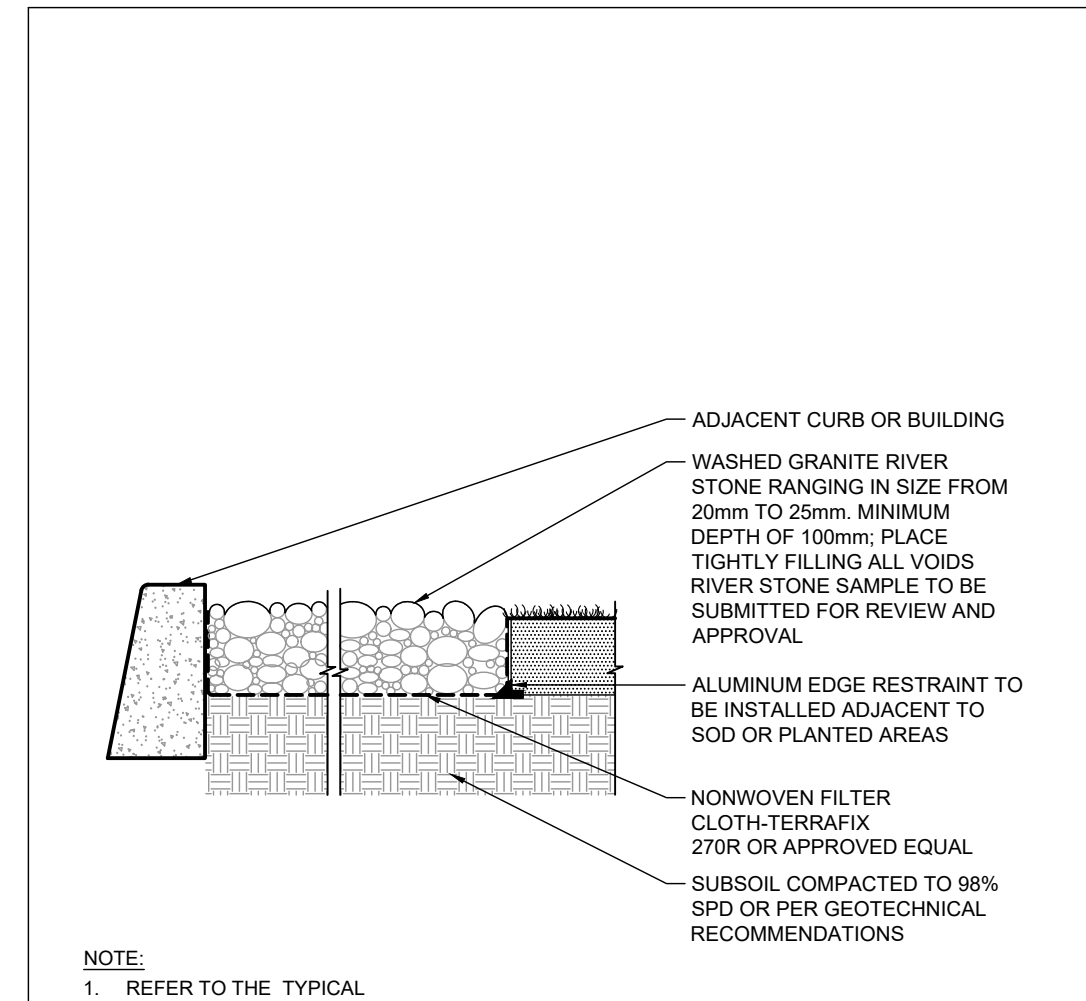

RIVERSTONE DETAIL D8

NOTE: THE POSITION OF ALL POLE LINES, CONDUITS, WATERMANS, SEWERS AND OTHER UNDERGROUND AND OVERGROUND UTILITIES AND STRUCTURES IS NOT NECESSARILY SHOWN ON THE CONTRACT DRAWINGS, AND WHERE SHOWN, THE ACCURACY OF THE POSITION OF SUCH UTILITIES AND STRUCTURES IS NOT GUARANTEED. BEFORE STARTING WORK, DETERMINE THE EXACT LOCATION OF ALL SUCH UTILITIES AND STRUCTURES AND ASSUME ALL LIABILITY FOR DAMAGE TO THEM.

Owner: Rosefellow c/o Julian Nihi 750 Marie-Laurin, Suite 210 Saint-Laurent, QC H4M 2M4 Phone: (514) 532-1080

NOT FOR CONSTRUCTION

No.	REVISION	DATE	BY
2.	REVISED PER CITY COMMENTS	MAR 30/23	RGJ
1.	ISSUED FOR CITY OF OTTAWA REVIEW	DEC 16/22	RGJ

SCALE	DESIGN
	KW
	CHECKED RGJ
	DRAWN KW
	CHECKED KW
	APPROVED RGJ

FOR REVIEW ONLY	

NOVATECH
 Engineers, Planners & Landscape Architects
 Suite 200, 240 Michael Cowpland Drive
 Ottawa, Ontario, Canada K2M 1P6
 Telephone (613) 254-9643
 Facsimile (613) 254-5867
 Website www.novatech-eng.com

LOCATION CITY OF OTTAWA 405 HUNTMAR DRIVE - WAREHOUSE DEVELOPMENT	PROJECT No. 122151
DRAWING NAME LANDSCAPE DETAILS	REV #2
	DRAWING No. 122151-L7