

THIS SITE PLAN HAS BEEN BASED ON THE SURVEYOR'S TOPOGRAPHY SKETCH PREPARED BY MCINTOSH PERRY SURVEYING INC., DATED OCTOBER 26th, 2021.

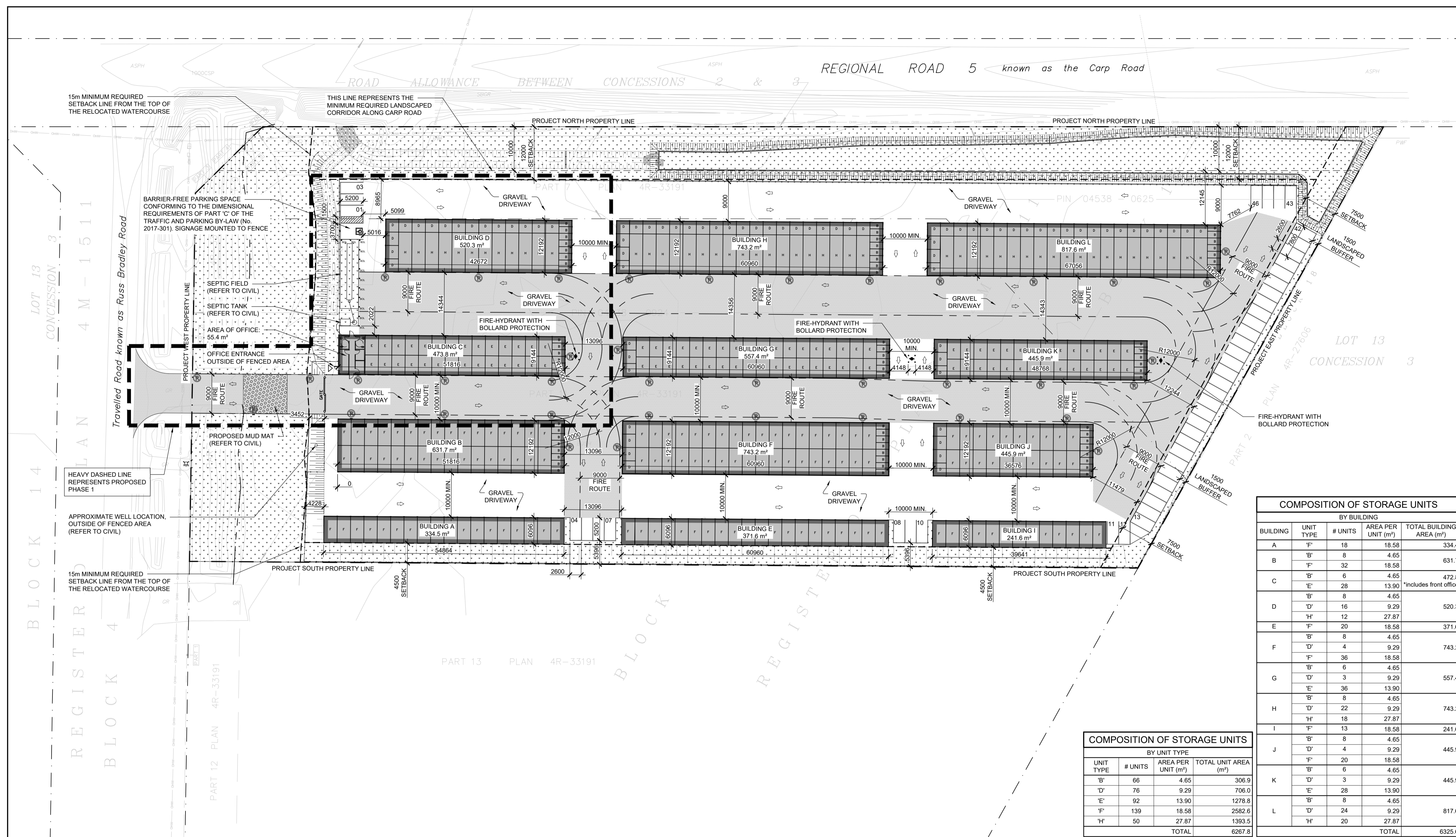

| COMPOSITION OF STORAGE UNITS |           |         |                    |                          |
|------------------------------|-----------|---------|--------------------|--------------------------|
| BY BUILDING                  |           |         |                    |                          |
| BUILDING                     | UNIT TYPE | # UNITS | AREA PER UNIT (m²) | TOTAL BUILDING AREA (m²) |
| A                            | 'F'       | 18      | 18.58              | 334.4                    |
| B                            | 'B'       | 8       | 4.65               | 631.7                    |
|                              | 'F'       | 32      | 18.58              |                          |
| C                            | 'B'       | 6       | 4.65               | 472.8                    |
|                              | 'E'       | 28      | 13.90              |                          |
| D                            | 'B'       | 8       | 4.65               | 520.3                    |
|                              | 'D'       | 16      | 9.29               |                          |
| E                            | 'H'       | 12      | 27.87              | 371.6                    |
|                              | 'F'       | 20      | 18.58              |                          |
| F                            | 'B'       | 8       | 4.65               | 743.2                    |
|                              | 'D'       | 4       | 9.29               |                          |
| G                            | 'F'       | 36      | 18.58              | 557.4                    |
|                              | 'B'       | 6       | 4.65               |                          |
| H                            | 'B'       | 8       | 4.65               | 743.2                    |
|                              | 'D'       | 22      | 9.29               |                          |
| I                            | 'H'       | 18      | 27.87              | 241.6                    |
|                              | 'F'       | 13      | 18.58              |                          |
| J                            | 'B'       | 8       | 4.65               | 445.9                    |
|                              | 'D'       | 4       | 9.29               |                          |
| K                            | 'F'       | 20      | 18.58              | 445.9                    |
|                              | 'B'       | 6       | 4.65               |                          |
| L                            | 'B'       | 8       | 4.65               | 817.6                    |
|                              | 'D'       | 24      | 9.29               |                          |
| TOTAL                        |           |         |                    | 6325.6                   |

| COMPOSITION OF STORAGE UNITS |         |                    |                      |
|------------------------------|---------|--------------------|----------------------|
| BY UNIT TYPE                 |         |                    |                      |
| UNIT TYPE                    | # UNITS | AREA PER UNIT (m²) | TOTAL UNIT AREA (m²) |
| 'B'                          | 66      | 4.65               | 306.9                |
| 'D'                          | 76      | 9.29               | 706.0                |
| 'E'                          | 92      | 13.90              | 1278.8               |
| 'F'                          | 139     | 18.58              | 2582.6               |
| 'H'                          | 50      | 27.87              | 1393.5               |
| TOTAL                        |         |                    | 6267.8               |

| Revisions |    |                                          |             |
|-----------|----|------------------------------------------|-------------|
| No.       | By | Description                              | Date        |
| 06        | JF | ISSUED FOR SITE PLAN CONTROL RESPONSE 01 | 04 OCT 2023 |
| 05        | JF | ISSUED FOR SITE PLAN CONTROL             | 16 DEC 2022 |
| 04        | JF | ISSUED FOR COORDINATION                  | 13 DEC 2022 |
| 03        | JF | ISSUED FOR COORDINATION                  | 27 SEP 2022 |
| 02        | JF | ISSUED FOR REVIEW                        | 17 JUN 2022 |
| 01        | JF | ISSUED FOR CLIENT REVIEW                 | 11 JAN 2022 |

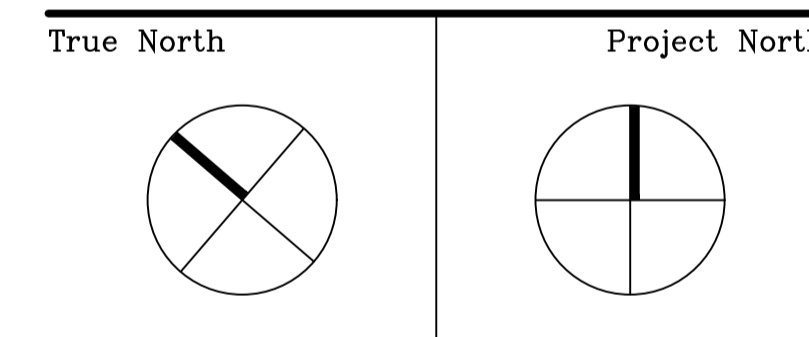

Project  
**SELF STORAGE SITE PLAN CONTROL**

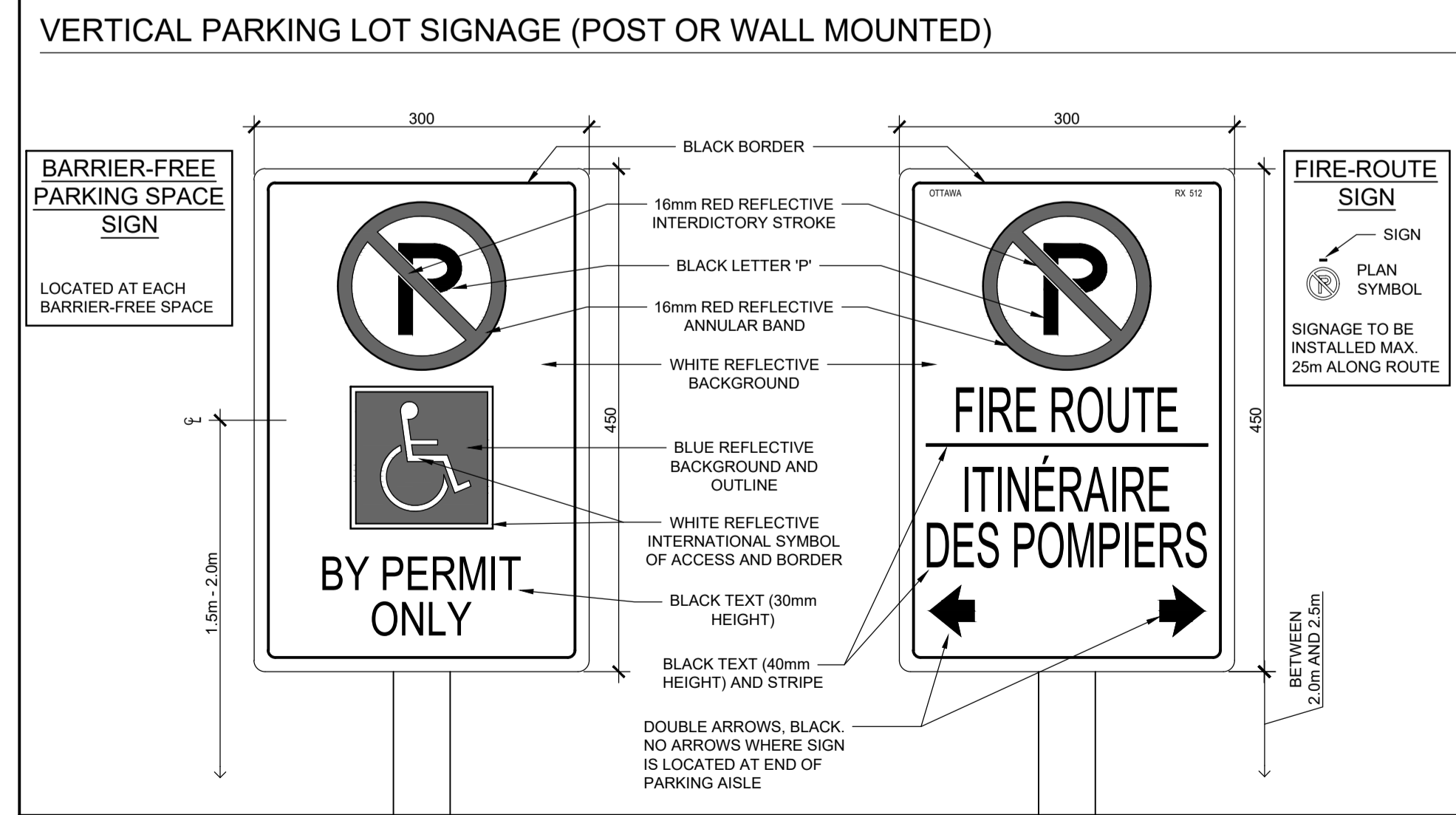

**ZONING INFORMATION**  
PER THE CITY OF OTTAWA ZONING BY-LAW 2008-250 CONSOLIDATION  
**LEGAL DESCRIPTION:** PORTIONS OF PARCEL 04538-0625, PARCEL 04538-0924 AND ADJUTING LANDS, PARTS 8 THROUGH 11, PLAN 4R-33191 BEING PART OF BLOCKS 15 AND 16, REGISTERED PLAN 4M-1511, CITY OF OTTAWA  
**PROPOSAL:** NEW GROSS 6,326 m² [68,093 ft²] SINGLE STOREY SELF STORAGE UNITS OVER 12 BUILDINGS. AN OFFICE, UTILITIES ROOM, AND WASHROOMS WILL BE PROVIDED IN THE BUILDING NEAREST THE MAIN DRIVEWAY ACCESS.  
**ZONING:** DESIGNATION: (T1B) AIR TRANSPORTATION FACILITY SUBZONE (PART 12)  
**ZONING PROVISIONS (PER TABLES 207 & 208):**  
• LOT AREA (MIN.) = NO MINIMUM  
ACTUAL LOT AREA = 24,247 m²  
• LOT FRONTAGE (MIN.) = NO MINIMUM  
ACTUAL FRONTAGE = 99.1 m  
• SETBACKS (MIN.):  
- FRONT = 12.0 m  
- CORNER SIDE = 12.0 m  
- INTERIOR SIDE = 4.5 m  
- REAR = 7.5 m  
• MINIMUM SETBACK FROM WATERCOURSE: 15.0 m FROM THE TOP OF BANK, PER SCHEDULE H OF SUBDIVISION AGREEMENT  
• MINIMUM LANDSCAPED BUFFER ABUTTING CARP ROAD = 10.0 m  
• MIN. % OF PARKING PROVIDED AS LANDSCAPED AREA = 15% MIN.  
- REQUIRED: = 93.15 m²  
- ACTUAL: = 6,140.4 m²

**SITE PLAN LEGEND**

|       |                                                        |      |                                                                                                          |
|-------|--------------------------------------------------------|------|----------------------------------------------------------------------------------------------------------|
| —     | PROPERTY LINE                                          | ○*   | APPROXIMATE LOCATION AND CROWN OF NEW AND EXISTING TREES (REFER TO CIVIL DRAWINGS FOR SPECIES)           |
| —     | PROPERTY MARKERS                                       | ▶    | PRINCIPAL ENTRANCES                                                                                      |
| - - - | SETBACK LINE                                           | ▶    | EMERGENCY EXITS                                                                                          |
| - - - | FIRE ROUTE LINES                                       | ▶    | SECONDARY ACCESS DOORS AND/OR OVERHEAD DOORS (OH)                                                        |
| - - - | NEIGHBOURING PROPERTY LINES                            | ▶    | FIRE-HYDRANT (REFER TO CIVIL)                                                                            |
| - - - | FENCELINES                                             | ▶    | NEW CATCH BASIN (REFER TO CIVIL)                                                                         |
| - - - | CARP                                                   | ▶    | TRAFFIC FLOW                                                                                             |
| - - - | STREETNAME AND CENTRELINE                              | ▶    | EXTERIOR WALL MOUNTED LIGHT PACKS (REFER TO ARCHITECTURAL ELEVATIONS AND ELECTRICAL ENGINEER'S DRAWINGS) |
| - - - | BARRIER-FREE CURB RAMP w/ TACTILE ATTENTION INDICATORS | ▶    | CONCRETE-FILLED PAINTED METAL BOLLARD                                                                    |
| ▨     | EXISTING BUILDINGS/ STRUCTURES                         | ○BOL | FIRE ROUTE/NO PARKING SIGNAGE - INSTALLED MAX. 25m ALONG ROUTE (SEE DETAIL THIS SHEET)                   |
| ▨     | EXTENTS OF PROPOSED BUILDING(S)                        |      |                                                                                                          |
| ▨     | LANDSCAPED AREA (REFER TO LANDSCAPE DRAWINGS)          |      |                                                                                                          |
| ▨     | HEAVY DUTY SURFACING (REFER TO CIVIL)                  |      |                                                                                                          |
| ▨     | CONCRETE SIDEWALK                                      |      |                                                                                                          |