

MERIVALE ROAD

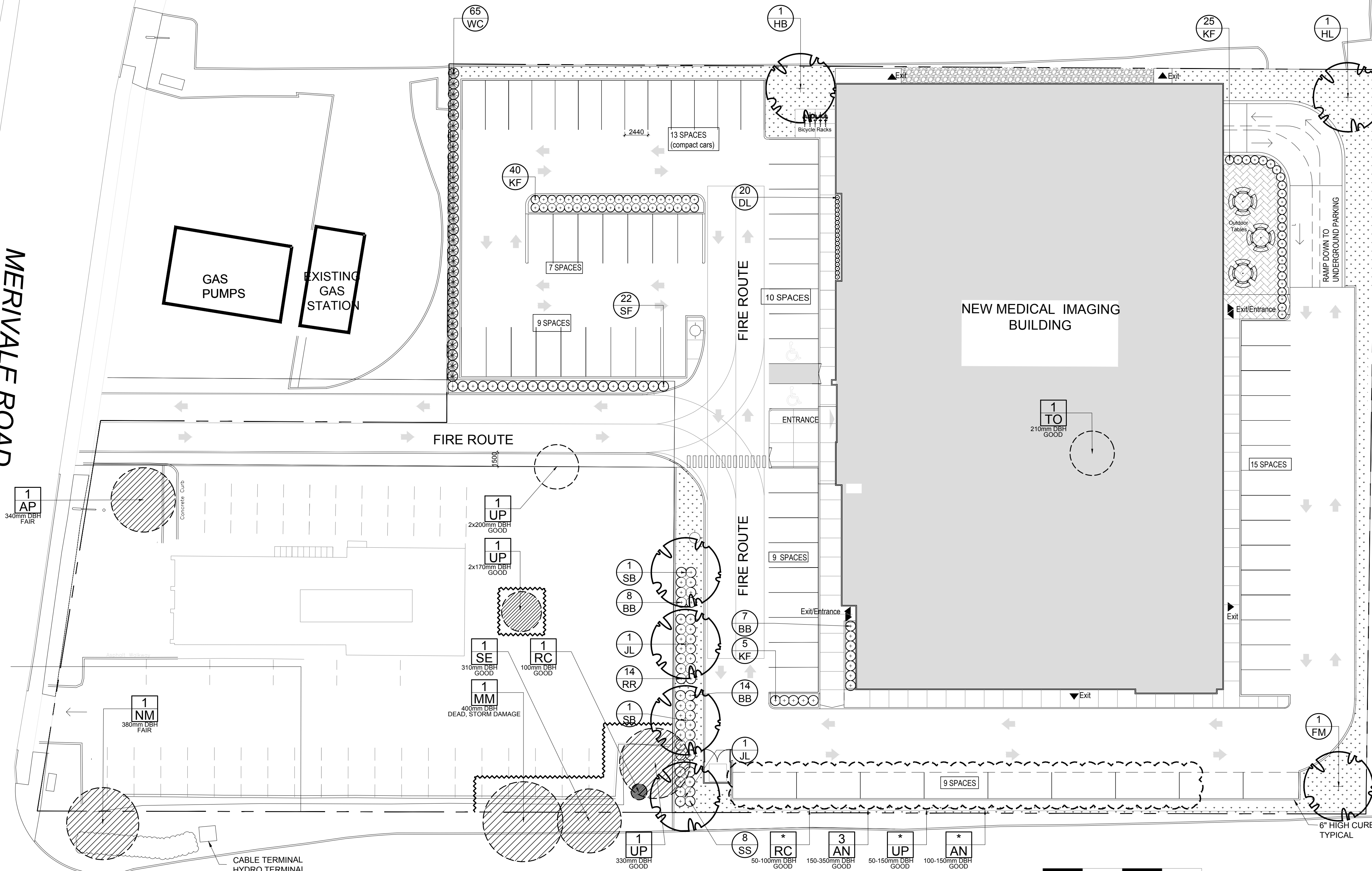

- GENERAL NOTES:**
- IT IS THE RESPONSIBILITY OF THE APPROPRIATE CONTRACTOR OR OFFICIAL TO REPORT ANY ERRORS, OMISSIONS OR DISCREPANCIES ON THIS PLAN WITH ACTUAL SITE CONDITIONS TO THE LANDSCAPE ARCHITECT BEFORE PROCEEDING WITH CONSTRUCTION.
 - THE CONTRACTOR IS TO NOTIFY ALL UTILITY COMPANIES AND AUTHORITIES PRIOR TO ANY EXCAVATION AND ASCERTAIN LOCATIONS OF UNDERGROUND SERVICES.
 - THE CONTRACTOR IS TO REINSTATE ALL AREAS AND ITEMS DAMAGED AS A RESULT OF CONSTRUCTION ACTIVITY.
 - THE CONTRACTOR IS TO COMPLY WITH ALL PERTINENT CODES AND BY-LAWS.
 - THE CONTRACTOR IS TO MAINTAIN A POSITIVE SURFACE RUN-OFF THROUGHOUT THE ENTIRE CONSTRUCTION PERIOD.
 - THE LANDSCAPE ARCHITECT IS NOT RESPONSIBLE FOR SUBSURFACE CONDITIONS.
 - THE CONTRACTOR IS TO IDENTIFY ALL EXISTING TREES TO REMAIN ON SITE WITH THE LANDSCAPE ARCHITECT PRIOR TO CONSTRUCTION.
 - THE CONTRACTOR IS TO STAKE THE PROPOSED LOCATION OF ALL PLANT MATERIAL IN CONJUNCTION WITH THE LANDSCAPE ARCHITECT PRIOR TO EXCAVATION.
 - MINIMUM DISTANCES FOR SELECTED DECIDUOUS TREES ARE AS FOLLOWS:
 - BUILDING FOUNDATIONS - 7.5M
 - SIDEWALKS - 1.5M
 - PUBLIC STREETS - 2.5M
 - UNDERGROUND INFRASTRUCTURE - 2.0M
 - ALL TREES WITHIN 1M OF UNDERGROUND UTILITY TRENCHES ARE TO BE EXCAVATED BY HAND.
 - REMOVE ALL PROTECTIVE WRAPPINGS FROM TREE TRUNKS AFTER INSTALLATION.
 - STAKING OF TREES SHALL ONLY BE PERFORMED IF NECESSARY.
 - ENSURE THAT MULCH IS PULLED BACK A MINIMUM DISTANCE OF 75MM FROM BASE OF TREE TRUNK.

CLIENT
1545A MERIVALE INC.

CONSULTANTS
ARCHITECTS:
(L+D)
LALANDE + DOYLE ARCHITECTS INC.
www.l+d.ca
Tel: 613.233.2600
Fax: 613.233.1008
100 Holland Ave
Ottawa, Ontario K1Y 0T2

CIVIL ENGINEERS:
NOVATECH
ENGINEERING CONSULTANTS LTD.
ENGINEERS & PLANNERS

- LEGEND**
- EXISTING TREE TO REMAIN
 - EXISTING TREE TO BE REMOVED
 - GROUP OF EXISTING TREES TO BE REMOVED
 - PROPOSED SHRUBS / PERENNIALS / ORNAMENTAL GRASSES
 - PROPOSED DECIDUOUS TREE
 - PROPOSED RIVERSTONE MULCH
 - PROPOSE SOD
 - PROPOSED PRECAST CONCRETE PAVERS
 - TREE PROTECTION FENCE



3 PROPOSED THREE (3) RING BIKE RACK
SCALE: NTS

PROPOSED PLANT LIST

KEY	QTY	BOTANICAL NAME	COMMON NAME	SIZE	CONDITION	REMARKS
TREES						
FM	1	Acer x freemanii	Freeman's Maple	60mm cal.	B&B	
HB	1	Celtis occidentalis	Hackberry	60mm cal.	B&B	
HL	1	Gleditsia triacanthos	Honey Locust	60mm cal.	B&B	
JL	2	Syringa reticulata	Japanese Tree Lilac	60mm cal.	B&B	
SB	2	Amelanchier canadensis	Serviceberry	60mm cal.	B&B	
SHRUBS						
BB	29	Euonymus alatus 'Compactus'	Dwarf Burning Bush	600mm ht.	Potted	Space 1000mm o.c.
RR	14	Rosa rugosa	Rugosa Rose	600mm ht.	Potted	Space 1000mm o.c.
SF	22	Sorbaria sorbifolia 'Sem'	Sem False Spiraea	600mm ht.	Potted	Space 1000mm o.c.
SS	8	Sorbaria sorbifolia	Ural False Spiraea	600mm ht.	Potted	Space 1000mm o.c.
WC	65	Thuja occidentalis 'Clumps'	White Cedar Clumps	1200mm ht.	Bare root	Space 450mm o.c.
ORNAMENTAL GRASSES & PERENNIALS						
DL	20	Hemerocallis 'Stella D'Oro'	Stella D'Oro Daylily	100mm pot	Potted	Space 400mm o.c.
KF	70	Calamagrostis x acutiflora 'Karl Foerster'	Feather Reed Grass	250mm pot.	Potted	Space 800mm o.c.

EXISTING TREE LIST

KEY	QTY	BOTANICAL NAME	COMMON NAME	SIZE	CONDITION	REMARKS	OWNERSHIP
AN	*	Acer negundo	Manitoba Maple	100-350mm dbh	GOOD	To be removed	1545 Merivale Road
AP	1	Acer platanoides	Norway Maple	340mm db	FAIR, TAR SPOT	To remain	1545 Merivale Road
MM	1	Acer negundo	Norway Maple	400mm dbh	FAIR, TAR SPOT	To remain	1547 Merivale Road
NM	1	Acer platanoides	Norway Maple	380mm db	FAIR, TAR SPOT	To remain	1547 Merivale Road
RC	*	Rhamnus cathartica	Common Buckthorn	50-100mm db	GOOD	See plan	1545 Merivale Road
SE	1	Ulmus pumila	Siberian Elm	310mm dbh	GOOD	To remain	1547 Merivale Road
TO	1	Thuja occidentalis 'Fastigiata'	Pyramidal Cedar	200mm dbh	GOOD	To be removed	1545 Merivale Road
UP	*	Ulmus pumila	Siberian Elm	50-330mm dbh	GOOD	See plan	1545 Merivale Road

*DENOTES NUMEROUS

1 TREE CONSERVATION REPORT & LANDSCAPE PLAN
SCALE 1:300

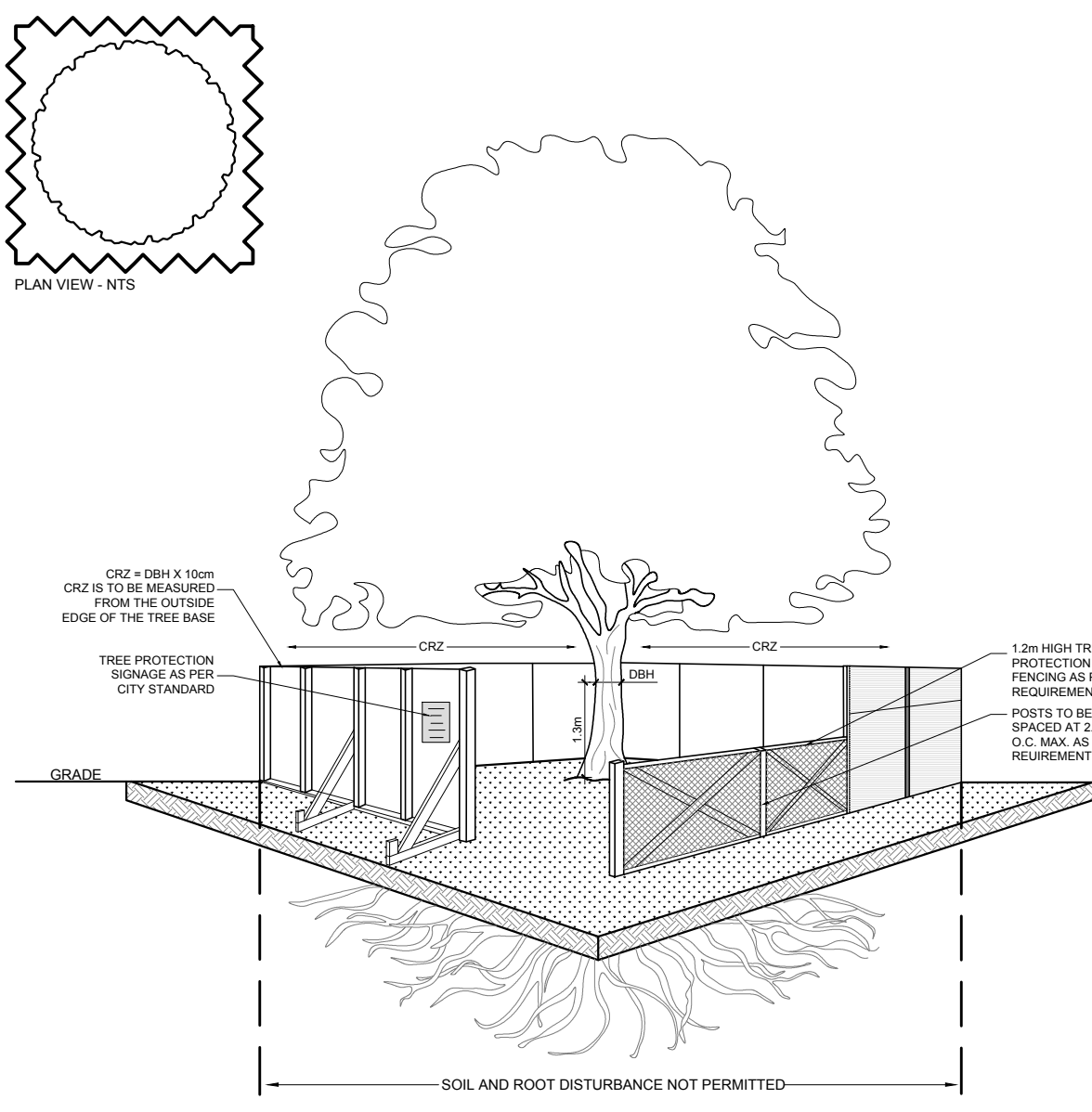

2 TREE PROTECTION FENCE
SCALE: NTS

- TREE PROTECTION REQUIREMENTS:**
1. PRIOR TO ANY WORK ACTIVITY WITHIN THE CRITICAL ROOT ZONE (CRZ) OF A TREE, TREE PROTECTION FENCING MUST BE INSTALLED SURROUNDING THE CRITICAL ROOT ZONE AND REMAIN IN PLACE UNTIL THE WORK IS COMPLETE.
 - DO NOT PLACE ANY MATERIAL OR EQUIPMENT INCLUDING OUTHOUSES;
 - DO NOT ATTACH ANY SIGNS, NOTICES OR POSTERS TO ANY TREE;
 - DO NOT RAISE OR LOWER THE EXISTING GRADE; TUNNEL, OR BORE WHEN DIGGING;
 - DO NOT DAMAGE THE ROOT SYSTEM, TRUNK, OR BRANCHES OF ANY TREE;
 - ENSURE THAT EXHAUST FUMES FROM ALL EQUIPMENT ARE NOT DIRECTED TOWARDS ANY TREE CANOPY;
 - DO NOT EXCEED HARD SURFACE OR SIGNIFICANTLY CHANGE LANDSCAPING
 2. UNLESS PLANS ARE APPROVED BY CITY FORESTRY STAFF, FOR WORK WITHIN THE CRZ:
 - DO NOT PLACE ANY MATERIAL OR EQUIPMENT INCLUDING OUTHOUSES;
 - DO NOT ATTACH ANY SIGNS, NOTICES OR POSTERS TO ANY TREE;
 - DO NOT RAISE OR LOWER THE EXISTING GRADE; TUNNEL, OR BORE WHEN DIGGING;
 - DO NOT DAMAGE THE ROOT SYSTEM, TRUNK, OR BRANCHES OF ANY TREE;
 - ENSURE THAT EXHAUST FUMES FROM ALL EQUIPMENT ARE NOT DIRECTED TOWARDS ANY TREE CANOPY;
 - DO NOT EXCEED HARD SURFACE OR SIGNIFICANTLY CHANGE LANDSCAPING
 3. TREE PROTECTION FENCING MUST BE AT LEAST 1.2m IN HEIGHT, AND BE CONSTRUCTED OF ROAD OR FRAMED MATERIALS (E.G. MODULOC® STEEL PLYWOOD HOARDING, OR SNOW FENCE ON A 2"x4" WOOD FRAME) WITH POSTS 2.4m APART, SUCH THAT THE FENCE LOCATION CANNOT BE ALTERED. ALL SUPPORTS AND BRACKING MUST BE PLACED OUTSIDE OF THE CRZ, AND INSTALLATION MUST MINIMIZE DAMAGE TO EXISTING ROOTS. (SEE DETAIL)
 4. THE LOCATION OF THE TREE PROTECTION FENCING MUST BE DETERMINED BY AN ARBORIST AND DETAILED ON AN ASSOCIATED PLAN FOR THE SITE (E.G. TREE CONSERVATION REPORT, TREE DISCLOSURE REPORT, ETC). THE PLAN AND CONSTRUCTED FENCING MUST BE APPROVED BY CITY FORESTRY STAFF PRIOR TO THE COMMENCEMENT OF WORK.
 5. IF THE FENCED TREE PROTECTION AREA MUST BE REDUCED TO FACILITATE CONSTRUCTION, MITIGATION MEASURES MUST BE PRESCRIBED BY AN ARBORIST AND APPROVED BY CITY FORESTRY STAFF. THESE MAY INCLUDE THE PLACEMENT OF PLYWOOD, WOOD CHIPS OR STEEL PLATING OVER THE ROOTS FOR PROTECTION AND THE PROPER PRUNING AND CARE OF ROOTS WHERE ENCOUNTERED.
- BY-LAWS:**
- ALL CITY-OWNED TREES ARE PROTECTED UNDER THE MUNICIPAL TREES AND NATURAL AREAS PROTECTION BY-LAW (2008-079). WITHIN THE URBAN AREA, PRIVATELY-OWNED TREES GREATER THAN 50cm IN DIAMETER ON LOTS 1 HECTARE IN SIZE OR LESS, AND TREES GREATER THAN 15cm IN DIAMETER ON LOTS GREATER THAN 1 HECTARE, ARE PROTECTED UNDER THE URBAN TREE CONSERVATION BY-LAW (2008-200).

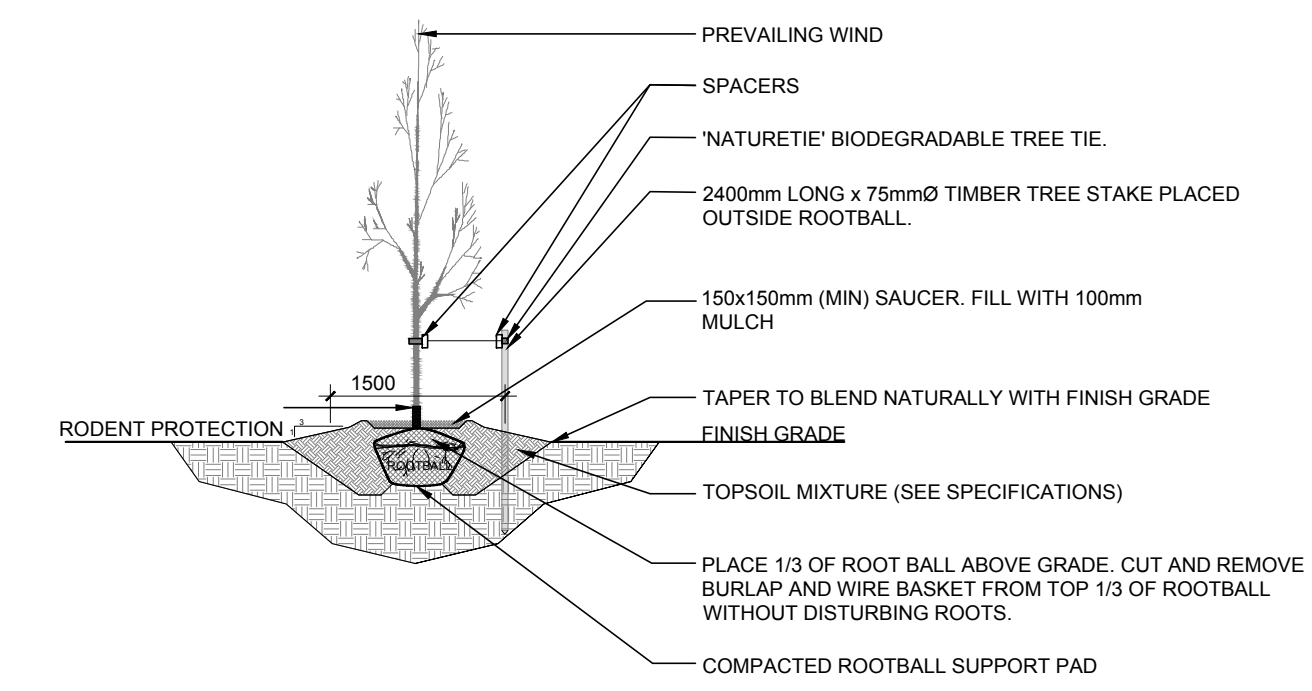

4 DECIDUOUS TREE PLANTING
SCALE: NTS

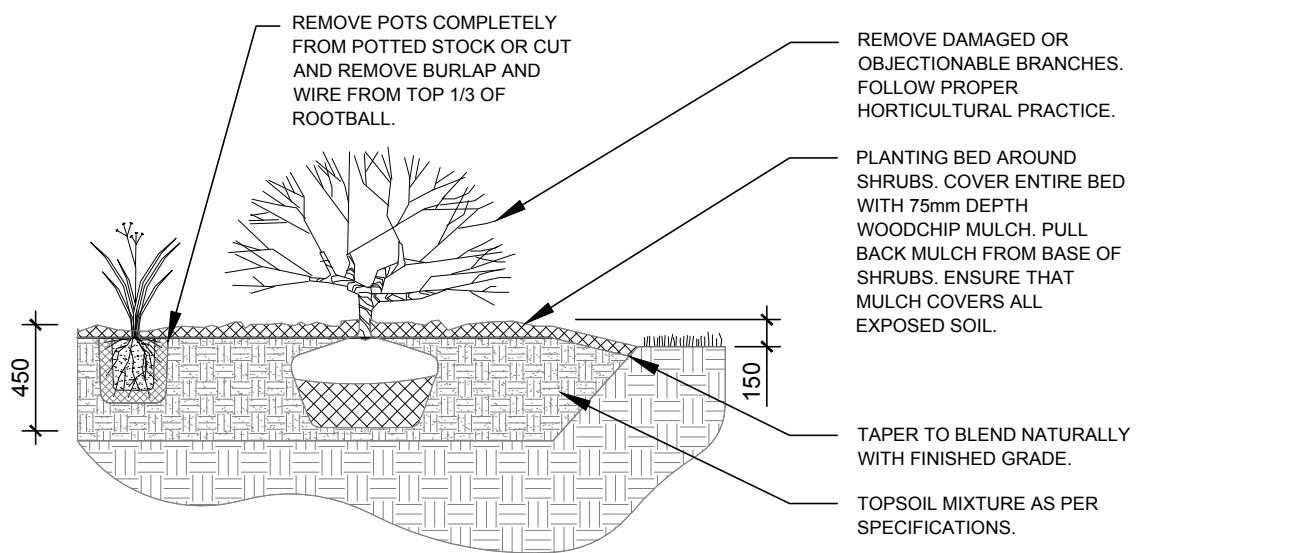

5 SHRUB / PERENNIAL / ORNAMENTAL GRASS PLANTING
SCALE: NTS

No.	Issue	Date	ML	JL	DR	CK
1	ISSUED FOR SITE PLAN CONTROL	12/23/2022				

JAMES B. LENNOX & ASSOCIATES INC.
LANDSCAPE ARCHITECTS
3333 CARLING AVE. OTTAWA, ONTARIO K2H 5A8
Tel: (613) 722-5168 Fax: (866) 343-3942

PROJECT
MERIVALE MEDICAL IMAGING CLINIC
1545 MERIVALE ROAD, OTTAWA ON

DRAWING
TREE CONSERVATION REPORT & LANDSCAPE PLAN

STAMP
SCALE
AS SHOWN
START DATE
OCTOBER 2022
PROJECT NO.

PROJECT NORTH
DRAWING NO.
L.1
PLOT SIZE ARCH-D