

Copyright Reserved

The Contractor shall verify and be responsible for all dimensions. DO NOT scale the drawings - any errors or omissions shall be reported to Stantec without delay.  
The Copyrights to all designs and drawings are the property of Stantec. Reproduction or use for any purpose other than that authorized by Stantec is forbidden.

Legend

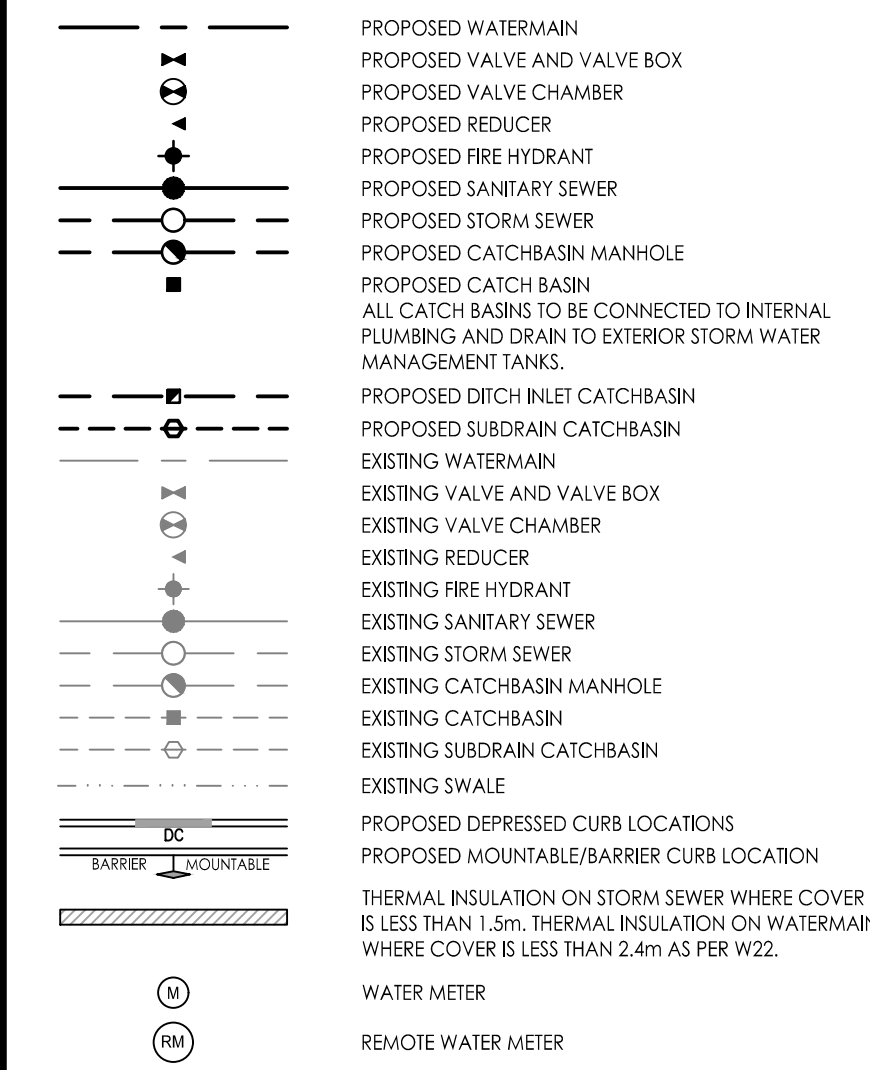

NOTES:

- 1. UNDERGROUND PARKING RAMP TRENCH DRAINS TO BE CONVEYED THROUGH BUILDING AND OUTLET INTO EXTERNAL UNDERGROUND STORM WATER MANAGEMENT STORAGE TANKS.
- 2. ALL SURFACE CATCH BASINS INSTALLED ON TOP OF UNDERGROUND PARKING STRUCTURE TO BE CONVEYED THROUGH BUILDING AND OUTLET INTO EXTERNAL UNDERGROUND STORM WATER MANAGEMENT STORAGE TANKS.
- 3. PROPOSED FIRE HYDRANT TO BE SERVICED THROUGH BUILDINGS INTERNAL PLUMBING.
- 4. ALL CATCHBASINS AND FIRE HYDRANTS INSTALLED ON TOP OF PARKING GARAGE STRUCTURE ARE TO BE INSTALLED BY OTHERS.
- 5. INTERNAL GARAGE DRAINS TO BE CONNECTED TO THE SANITARY SEWER.

- 6. AT THE COMPLETION OF CONSTRUCTION A WATER SYSTEM PRESSURE CHECK IS REQUIRED TO BE COMPLETED TO DETERMINE IF PRESSURE CANNOT BE MAINTAINED AT 2.0 BAR.

No.	Description	MJS	DT	MJS	DT
10	REVISED PER CITY COMMENTS	MJS	DT	23.09.01	
9	REVISED AS PER CITY COMMENTS	MJS	DT	23.06.30	
8	REVISED WATER SERVICING	MJS	DT	23.03.10	
7	REVISED ADS SYSTEM	MJS	DT	23.12.13	
6	ISSUED FOR SPA AMENDMENT	MJS	DT	22.12.22	
5	REVISED AS PER CITY COMMENTS	MJS	DT	22.07.14	
4	REVISED AS PER CITY COMMENTS	MJS	DT	22.03.29	
3	REVISED AS PER CITY COMMENTS	MJS	TR	21.09.02	
2	ISSUED FOR GEOTECH REVIEW	MJS	DT	21.08.03	
1	ISSUED TO CITY FOR SPA	MJS	DT	20.05.22	

Revision	By	Appd.	YY.MM.DD
1	MJS	DT	20.05.22

File Name: 160401511-DB MJS DT MJS 19.09.05 Dwn. Chkd. Dsgn. YY.MM.DD

Permit-Seal

Client/Project  
NAUTICAL LANDS GROUP  
2962 Carp Road  
WELLINGS OF STITTSVILLE PH 2  
20 CEDAROW COURT  
OTTAWA, ON

Title  
SITE SERVICING PLAN

Project No. 160401511	Scale 1:500	Sheet 1	Revision
--------------------------	----------------	------------	----------

SSP-1 3 of 7 10  
PLAN No. 18190

Proposed ICD Schedule

Area ID	Office Name	ICD Invert	ICD Type	2yr Head (m)	2yr Flow (L/s)	100yr Head (m)	100yr Flow (L/s)
L102A	CB102A-1	102.70	IPEX TEMPEST HF (102mm ORIFICE)	0.33	10.9	1.21	22.8
L103A	CB103A-1	103.07	IPEX TEMPEST HF (178mm ORIFICE)	0.25	25.2	1.22	69.5
L103B	CB103B-1	102.42	IPEX TEMPEST HF (83mm ORIFICE)	0.52	9.9	1.25	15.3
L103C	CB103C-1	102.70	IPEX TEMPEST HF (83mm ORIFICE)	0.67	10.9	1.45	16.5
L103D	CB103D-1	102.62	IPEX TEMPEST HF (152mm ORIFICE)	0.60	33.3	1.49	56.1
L103E	CB103E-1	102.43	IPEX TEMPEST HF (127mm ORIFICE)	1.18	35.1	1.36	37.4
L104A/B	CBMM104A	102.61	IPEX TEMPEST HF (102mm ORIFICE)	1.17	21.9	1.34	24.4
L106A	CB106A-1	101.97	IPEX TEMPEST HF (102mm ORIFICE)	1.05	22.8	1.46	25.0
L502A/B	EA502-1	102.02	IPEX TEMPEST HF (83mm ORIFICE)	1.27	15.2	2.16	20.0
ADS TANK	100-O1	101.37	IPEX TEMPEST HF (83mm ORIFICE)	0.91	12.8	1.83	18.3
ADS TANK	100-O2	102.25	200mm CIRCUULAR ORIFICE	0.03	1.9	0.95	78.1
ADS TANK	100-WS1	103.00	500mm WIDE WEIR	0.00	0.0	0.20	58.3
UNC-4	CBMH105	102.88	IPEX TEMPEST HF (83mm ORIFICE)	0.71	11.2	1.78	18.1

\*NOTE: FLOW VALUES HAVE BEEN ADJUSTED DUE TO IMPACTS BY DOWNSTREAM ADS STORAGE UNIT HGL

Schedule of Roof Release Rates

Roof	Number of Drains	Drain Type	100yr Head (m)	100yr Flow (L/s)	100yr Storage (m3)
ROOF1	2	Watts Accrotel Weir (50% Open)	0.13	2.3	5.3
ROOF2	9	Watts Accrotel Weir (50% Open)	0.15	11.2	83.8
ROOF3	8	Watts Accrotel Weir (50% Open)	0.15	9.9	69.0
ROOF4	2	Watts Accrotel Weir (50% Open)	0.13	2.3	5.3

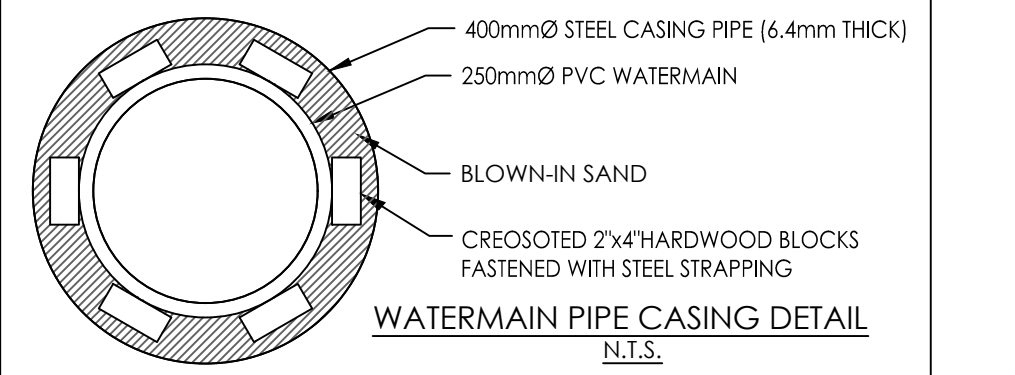
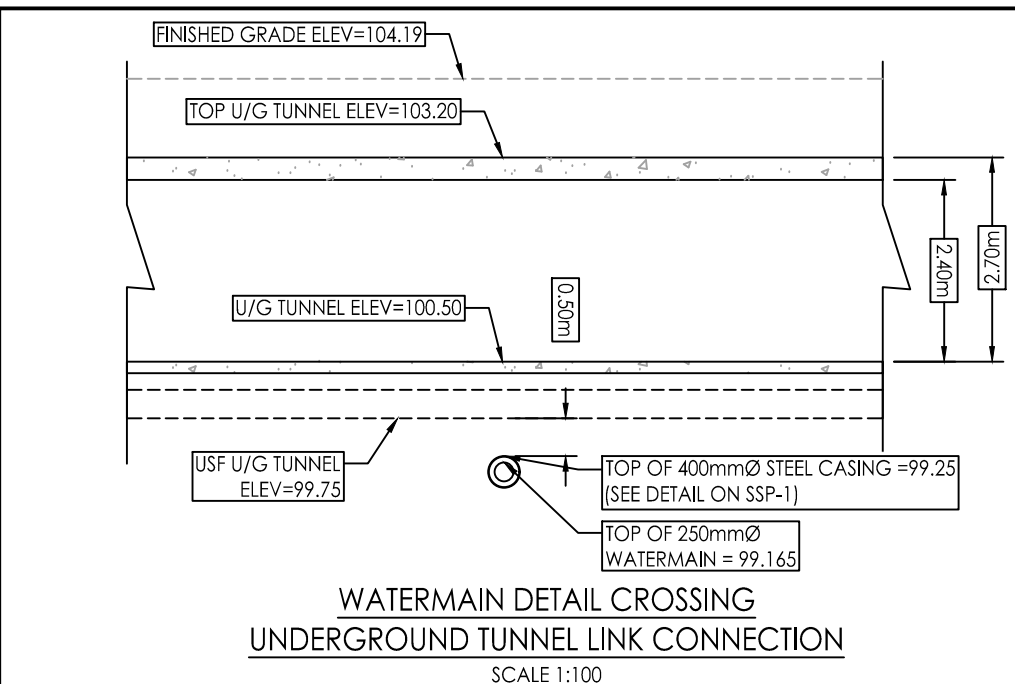

250mm Ø WATERMAIN DEFLECTION UNDER U/G TUNNEL

STATION	FINISHED GRADE	TOP OF W/M	ITEM
0+00	104.68	101.48	CONNECT TO EX 250mmØ WATERMAIN WITH 45° VERTICAL BEND
0+03.0	104.66	99.145	45° VERTICAL BEND
0+03.75	104.66	99.145	START OF 40mmØ STEEL SLEEVE
0+04.25	104.60	99.145	END OF 40mmØ STEEL SLEEVE
0+10.0	104.00	99.145	45° VERTICAL BEND
0+13	103.95	101.50	CONNECT TO EX 250mmØ WATERMAIN WITH 45° VERTICAL BEND

200mm Ø WATERMAIN A

STATION	FINISHED GRADE	TOP OF W/M	ITEM
0+00	104.47	101.48	CONNECT TO EX VALVE CHAMBER (300mmØ W/M) AND REDUCE TO 200mmØ
0+02	104.44	102.50	22° HORIZONTAL BEND
0+09.8	104.37	101.97	22° HORIZONTAL BEND
0+02	104.44	102.50	TOP OF PIPE
0+40	104.43	102.50	TOP OF PIPE
0+60	104.30	101.80	TOP OF PIPE
0+80	104.64	101.40	TOP OF PIPE
0+100	104.46	102.50	TOP OF PIPE
0+120	104.42	102.50	TOP OF PIPE
0+132	104.56	101.80	200mmØ VALVE AND VALVE BOX
0+139.4	104.58	101.80	45° VERTICAL BEND, CROSSING AS PER W3.2 INSULATE PER W2
0+141.0	104.58	102.50	45° VERTICAL BEND, CROSSING AS PER W3.2 INSULATE PER W2
0+141.6	104.58	102.50	45° VERTICAL BEND, CROSSING AS PER W3.2 INSULATE PER W2
0+143.4	104.58	101.80	45° VERTICAL BEND, CROSSING AS PER W3.2 INSULATE PER W2
0+144	104.31	101.810	TEE CONNECTION TO EXISTING 250mmØ WATERMAIN

SEWER AND WATERMAIN CROSSING TABLE

CROSSING ID	STM INV	STM OBV	WTR TOP	WTR BTM
1	101.45	101.83	102.53	102.33
2	102.61(102.53)	103.06(103.14)	102.06	101.84
3	100.89	101.14	101.95	101.75
4	102.90	103.10	102.02	101.82
5	102.80	103.00	102.04	101.84

CITY OF OTTAWA GROSS FLOOR AREAS & AMENITY AREAS (2&3)

Level	Area	City GFA	Amenity Area	Communal Amenity Area	Commercial
LEVEL 01	1801.58 m²	1801.58 m²	0.00 m²	0.00 m²	0.00 m²
LEVEL 01	160.24 m²	0.00 m²	160.24 m²	0.00 m²	0.00 m²
LEVEL 01	3182.96 m²	0.00 m²	0.00 m²	3182.96 m²	0.00 m²
LEVEL 01	950.85 m²	0.00 m²	0.00 m²	0.00 m²	950.85 m²
LEVEL 02	3640.94 m²	0.00 m²	0.00 m²	0.00 m²	0.00 m²
LEVEL 02	315.00 m²	0.00 m²	315.00 m²	0.00 m²	0.00 m²
LEVEL 02	124.77 m²	0.00 m²	0.00 m²	124.77 m²	0.00 m²
LEVEL 03	3875.75 m²	0.00 m²	0.00 m²	0.00 m²	0.00 m²
LEVEL 03	373.83 m²	0.00 m²	373.83 m²	0.00 m²	0.00 m²
LEVEL 04	3812.03 m²	0.00 m²	0.00 m²	0.00 m²	0.00 m²
LEVEL 04	375.40 m²	0.00 m²	375.40 m²	0.00 m²	0.00 m²
LEVEL 05	3518.63 m²	0.00 m²	3518.63 m²	0.00 m²	0.00 m²
LEVEL 05	558.52 m²	0.00 m²	558.52 m²	0.00 m²	0.00 m²
LEVEL 06	3526.92 m²	0.00 m²	3526.92 m²	0.00 m²	0.00 m²
LEVEL 06	460.12 m²	0.00 m²	460.12 m²	0.00 m²	0.00 m²
Grand total	26678.13 m²	20176.45 m²	2243.10 m²	3307.73 m²	950.85 m²

UNIT TYPES AND BARRIER FREE UNITS

	LEVEL 1		LEVEL 2		LEVEL 3		LEVEL 4		LEVEL 5		LEVEL 6	
	TOTAL UNITS	BARRIER FREE UNITS	TOTAL UNITS	BARRIER FREE UNITS	TOTAL UNITS	BARRIER FREE UNITS	TOTAL UNITS	BARRIER FREE UNITS	TOTAL UNITS	BARRIER FREE UNITS	TOTAL UNITS	BARRIER FREE UNITS
STUDIO	0	0	6	2	9	2	9	2	5	2	5	2
1 BED	22	0	39	6	41	7	43	9	45	7	45	7
1 BED + DEN	2	1	3	1	3	1	3	0	3	0	3	0
2 BED	4	2	10	2	10	2	8	2	8	2	8	1
2 BED + DEN	0	0	2	1	2	1	2	1	2	0	2	0
TOTALS	28	3	60	12	65	13	65	14	63	11	63	10

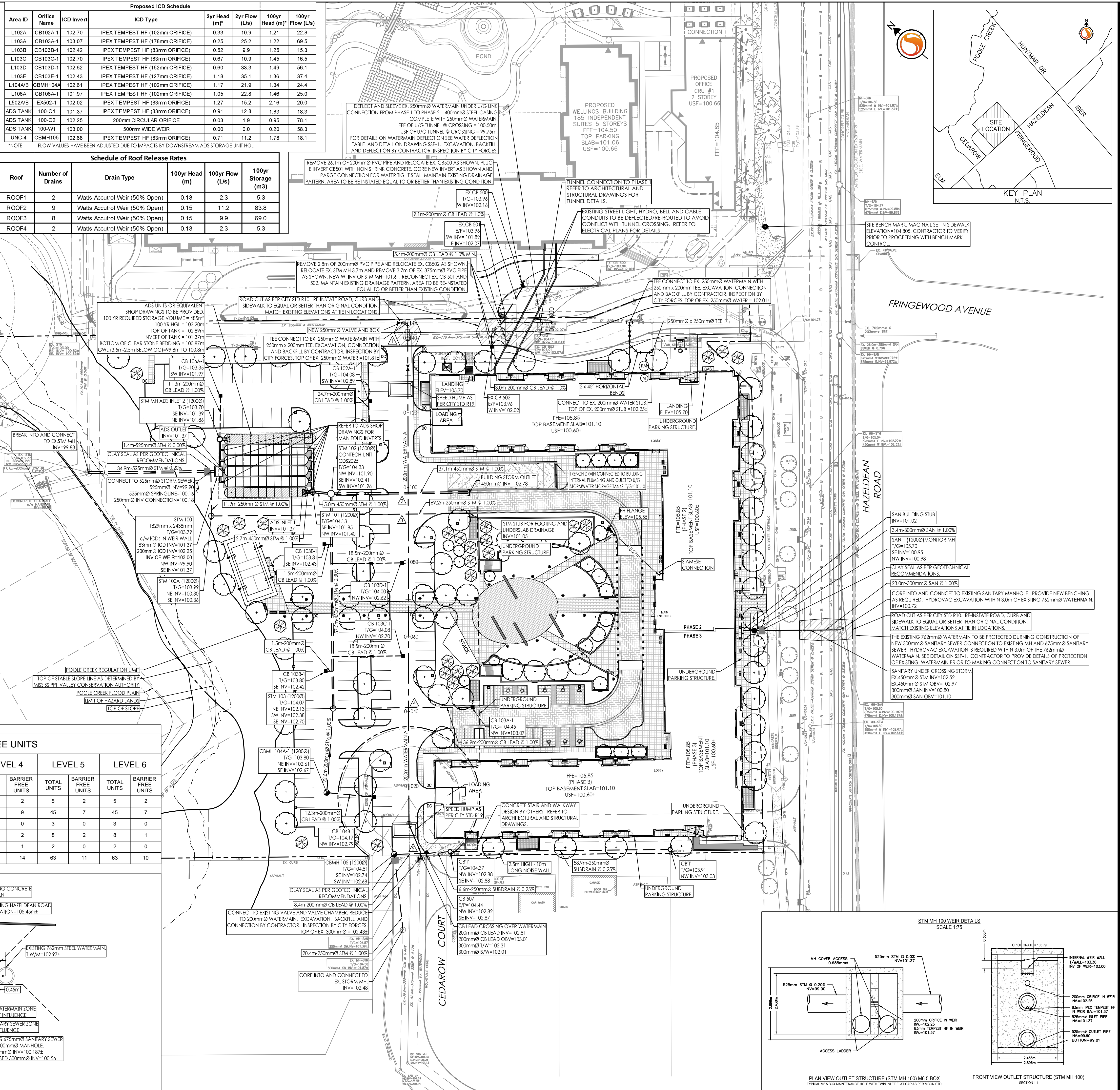
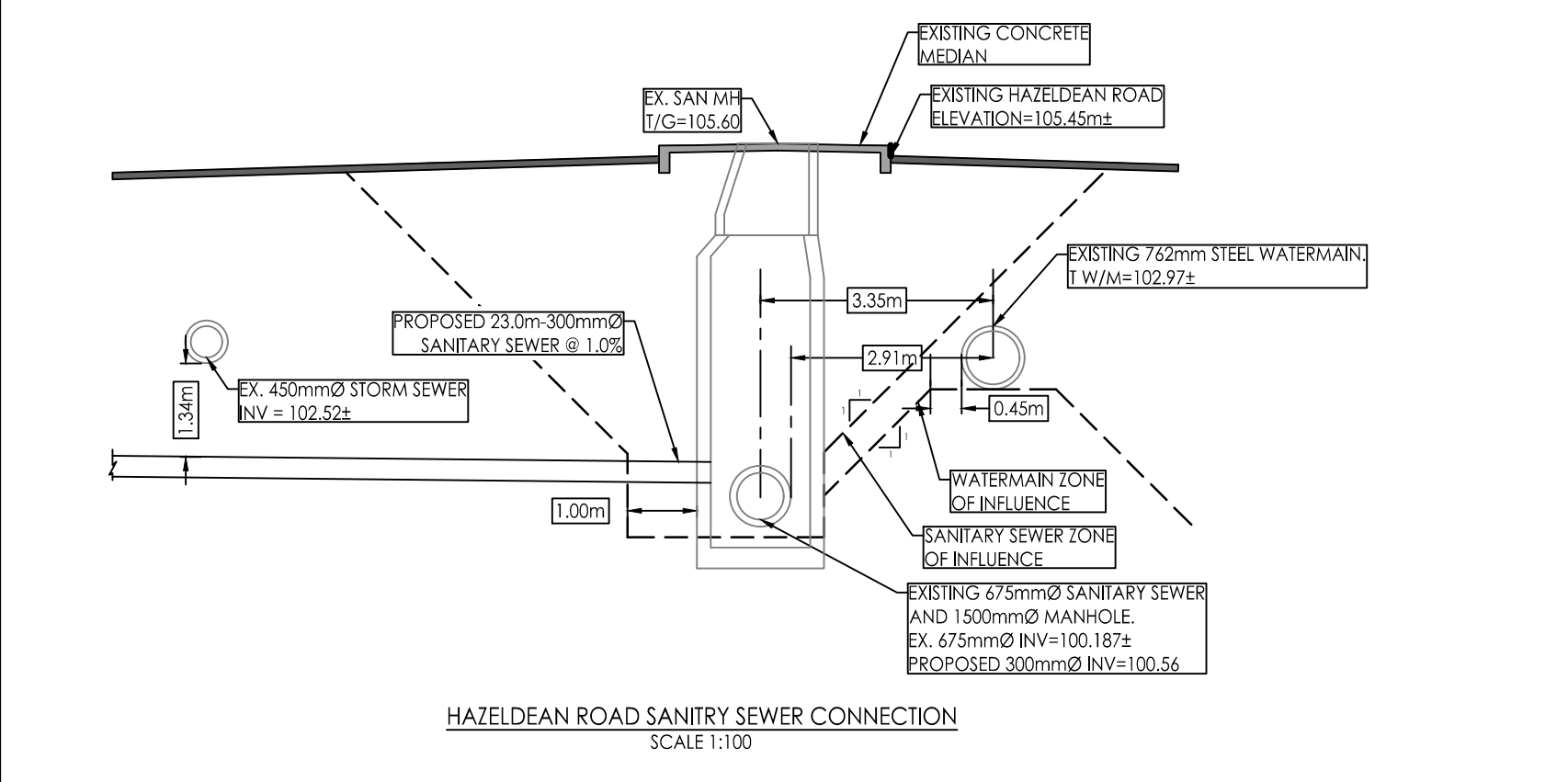

PLAN VIEW OUTLET STRUCTURE (STM MH 100) M6.5 BOX  
TYPICAL M6.5 BOX MAINTENANCE HOLE WITH 10mm INLET CAP AS PER M6.5 BOX

FRONT VIEW OUTLET STRUCTURE (STM MH 100)  
SECTION 1-1

W:\Ottawa\160401511\design\drawings\160401511-DB 2.dwg  
2023/09/20 2:51 PM by: [redacted]

D07-12-23-0004